

Locating and Seating Pins• DIN 6321

22630.0033



Product Description

Cylindric locating pins for locating workpieces in toleranced holes and also to be used as stops and feet.
Flattened locating pin used to overcome differences in tolerances, between holes or to position an element in one direction only.

Material

- Tool steel, hardened, ground

Drawing

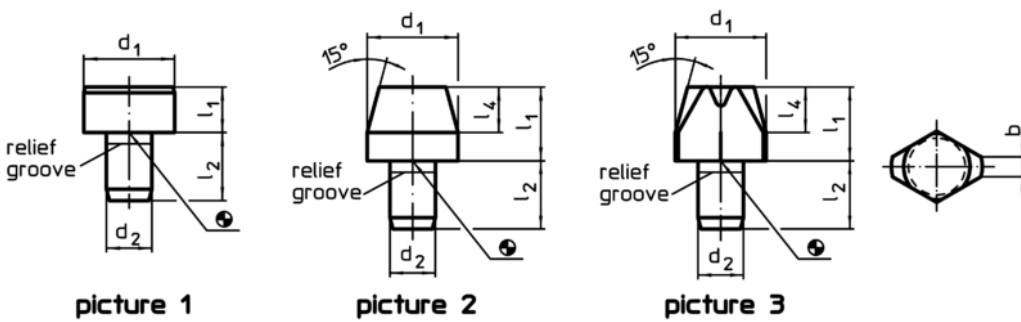

Order information

Dimensions		Location hole			Art. No.		
d_1 g6	l_1	d_2 n6 [mm]	l_2	l_4		H7 [mm]	[g]
locating pin, cylindric, DIN 6321, form B – picture 2							
25	25	12	18	9	12	106	22630.0033

Application example

