

Lateral Spring Plungers with spring steel sheet

22160.0212



Product Description

The lateral spring plunger with spring steel sheet guarantees a simple and secure positioning of workpieces or components at stops or fixture plates, e.g. in board mounting or before the clamping process in the jig and fixture construction. The double-sided version allows for serial clamping. Below h_1 is resulting a down hold effect.

Material

Spring element

- Stainless steel

Body

- Steel, black

Drawing

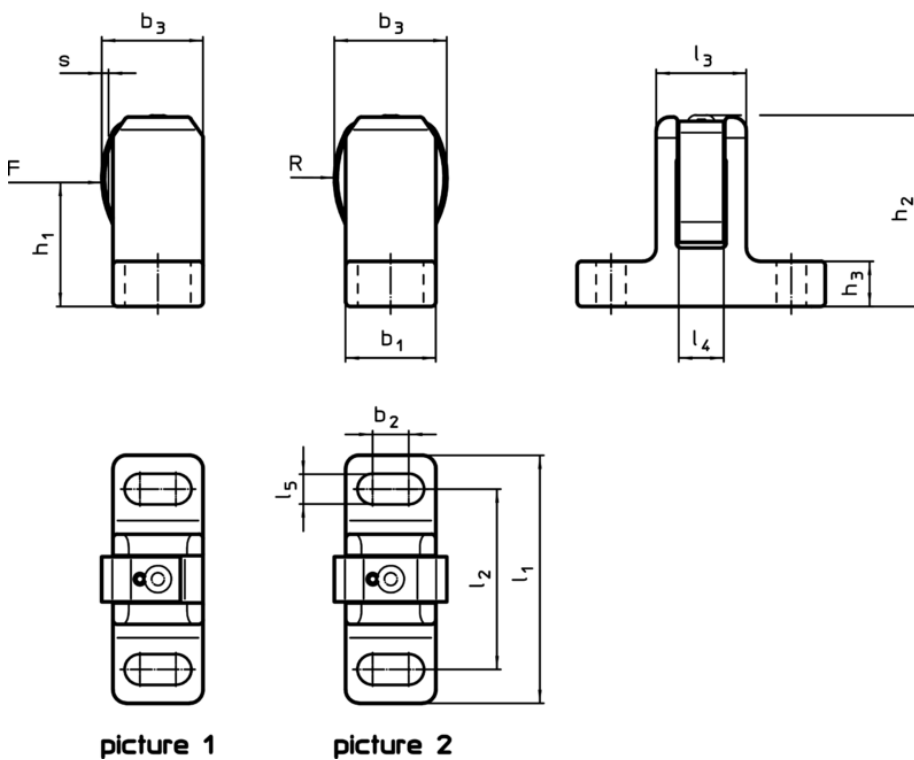

Order information

Dimensions													Stroke s	For screw	Spring load F max. ¹⁾ ~ [N]	🌡️ max. [°C]	🏠 [g]	Art. No.
l_1 ± 1	l_2	l_3	l_4	l_5	b_1 $\pm 0,5$	b_2	b_3 ~	h_1	h_2 ± 1	h_3	R							
[mm]													[mm]	[mm]	[N]	[°C]	[g]	
double-sided – picture 2																		
72	50	23	12	13,5	25	6	33,5	40,5	61,5	15	32,8	1,5	M12	170	250	260	22160.0212	

¹⁾ statistical average value

Application example

