

## Lateral Spring Plungers with spring steel sheet

22160.0012



### Product Description

The lateral spring plunger with spring steel sheet guarantees a simple and secure positioning of workpieces or components at stops or fixture plates, e.g. in board mounting or before the clamping process in the jig and fixture construction. The double-sided version allows for serial clamping. Below  $h_1$  is resulting a down hold effect.

### Material

#### Spring element

- Stainless steel

#### Body

- Steel, black

### Drawing

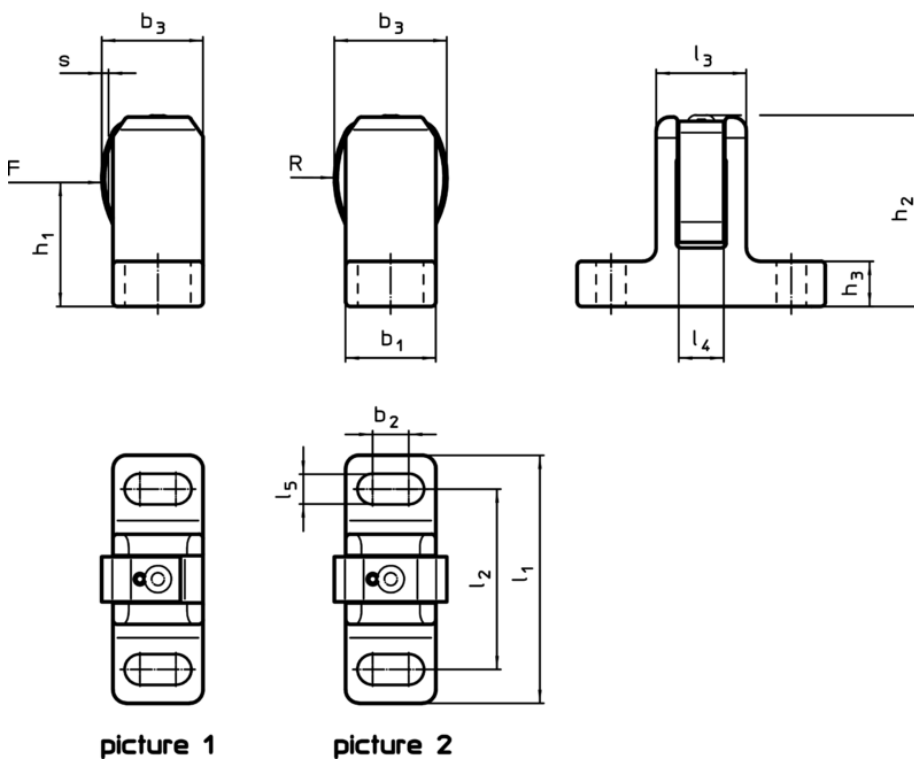

picture 1

picture 2

### Order information

Dimensions														Stroke s	For screw	Spring load F max. <sup>1)</sup> ~	max. [°C]	[g]	Art. No.
l <sub>1</sub> ±1	l <sub>2</sub>	l <sub>3</sub>	l <sub>4</sub>	l <sub>5</sub>	b <sub>1</sub> ±0,5	b <sub>2</sub>	b <sub>3</sub> ~	h <sub>1</sub>	h <sub>2</sub> ±1	h <sub>3</sub>	R	[mm]	[mm]						
one-sided – picture 1																			
72	50	23	12	13,5	25	6	29	40,5	61,5	15	32,8	1,5	M12	170	250	255	22160.0012		

<sup>1)</sup> statistical average value

Application example

