

Lateral Spring Plungers with spring steel sheet

22160.0006



Product Description

The lateral spring plunger with spring steel sheet guarantees a simple and secure positioning of workpieces or components at stops or fixture plates, e.g. in board mounting or before the clamping process in the jig and fixture construction. The double-sided version allows for serial clamping. Below h_1 is resulting a down hold effect.

Material

Spring element

- Stainless steel

Body

- Steel, black

Drawing

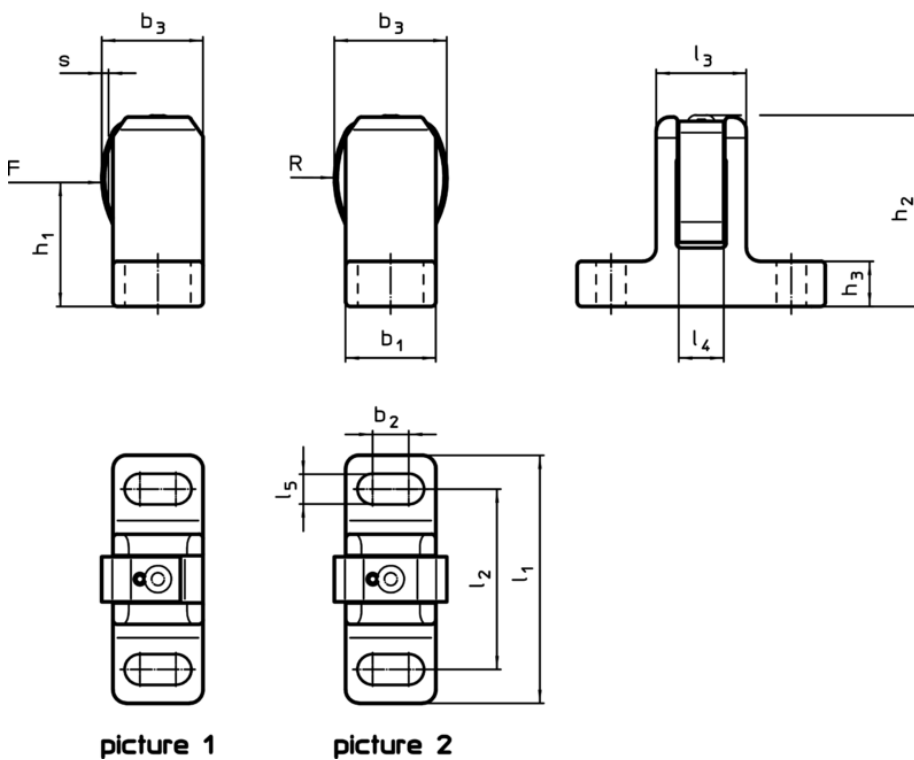

picture 1

picture 2

Order information

Dimensions											Stroke s	For screw	Spring load F max. ¹⁾ ~	max. [°C]	[g]	Art. No.	
l_1 ± 1	l_2	l_3	l_4	l_5	b_1 $\pm 0,5$	b_2	b_3 ~	h_1	h_2 ± 1	h_3							R
one-sided – picture 1																	
55	40	20	10	6,6	20	8	22,5	28,5	43	10	22,5	1,5	M6	55	250	130	22160.0006

¹⁾ statistical average value

Application example

