

## Spring Plungers· smooth, long, with collar and ball 22080.1105



### Product Description

Spring plungers can be used for locating or for applying pressure, as a detent or for ejection. This version has higher spring forces than the standard version. "EH 22080. Spring Plungers, smooth, with collar and ball".

#### Material

##### Body

- Stainless steel 1.4303

##### Ball

- Stainless steel, hardened

##### Spring

- Stainless steel

### More information

#### Notes

Special types on request.  
Spring range and forces are precisely tested.

#### References

Calculation of indexing resistance, see details at the start of the section.

#### Further products

- Spring Plungers, smooth, with collar and ball

### Drawing

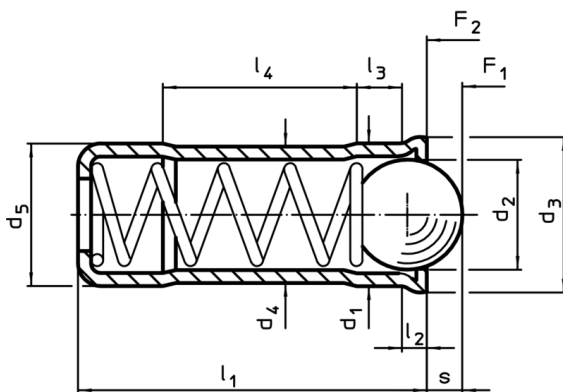

### Order information

| Dimensions                      |                |                |                |                         |                |                     |                     |                     |                     | Stroke<br>s<br>+0,2<br>-0,1<br>[mm] | Spring load <sup>1)</sup> |     | max.<br>[°C] | Location hole<br>H7<br>[mm] | [g] | Art. No. |
|---------------------------------|----------------|----------------|----------------|-------------------------|----------------|---------------------|---------------------|---------------------|---------------------|-------------------------------------|---------------------------|-----|--------------|-----------------------------|-----|----------|
| d <sub>1</sub><br>+0,1<br>+0,04 | d <sub>2</sub> | d <sub>3</sub> | d <sub>4</sub> | d <sub>5</sub><br>±0,04 | l <sub>1</sub> | l <sub>2</sub><br>~ | l <sub>3</sub><br>~ | l <sub>4</sub><br>~ | F <sub>1</sub><br>~ |                                     | F <sub>2</sub><br>~       | [N] |              |                             |     |          |
| 5                               | 4              | 5,6            | 4,85           | 5                       | 12             | 0,9                 | 2,1                 | 6                   | 19,3                | 29,2                                | 250                       | 5   | 1            | 22080.1105                  |     |          |

<sup>1)</sup> statistical average value

Application example

