

## Spring Plungers with internal hexagon

22060.0404

### Product Description

Spring plungers can be used for locating or for applying pressure, as a detent or for ejection.



#### Material

##### Pin

- Stainless steel 1.4305

##### Body

- Stainless steel 1.4305

##### Spring

- Stainless steel

#### Assembly

Spring plungers can be mounted and removed by means of the slot or internal hexagon. Please use a special assembly tool for mounting with a slot (pin side).

#### Characteristic

Standard spring load: no marking

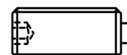

Standard spring load

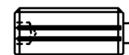

Heavy spring load

#### More information

#### Notes

Special types on request.  
Spring range and forces are precisely tested.

#### References

Thread lock on request, please refer to appendix - Technical Data -

#### Further products

- Spring Plungers, with internal hexagon and seal

### Drawing

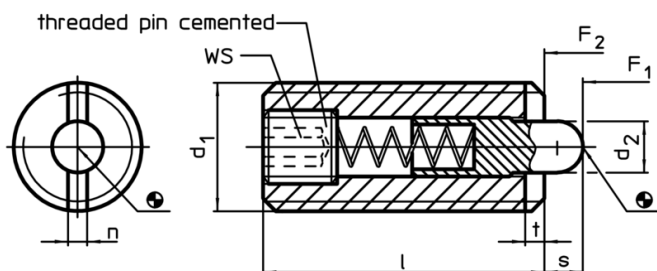

### Order information

Dimensions					WS	Stroke s	Spring load <sup>1)</sup>		max. [°C]	[g]	Art. No.
d <sub>1</sub>	d <sub>2</sub>	l	n	t			F <sub>1</sub> ~	F <sub>2</sub> ~			
[mm]					[mm]	[mm]	[N]				
stainless steel, standard spring load											
M4	1,5	15	0,6	0,6	1,3	1,5	4,5	16	250	1,1	22060.0404

<sup>1)</sup> statistical average value

### Accessories

Dimensions d <sub>1</sub> [mm]	[g]	Art. No.
Assembly tool for mounting via slot (pin sided)		
M 4	29	22060.0804

Application example

