

## Spring Plungers with internal hexagon

22060.0212

### Product Description

Spring plungers can be used for locating or for applying pressure, as a detent or for ejection.



#### Material

##### Pin

- Thermoplastic POM, white

##### Body

- Free cutting steel, blackened

##### Spring

- Stainless steel

#### Assembly

Spring plungers can be mounted and removed by means of the slot or internal hexagon. Please use a special assembly tool for mounting with a slot (pin side).

#### Characteristic

Standard spring load: no marking

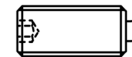

Standard spring load

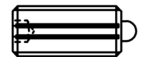

Heavy spring load

#### More information

#### Notes

Special types on request.  
Spring range and forces are precisely tested.

#### References

Thread lock on request, please refer to appendix - Technical Data -

#### Further products

- Spring Plungers, with internal hexagon and seal

### Drawing

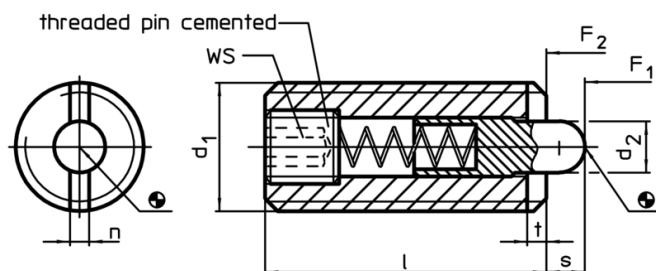

### Order information

| Dimensions   |                |    |     |   | WS<br>[mm] | Stroke<br>s<br>[mm] | Spring load <sup>1)</sup>  |                            | min.<br>[°C] | max.<br>[°C] | [g] | Art. No.   |
|--|----------------|----|-----|---|------------|---------------------|----------------------------|----------------------------|--------------|--------------|-----|------------|
| d <sub>1</sub>   | d <sub>2</sub> | l  | n   | t |            |                     | F <sub>1</sub><br>~<br>[N] | F <sub>2</sub><br>~<br>[N] |              |              |     |            |
| free cutting steel, pin from thermoplastic, standard spring load |                |    |     |   |            |                     |                            |                            |              |              |     |            |
| M12  | 6              | 28 | 2,7 | 2 | 4          | 4                   | 12                         | 53                         | -30          | 50           | 14  | 22060.0212 |

<sup>1)</sup> statistical average value

### Accessories

| Dimensions<br>d <sub>1</sub><br>[mm]            | [g] | Art. No.   |
|---|-----|------------|
| Assembly tool for mounting via slot (pin sided) |     |            |
| M12   | 112 | 22060.0812 |

Application example

