

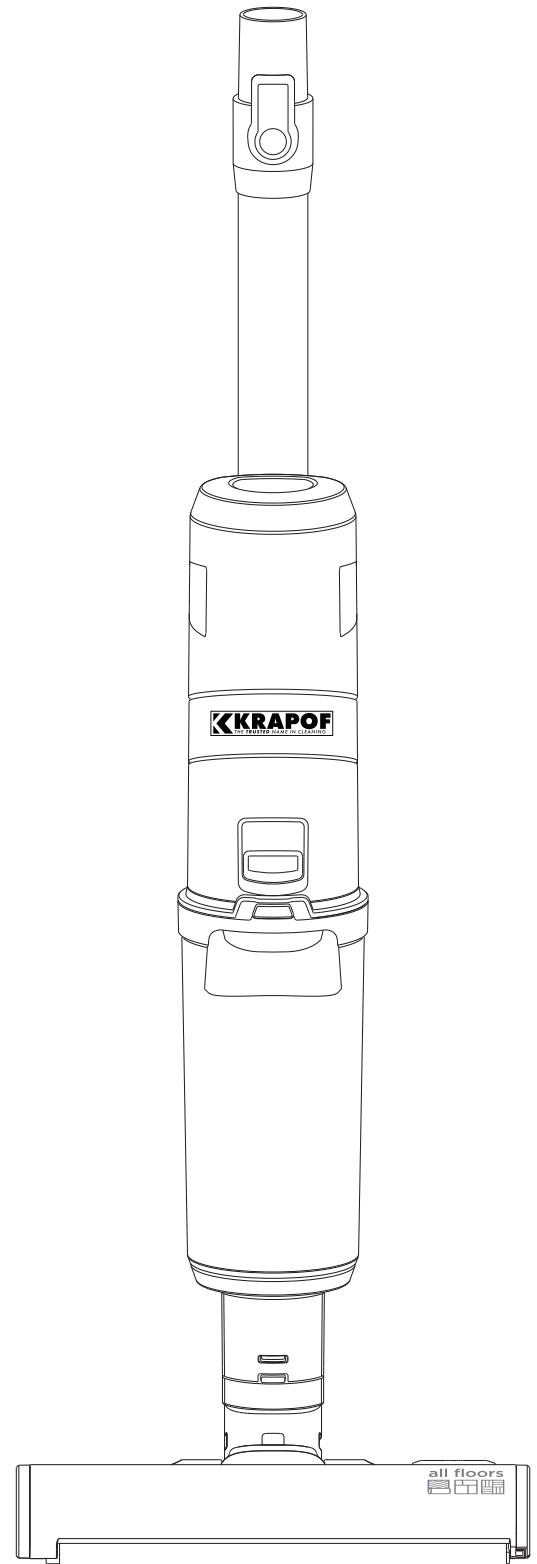

# SLIMVAC

## Wet & Dry

<b>Battery</b>	25.9V/2000mah
<b>Charging Period</b>	5 hours
<b>Battery Charger Output</b>	30V/500mA
<b>Net Weight</b>	2.65kg
<b>Usage Time</b>	MIN: Up to 35 min (ECO cleaning mode) MAX: Up to 8 min (Boost Cleaning Mode)
<b>Power</b>	350w
<b>Model Number</b>	KRWDVAC-03



# USER MANUAL

Please Read this **User Guide** carefully before use  
& keep it handy for future reference

# SAFETY WARNINGS



Read the operating instructions carefully and pay special attention to the safety information. If you do not follow the safety instructions or the information on proper handling in this manual, we assume no liability for any resulting personal injury or property damage. Such cases will invalidate the warranty/guarantee.

## **IMPORTANT General Use:**

- This appliance is not intended for use by persons (including children) with reduced physical, sensory, or mental capabilities, or those lacking experience and knowledge, unless they have received supervision or instruction regarding the use of the appliance from a person responsible for their safety.
- Children should be supervised to ensure they do not play with the appliance.
- **General Use:**
- If a vacuum cleaner can be equipped with a hand-held accessory with rotating parts, a warning must be provided regarding the risk of entrapment.
- Never use the appliance if its adapter or plug is damaged, if it is not working properly, or if it has fallen and been damaged. In such cases, take the appliance to a service center for a safety and functionality check.
- Never immerse the charger, battery, or motor part of the vacuum cleaner in water (even partially) and protect them from moisture.
- Switch off the device before performing any use or technical maintenance on tank.
- Never leave the product unattended while in operation.
- Do not charge the battery if electrolyte is leaking from it.
- The appliance must be disconnected from the power adapter when removing the battery.
- Do not throw the battery into fire. There is a risk of explosion!
- To ensure safety and proper functioning of the appliance, use only original spare parts and accessories approved by the manufacturer.
- Only use this appliance for the purpose it was designed for, as specified in this manual. Never use the appliance for any other purpose.
- The manufacturer is not responsible for damage caused by improper use of the appliance or accessories, and the warranty does not apply if the safety warnings above are not followed. Failure to replace or maintain all filters regularly, or using non-original filters that result in failure or damage to the vacuum cleaner, is considered improper use of the appliance.

# SAFETY WARNINGS

## **B) Use Of The Appliance:**

- The product is intended for home use and similar environments (e.g., shops, offices, hotels, motels, and other residential accommodations, including facilities offering breakfast). It is not intended for commercial use.
- Avoid contact with the rotating brush when handling the vacuum cleaner (e.g., with loose clothes, hair, fingers, jewelry, bracelets, etc.).
- Do not leave the floor nozzle with the rotating brush in one place for too long, as this could damage the surface being vacuumed.
- The floor nozzle with the rotating brush is not intended for vacuuming impurities from carpets with high piles.
- Do not use the mopping adapter for dry cleaning.
- When cleaning floors made of parts or containing wooden components, ensure that the floor is completely sealed against water leaks. The surface must also be resistant to spilled water.
- The manufacturer is not liable for any damages caused by water leaking into the floor and will not participate in compensation for such damages.
- The mopping adapter is intended for cleaning carpet hard flooring materials (e.g., wood, linoleum, vinyl, floor tiles, parquet, floating floors, etc.). It is not intended for vacuuming dirt from carpets.
- Never use the vacuum cleaner or touch the adapter with wet hands or feet.
- Always switch off the vacuum cleaner when charging the battery and after use.
- Do not vacuum wet or moist floor coverings. Do not use the vacuum cleaner in outdoor areas. Moisture entering the unit can cause damage and disable it. This defect is not covered by the warranty.
- Do not vacuum water, liquids, or aggressive liquids.
- Do not vacuum sharp objects (e.g., glass, shards), hot, flammable, or explosive items (e.g., ash, hot cigarette butts, gasoline, thinners, aerosol vapors), or greasy substances (e.g., fats, oils), or caustic agents (e.g., acids, solvents). Vacuuming these items may damage the dust filters or the vacuum cleaner.
- The pores of the microfilters may become clogged when vacuuming very fine dust, reducing air permeability and suction performance. In such cases, the microfilters must be cleaned before the container is full.
- Do not use the vacuum cleaner to clean up dust and dirt from construction activities, such as plasterboard dust, fine sand, cement, construction dust, or plaster particles. Vacuuming such materials may cause damage to the unit. Warranty repairs do not cover damage caused by this type of dirt.

# SAFETY WARNINGS

## **C) Accessories & Assemble Of The Appliance:**

Install the vacuum cleaner and appliance at a safe distance from flammable objects (e.g., curtains, drapes, wood, etc.), heat sources (e.g., ovens, stoves, etc.), and wet surfaces (e.g., sinks, washbasins, etc.).

## **D ) ADAPTER:**

- If the adapter of the appliance is damaged, it must be replaced by the manufacturer, a service technician, or a similarly qualified person to prevent dangerous situations.
- **WARNING:** To charge the battery, use only the network adapter supplied with this appliance.
- To power the appliance, only apply a safe, low voltage in accordance with the specifications on the type plate.
- Use the charger only indoors.
- The adapter supplied with this appliance is intended for this appliance only. Do not use it for other purposes.
- The power cord must not be damaged by sharp or hot objects, open fire, water immersion, or bending over sharp edges.

!

# PARTS/FEATURES

## DRY VACUUM

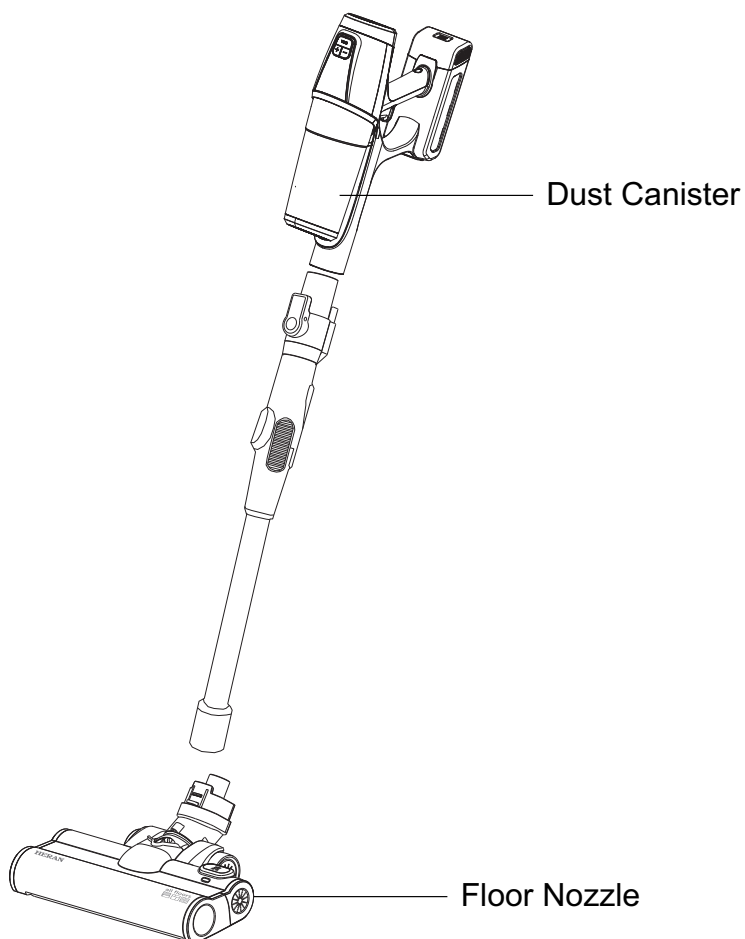

## WET VACUUM

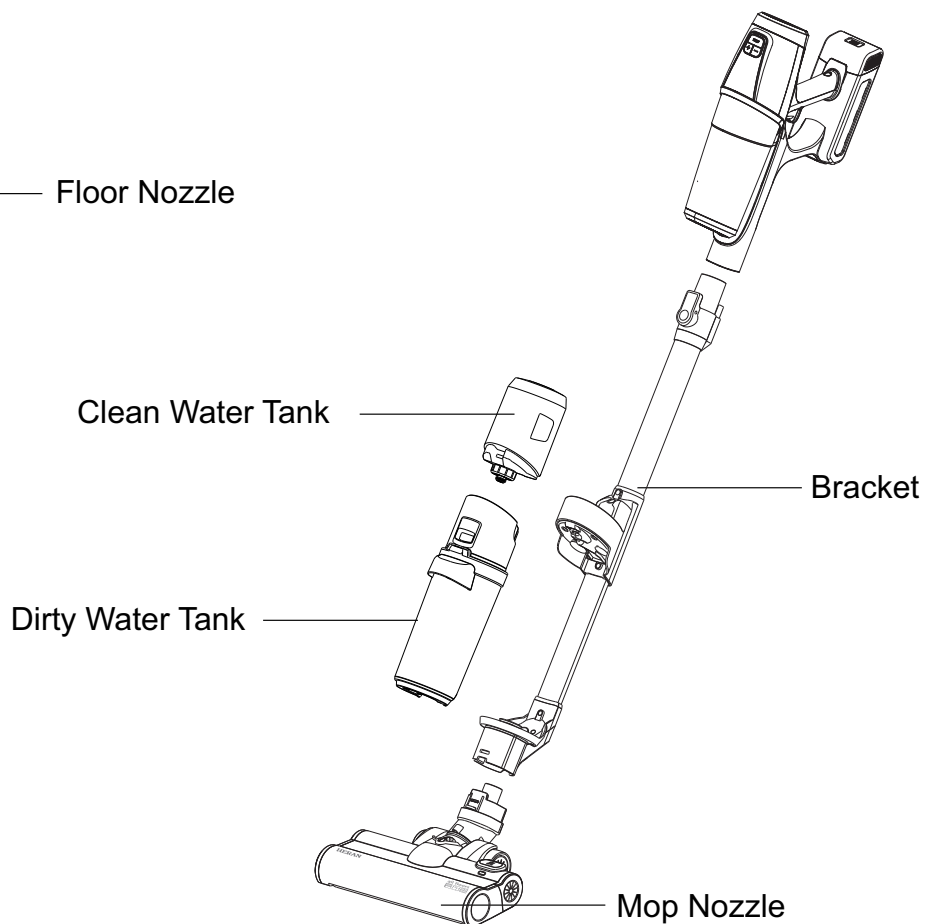

# 1. Accessory Instructions/Assembly

- Remove all packing material and take out the vacuum cleaner and accessories.
- Remove any adhesive films, stickers, or paper from the appliance.

## VACUUM CLEANER ASSEMBLY

When assembling the vacuum cleaner, follow the procedure outlined below. Select the appropriate accessories based on the intended use. For disassembly, reverse the procedure and release the locks.

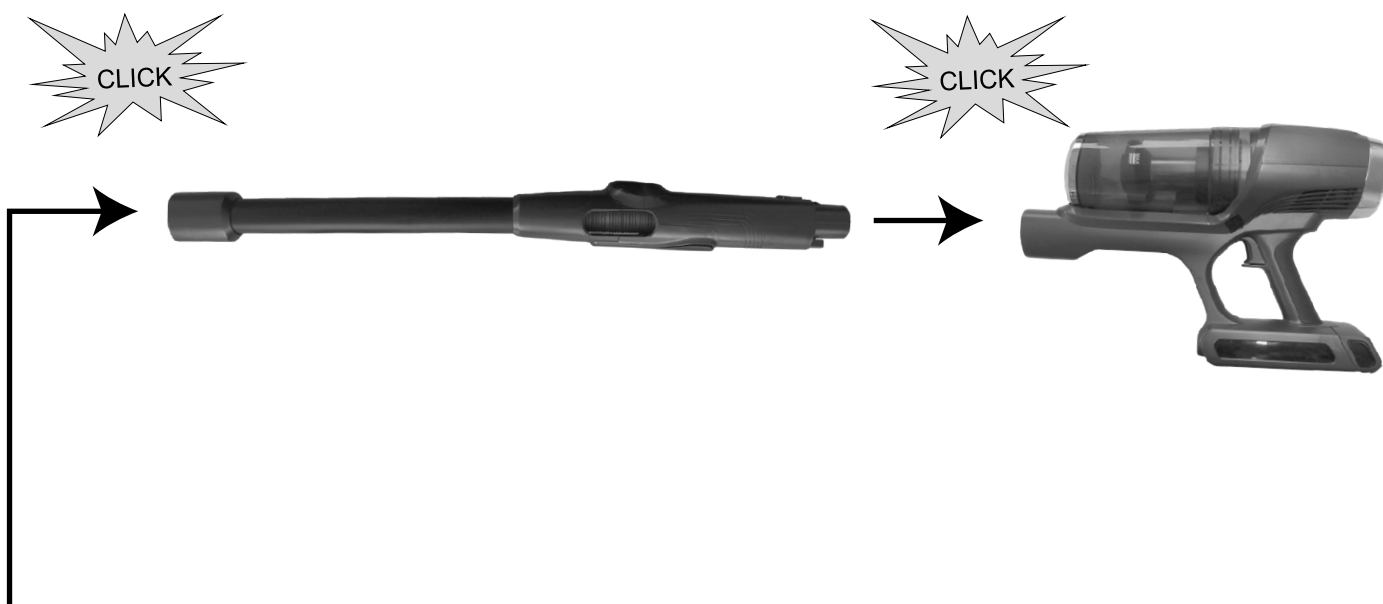

DRY CLEANING HEAD	WET CLEANING HEAD
	

# 1. Accessory Instructions/Assembly

## CHARGING THE BATTERY

Switch off the device before charging (it cannot be switched on during the charging process). Insert the adapter into the battery charging connector and then plug it into the mains, or use the charging holder, inserting the adapter into the stand charging connector and then into the mains. The battery must be charged for at least 8 hours prior to the first use. After that, the standard charging time is approximately 4-6 hours. The charging status and progress are indicated by the indicator.



**If you are charging the battery using only the adapter, remove the battery from the vacuum cleaner before charging.**

# 1. Accessory Instructions/Assembly

## Operation and battery status indicator LEDs

Flashing blue	Flat battery
Increasing number of blue flashing segments	Battery is charging.
Blue light on continuously	Battery is charged / indication of operation (individual segments turn off during operation, as the battery discharges)



**Recharge the vacuum cleaner as soon as its suction performance weakens. When using the vacuum cleaner for an extended period or in a hot environment, the battery may become too hot for charging. Allow the battery to cool down before charging.**

## USE OF VACUUM CLEANER

Allow the vacuum cleaner to charge sufficiently before use.

### ON/OFF Button

- Press the button to switch on the device.
- Press the button again to switch off the device.

Buttons "+" or "-" for Suction Power Adjustment. Six suction power levels are available:

- Press "+" to increase the suction power.
- Press "-" to decrease the suction power.
- 

### Button "AUTO" for Automatic Suction Power Adjustment

- Press "AUTO" to activate automatic suction power adjustment based on the level of debris/dirt (the indicator light will turn on when this mode is active).
- Press "+" or "-" to turn off this mode (the indicator lamp will turn off).





# 1. Accessory Instructions/Assembly

## NOTE

The floor nozzle has electronic protection against rotation brush blockage. If the rotation brush becomes blocked during operation, follow these instructions:

- If the rotation brush of the floor nozzle is blocked, the LEDs will turn off, the brush will stop rotating, and the indicator lamp will turn on. The motor will continue running.
- Switch off the device, remove the obstruction, and then you can switch the back on.

Floor Nozzle



Indicator Lamp



# 1. Accessory Instructions/Assembly

## USE OF MOPPING NOZZLE

### Rolling brush removal

Push the slide button in the direction of the arrow, and pull out the roller brush to dry and replace.

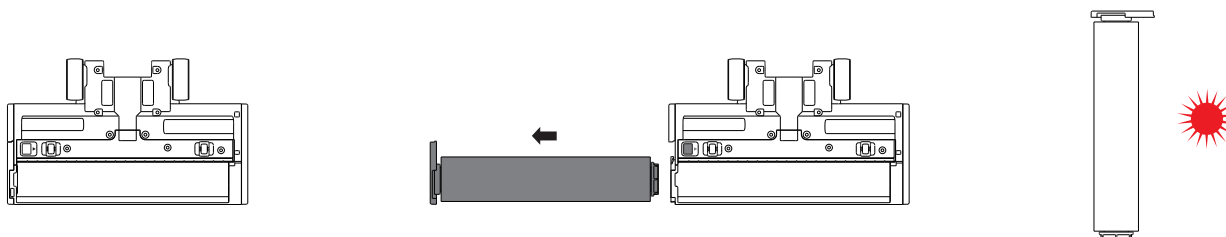

### Inject water

Open the clean water tank cover, pour in water below the highest water level, and then close the lid and tighten it.

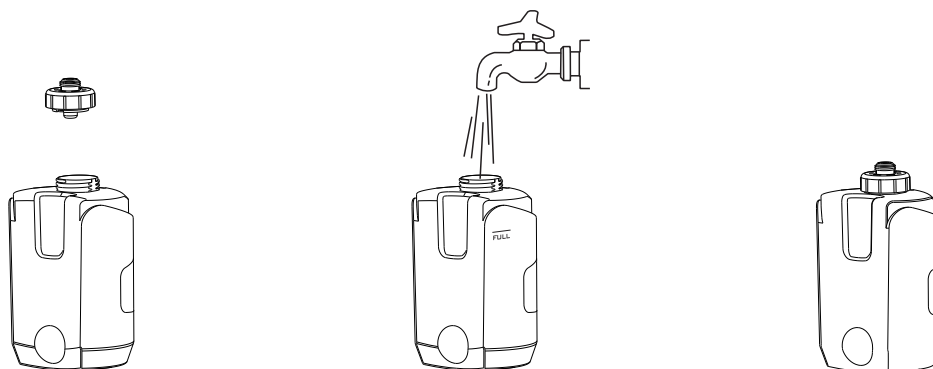

### Discard of the dirty water

Take off the cover of the dirty water tank, remove the cover to empty the dirty water, and then rinse the dirty water tank.



# 1. Accessory Instructions/Assembly

## 1. How to connect to host

Place the mopping accessory on the ground. Vertically insert the lower part of the vacuum cleaner into the mop accessory connector. Press the handheld vacuum cleaner downward until you hear a “click” sound, indicating the connection is complete.



The product is a vacuum cleaner accessory and cannot be used alone without an independent power supply. When the product is in high-power mode, water vapor may be generated due to strong suction. It is recommended to use it for no more than 3-4 minutes.

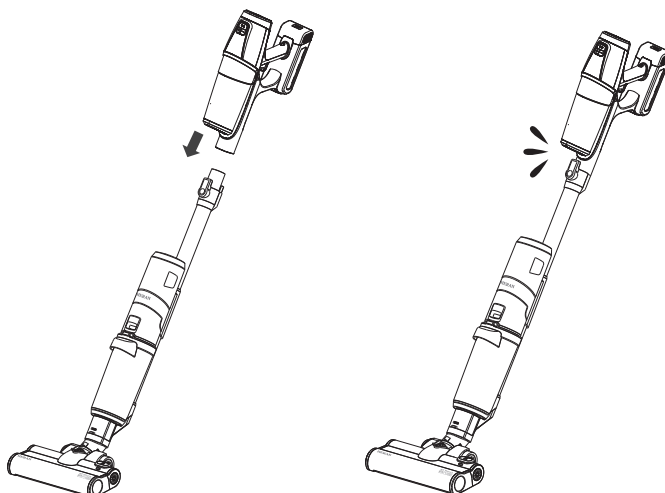

## 2. Spray water on the ground

When you press the water button, the indicator light will turn on, and water will be sprayed onto the ground. Press the button again, and the indicator light will turn off, stopping the water spray.

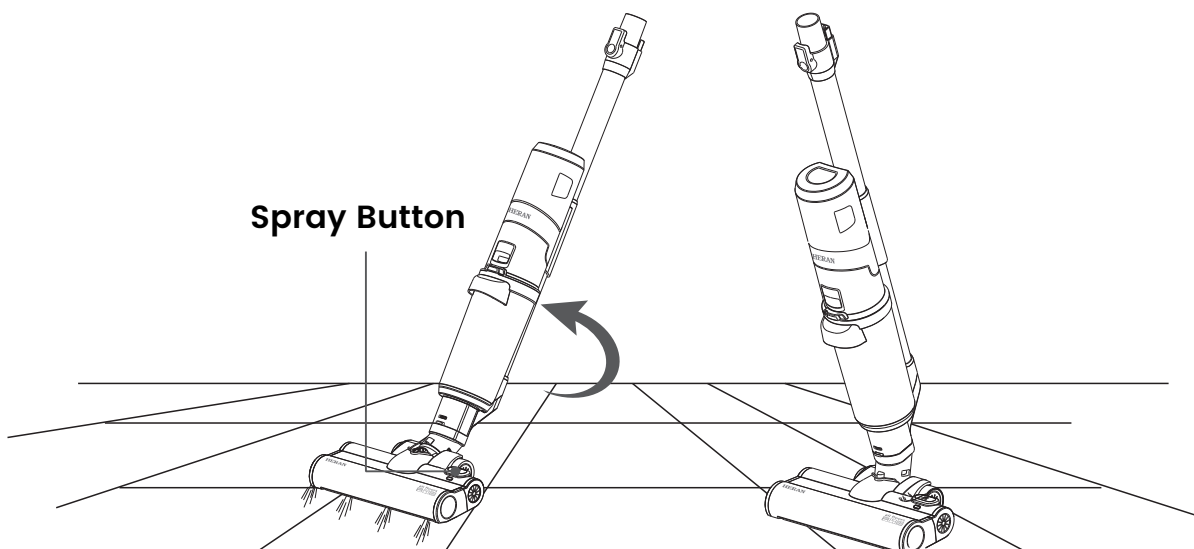

## 2. Cleaning And Maintenance

### NOTE

- For hygienic purposes, we recommend emptying the container and cleaning filters after each use.
- Maximum suction power can be achieved when the filters are clean and the container is empty.
- Each time you empty the dust container, we also recommend cleaning the
- when vacuuming very fine dust, the filter pores may become clogged, airflow and suction power. In this case, the filters should be cleaned, even if the container is not full.

Clean the surface of the vacuum cleaner and adapter with a soft, damp cloth.

Do not use rough or aggressive detergents!

### Accessories

After each vacuuming, visually inspect the brushes or collectors for any impurities. If any are found, remove them.

### Floor nozzle with rotary brush

Remove any dirt, especially hair or pet hair, stuck to the brush.

To make cleaning easier, the brush can be removed (see Fig. 1).

### Dust container

Clean the surface and interior of the container (see Fig. 2) with a soft, damp cloth. Blow out the separator. The plastic components can be rinsed under running water. Allow all parts to dry completely.

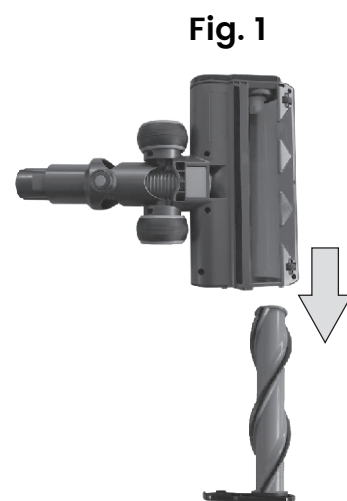
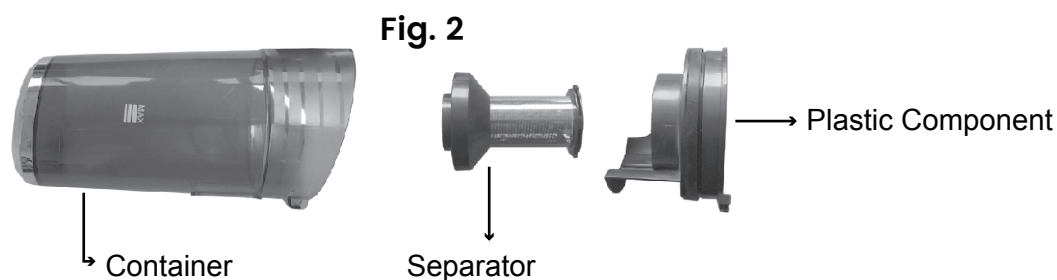

### HEPA filter

Gently shake out the HEPA filter (see Fig. 3) or blow it out. If the HEPA filter is very dirty, you can rinse it under lukewarm running water. Allow it to dry thoroughly.

### Mopping adapter

Use a soft, damp cloth to clean the surface of the mopping adapter. For thorough maintenance, the adapter can be disassembled (see page 9). Rinse the tank with water and the plastic holder under running water. Allow all parts to dry completely before reassembling.

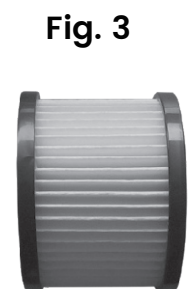

### 3. Troubleshooting

Common Faults	Possible Causes	Solution
<b>The machine will not power on</b>	<ul style="list-style-type: none"> <li>The product has no power or insufficient power.</li> <li>The Water level in the dust collection bucket has reached the specified capacity.</li> <li>The roller brush is entangled with hair and other objects.</li> </ul>	<ul style="list-style-type: none"> <li>Please fully charge the product before use.</li> <li>Take out the dust bucket and pour out the Water level before using it again.</li> <li>Clean the roller brush.</li> </ul>
<b>The suction power of the product is reduced</b>	<ul style="list-style-type: none"> <li>The roller brush cover and dust collection bucket are not installed properly.</li> <li>The roller brush is entangled with hair and other objects.</li> <li>The floor brush nozzle is blocked.</li> <li>The filter above the float valve is dirty.</li> <li>Battery power is low.</li> <li>The pre-filter is dirty.</li> </ul>	<ul style="list-style-type: none"> <li>Reinstall the components.</li> <li>Clean the roller brush.</li> <li>Clear any obstruction in the nozzle.</li> <li>Clean any filters before use.</li> <li>Please fully charge the product before use.</li> <li>Clean the front filter before use.</li> </ul>
<b>The motor makes strange noise when running</b>	<ul style="list-style-type: none"> <li>The nozzle is dirty.</li> </ul>	<ul style="list-style-type: none"> <li>Clear any obstructions in the nozzle.</li> </ul>
<b>The ground cannot be brushed with water</b>	<ul style="list-style-type: none"> <li>There is no water in the solution tank.</li> <li>The solution release button is not pressed.</li> <li>The solution tank is not installed correctly.</li> </ul>	<ul style="list-style-type: none"> <li>Add water to the solution tank.</li> <li>Press the solution release button to reinstall the solution tank.</li> <li>Install the solution tank.</li> </ul>
<b>The air outlet cover is leaking</b>	<ul style="list-style-type: none"> <li>The filter sponge is not installed.</li> <li>The float is not installed.</li> </ul>	<ul style="list-style-type: none"> <li>Install the filter sponge and float.</li> </ul>

★ If the product still cannot function properly after the above steps, please contact our company's after-sales service department for assistance.

### 3. Troubleshooting

Mainframe Function Parameters	
Product Name	Vacuum Cleaner Mopping Accessories
Rated Voltage	DC 25.9V
Power Consumption	30W
Net Weight	1.8kg
Machine Size	W270 x H805 x D210 mm
Clean Water Tank Capacity	500ml
Sewage Tank Capacity	300ml



# SLIMVAC

## Wet & Dry

<b>Battery</b>	25.9V/2000mah
<b>Charging Period</b>	5 hours
<b>Battery Charger Output</b>	30V/500mA
<b>Net Weight</b>	2.65kg
<b>Usage Time</b>	MIN: Up To 35 min (ECO cleaning mode) max: Up to 8 min (Boost Cleaning Mode)
<b>Power</b>	350w
<b>Model Number</b>	KRWDVAC-03

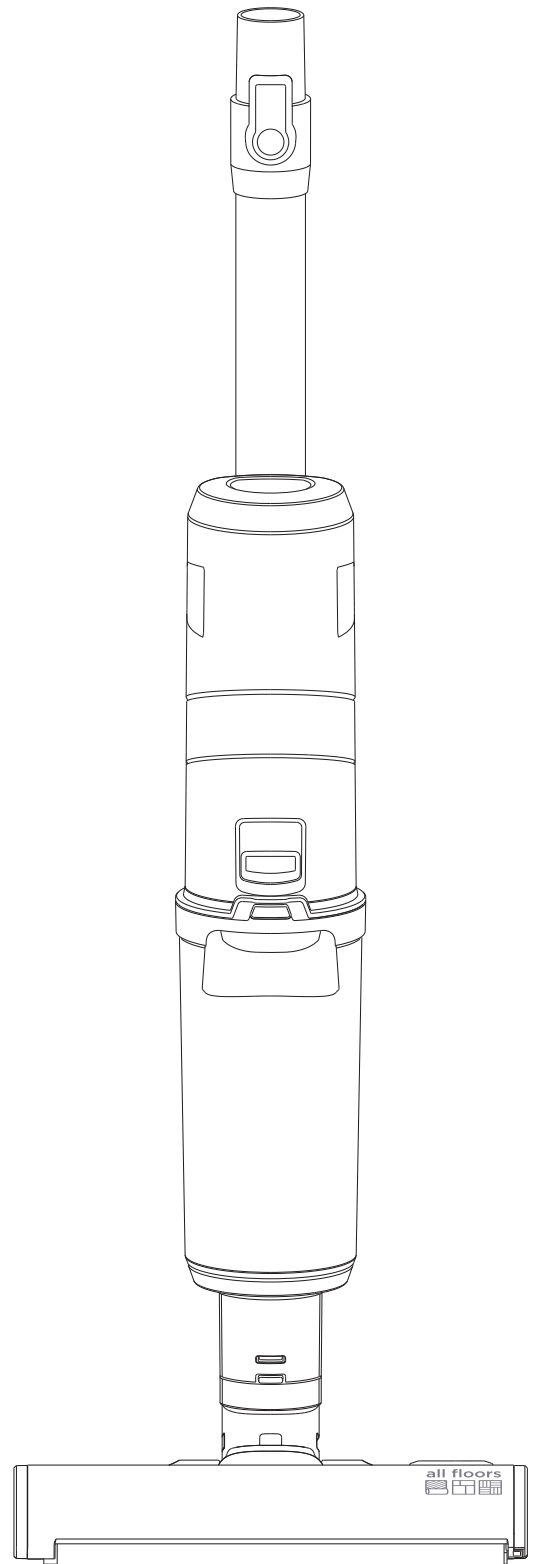

**KLEVA RANGE®**

🌐 [www.klevarange.com.au](http://www.klevarange.com.au)

☎ 02 9387 4100

✉ [enquiries@klevarange.com.au](mailto:enquiries@klevarange.com.au)

📍 Suite 301 / 209 Oxford St

Bondi Junction NSW 2022 Australia

**GENUINE  
KLEVA  
QUALITY**



Klevarange is a registered trade mark  
of Take Two Marketing and Events Pty Ltd.