

# // QUICKSTART

# VENYM

## Initial mounting

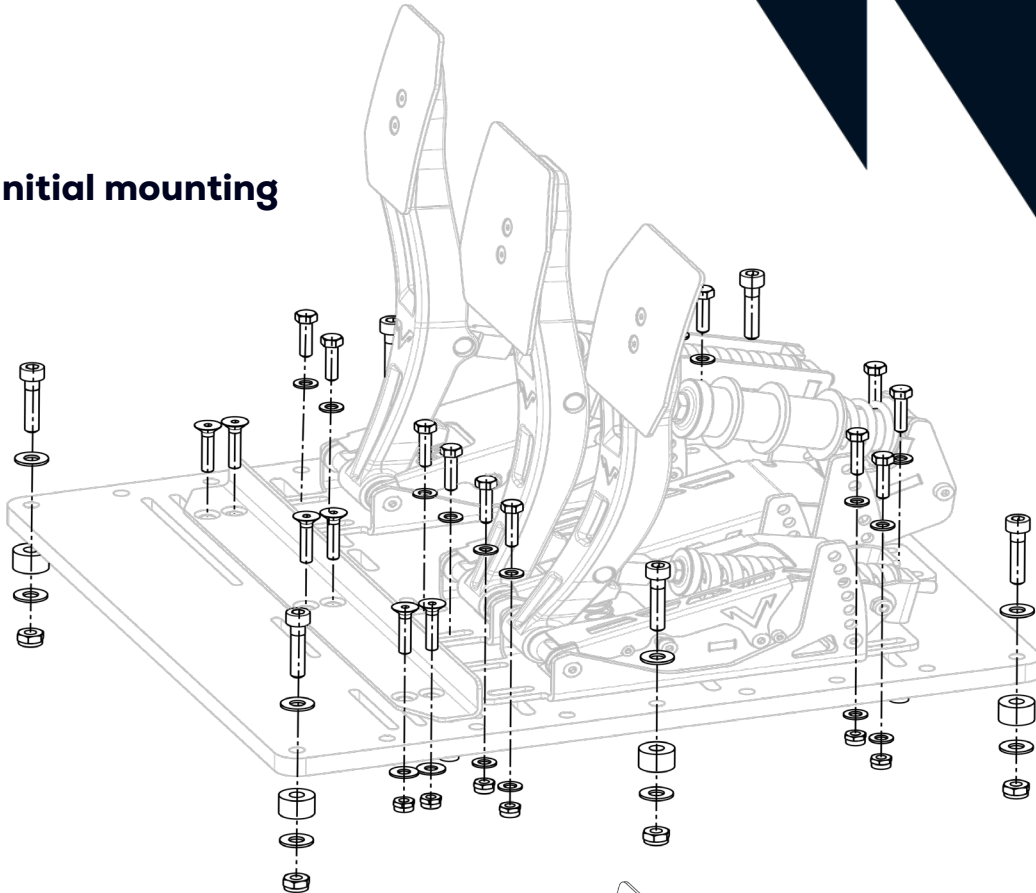

LEFT VIEW BRAKE PEDAL

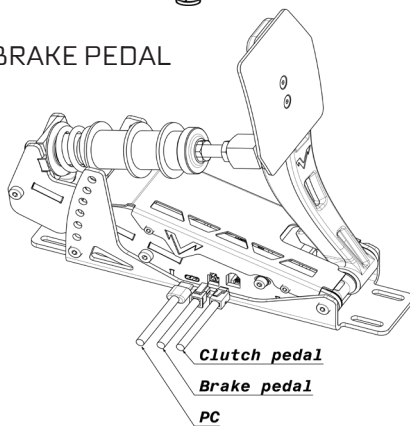

RIGHT VIEW BRAKE PEDAL

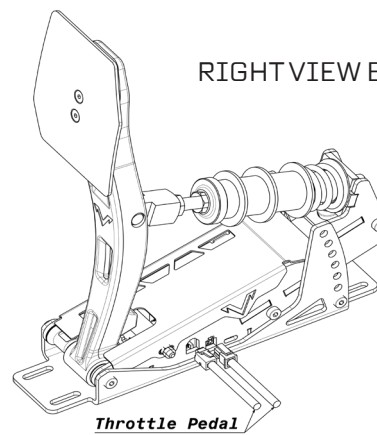

Venym Atrax and Black Widow are  
FIA Official Licensed Product ©



©FIA 2020. FIA logo, FIA word, Federation Internationale de l'Automobile words are protected by copyrights. All rights reserved.



**DOWNLOAD OUR SOFTWARE ON [PITSTOP.VENYM.COM](http://PITSTOP.VENYM.COM)**

# //1 Setups

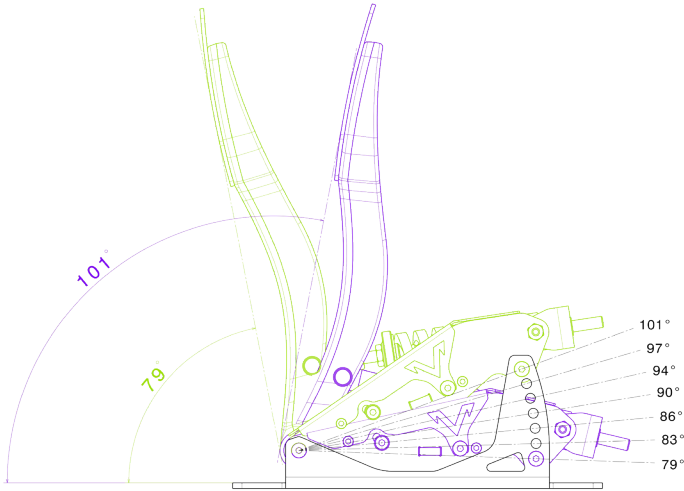

## 1/ Angle setup

Adjust the angle of each pedal from 79° to 101° by changing the rear mounting hole position.

## 2/ Pedal plate setup :

Adjust the pedal plate of each pedal in order to suit your feet.

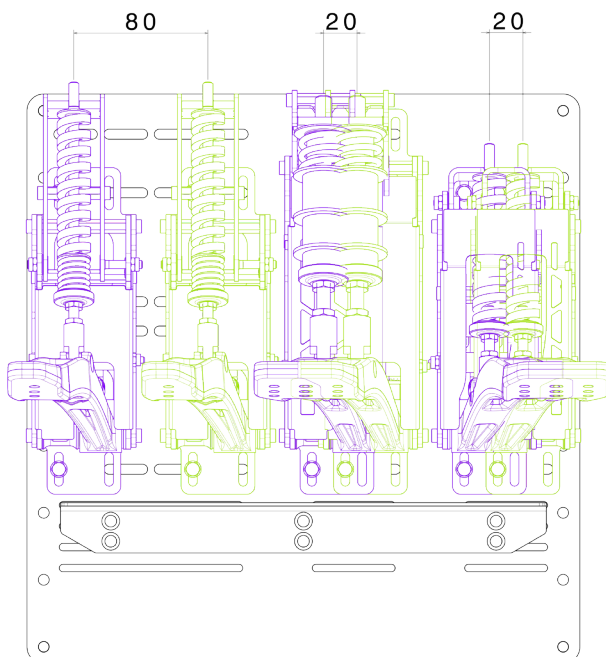
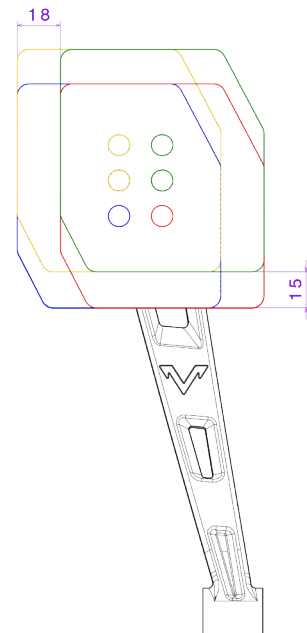

## 3/ Position setup

Each pedal can be adjusted forwards, backwards, left or right.

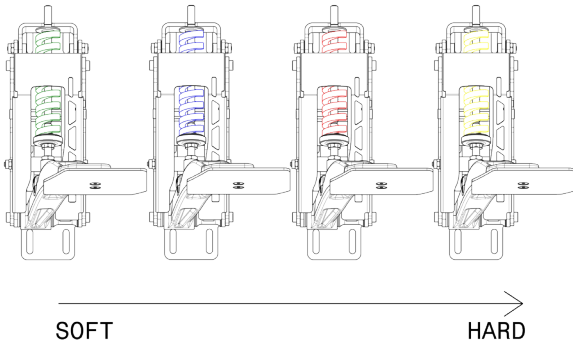

## 4/ Throttle setup

Adjust your throttle pressure with different spring options.

## 5/ Brake setup

Adjust your brake pressure with different rubber options. Add a spring on your brake pedal to get the same feeling as in a real race car.

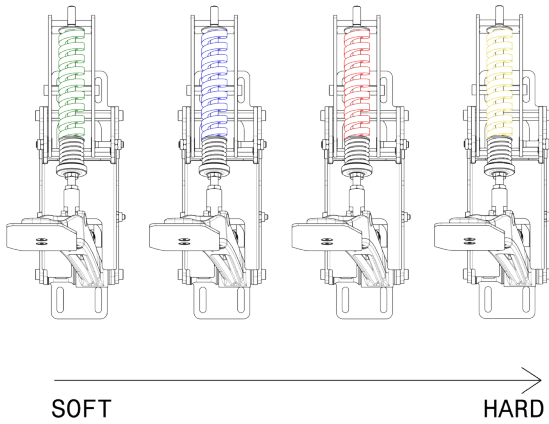
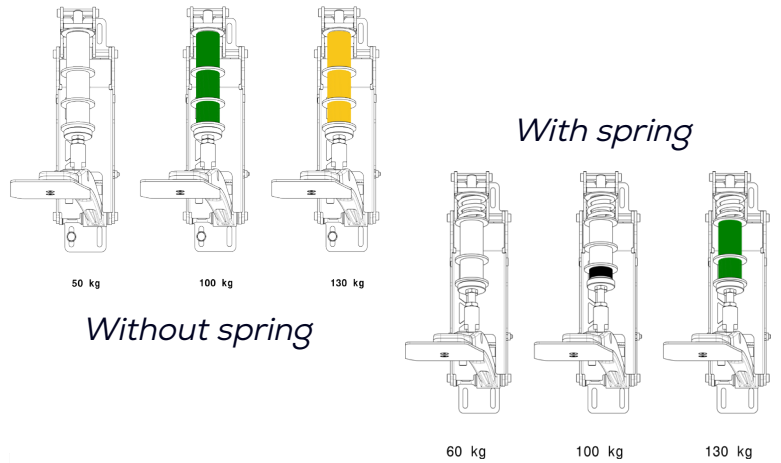

## 6/ Clutch setup

Chose your clutch pressure with different spring options.

## 7/ Pedal travel setup

Adjust the pedal travel with a combination of different positions.

From **57.9°** to **73.9°** for the clutch.  
 From **35.5°** to **48.3°** for the brake.  
 From **45.1°** to **67.5°** for the throttle.

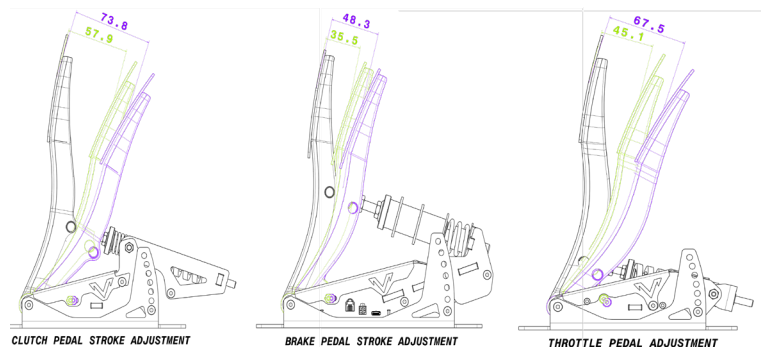

# //2 Maintenance

## 2/ Preventive lubrication

If the axle seems noisy, it is important to lubricate with silicone grease the screw inside the pedal axis.

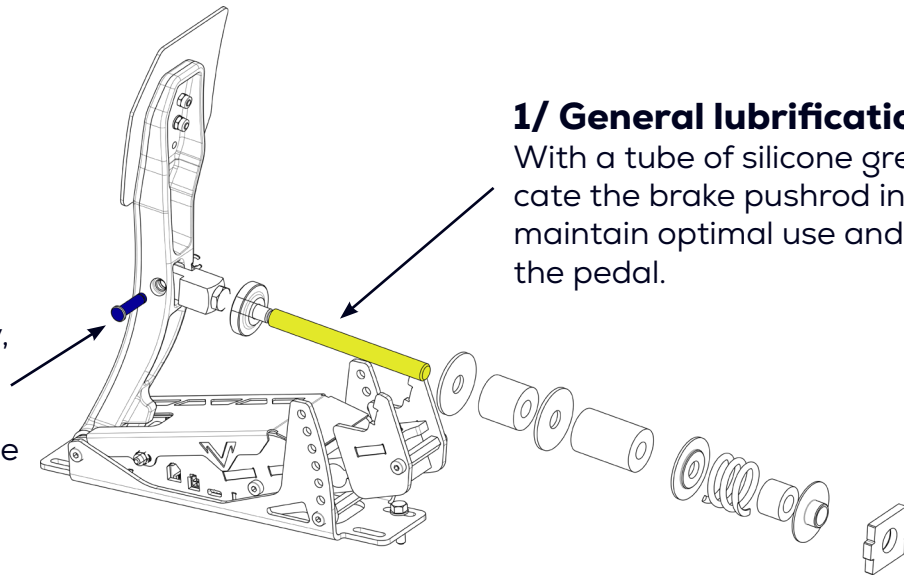

## 1/ General lubrication

With a tube of silicone grease, lubricate the brake pushrod in order to maintain optimal use and longevity of the pedal.

# //3 Software

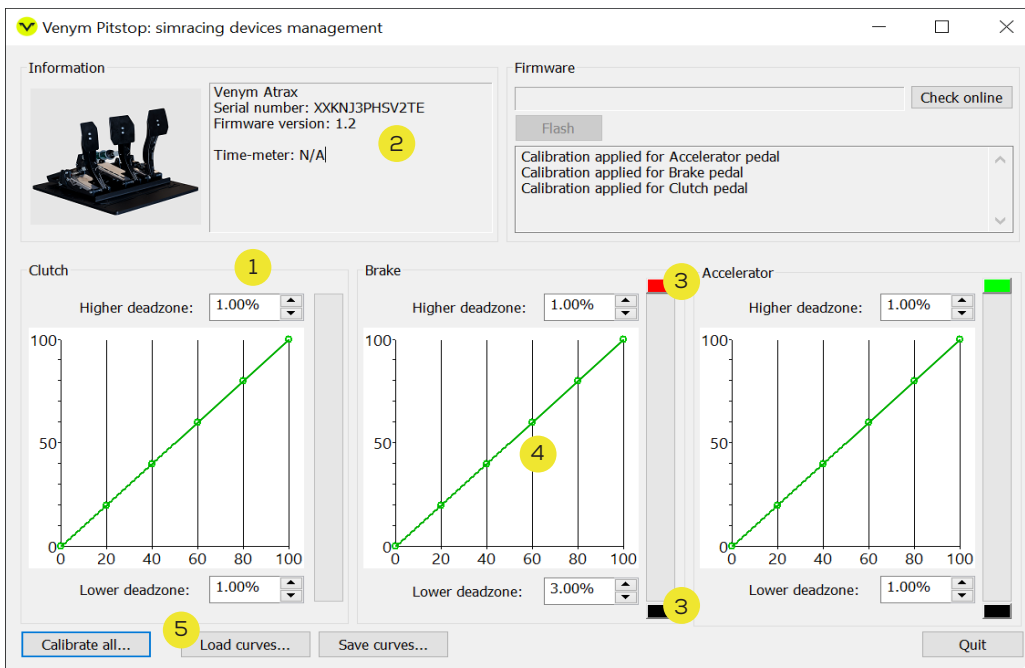

- 1 Edit your upper and lower pedal travel deadzone
- 2 Check if your firmware is updated
- 3 Pedals lights customization
- 4 Adjust the curves to your needs
- 5 Load preset curves from your preferred cars

Calibrate all three pedals with our calibration system. You can also calibrate each pedal independently with a right click on the graph.

Download our software  
[pitstop.venym.com](https://pitstop.venym.com)

