

# Patio Pet Door Kit

Product codes:

Black #1129, #1130, #1131

White #1092, #1094, #1096

Silver #1142, #1144, #1146

**IMPORTANT!**  
**READ AND FOLLOW THESE**  
**INSTRUCTIONS CAREFULLY**  
**AND KEEP FOR FUTURE**  
**REFERENCE.**

INSTALLATION INFO



# TABLE OF CONTENTS

## TOOLS REQUIRED - Not included

Flat head screw driver



### WHAT'S IN THE BOX

Parts List 02

### SAFETY INFORMATION

General 03

### INSTALLATION

Step 1 to 4 04 - 07

### ACCESSORIES

Weather Resistant Panels 08

Additional Height Extensions 09

Spare Parts 10

### SUPPORT

Training 11

Warranty Certificate 12

After Sales Support 13

## WHATS IN THE BOX

### Parts List

PART	DESCRIPTION	QTY
	Patio Pet Door	x1

# WARNINGS

## WARNING

**Please read these cautions and notes carefully before attempting installation. For any questions or concerns, contact Customer Support at [www.hakunapets.com/help](http://www.hakunapets.com/help).**

If your home has children as well as pets it is important to remember that children can misuse the pet door and gain access to potential hazards on the other side. You may contravene municipal laws and be found guilty of an offence if there was a swimming pool on the other side of the pet door. You are further advised to be very alert to any future hazards which may occur from time to time on the other side of the pet door such as garden chemicals or insecticides which, even if only put down for a few minutes, would be dangerous to children. Remember that any closing panel or lock provided by Perma Products with this product is for simple convenience and is certainly not a security device. Furthermore we will not be responsible or liable for unintended use or misuse. Please remember it is you the purchaser who must at all times be aware of what you have allowed access to by the installation of this pet door. Please remain vigilant throughout the life of this product as it is you the purchaser who is responsible for any oversight this installation creates.

## CAUTION

Before you install this door you must check all your building codes or body corporate rules that could affect the installation of a pet door. You should also check with a qualified builder or trades person that the installation you intend is suitable and safe within the chosen location. This is neither a fire door or security door and it is imperative that you the purchaser consider any risks that may be created both inside and outside after installation of your pet door. Please remember to consider future risks that could be brought about by changes elsewhere on your property.

It is up to the user to take active steps to reduce risks of damage during adverse weather conditions including but not limited to storms or heavy downfalls. This includes manually locking the Pet Door, ensuring adequate measures are taken to ensure your pets safety and sealing the area ensuring the safety of the surrounds.

## NOTE

Keep these warnings and cautions with any other important documents in your home and give them to any new owner, tenant or guest so that they too can be made aware of the responsibilities that come with having a pet door within the premises. Template is to be used only as a guide, ensure all measurements and alignment is correct.

Ensure the suitability of location before installation of pet door. If installing into a sliding door, check pet door does not interfere with door operation or any other doors.

# INSTALLATION

## Step 1.

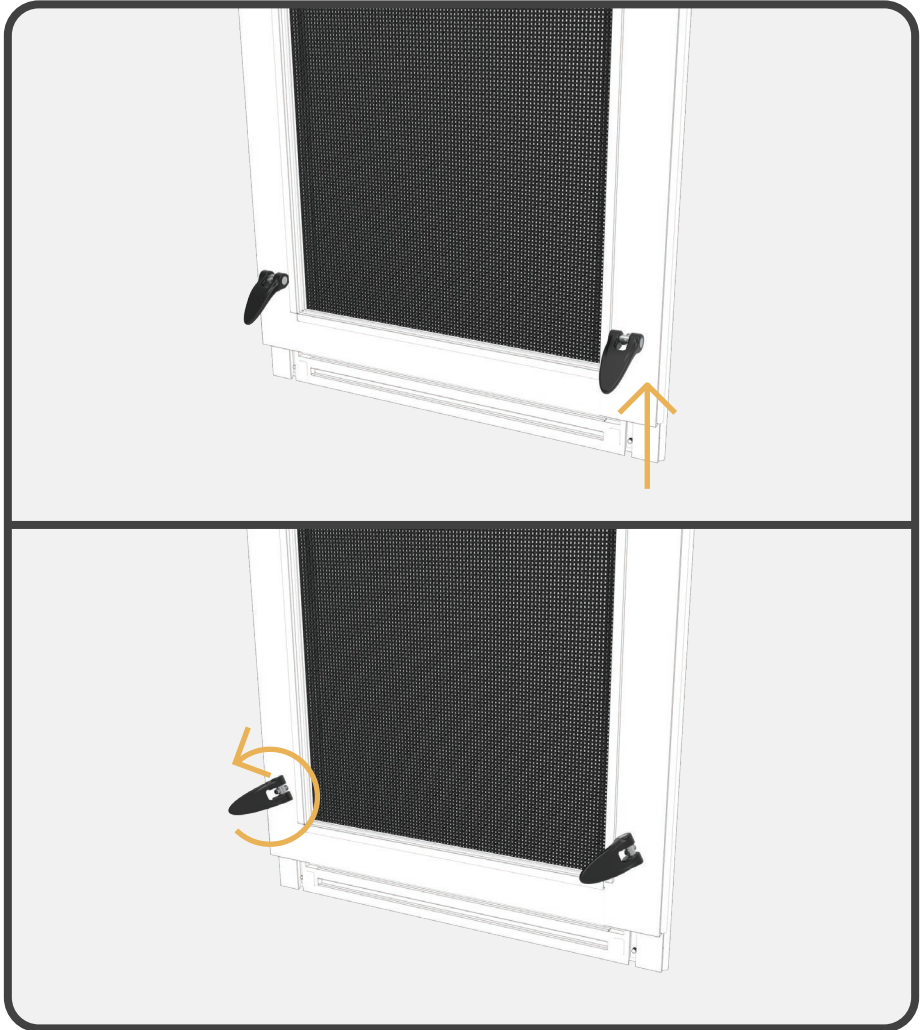

Lift latches and twist to unlock.

# INSTALLATION

## Step 2.

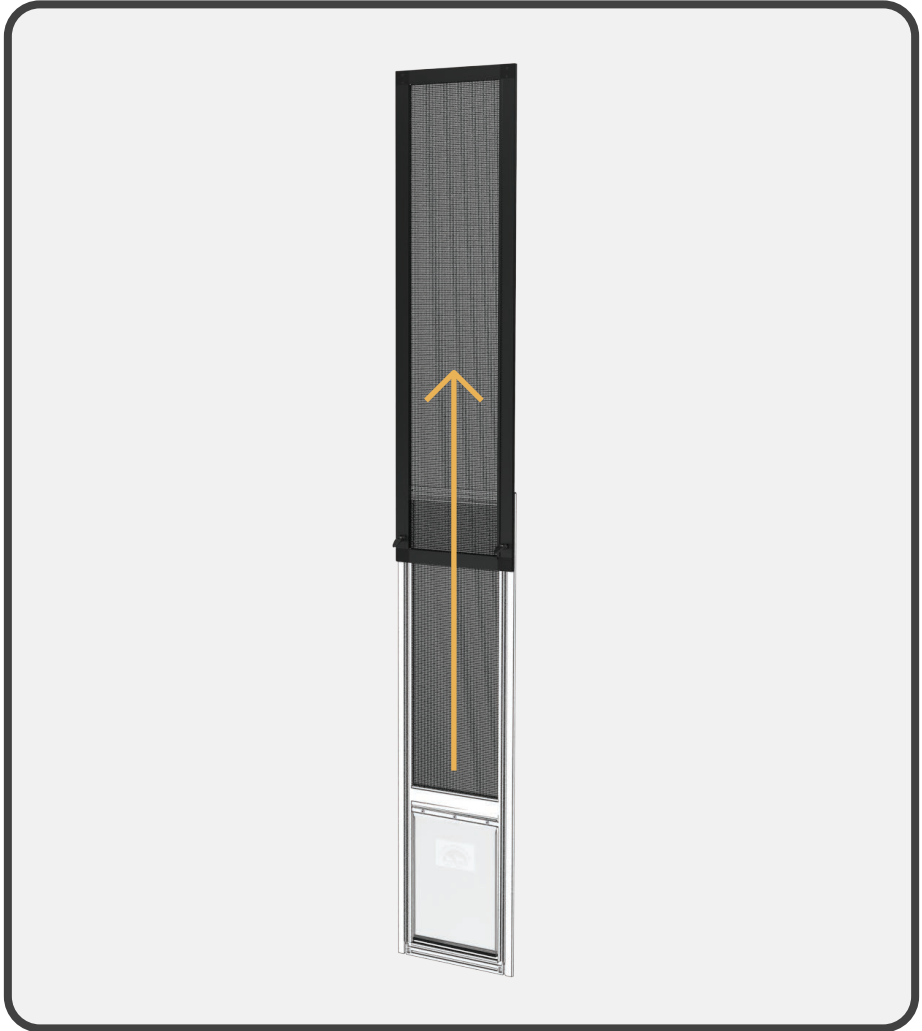

Insert pet door into sliding door track and slide up to extend, ensure a firm grip on door when extending/ retracting. Letting the top frame retract without guidance will cause damage to the door.

**Note: Frame will require Silicon to be sprayed inside of the tracks over time to ensure smooth function.**

# INSTALLATION

## Step 3.

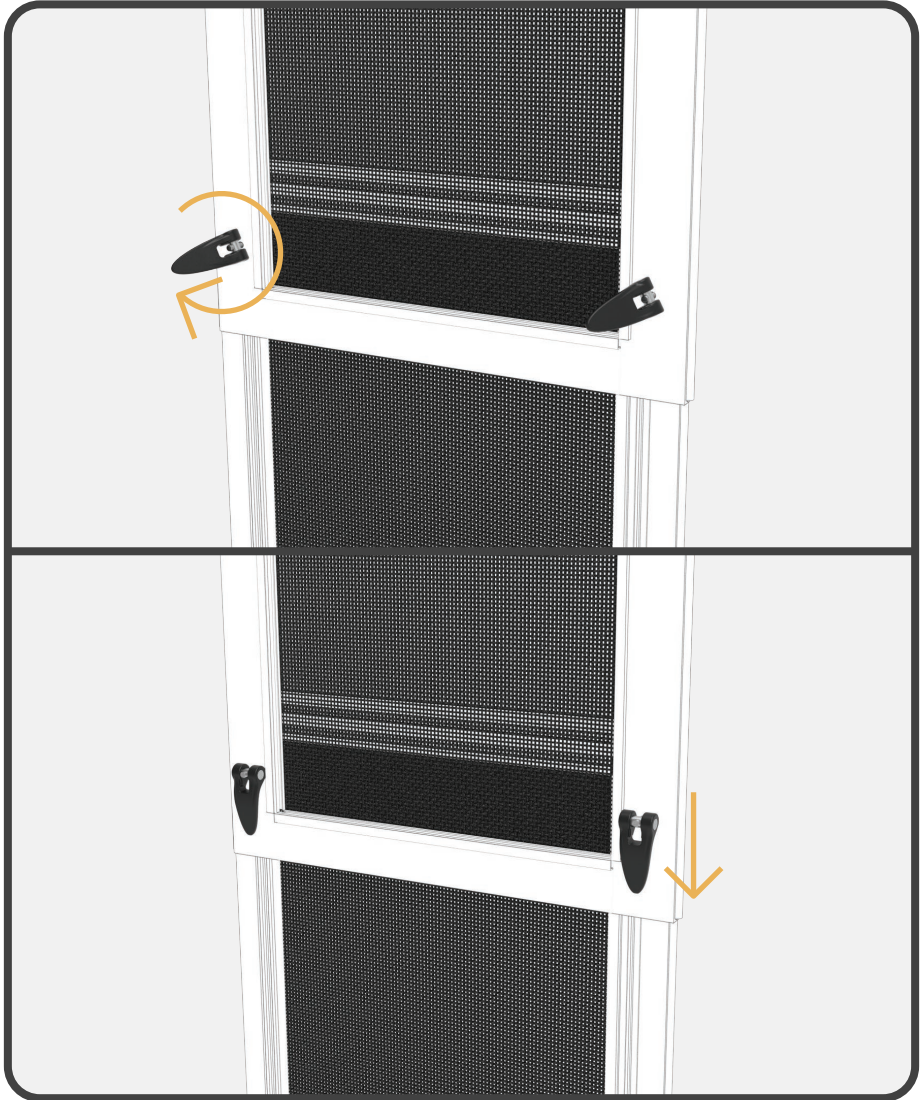

Once extended to fit into sliding door frame, twist and clip down latches to lock.

**Note: DO NOT over tighten the latches as this will cause damage to the door.**

**Latches are only required to be firm when locking the door in place.**

# INSTALLATION

## Step 4.

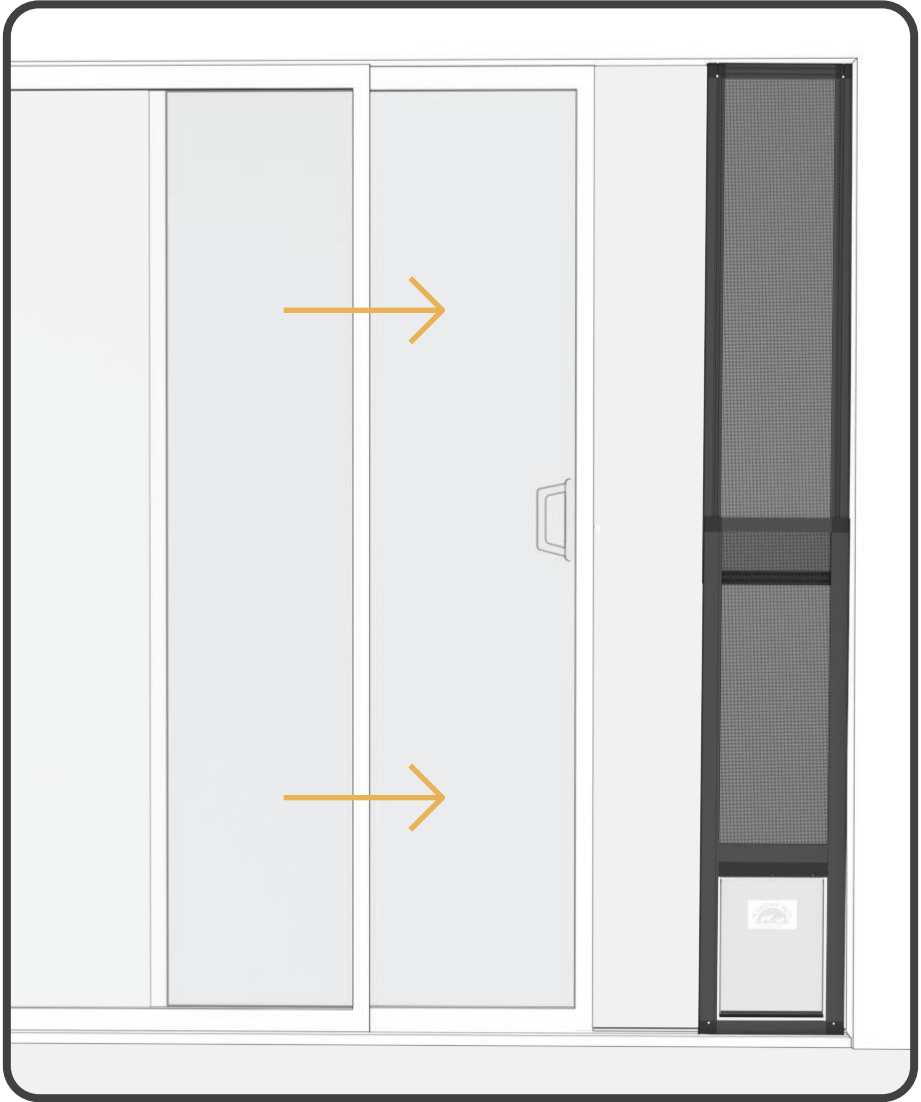

Secure pet door in place by sliding door flush up against pet door frame edge.

**Note: Ensure sliding door is level, most doors will have adjustment screws to achieve this.**

# PATIO PET DOOR ACCESSORIES

*\*Sold Separately*

## Use with Weather Resistant Panels

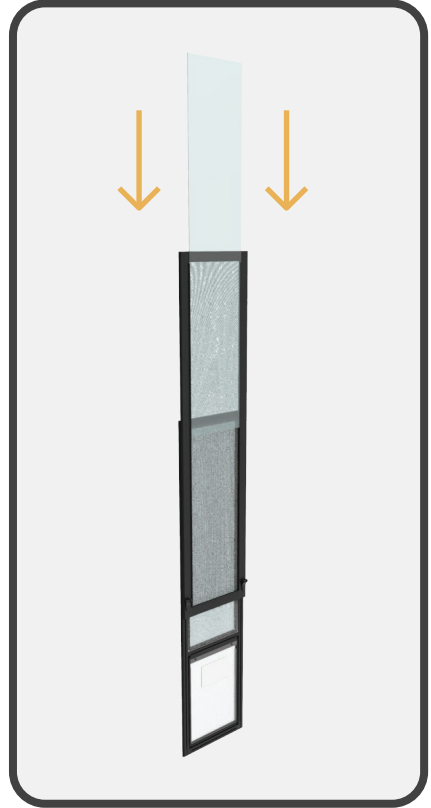
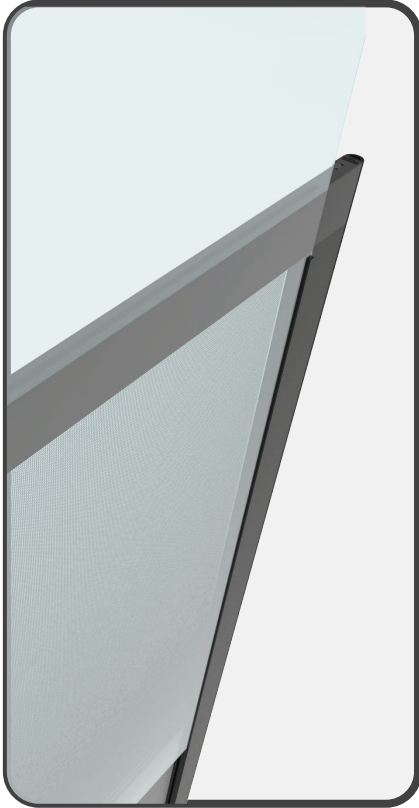

Keep your home protected from elements with Weather Resistant Panels.  
Easy to install, simply slide the Weather Resistant Panels into the Patio Pet Door runners.

### **Note:**

**Install Weather Resistant Panels before installing Extensions.**

Small - #2852

Medium - #2853

Large - #2854

Available at [hakunapets.com](http://hakunapets.com)



SCAN ME  
For spare parts info



# PATIO PET DOOR ACCESSORIES

*\*Sold Separately*

## Additional Height Extensions



Extend the height of the Patio Pet Door by 100mm / 4" for extra tall doorways or increase flap height for bigger pets.

Easy to install, simply slide on top or bottom of door and use two screw points to secure.

**Note: Maximum of 3x Extensions can be used together.**

Extensions

Available at  
[hakunapets.com](http://hakunapets.com)



SCAN ME  
For spare parts info

# PATIO PET DOOR ACCESSORIES

## Flap Adjustment & Replacement



1. Remove the screws at the top of the frame securing the flap



2. Loosen screws and open the metal strip/bar that clasps the flap in place

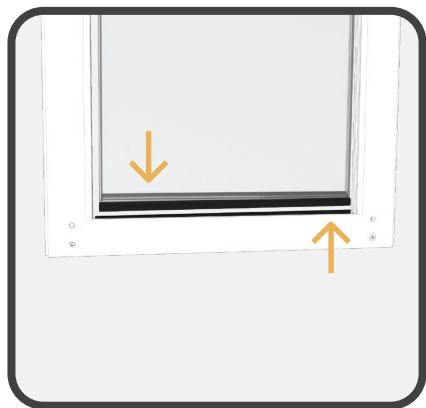

3. Adjust flap position in frame



4. Push down the strip / bar to clasp the flap in place and secure with screws

Replacement flaps  
available at [hakunapets.com](http://hakunapets.com)

Small - #5020

Medium - #5021

Large - #5022



SCAN ME  
For installation video

# TRAINING



---

**Before starting your training, assess whether your dog would be more motivated to come inside through the pet door or go outside through it. If your dog loves being inside the house, you should start this training with them outside. If they're always excited to get outside, start with them inside the house.**

1. With your dog on one side of the pet door and you on the other, lift the flap of the pet door all the way up and call them, using an excited voice. Hold treats or your dogs favourite toy so they can see them on the other side of the pet door. Reward any attempt to come towards or through the door with lots of verbal encouragement, but don't let them have the treat until they make it the whole way through. If your dog is hesitating or nervous to approach after trying this step, take a break and come back to it later.

2. When they come all the way through, praise and reward them. Then, leaving them where they are, go to the other side of the pet door, lift the flap and repeat the same exercise. Do a few repetitions going each way, then take a break. This training can be both stressful and exciting for your dog, so you should do short sessions to avoid burning them out or causing them to become distressed.

3. After your dog has had a break, repeat the exercise. If they're coming through with no hesitation, repeat the exercise holding the flap up only halfway. Your dog may be distressed by feeling the flap touching them, use lots of verbal encouragement to guide them through the door and reward them if they do go all the way through.

4. Once they're going through with the flap halfway up, continue doing short sessions with them, gradually lifting the flap up less and less, until your dog is pushing through the door on their own.

5. Now try to get them to do it on their own. You can do this by leaving them on one side of the door and scattering some treats or leaving their favourite toy on the other side of the door. Repeat this for a few sessions until your dog goes through without any verbal encouragement or reward.

# WARRANTY CERTIFICATE

Congratulations! You have made an excellent choice of this quality product. Our commitment to quality also includes our service. Should you, contrary to expectations, experience defects due to manufacturing faults, we will provide you with a warranty against defects as follows:

---

## WARRANTY

The product is guaranteed to be free from defects in workmanship and parts for a period of 1 year from the date of purchase. Defects that occur within this warranty period, under normal use and care, will be repaired, replaced or refunded at our discretion. The benefits conferred by this warranty are in addition to all rights and remedies in respect of the product that the consumer has under the Competition and Consumer Act 2010 and similar state and territory laws.

Our goods come with guarantees that cannot be excluded under the Australian Consumer Law. You are entitled to a replacement or refund for a major failure and for compensation for any other reasonably foreseeable loss or damage. You are also entitled to have the goods repaired or replaced if the goods fail to be of acceptable quality and the failure does not amount to a major failure.

## PROOF OF PURCHASE

This warranty is valid for the original purchase and is not transferable. Please keep your purchase docket, tax invoice or receipt as the best proof of purchase, and as proof of date on which the purchase was made.

## EXTENT OF WARRANTY

This warranty is limited to defects in workmanship or parts. All defective products or parts will be repaired or replaced. This warranty does not cover consumable items.

## NORMAL WEAR AND TEAR

This warranty does not cover normal wear and tear to the products or parts.

## EXCLUSIONS

This warranty does not cover:

- Any defects caused by an accident, misuse, abuse, improper installation or operation, lack of reasonable care, unauthorised modification, loss of parts, tampering or attempted repair by a person not authorised by the distributor.
- Any product that has not been installed, operated or maintained in accordance with the manufacturer's operating instructions provided with the product.
- Any product that has been used for purposes other than domestic use.

## TO MAKE A CLAIM

If a defect in the goods appears within 1 year, you are entitled to claim a warranty.

Please contact after sales support via the link below:

[www.hakunapets.com/contact-us](http://www.hakunapets.com/contact-us)

Please ensure that you have a copy of proof of purchase so that we are able to respond as quickly and efficiently as possible.





# Thankyou !

for making a purchase  
with Hakuna Pets.

---

Providing our customers with a positive experience  
is our #1 priority and we value your feedback.



If you have anything less than 5 star  
satisfaction or you require any assistance  
with spare parts please contact us directly at:  
[www.hakunapets.com/contact-us](http://www.hakunapets.com/contact-us)