

ACTECH 2170 FC:

1st Coat Mixed with Acetone:

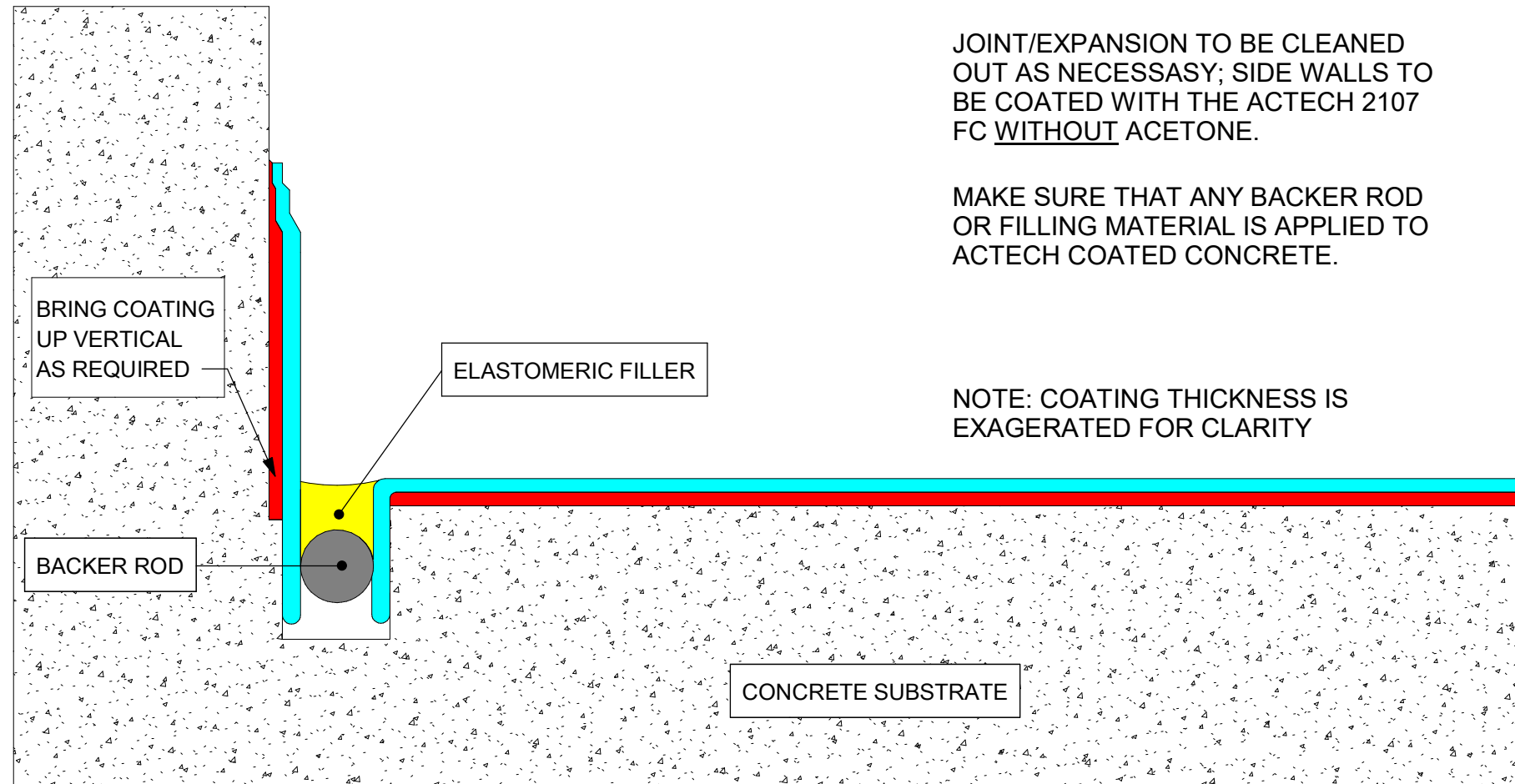

2nd Coat "Neat" Not Thinned:



JOINT/EXPANSION TO BE CLEANED OUT AS NECESSARY; SIDE WALLS TO BE COATED WITH THE ACTECH 2107 FC WITHOUT ACETONE.

MAKE SURE THAT ANY BACKER ROD OR FILLING MATERIAL IS APPLIED TO ACTECH COATED CONCRETE.

NOTE: COATING THICKNESS IS EXAGGERATED FOR CLARITY

DRAWING NO

FLOOR/DECK TO WALL WITH EXPANSION JOINT

D2

REVISION

ISSUE DATE

SCALE

DRAWN BY

06/21/23