

Two lowering height option

RacingBros MSX/Grom/MONKEY front fork lowering kits has two different low down setting by two different install steps.

Low down for 4" (Fork TLG=22.2")

Insert the spacer on the shaft.

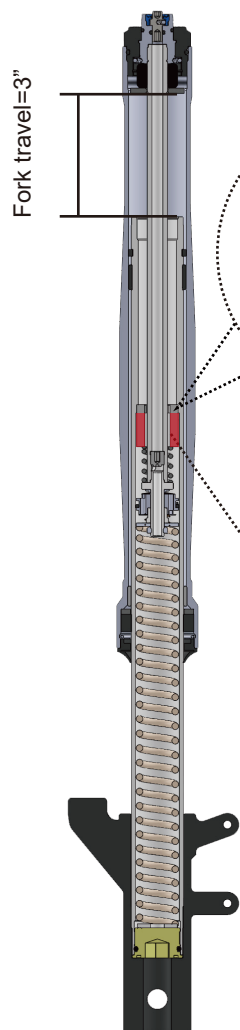

Low down for 3" (Fork TLG=23.2")

Put the spacer at the bottom of the steel tube.

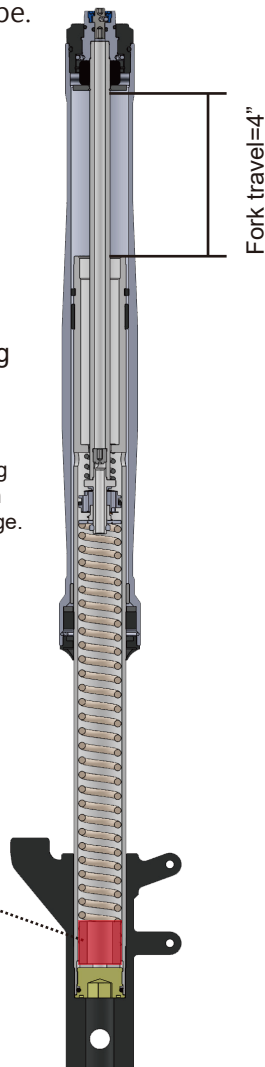

Position of parts:

POM spacer
Top out spring piston

Warning:
Incorrect installing may lose function and cause damage.

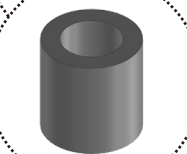

POM SPACER

Install the travel spacer

Before installing the Front fork lowering kits. You have to check whether the parts of bike (for example: head light or front fender) will interfere while the front fork is working. Using the travel spacer to prevent this situation. Each spacer will reduce 1" of the travel.

Travel spacer x1 reduce 1" of the travel

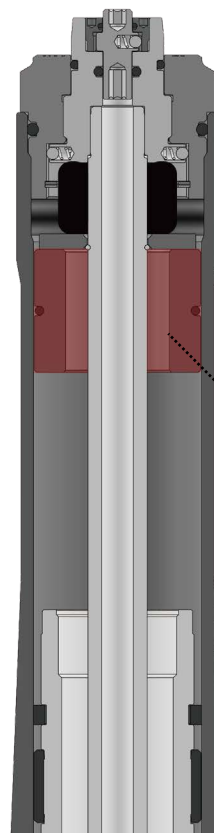

Please apply grease on the O-ring before install the spacer.

Travel spacer x2 reduce 2" of the travel

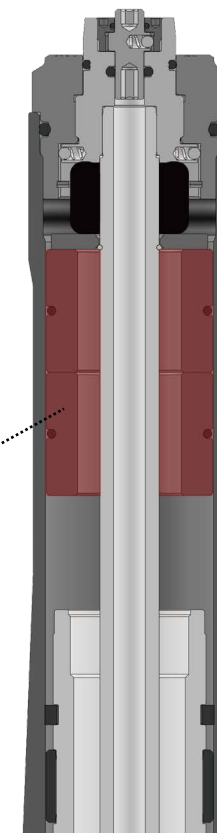

Stock Fork Information:

1. Fork TLG= 26.2"
2. Fork Travel=4"

Note: TLG is measured from the top-end of outer(aluminum) tube to center of front axle.



RULE THE ROAD



RacingBros International Inc.

No.201, Heshun Rd., Beitun Dist., Taichung
City 40642, Taiwan
Tel:+886 4 2435 0275
Fax:+886 4 2435 0276
www.racingbros.com



HONDA MSX/GROM/MONKEY FRONT FORK LOWERING KITS

Instruction manual

Steel tube x2



Aluminum tube x2



OD=33.7mm
Travel spacer x4



OD=24.5mm
POM Spacer x2



Spring x2



The spec of the spring
is mark on the end of
spring.
(6.5N/mm or 7.5N/mm)



Wiper x2



Sealx2