

ASSEMBLING INSTRUCTIONS FOR RAINDROP L GREENHOUSE

Dear customer, congratulations on the purchase of the Raindrop L greenhouse from My Great Greenhouse. When correctly assembled and maintained, the greenhouse will serve you and bring happiness for a long time. This manual includes information and tips on assembling and maintaining the structure.

YOU MUST READ THESE INSTRUCTIONS BEFORE ASSEMBLING THE GREENHOUSE.

1. Precautions

Attention: Before installing the greenhouse, attentively read these instructions. Follow all the guidelines and tips in it.

Warning: While assembling the greenhouse, the usage of personal protection such as special gloves, glasses, boots, and helmets is strongly recommended.

Do not start assembling when the wind is blowing.

Make sure to finish the installation in one day (the warranty doesn't apply to partially assembled greenhouses).

Keep children away from the area of assembly.

If using a stepladder or power tools, be cautious and follow the producer's safety advice. When installing the greenhouse, use only working tools in good condition (both manual and electric).

Before moving the packs of the greenhouse, pay attention to their weight. Then, be careful when moving the packs. If necessary, involve the required number of people to move the packs of the greenhouse or use particular means (carts, etc.)



438-927-1727

info@mygreatgreenhouse.ca

www.mygreatgreenhouse.ca

**Use tools that are in good condition only,
keep children away from the area of assembly.**

Attention: Before assembly, to make sure that you are allowed to build this structure, consult city or municipality building codes.

The surface where the greenhouse is mounted must be flat. The structure must be securely anchored to a level base. We strongly recommend anchoring the greenhouse on a wooden or concrete base.

The greenhouse shouldn't be positioned where tree branches, loads of snow, ice, or other overhead particles could fall and damage the construction.

In violation of the above recommendations, the guarantee for the coating material and the frame does not apply.

Important: For assembling the greenhouse, you will need at least **two people**.

This instruction is for Raindrop L4 - L10 greenhouses.

Attention! Cellular polycarbonate sheets are protected from ultraviolet rays inside the panel. They have a special UV protective layer on both sides of the sheet, which prevents the harmful effects of ultraviolet radiation. The polycarbonate sheets must be installed so that the front side (has a film with text and pictures), on which the reinforced layer of protection against ultraviolet rays is applied, is always facing the sun during installation. Do not remove this film until the greenhouse installation is complete.



438-927-1727

info@mygreatgreenhouse.ca

www.mygreatgreenhouse.ca

- M10 wrench – (included in the kit);
- M6 wrench and M6 driver bit;
- Screwdriver drill bit - crosshead;
- Crosshead screwdriver;
- Utility knife or a jigsaw;
- Hammer drill (in case the greenhouse will be set on concrete);
- Drill
- 5/64 - 3/32 drill bit
- Ladder



Use tools that are in good condition only, keep children away from the area of assembly.



2. Specification

Item No	Item name	Quantity		Note
		L4	+1 m	
01	Brace 975 mm bottom	8	2	
02	T-connector	6	2	
03	Stud	6	2	
04	End triangle	2	1	
05	Arc triangle	3		
06	Transverse brace 975 mm	16	4	
07	Brace 1970 mm bottom	2		
08	Corner brace	68	16	
09	Countersunk screw 6x40 mm	72	16	
10	Nut M6	72	16	
11	Aluminum base L= 2283 mm	10	2	
12	Front/Rear end, left	2		
13	Front/Rear end, right	2		
14	Aluminum base L= 950 mm	8	2	
15	Aluminum base L= 959 mm	8	2	
16	Aluminum cap L= 1517	10	2	
17	Aluminum cap L= 2030	10	2	
18	Countersunk screw 4,8x13 mm	172	36	
19	Countersunk screw 4,2x16 mm	202	38	
20	Hex head screw 6x90	24	4	
21	Hex head self-tapping screw 5.5x25		8	
22	Self-tapping screw 3.9x19 mm	66		
23				
24	Door handle	7		
25	Latch	6		
26	External door handle	2		
27	Wrench	1		
28	Lift support	4		
29	100x100 Coner brace	4		
30	Plate to fix the wooden beams			
31	Anchor	4		
32	Wood screw	34		
33	Aluminum profile seal	set		
34	Door and window seal, m	5		
35	Expanding foam tape	set		
36	Ridge cover	4	1	

To determine the quantity of parts for your greenhouse, take the quantity for the 4 meter greenhouse (L4) and if you have a 5 meter greenhouse, add the quantity by +1 m. If your greenhouse is 6 meters long, add two times to the quantity of the 4 meter greenhouse +1 m.

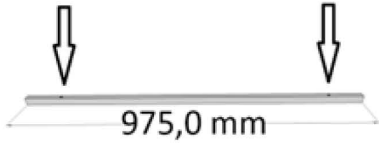

Package #3

01

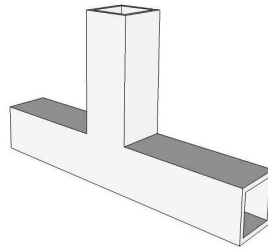

02



Package #3

03

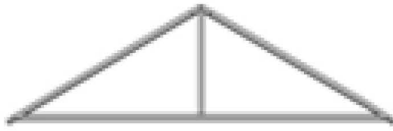

Package #5

04



Package #5

05

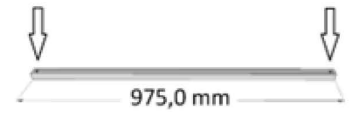

Package #4

06

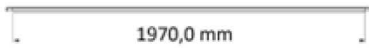

Package #2

07

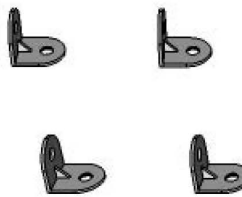

08



09



10

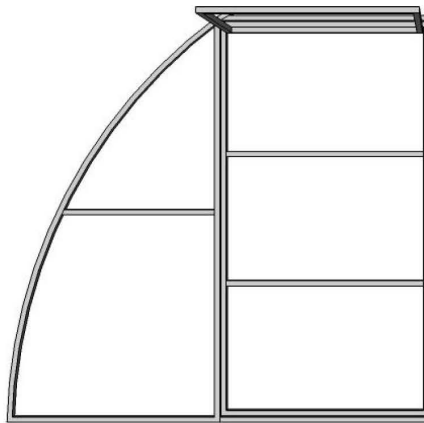

Package #1

12

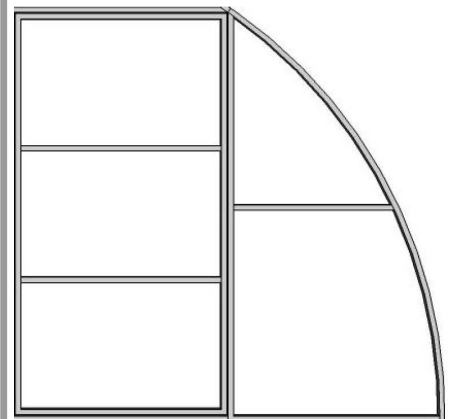

Package #1

13

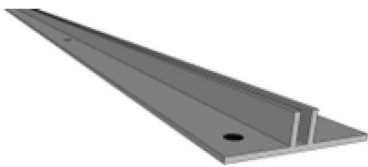

Package #6

11

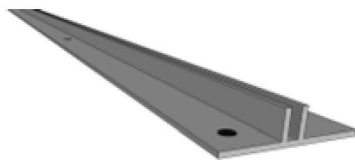

Package #6

14

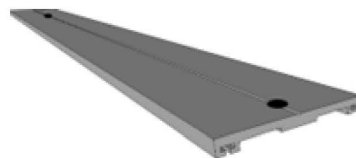

Package #7

15

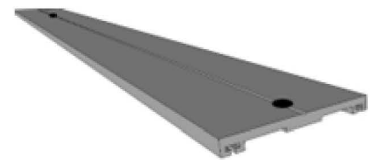

Package #7

16



Package #7

17



18



MY GREAT GREENHOUSE
 1-833-212-3727
 438-927-1727
www.mygreatgreenhouse.ca

18



19



20



21



22



23

24



25



26



27



38

28

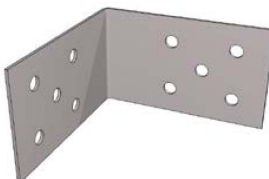

29



30



31



32

Package #6



33



34



35



36



MY GREAT GREENHOUSE

1-833-212-3727

info@mygreatgreenhouse.ca

www.mygreatgreenhouse.ca

Polycarbonate sheets for Raindrop L 4-10 m

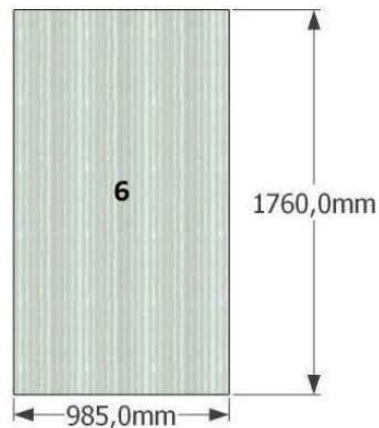
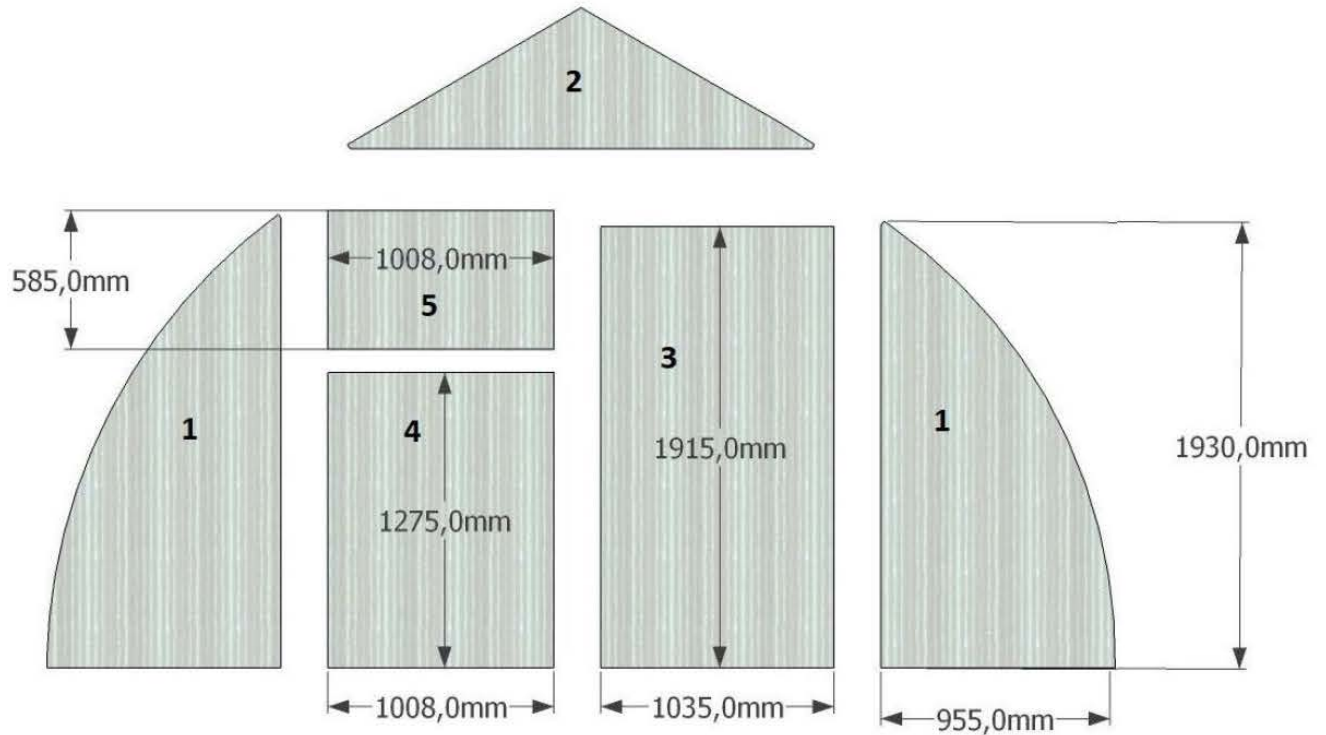

Polycarbonate sheets for Raindrop L +1 m

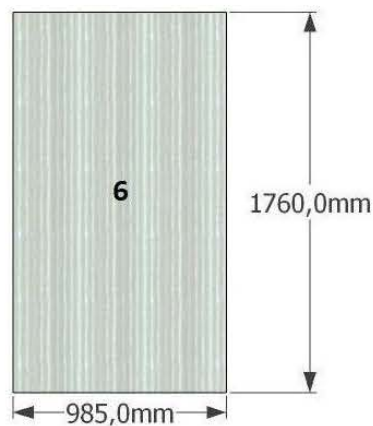

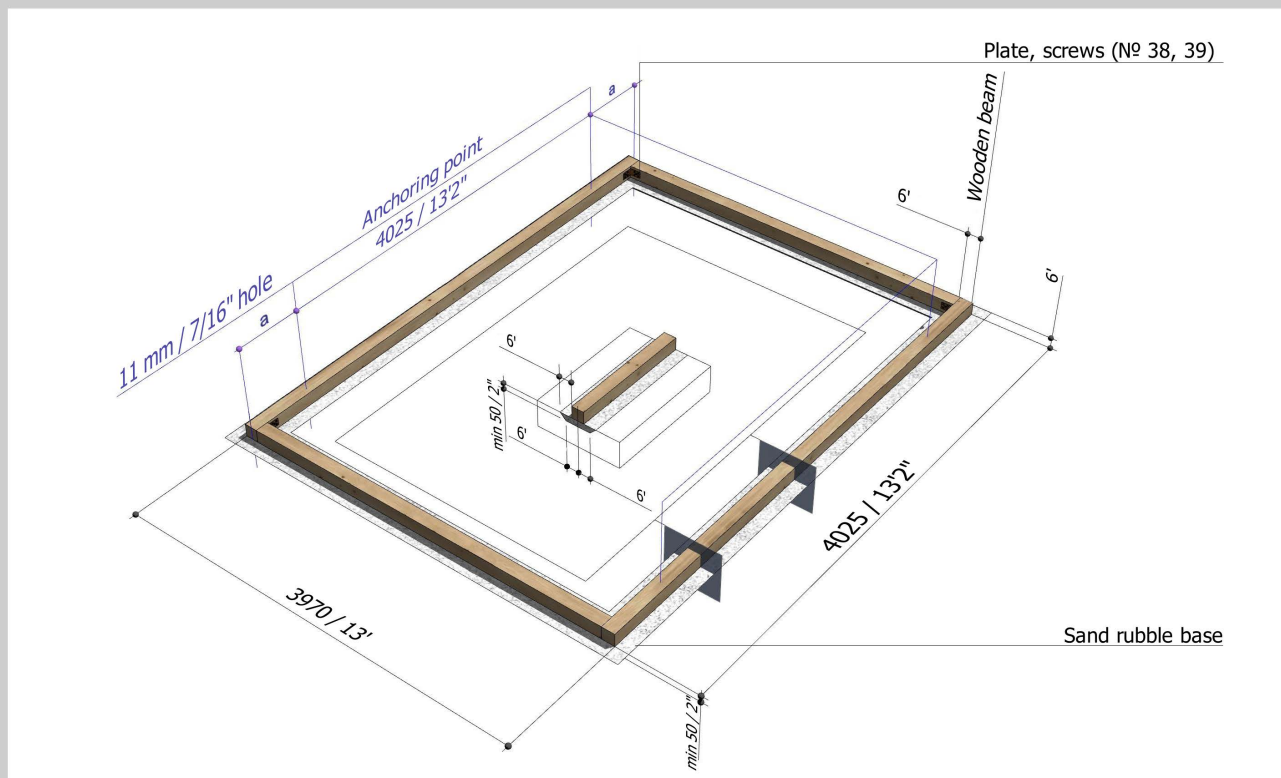

The greenhouse should be installed on a wooden base. Below are guidelines for preparing the base for a greenhouse installation.

A wood beam with a cross-section of at least 6"x6" can act as a wooden base. Make sure to use treated wood.

Install the wooden beam on a sand-rubble surface with a depth of at least 5 centimeters. Use a corner (#29) and screws (#32) at a right-angle at joints between the two beams. Use plates (#30) and screws (#32) to connect the two bars lengthwise.

We highly recommend anchoring the base to the ground using anchors (#31) For a greenhouse with a length of 4 meters, four anchoring points are sufficient. For a greenhouse with a length of 6 meters, six anchoring points are sufficient. Place the anchoring points evenly on the two long sides of the greenhouse.

If you want to install the greenhouse on a concrete base, fix the wooden base to the concrete using anchors with a diameter of 8 mm.

Finally, verify that the wooden base is level and the diagonals are equal.

IMPORTANT: The wooden base of the greenhouse must have the same outer dimensions as the outer dimensions of the metal frame of the greenhouse. The polycarbonate sheets will cover the bottom of the greenhouse frame and slightly overlap the wood beam.

The greenhouse wood base should be the same dimensions as the greenhouse dimensions. The geometrical parameters of the bases for different greenhouses of the L model are indicated below:

RAINDROP L4-L10				
	Wood base width		Wood base length	
	cm	in	cm	in
L4	397	13'	402.5	13'2"
L5	397	13'	502.5	16'6"
L6	397	13'	602.5	19'9"
L7	397	13'	702.5	23'1"
L8	397	13'	802.5	26'4"
L9	397	13'	902.5	29'7"
L10	397	13'	1002.5	32'11"

Preparing the wood base

In the case of installing the greenhouse on a wooden base, we recommend attaching Anchors #31 to the wood base beams using Screws #32.

Picture # 1

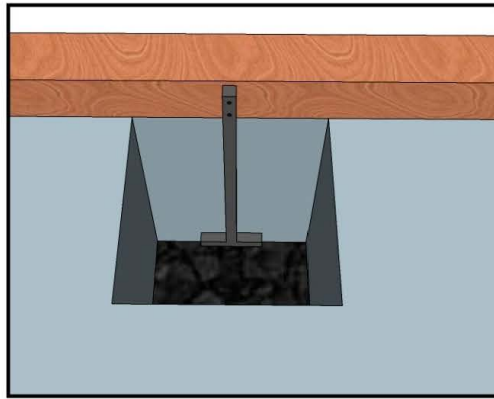
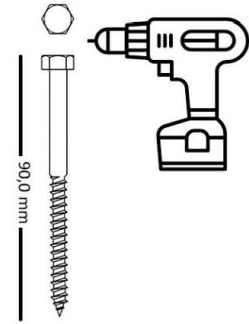
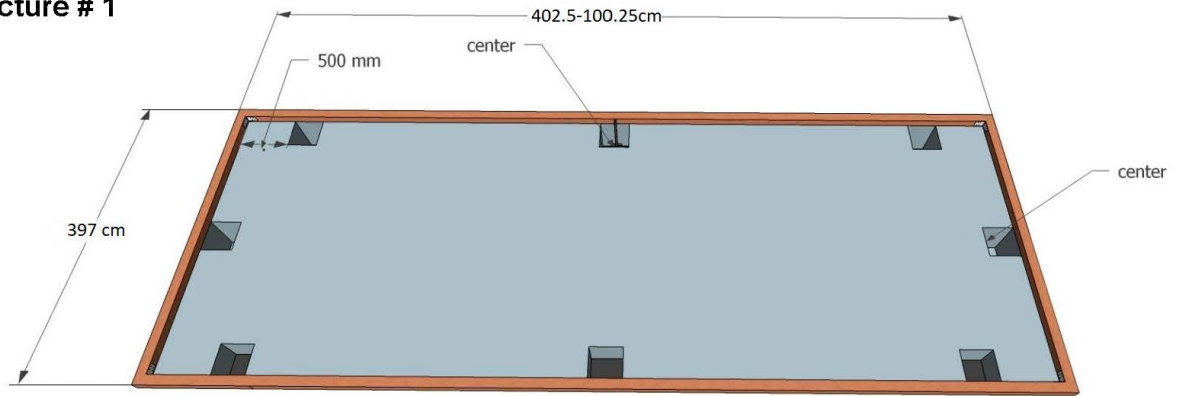

$$X=Y$$

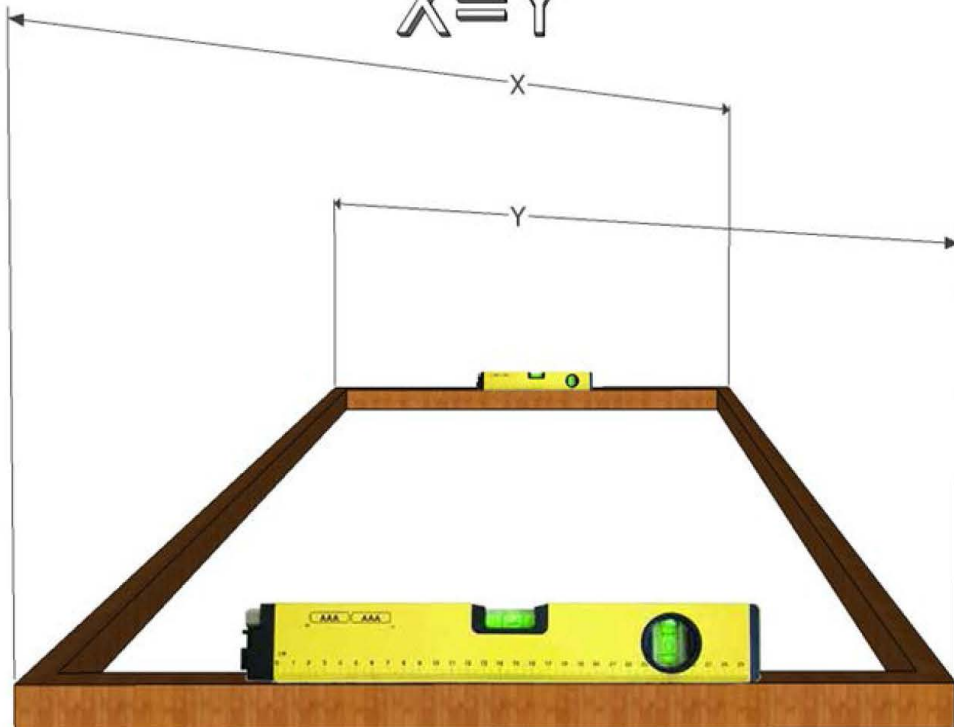

Greenhouse installation

1. Place the longitudinal frame elements (Braces # 01 and T-shape connector # 02) on the long side of the wooden base. (Picture No. 2, 3).

Picture # 2

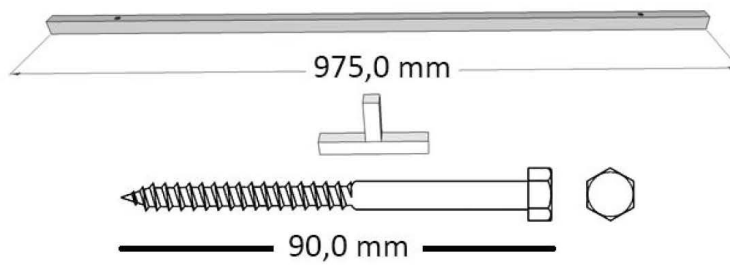

Picture # 3

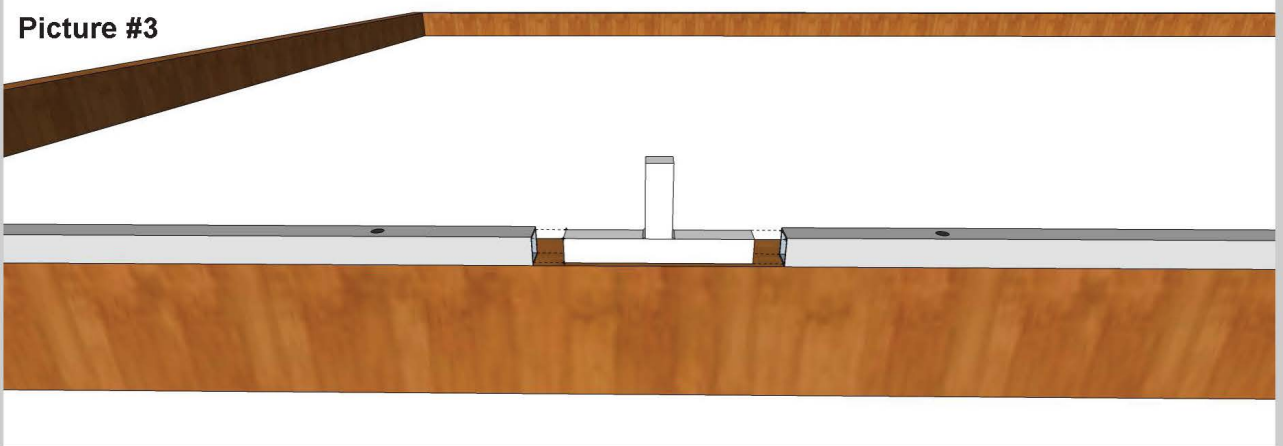

2. The ends of the installed Braces # 01 along with the T-shape connectors # 02 should be 25 mm (1") from the outside of the short parts of the wood base (Picture # 4).

Picture # 4

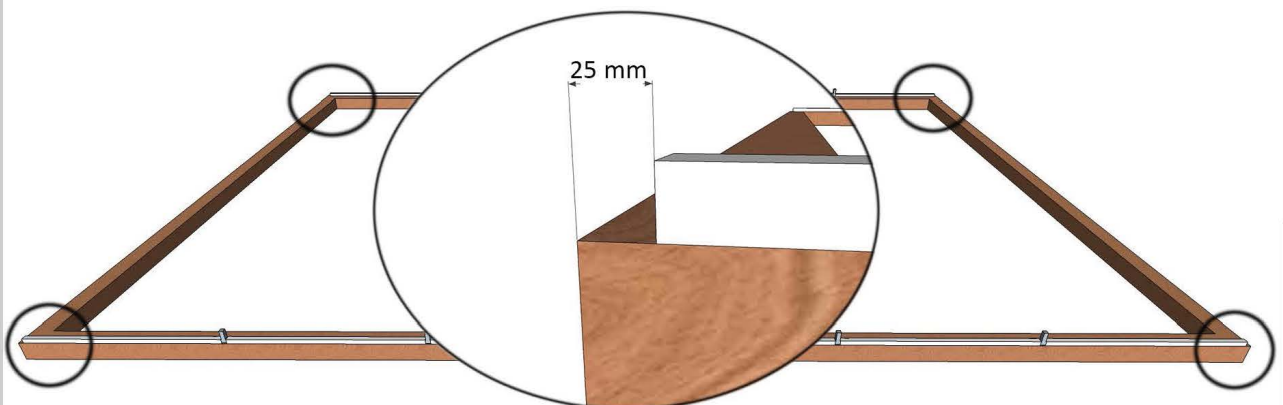

3. Fasten Braces # 01 together with the T-shaped connectors # 02 on the wood base beams using Screw #20.

Picture #5

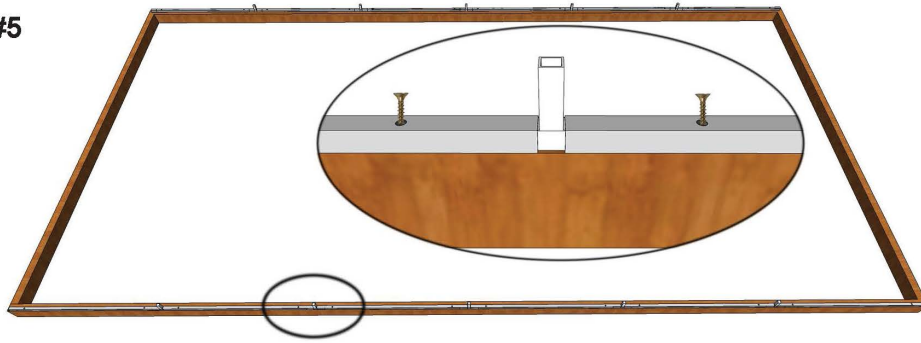

4. Assemble the Arches, connecting and fastening together all the Studs #03 and an appropriate quantity of Arc triangle #05 that you have in the kit, as shown in Picture #6.

Picture #6

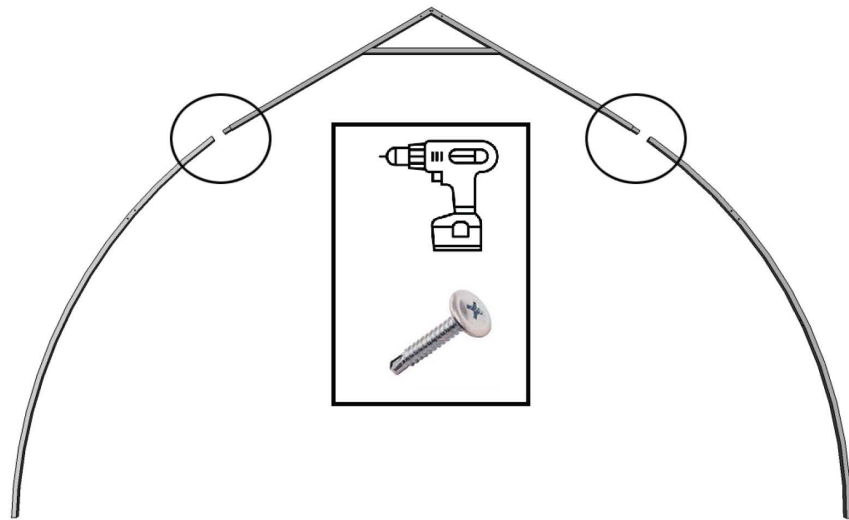

5. Install the previously assembled arches on the longitudinal elements of the frame by inserting T-shaped connectors into the lower ends of the arches, as shown in Picture # 7

Picture #7

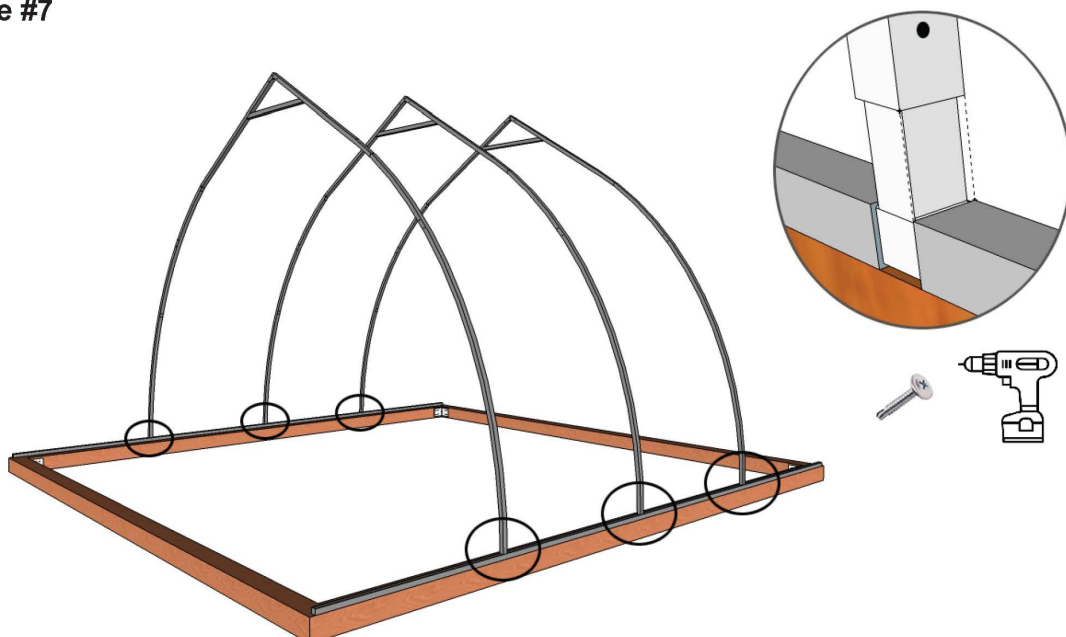

6. Using bolts #09 and nuts #10, attach Corner braces #08 to Transverse brace 975 mm #06 (Picture # 8)

Picture #8

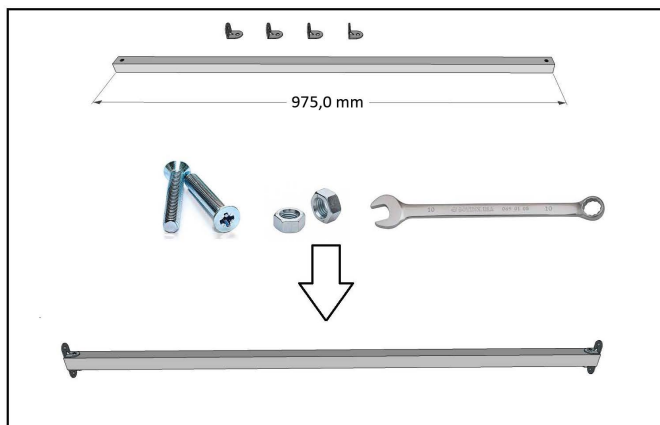

7. Using bolts #09 and nuts #10, attach assembled Braces with earlier installed Arches (Picture #9)

Picture #9

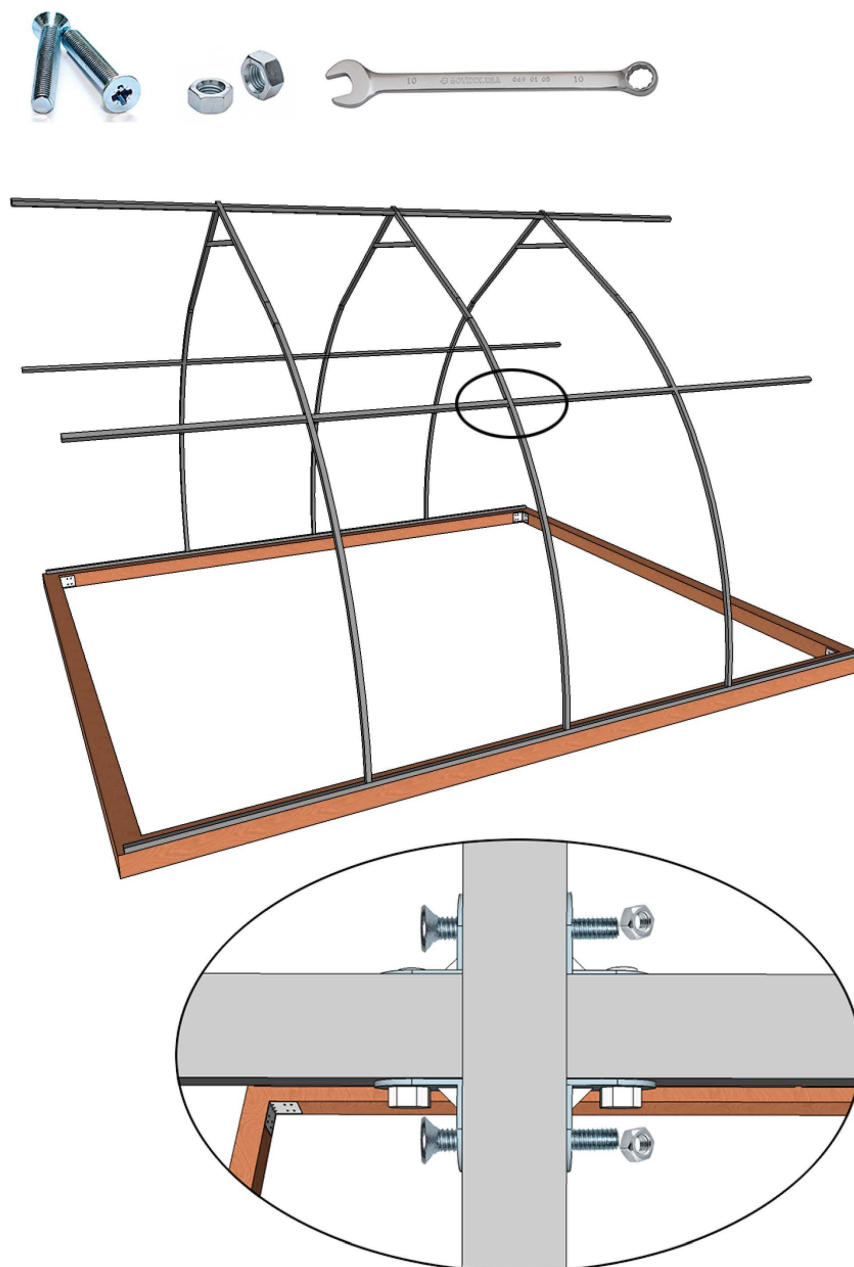

8. Assemble the front and the rear ends.

Place parts ## 04, 07, 12 and 13 as shown in Picture #10 using a flat, level surface near the greenhouse installation site. Attach them using screw #19.

Picture №10

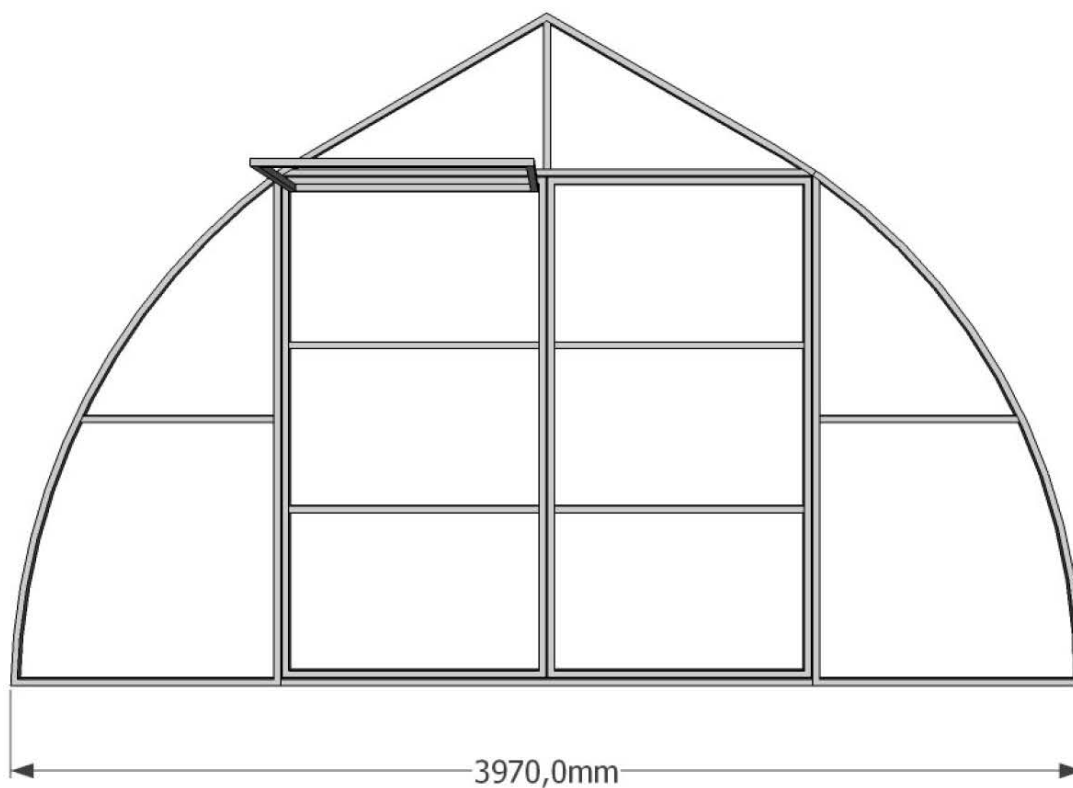
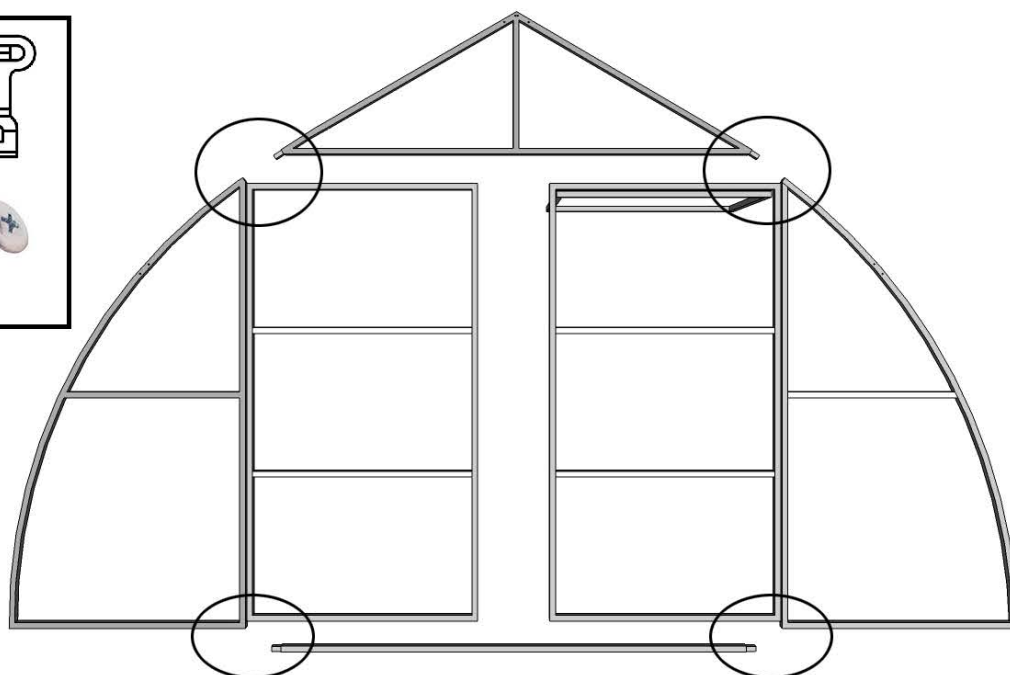
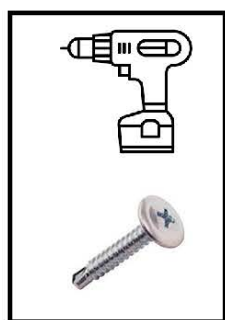

Be careful when assembling the frame. Correct adjustment of all elements is the most critical part of the assembly!

9. Lift up the front frame and put it on the prepared base. Attach the door end to the assembled central part of the greenhouse frame. (Picture #11). Repeat it with the rear end.

Picture #11

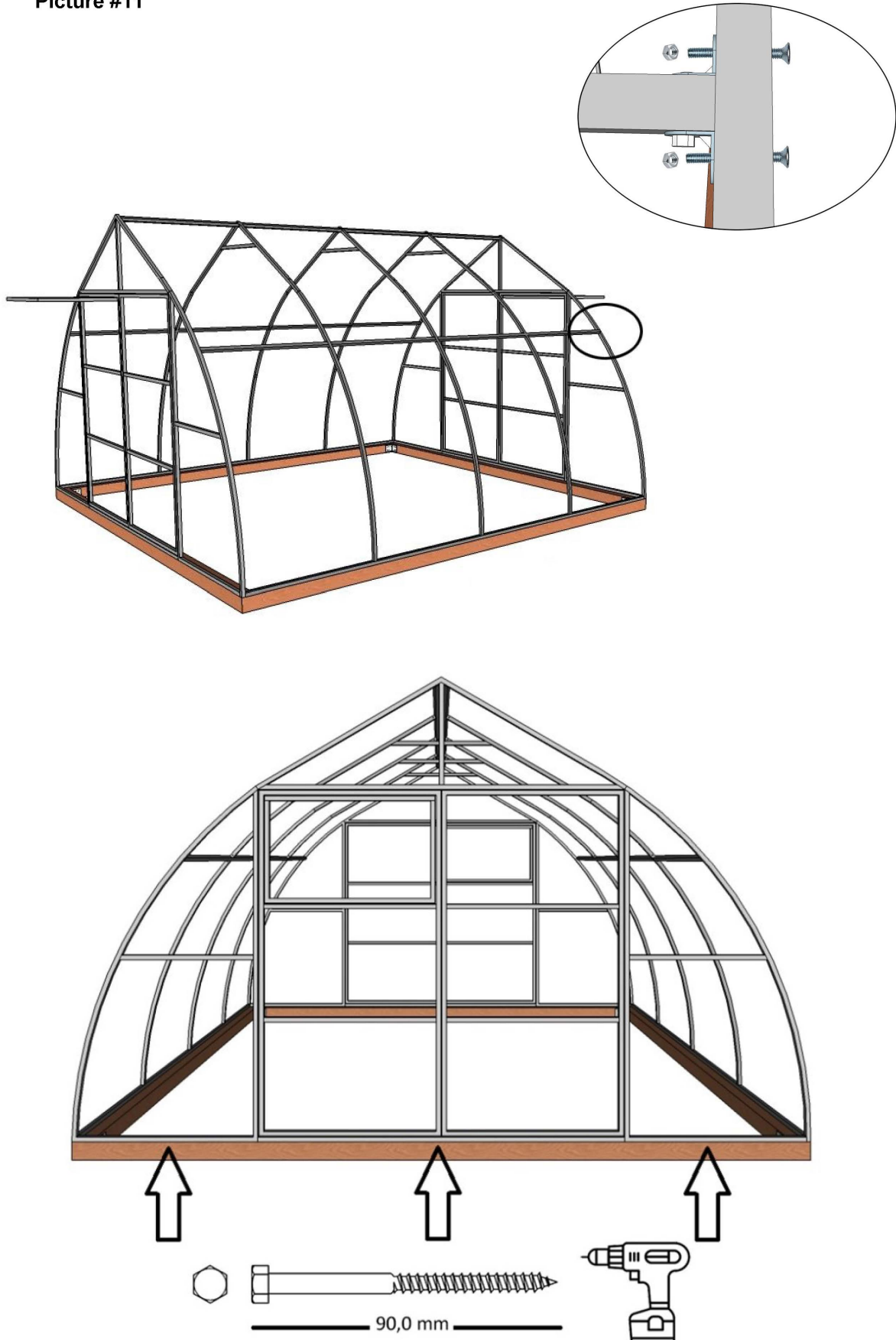

10. Install polycarbonate sheets on the front and back ends in accordance with the numbers indicated on each sheet, in random order. Pictures # 12 and 13.

To fasten the polycarbonate sheets to both ends of the frame, use self-tapping screws 4.8x25 with a bonded washer (#21).

Picture #12

10

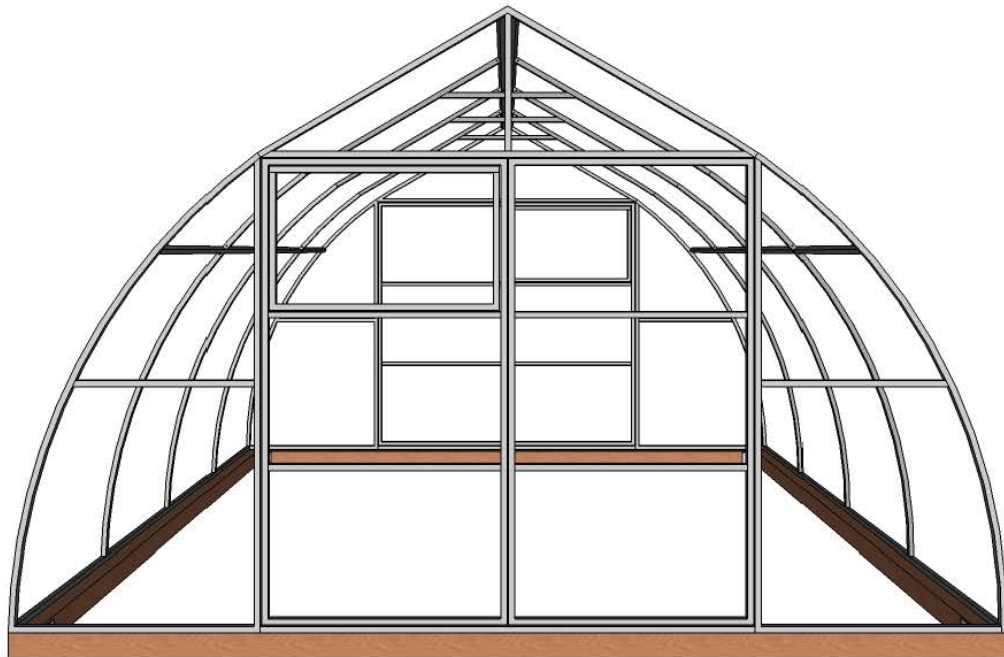
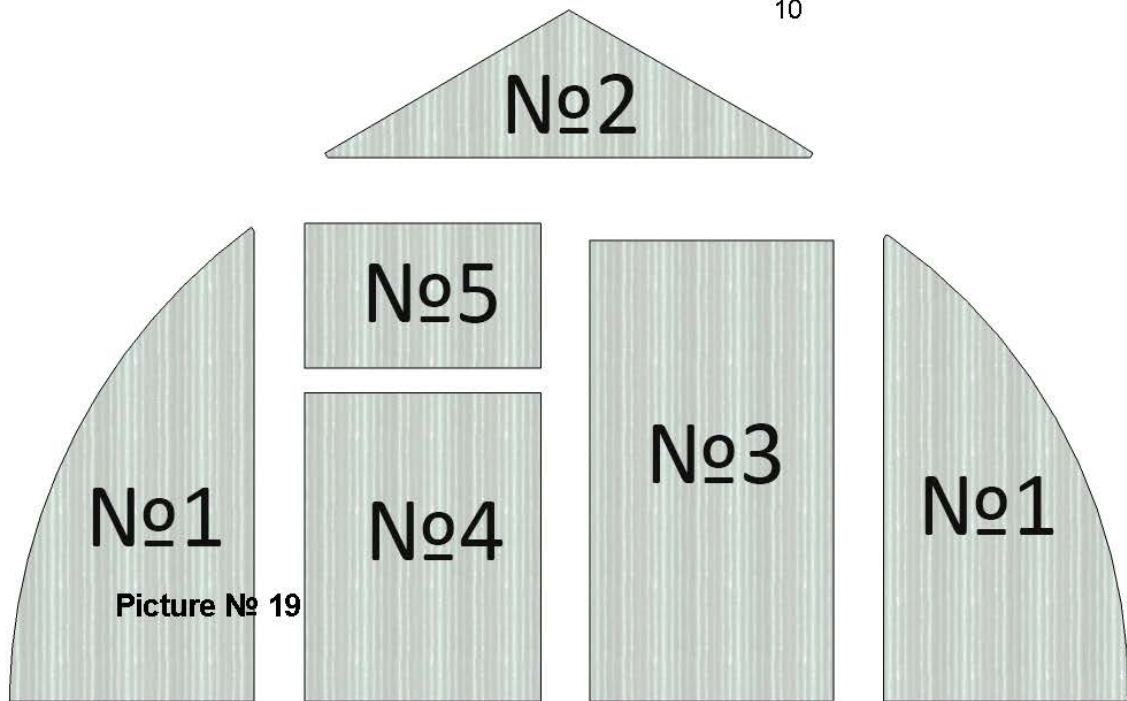

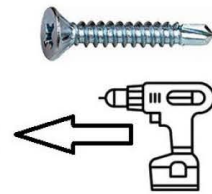
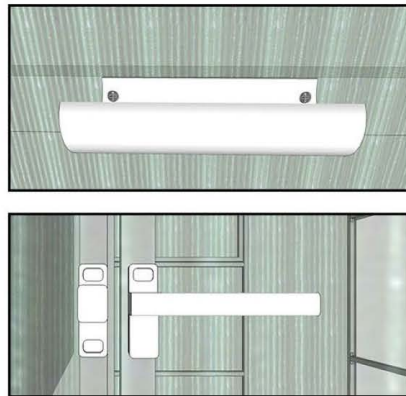
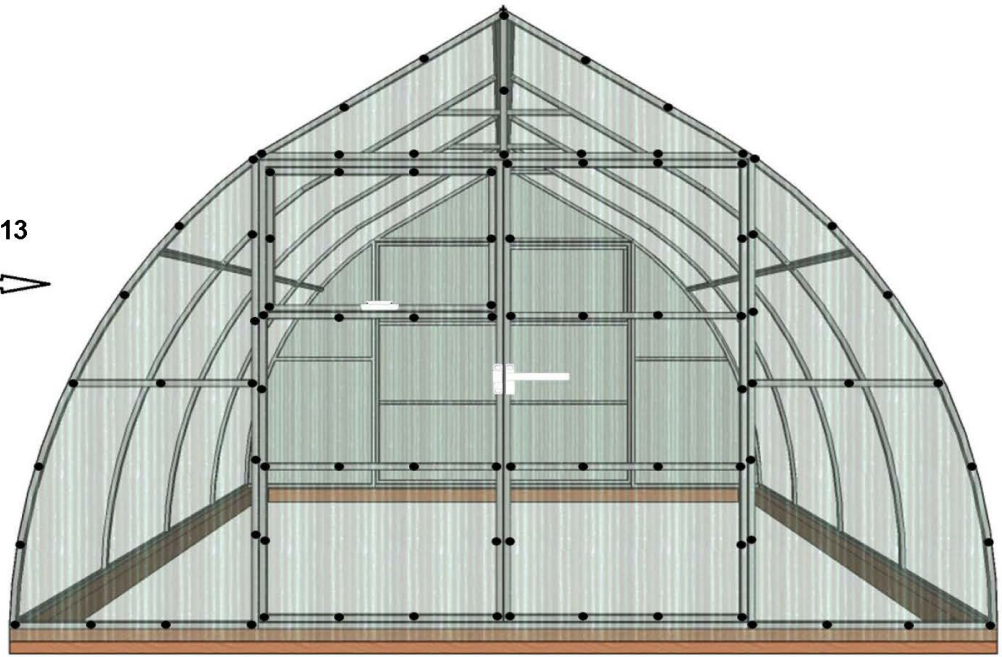
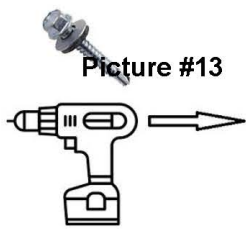

Picture #14

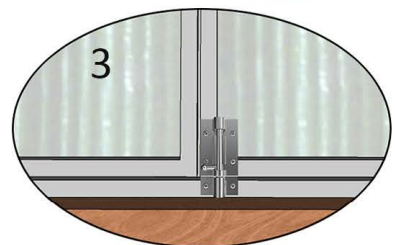
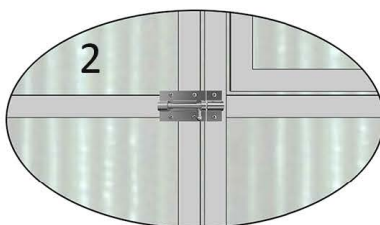
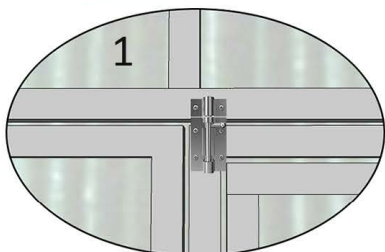
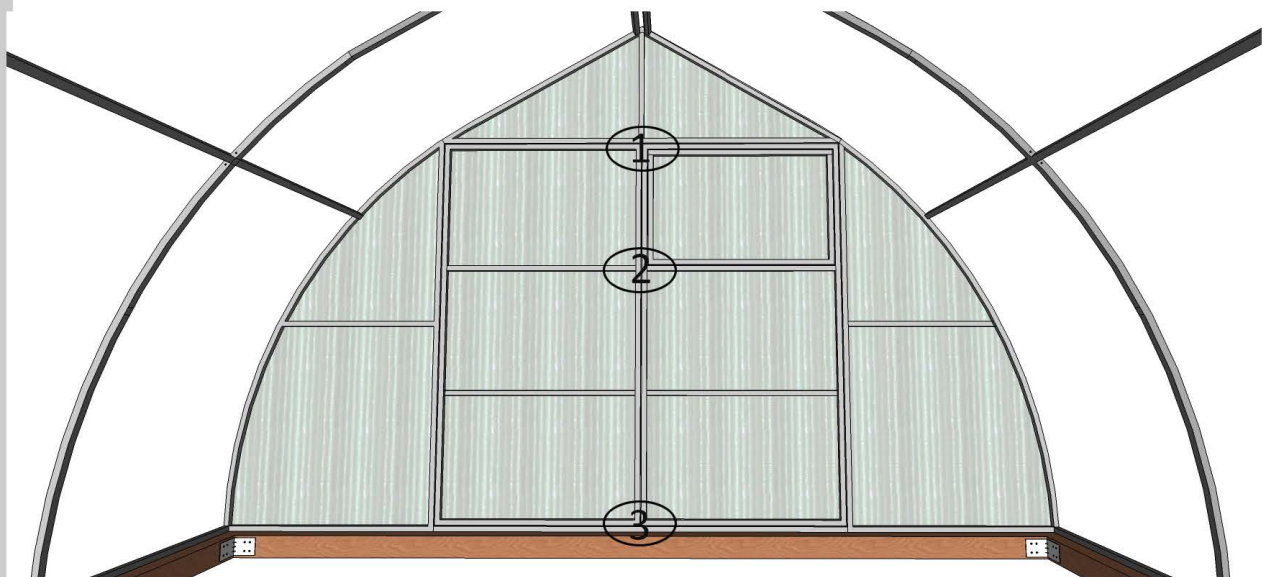

11. Install the two pieces of 2320 mm aluminum bases # 26 along the Stud №3. Attach them to the Studs with screws # 19. Start from the top.

Picture # 15

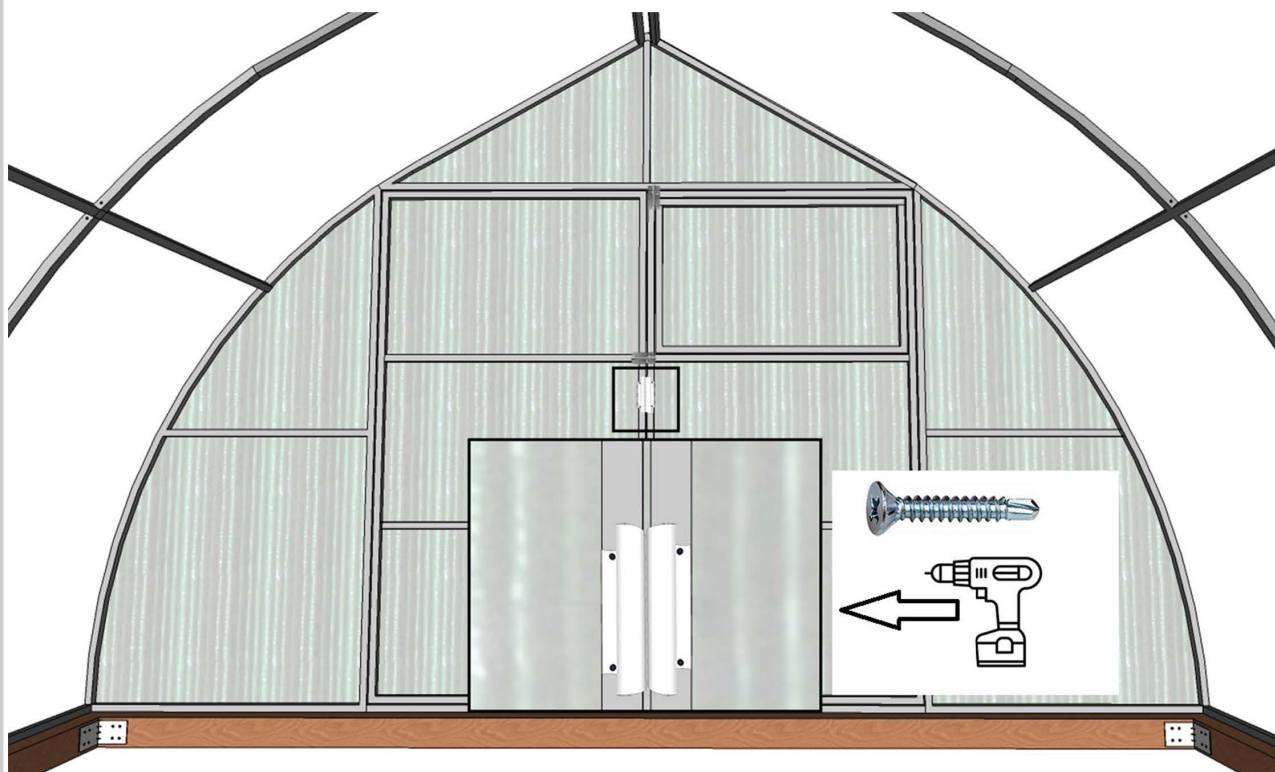

12. Install the two pieces of 2320 mm aluminum bases # 26 along the Stud №3. Attach them to the Studs with screws # 19. Start from the top.

Picture # 16

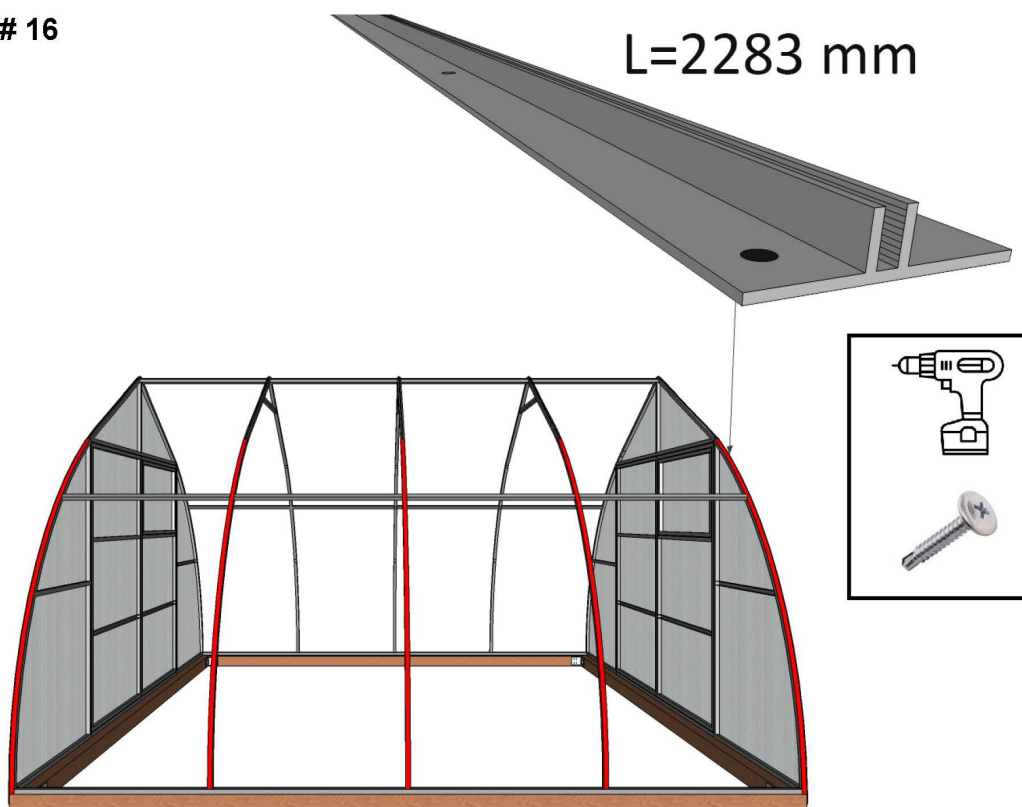

13. Install short pieces of 950 mm aluminum base # 14 along with Braces # 01. Attach them to Braces with screws # 19.

Picture # 17

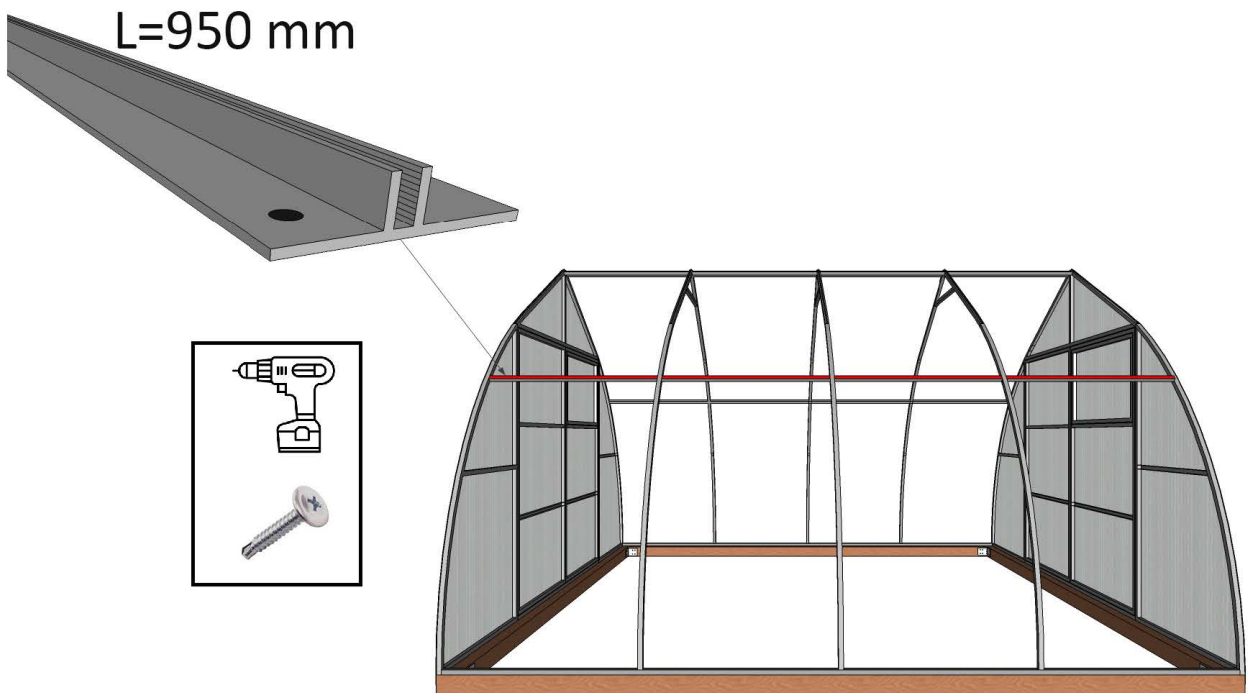

Picture #18



14. Place the polycarbonate sheets # 6 between the studs as shown in Picture # 23.

Picture # 19

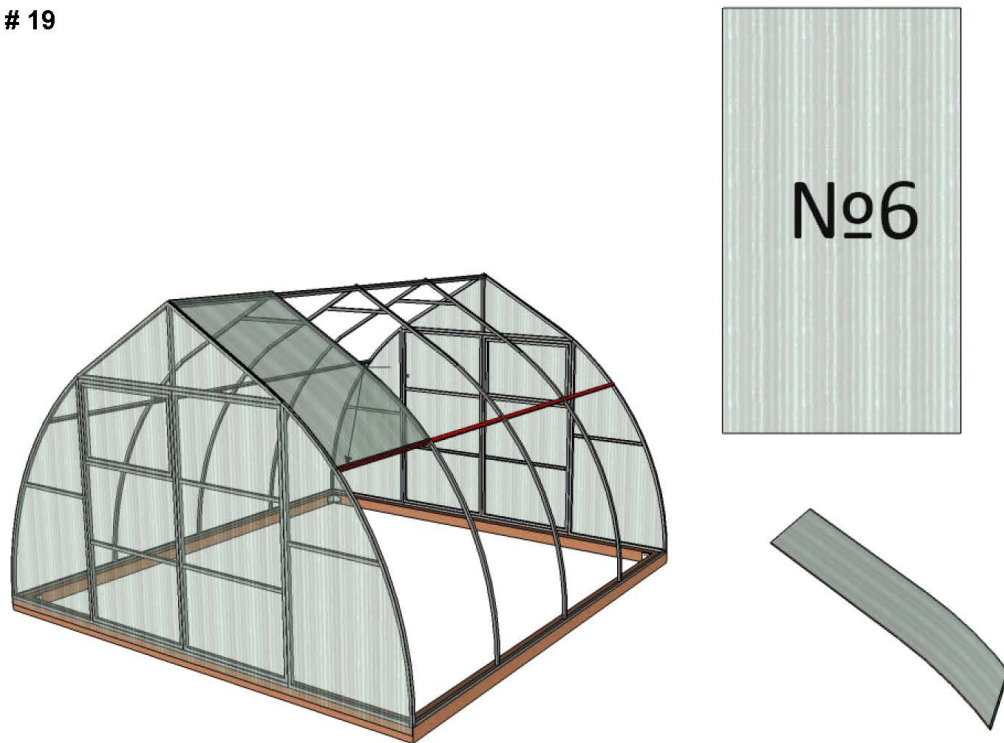

The polycarbonate sheets are extended down below the baseline of the aluminum brace #1 and are screwed in from the outside. They extend down past the frame. When you assemble the frame and start attaching the sheets to it, you will see how far exactly they are extended.

The upper part of the bottom sheet #6 rests against the aluminum profile (base #14), which you must first attach to the Transverse brace 975 mm # 6 (Picture #9). The lower end of this sheet will partially cover the wooden beam for the appropriate length. The polycarbonate sheets will cover the bottom of the greenhouse frame and slightly overlap the wood beam.

15. Insert aluminum profile seal # 33 into the two parallel grooves in aluminum caps ##15, 16,17 as shown in the picture below. Cover the joints of the polycarbonate sheets along with the studs with these aluminum caps and secure the cover with screws # 18.

Picture #20

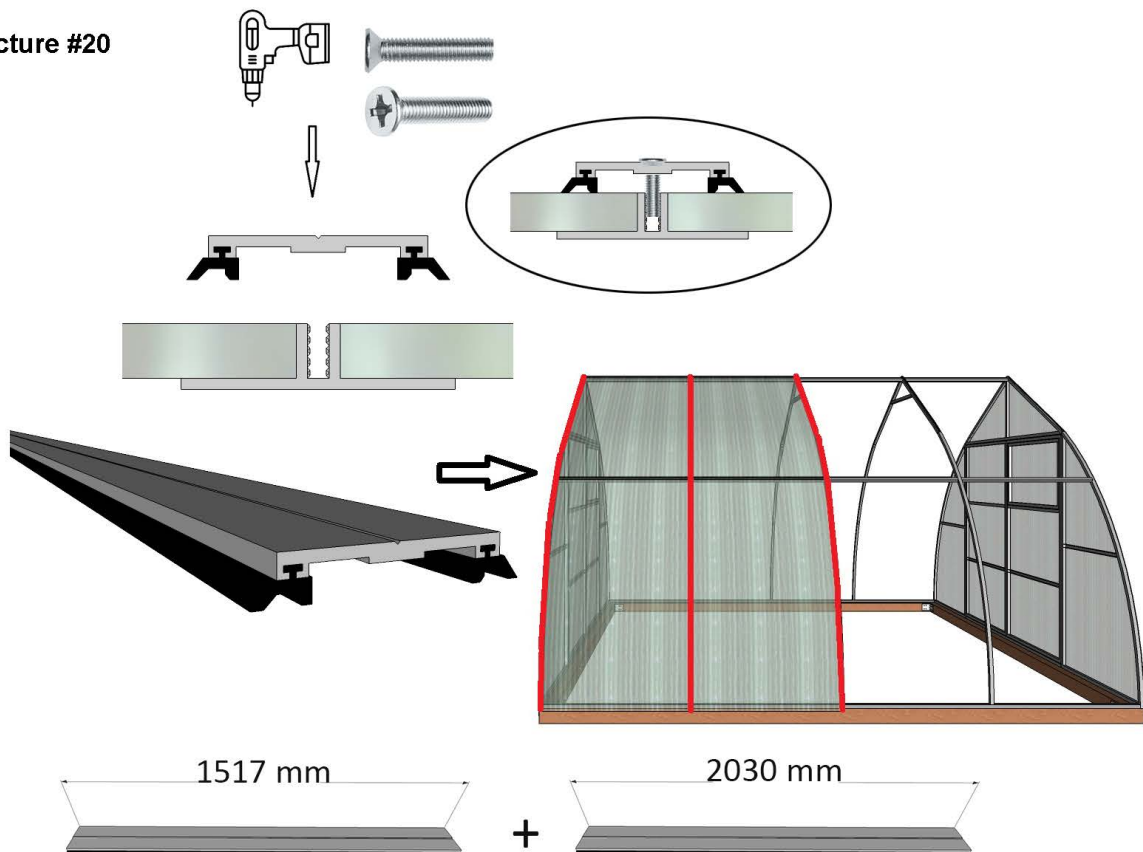

16. Insert aluminum profile seal # 33 into the two parallel grooves in aluminum caps ##15, 16,17 as shown in the picture below.

Cover the joints of the polycarbonate sheets along with the studs with these aluminum caps and secure the cover with screws # 18.

Picture #21

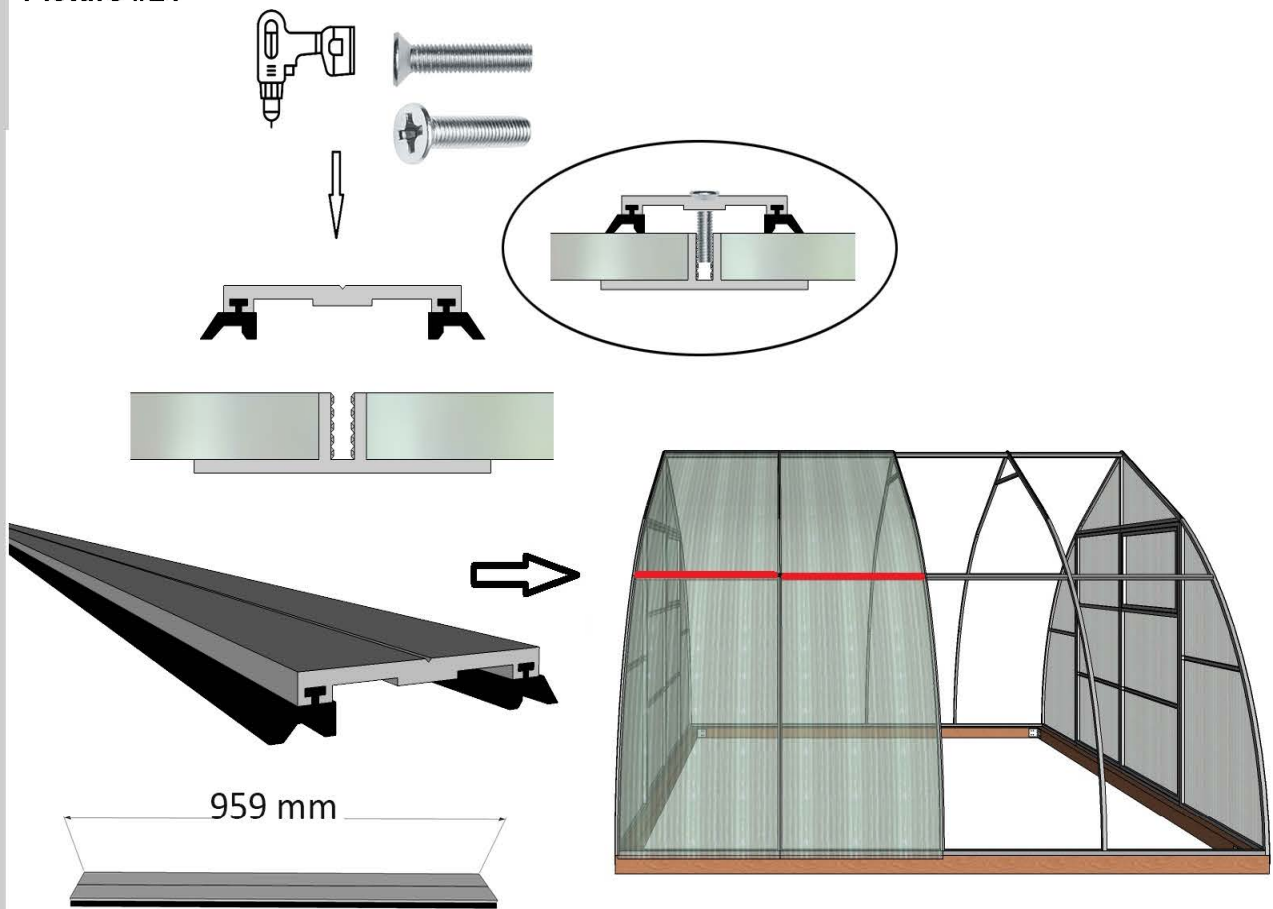

17. Windows installation

Picture #22

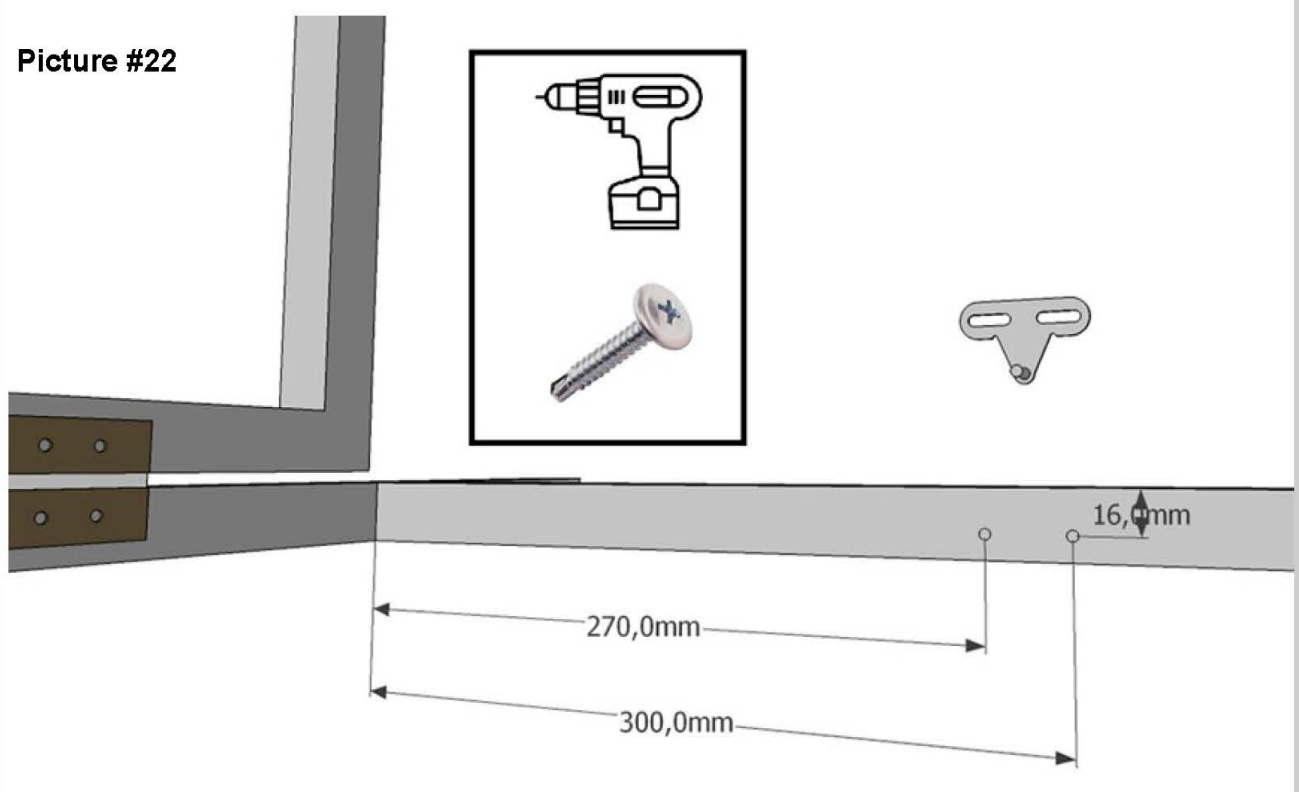

Picture #23

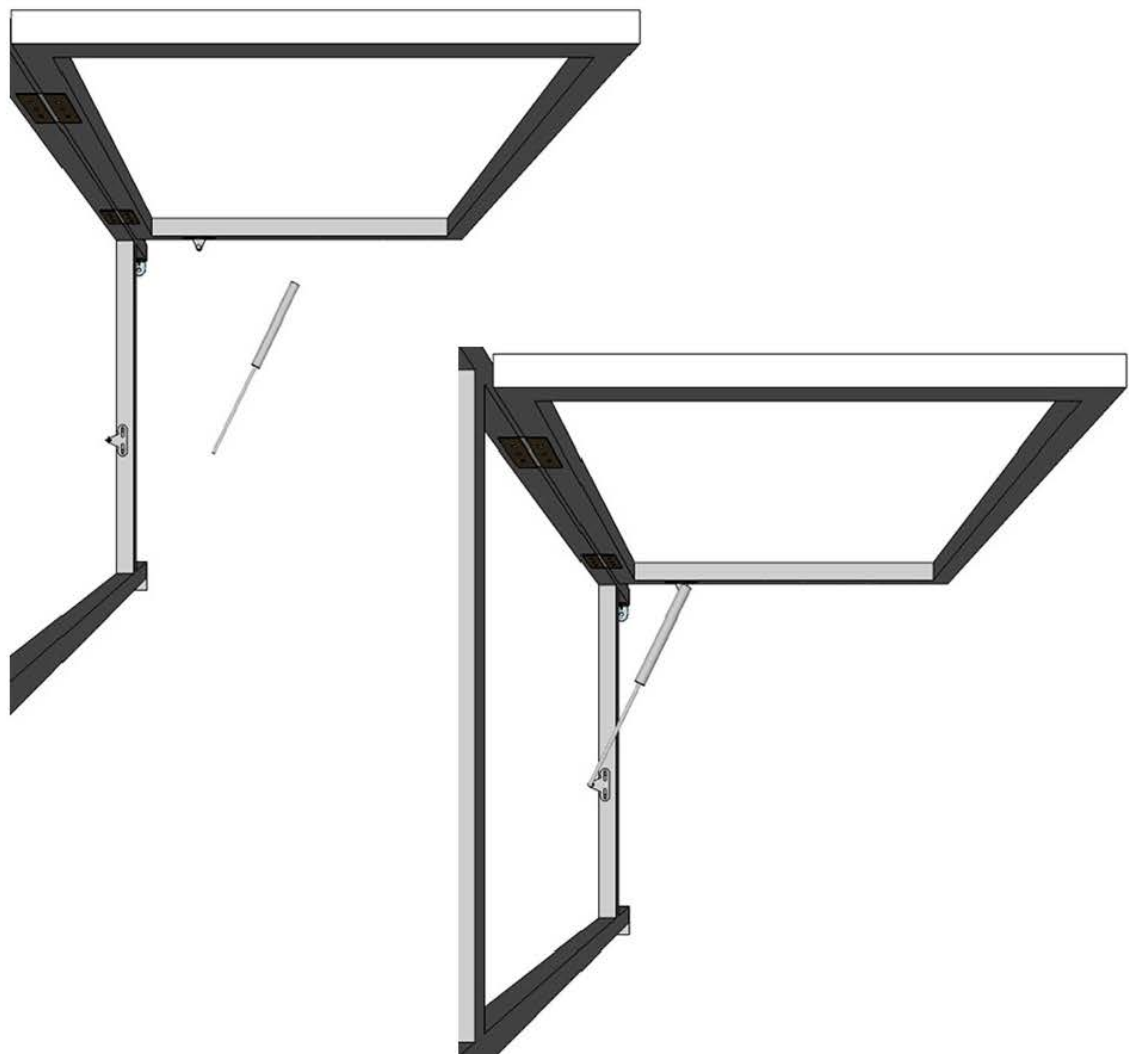
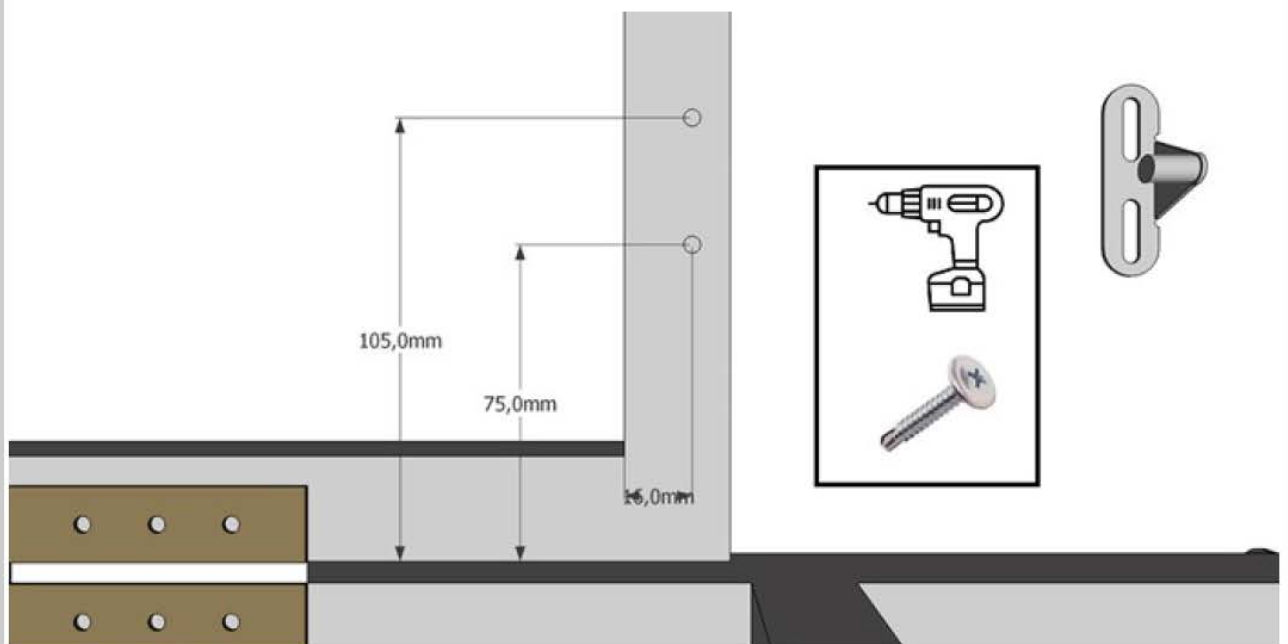

18. Install Door and window seal #34 on the door and ventilation window as shown in picture #24.

Picture #24

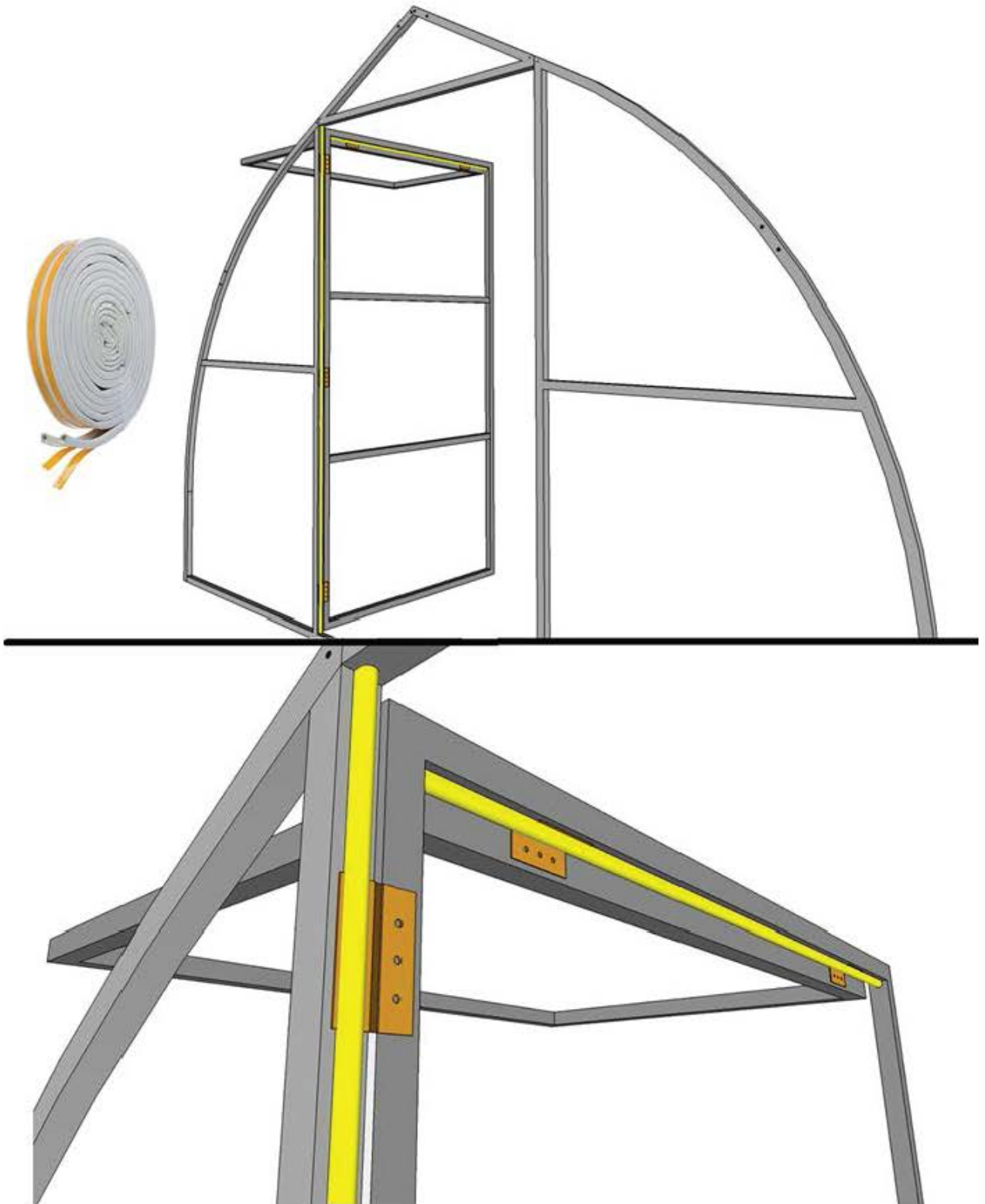



17. Using a self-adhesive backing, attach expanding foam tape #35 along both sides of the inner surface of the Ridge cover # 36 along its entire length, leaving 5 cm open from each end and as close as possible to the outer edge of the longest portion of the ridge cover. Expanding foam tape # 36 due to its gradual expansion, will fill the gap between the ridge cover and the polycarbonate sheets at the top of the greenhouse to prevent the ingress of water, air, snow and dust.

Picture #25

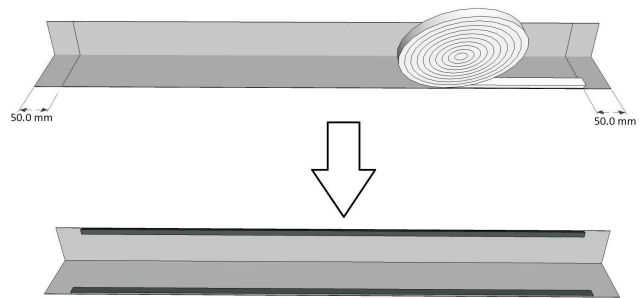

After that, install the ridge cover on the top of the greenhouse, clearly positioning it with the edges of polycarbonate sheets. When joining two ridges, try to overlap each other. Fasten the ridge cover in the places above the studs ## 03, 12 and 13. In the place of the self-tapping screw for attaching the ridge cover, pre-drill a hole through the ridge cover, base cover, polycarbonate, and the stud.

We recommend installing the ridge cover in the following sequence as in the pictures below:

Picture #26

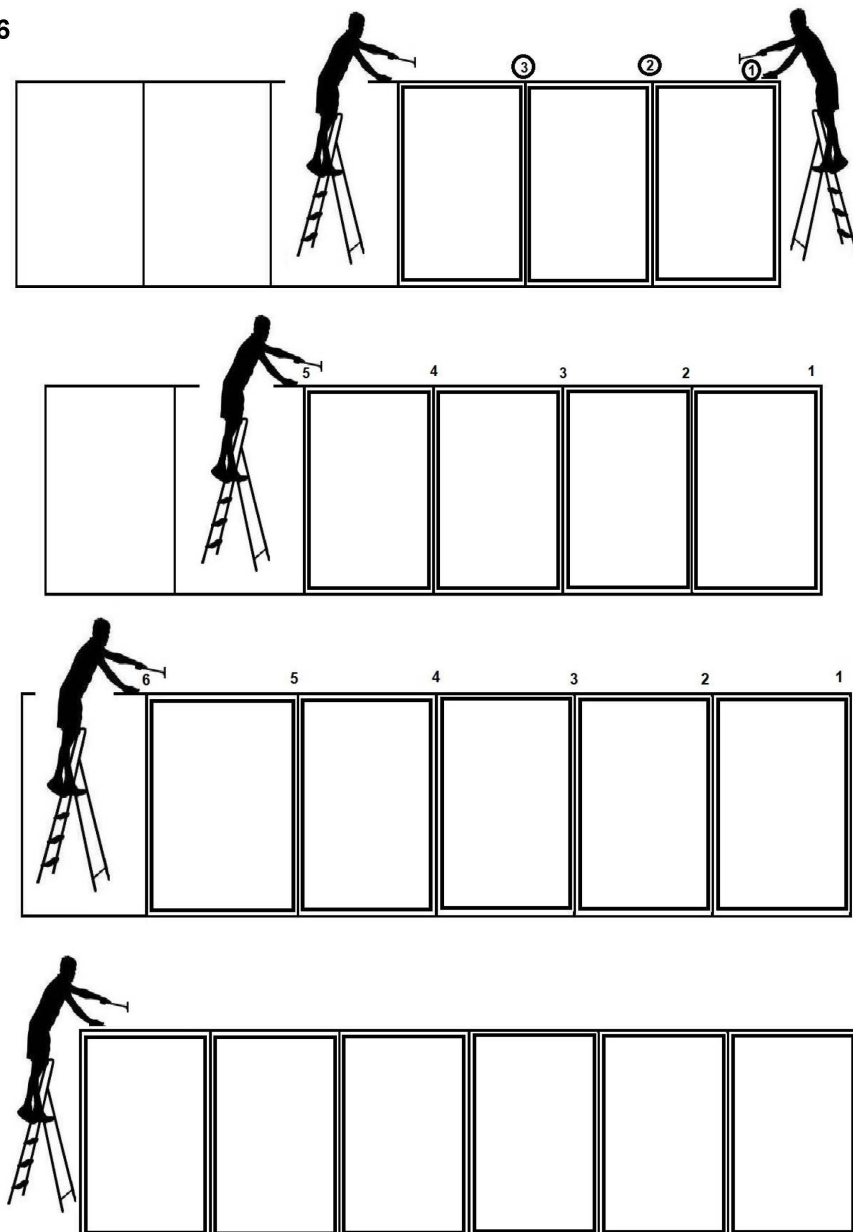

Picture #27

