

# User Manual

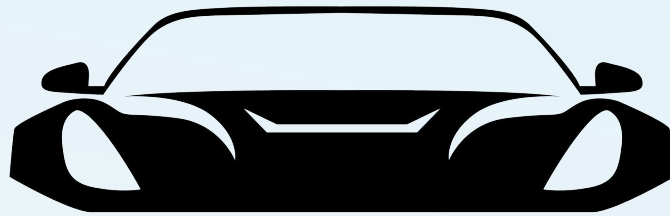

**STREAMLINE**  
C O D I N G

**NBT Carplay MMI BOX**

# Specifications

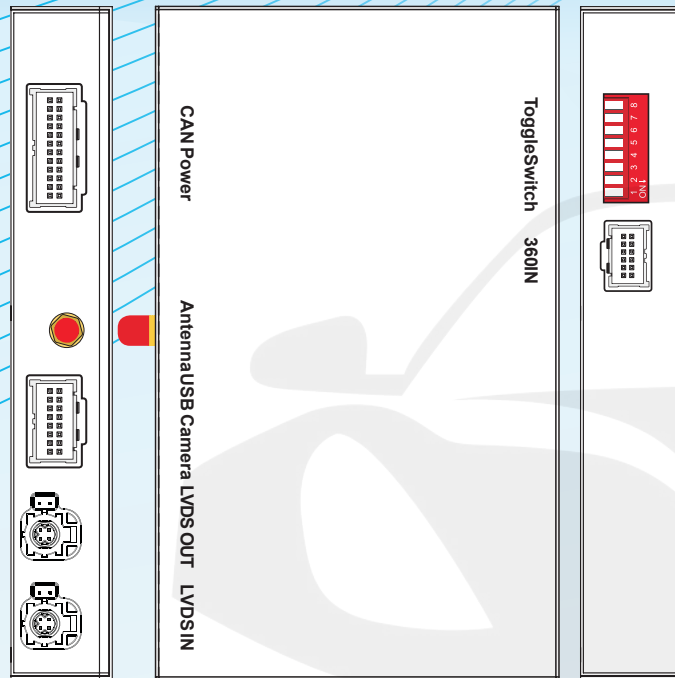

## Panel description

<b>CAN Power</b>	For power cable connection, CAN data transmission
<b>Antenna</b>	Wifi antenna connector
<b>USB Camera</b>	USB data transmission, and for reverse/front camera connection
<b>LVDS OUT</b>	Connect with cable labelled 'LVDS-GPBMW1901-NBT'
<b>LVDS IN</b>	Connect with OEM LVDS from the screen
<b>Toggle switch</b>	Refer DIP code setting to set for different screen size
<b>360 IN</b>	Exterior 360 input(VGA signal input)

<b>Input</b>	USB/CVBS signal input
<b>Input Voltage</b>	12-16V DC
<b>Rated Current</b>	2A
<b>Rated Power</b>	24W
<b>Control</b>	Voice/ iDrive control
<b>Material</b>	Housing aluminum

## Features

- >Support wireless/wired Carplay connection
- >Support wireless/wired Android auto function (some mobile phones)
- >Support wireless Airplay function
- >Support wired Autolink function
- >Compatible with OEM microphone and external microphone
- >Support EQ adjustment,lossless sound quality
- >Support USB to play audio file &video, support firmware upgrade
- >Keep the OEM system function, reversing radar and track display

# Accessories



LVDS cable LVDS-NBT-C19



WIFI antenna



AV/USB cable  
AV-USB-GP68



CAN power cable CAN-NBT-C19  
(Note: This cable isn't for bmw i3/i8, longer for i3/i8)



MIC adapter cable  
MIC-22C-DZ

# Compatible car model

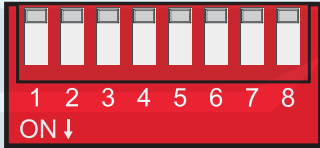
Series	Car model	Production year	Toggle switch
1	F20,F21	2012-2016	<p>OFF</p>  <p>ON</p> <p>1: ↓      0: ↑</p>
2	F22	2014-2016	
3	F30/F31/F34	2013-2015	
4	F32/F33/F36	2014-2016	
5	F10/F11/F07	2013-2015	
6	F12/F13	2013-2016	
7	F01/F02	2013-2016	
X3	F25	2013-2016	
X4	F26	2014-2016	
X5	F15	2014-2016	
X6	F16	2015-2016	8.8/10.25 inch:
MINI	F56	2014-2016	11100000

## NBT car system interface



## NBT MINI



## NBT i3/ i8

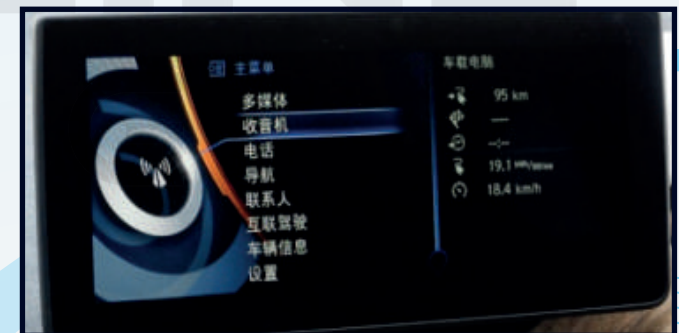

# Connection Diagram

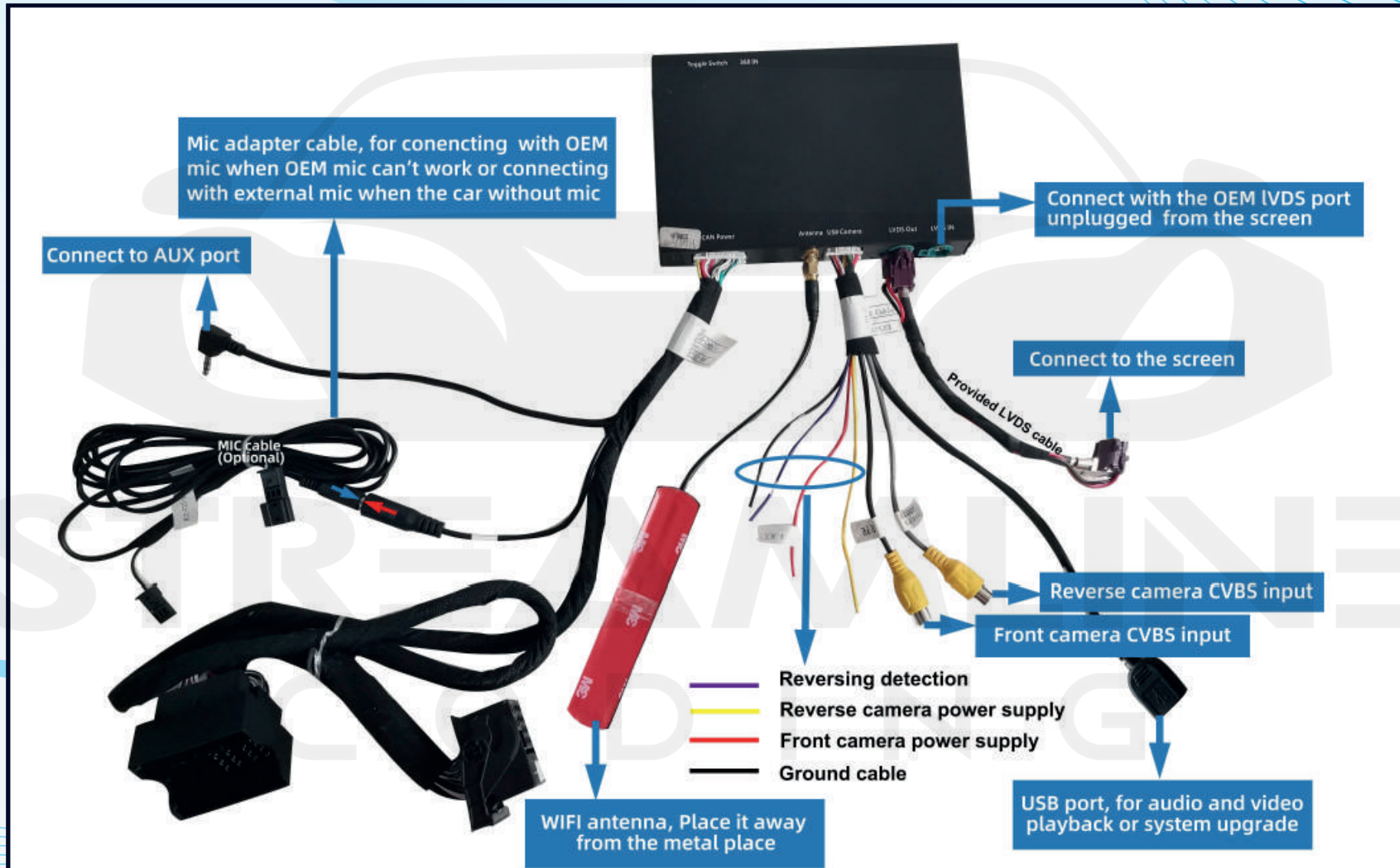

# Reverse camera wiring connection and settings

## Automatic transmission

1. Connect the reverse camera to CVBS OUT labeled 'Reverse camera'
2. Connect the cable labeled '12V reverse camera(yellow)' to camera power
3. Setting → Reverse → Reverse camera → Aftermarket

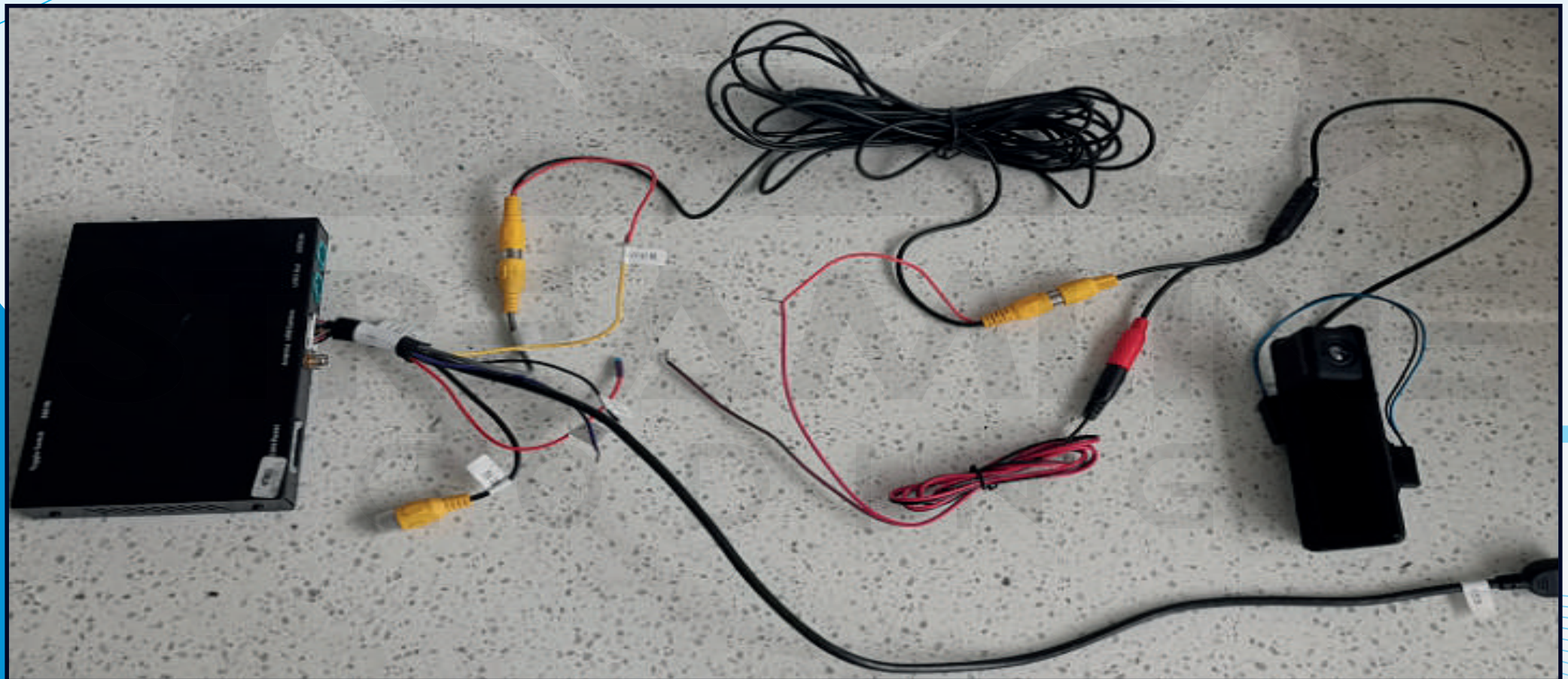
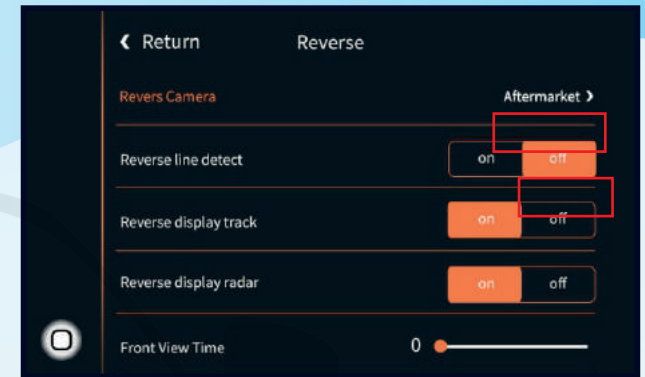

# Munal transmission

1. Connect the reverse camera to CVBS OUT labeled 'Reverse camera'
2. Setting → Reverse → Reverse camera → Aftermarket

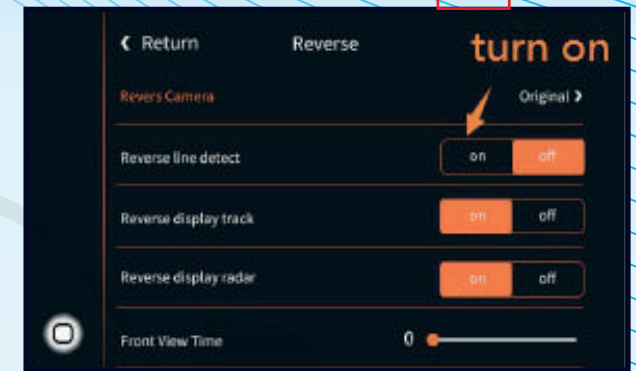

# Wireless carplay connection

1. Turn on WIFI (Fig.1)
2. Turn on Bluetooth (Fig.2), and connect Carplays bluetooth (Fig 3/4)
3. After the bluetooth connection is completed he following prompts will pop up, click 'Allow Use carplay ' (Fig.5/ 6)

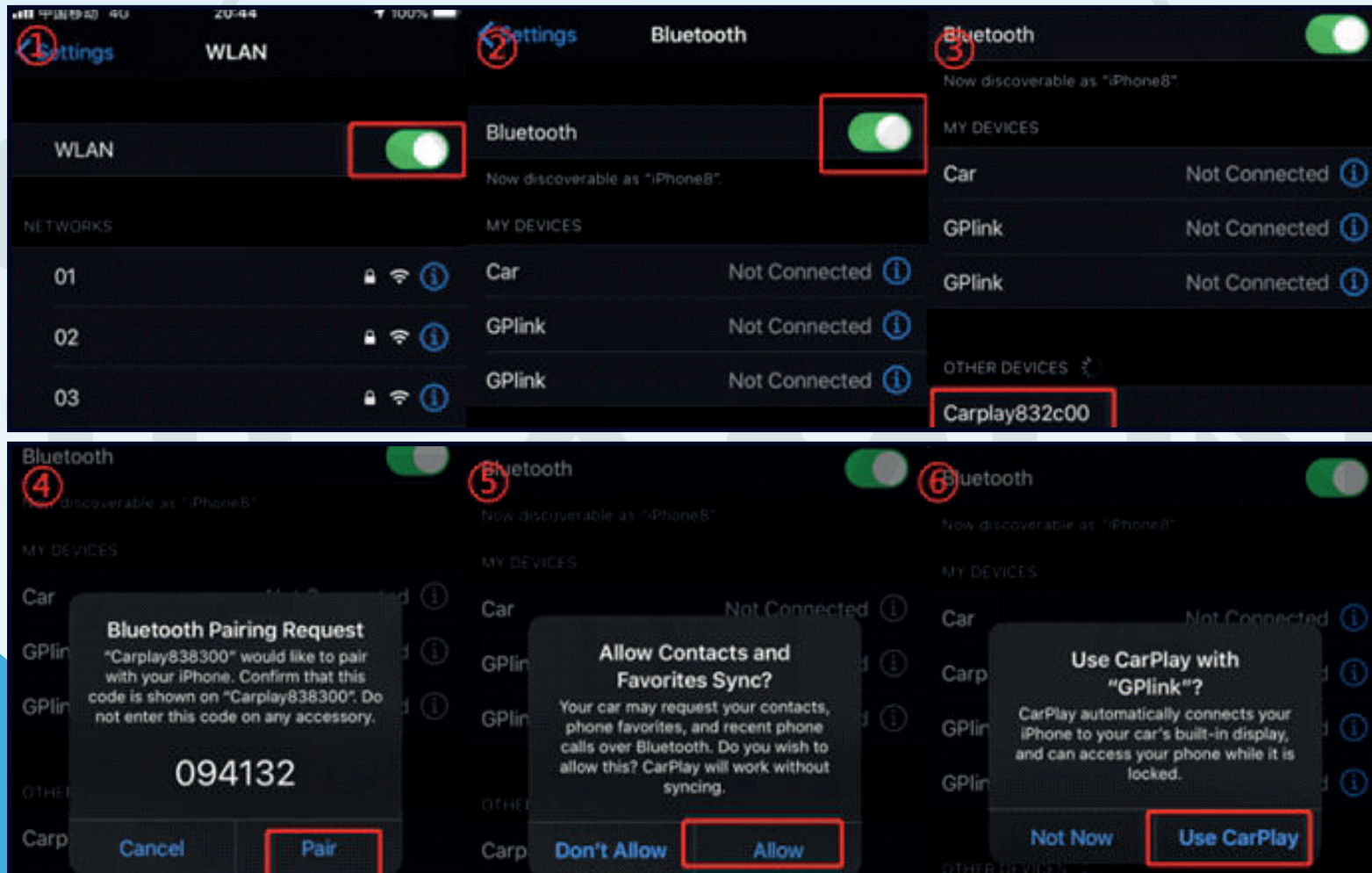



# Wireless Android auto connection

1. Turn on WIFI (Fig.1)
2. Turn on Bluetooth (Fig.2)
3. Enter the Wireless Dev APP (Fig.3 )
4. Search the bluetooth of phone (Fig.4 /5/ 6)
5. Choose any one of the options on the car end to pair (Fig.7)
6. The pairing request pops up on the phone, select 'pair' (Fig.8/9)

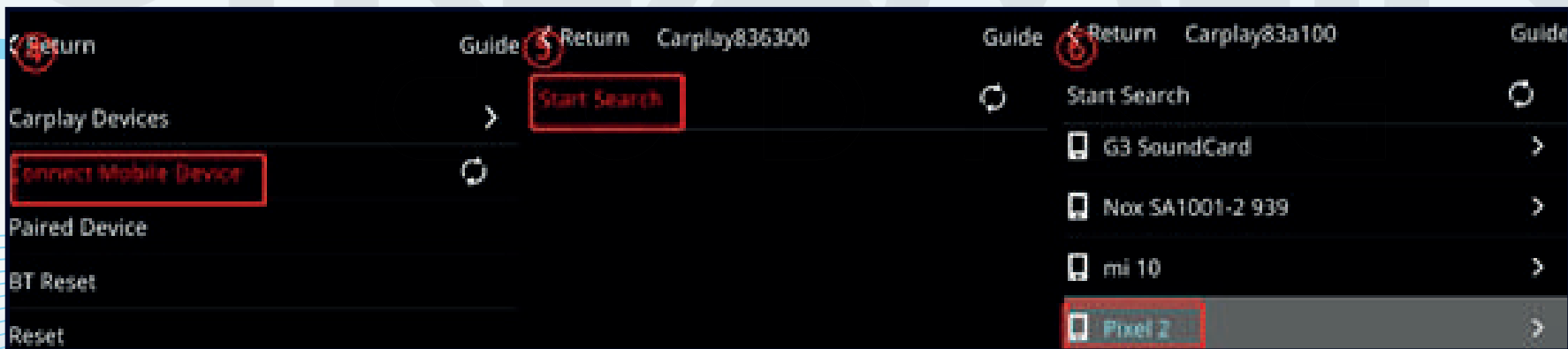
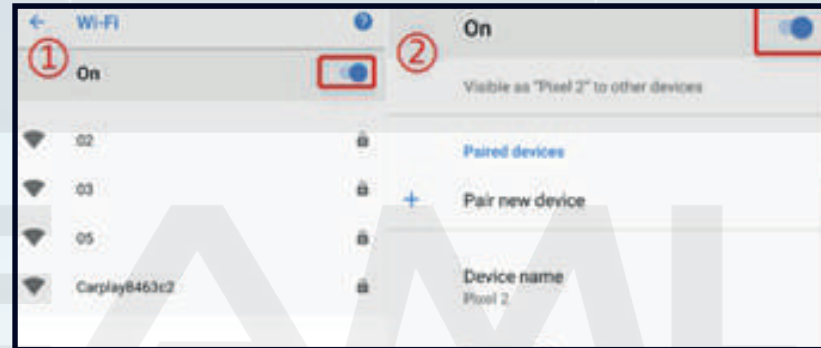
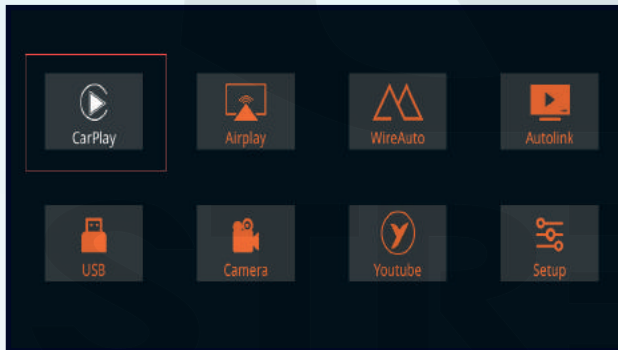

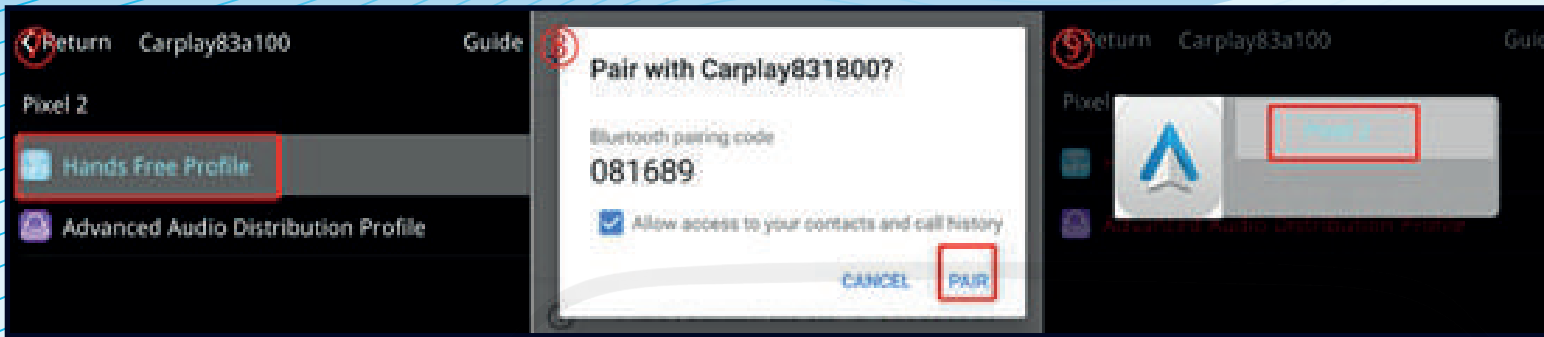

## Wired Android auto connection

1. Download Android auto APP on Android phone(Fig.1).
2. Click 'WireAuto, icon(Fig.2), the prompt 'Please connect your Android device' will pop up(Fig.3).
3. Plug your phone to USB port. then it will enter Android auto automatically(Fig.4).

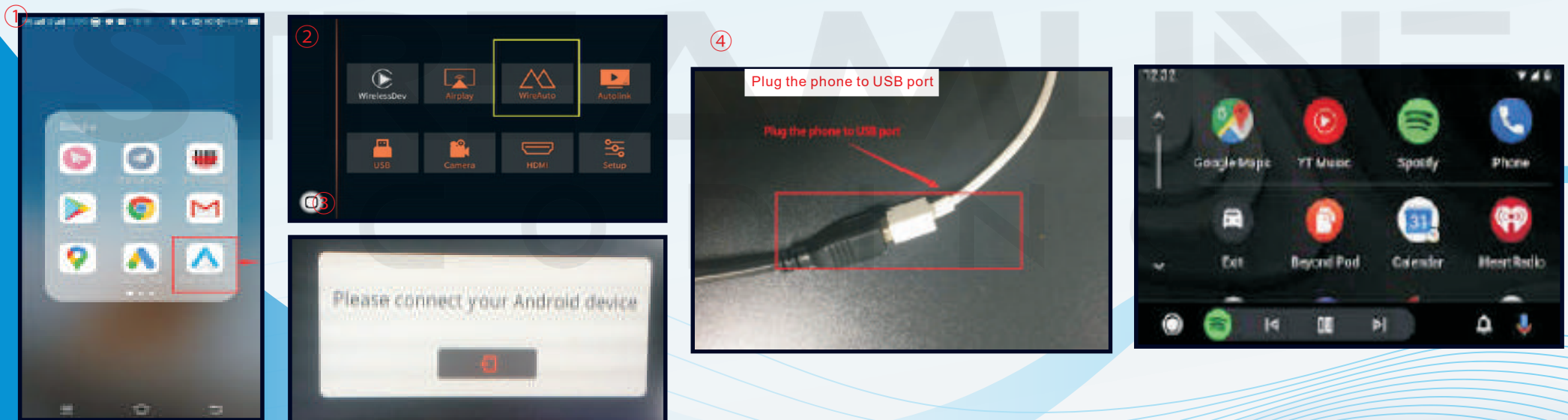

# Wireless Airplay connection

1. Click 'Airplay' icon first (Fig.1), the pairing information with the phone will be displayed (Fig.2)
2. Search wifi signal of Airplay and connect
3. Turn on Airplay (Fig3/4)

**Note: If you have connected Carplay before, please disconnect Carplay wifi first.**

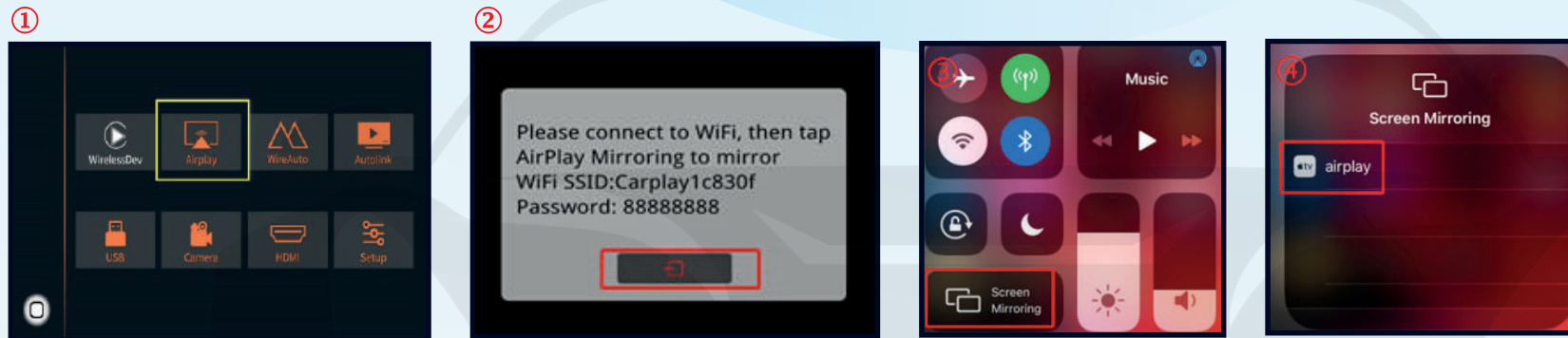

# Wired Autolink connection

1. Download Android auto APP on your Android phone and turn on all the prompt permissions of this APP (Fig.1).
2. Click 'Autolink' icon (Fig.2), the prompt 'Please connect your Android device' will pop up (Fig.3).
3. Plug your phone to USB port (Fig.4). It will enter Android auto automatically (Fig.5).

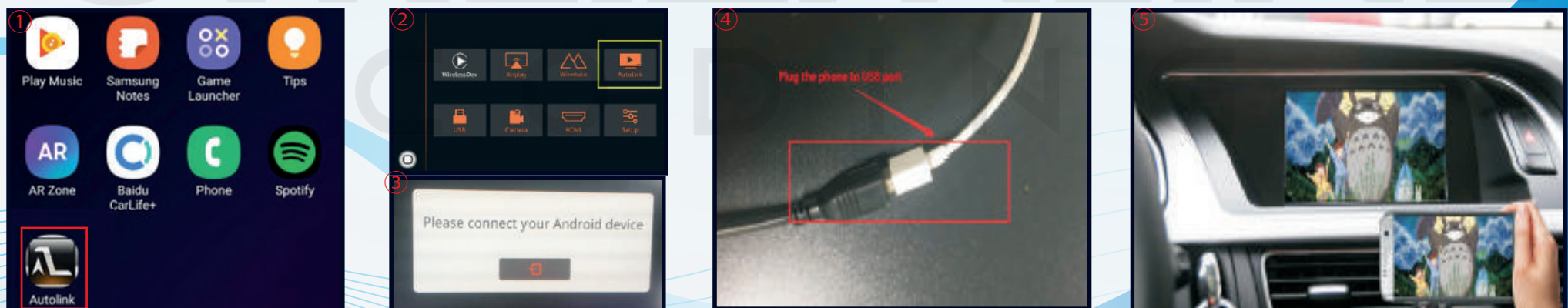

# Original buttons



**BMW i-Drive Button**



**Steering Wheel Buttons**

Button	Function	Operation	Remarks
1 MENU	System switching	Long press the button for 3 seconds	OEM $\longleftrightarrow$ CarPlay
2 Back	Go Back	Press the button short time	AppleCar Play Function
	Restart	Press the button for 5 seconds	Google Android Auto
 Dial	Move the pointer Left or Right	Turn the dial Move Left or Right	You can use this Function when you get in trouble
	Move the pointer Up or Down	Move the Dial Long time	AppleCar Play Function
4 Ok key	Ok key	Short pures to choose to activate siri	Google Android Auto
			AppleCar Play Function
5 Volume adjustment	Volume adjustment	Press to increase/ decrease the volume	AppleCar Play Function
			Google Android Auto
6 	"Siri" "Google Assistant"	Press the button 3 seconds	AppleCar Play Function
			Google Android Auto

# Setting instruction:

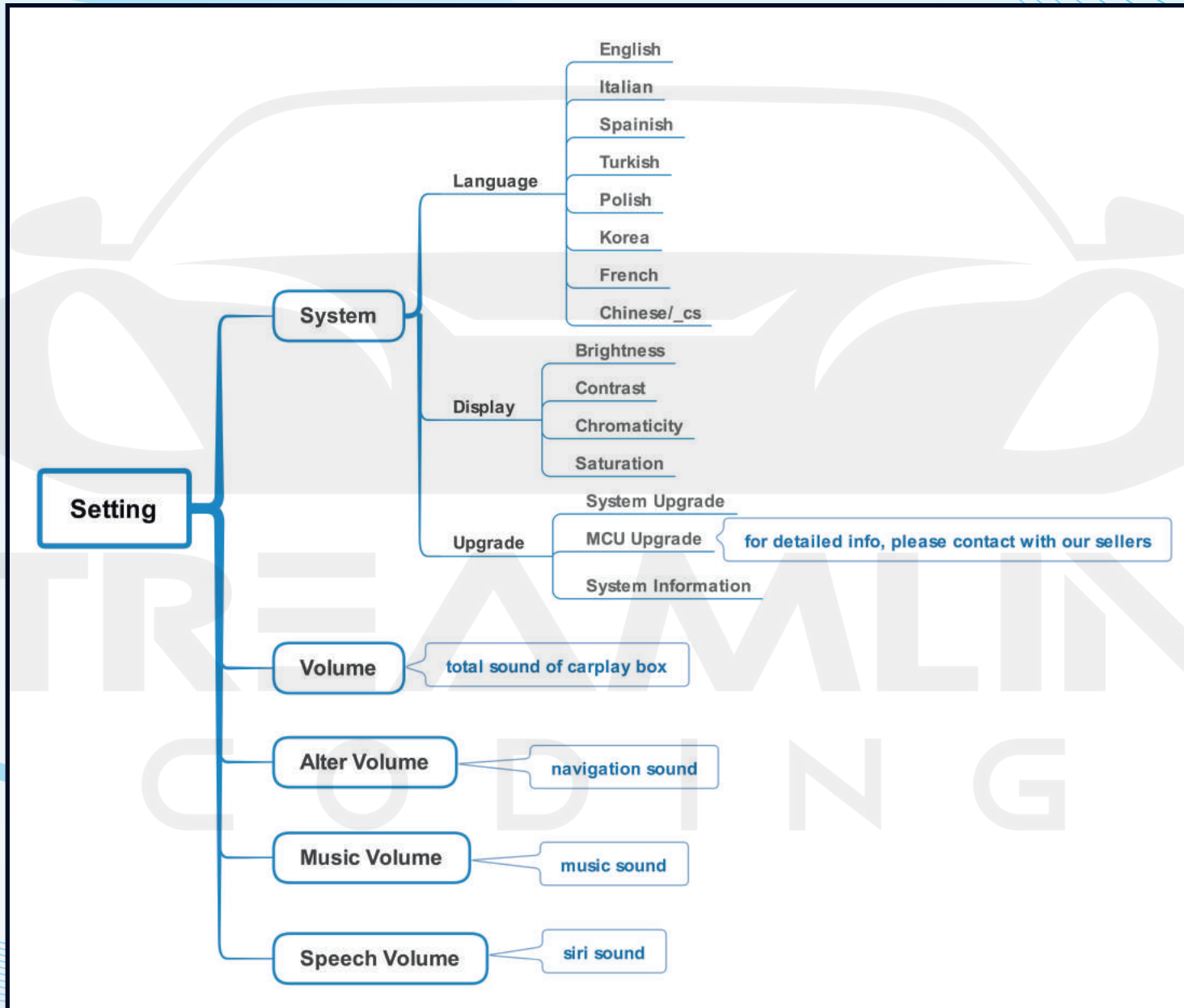

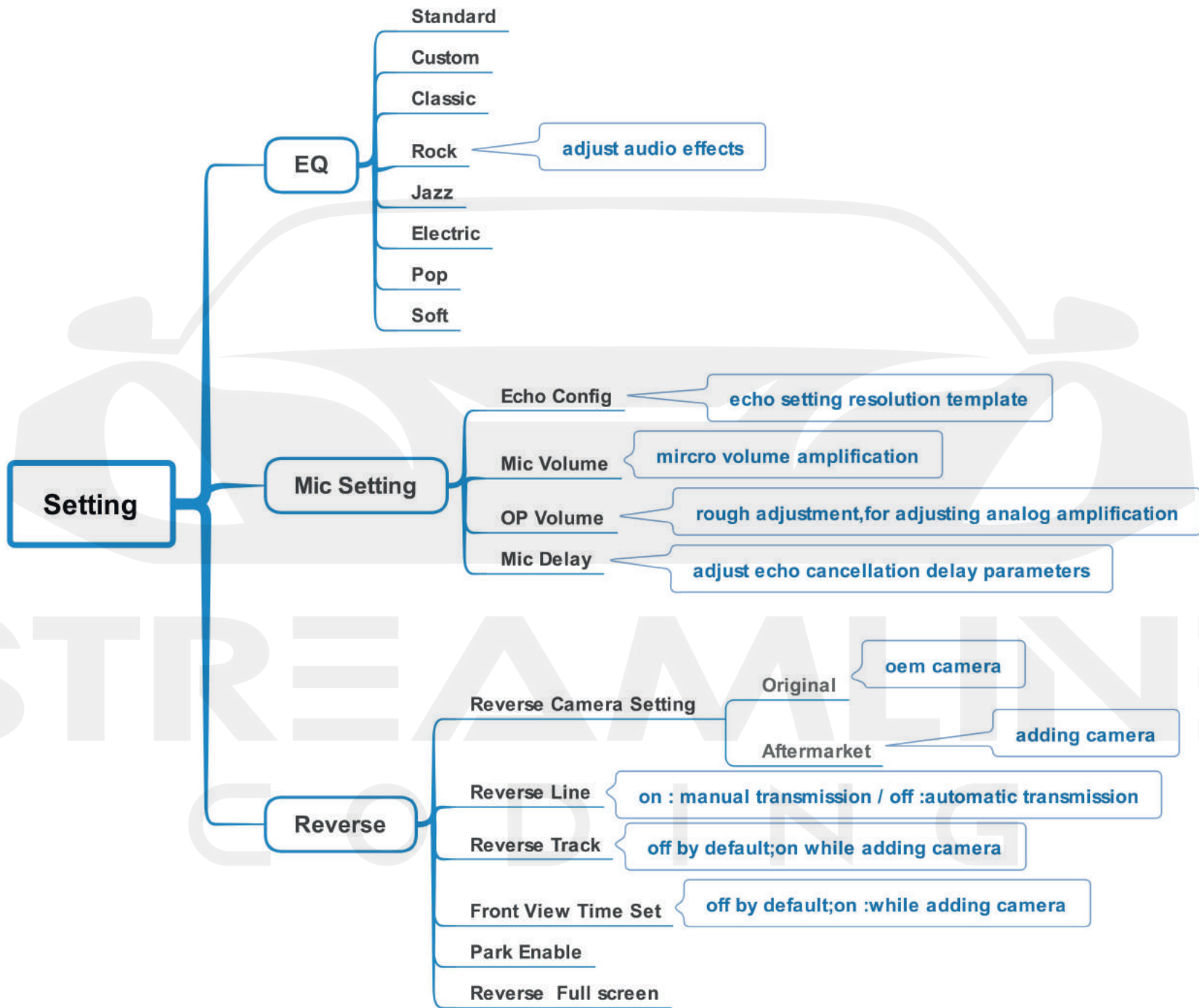

# Setting

## Carplay/Android-auto

Left Scrap

Right Scrap

Top Scrap

parameters can be adjusted to make the scen show symmetry

Bottom Scrap

Carplay Auto Dark Mode

Enable Carplay U/D Key

make idrive select up or down

## WiFi Channel(reboot required)

6

2.4GHZ,basic wifi channel

36

5GHZ,global universal channel

149

5GHZ,china channel

## Right Drive

on: right hand drive; off: left hand drive

## Camera Mirror

## Using Car's BT Phone

## Enable Wheel Key

activate the function of steering wheel

# FAQ

1. Q: What need to be paid attention to during installation?

- A: 1) Make sure that the carplay box is compatible with the installed model, and check whether the label of box matches with the car model.  
2) Power off during installation  
3) After the installation is complete, it is best to lock the car for a few minutes to turn it on, wait until the running test is normal, then restore the car.

2. Q: After installing the box unit, the screen displays no signal or switches to the carplay interface with display of black screen, yellow screen, abnormal screen or no response.

- A: 1) Check whether the wiring is connected according to the wiring diagram,  
2) original car LVDS cable must be transferred to inport of carplay box which is disconnected from screen monitor  
3) If the wiring connection is normal but the display is not normal, check if the pins of the lvds cable ports are bent or not in contact, you need to re-plug it.  
4) Check whether the dip switch code is correct, after each change, re-plug the box's can power cable .  
5) If the dip switch code and wiring connection are normal after inspection, box still switches to the black screen, it is recommended to upgrade the system under the guidance of relevant personnel

3. Q: I don't have sound when I connect carplay, what can I do?

- A: 1) Connect fiber cable  
2) Set AUX on OEM system, ensure that the Bluetooth signal connection between the mobile phone and the original car is disconnected.  
3) If there is no sound after step1/2, connect AUX cable to AUX port of armrest box.

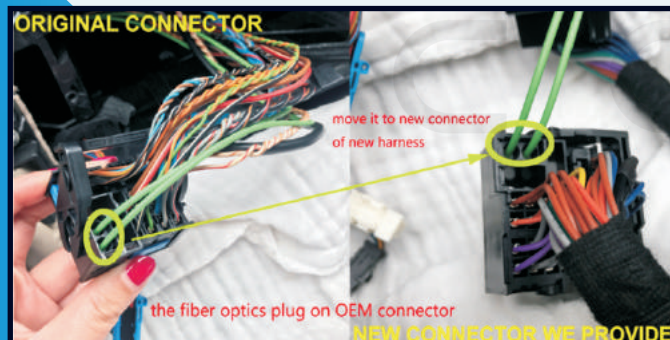



4. Q: My car has OEM microphone, but it can't work, what can I do?

A: Please use the following cable to connect to OEM microphone.

1) Connect A to C

2) Unplug blue connectors and place mic tap cable in between the connector with microphone on it and the main wiring harness coming from the roof. (B/D need to be connected)

## OEM MIC

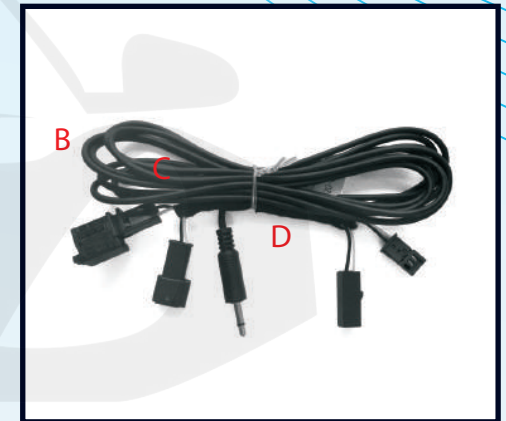

5. Q: I don't have OEM microphone, how to connect external microphone?

A: You can do as following solutions.

1) Connect A with C, B with D.

2) Set pin7 to ON, and restart



6.Q: Solutions to not being able to connect with carplay

A: can try to use the solutions below separately or together

- 1) Click on carplay bluetooth or wifi on the mobile phone
- 2) At the same time, clear the Bluetooth devices on the mobile phone and the car, and then pair and connect
- 3) Go to WirelessDev to reset the Bluetooth, and then pair and (Fig.1)

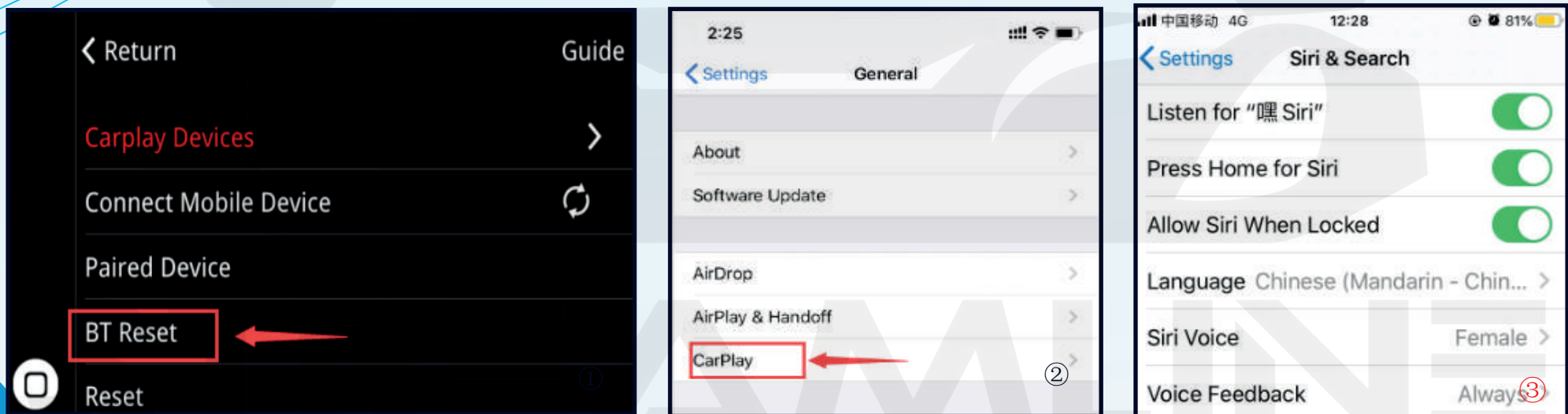

- 4) Restore the mobile network to the mobile phone
- 5) Check whether the carplay on the mobile phone is turned on (Fig.2)
- 6) Siri permissions are all turned on(Fig.3)
- 7) If necessary, check the antenna (whether it is broken, or attached to the metal, stay away from the box)

7. Q:When I call someone, he can hear himself, how to do?

A:1) Adjust the volume of the original car to normal use

2) Turn the volume in 'audio' setting to 13(Fig.1)

3) Turn the 'Microphone Volume' to 12

4) 'Microphone OP' tune from 0 until no echo is heard

5) Adjust 'AEC quality' to 2

6) If the caller hears the echo interval for a long time, fine-tune the 'Microphone delay

7) If the caller hears a small voice, you can fine-tune the 'Microphone Volume' and 'Microphone PGA'

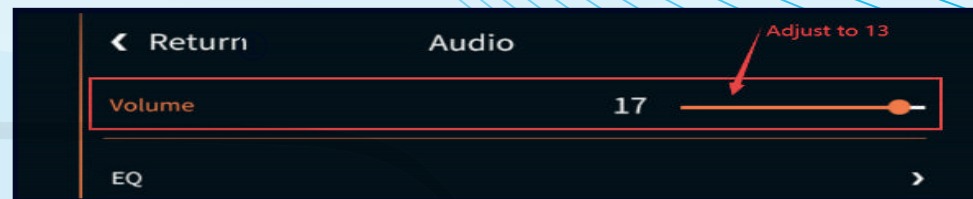

8. Q:I install the carplay, but the button on steering wheel can't work?

A:1)Set the setting 'Enable wheel key' to ON(Fig.2)

2) Short press the voice button or long press 5 sec the ok button on i drive knob to activate siri.

9. Q:Siri function can not be used

A: 1) Check whether has turned the siri access permissions on iphone,turn all the options on

2) Turn the function of steering wheel on in carplay switch page setup

3) If can activate the Siri but Siri cant receive the command please check whether the mic works first, if no problem with mic, check the Bluetooth of iphone, disconnect it from original car Bluetooth.

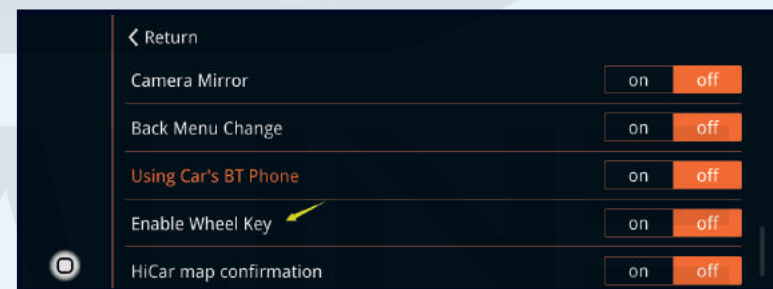



**STREAMLINE**  
CODING