

STAR VISION CAMPERS & CARAVANS

PXI DELUXE OFFROAD HYBRID 5.8 m / 4 Berth

5 YEARS STRUCTURAL WARRANTY
PRICE MATCH GUARANTEE
FINANCE AVAILABLE

ELECTRIC ROOF

BUNK BEDS

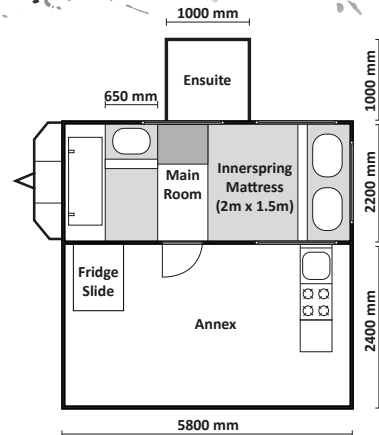

STANDARD FEATURES

\$ 39,990

• Plus Dealer Delivery & On Road Costs

- Ball weight: Approx 220 KG
- Tare weight: Approx 2140 KG
- Loading capacity (ATM): 2700 KG (Fitted with breakaway unit)
- Hot-Dip Galvanised steel chassis & body deadener
- ARK XO 750 Series heavy duty dual jockey wheel
- Cruisemaster DO35 (3.5 tonne)
- 7 Pin flat trailer plug
- Anderson plug located on draw bar
- 4x Stabilisers legs
- 2x 4.5kg Gas bottle holders
- Massive amount of external storage
- Built-in LED lights
- 3 Burner LPG Gas cooktop
- Fridge slide (960 L x 570 W x 510 H mm)
- Heavy duty stainless steel kitchen sink with electric water pump
- Cutlery tray
- 120 + 80 Litre water tanks
- 16" Alloy rims

- Mud terrain tyres (265/75R16)
- Coil spring, independent trailing arm suspension
- 4x Off road shock absorbers
- Stone guard / Pebble guard
- Electric roof
- 200W Roof mounted solar panel
- 2000W Power inverter
- 240 Volt power inlet + 240 Volt charger
- 240 Volt power outlet
- USB & 12v outlets
- LED Side Lights
- Massive storage under the bed
- Bunk bed converts into couch
- Top bunk (1750mm x 560mm)
- Bottom bunk (1920mm x 560mm)
- Speakers (Internal & External)
- Entertainment system with DVD / VCD / CD / MP4 / MP3 Player / AM or FM Radio / AUX / USB



BASE CAMP AUSTRALIA
 7 Niche Parade
 Wangara WA 6065
 1300 473 009
 sales@basecampaaustralia.com.au

STAR VISION

SPECIFICATIONS

Trailer Size:	5800 L x 2200 W x 2200 H mm	Wheels and Tyres:	4 x Alloy Wheels, 2 x Brand New Spare 16" (265/75R16)
Draw-bar:	Total Draw-bar size: 3380 mm (3600 mm include coupling)	Brakes:	4WD 12 inch Electric Brakes and Hand Brake
Chassis:	Extra Heavy Duty off-road frame	Coupling:	Cruisemaster DO35 3.5T All-Terrain coupling with double safety chains
Ball Weight:	Approx 220 KG	Finish:	Hot-Dip Galvanised steel frame
TARE Weight:	Approx 2140KG	Jockey Wheel:	ARK XO 750 Series dual jockey wheel
ATM:	2700 KG	Jerry Can Holder:	2 x Jerry can holders
Fridge Box Size:	960 L x 570 W x 510 H mm	Water tanks:	120 + 80 Litre water tanks
Suspension:	Coil spring, twin shock absorbers, independent trailing arm	Gas Bottle holder:	2x 4.5kg Gas bottle holders
Stabiliser legs:	4 x quick lock-up and wind down drop-down stabiliser bars	Bedding area:	LED Lights with Switch
Solar panel:	200W Roof mounted solar panel	Lights:	Built-in LED Lights (internal & external)

OTHER FEATURES

Awning Type:	Rollout	Windows:	Midge mesh Mosquito Proof Netting and block out blinds on all windows
Annex Section:	4060 x 2400 mm	Popup roof:	Electric opening / gas strut / scissor arms
Mattress:	2000 L x 1550 W x 170 H mm (innerspring)	Other features:	• Easy electric roof enables easy setup

TOURING PACKAGE

- 2x 100Ah AGM Batteries
- No Annex
- No Under-bench Air Conditioner

OPTIONAL EXTRAS

- Chest Fridge
- Diesel Heater
- Caravan TV

ULTIMATE PACKAGE

- 2x 135Ah Lithium Batteries
- Fully Enclosed Annex (Walls & Floor)
- Under bench Air Conditioner (Hot & Cold)



*The information is accurate at the time of print. Please refer to our website for the updates.

