

STAR VISION

CAMPERS & CARAVANS

CX3 PRO

OFFROAD HYBRID
15 ft / up to 4 Berth

5 YEARS STRUCTURAL WARRANTY
PRICE MATCH GUARANTEE
FINANCE AVAILABLE

ELECTRIC ROOF

LUXURY KITCHEN

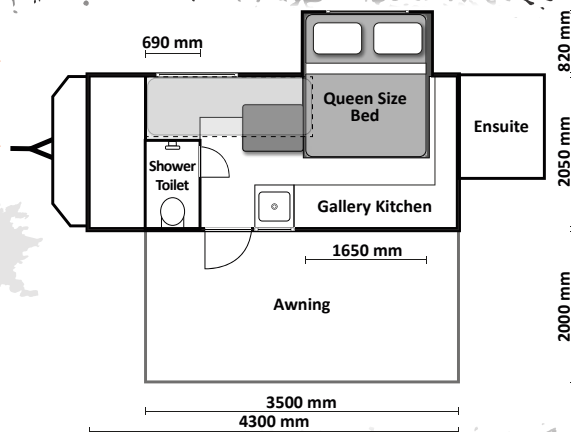

\$ 57,990

Plus Dealer Delivery & On Road Costs

STANDARD FEATURES

- Ball weight: Approx 180 KG
- Tare weight: Approx 2280 KG
- Loading capacity: 2800 KG (Fitted with breakaway unit)
- Hot-Dip Galvanised chassis & body deadener
- ARK XO 750 Series heavy duty dual jockey wheel
- Cruisemaster DO35 (3.5 tonne)
- 7 Pin flat trailer plug
- Anderson plug
- 4x Stabilisers legs
- 2x Jerry can holders
- 2x 9 KG Gas bottle holders
- LED Lights (internal & external)
- Thetford 3 LPG Gas burner cooktop
- Fridge slide (970 L x 520 W x 630 H mm)
- Stainless steel kitchen sink with electric water pump
- Kitchen light
- 120 + 80 Litre Fresh water tanks
- 80 Litre Grey tank
- Alloy rims
- Mud terrain tyres (265/75R16)
- Coil spring, independent trailing arm suspension
- 4x Heavy duty off road dual shock absorbers
- Electric roof
- 400W Roof fitted solar panel
- 2x 135Ah Lithium batteries
- 2000W Power inverter
- 240 Volt power inlet + 240 Volt charger
- 240 Volt power outlet
- USB outlet plug + 12 Volt
- Table (height adjustable)
- Cushioned dining area
- Massive amount of storage space
- Hot/Cold reverse cycle floor mounted air conditioner
- Internal Combine Ensuite
- External Shower
- Thetford cassette toilet
- Speakers (Internal & External)
- Entertainment system with DVD / VCD / CD / MP4 / MP3 Player / AM or FM Radio / AUX / USB



BASE CAMP AUSTRALIA
 7 Niche Parade
 Wangara WA 6065
 1300 473 009
 sales@basecampaaustralia.com.au

STAR VISION

SPECIFICATIONS

Trailer Size:	6250 L x 2000 W x 2350 H mm	Wheels and Tyres:	2 x Alloy Wheels, 2 X Brand New Spares 16" (265/75R16)
Draw-bar:	Total Draw-bar size: 3600 mm (3800 mm include coupling)	Brakes:	4WD 12 inch Electric Brakes plus additional Hand Brake
Chassis:	Extra Heavy Duty off-road frame	Coupling:	Cruisemaster DO35 3.5T All-Terrain coupling with double safety chains
Ball Weight:	Approx 180 KG	Finish:	Hot-Dip Galvanised steel frame
TARE Weight:	Approx 2280 KG	Jockey Wheel:	ARK XO 750 Series dual jockey wheel
ATM:	2800 KG	Jerry Can Holder:	2 x Jerry can holders
Fridge Box Size:	970 L x 520W x 630 H mm	Water tank:	120 + 80 Litre tank
Suspension:	Coil spring, twin shock absorbers, independent trailing arm	Grey tank:	80 Litre tank
Stabiliser legs:	4 x quick lock-up and wind down drop-down stabiliser bars	Gas Bottle holder:	2 x Gas bottle holders (9 KG bottles)
Solar panel:	400W Roof mounted solar panel	Lights:	Built-in LED Lights (internal & external)

OTHER FEATURES

Awning Type:	Rollout	Other features:	<ul style="list-style-type: none"> • Easy electric roof enables easy setup • High Strength Frame
Awning Section:	3500 x 2000 mm	Mounting System:	Electric roof / struts / scissor arms
Mattress:	1860 L x 1530 W x 170 H mm (inner spring)		
Windows:	7x Midge mesh Mosquito Proof Netting windows and 3x Pushout		

OPTIONAL EXTRAS

- Fully Enclosed Annex
- Diesel Heater
- Fridge
- TV



*The information is accurate at the time of print. Please refer to our website for updates.

