

Installation instructions

01

Gather plaque, template, rods and spacers. Not included: spirit level, tape, epoxy adhesive [Selleys Araldite] hammer, drill and 5mm bit. Brick or concrete may require a hammer drill and 5mm masonry bit.

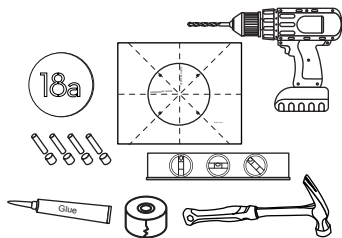

02

Tape template at desired location. Use a spirit level to align template. Drill holes according to template using 5mm drill bit then remove template.

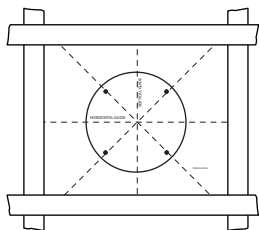

03

Apply a small amount of epoxy adhesive to one end of the rods.

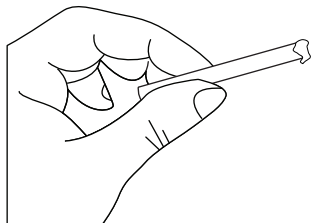

To extend the life of your plaque, clean every six months or every three months in coastal areas. Use a soft cloth and a mild household detergent solution to remove dust, salt, and other deposits. Rinse gently with clean, fresh water. Dry with non-abrasive towel.

04

Push rods into pre-drilled holes on back of the plaque. Light tapping with a hammer may be required. If so, place on soft surface to avoid scratching face of plaque. Wait for adhesive to dry before proceeding.

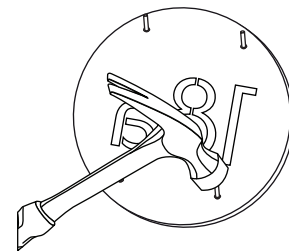

05

For a floating mount, slide spacers over each of the rods. Alternatively, leave the spacers off for a flush mount.

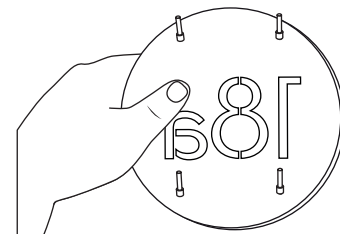

06

Apply a small amount of epoxy adhesive to the end of the exposed rods and push plaque into holes. Light tapping with a hammer may be required. Take care to not scratch the face of the plaque.

