

Installation instructions

01

Gather numbers, template, rods and spacers. Not included: spirit level, tape, epoxy adhesive [Selleys Araldite] hammer, drill and 5mm bit. Brick or concrete may require a hammer drill and 5mm masonry bit.

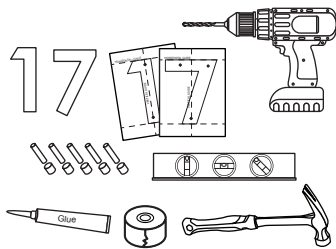

04

Push rods into pre-drilled holes on back of each number. Light tapping with a hammer may be required. If so, place on soft surface to avoid scratching face of number. Wait for adhesive to dry before proceeding.

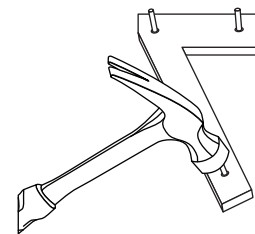

02

Tape template/s at desired location, overlapping to set spacing if required. Use a spirit level to align template. Drill holes according to template using 5mm drill bit then remove template.

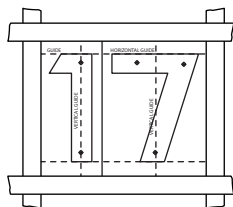

05

For a floating mount, slide spacers over each of the rods. Alternatively, leave the spacers off for a flush mount.

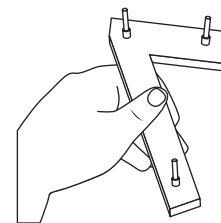

03

Apply a small amount of epoxy adhesive to one end of the rods.

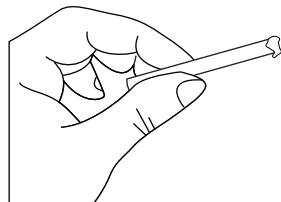

06

Apply a small amount of epoxy adhesive to the end of the exposed rods and push number into holes. Light tapping with a hammer may be required. Take care to not scratch the face of the number.

