

Thank you for purchasing this OXS product.

To receive more complete service, please follow us at www.oxsaudio.com

OXS

SOUNDBAR S5 V1.1

User Manual

MANUALE DI ISTRUZIONI

MANUEL D'UTILISATION

تاميلعتلا لي ل د

制造商:深圳雷戈创新科技有限公司

地址:深圳市龙岗区园山街道荷坳社区龙岗大道8288号大运软件小镇17栋105

製造商:深圳雷戈創新科技有限公司

地址:深圳市龍崗區園山街道荷坳社區龍崗大道8288號大運軟體小鎮17棟105

Produttore: Shenzhen Leige Innovation Technology Co., Ltd.

Indirizzo: 105, edificio 17, città del software Dayun, N. 8288,

Viale Longgang, Comunità di Heao, Strada di Yuanshan, distretto di Longgang, città di Shenzhen

Thank you for purchasing this OXS product.

To receive more complete service, please follow us at www.oxsaudio.com

INFORMAZIONI SU QUESTO MANUALE

Il manuale d'uso è diviso in due parti: il presente manuale d'uso semplificato e un manuale completo dettagliato, che è possibile scaricare.

Manuale d'uso

Consultare il presente manuale per istruzioni su installazione del prodotto, componenti e modalità di connessione.

Manuale completo

È possibile consultare il manuale completo o scaricarlo dal sito web di OXS. (<http://www.oxsaudio.com/support>)

Design e specifiche sono soggetti a modifica senza preavviso.

SOMMARIO

Elenco articoli	IT - 04
Layout del dispositivo	IT - 05
Telecomando	IT - 07
Istruzioni per l'uso	IT - 08
1. Collegare l'alimentazione elettrica	IT - 08
2. Operazioni normali	IT - 08
3. Collegare l'USCITA TV-HDMI (eARC/ARC)	IT - 10
4. Utilizzare il cavo HDMI per collegare il dispositivo - HDMI IN	IT - 11
5. Utilizzare il cavo OPT per collegare il dispositivo	IT - 12
6. Utilizzare il cavo AUX per collegare il dispositivo	IT - 13
7. Collegare l'audio USB	IT - 14
8. Collegare il Bluetooth	IT - 15
Guida per l'aggancio a parete	IT - 16

ELENCO ARTICOLI

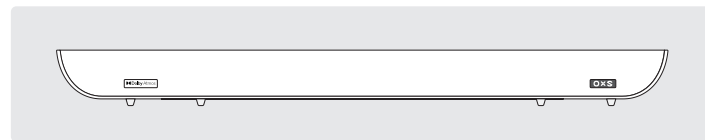

Impianto elettronico audio ×1

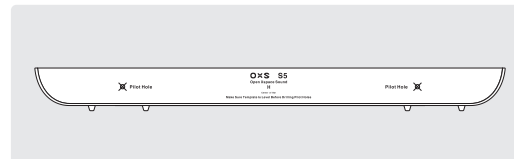

Modello per montaggio a parete ×1

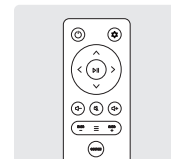

Telecomando ×1

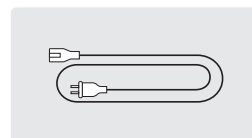

Cavo di alimentazione ×1

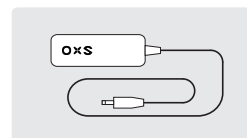

Adattatore ×1



Batteria ×2

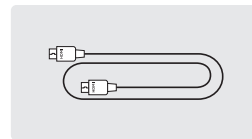

Cavo HDMI ×1

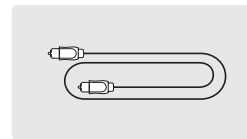

Cavo OPT ×1

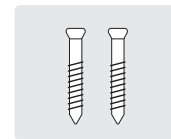

Vite per fissaggio a parete ×2



Sicurezza e manutenzione ×1



Specifiche tecniche ×1



Manuale d'uso ×1

LAYOUT DEL DISPOSITIVO

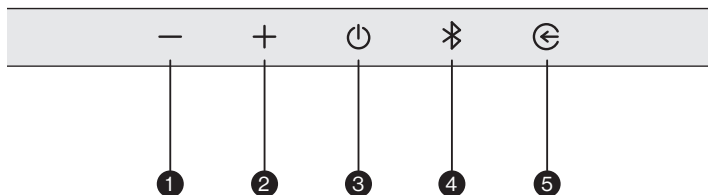

Pulsante a sfioramento

1	Diminuzione del volume		Regolare il volume
2	Aumento del volume		
3	Standby		In modalità standby, premere il pulsante standby per accendere il sistema di altoparlanti
4	Bluetooth		Passare alla sorgente Bluetooth o eseguire l'associazione Bluetooth
5	Selezione della sorgente audio		Cambiare la sorgente di ingresso audio premendo brevemente il tasto TV → HDMI → OPT → USB → BT → AUX

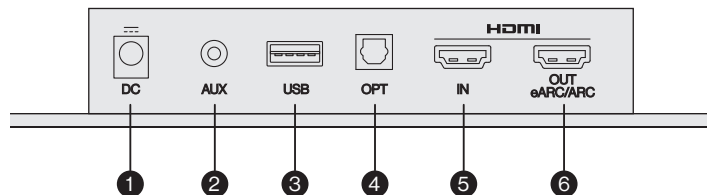

Porta di collegamento

1	DC		Porta di alimentazione CC
2	AUX		Ingresso audio AUX
3	USB		Audio USB (L'interfaccia USB viene utilizzata solo per la trasmissione dei dati)
4	OPT		Ingresso audio OPT
5	HDMI IN		Collegare l'HDMI all'ingresso
6	HDMI OUT (eARC/ARC)		Collegare l'HDMI (eARC/ARC) del televisore all'ingresso

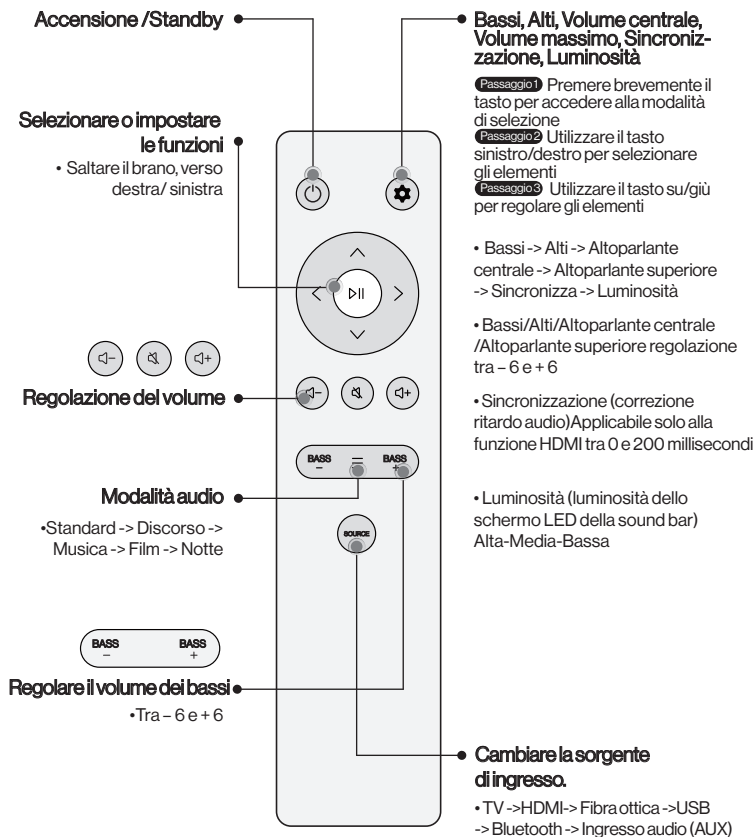

IT

Collegare l'alimentazione elettrica

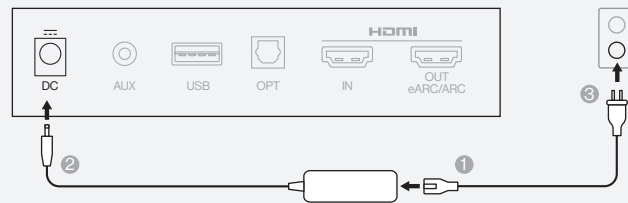

Operazioni normali

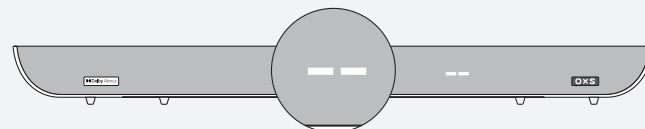

1 Dopo aver collegato l'alimentazione, il dispositivo entra in modalità standby

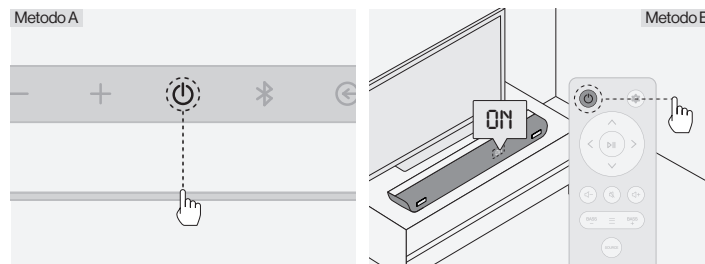

2 Premere brevemente il tasto per accendere.

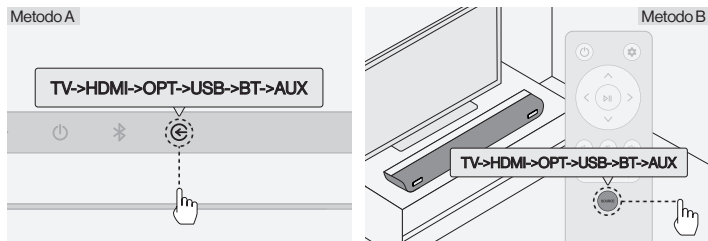

3 Cambiare alla sorgente di ingresso corretta

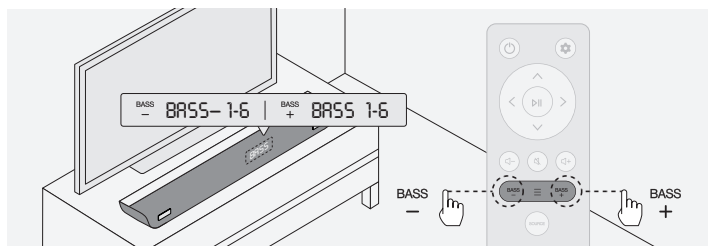

4 Regolare l'effetto audio o i toni bassi

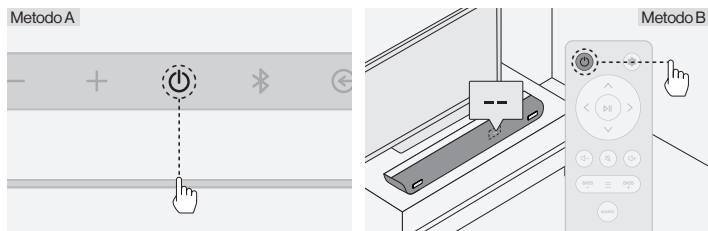

5 Premere brevemente il pulsante per spegnere l'alimentazione

In modalità AUX/OPT/TV/HDMI/BT, se non vi è alcun segnale audio entro 15 minuti, l'impianto elettronico audio entrerà automaticamente nello stato di standby.

Collegare il televisore



1 Collegamento HDMI

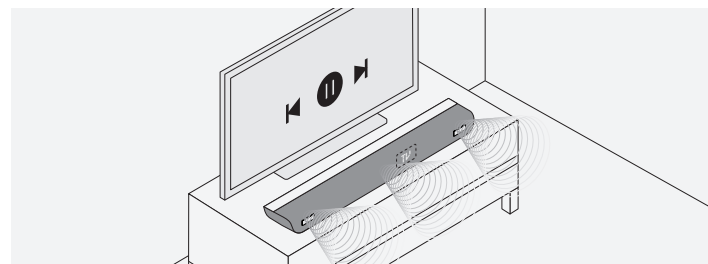
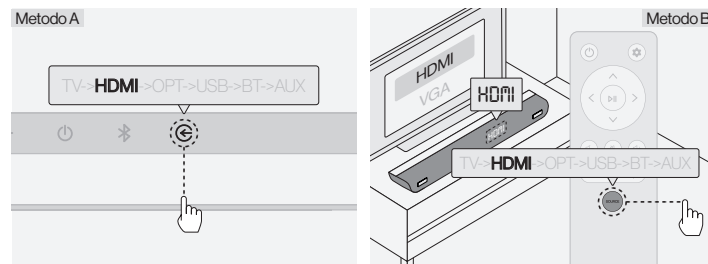

2 Selezionare la modalità "TV"

Utilizzare il cavo HDMI per collegare il dispositivo

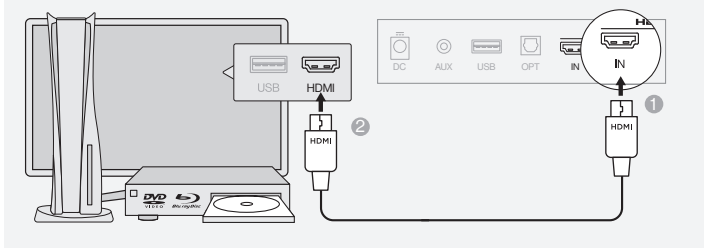

1 Collegamento tramite HDMI

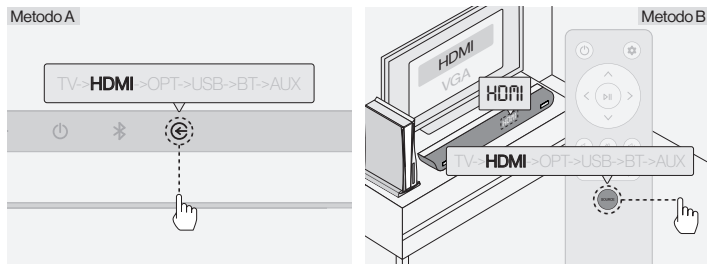

2 Selezionare la modalità "HDMI"

Utilizzare il cavo OPT per collegare il dispositivo

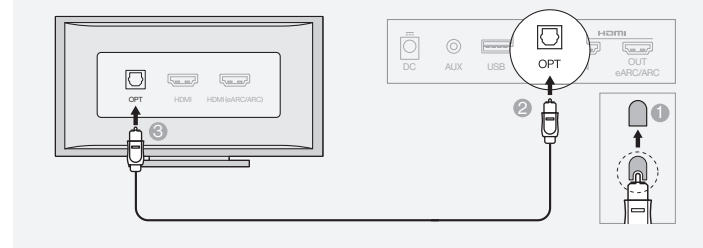

1 Utilizzare il cavo in fibra ottica per collegare il dispositivo e l'impianto elettronico audio

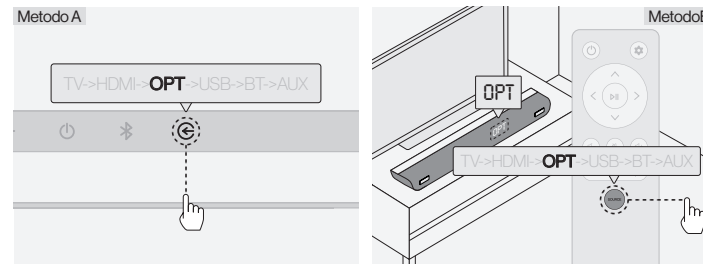

2 Selezionare la modalità "Fibra ottica"

Utilizzare il cavo AUX per collegare il dispositivo

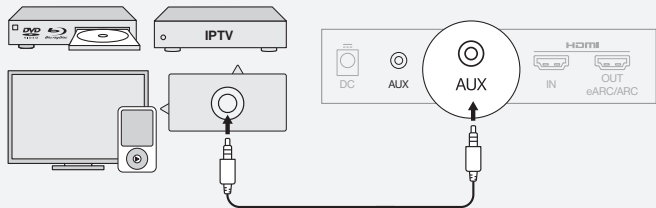

- 1 Utilizzare il cavo AUX per collegare il dispositivo e l'impianto elettronico audio

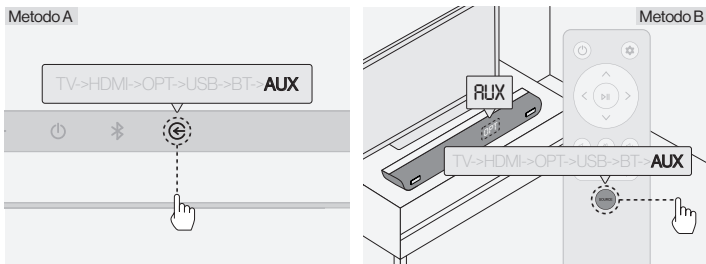

- 2 Selezionare la modalità "AUX"

Collegare l'audio USB

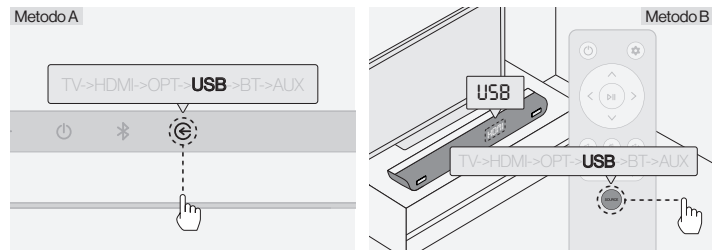

- 1 Selezionare la modalità "USB"

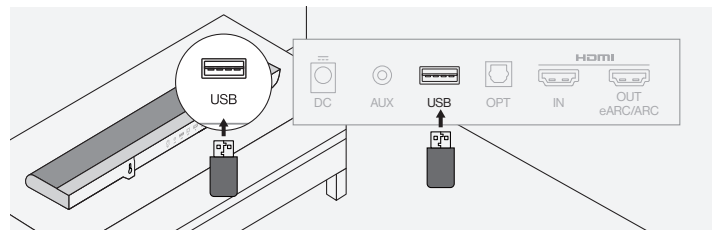

- 2 Collegare l'unità USB all'impianto elettronico audio

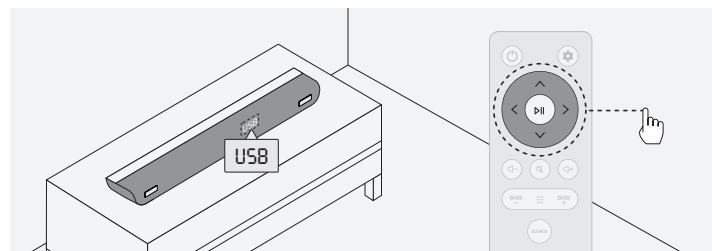

- 3 Controllare altre funzioni tramite il telecomando

Collegare il Bluetooth

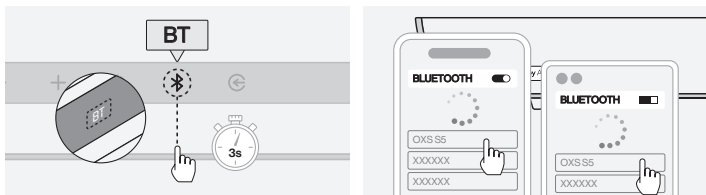

- 1 Passare alla modalità "BT" e premere il pulsante "BT" per 3 secondi per accedere alla modalità di associazione
- 2 Selezionare la modalità Bluetooth sul dispositivo. Selezionare "OXS S5" sullo schermo del dispositivo

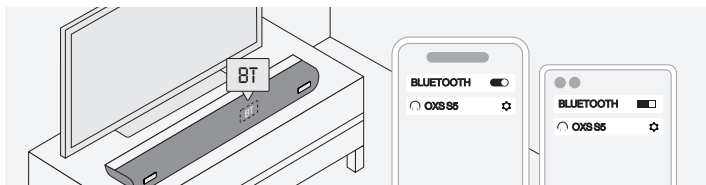

- 3 Dopo il collegamento, l'indicatore "BT" sull'impianto elettronico audio rimarrà stabile

GUIDA PER L'AGGANCIO A PARETE

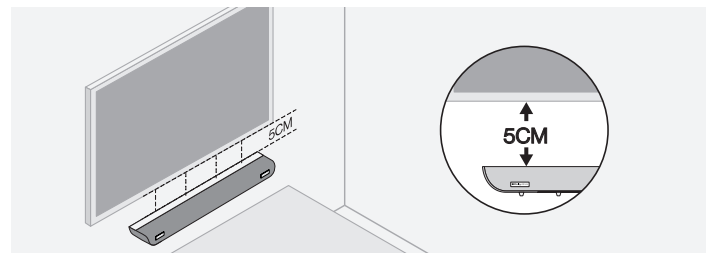

- 1 Se il televisore è appeso alla parete, posizionare l'impianto elettronico audio almeno 5 cm sotto il televisore

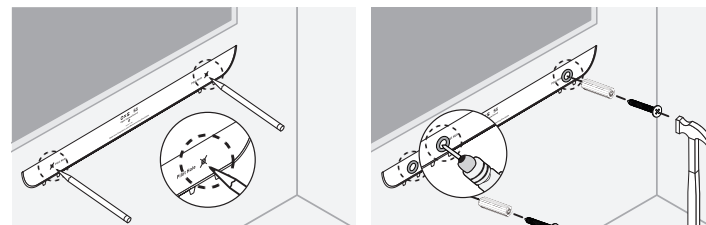

- 2 Utilizzare il modello di installazione a parete per contrassegnare la posizione dei fori di perforazione
- 3 Praticare i fori, installare sulla parete e installare le viti a espansione.

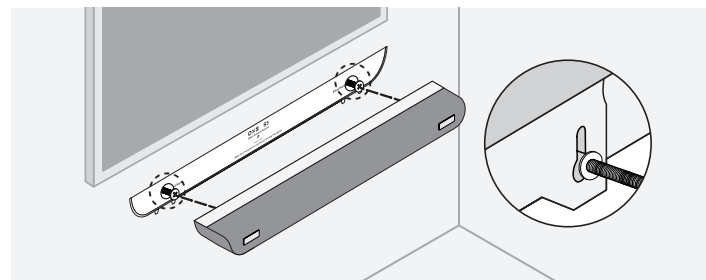

- 4 Appendere l'impianto elettronico audio alle viti di fissaggio a parete

À PROPOS DE CE MANUEL

Il existe deux parties dans ce manuel d'utilisation : un manuel d'utilisation simple et un manuel complet et détaillé. Il vous est possible de télécharger.

Manuel d'utilisation

Pour connaître comment faire l'installation du produit, ses composants et son mode de connexion, veuillez consulter ce manuel.

Manuel complet

Pour consulter le manuel complet ou le télécharger, rendez-vous sur le site web d'OXS. (<http://www.oxsaudio.com/support>).

Il est possible que la conception et les spécifications soient modifiées sans avis préalable.

CONTENU

Contenu de l'emballage	FR - 04
Disposition de l'appareil	FR - 05
Télécommande	FR - 07
Mode d'emploi	FR - 08
1. Connecter la station d'alimentation	FR - 08
2. Opérations normales	FR - 08
3. Connectez la sortie TV - HDMI (eARC/ARC)	FR - 10
4. Utilisez le câble HDMI pour connecter l'appareil - HDMI IN	FR - 11
5. Utilisez le câble OPT pour connecter l'appareil	FR - 12
6. Utilisez le câble AUX pour connecter l'appareil	FR - 13
7. Connectez le câble audio USB	FR - 14
8. Connectez le Bluetooth	FR - 15
Guide pour la fixation murale	FR - 16

CONTENU DE L'EMBALLAGE

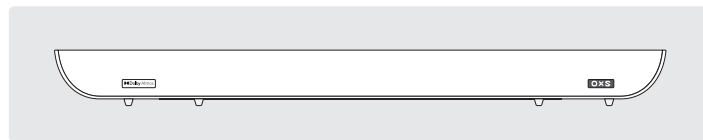

Système électronique audio ×1

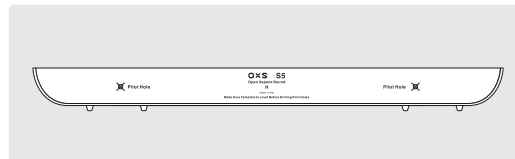

Gabarit de fixation murale ×1

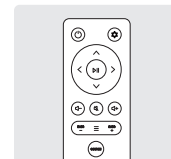

Télécommande ×1

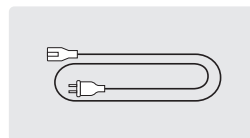

Cordon d'alimentation ×1

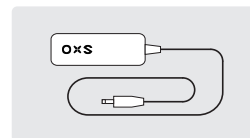

Adattatore ×1



Pile ×2

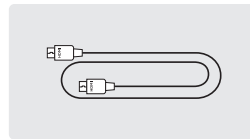

Câble HDMI ×1

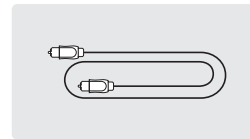

Câble OPT ×1

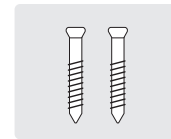

Vis pour fixation murale ×2



Sécurité et entretien ×1









Spécifications techniques ×1

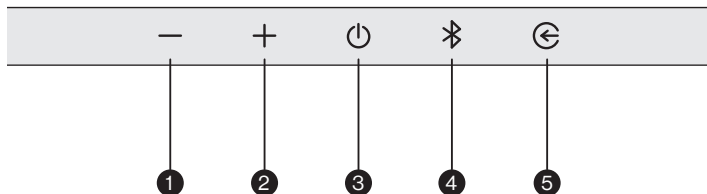





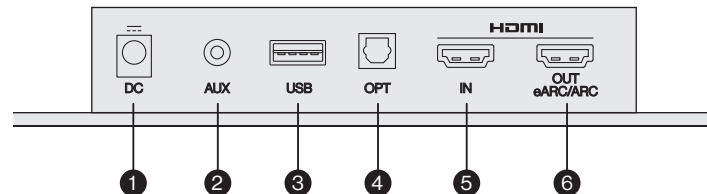

Manuel d'utilisation ×1

DISPOSITION DE L'APPAREIL



Touche tactile	
1	Diminution du volume  Régler le volume.
2	Augmentation du volume  Régler le volume.
3	Mise en veille  En mode veille, appuyez sur la touche de veille pour mettre le système de haut-parleurs sous tension.
4	Bluetooth  Passez à la source Bluetooth ou procédez à l'appariement Bluetooth.
5	Sélection de la source audio  Appuyez brièvement sur le bouton pour changer de source d'entrée audio. TV → HDMI → OPT → USB → BT → AUX



Port de connexion	
1	DC  Port d'alimentation CC
2	AUX  Entrée audio AUX
3	USB  Audio USB (L'utilisation de l'interface USB est limitée à la transmission de données)
4	OPT  Entrée audio OPT
5	HDMI IN  Connecter le HDMI à l'entrée
6	HDMI OUT (eARC/ARC)  Connecter le HDMI (eARC/ARC) du téléviseur à l'entrée

TÉLÉCOMMANDE

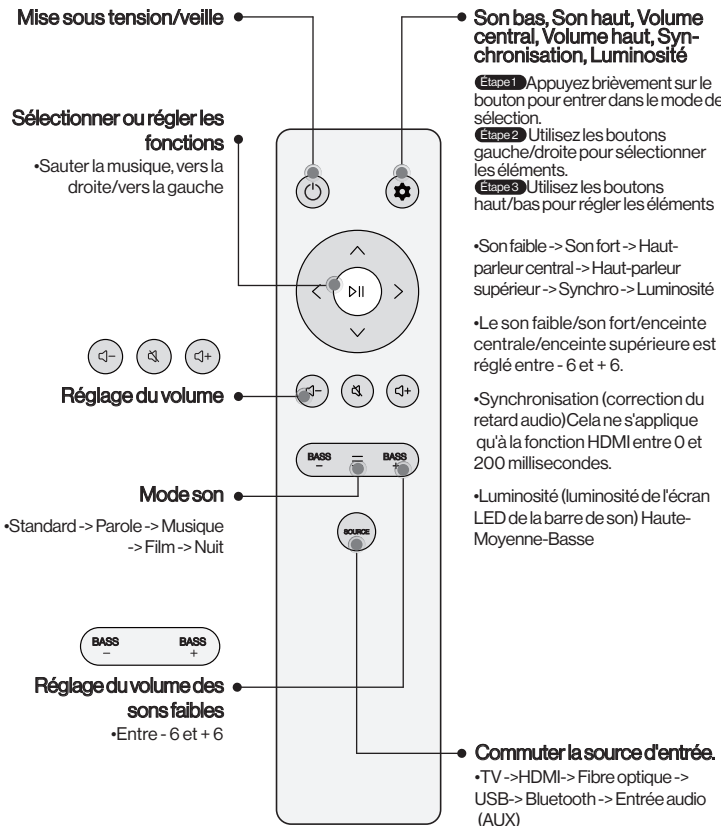

MODE D'EMPLOI

Connecter la station d'alimentation

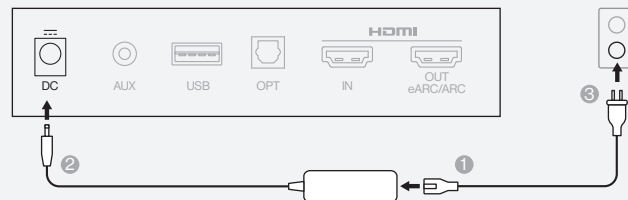

Opérations normales

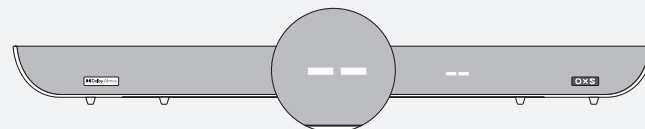

1 Après avoir connecté la station d'alimentation, l'appareil passe en mode veille.

Méthode A

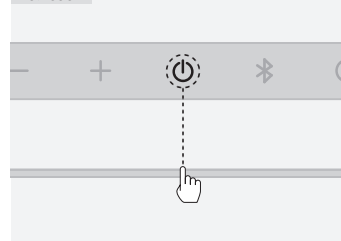

Méthode B

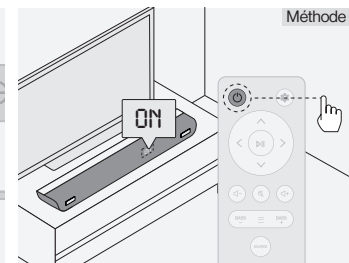

2 Appuyez brièvement sur le bouton pour mettre l'appareil en marche.

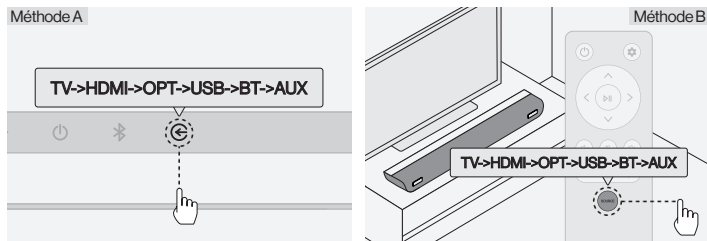

3 Sélectionnez la bonne source d'entrée.

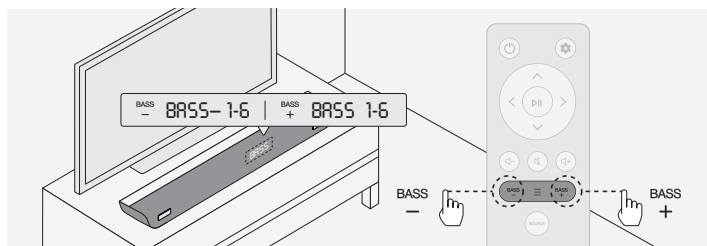

4 Réglez l'effet audio ou le niveau sonore.

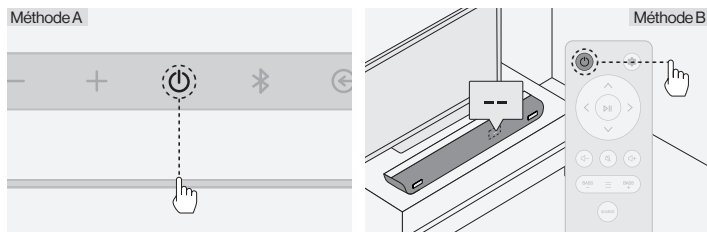

5 Appuyez brièvement sur la touche pour éteindre l'appareil.

Lorsque l'appareil est en mode AUX/OPT/TV/HDMI/BT, si aucun signal audio n'est émis dans les 15 minutes, l'électronique audio se met automatiquement en veille.

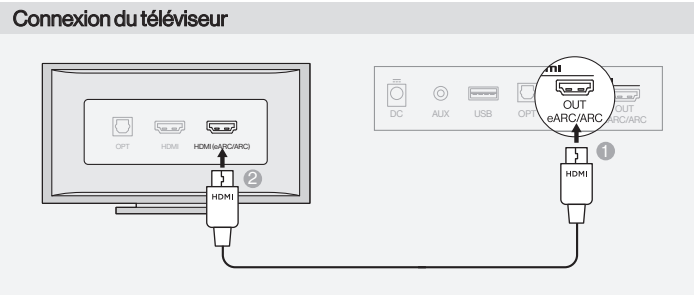

1 Connexion HDMI

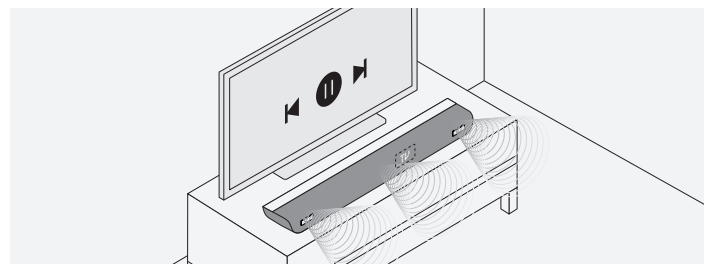
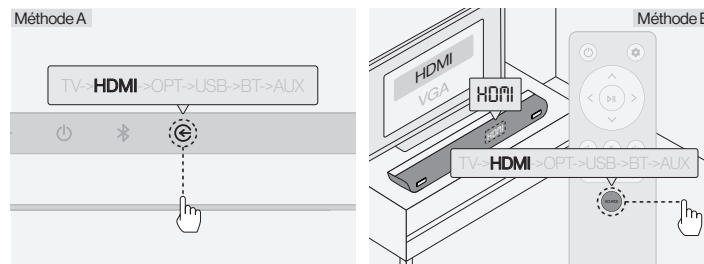

2 Sélectionnez le mode « TV ».

Utilisez le câble HDMI pour connecter l'appareil

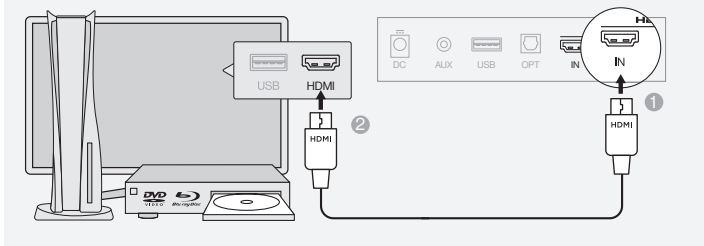

① Connectez via HDMI

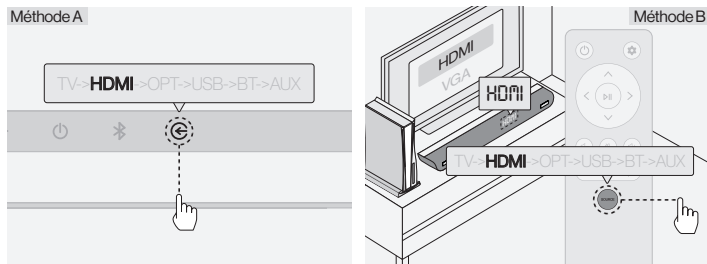

② Sélectionnez le mode « HDMI ».

Utilisez le câble OPT pour connecter l'appareil

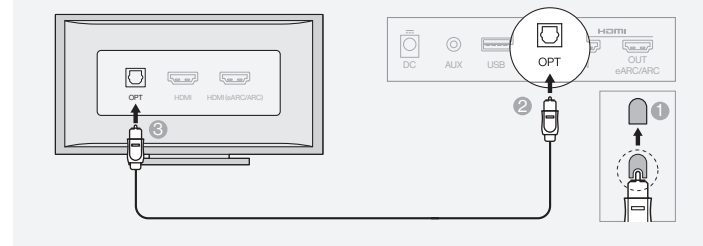

① Utilisez le câble à fibre optique pour connecter l'appareil et l'électronique audio.

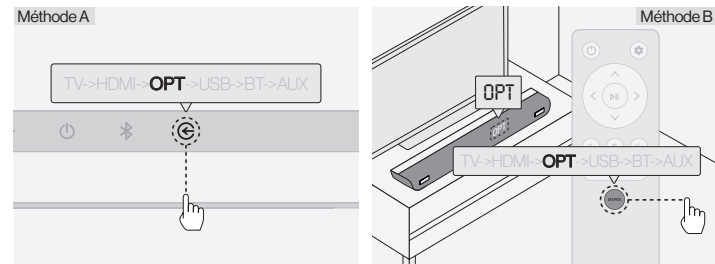

② Sélectionnez le mode « Fibre optique ».

Utilisez le câble AUX pour connecter l'appareil

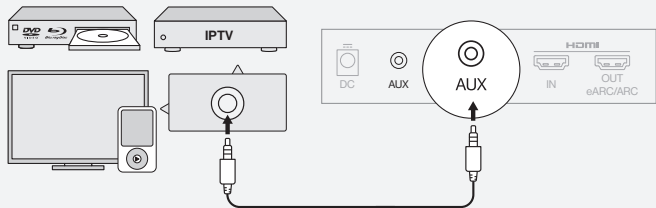

- 1 Raccordez l'appareil et l'électronique audio à l'aide du câble AUX.

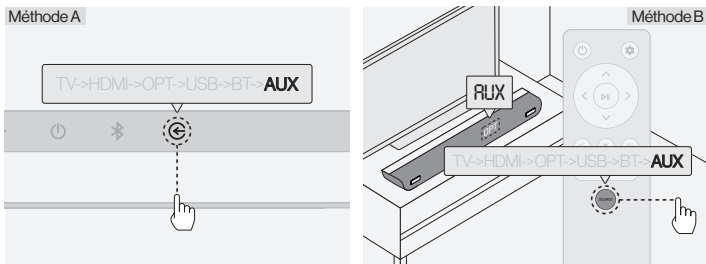

- 2 Sélectionnez le mode « AUX ».

Connectez le câble audio USB

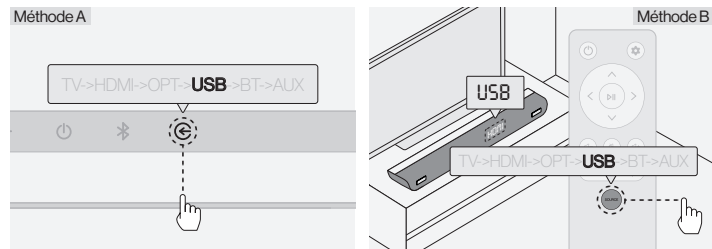

- 1 Sélectionnez le mode « USB ».

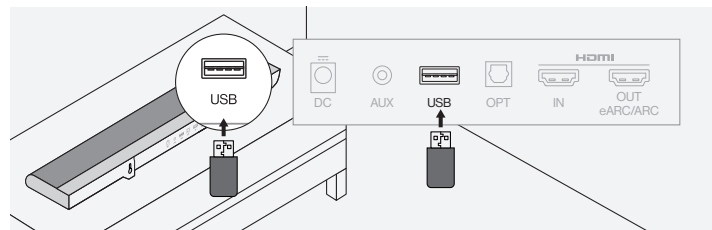

- 2 Connectez le lecteur USB à l'électronique audio.

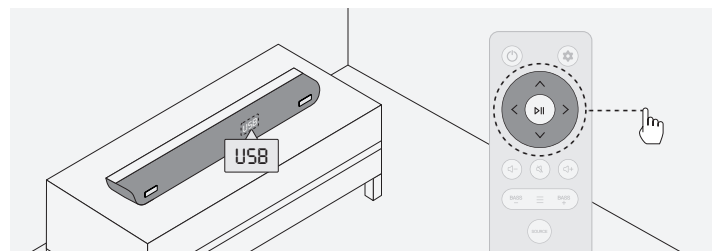

- 3 Contrôlez davantage de fonctions à l'aide de la télécommande.

Connectez le Bluetooth

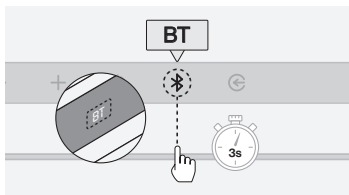

- 1 Passez en mode « BT » et appuyez longuement sur le bouton « » pendant 3 secondes pour entrer dans le mode d'appariement.

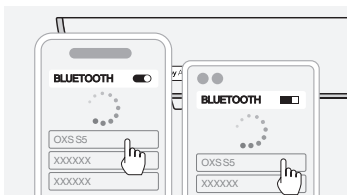

- 2 Sélectionnez le mode Bluetooth sur votre appareil. Sélectionnez « OXS S5 » sur l'écran de l'appareil.

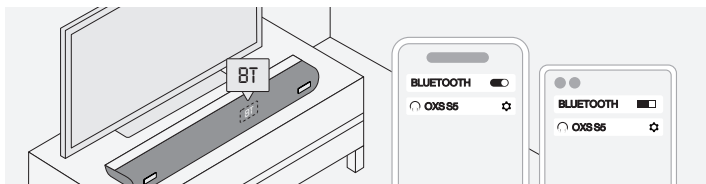

- 3 Une fois la connexion réussie, l'oyvant lumineux « BT » sur l'électronique audio reste stable.

GUIDE POUR LA FIXATION MURALE

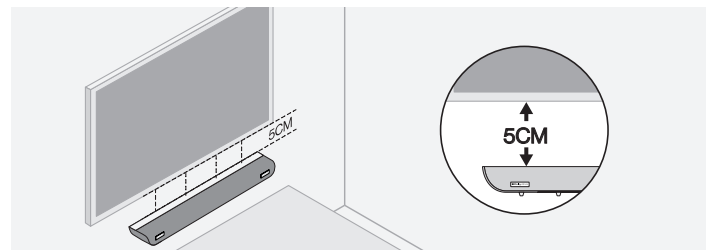

- 1 Si le téléviseur est accroché au mur, placez l'appareil électronique audio au moins 5 cm en dessous du téléviseur.

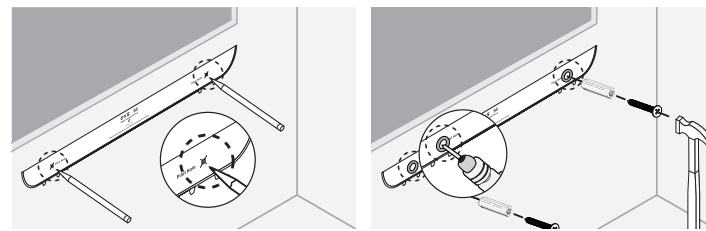

- 2 Utilisez le gabarit d'installation murale pour marquer l'emplacement des trous de forage.
- 3 Percez les trous, installez-les sur le mur et installez les vis d'expansion.

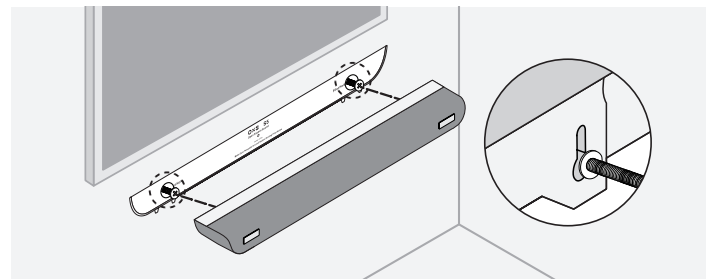

- 4 Fixez les composants électroniques audio sur les vis de suspension murale.

جول هذا الادليل

دليل اللمستخدم الابسيط هذا ودليل مستخدم مفصل وكامل. يمكنك تنزيله.
ينقسم دليل المستخدم إلى قسمين:

① دليل المستخدم

استخدم هذا الدليل لمعرفة طريقة تثبيت المنفذ والمكونات ووضع الاتصال.
ارجى

② الدليل الكامل

يمكنك الاطلاع على الدليل الكامل أو تنزيله من الموقع
يمكنك OXS (<http://www.oxsaudio.com/support>)

التصميم والمواصفات خاضعة للتغيير دون إشعار مسبق.

قائمة العناصر

AE -04

تصميم الجهاز

AE -05

التحكم عن بعد

AE -07

تعليمات الاستخدام

AE -08

1. قم بتوصيل إمدادات الطاقة

AE -08

2. العمل بالعدادية

AE -08

3. توصيل التلفاز — منفذ HDMIOUT (eARC/ARC)

AE -10

4. استخدم كابل HDMI للتوصيل بالجهاز — HDMIIN

AE -11

5. استخدم كابل OPT للتوصيل بالجهاز

AE -12

6. استخدم كابل AUX للتوصيل بالجهاز

AE -13

7. اتصال صوت USB

AE -14

8. اتصال البلوتوث

AE -15

توجيهات التعليق على الحائط

AE -16

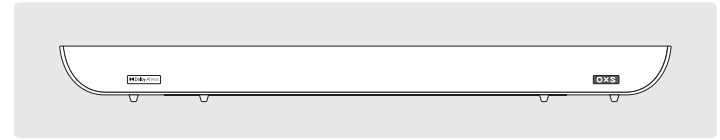

الالكترونيات الصوتية 1X

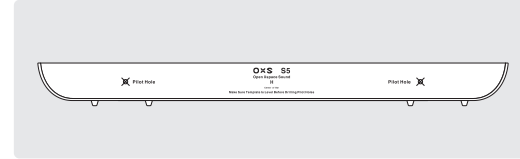

قالب التعليق على الحائط 1X



جهاز التحكم عن بعد 1X

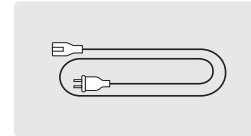

سلك الطاقة 1X

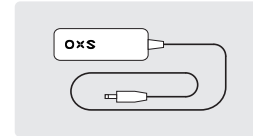

المحول 1X

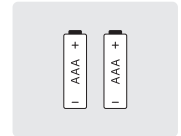

البطارية 2X

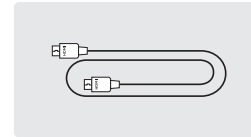

كابل HDMI 1X

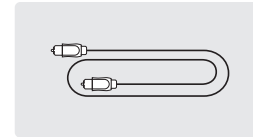

كابل OPT 1X

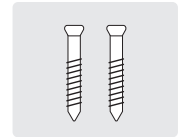

الحائط 2X
برغي التعليق على



الأمان والصفحة 1X



المواصفات الفنية 1X

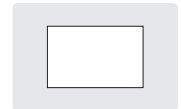

دليل المستخدم 1X

تصميم الجهاز

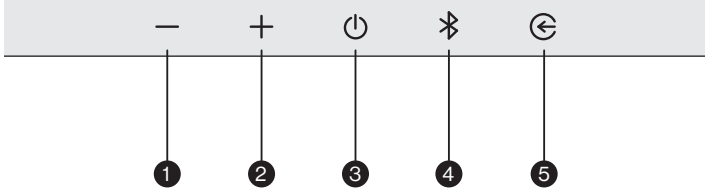

زر لمس		
1	خفض الصوت (-)	ضبط مستوى الصوت
2	رفع الصوت (+)	
3	الاستعداد (power icon)	زر الاستعداد لتشغيل نظام مكبرات الصوت في وضع الاستعداد، اضغط على
4	بلوتوث (Bluetooth icon)	البلوتوث أو قم بإجراء اقتران البلوتوث قم بالتبديل إلى مصدر
5	الصوت الاختيار مصدر (source icon)	الصوت بالضغط لفترة وجيزة على المفتاح قم بتبديل مدخل TV <- HDMI <- OPT <- USB <- BT <- AUX

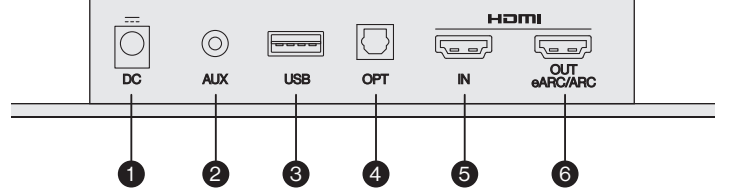

منفذ الاتصال		
1	DC	منفذ طاقة تيار مباشر
2	AUX	مدخل صوت AUX
3	USB	صوت USB (تستخدم واجهة USB لنقل البيانات فقط)
4	OPT	مدخل صوت OPT
5	HDMI IN	اتصال HDMI بالمدخل
6	HDMI OUT (eARC/ARC)	اتصال HDMI (eARC/ARC) لتل فاز بالمدخل

تعليمات الاستخدام

قم بتوصيل إمدادات الطاقة

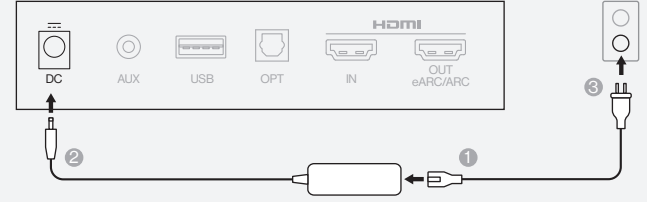

العملیات الاعیادیة

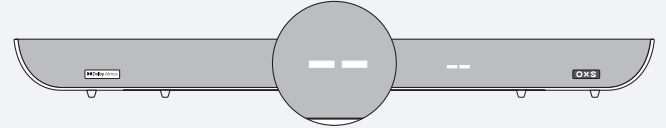

1 بعد توصيل إمدادات الطاقة، يدخل الجهاز في وضع الاستعداد

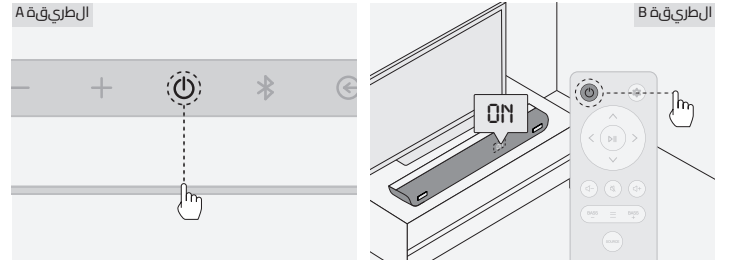

2 اضغط لفترة وجيزة على المفاتيح للتشغيل

التحكم عن بعد

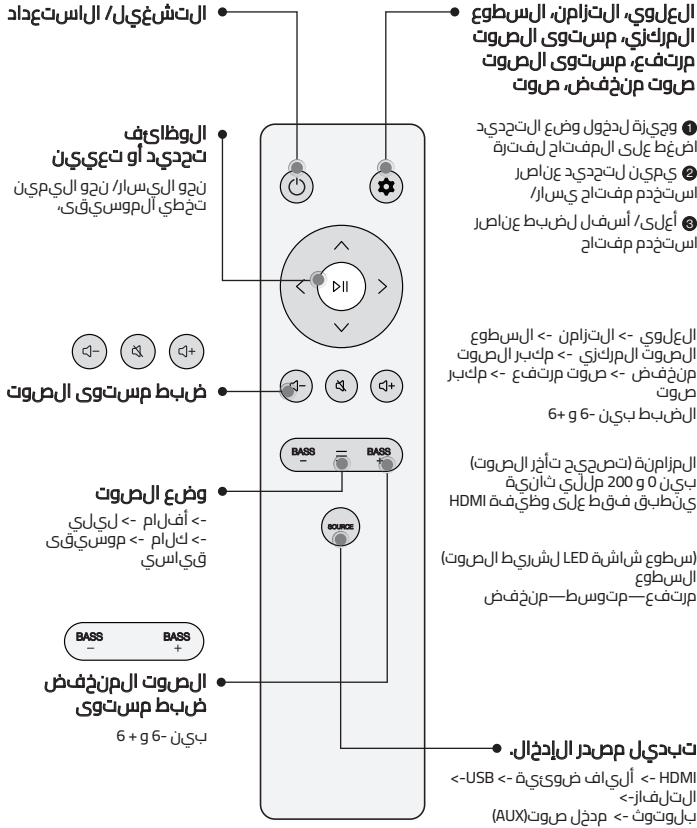

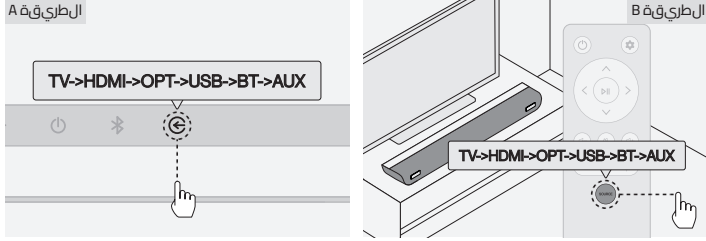

3 تبديل مصدر الإدخال إلى أي من

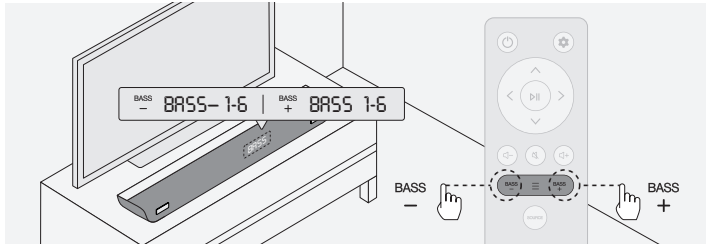

4 ضبط تأثير الصوت أو مستوى الصوت المنخفض

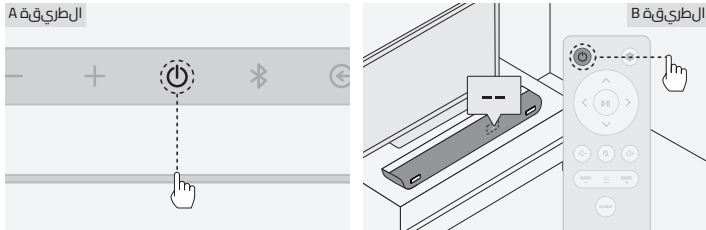

إشارة صوت خلال 15 دقيقة، ستدخل إلى حالة الاستعداد تلقائياً. إذا لم يكن هناك أي وضع AUX/OPT/TV/HDMI/BT.

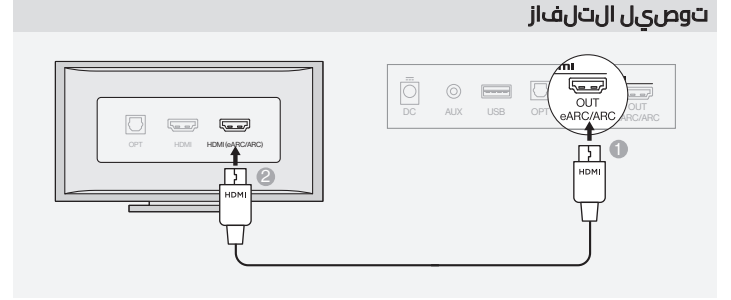

1 الاتصال عبر HDMI

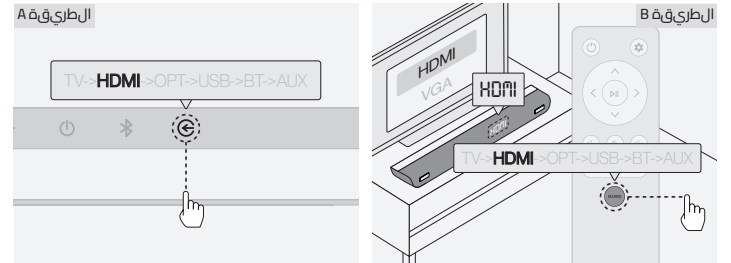

2 حدد وضع "التلفاز"

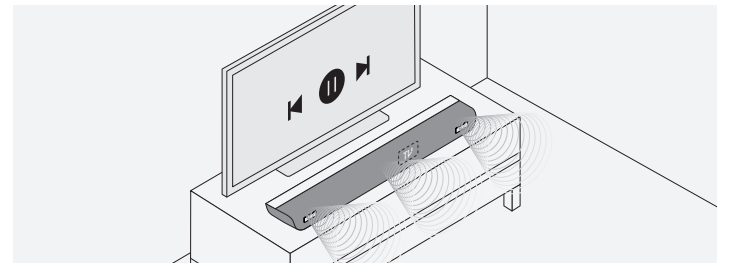

استخدم كابل HDMI للاتصال بالاجهاز

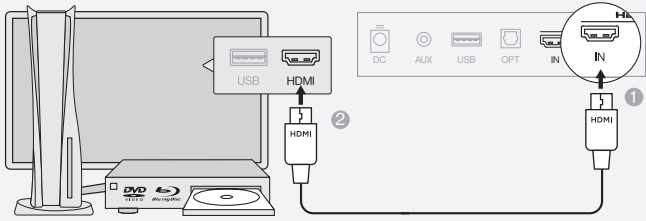

1 الاتصال عبر HDMI

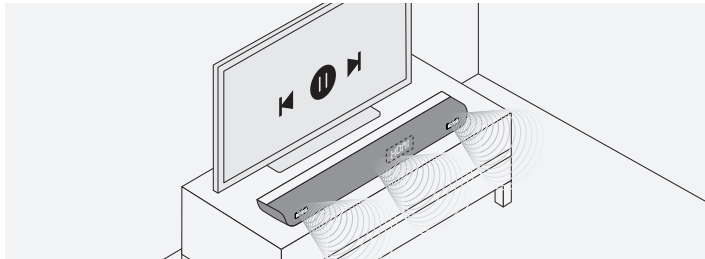
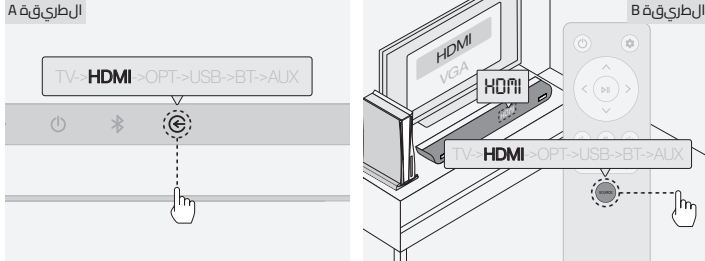

2 حدد وضع "HDMI"

استخدم كابل OPT للاتصال بالاجهاز

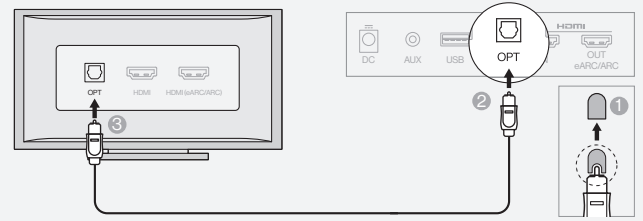

1 استخدم كابل الالبياف الضوئية لتوصيل الاجهاز والالكترونيات الصوتية

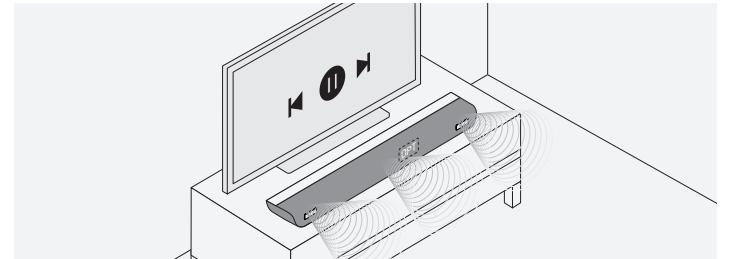
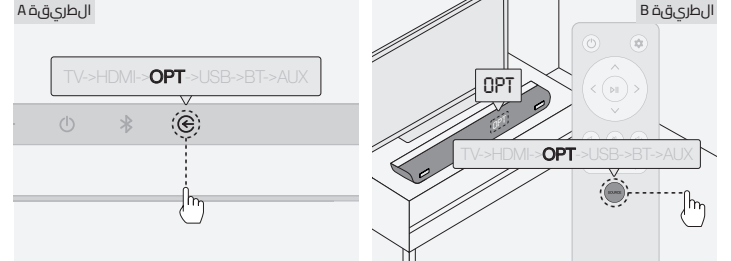

2 حدد وضع "الالبياف الضوئية"

استخدم كابل AUX للاتصال بالاجهزة

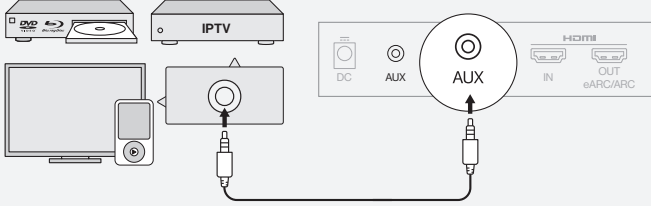

1 استخدم كابل AUX لتوصيل الاجهزة والالكترونيات الصوتية

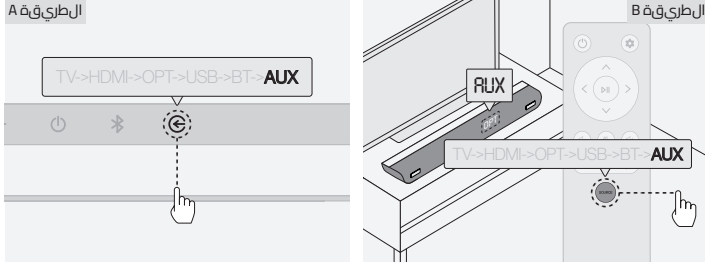

2 حدد وضع "AUX"

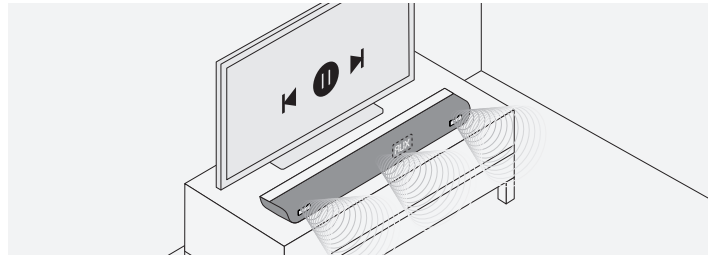

اتصال صوت USB

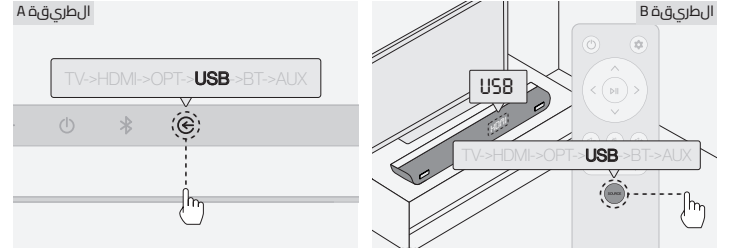

1 حدد وضع "USB"

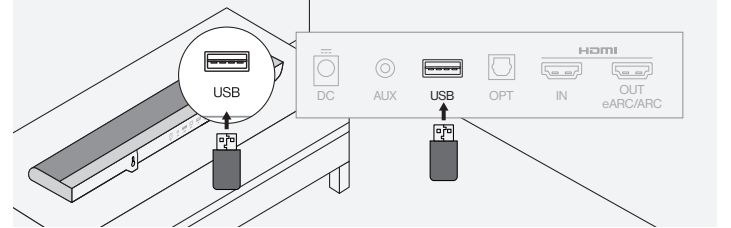

2 قم بتوصيل محرك قرص USB بالاجهزة الالكترونيات الصوتية

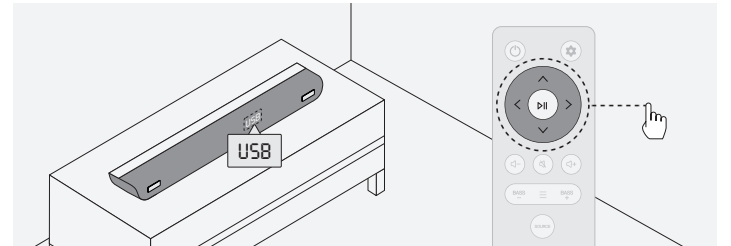

3 التحكم بالاجهزة من الواجهة بواسطة جهاز التحكم عن بعد

توجيهات التعلیق على الحائط

اتصال الابل وتوتوث

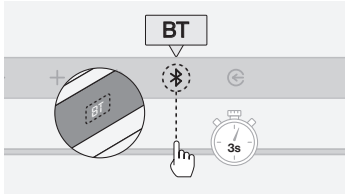

1 زر "⌘" لمدة 3 ثوان لدخول وضع الاقتران إلى وضع "بلوتوث"، واضغط مطولاً على التبدیل

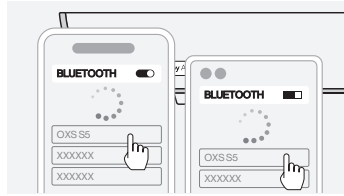

2 دد "OXS S5" على شاشة الجهاز حدد وضع الابل وتوتوث على جهازك

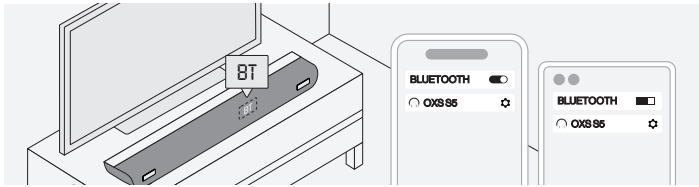

3 بعد الاتصال بنجاح، سيبقى مؤشر "بلوتوث" على الابل كترونيات الصوتية ثابتا

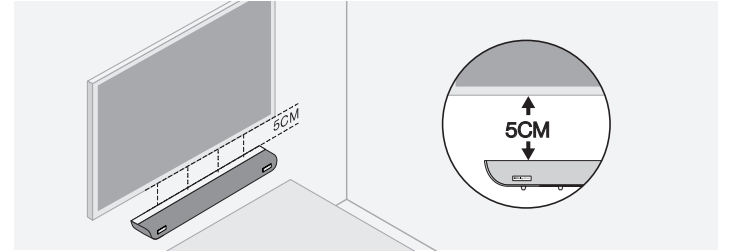

1 ضع الابل كترونيات الصوتية على بعد 5 سم على الأقل، أسفل التلفاز إذا كان جهاز التلفاز معرّقا على الحائط.

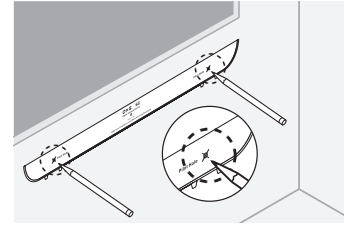

2 الحائط لتحديد مواقع ثقوب الحفر استخدم قائل التثبيت على

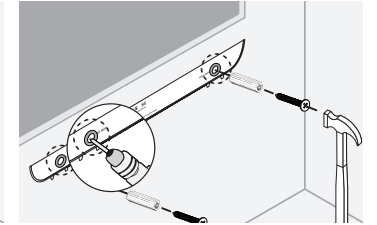

3 ثم بمتثبيت براغي التوسيع المثقوب، وقيم بالتثبيت على الحدار، قم بحفر

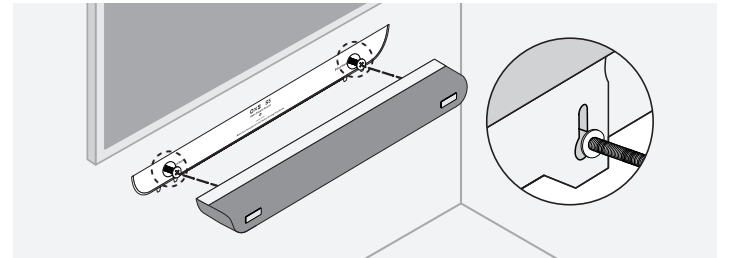

4 قم بتعلیق الابل كترونيات الصوتية على براغي التعلیق على الحدار