

PRODUCT MANUAL



ATTENTION! PLEASE READ THESE INSTRUCTIONS BEFORE USING THIS DEVICE

PRODUCT MANUAL



NOTICE:

If your package is missing parts or you are having issues with install, please call us directly or message us. Our customer service team will address any questions or concerns you may have. Have this manual open and ready for reference.

SAFETY



To reduce risk of injury when installing & using the chair, follow these precautions:

- Read all of these instructions before installing and using your salon chair.
- It is helpful to have 2 people install and turn the chair upright after installing.
- **Do not over-extend the chair, creating the risk of falls or tipping the chair, and its occupant over, resulting in injury**

PARTS & FEATURES

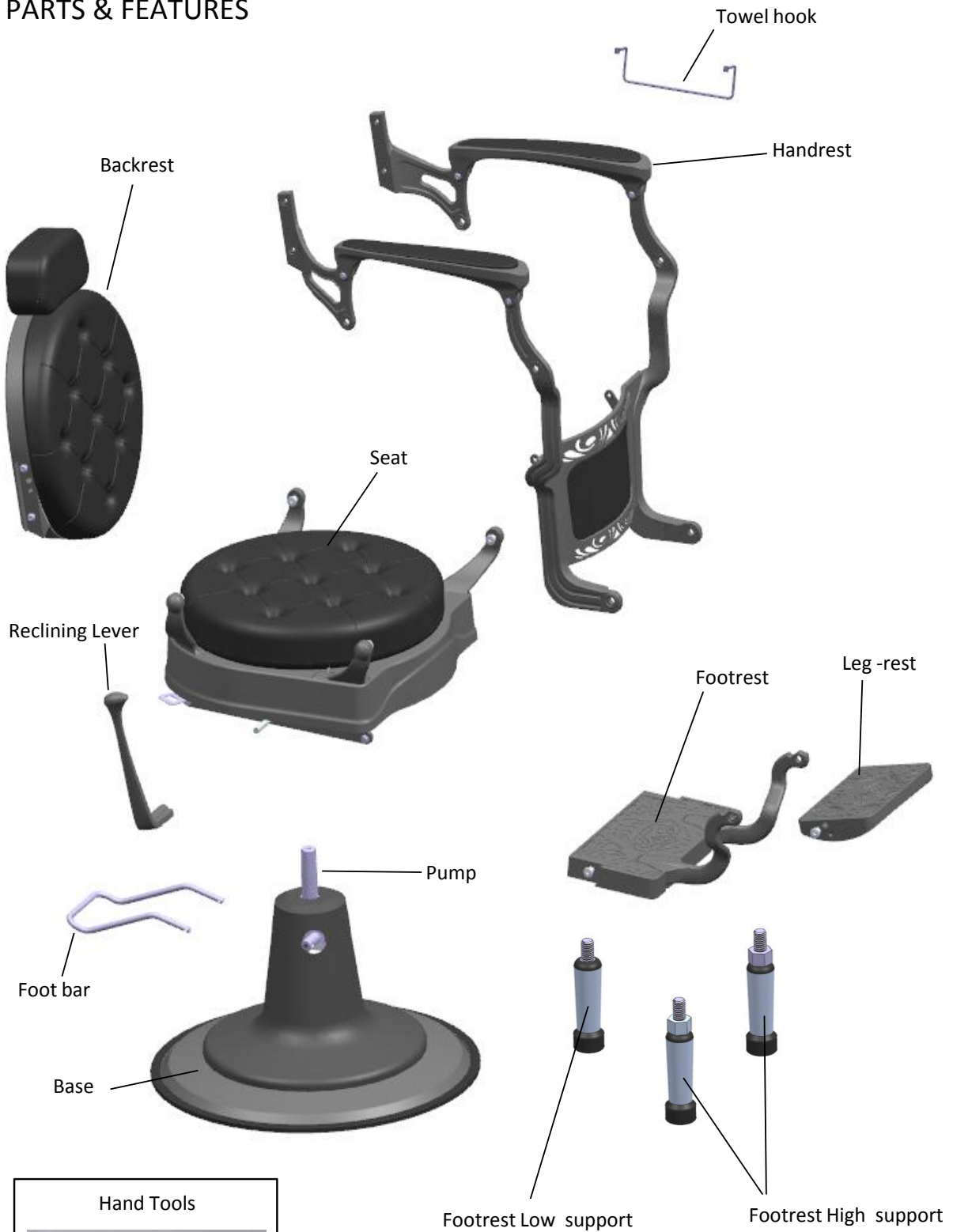

INSTALLATION INSTRUCTION

First: Install foot bar to the pump

Step 1: Place Base & Pump on floor.
Use Allen Wrench to loosen the screws in the crossbar.
See photo besides.
Insert Foot Bar into the holes of the crossbar.
(May require slightly squeezing ends of Foot Bar towards each other, and some maneuvering for the bar ends to go into place.)
Step 2. Tighten the 2 set screws to firmly hold the Foot Bar in place.

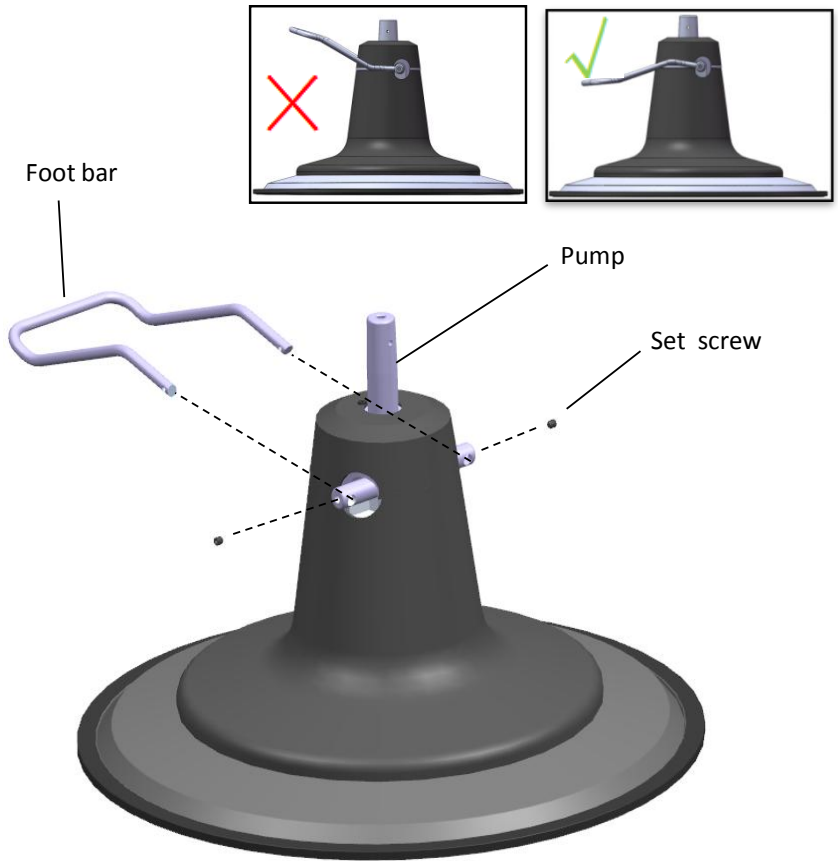

Second : Set the Seat onto the top of Pump

Step 1. Locate the slot in the short column under the Seat. Align this slot with the black pin at the top of pump and press seat down to set Seat onto top of pump .

Please follow up the diagram beside

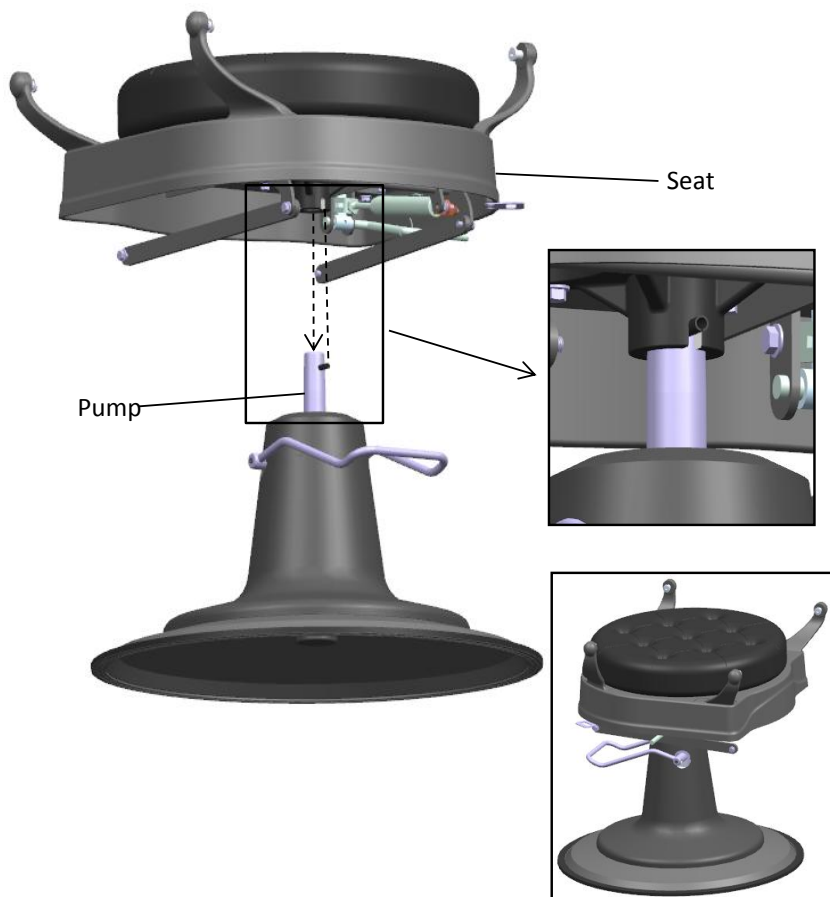

Third : Install handrest to the seat

Step 1.Remove the 4 big bolts and 2 small bolts which Pre-fixed in seat.
Step 2.Install handrest to the seat by 4 big bolts and 2 small bolts which removed from seat .

Please follow up the diagram beside

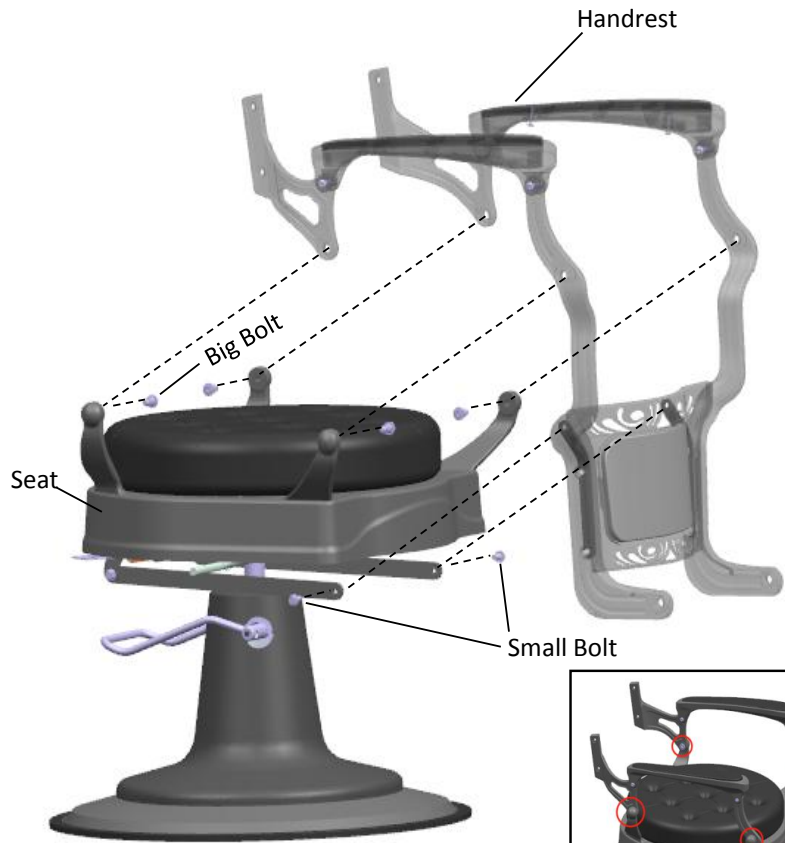

The circles is the conncting position of big bolt or small bolt



Fourth : Install Leg-rest to the foot-rest

Step 1:Remove 2 big bolts which pre-fixed in the leg-rest then install the leg-rest to the foot-rest by 2 big bolts which removed from the leg-rest.

Please follow up the diagram beside

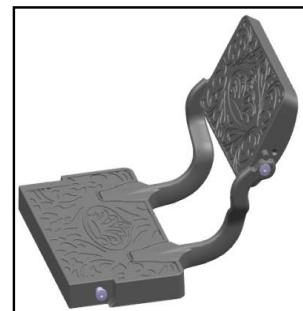
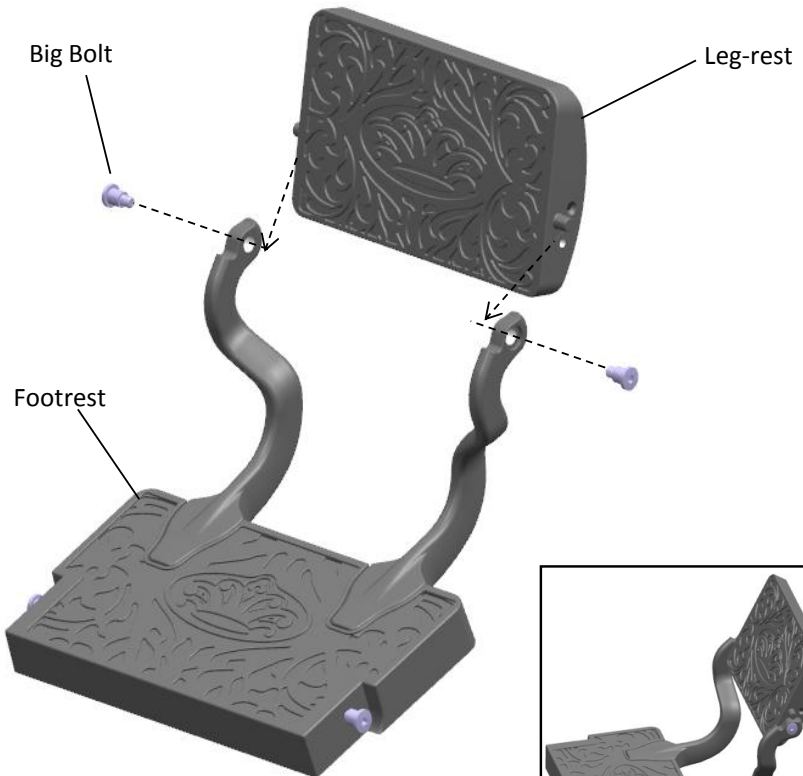

Fifth : Install Footrest low support and Footrest high supports to foot-rest

1. Step 1: Install 1 Footrest low support and 2 Footrest high supports to the bottom of foot-rest.
Please follow up the diagram beside

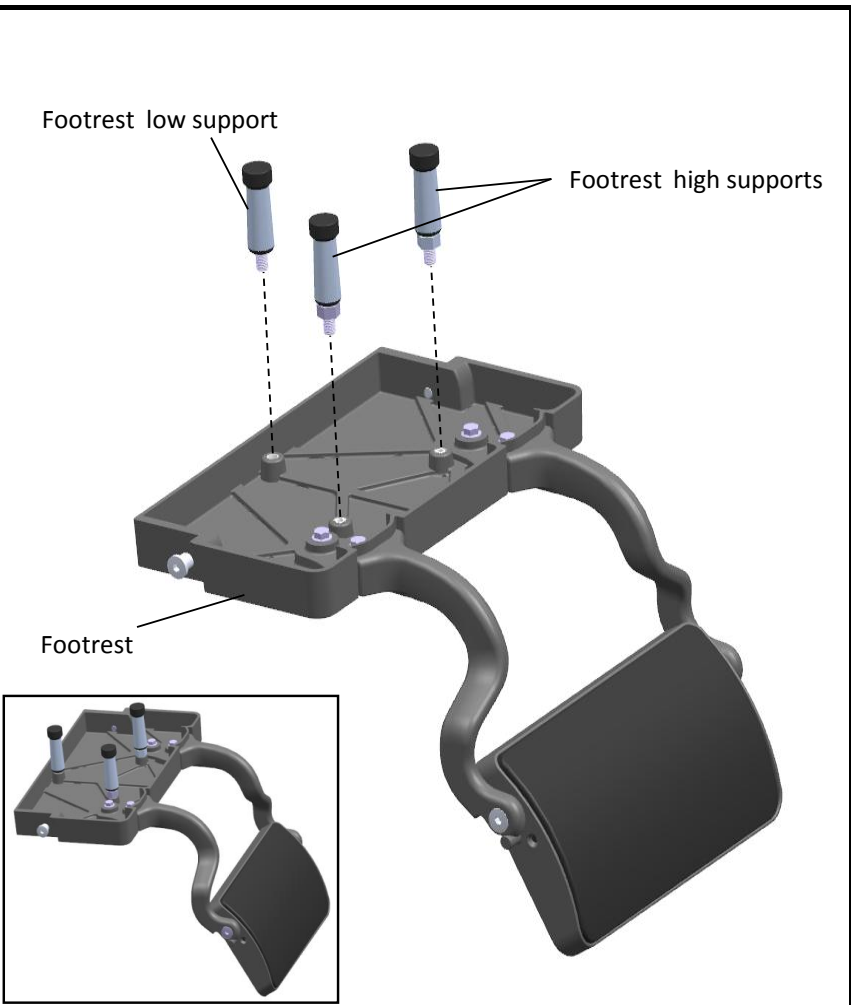

Sixth : Install foot-rest to the chair

Step 1. Removed 2 big bolts which pre-fixed in the foot-rest.

Step 2. Install foot-rest to chair by the big bolts which removed from the foot-rest.

Please follow up the diagram beside

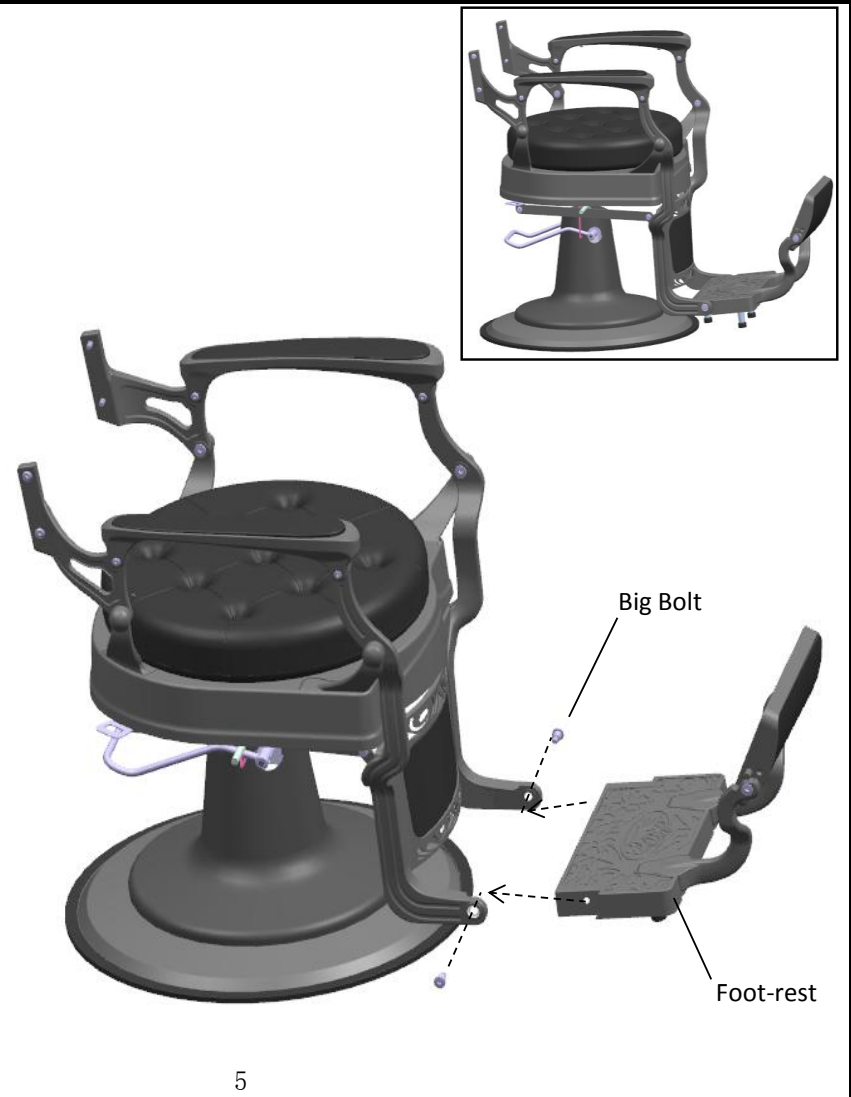

Sevnth : Install back-rest to chair

Step 1. Removed 4 bolts which pre-fixed in the Back-rest.

Step 2. Install Back-rest to chair by 4 bolts which removed from the Back-rest.

Please follow up the diagram beside

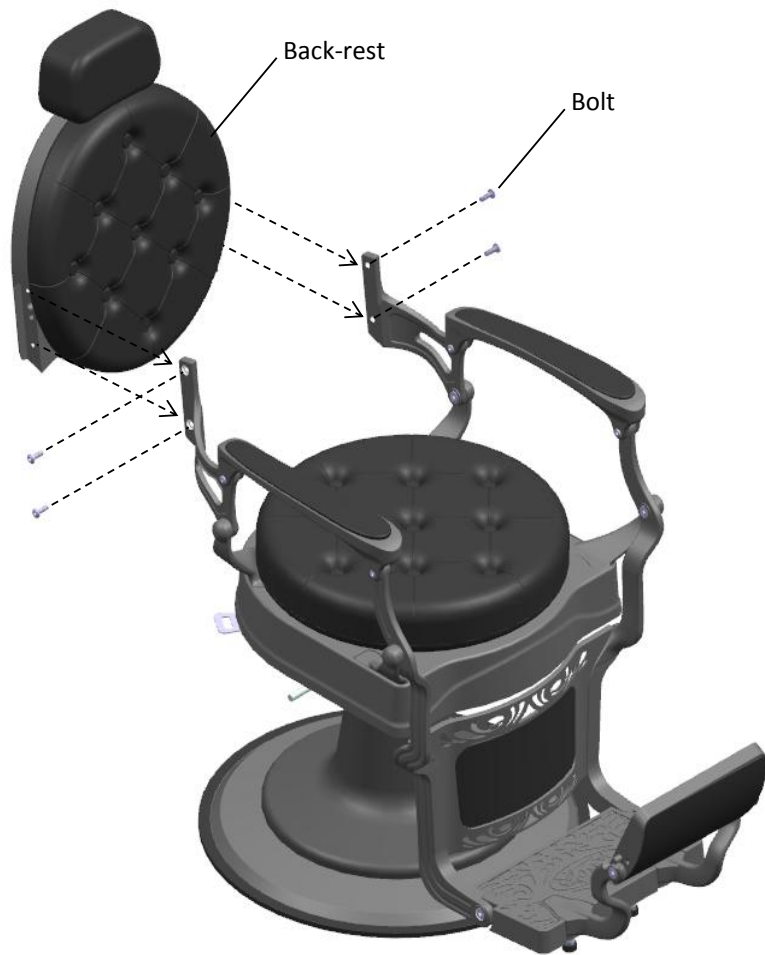

Eighth : Install Reclining Lever to chair

Step 1. Loosen the bolts which pre-fixed in the bottom of Reclining Lever .

Step 2. Set Reclining Lever on to the bent iron bar of chair .

Step 3. tighten the bolt which pre-fixed in the bottom of Reclining Lever .

Please follow up the diagram beside



Ninth : Install Towel hook to hand-rest

Step 1. Removed 2 bolts which pre-fixed in the hand-rest .
Step 2. Install the Towel hook to hand-rest by 2 bolts which removed from hand-rest .

Please follow up the diagram beside

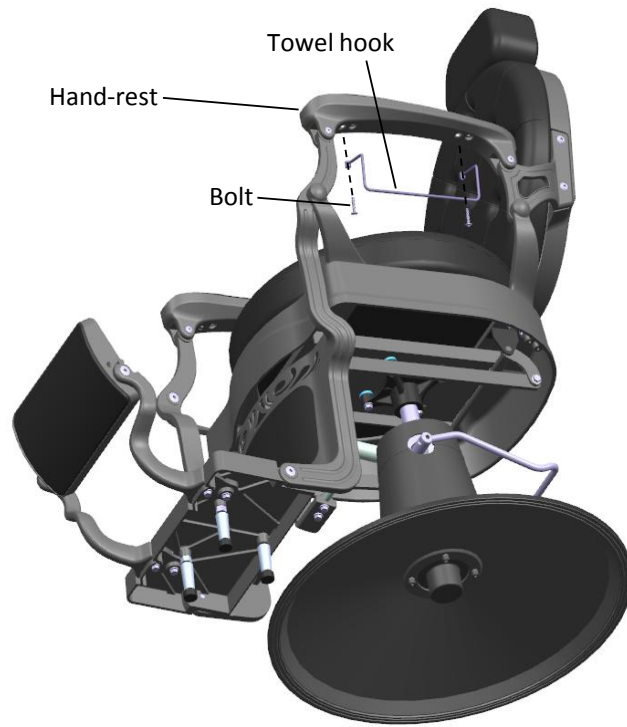

OPERATING THE CHAIR

First :

1. In the natural state, the upper part of the pump can rotate freely on the rotation axis of the pump;
2. Elevate the foot bar to lock the rotating .



Second : Raising the Chair

- Step down on the Foot Bar repeatedly to raise the chair to the desired height.
- Do not over-extend the chair, creating the risk of falls or tipping the chair and its occupant over, resulting in injury



Third: Lowering the Chair

- Step down and hold the Foot Bar to allow chair to lower.



Foruth : Recline the Backrest

- Push the lever backwards ($35^{\circ}\sim 40^{\circ}$) and push the backrest to back . The backrest will tilt backwards;loosen the lever to get the tilt degree of backrest ;Turn the lever again backwards ($35^{\circ}\sim 40^{\circ}$) ,the backrest can Back to the original position.Don't push lever too hard. It 'll break lever.



Fifth :

- You can adjust the height of the headrest by pressing the button on the backrest

