

LAZY JACK BOOM BAG MEASUREMENT FORM

We require the following information and measurements to enable us to ensure a perfect fit for your new sail cover. It is advisable to use a long fiberglass tape.

CUSTOMER NAME:

BOAT TYPE/MODEL:

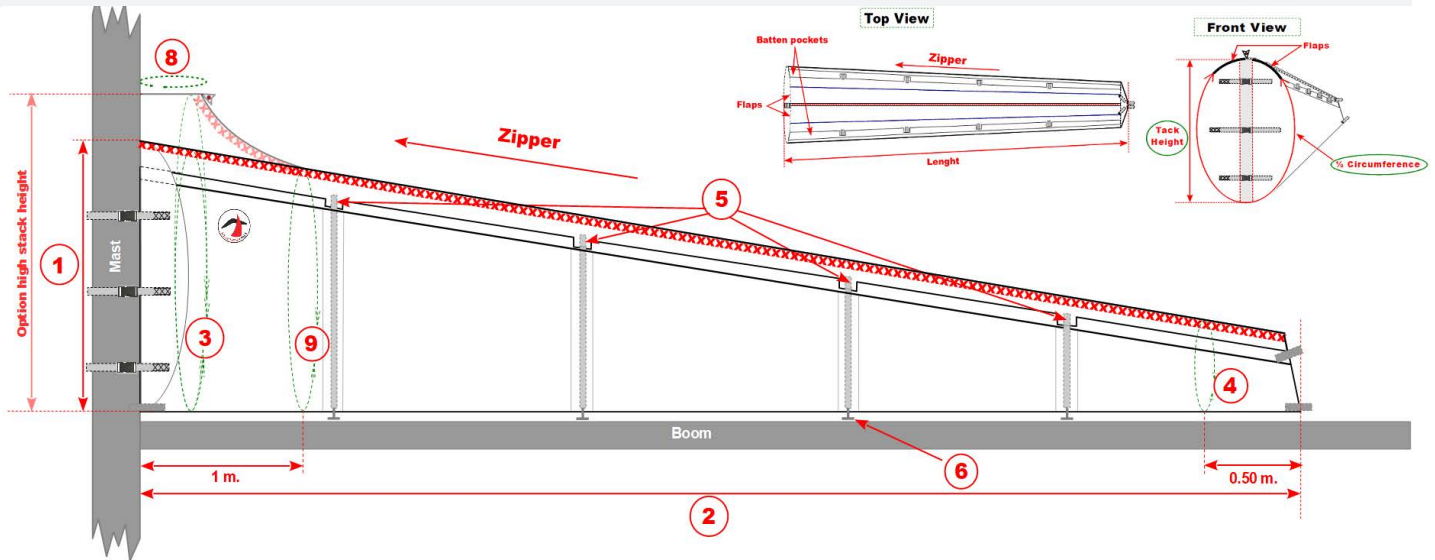

MEASURE YOUR EXISTING SAIL ON THE BOOM

- | | | | |
|---|------------------------|--|------------------------|
| <p>1. Stack Height: Measure from the top of the mainsail headboard in the stowage position to the top of the boom.</p> | <input type="text"/> m | <p>5. Number of Lazy Jack Attachment Points: Refers to the number of lazy jack rope attachment - Standard is 4 for all our bags for boats above 28ft and 3 for boats under 28ft</p> | <input type="text"/> |
| <p>2. Length of Bag: Measurement from the aft side of the mast to the 50-100mm past the clew of the mainsail</p> | <input type="text"/> m | <p>6. Foot Slide Type: Please specify slide style No.1, No.2 or No.3 style (or if you don't have a boom track please provide boom circumference and we will fit velcrow straps)</p> | <input type="text"/> |
| <p>3. Circumference Behind the Mast: Circumference of the mainsail approximately 100mm behind the mast.
(Measurement is usually 2.2 to 2.3 x stack height - for example a bag with a stack height of 1000mm would have a measurement 3 of 2200-2300mm)</p> | <input type="text"/> m | <p>7. Colour: All our covers are built from 9oz Sunbrella Marine Fabric. Please select from one of the colours on the reverse side of this form or from the sunbrella colour chart.</p> | <input type="text"/> |
| <p>4. Circumference 500mm forward of bag end: Circumference of the mainsail approximately 500mm forward of the back end of the cover.
(Measurement is usually 18 to 20% of the total length of the bag - for example a 4000mm bag would have a measurement 3 of 720-800mm)</p> | <input type="text"/> m | <p>Option high stack height</p> | |
| | | <p>8. Circumference around headboard</p> | <input type="text"/> m |
| | | <p>9. Circumference at 1 m from front of bag</p> | <input type="text"/> m |

LAZY JACK BOOM BAG MEASUREMENT FORM

NO.1

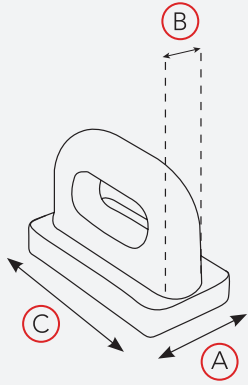

NO.2

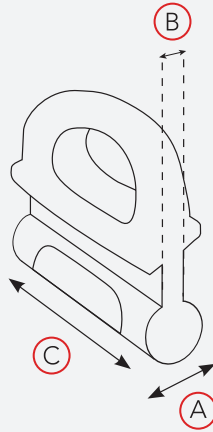

NO.3

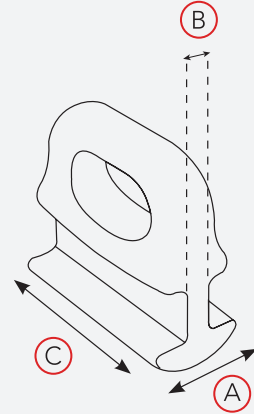

FOOT SLIDE

Existing foot slides: Part number or circle style number above

Measurements of existing foot slide

(A) Width

(B) Neck

(C) Length

COLOUR (please circle)

Pacific Blue, Ocean Blue, Marine Blue, Navy, Cream, Cadet Grey, Charcoal Grey, Silver, Black, Orange, Sunflower Yellow, Jockey Red

* Check with your local sail maker for a larger range of colours and availability