

Miniature high frequency split core Current Transformer
OPCT16AL 100a/100ma 50a/25ma 100A/50mA 100a/20ma
100a/25ma mini ct clamp



**Official
Authentic**

Ratio: 1000/1 2000/1

3000/1 4000/1 5000/1



New upgraded version of open-type current

Combining advanced industrial level design, casting fine products transformer



Choose High-quality materials



safe and stable



Thick wire



Easy to use

Multi-field **application** of current transformer

IT'S SUMMER, YOU AT EASE

EASILY MATCH AC POINTER AMMETERS , 1.5 (6) A, 2.5 (5) A, 3 (6) A SINGLE-PHASE,
THREE-PHASE ELECTRIC ENERGY METER



Car charging
pile



Household electric
meter



Power grid
transformation



5G base station
monitors

Product parameters

PRODUCT PARAMETERS

OPCT16AL Split Core Current Transformer

Flame retardant properties : UL94-V0

Insulation resistance : Normal than 1000M Ω

Work voltage : 0.66/0.72KV

Compressive strength : 2KV/50Hz/1min

Work frequency : 50Hz~200KHz

Operating temperature : -40°C~+85°C

Used for : Power project renovation, Power monitoring, Load current detection

Installation method : Busbar perforation, secondary lead output, fixed with cable ties on both sides

Dimension (in/mm) :

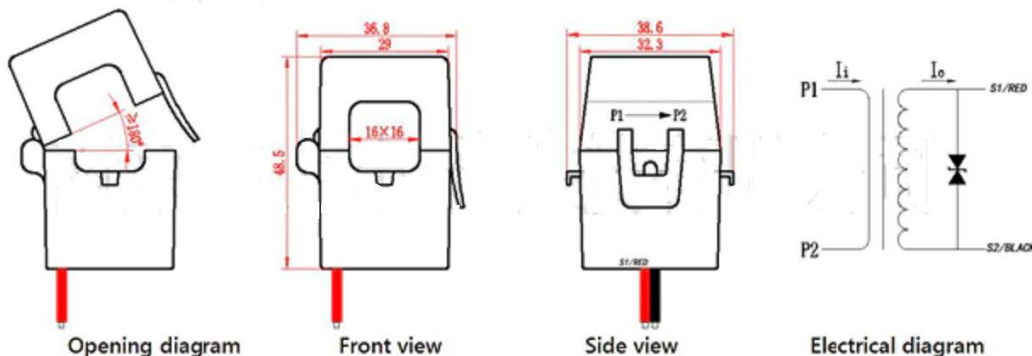

Technical Data :

	OPCT16AL (1000/1)	OPCT16AL (2000/1)	OPCT16AL (3000/1)	OPCT16AL (4000/1)	OPCT16AL (5000/1)	Unit
Rated input	100	100	150	100	100	A (AC)
Rated output	100	50	50	25	20	mA (AC)
Rated sampling load	20	100	75	300	400	Ω
Rated sampling voltage	2	5	3.75	7.5	8	V (AC)
Turns ratio	1000/1	2000/1	3000/1	4000/1	5000/1	—
Phase shift	≤ 60 (100A, 0 Ω)	≤ 45 (100A, 0 Ω)	≤ 45 (150A, 0 Ω)	≤ 45 (100A, 0 Ω)	≤ 45 (100A, 0 Ω)	'
Accuracy error	0.5	0.5	0.5	0.5	0.5	%
Linearity	0.3	0.3	0.3	0.3	0.3	%
Measuring current	0~100A (RL $\leq 20\Omega$)	0~100A (RL $\leq 100\Omega$)	0~150A (RL $\leq 75\Omega$)	0~150A (RL $\leq 50\Omega$)	0~150A (RL $\leq 50\Omega$)	A (AC)
Maximum current	0~120A (RL $\leq 10\Omega$)	0~200A (RL $\leq 10\Omega$)	0~190A (RL $\leq 10\Omega$)	0~180A (RL $\leq 10\Omega$)	0~160A (RL $\leq 10\Omega$)	A (AC)
DCR	41 \pm 5	125 \pm 15	293 \pm 30	565 \pm 50	860 \pm 80	Ω
Weight	82.1	89.2	87.8	87	87.4	g
Output line length	1000	1000	1000	1000	1000	mm

Note : Current transformers are prohibited to be used in open circuit,also can't be connected to fuse.

Please connect the output of the transformer first,and then clamp the transformer on the bus under test.

SIX ADVANTAGES HARD CORE QUALITY

SHOW OUR ADVANTAGES THROUGH A COMPREHENSIVE COMPARISON OF MATERIALS
AND PERFORMANCE

//////////////////// **1** //////////////////////

CORE COMPARISON

CORE CONTRAST



OUR PRODUCTS

A MIRROR POLISHING PROCESS IS ADDED TO THE MAGNETIC CORE CLOSURE TO MAKE THE MAGNETIC CORE FIT TIGHTLY, EFFECTIVELY REDUCE LOSSES, AND IMPROVE PRODUCT PERFORMANCE.



OTHER PRODUCTS

ORDINARY FERRITE CORE, THERE IS NO MIRROR POLISHING AT THE CORE CLOSURE. THE LOSS IS RELATIVELY LARGE, AS A RESULT, THE ACCURACY ERROR OF THE PRODUCT IS LARGE, THE ANGULAR DIFFERENCE IS HIGH, AND THE CONSISTENCY IS POOR. AFFECT CUSTOMER USE.

SHRAPNEL COMPARISON

SHRAPNEL CONTRAST

KNOWLEDGE ENCYCLOPEDIA:

OPEN TRANSFORMERS DUE TO IMPERFECTIONS IN THE IRON CORE, THEREFORE, THE DEGREE OF CLOSURE OF THE IRON CORE CONTACT SURFACE IN THE PRODUCTION OF TRANSFORMERS DIRECTLY AFFECTS THE PERFORMANCE OF THE PRODUCT.



✓ 301 STAINLESS STEEL SHRAPNEL

OUR PRODUCTS

USING 301 STAINLESS STEEL SPRING PLATE, NOT EASY TO RUST, AND HAS EXCELLENT MECHANICAL PROPERTIES, ANTI-BALLISTIC PERFORMANCE, FATIGUE PERFORMANCE, HARDENABILITY, PHYSICAL AND CHEMICAL PROPERTIES, CAN PROVIDE LONG-LASTING ELASTIC

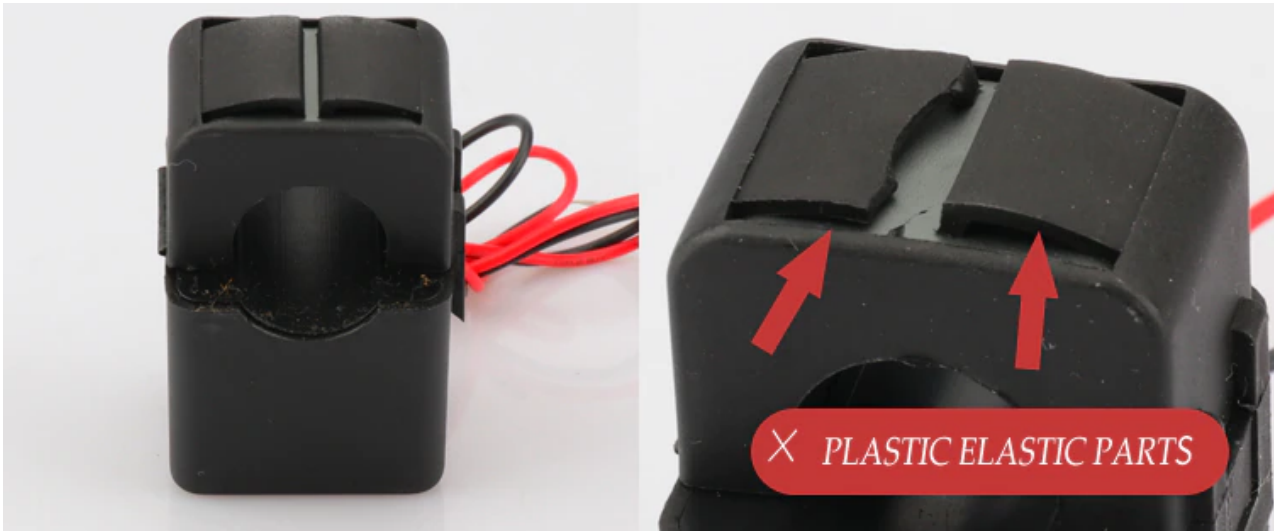

↑
OTHER PRODUCTS

USE ONE-PIECE INJECTION-MOLDED SHELL TO PROVIDE ELASTICITY. THE ELASTICITY IS WEAK AND NOT DURABLE. AND PLASTIC IS EASY TO AGE AND BREAK EASILY.



OUTPUT LEAD COMPARISON

OUTPUT LEAD COMPARISON



ANAEROBIC FINE COPPER

↑
OUR PRODUCTS

*OUTPUT LEAD 2 * 0.35 SQUARE RED AND BLACK PARALLEL LINE,
LOW-RESISTANCE, HIGH-PRECISION OXYGEN-FREE COPPER, PC
PVC FLAME RETARDANT MATERIAL WITH CLEAR LOGO
PRINTED ON THE LINE*



FEW ALUMINUM WIRES



TWO NON-STANDARD ALUMINUM CORE WIRES, USING OPTICAL FIBER RECYCLED PLASTIC IS EASY TO AGE WITHOUT TOUGHNESS, THE ONLINE LOGO IS UNCLEAR OR UNMARKED.



SHELL COMPARISON

SHELL CONTRAST



THE SHELL IS MADE OF HIGH-QUALITY PC ABS ALLOY, WITH A TEMPERATURE RESISTANCE OF $-40 \sim +85$ °C. HIGH TENSILE AND COMPRESSIVE STRENGTH, DURABLE ROTATING STRUCTURE.



↑
OTHER PRODUCTS

THE SHELL USES RECYCLED PLASTIC, WHICH IS EASY TO AGE WITHOUT TOUGHNESS, LOW TENSILE AND COMPRESSIVE STRENGTH, UNRELIABLE LINKS, AND EASY TO BREAK AFTER REPEATED OPENING AND CLOSING.



COMPARISON OF OUTPUT METHODS

OUTPUT MODE COMPARISON

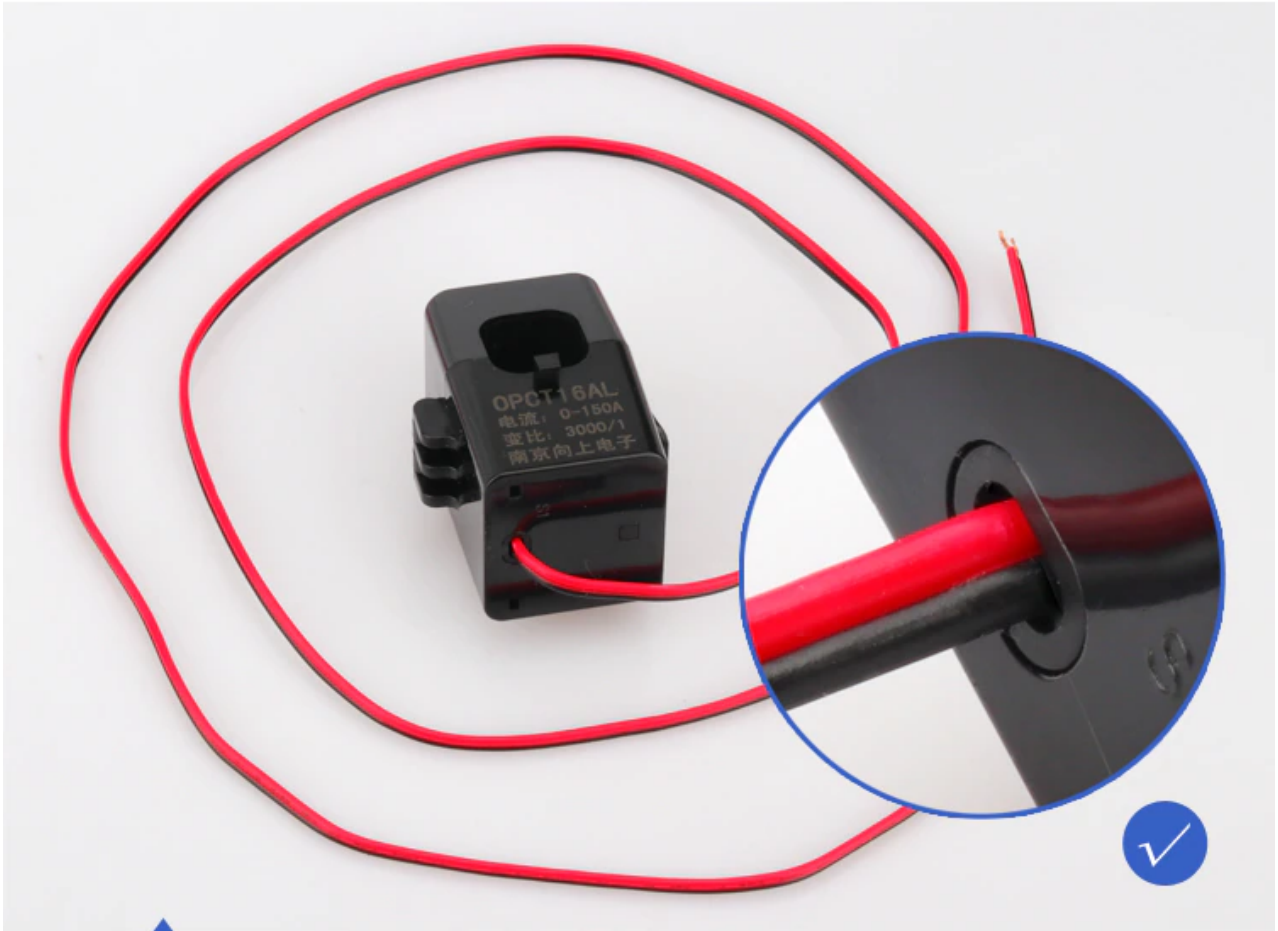

↑
OUR PRODUCTS

THE OUTPUT IS RED AND BLACK, AND THE OUTPUT IS UNILATERAL. THE PRODUCT IS BEAUTIFUL, CONVENIENT FOR LATER CONSTRUCTION

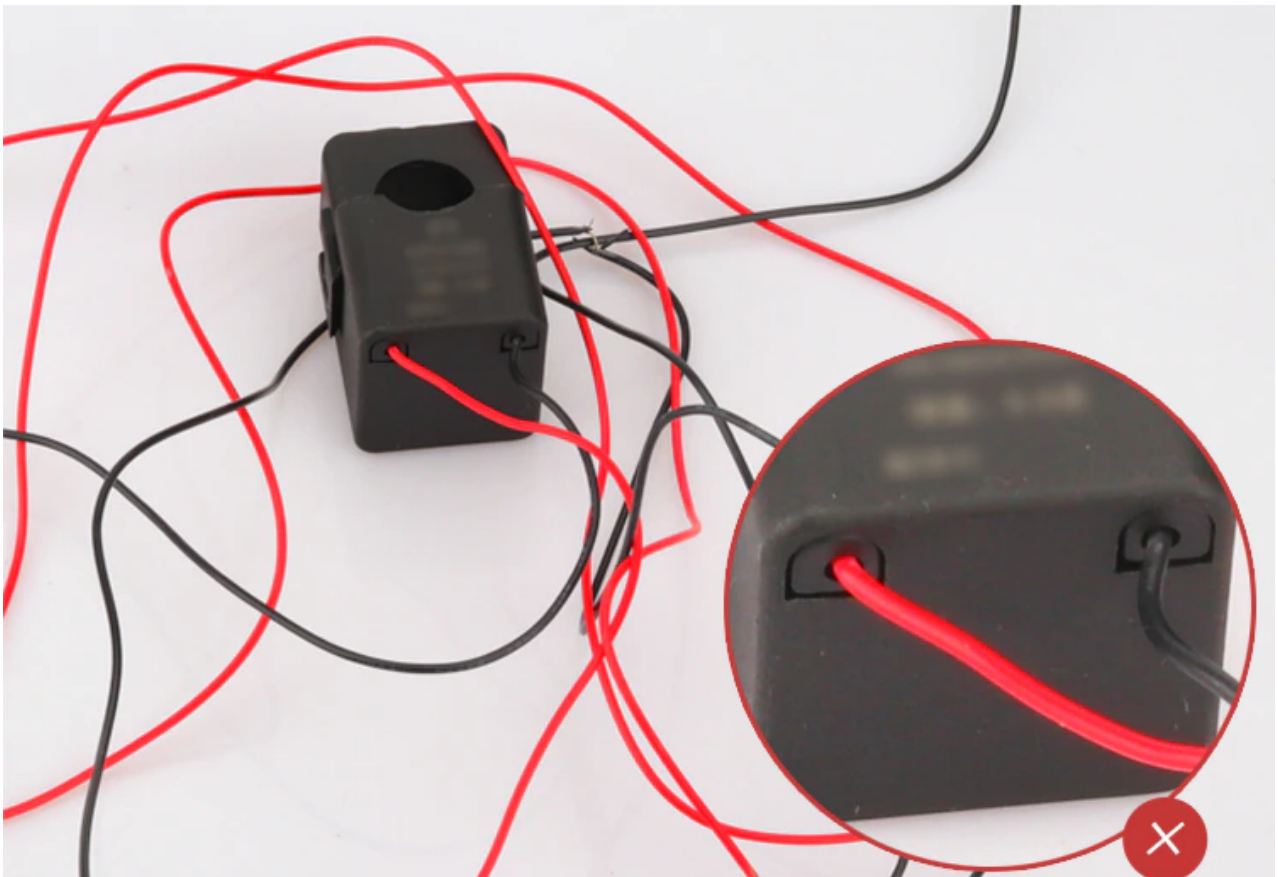



TWO SEPARATE ELECTRON WIRES ARE DRAWN FROM BOTH SIDES, SCATTERED AND DISORDERED. AFFECT THE LATER CONSTRUCTION LINE.

GOOD PRODUCTS WITH GOOD MATERIALS, MORE SECURE, MORE REST ASSURED



PERFORMANCE COMPARISON

PERFORMANCE COMPARISON

Quality is more than just talking, it is the purpose of our company !



✓ Accuracy error: 0.3% angular difference 3% rated current 100%

Accuracy error $\pm 0.5\%$, angular difference $32'$, rated current 100%



STABLE PERFORMANCE, SMALL LEAKAGE MAGNETISM, SMALL VOLUME, HIGH ACCURACY, PRODUCT CONSISTENCY IS GOOD, ENSURING THE PEACE OF MIND OF EVERY CUSTOMER.

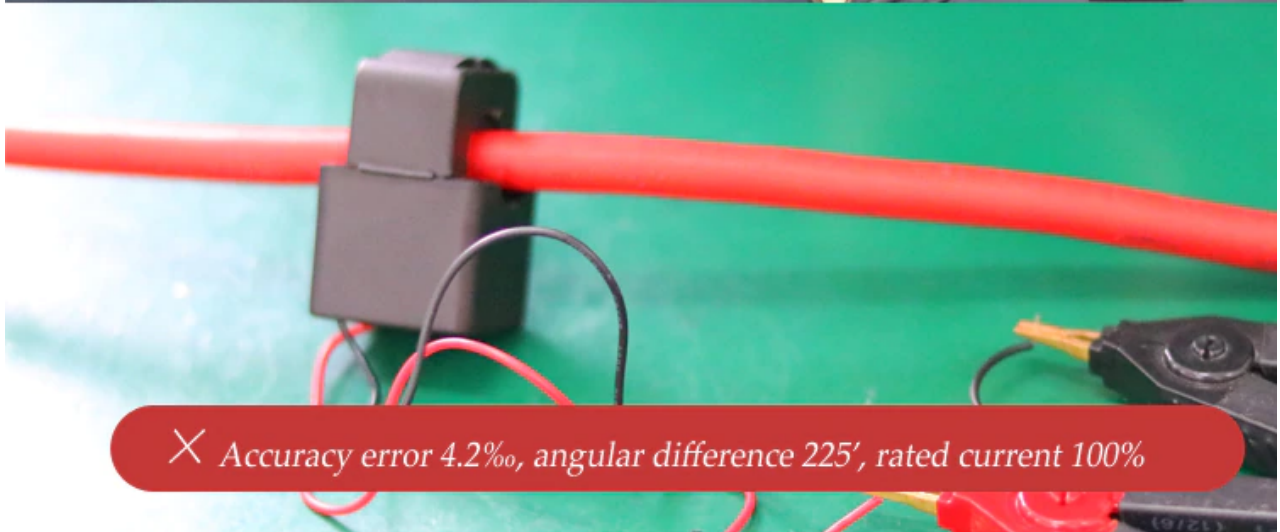

✗ Accuracy error 4.2‰, angular difference 225', rated current 100%



LOW STANDARDS, LOW REQUIREMENTS, LARGE ACCURACY ERRORS, POOR LINEARITY AND CONSISTENCY OF PRODUCTS, VIRTUAL STANDARD PARAMETERS, AND SECONDARY CHARGING, PRODUCT QUALITY CANNOT BE GUARANTEED

Production Process

PRODUCTION PROCESS

WHY CHOOSE XINJIANG RAISINS

为什么选择我们

01

SHOW PRODUCTION
PROCESS, SOME MORE
TRUST,

02

ORIGINAL FACTORY
QUALITY IS MORE
GUARANTEED



IRON CORE



COPPER WIRE



SHELL



WINDING MACHINE



FINISHED PRODUCT



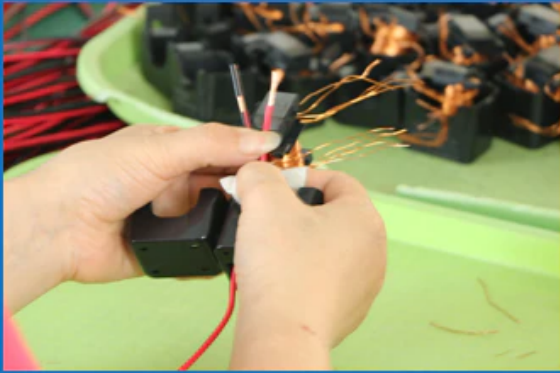

MANUAL OPERATION



SEMI-FINISHED PRODUCT



ONLINE DETECTION



TEST DATA





MANUAL PACKAG



LAYER BY LAYER PACKAGE

**WE ARE MANUFACTURERS, SELECTION
WILL NOT, TECHNICAL SUPPORT**



CERTIFICATIONS

资质证书



STAFF STYLE

员工风采

