







Mandatory Safety

- Never use the product for the proposes other than listed on this manual.
- Read the instruction manual before using this product.
- Remove all the packaging before use.
- If the unit will not be used for an extended period empty all the water, remove batteries and clean the unit before storage.
- "WARNING" contains important safety instructions. Be sure to follow these instructions.

Warning

-  • This device is not intended for use by persons with reduced physical or cognitive capacities without the necessary experience or knowledge, unless they have been trained to use the device correctly by a person responsible for their safety and have understood the risks involved.
-  • Stop using the product immediately and remove the batteries from the device once smoke, smell, unusual sounds or other anomalies occur.
-  • Do not modify, fix or dismantle this product, as fire, electric shock or damage may occur.
-  • When the product is at the end of its life, we recommend disposal at a collection point for the recycling of electrical and electronic equipment, rather than with household waste.
-  • When this product remains unused for a long period of time, the main unit must remove all the batteries and pour out the water from the water tank. Otherwise electric shock malfunction may occur.
- Remove all the batteries before cleaning and maintenance.

- Please avoid dripping the essential oil onto the exterior of the product or onto furniture.If essential oil dripping accidentally occurs, wipe off immediately to avoid discoloration of the exterior of the product or the furniture.
- This product is not medical equipment. Directly inhaling the aroma mist from the spout is not recommended.
- If you have any special physical conditions, such as pregnancy, lung failure, cancer, epilepsy, or other illnesses, please consult your doctor before using essential oils. Stop using the product and open the windows for ventilation if you start to feel uncomfortable.
- If you have a skin reactions or eye uncomfortable feeling, stop using the product immediately and consult physician if necessary.
- Essential oils are highly concentrated and should always be handled with care, including the amount for each use.

-  • This product is not intended for use by persons (including children) with reduced physical, sensory or mental capabilities, or lack of experience and knowledge, unless they have been given supervision or instruction concerning use of the product by a person responsible for their safety.
- Do not let children use this product. Keep out of reach of children as electric shock and injury may occur. Children should be properly supervised to ensure that they will not play with this product.
- To avoid fire, electric shock, injury or damage, do not place the product in the areas listed below :
 - Environments exposed to direct sunlight to high temperatures and keep away from sources of ignition.
 - Pressurized objects and combustibles.

Product Dimensions

Product Name:	Pebble	Main unit weight:	60g
Model code:	BL-027	Water Tank Caoacity:	16ml
Product Size:	74mm(L) x 33mm(W) x 119mm(H)	Usage area:	10 - 15cm face distance
Material:	PP	Design:	USA
Power input:	DC 4.5V--1.25W	Made in China	
Batteries:	AAA x 3		
Manufacturer:	Bloomy Lotus LLC		

Product Warranty

Thank you for your purchase. The products carry a limited 12-month warranty on manufacturer defects. Please contact your local distributor for after sales enquiries or product maintenance.

Proof of purchase will be required. Warranty does NOT cover:

- Damage of accessories due to often use /depreciation
- Damage due to abuse or improper use of the product
- Damage of non-household use (i.e natural disaster, commercial use)
- Fail to provide any proof of product damage & purchase

We reserves the right for final decision of free product maintenance provided within mentioning period and any other conditions.

Product name: _____ Model no.: _____
 Batch no: _____ Point of purchase: _____
 Date of purchase: _____



Troubleshooting

If you experienced unsatisfactory operations, please follow our troubleshooting guidelines listed below.

Symptom	Possible Cause	Solution
The diffuser cannot turn on	No more batteries power	Remove and change the new batteries
	The batteries / water tank did not insert well	Insert the batteries and water tank again correctly
	The ultrasonic plate / mist nozzle are in wet.	Always dry the ultrasonic plate / mist nozzle before starting the machine.
No mist when the diffuser is ON	No water in the water tank	Refill the water to the water tank
	The water is below the minimum water line	Refill the water until it reaches between the Max. and Min. water level line
	The diffuser are facing up	Make sure the diffuser are using horizontally or downwardly
	The ultrasonic plate / water tank are not in a good condition	Please follow the cleaning and maintenance instruction to clean the Ultrasonic plate / water tank
		Shake the appliance gently during operation

BLOOMY LOTUS

Giving you a room to breathe.

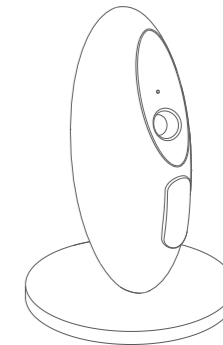

USER'S MANUAL Pebble

Thank you for purchasing this product.
Please read the user manual carefully before use.

Overview

Main body

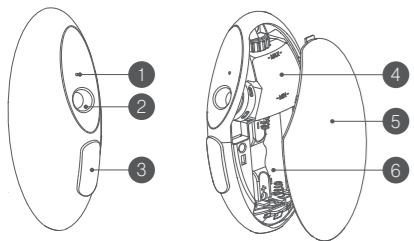

1. LED indicator
2. Ultrasonic plate / Mist nozzle
3. On/Off button
4. Water tank
5. Side cover
6. Battery compartment

Accessories

7. Standing base
8. Drawstring bag
9. Water bottle

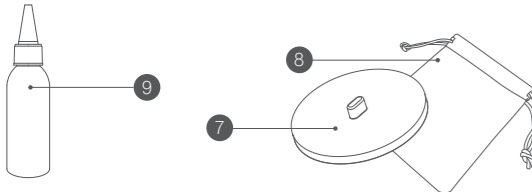

Operation Instructions

Before starting the Pebble Beauty Diffuser, you may....

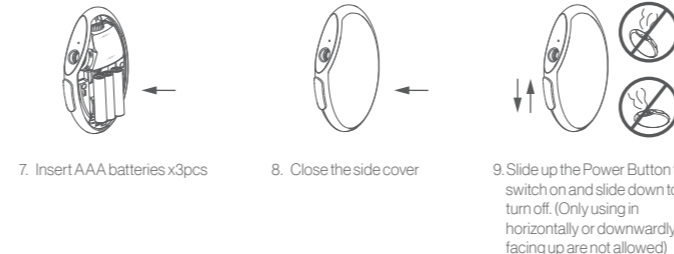
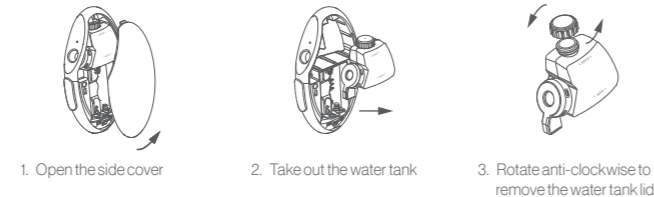

Note :

- For best result, we recommend to use 100% pure essential oil with this diffuser. Artificial fragrance, flavor, or impurities might harm to the unit.
- Always dry the water tank, mist nozzle and ultrasonic plate before starting the machine.
- Always remove the batteries / empty the water tank when not in use.
- Make sure the machine are using horizontally or downwardly, facing up are not allowed and may hurt the machine.
- Do not block mist nozzle while in use.
- Do not use distilled water for this device.
- Do not use hot water. Always use water in cool or room temperature.
- Do not use the machine with self-made cleansers, creams, oils or cosmetic products containing harsh chemicals or rough particles.
- Regular cleaning of the appliance ensures optimal results and a longer life of the appliance.
- Bubbles or droplet might appear around the mist nozzle. Please clean around the nozzle before use.

Clean & maintenance

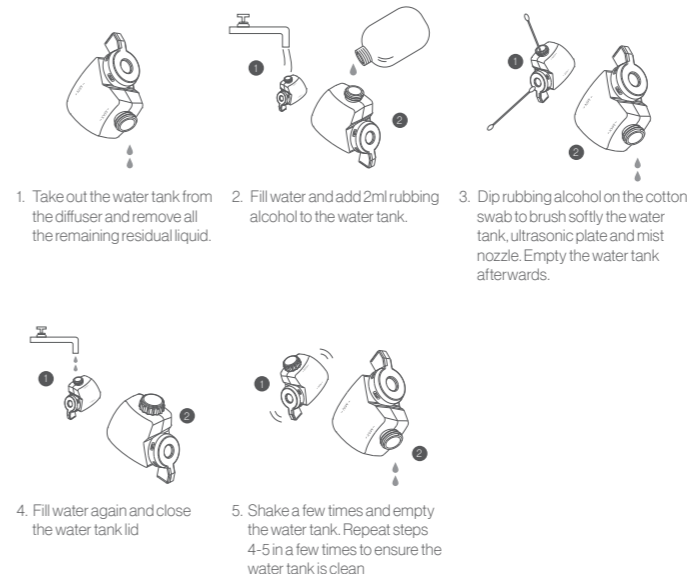

BLOOMY LOTUS

Giving you a room to breathe.