

Parts Diagram - AccuPro 2000

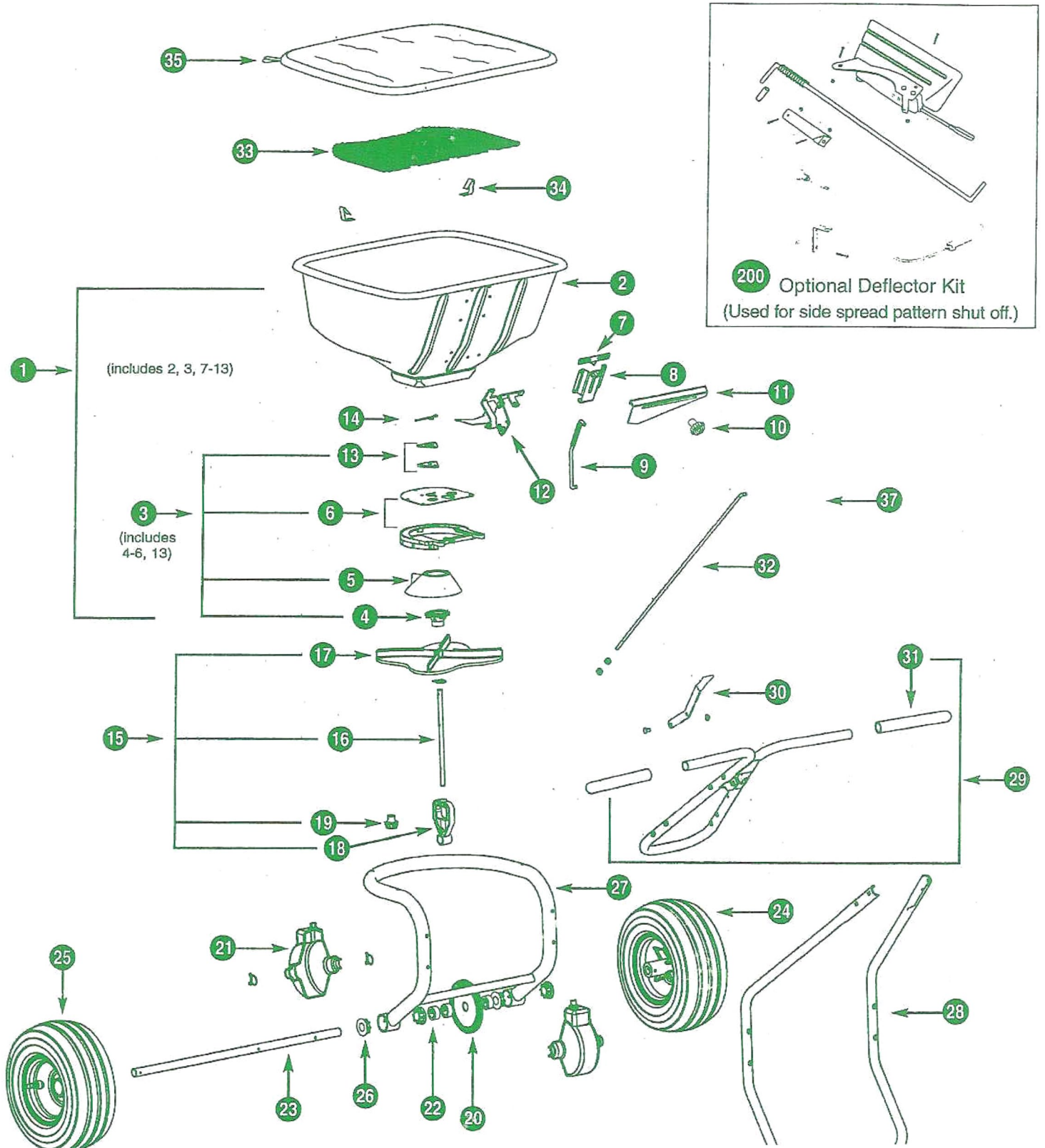

Ordering Parts

See diagram for assistance in identifying specific parts.

For parts orders, call 01902 440250

IMPORTANT: When ordering replacement parts, always provide the following information:

- 1) Part number (DO NOT use key numbers when ordering parts. ALWAYS use part numbers.)
- 2) Part description
- 3) AccuPro 2000 Model #8099-1

KEY #	PART DESCRIPTION	PART #
1	Hopper Assembly	791035
2	*Hopper	790115
3	*Helical Cone Assembly	780945
4	Helical Cone Retainer/Bearing Shield	792001
5	Helical Cone	780941
6	Shutoff Plate Retainer/Shutoff Plate Base	792002
7	*Pointer	790341
8	*Rate Control Housing	790321
9	*Rate Control Rod Assembly	790395
10	*Rate Control Knob/Washer	792003
11	*Rate Control Plate	790330
12	*Pivot Lever/Main Shutoff Plate Assembly	790265
13	*Agitator Bearing, Set	792004
14	Agitator Pin	780100
15	Rotor and Gear Carrier Assembly	780195
16	Rotor Shaft	790020
17	Rotor Plate	780191
18	Gear Carrier, Complete	780155
19	Pinion Gear	780122
20	Ring Gear	780121
21	Gearbox Cover Half (set of 2)	780110
22	Axle Collar (each)	780200
23	Axle, Complete	790015
24	Drive Wheel	790120
25	Idler Wheel	790130
26	Axle Bearing (set of 4)	790151
27	Frame Assembly (includes 26)	790045
28	Rest	790061
29	Handle Assembly (includes 30, 31)	790075
30	Main Shutoff Lever	790215
31	Hand grips (set of 2)	1000061
32	Main Shutoff Control Rod	790250
33	Hopper Screen	790141
34	Hopper Screen Clip (set of 2)	780440
35	Hopper Cover	790161
36	Fastener Package (not shown)	790905
37	Calibration Key (see calibration instructions)	791082
200	Complete Deflector Kit (optional)	1000060

All part and subassembly kits include necessary fasteners and assembly instructions.
 *Indicates parts included with hopper assembly



**For More
Information
Call ...**

01902 440250



**Or Visit Our
Website At ...**

www.pitchcare.com