



# KAWASAKI FR AIR FILTER KIT

## INSTALLATION INSTRUCTIONS

FITS FR65IV FR69IV FR730V



1 Remove the air filter and the intake tube from the engine. Retain hose clamp for Step 7.



2 Remove the 2 screws shown above to detach the air box lid. Retain screws for the next step.



3 Attach the new air filter mounting bracket using the retained screws from the previous step.



4 Install the 2 provided canister clamps as shown.



5 Long End Down

Ensure the long end of the air intake tube is facing down to the carburetor.



6

Attach the new air intake tube to the canister using one of the small clamps provided in the kit.



7 Long End Down

Install the new air intake tube down on the carburetor using the retained factory clamp from Step 1.

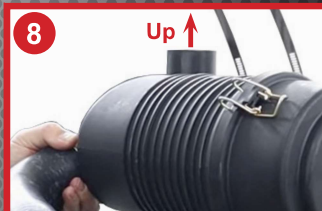

8

Ensure that the opening for the dust cap is facing up as shown.



9

Secure the canister to the mounting bracket using the remaining 2 canister clamps. Tighten all 4 clamps.



10

Install the dust cap using the remaining small hose clamp provided in your kit.

# INSTALLATION COMPLETE!