

# Flat Glass Door 960L LED Display Fridge

| Vertical Display & Storage



# Flat Glass Door 960L LED Display Fridge

Vertical Display & Storage

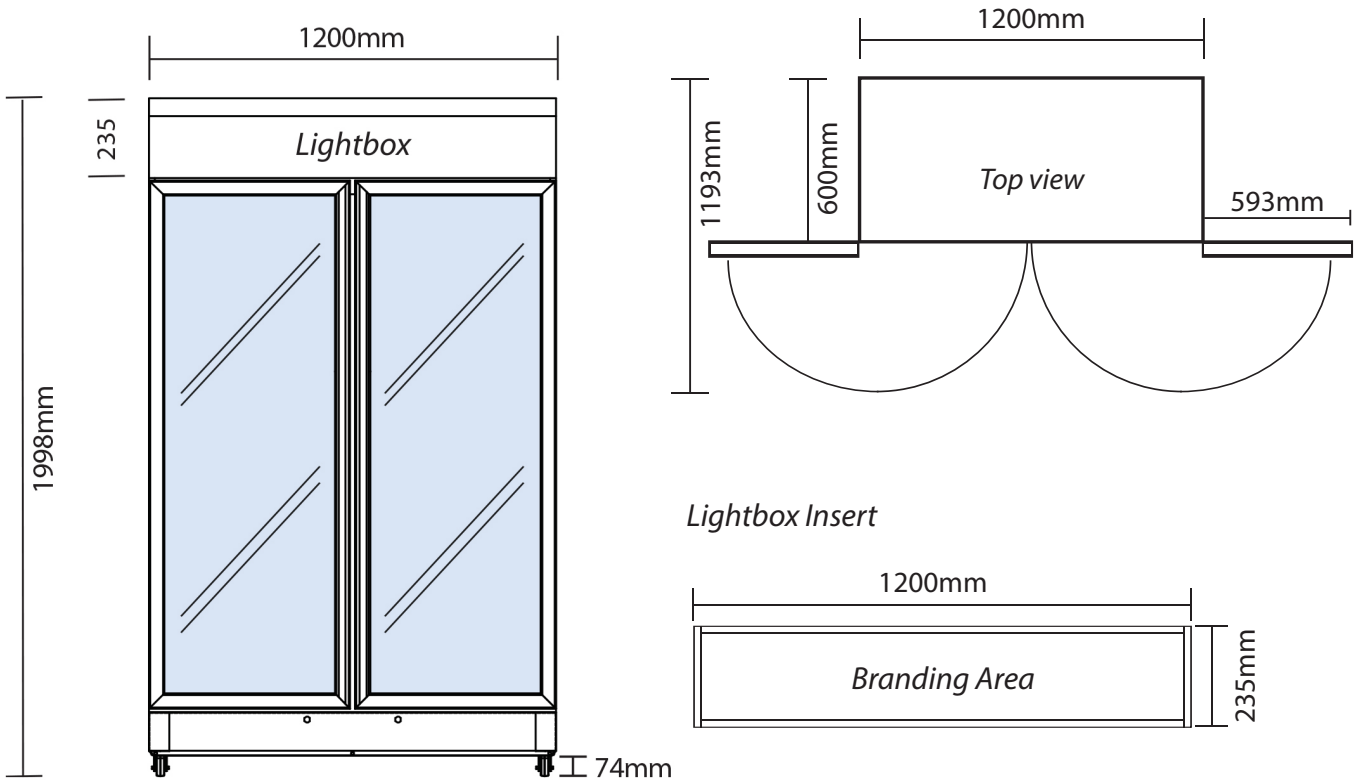

| SPECIFICATIONS         |                  |                          |   | DIMENSIONS           |      |
|------------------------|------------------|--------------------------|---|----------------------|------|
| Model Number           | GM1000LBECO      | Colour                   | Black   | <b>External (mm)</b> |      |
| Part Number            | 3736253          | Display Light Box        | Yes   | <b>Width</b>         | 1200 |
| Volume                 | 960L             | Internal Light           | LED   | <b>Depth</b>         | 690  |
| Unit Weight            | 177kg            | No. of Doors             | 2   | <b>Height</b>        | 1998 |
| Packaged Weight        | 182kg            | Door Type                | Glass   | <b>Internal (mm)</b> |      |
| Adjustable Temp. Range | +1°C to +7°C     | Door Glass Type          | Double glazed   | <b>Width</b>         | 1090 |
| Max. Ambient Temp.     | 38°C             | Door Style               | Hinged  | <b>Depth</b>         | 545  |
| Climate Class          | 3M1              | Door Shape               | Flat  | <b>Height</b>        | 1707 |
| Energy Consumption     | 7.38kWh/24h      | Door Swing Dimension     | 593mm   | <b>Packaged (mm)</b> |      |
| GEMS Star Rating       | 6 stars          | Total Depth of door open | 1193mm  | <b>Width</b>         | 1270 |
| Refrigeration Capacity | 650W             | Self-Closing Door        | Yes   | <b>Depth</b>         | 754  |
| Refrigerant            | R290             | Door Lock                | Yes   | <b>Height</b>        | 2115 |
| Rated Current          | 4A               | No. of Shelves incl Base | 5   |                      |      |
| Electrical Voltage     | 220-240V         | Shelf Type               | Adjustable  |                      |      |
| Frequency              | 50Hz             | Shelves Dimensions       | 527(w) x 478(d) mm                                    |                      |      |
| Power Supply           | Single Phase     | Temp. Controller         | Analogue  |                      |      |
| Power Plug             | 1 x 10A          | Castors                  | Yes   |                      |      |
| Plug Location          | Bottom left rear | Warranty                 | 2 Years Bromic Extra Care Warranty - Labour and Parts |                      |      |