

HC2R

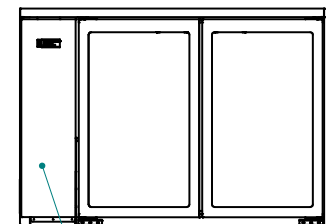

CATEGORY	GENERAL COUNTERS & BACK BARS
RANGE	CAMEO
UNIT	REFRIGERATOR
TYPE	REMOTE
DOORS	2

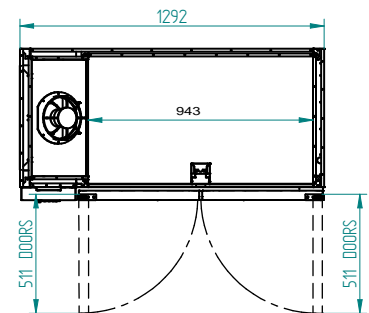
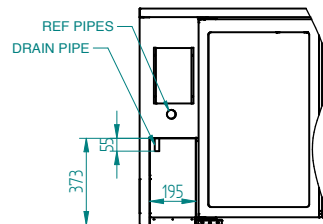
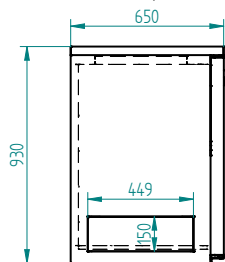

REMOVABLE CONTROL PANEL (Electrical/Refrigeration Connections)

SPECIFICATIONS

CAPACITY LITRES	420
TEMPERATURE	1°C / 4°C
DIMENSIONS - W X D X H (ON LEGS) MM	1292 W x 650 D x 1080 H
WEIGHT UNPACKED (KG)	170

STANDARD INCLUSIONS ***

DOOR TYPE	Standard: G (Glass Door) Optional: S (Solid Door)
FINISH	B (Black with stainless steel countertop and internal floor) or S (Stainless Steel) interior and exterior excluding rear and under
SHELVES/DOOR	2

ELECTRICAL

POWER SUPPLY	10 amp	
FRIDGE MODELS	RUNNING AMPS	0.7

GAS TYPE

REFRIGERANT	R404a
REFRIGERATION WATTAGES FOR REMOTE UNITS	
REMOTE WATTAGES	650 @ -5°C SST

*** For **OPTIONS** refer to the current Williams Price Guide