

RC1T

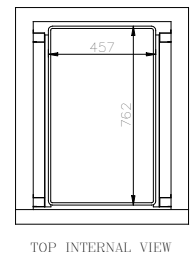

| | |
|----------|-----------------------|
| CATEGORY | FOODSERVICE UPRIGHTS |
| RANGE | Crystal Bakery |
| UNIT | RETARDER |
| TYPE | SELF CONTAINED |
| DOORS | 1 |

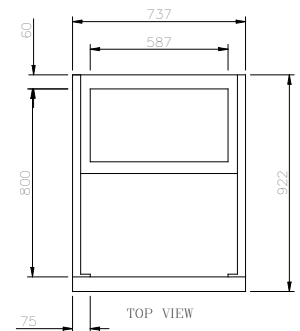
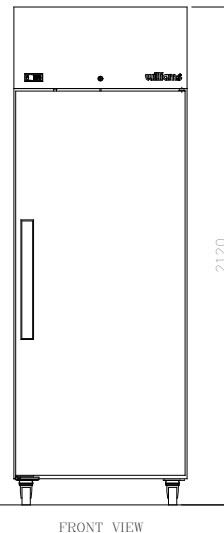
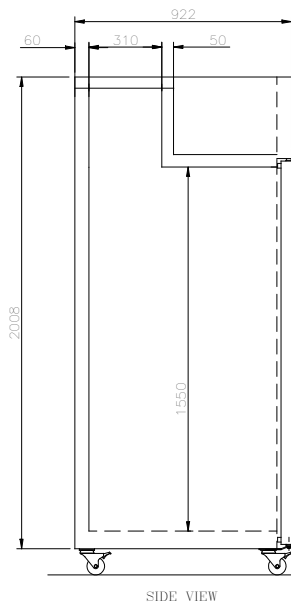

SPECIFICATIONS

| | |
|--|------------------------|
| CAPACITY LITRES | 730 |
| TEMPERATURE - 43°C AMBIENT ENVIRONMENT | -5°C /+3°C |
| DIMENSIONS - W X D X H (ON CASTORS) MM | 737 W x 922 D x 2120 H |
| WEIGHT UNPACKED (KG) | 160 |

STANDARD INCLUSIONS ***

| | |
|---|--------------------------|
| DOOR TYPE | Standard: S (Solid Door) |
| FINISH (INTERIOR & EXTERIOR EXCLUDING REAR & UNDER) | S (Stainless Steel) |
| TRAY SLIDES PER DOOR (NO TRAYS OR SHELVES SUPPLIED)(ACCOMODATES 18" OR 16" TRAYS) | 20 |

ELECTRICAL

| | |
|-----------------------------|--------|
| POWER SUPPLY | 10 amp |
| POWER CABLE LENGTH (METRES) | 2 |
| RUNNING AMPS | 4.0 |

GAS TYPE

| | |
|-------------|-------|
| REFRIGERANT | R134a |
|-------------|-------|

REFRIGERATION WATTAGES FOR OPTIONAL REMOTE UNITS

| | |
|-----------------------------|----------------|
| FRIDGE MODELS - SOLID DOORS | 520 @ -5°C SST |
|-----------------------------|----------------|

*** For **OPTIONS** refer to the current Williams Price Guide