

## SCREW FIXING

BASELINE 05

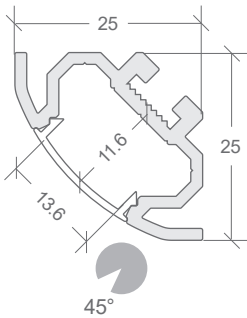

BASELINE 08

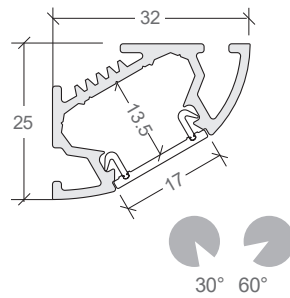

HIGHLINE 04

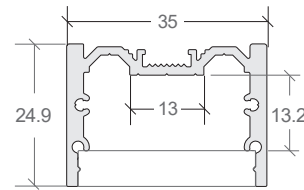

## A. PROFILE INSTALLATION

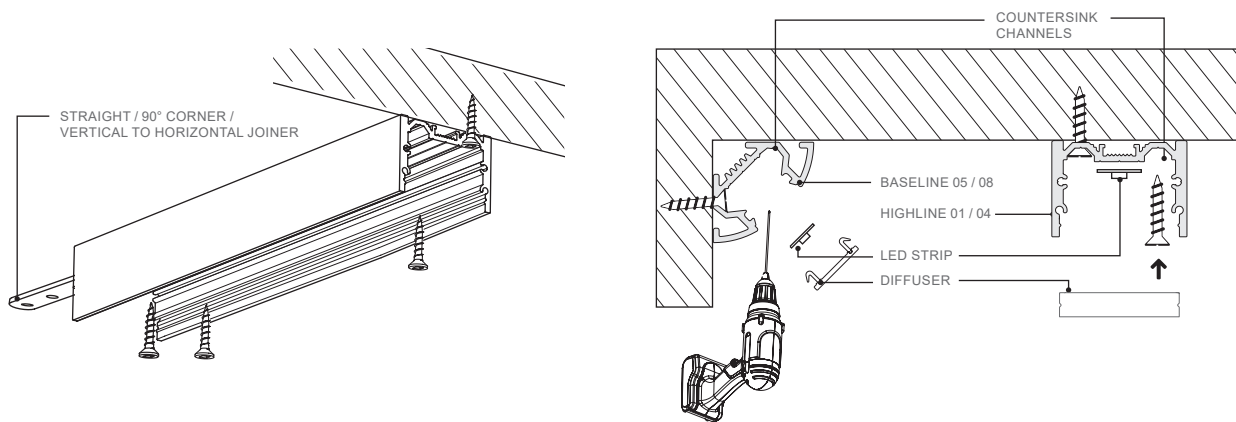

1. Where joining profile, use the appropriate joiner and tighten grub screws.
2. Drill cable entry hole in profile for LED power feed. Thread LED power feed through hole, ensuring it is protected from sharp profile edges e.g. heatshrink or similar.
3. Use suitable screws (not supplied) to mount profile using countersink channels. Screws are recommended within 100mm each end, and evenly spacing in the middle (max of 1m).

## B. LED INSTALLATION

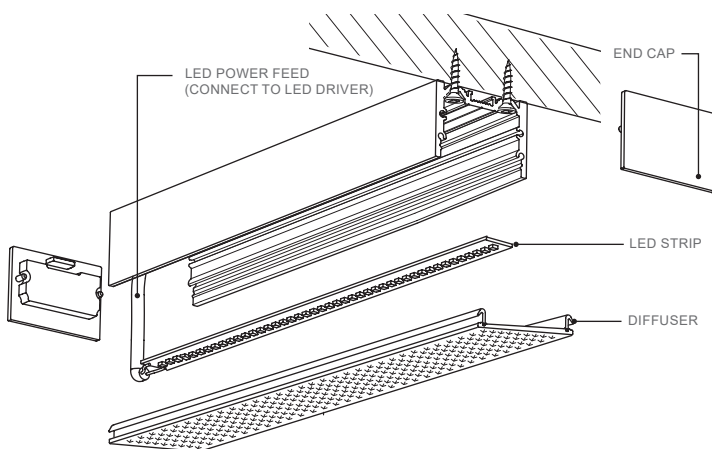

1. **IMPORTANT** - Before mounting LED strip, clean profile using an alcohol based cleaner.
2. Remove 3M paper from LED strip. Use the guide lines at the back of the profile as a guide to mount the LED strip.
3. Attach diffuser to profile by clicking in securely.
4. Secure end caps by pressing into place

## C. MAKE ELECTRICAL CONNECTION

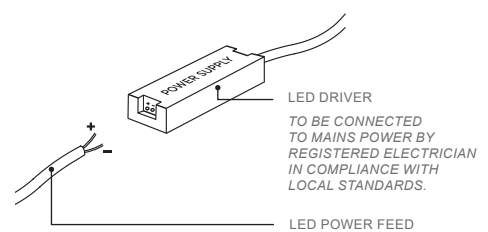

1. Connect LED power feed to LED driver.