

EX-STOCK
PRODUCT

NEON ARC | WHITE | PVC

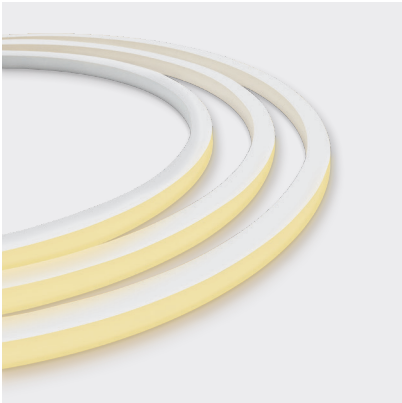

With the introduction of our indent range of Silicone encapsulated Neon LED ribbon, our local, end of line PVC stock is available with 3 year warranty using local connectors.

Neon Arc is a square W16 × H17mm, vertical bending model perfect for cove lighting, or architectural features in exterior and interior applications.

Stock quantities vary - Talk to our team.

For more options consider our indent silicone Neon range - lead times apply.

APPLICATIONS

- Theatres, bars, restaurants, & retail
- Cove lighting
- Architectural features
- Exterior or interior installations

FEATURES

- Neon Arc can be curved in the opposite direction of the other neon products
- UV & flame resistant

COLOUR	CODE	LUMENS	CRI
WARM WHITE 2700K +/- 145K	BL-LS-4800-27	≥420lm/m	
NATURAL WHITE 4000K +/- 275K	BL-LS-4800-40	≥480lm/m	≥80
COOL WHITE 5000K +/- 300K	BL-LS-4800-50	≥480lm/m	

ELECTRICAL & OPTICAL DATA VARIANCE +/- 10%
SOLD BY THE METRE
IES FILES AVAILABLE

LED WATTS	12W/m	MINIMUM BEND RADIUS	150mm
INPUT VOLTS	24V DC constant voltage	BEND DIRECTION	Vertical bending
OPERATING TEMP.	-20°C ~ +45°C	DIMENSIONS	W16 × H17mm
MAX. RUN PER POWER FEED	10m using one feed 20m using two feeds (01 & 02 connectors)	INGRESS PROTECTION	Up to IP67 Protection established by use of connection type SEE PAGE 2.
BEAM ANGLE	160°	CUTTING LENGTH	55.6mm
SOURCE LIFE	50,000 hours	HOUSING	UV & flame resistant white PVC
WARRANTY	3 years	MOUNTING	Profile / clips available SEE PAGE 3.
		CONTROL	Dimmable by PWM signal

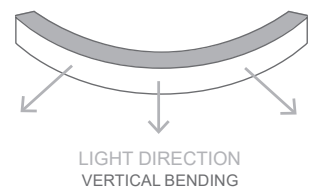
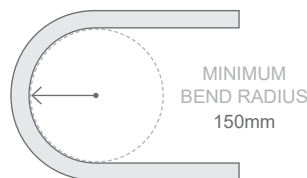
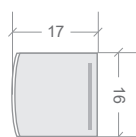

NEON ARC | WHITE | PVC | CONNECTIONS

Neon products are IP rated based on the fitted connections (power feed / end caps).

Can be fitted on-site or pre-fitted by Bright Light.

CLASP CONNECTIONS | IP65



TOP END FEED CONNECTOR SUPPLIED AS 1M CABLE

INSTALLATION WITH DOUBLE POWER FEED:
FEED 01 + FEED 02

CONNECTOR TOLERANCE +/-0.5MM



TOP END FEED

01



END CAP

02

WHITE

BL-LS-4806

BL-LS-4807

BL-LS-4801

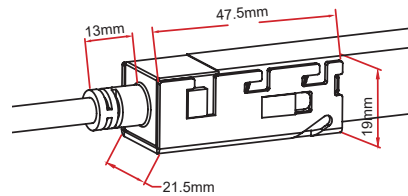

TOP END FEED

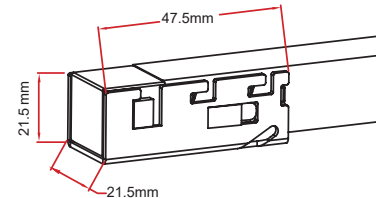

END CAP

SNAP CONNECTIONS | IP67



TOP END FEED CONNECTOR SUPPLIED AS 1M CABLE

INSTALLATION WITH DOUBLE POWER FEED:
FEED 01 + FEED 02

MUST BE FITTED CORRECTLY FOR IP RATING



TOP END FEED

01



END CAP

02

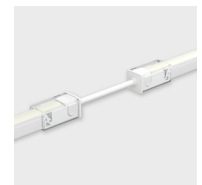

300MM FLEXIBLE
CONNECTOR

WHITE

BL-LS-4808

BL-LS-4809

BL-LS-4811

BL-LS-4810

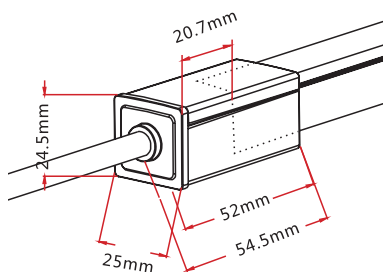

SNAP TOP END FEED CONNECTOR

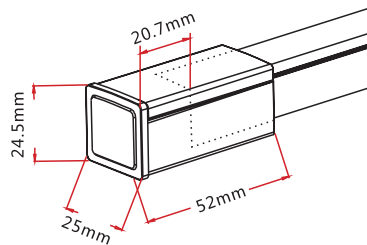

SNAP END CAP

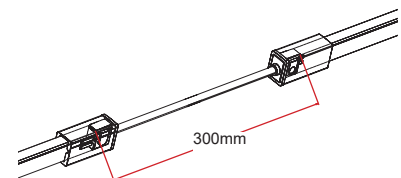

SNAP FLEXIBLE CONNECTOR

NEON ARC | MOUNTING ACCESSORIES

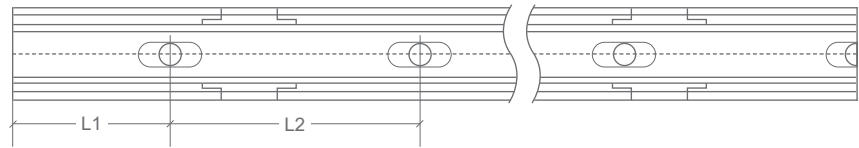

CODE	ACCESSORY	L1	L2	HOLE DIMENSIONS	HOLE NUMBER
BL-LS-4803	SELF-LOCKING ALUMINIUM PROFILE 2m	100mm	200mm	4 × 10mm	10
BL-LS-4802	SELF-LOCKING ALUMINIUM MOUNTING CLIP 35mm	5mm	25mm	4 × 10mm	2
BL-LS-4804	PLASTIC PROFILE 2m	100mm	200mm	Ø3.5mm	10
BL-LS-4805	PLASTIC PROFILE 1m	100mm	200mm	Ø3.5mm	5
BL-LS-4813	BENDABLE STAINLESS STEEL PROFILE 890MM <i>MULTIPLE FIXING LOCATIONS</i>	-	-	-	-
BL-LS-4814	HYBRID PROFILE 2m	100mm	200mm	4 × 10mm	10

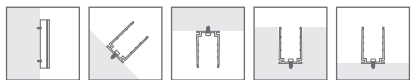
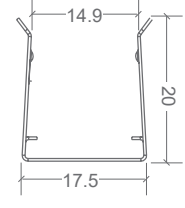
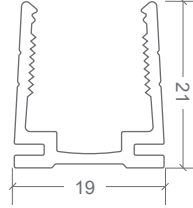
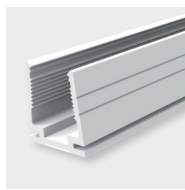
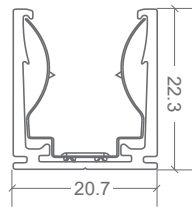
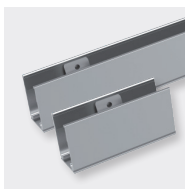

SELF-LOCKING ALUMINIUM PROFILE & MOUNTING CLIP

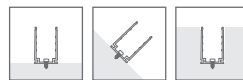

PLASTIC PROFILE 2M

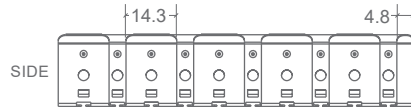

BENDABLE STAINLESS STEEL PROFILE 890MM

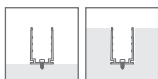
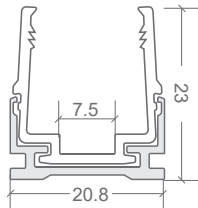

HYBRID PROFILE 2M