

## RING PENDANT

VOLTS	220–240V AC, 50/60Hz input
OPERATING TEMP. (ENVIRONMENT)	-20°C ~ +40°C
INGRESS PROTECTION	Indoor use only
MOUNTING	Ø250mm Central Mounting bracket Suspended with 1.5m power cable and safety cable
CONTROL	Non-dimmable

INSTALLATION IS TO BE DONE BY REGISTERED ELECTRICIAN IN COMPLIANCE WITH LOCAL STANDARDS

### INSTALLATION

1. Ensure power is turned off before installation
2. Loosen side screws from the central mounting bracket (if required) and rotate to remove interior bracket (leave side screws in interior bracket or keep safe).
3. Mount interior bracket to ceiling using 4 × screw fixings suitable for your specific ceiling type (fixing screws not included).

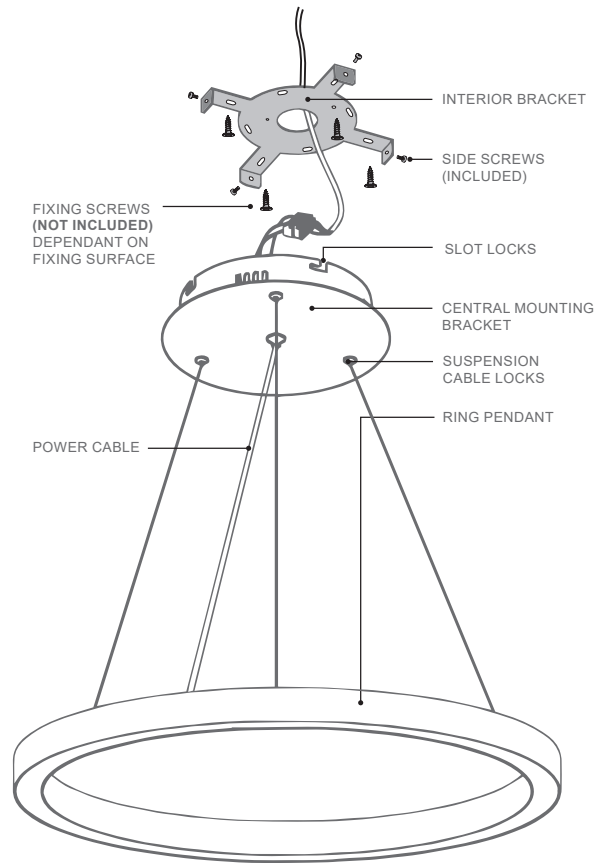
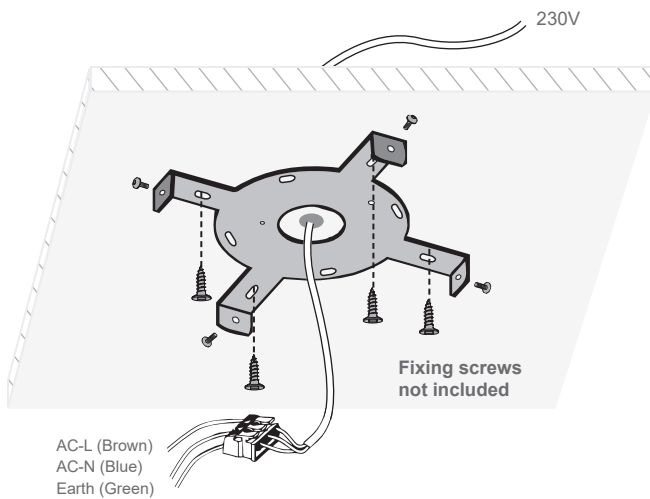

4. Drill hole and bring 230V power cable through centre of interior bracket.
5. Connect 230V L, N, Green (earth) wires with matching wires on Ring Pendant connector. Connector is housed in the central mounting bracket.
6. Adjust the power cable and suspension wire lengths as desired. Suspension lock buttons on the face of the central mounting bracket will prevent suspension wire from moving through unless button is pressed in. Suspension wire are looped inside the central mounting bracket to prevent accidental complete removal.

#### SUSPENSION WIRE LOCKS

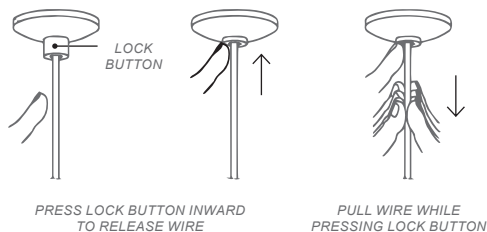

7. Align the central mounting bracket slot locks with the interior bracket side screws. Push central mounting bracket up and rotate to fit screws into slot locks, then tighten screws to secure in place. Cable ties can be used to secure power cable to the nearest suspension cable.
8. Installation complete, turn the power back on and check the ring pendant is operating correctly.

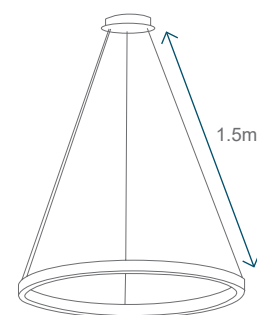

#### SUSPENSION LENGTH

Ring Pendants have 1.5metre suspension wires and power cables.

Larger diameter pendants will hang slightly higher than smaller ones. To hang at the same height simply tighten suspension wires on smaller pendants to match larger ones.