

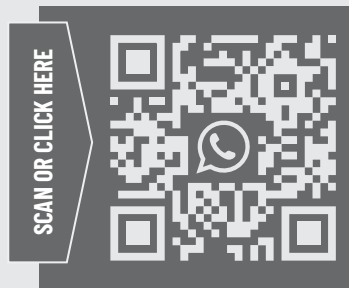

DESIGN FIRST, FUNCTION ALWAYS.

Looking for help?

Get in touch with Nuuk Customer Care to speak to a Product Specialist



✉ Write to us at:
care@nuuk.in

☎ +91 98215 51009
Mon-Fri,
9:00 am-6:00 pm IST

🌐 www.nuuk.in

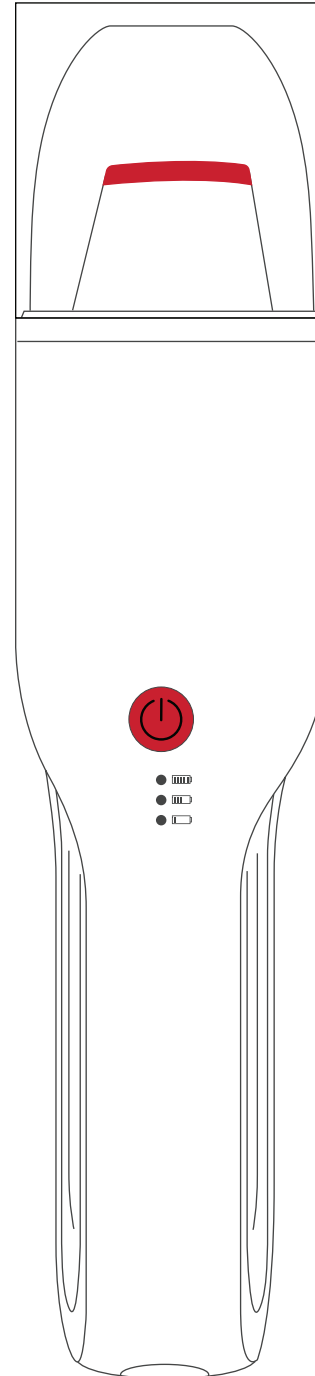

REN GO

Portable Vacuum Cleaner

VC161151BKB
User Guide

If you are reading this, congratulations, you have great taste! You are also in the **top 1%** of customers globally who read product guides.

We believe great design makes everything more usable, including this guide. Before we dive in, a message from our dedicated team of engineers and design thinkers:

Thank you for choosing Nuuk.

We started with a simple question - how do we bring world-class home appliances to our customers?

We design products with real people in mind. That's easy for us because we are our own customers. We know what we like, and we think you might like that too.

We then work closely with our partners to manufacture products to exacting standards so they work the way they are supposed to. Every. Single. Time.

Finally, we commit that on the rare occasion that our product doesn't meet your expectations, we will solve the problem quickly and decisively.

Doing this is simple yet hard. The result is products that are intuitive and delightful. Products that are **design first, function always**.

Hope you enjoy using your Nuuk as much as we enjoyed building it!

Team Nuuk

CLAIM EXTENDED WARRANTY

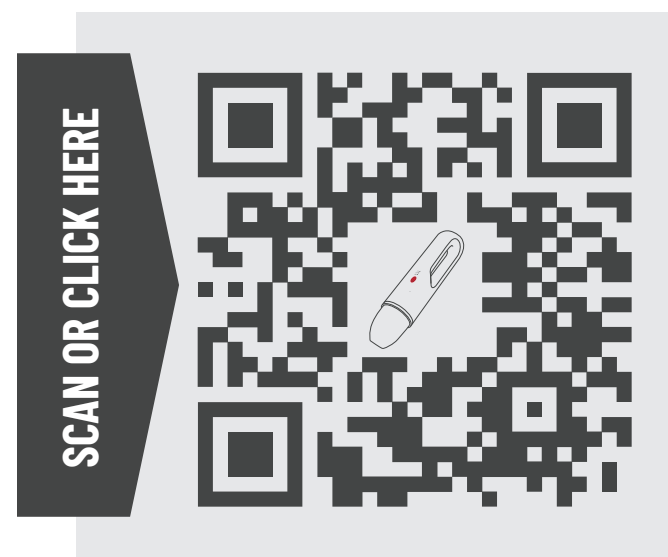

Access User Guide and other product resources or visit
nuuk.in/resources/rengo

ALL YOU NEED TO KNOW

A

Safety First

1-3

C

Let's Get Started

6

E

Caring for your REN GO

11-12

G

The Nuuk Promise

14

B

Know your REN GO

3-5

D

Mastering your REN GO

6-10

F

Troubleshooting

13

H

Nuuk Pledge

15

A. SAFETY FIRST - PAY ATTENTION!



Before you dive into using your Nuuk REN GO, please invest some time in reading this user guide. Trust us, it's not just a formality; it's crucial. Failing to do so may result in electric shocks, fire hazards, and personal injuries. Let's take safety very seriously.

General Safety

- This product is not intended for use by persons (including children) with reduced physical, sensory, or mental capabilities, or lack of experience and knowledge, unless they have been given supervision or instruction concerning the use of the product by a person responsible for their safety.
- Please note that this vacuum cleaner is not a toy for children or pets. Children should be supervised at all times to ensure they do not treat this product (especially the nozzle attachments) as a plaything. The vacuum cleaner should be kept out of reach of children or pets at all times.
- **And remember those packaging bags?** Please remove and store them or discard them responsibly. Do not allow children or pets to play with them or put them on their heads, as this action may cause suffocation.

Operational Safety

- Do not block the air vents. Do not let hair, loose clothing, fingers or any body part come in contact with the front or rear vents especially when the vacuum cleaner is operating. They could be entangled in the vacuum cleaner, causing damage or injuries.
- Avoid water splashes. Do not use it near the bathtub, shower area, or washbasins; do not take it into the pool or outside in the rain. Do not use the vacuum cleaner with wet hands. Do not use a wet cloth or wet hands to wipe or clean the vacuum cleaner.
- The vacuum cleaner contains a built-in rechargeable battery.
 - Do not operate the vacuum cleaner near flammables or combustibles, in an area where flammable liquids (like paints) are stocked/used/present or in case of gasoline leakages. Do not apply or add fragrances to the vacuum cleaner as these types of products are known to contain flammable chemicals which may cause the vacuum cleaner to catch fire.
 - Do not expose the vacuum cleaner to extreme heat or direct sunlight. Do not place it in a high-temperature environment.
- Do not vacuum (i.e. use the vacuum cleaner to pick up) the following:
 - any flammable or combustible liquids (such as gasoline)
 - any liquids, such as water or soda
 - any burning or smoking substances such as unextinguished cigarette butts
 - any hard or sharp objects, such as building materials, glass or nails

SAFETY FIRST - PAY ATTENTION!

- Immediately stop using the vacuum cleaner if it makes unusual sounds, gives off bad odors or overheats. Do not try to disassemble this vacuum cleaner; there are no parts that can be repaired by the user. If the product needs repair, please contact Nuuk Customer Care to speak to our Product Specialist.

Nuuk Pro Tip - Always store the vacuum cleaner and its accessories in the Nuuk Storage Pouch. Place it in a cool (out of direct sunlight) dry area e.g., inside the car glove compartment or boot, out of reach of children and pets.

Electrical Safety

Charging

- This is a rechargeable vacuum cleaner, which uses 5V $\overline{\text{---}}$ 2A power supply (as mentioned on the rating label on the product). We recommend you use adaptors that do not exceed 5V $\overline{\text{---}}$ 2A specification to charge your REN GO.

Nuuk Pro Tip - As a practice, always check the compatibility between the voltage of the equipment and the product before use. This is to ensure the best charging experience - providing sufficient power to charge your product efficiently, while maintaining safety.

- Ensure the charging cable is placed where it will not be stepped on, tripped over, or subjected to damage or stress. If the charging cable is damaged or broken, stop using it immediately and reach out to Nuuk Customer Care.
- Do not charge the vacuum cleaner near heat sources such as radiators, in humid areas like bathrooms or outdoors in direct sunlight.

Battery repair and disposal

- The batteries are not removable. Do not disassemble, crush or puncture the vacuum cleaner.
- If the battery is damaged do not attempt to replace it on your own. It is only repairable or replaceable by Nuuk's trained Product Technicians. Please contact Nuuk Customer Care to speak to our Product Specialist.
- When the vacuum cleaner reaches the end of its service life, please dispose of, or recycle properly in accordance with local laws and regulations for e-waste management. Do not dispose of the vacuum cleaner on fire as it may explode.
- In the rare case of any battery leakage due to external damage, avoid contact with skin and eyes. If contact occurs, wash the area with water and seek medical advice.

SAFETY COMES FIRST - PAY ATTENTION!

Transportation

- The vacuum cleaner should be powered off during transport.

Safety should never be taken lightly. Regularly reviewing and adhering to these instructions ensures a safer and more enjoyable cleaning experience with your cordless vacuum cleaner.

B. KNOW YOUR REN GO

A. Package Contents

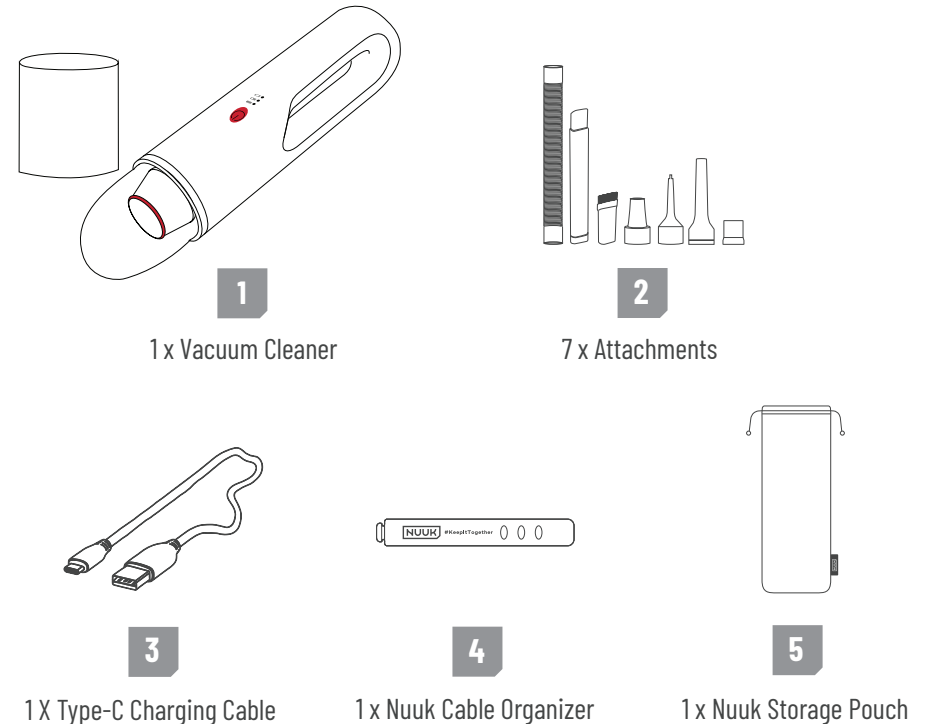

Note:

- Illustrations of the product, accessories and user interface in the User Guide are for reference purposes only. The actual product and functions may vary due to product enhancements

KNOW YOUR REN GO

B. Product Overview

Nuuk REN GO: 4-in-1 Portable Vacuum Cleaner

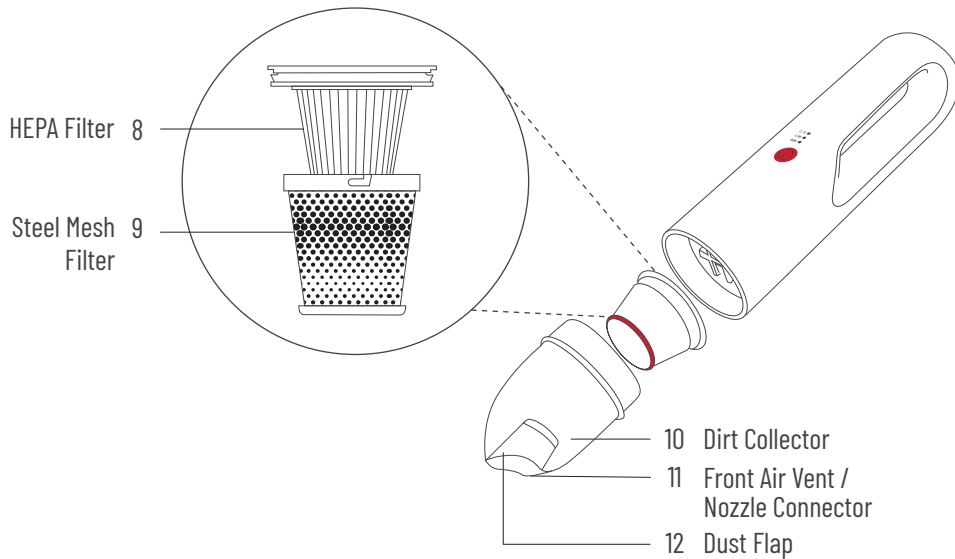
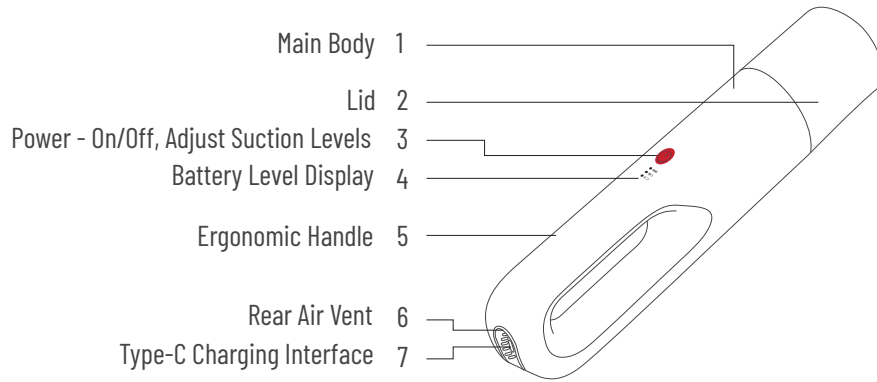





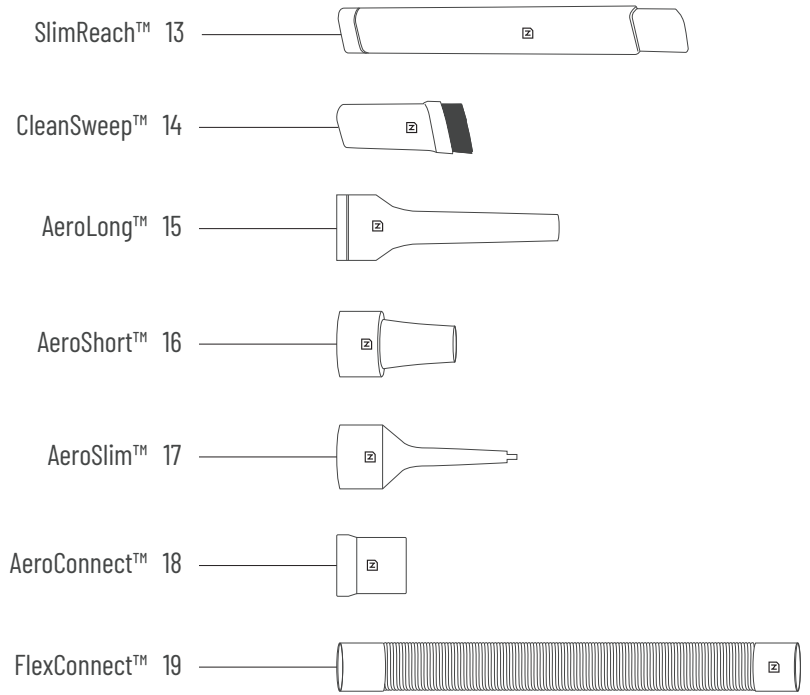

KNOW YOUR REN GO

B. Product Overview



Technical Specifications

 Model VC161151BKB	 Rated Charging Input DC 5V \approx 2A	 Motor Type BLDC, 68500 RPM
 Power Suction Turbo Mode - 11 kPa Eco Mode - 8 kPa	 Rated Output Voltage 7.4V Rated Output Power 80W	 Battery 4400 mAh
		 Charging Time 3 hours

C. LET'S GET STARTED

- Unbox your REN GO and make sure you've got everything listed on the package and in the user guide.
- Your REN GO is ready to use right out of the package.

Nuuk Pro Tip - Scan the QR code on the product rating label to register your REN GO for extended warranty.

D. MASTERING YOUR REN GO

Operating your REN GO is as effortless as it can get.

Power (on/off) and Mode Selection



Press the power button to turn on/off the vacuum cleaner and cycle through suction levels.

- Press "⏻" first time and the vacuum cleaner starts on Eco Mode.
- Press "⏻" again to switch to Turbo Mode.
- Press again to power off.

Charging

- When using the vacuum cleaner for the first time or using it after being left unused for an extended period, make sure it is fully charged.
- Use Eco Mode for saving battery and longer use, switch to Turbo Mode when stubborn dirt or highly dusty areas need to be cleaned.

Battery Indication Lights

There are three levels of battery indication.



■ Full



■ Medium



■ Low

MASTERING YOUR REN GO

REN GO Status		Indicator Lights
Battery Level	Fully Charged	All three indicator lights are continuously on when the product is turned on
	In Use	The indicator levels decrease in a ladder manner as mentioned below to indicate remaining battery level All three lights -> Two lights -> One light
	Fully Discharged / Low Battery	The 'Low' battery indicator blinks continuously
Charging Status	When fully discharged	If the product is fully discharged at the time of charging, the indicator levels increase in a ladder manner to indicate charging One light -> Two lights -> All three lights
	When > 33% charged	'Low' indicator light is on continuously; 'Medium' and 'Full' indicator lights blink in a ladder manner
	When > 66% charged	'Low' and 'Medium' indicator lights are on continuously; 'Full' indicator light blinks
	When > 100% charged	All three lights are on continuously

Understanding 4-in-1 functions and attachments

REN GO has two air vents- front and rear, which can help perform four functions. You just need to attach the relevant nozzle at the correct vent and you are all set.

- Front Air vent
 - Vacuum Suction
 - Deflation
- Rear Air vent
 - Air Dusting
 - Inflation

Slick Feature Alert: Each of the 7 REN GO attachments come with markings for ease of recall on the function it can perform, making using REN GO a snap, like a walk in the park!

REN GO Attachment		Function(s)	Placement	Detail	Surfaces
SlimReach™		Vacuum Suction	Front Air Vent	Designed for cleaning dust/dirt in tight spaces and corners	Car - Gaps in Seats, Dashboards, Door etc Home - Gaps on Sofas, Cabinet corners, Drawers, Ceilings, Wardrobes etc    
CleanSweep™		Vacuum Suction	Front Air Vent	Vacuum suction through the Front Air Vent for taking out dust, any leftovers, debris, food, hair, etc., from cushioned surfaces, carpeted areas, AC vents.	Car - Car interiors, AC vents, Dashboard Home - Tables, Chairs, Sofa, Furniture, Mats, AC vents, Keyboard      
AeroLong™		Compressed Air Dusting + Inflating + Deflating	Front Air Vent or Rear Air Vent	Multi-purpose - use it based on the type and size of the object.	Compressed Air Dusting - For hard-to-reach spaces like doors, window panels, fan blades, keyboard/electronics Inflating - Balloons, air mattress Deflating - Sealing vacuum bags      
AeroShort™		Compressed Air Dusting + Inflating + Deflating	Front Air Vent	Multi-purpose - use it based on the type and size of the object.	Compressed Air Dusting - For hard-to-reach spaces like doors, window panels, fan blades, keyboard/electronics Inflating - Balloons, air mattress Deflating - Sealing vacuum bags      
AeroSlim™		Compressed Air Dusting + Inflating + Deflating	Front Air Vent	Multi-purpose - use it based on the type and size of the object.	Compressed Air Dusting - For hard-to-reach spaces like doors, window panels, fan blades, keyboard/electronics Inflating - Balloons, air mattress Deflating - Sealing vacuum bags      
AeroConnect™		Connector		Connector for attaching air dusting and inflator accessories.	
FlexConnect™		Connector		Connector for extending reach to access hard-to-reach spaces.	

MASTERING YOUR REN GO

Emptying the Dirt Collector

Make sure to empty and clean the dirt collector regularly to prevent any blockages.

- 1 Stand close to a trash can or dustbin for ease of emptying dirt from the vacuum cleaner directly into the bin

- 2 Slightly rotate the nozzle of the vacuum cleaner to open the dirt collector

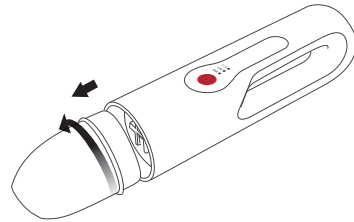

- 3 Now with the nozzle in one hand, use the other hand to pull out the filter assembly from the cup

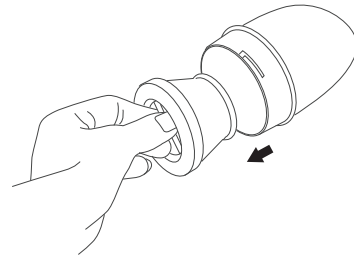

- 4 Empty out the dirt/debris into the trash can directly

- 5 Put the filter assembly back in the nozzle. Secure the nozzle back into the vacuum cleaner by rotating and tightening in the opposite direction according to Step 2 mentioned above.

To prevent dirt/debris from falling out of the vacuum cleaner during use, make sure the flap in the nozzle connector is not stuck and the lid is secured after use

Dust and dirt buildup in the collector can affect performance, so it's a good idea to keep emptying it before it gets full.

E. CARING FOR YOUR REN GO

Keeping Your REN GO in top-notch condition is effortless.

Main Body/Exterior

- Gently wipe away the dust with a soft and dry microfiber cloth. Easy-peasy!

Note:

- The Vacuum Cleaner's main body and exterior are not washable. Only the below mentioned components can be washed or rinsed.

Nozzles / Attachments

- The nozzles can be rinsed with clean water.
- While cleaning, look for blockages in the nozzle or attachments and clear out any debris you find.
- Make sure the nozzles are completely dry before reusing.

Dirt Collector and Filter Assembly (HEPA filter and steel filter)

- The dirt collector and filter assembly can be rinsed with clean water.
- Slightly rotate the nozzle to open the dirt collector. Pull out the filter assembly. Empty out the contents of the dirt collector.
- Slightly rotate the steel mesh filter to separate the filter assembly.
- Use clean water to rinse all the components. Make sure the dust flap on the front nozzle is intact while cleaning, or secure it after cleaning.
- Ensure each component is completely dry before putting the assembly back.

Note:

Please don't use soap, disinfectant, scrub or brushes to clean any of the components to avoid scratches or damage.

Keep your REN GO running smoothly by taking care of any excess dust build up in the dirt collector, filters or attachments.

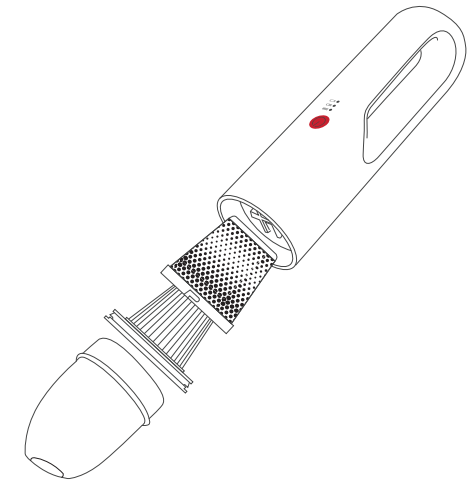

E. CARING FOR YOUR REN GO

A Word of Caution



- Always turn off your REN GO and unplug it from the charging before you dive into any cleaning or maintenance.
- Do not use chemical agents like cleaning liquids or rubbing alcohol. They can impair the motor housing and cause your unit to malfunction.
- Don't introduce your REN GO or charging cord to water or any other liquids. It's a recipe for short circuits, fires, electric shocks and all sorts of hazards.

Storage

- Always store the vacuum cleaner and its accessories in the Nuuk Storage Pouch. Place it in a cool (out of direct sunlight) dry area e.g., inside the car glove compartment or boot, out of reach of children and pets.
- Lastly, if your REN GO is taking a vacation from service for a while, fully charge and unplug it before storing it in a cool, dry place. Don't store in a high temperature environment. To avoid battery damage, recharge the vacuum cleaner at least once every three months. It'll thank you later!

F. TROUBLESHOOTING

What to do when your REN GO hits a snag

"My vacuum cleaner won't power on"

- Make sure the battery is charged.
- Make sure the vacuum cleaner is unplugged from charging before use.

"My vacuum cleaner is not charging" or

"The indicator doesn't light up while charging"

- Make sure that the Type-C charging cable is securely inserted into the charging socket for charging.
- Make sure you are using the Nuuk Charging Cable Type-C for charging. This cable is specifically designed for optimal compatibility and performance with your vacuum cleaner. If Nuuk Charging Cable is not available, you can use any other high quality USB-A to Type-C cable.

TROUBLESHOOTING

- Make sure to use a power adapter or car charger that matches the voltage specified on the vacuum cleaner's label (DC 5V --- 2A). Using a charger with the wrong voltage could harm your vacuum and cancel the warranty.

Note:

- Type C to Type C charging will not work with RenGo.

"My vacuum cleaner turned off during use."

- The battery may be low; recharge the vacuum cleaner.

"My vacuum cleaner's suction seems weak."

- Empty the dirt collector if it's full. A full bin can drastically reduce suction power.
- Inspect the filter and clean it if it's clogged or dirty.
- Look for blockages in the nozzle or attachments and clear out any debris you find.

If your issue isn't on the list or if it just won't work, please reach out to us at Nuuk Customer Care to speak to our Product Specialist.

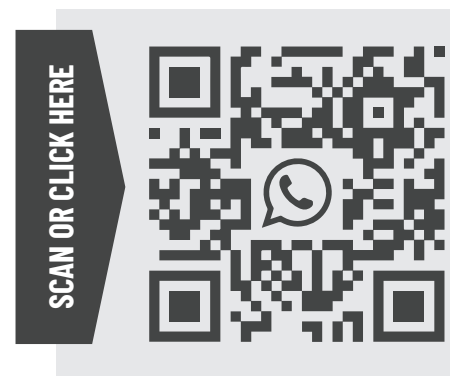

or  Write to us at care@nuuk.in

With a little care and troubleshooting savvy, your REN GO will continue to perform at its best, ensuring your spaces stay clean and fresh!

G. THE NUUK PROMISE

Default 12-month warranty: Your REN GO is covered under the Nuuk Warranty for 12 months from the date of its original purchase.

If your REN GO runs into any issues, just reach out to us at Nuuk Customer Care.

Make sure to hold on to the original purchase invoice, whether it's in hard copy or soft, to avail of the warranty.

Please keep in mind the following:

- The warranty won't apply in cases of accidents, water damage, misuse, unauthorized repairs, or if the product has been used for commercial purposes.
- We do not cover normal wear and tear, or any damages caused by not following the User Guide instructions, e.g., by connecting your product to an unsuitable mains supply.
- Do not dismantle the product or let anyone not authorized by Nuuk perform repairs.



Should your Ren Go have any issues, get in touch with our Product Specialist.

✉ Write to us at care@nuuk.in



H. THE NUUK PLEDGE- "LIVE WELL, DO GOOD"

Here at Nuuk, we're all about living well and doing good. That's why we're committed to giving our best to you, our awesome customers, the communities we're part of, and this precious planet we all share.

When it comes to the Nuuk REN GO, rest assured it is compliant with the highest global standards for electrical products. Check it out:

RoHS Compliant



RoHS is a directive in the European Union that stands for the Restriction of Hazardous Substances. It was created to control the use of hazardous materials often found in electrical and electronic equipment and goods. The goal of RoHS (Restriction of Hazardous Substances) is to reduce the environmental effects of electronics and protect human health. The legislation's primary purpose is to make electronics manufacturing safer at every stage of an electronic device's life cycle.

Responsible Manufacturing



Your Nuuk REN GO has been manufactured in a BSCI (Business Social Compliance Initiative) certified facility. BSCI, a non-profit organization under the Foreign Trade Association, puts in place an audit system that deals with monitoring and assessing the standards of manufacturing.

Recycle Responsibly



This marking indicates that this product should not be disposed of with other household wastes. Electrical and electronic products must be disposed of separately. To prevent possible harm to the environment or human health from uncontrolled waste disposal, recycle it responsibly to promote the sustainable reuse of material resources.