

Please read this guide carefully before using the product. It contains important information for your pet's safety as well as operating and maintenance advice. Keep this guide for future use. Should this product be passed on to other users, then this guide must be included.

## SAFETY AND COMPLIANCE

- Never use accessories that are not recommended by the manufacturer. They could pose a safety risk to the user and might damage the product. Only use original parts and accessories.
- Do not leave your pets unattended.
- Keep all small parts away from pets and children.
- Do not alter this product.
- Check the product regularly for damage. Replace if damaged.

## ⚠ WARNING ⚠

- Ensure the pet pen is properly assembled and all door latches are secure before leaving your pet in the pen.
- To prevent choking and other serious injuries, always remove any collars, tags, or leashes from your pet before leaving the pet in the pen.
- This product is not suitable for pets whose heads are smaller than the gap between the grids of the panels.
- This product is intended only for pets. Not intended for use with children. Children should not be allowed to play in the pet pen.

## ⚠ CAUTION ⚠

- This product cannot guarantee full containment and restraint in every circumstance.
- This product shall not be used to restrain aggressive dogs.
- Be careful when using on easily-damaged floors. Moving the pen too roughly could create scratches on the floor.
- Please dispose of product and packaging materials according to local regulations.
- No liability will be accepted for injury, accident, or damage resulting from improper use or non-compliance with this manual.

## ASSEMBLY METHOD

01

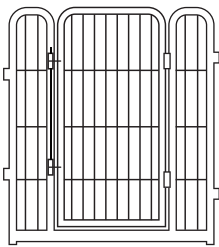

Locate the gate panel and ensure that the door lock is facing outwards.

02

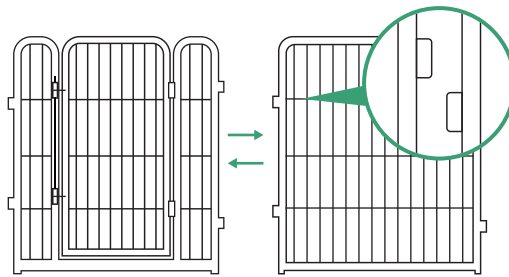

Align the circular rings on the gate panel and the regular panel. Please note that the height of the rings is different.

03

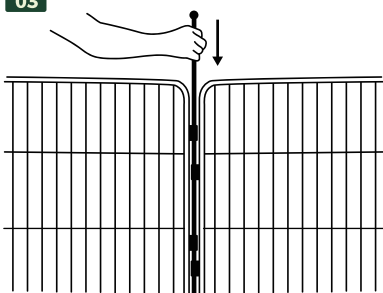

Insert the metal rod.

04

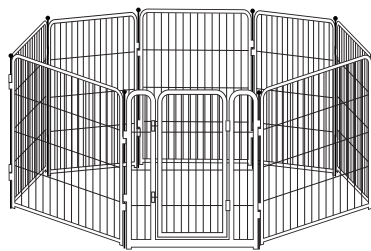

Finish installation.

05

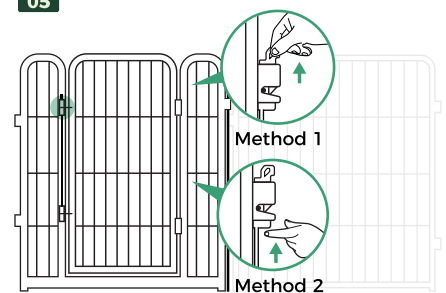

How to use the Door Latch Device

**NOTE:** The original intention of designing the integrated lock is to make the door opening and closing more convenient. After closing the door, please check and ensure that both the upper and lower door latches are securely locked.

## TIPS

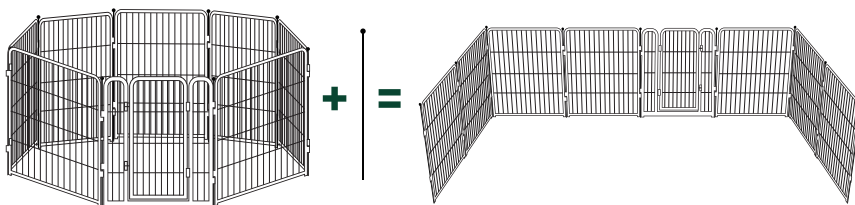

An additional metal rod is provided for use in scenarios where the fence will be incompletely closed, such as by a staircase, against a garage, by a wall, etc.

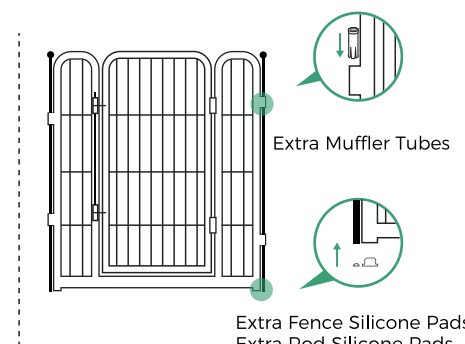

Extra Fence Silicone Pads  
Extra Rod Silicone Pads

# Letter to FXW Families

Dear friends,

Thank you very much for purchasing our product.

It is our honor to welcome you into the FXW family.

Unlock your freedom, savor the moment: this was our original intention in developing this product.

We hope that the FXW dog playpen will keep your pets safe and happy, so that you can enjoy a more relaxed outdoor life.

Since our products are made of metal, typical handling during the shipping process may result in superficial cosmetic damage to the surface of the product.

Please refer to the examples below.

Although we are developing more impact-resistant outer packaging, occasional instances of damage during transit are unavoidable.

If you encounter this kind of issue, please don't worry.

Please contact us ASAP. We will do our best to help resolve the problem within 24 hours until you are 100% satisfied, and we promise to bring you a five-star user experience.

Thank you for taking the time to read this letter.

Feel the bond, play well together.

Kind regards!

*FXW All Members*

## Examples

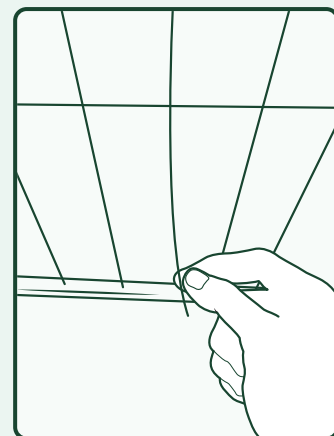
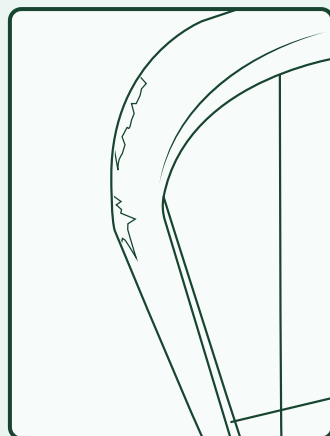
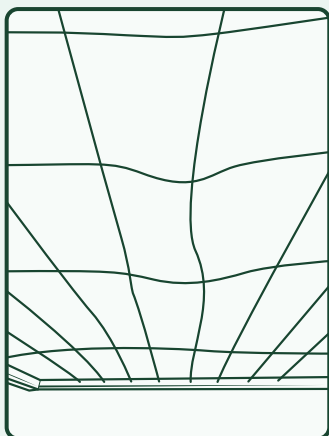

**Tips:** As this product is very heavy, to reduce unnecessary inconvenience and additional cost, if you want to return the package, please contact us first for a better return experience.

## Customer Service

 Facebook: FXWOfficial

 Instagram: fxw\_us

 support@fxw.life

 www.fxw.life