

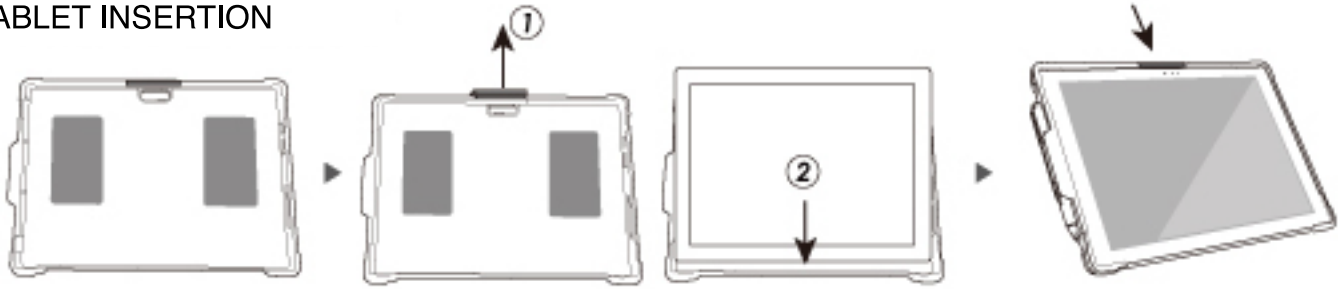

PAD-SCKS User Manual

Security Case with Kickstand & Anti-Theft Cable
For Surface Pro 4, Surface Pro 2017, Surface Pro 6, Surface Pro 7

TABLET INSERTION



1. Pull the stopper of the plastic case
2. Slide the Surface Pro into the case from bottom side.
3. Push the stopper back to fix the Surface Pro

TABLET REMOVAL

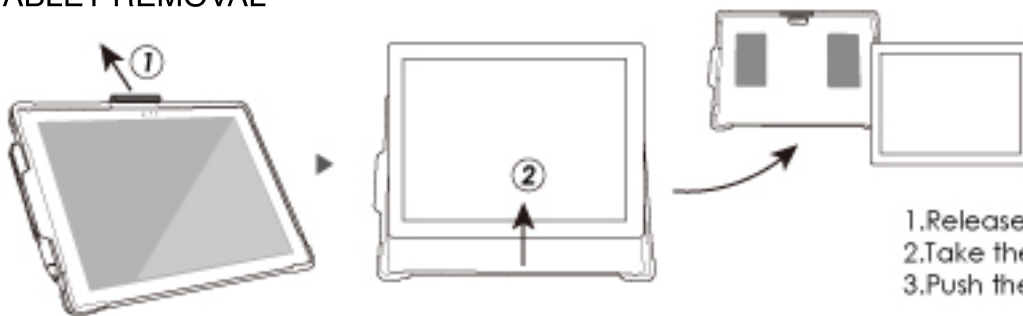

1. Release the stopper
2. Take the Surface Pro out from upper side.
3. Push the stopper back

HOW TO LOCK YOUR TABLET

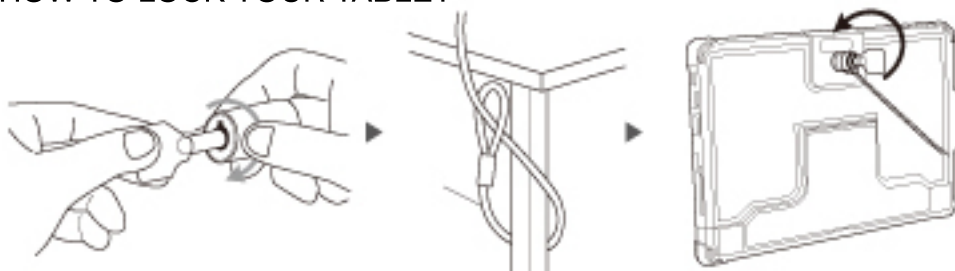

1. Use key push and turn it to let the lock at unlock situation
2. Tie the cable with the foot of table or others.
3. Insert the tip of lock into the case lock slot
4. Turn the key to let the lock at lock position.

HOW TO UN-LOCK TABLET

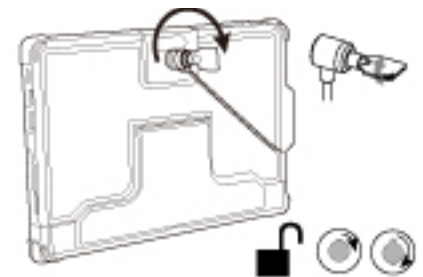

1. Use the key to let the lock at unlock position
2. Release the lock.

TABLET CASE STAND



1. Pull out the stand from case
2. Adjust the best view angle.

Optional item

Grip & Strap

1. Use the elastic bands of the grip to fix the Surface Pro case at the four corners.
2. Use the 2 hooks of the belt connect with the rings of grip.

