

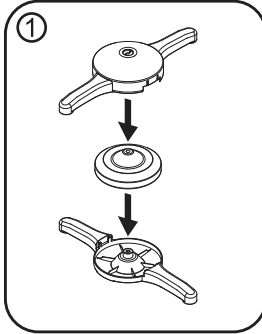

CTA Digital
Universal Quick Connect Floor Stand
Product Model: PAD-QCFB / PAD-QCFSW

INSTALLATION INSTRUCTIONS



Base assembly

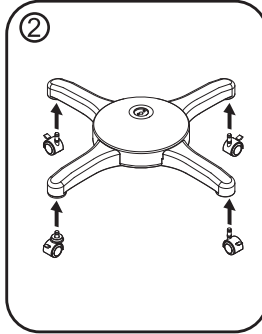

Insert casters

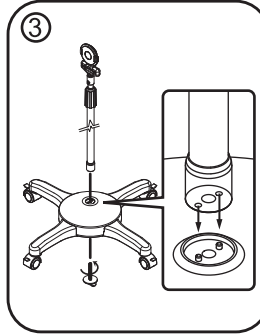

Stand assembly

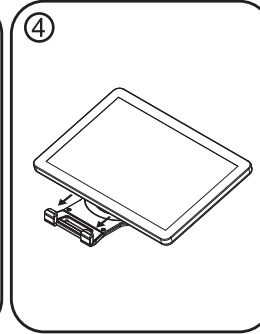

Place tablet on one side of bracket

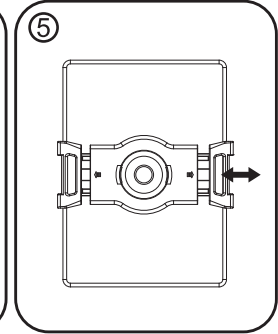

Pull open the bracket over the tablet and release

Caution:Please ensure that tablet is securely fixed in.

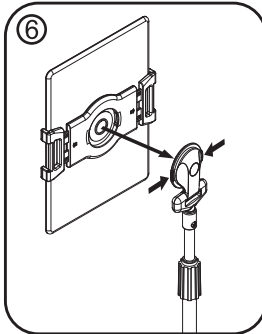

Attach to the panel

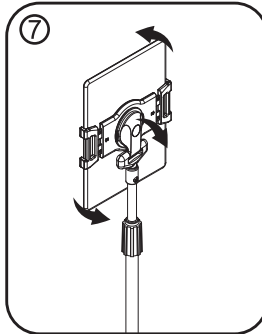

Horizontal / vertical view with angle adjustments

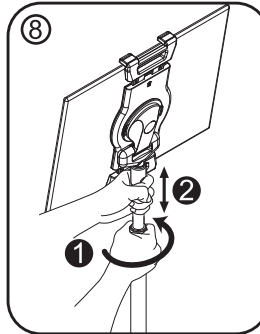

Release the knob to adjust the height

Caution:Please hold the pole when make adjustment

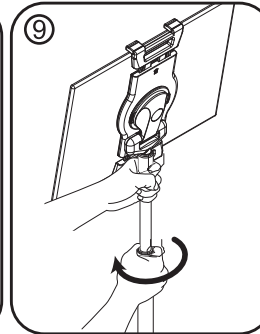

Tighten

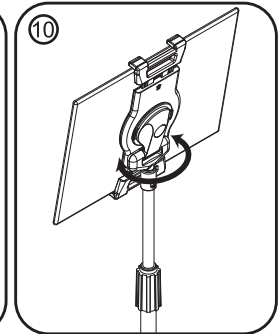

Rotates 360°

