

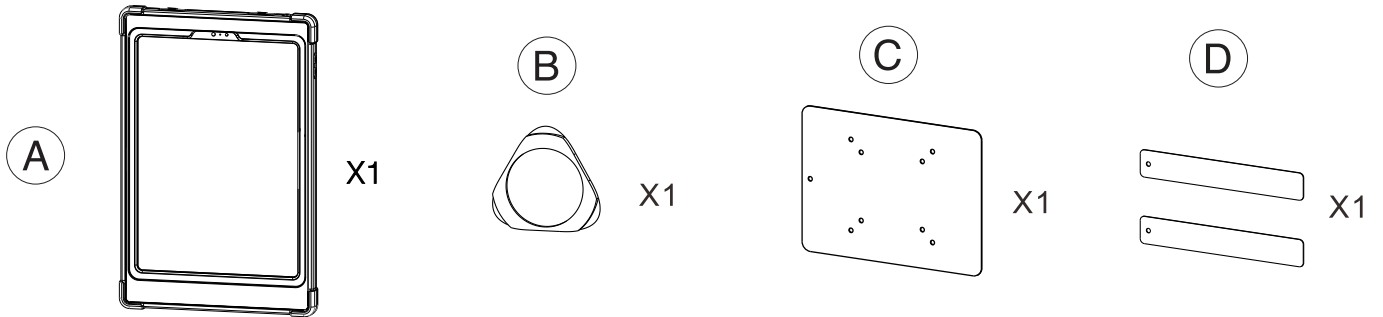

# Magnetic Splash-Proof Case and Metal Mounting Plates for iPad 10th Generation 10.9"

PAD-MSPC109 / PAD-MSPC109W

## CONTENTS:



## INSTALLATION:

### 1. INSERTING TABLET INTO ENCLOSURE

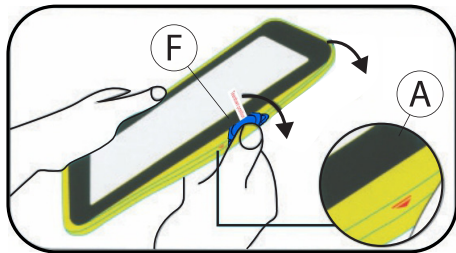

1A. Peel the external silicone sleeve from the internal hard case using component (B).

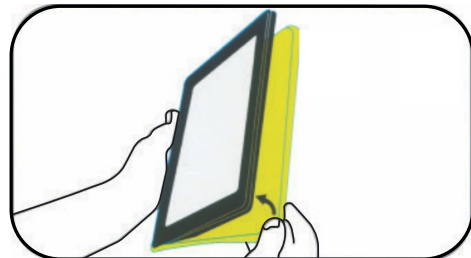

1D. Reinstall the external silicone rubber sleeve.

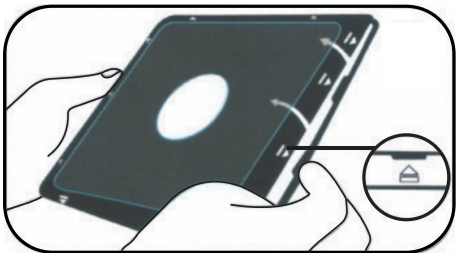

1B. To open case, apply gentle pressure to the small clips (noted on the diagram by arrows). The internal hard case will open when all four sides are unclipped.

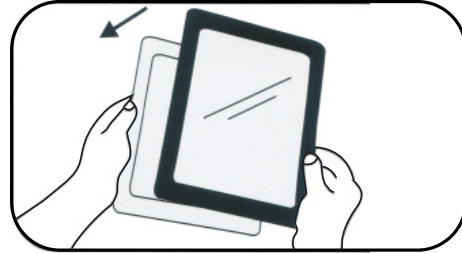

1E. Once the iPad is inside the rear cover, place the internal front cover on top and gently clip all four sides into position.

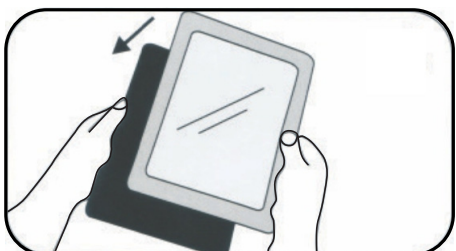

1C. Insert the iPad into the back portion of the hard cover.

## 2. HOW TO FLIP OUT KICKSTAND

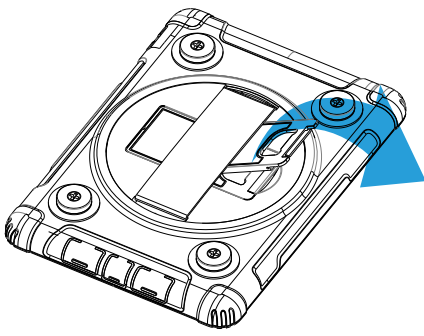

2A. Locate kickstand at case rear and fold out underneath strap.

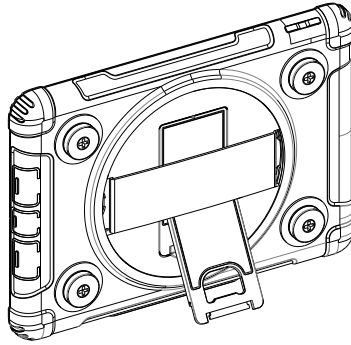

2B. Display tablet at desired viewing angle.

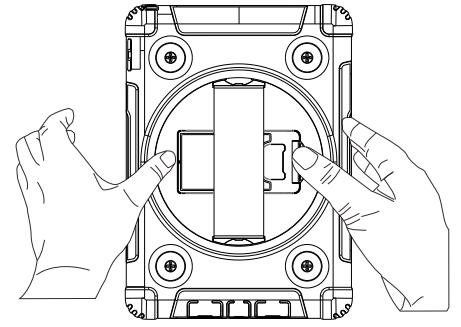

2C. Press kickstand back in to return to handheld mode.

## 3. HOW TO SETUP MAGNETIC MOUNTING PLATE

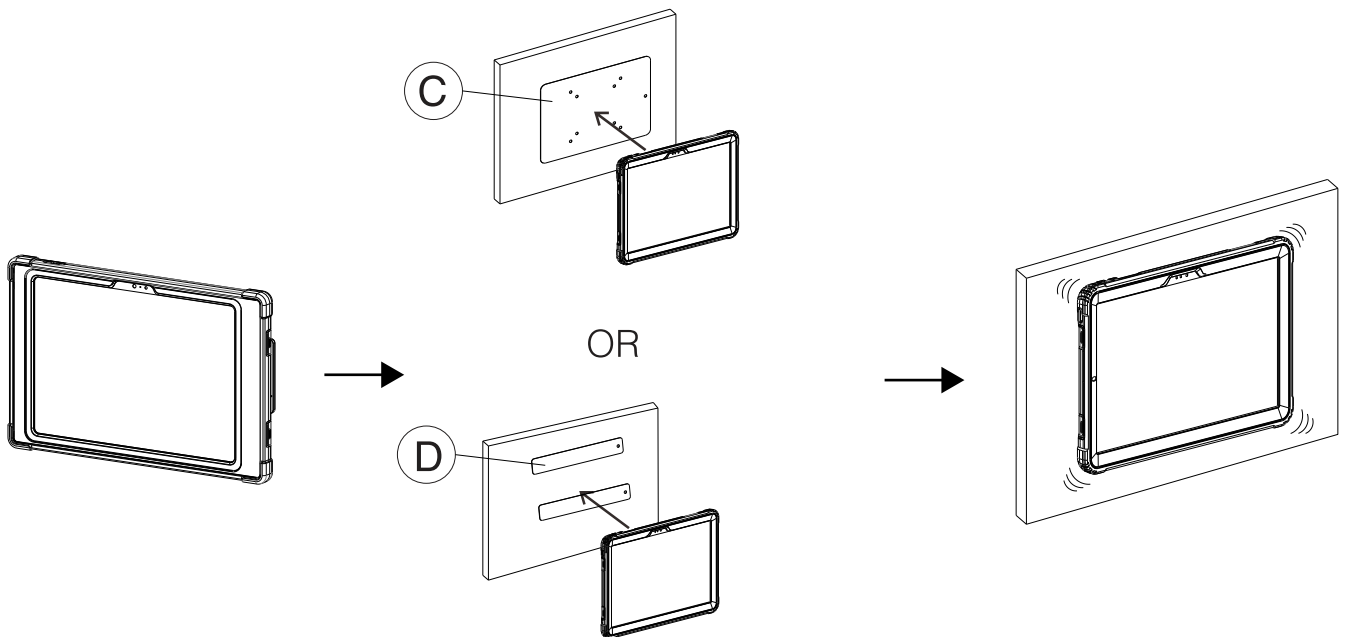

3A. First peel of the sticker backing for the adhesives on whichever mounting solution is being used (C or D). Place on wall, then place magnetic mounting case onto the plate.

## 4. ATTACHING CARRY STRAP



4A. If you have the corresponding shoulder strap (sold separately), insert the ends into the strap holes. Then tie them up and clasp the front as shown to the left.