



Custom Flex Clamp Mount with Wireless Inductive Charging Case

PAD-CFCICCS

INSTALLATION - MANUAL

Caution: For proper results, please make sure your device is properly aligned with the inductive charging plate.

Caution: Please do not place or store the product on or near high-temperature areas like heating devices, open flame, or in hot cars in extreme heat.

Caution: Please do not place or store the product in or near water, steam, or in any wet, humid, or damp places.

CONTENTS:

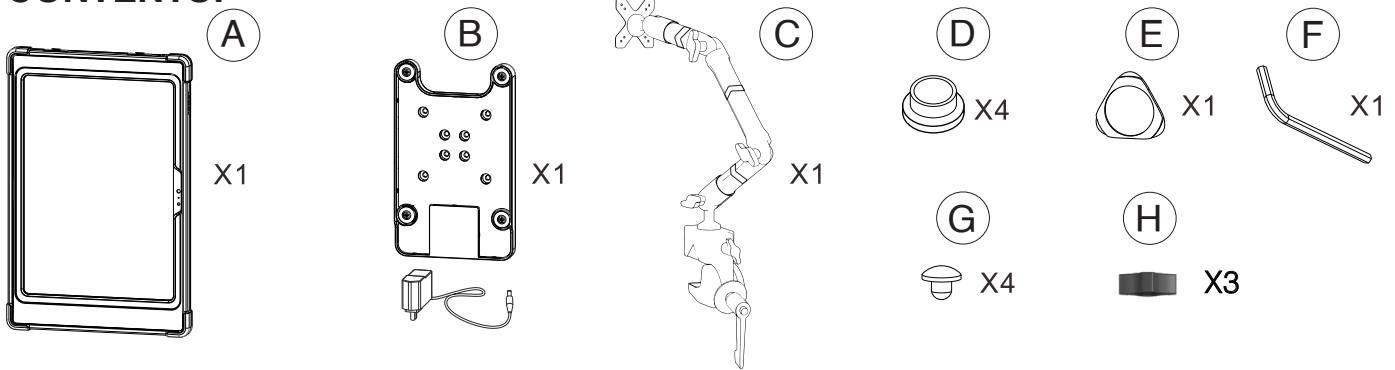

Power Supply:

Input : AC 100-240V 50/60Hz
 Output: DC12V 1.5A
 Rating power:18W
 Cable Length:1.8M
 DC Plug: 5.5*2.1mm male DC Plug

Inductive Charging Case:

Qi Standard: V1.2.4
 Input: DC12V 1.3A
 Output: DC5V 2.4A(Max.)
 Rating Power: 15W
 Efficiency: 80-85%(Max.)
 Inductive Distance:3-6mm

Input Socket: 5.5*2.1mm female DC socket
 Output Plug:Apple Lightning Plug
 Charging Time :4-4.5 hours)

Environmental Requirements:

Operating Temperature for iPad: 32°F to 95°F / 0°C to 35°C
 Nonoperating Temperature: -4°F to 113°F / -20°C to 45°C

INSTALLATION:

1. Inserting Tablet Into Enclosure

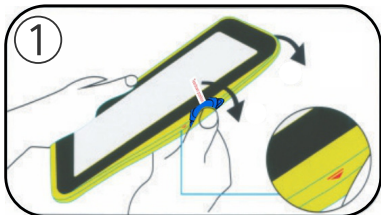

Peel the external silicone sleeve from the internal hard case using component (E).

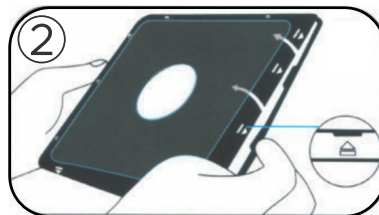

To open case, apply gentle pressure to the small clips (noted on the diagram by arrows). The internal hard case will open when all four sides are unclipped.

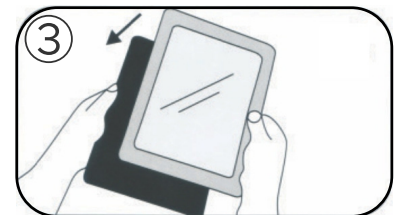

Insert the iPad into the back portion of the hard cover.

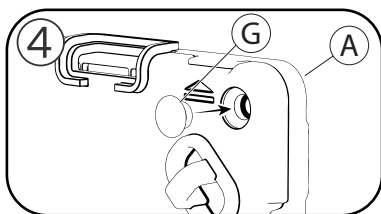

Find corner plugs (G), and insert them firmly in the the corners to complete this phase of installation.

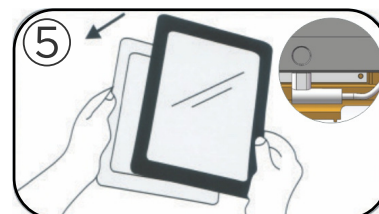

Once the tablet device is inside, plug the charging cable into the power socket. Then place the internal front (hard) cover on top of the case, and gently clip all four sides shut.

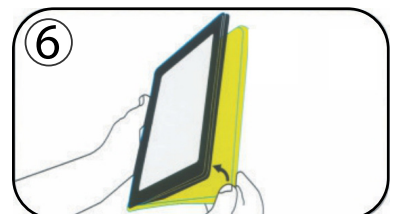

Reinstall the external silicone rubber sleeve.

2. Setting the Cover in Tabletop or Handheld Mode

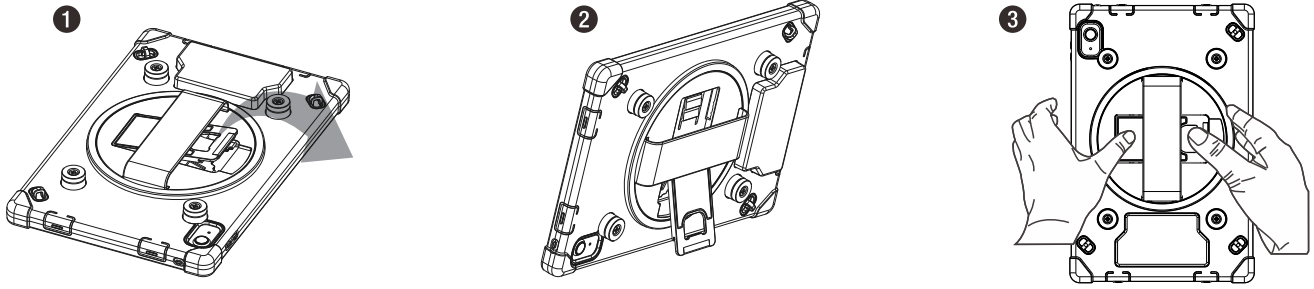

- 2A. Locate kickstand at case (A) rear and fold out underneath strap.
2B. Display tablet at desired viewing angle.
2C. Press kickstand in to return to handheld mode.

3. Setting the Cover in Tabletop or Handheld Mode

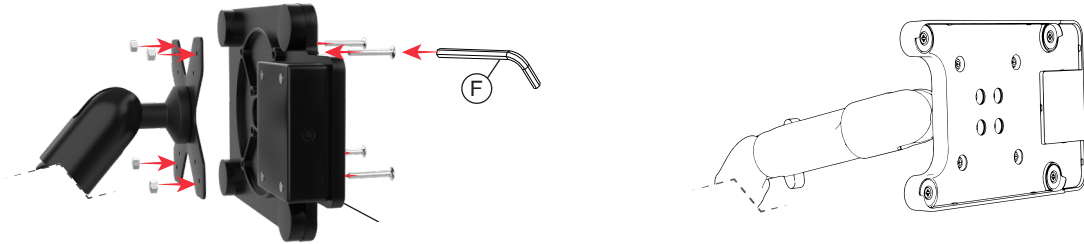

- 3A. Combine nuts and bolts through VESA plate from the front & back as shown with provided tools

4. Docking and Charging the Tablet Device

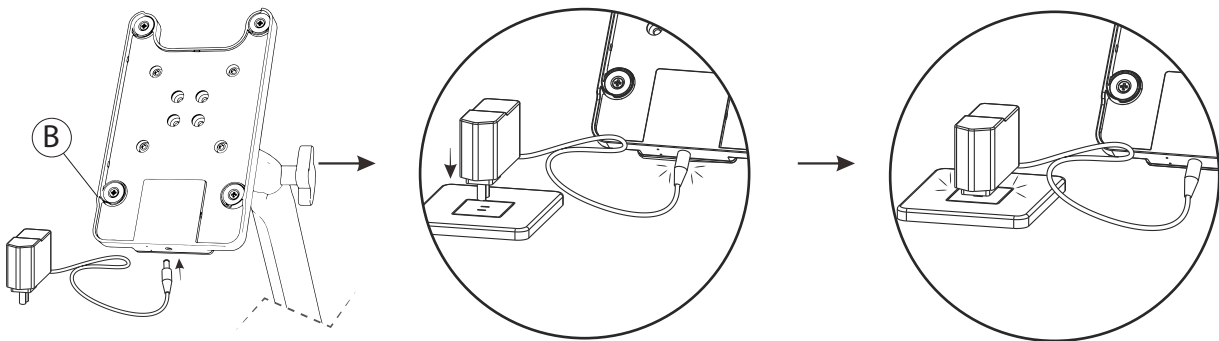

- 4A. Connect the AC/DC power supply to the charging plate as shown above.

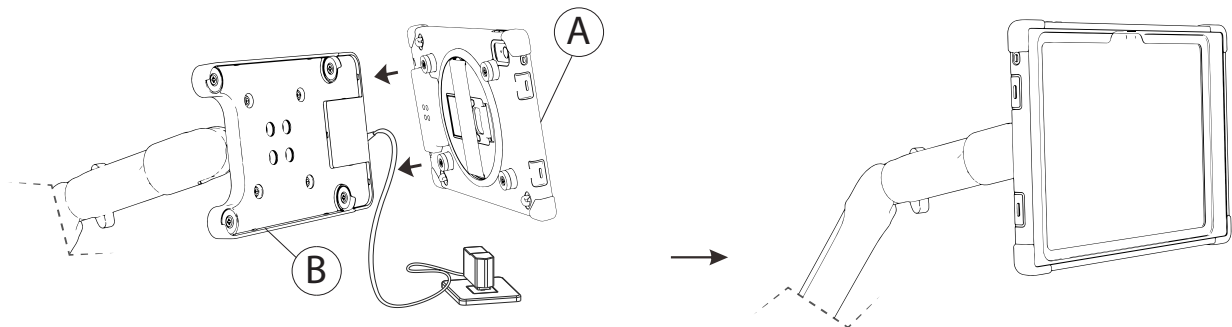

- 4B. Make sure that the charging case and the back charging plate are aligned properly. You should see a blue indicator lighting up on the back of the charging plate.

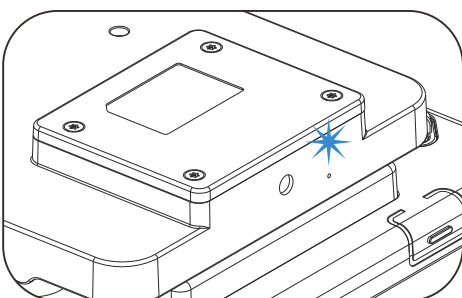

- 4C. The blue indicator light indicates that the tablet device is properly connected to the inductive charging plate.

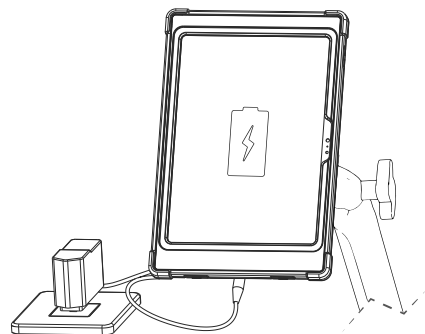

- 4D. There should be a power level indicator on the tablet screen.

5. Installing Custom Flex Security Desk Clamp Mount

DESK OPTION

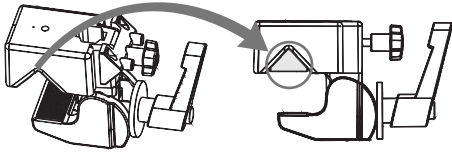

5A. Put the attached plastic insert on the side into the clamp.

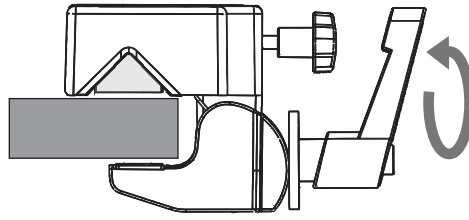

5B. Clip on the clamp to the desk then twist the lever clockwise to tighten it securely.

POLE OPTION

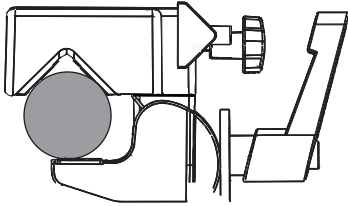

5C. Clip on the clamp to the Pole.

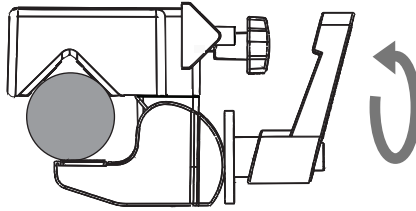

5D. Twist the lever clockwise to tighten it securely.

6. Adjusting the Flex Arm

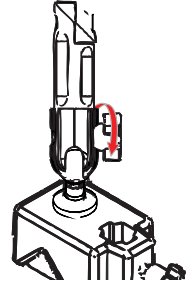
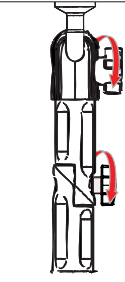

6A. Twist the SCREW KNOB of the arms anticlockwise to release the connection.
6B. Adjust the arms to your desired position and then tighten the screw knob clockwise.

7. Adjusting Any Ball Joint

CAUTION! PLEASE READ BEFORE USE!

*Disclaimer - Ball Joint Warning

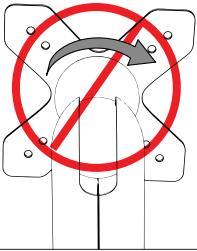

Do not attempt to adjust, tilt, or rotate any ball socket joints while it is fully tightened. Any such action will result in possible damage and loss of integrity of product functioning at full capacity. Manufacturer will not be responsible for any such actions by any person.

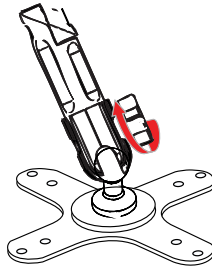

CAUTION: When adjusting the knob to control the positioning of the mount, you **MUST** loosen the knob before adjusting. If pressure is forced on the mount to move direction without loosening knob, damage could occur on the ball head.

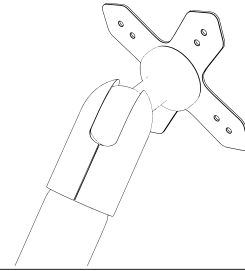

CAUTION: When changing the position of the holder, you **MUST** loosen the knob before moving. If the knob is fully tightened during the movement of the holder, the coupler could break and mount could become damaged.

8. When Attaching the Cable Bands

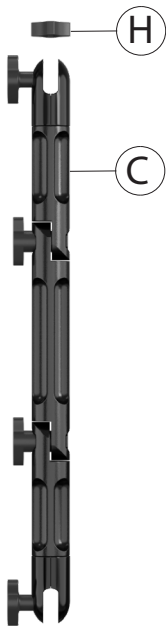

8A. Take all the cable bands (H) and stretch them open to fit around the body of the clamp mount (C).

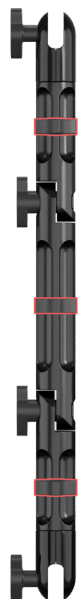

8B. Repeat the process until all the cable bands are evenly distributed onto the body of the flex mount as illustrated.

9. When Setting Up the Cable with the Bands

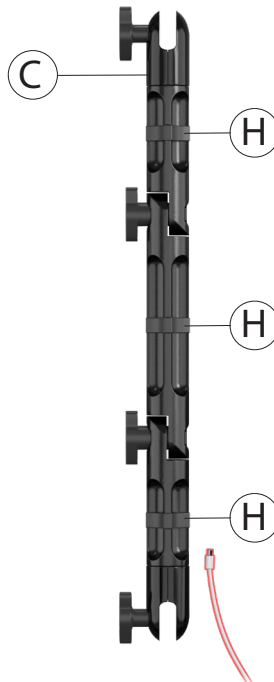

9A. Take your cable (not included) and route it alongside the body of the flex mount as neatly and tight as you can. Go through each of the cable bands so it is attached cleanly and snug to the flex mount as illustrated.

