

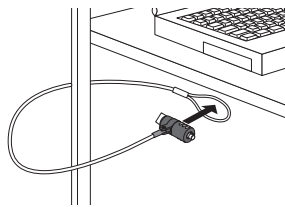

LT-PL

## Installation Manual

### How to install?



1. Loop the cable around a secure object.

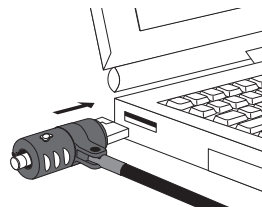

2. Put into a USB slot.

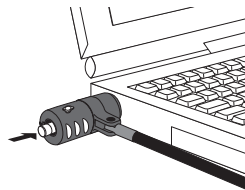

3. Push the button.

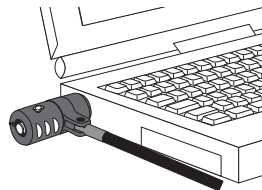

4. The USB lock is locked.

### How to unlock?

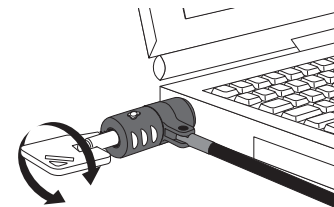

1. Put the key into the lock and turn it until hear "click!".

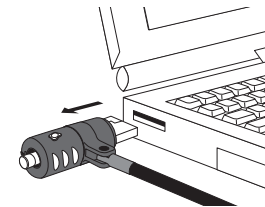

2. Pull out the USB lock.

### Attention

- Applicable only MacBook Air & Pro, and check the direction before installation.

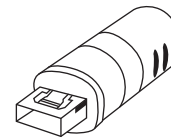
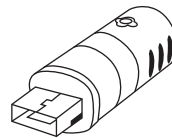

CTA DIGITAL  
Brooklyn, NY 11205  
support@ctadigital.com  
Made in Taiwan