



CTA Digital - Innovative Accessories

Product Model: PAD-SMT & PAD-SST

Thank you for choosing CTA Digital's product. We hope that you will enjoy using it. Please follow the guidelines and instructions as laid out in this instruction manual.

HOW TO SET YOUR COMBINATION LOCK

1. The pre-set combination is 0-0-0.
2. Push the Button (A) in the direction of the arrow-hold it until completing the next step.
3. Turn the Dial (B) to your desired personal combination.
4. Release the Button (A) now the lock will open at the desired combination (check to be sure the button moves freely at this combination. Before turning the dials to lock the case, write down your combination and put in a safe place.)

OPERATION

1. Make sure the suction cup (3), the installation surface and the surface of the device to be mounted are clean, grease-free, dust-free and dry.
2. Place the suction cup on the installation surface and apply some pressure.

ADJUST THE ANGLE

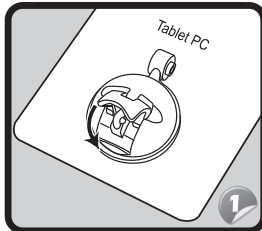
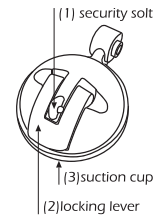
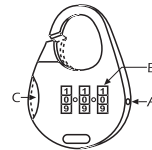
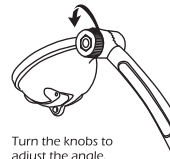

Place the suction on the Tablet PC, then push the locking lever (2) to install.

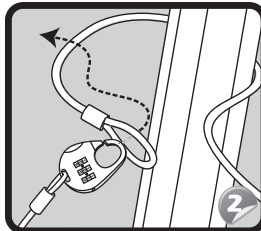

Loop the cable around a secure object.

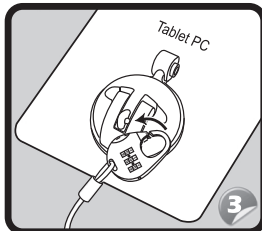

Insert the lock into the security slot (1) of the sucker lock.

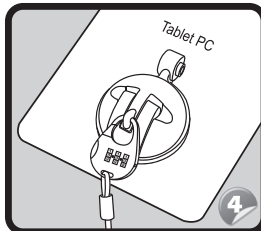

Installation is complete.