

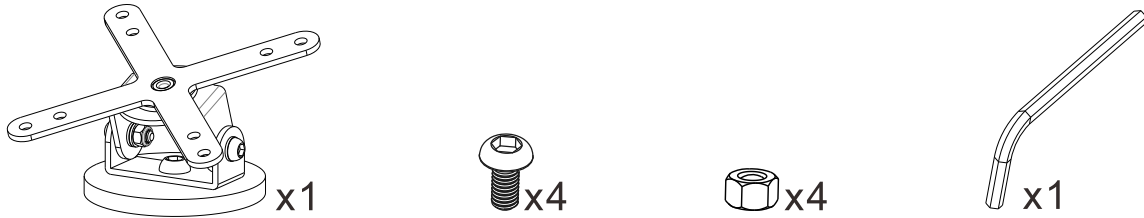

VESA Compatible Heavy-Duty Magnetic Mount

ADD-VFLOATM

INSTRUCTION - MANUAL



1. Installing a VESA compatible component example

**Tablet Enclosure is not included and only being shown as an example

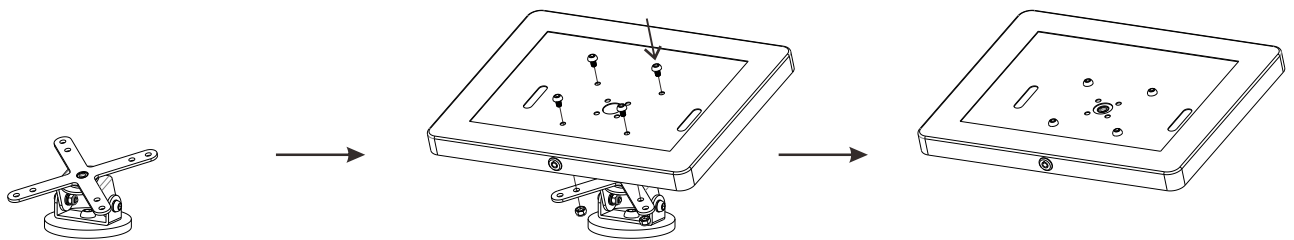

2. Side view of magnetic VESA mount with enclosure example

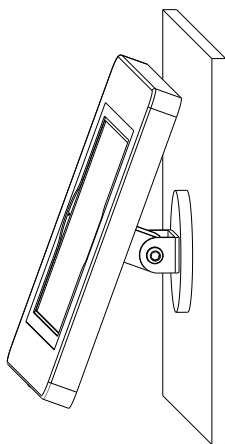

**Tablet Enclosure is not included and only being shown as an example