



ADD-GYM

Cup Holder and Towel Rack Gym Buddy Add-On for CTA Digital Floor Stands

INSTRUCTION MANUAL

Thank you for choosing CTA Digital's product. We hope that you will enjoy using it.
Please follow the guidelines and instructions as laid out in this instruction manual.

Maximum Weight Loading: 10 lbs/5.0 kgs

Package Contents:

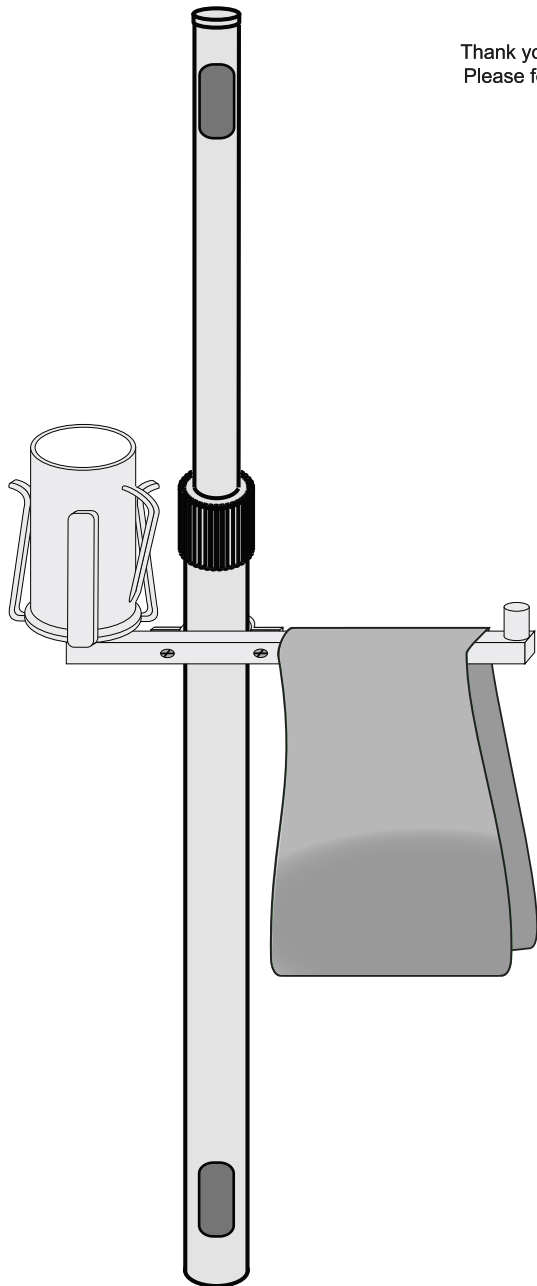
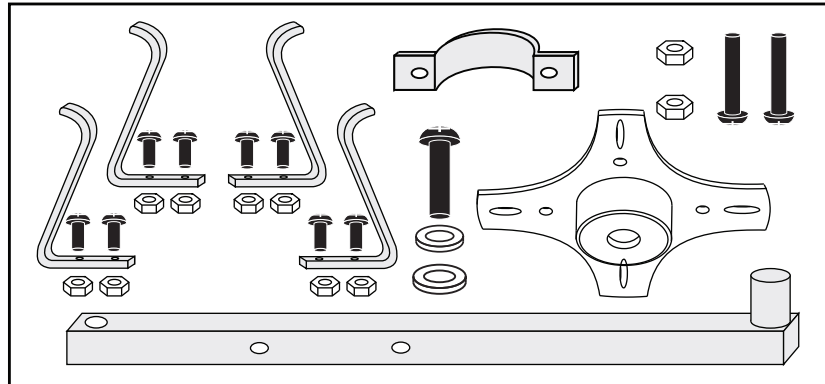

Instructions:

1. Attaching the Cup Holder to the Towel Rack

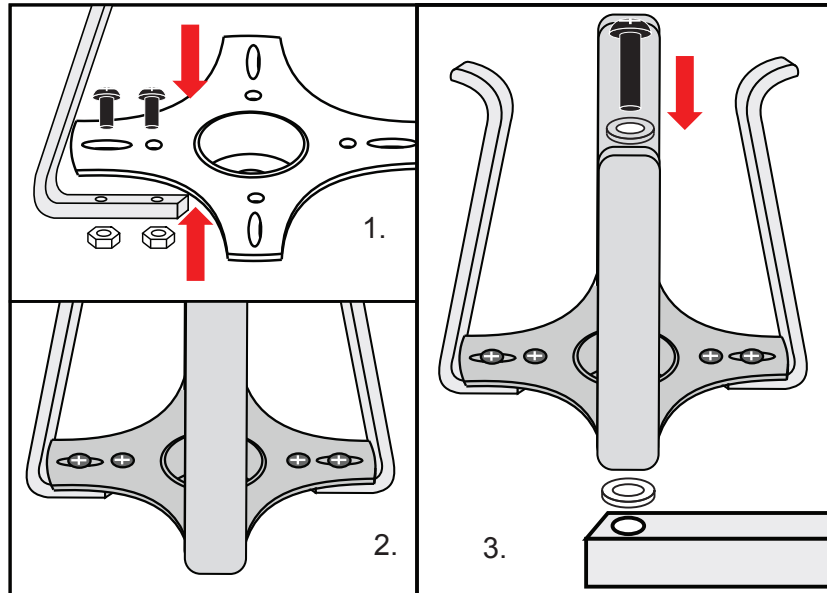

1. Align cup holder arms with base plate holes. Pass screw through holes and screw nut on underside. Repeat for all screws.
2. Align cup holder hole with towel rack hole, then pass screw through washer, cup holder, second washer. Screw onto towel rack.

2. Attaching Cup Holder and Towel Rack to the Pole

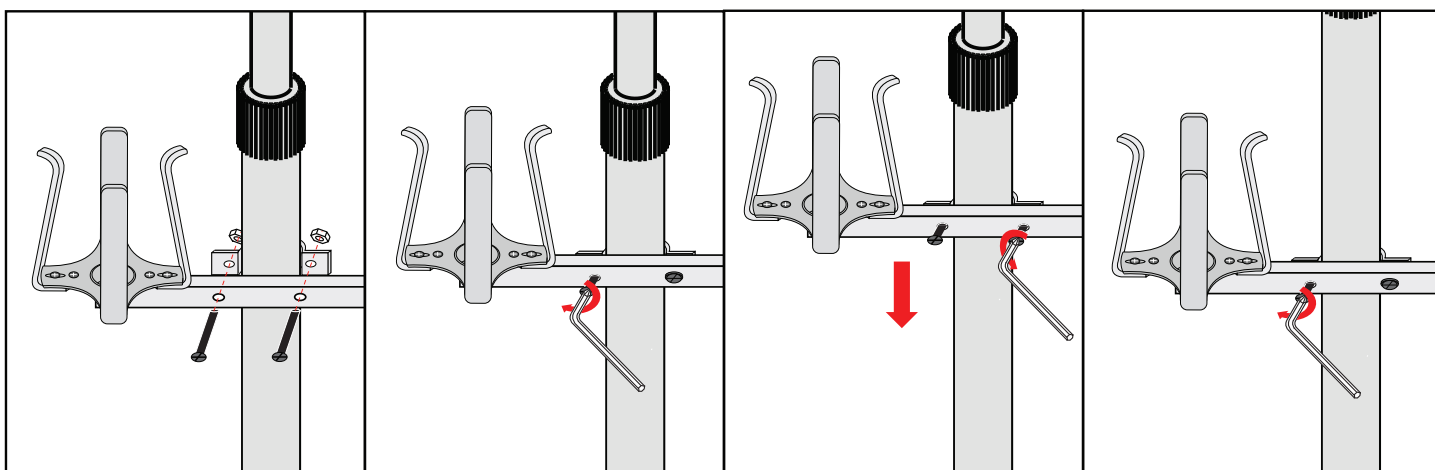

Align towel rack holes with grip holder holes on opposite sides of pole, below height-adjust ring. Pass screws through holes, then tighten at other end with nuts. Use Allen key while holding nut to tighten further.

To adjust position on the pole, loosen nuts with Allen key, move to desired orientation then tighten nuts again.