

Night Light Quick Start Guide

Product Overview

Thank you for purchasing our products. Please read the guide carefully before you use the product and keep it properly for future reference.

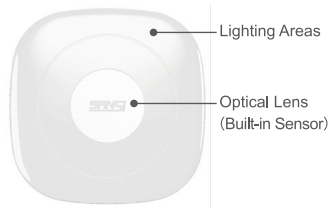

How to Use

- Installation: Adhesive / Suspensible.
- Batteries Loading: Rotate the battery cover counterclockwise as shown in the following figure to take it off and load 3 AAA batteries, then put the battery cover back and rotate clockwise to secure it.

Warranty & Contact

5-year warranty

Email: service@sansitech.us

Web: www.sansiled.com

SANSI

1

SANSI

2

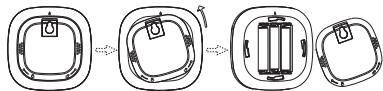

- The night light only works in dark environment.
- The night light automatically lights up for 15s upon every movement in the dark and the motion sensor can detect the movement up to 4 meters away with a span of up to 100-degrees.

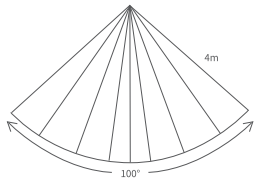

3



- The sensor of the night light cannot be triggered and the night light does not work if the environment is too bright and this does not belong to quality problems.
- Pay attention to the polarity when loading batteries.
- The induction area cannot be covered with any objects, otherwise the sensor sensitivity will be affected.
- Please replace the batteries in time if less brightness or shortened lighting time found.

4

Technical Data

Rated Power: 1W

Color Rendering Index: ≥ 80

Luminous Flux: 40lm

Correlated Color Temperature: 3000K

Sensitive Induction: $\geq 10\text{lux}$ Off; $\leq 3\text{lux}$ On

Infrared Induction Distance: 4m

Induction Angle: 100°

Induction Working Time: 15 seconds

Operating Ambient Temperature: $-10^\circ\text{C}\sim 40^\circ\text{C}$

Net Weight: 60g (Batteries excluded)

5

Cautions

1. Read the instruction manual thoroughly before first use. Follow all the safety instructions and information.
2. Ensure the voltage given on the rating label or in the instruction manual complies with the power supply.
3. Do not stare at the operating light source or direct the beam at other people or animals to prevent eye damage.
4. Install the product according to the intended use and as described in this manual.
5. Do not place the product near a heat source or exposed fire source, such as an electric heater or oven, fire, candle, or other places that may produce high temperature.
6. For indoor use only! Do not expose the product to rain or wet location.
7. Keep the children or pets away from the product and its accessories during assembly to avoid personal hazard and product damage.

6