



BEFORE + AFTER FAMILY ROOM

A chandelier above the dining table helps define the new eating area off the kitchen. Upgraded pantry doors and a herringbone tile floor set off the table and painted sideboard. Bifold doors: *The Home Depot*. Chairs: *Arhaus*

Homeowner Ashley designed the fireplace surround and mantel, which was made from a beam she salvaged from a 19th-century barn.



homeowner tip

ASHLEY HARDING, FONTANA-ON-GENEVA-LAKE, WI

“Take it slow. You have to understand how a space is going to be used before you can make a plan, and you can’t know that until you’re really living in it.”



Applying grasscloth above a chair rail and paint below it made good use of a pricey wall covering. Six-inch crown molding highlights the now 8-foot ceiling height.

AFTER

The footprint stayed the same in the 380-square-foot space, but removing a drop ceiling, an overhead divider, and lots of paneling made it feel twice as large

1. Raised the ceiling height about 8 inches by removing a drop ceiling with faux beams; took out a section of lowered ceiling that separated the room from a window-lined seating area with three skylights overhead.

2. Made over the fireplace with a custom surround and mantel designed by the homeowner.

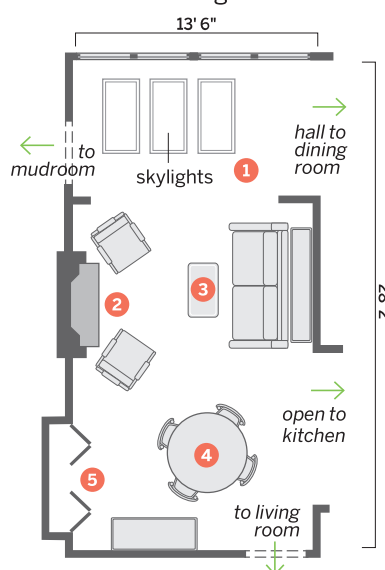

3. Arranged a sofa, ottoman, and two chairs around the new focal-point fireplace, and hung a modern chandelier above the new seating.

4. Created a casual dining spot off the kitchen by adding a 50-inch round table, a sideboard, and a second chandelier.

5. Upgraded the pantry doors from louvered ones to a more substantial paneled design.