

Tech Note: V7 IFP Bytello Registration and Device Enrollment

Remote Bytello DMS is a web-based software that simplifies the management of your campus equipment. With the DMS software, you can enjoy fleet management functionality for your interactive flat panels. Options include status monitoring, panel grouping, time and channel switching, volume control, and information bulletins. Everything you need is available in the same unified space.

Registration

1. If you want to get a license for the Remote Bytello DMS Software for your IFP, please email v7ifplicense@ingrammicro.com with the following information:
 - Copy of your IFP receipt
 - IFP Serial number(s)
 - Name
 - Email Address
2. V7 will send an invitation to register the email address you provided above which you must fill out. Please make sure to check your spam filter if you don't receive it within business days.
3. Once the registration is filled out, V7 will approve and activate your license.
4. Now you will be able to sign in to use the web application at dms.bytello.com

Device Enrollment

1. Log in with your account at <https://dms.bytello.com>
2. Click **Enroll** at the top

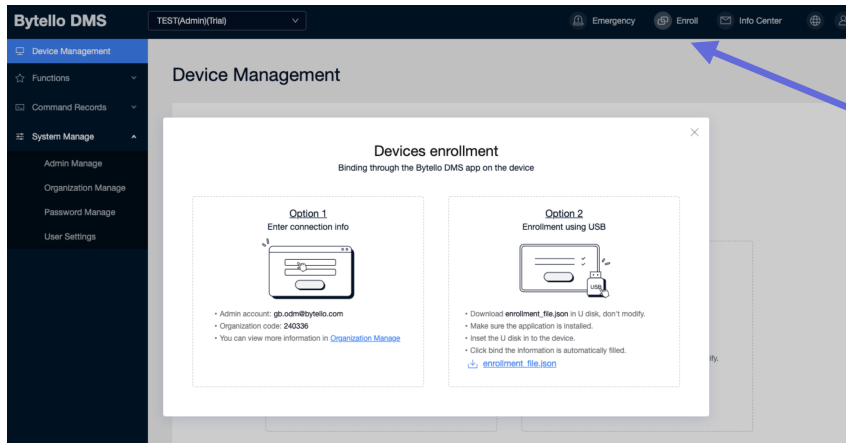

- Open the Bytello DMS remote app on the IFP (if you don't have it on your IFP, you can download the APK here: <https://www.bytello.com/dms>)

Option 1: Enter the enrollment information

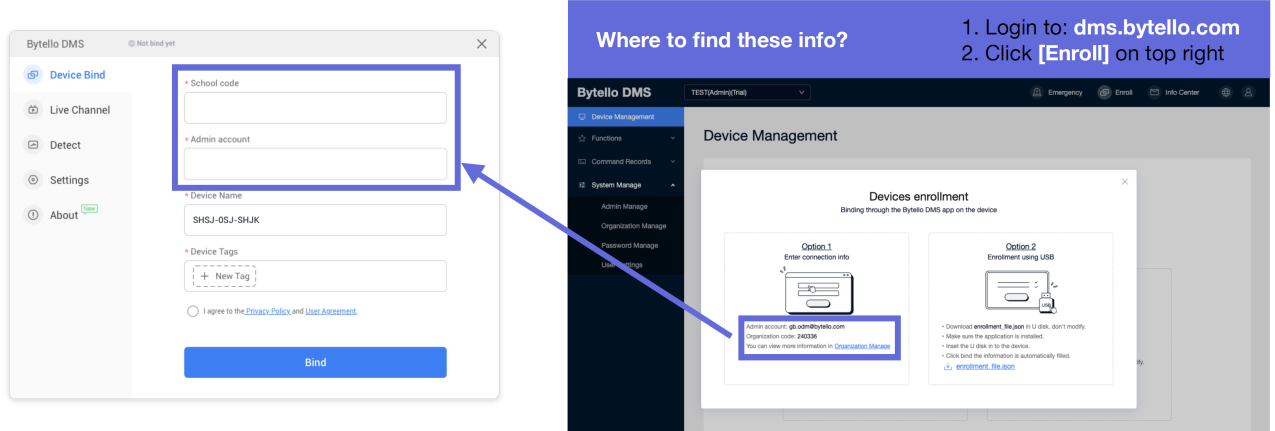

Option 2:

- Downloads the enrollment_file_json to the root folder of a USB Flash Drive
- Insert the USB Flash Drive into the IFP
- The information will be autofilled. Confirm and bind the device.

Note, if you have difficulty binding the device, please check your internet connection and make sure TCP ports 8888 and 8883 are open.

Wake on LAN (WOL)

Wake on LAN is required for the Bytello DMS Power on command. If the IFP is powered off, it can be remotely powered on using the Remote Bytello DMS software, but a Windows computer with the WOL software enabled must be on the same network as the IFP.

1. Enable WOL on the IFP

Press [input] [1] [3] [7] [9] to open Debug menu

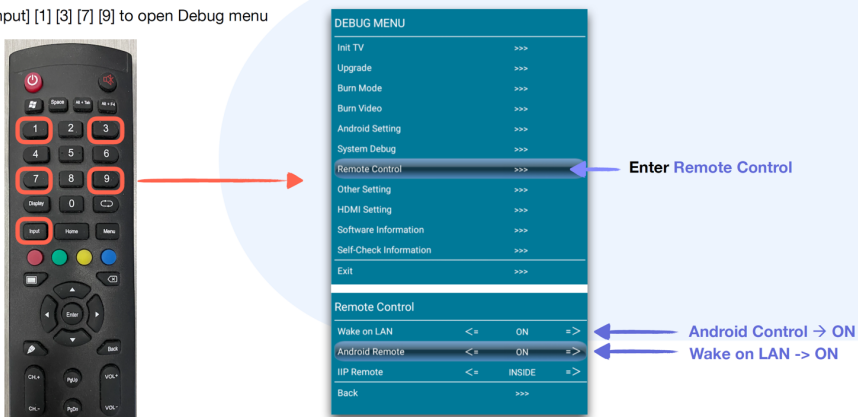

- Install the WOL.exe software on the Windows computer (download from <https://www.bytello.com/dms>)

- Open the WOL software on the Windows computer and connect (make sure your IFPs on the same Local Area Network are already enrolled and bound)

Find binding code

1. Login to: dms.bytello.com
2. Go System Manage -> School Manage
3. Find School code

- Check the WOL server status

Check WOL

1. Login to: dms.bytello.com
2. System -> Organization -> Server Management

WOL Server **connected** to Organization.
WOL **server is online**.
Two devices detected by the WOL server.

No server been setup

WOL Server **is not connected** to Organization.

No devices detected

WOL Server connected to Organization.
But **there is no devices detected** by the WOL server.
Check devices and WOL are under the same local area network.

If you are still having difficulty with WOL, try setting up WOL on the Windows computer (which must be on the same Local Area Network) before you enroll your devices. Make sure your computer's Ethernet adapter supports WOL.

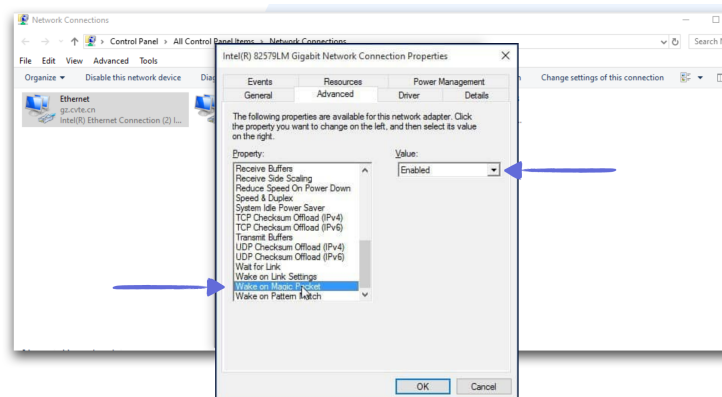



BYTELLO DEVICE
MANAGEMENT SYSTEM

USER GUIDE

TABLE OF CONTENTS

1.Introduction	4
2.Send a command	5
2.1 Select & send	5
2.2 Time mode	6
2.2.1 Execute Now	6
2.2.2 Timed mode	6
2.2.3 Recurring mode	6
2.3 Offline mode	6
2.3.1 Offline Mode Definition :	6
2.3.2 Offline Command Recall :	7
2.3.3 Application Scope and Impact :	7
3. Device Manage	9
3.1 Device control	9
3.1.1 Power on	9
3.1.2 Power Off	9
3.1.3 Reboot	9
3.1.4 Bells	10
3.1.5 Screen Lock	11
3.2 Message	12
3.2.1 Notification	12
3.2.2 Announcement	12
3.2.3 File Publish	13
3.2.4 Emergency	14
3.2.5 Live channel	14
3.3 Device settings	15
3.3.1 Image mode	15
3.3.2 Sound mode	15
3.3.3 Power state	16

3.3.4 Android state	17
3.3.5 Wallpaper	17
3.3.6 Logo	18
4. Advanced function	19
4.1 Applications	19
4.2 Android Input Switch	20
4.3 DMS software update	20
5. Records	22
5.1 Execution historY	22
5.2 Command in schedule	23
5.3 Command record details	23
6. System manage –ADMIN manage	25
6.1 Add a sub–admin	25
6.1.1 Input email address	25
6.1.2 Authorize Devices	25
6.1.3 Authorize Commands	26
6.2 Sub–admin manage	26
6.2.1 Sub–admin list	27
6.2.2 Sub–admin Details	27
7. systeM manage	28
7.1 organization manage	28
7.2 Server manage	28
7.3 Password manage	29
7.3.1 Bytello DMS LOCK	29
7.3.2 Screen LOCK	29
7.4 User settings	29
7.4.1 personal information	30
7.4.2 About	30

1. INTRODUCTION



Bytello DMS is a web-based software simplifies the management of your campus equipment.

With the DMS software, you can enjoy cluster management functionality for your interactive flat panels. Options include status monitoring, panel grouping, time and channel switching, volume control, and information bulletins. Everything you need is available in the same unified space.

2.SEND A COMMAND

2.1 SELECT & SEND

2.1.1 First select the equipment;

2.1.2 Then select the function and enter the function editing window;

2.1.3 Finally, make necessary edits in the function pop-up window and issue instructions.

2.1.4 Time selector

Principle: Do not choose the past time

Time alignment: according to the selected device, the later device is located in the time zone (UTC max) display

For example: UTC-4 UTC-6 UTC-8 three devices are selected at the same time, and enter the timed mode to select date + time to set the boot command. The time selection period at this time will be displayed according to the time of UTC-4

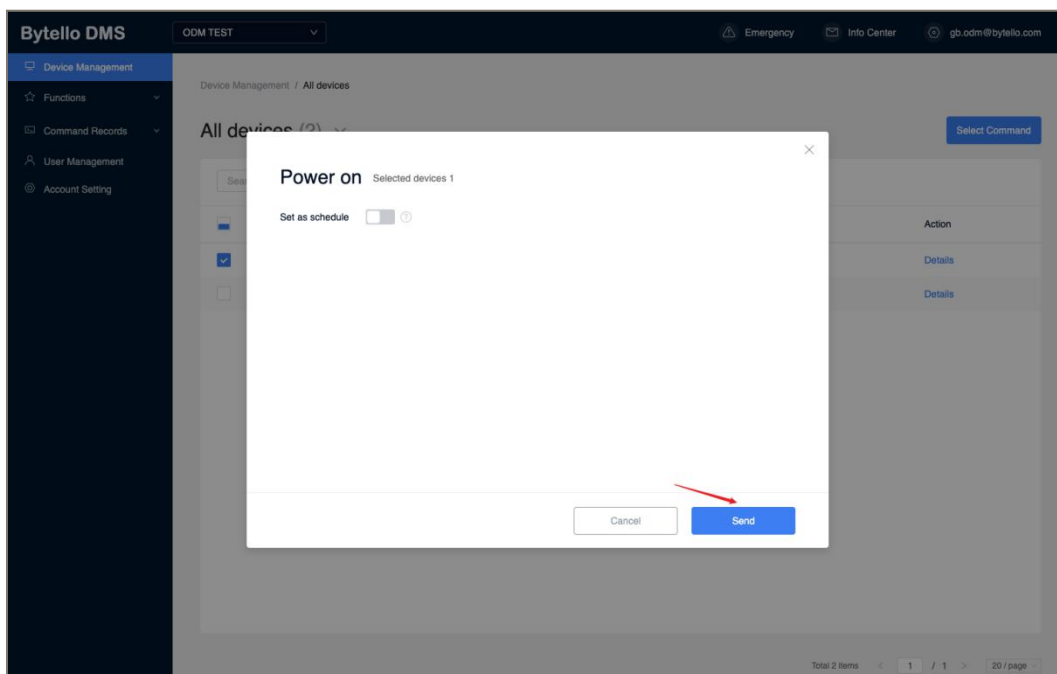

2.2 TIME MODE

2.2.1 EXECUTE NOW

Send the instruction immediately. After entering the function editing window, click Send directly to send and execute the instruction immediately.

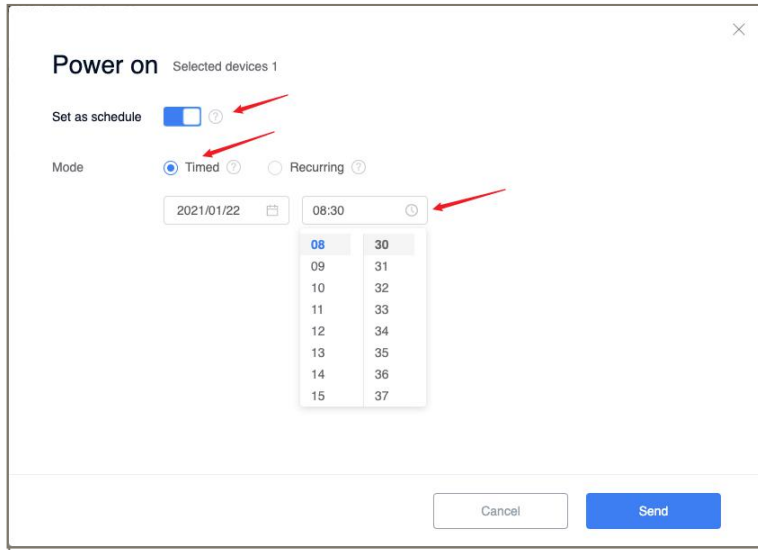

2.2.2 TIMED MODE

Select (future) year, month, day, and time to send instructions

2.2.3 RECURRING MODE

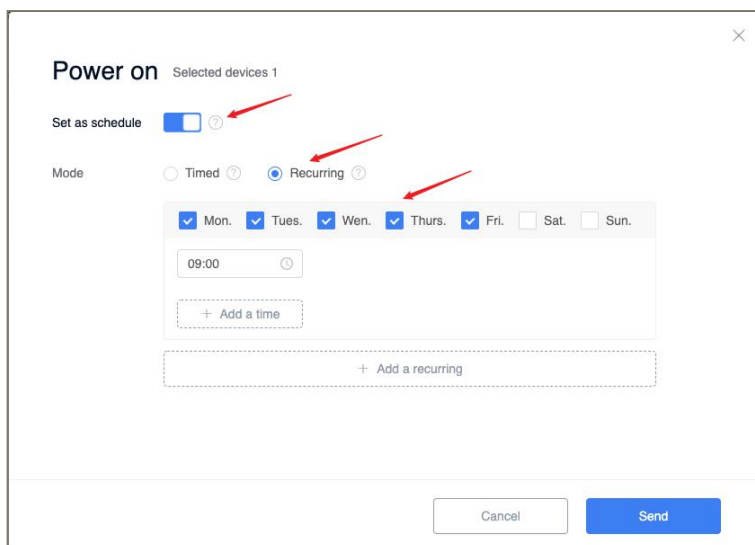

Specify the cycle to send instructions periodically

2.3 OFFLINE MODE

2.3.1 OFFLINE MODE DEFINITION :

Offline mode means that for Timed and Recurring type commands, after the device successfully receives the command for the first time. If the network is disconnected at the execution time, the device can still execute this command.

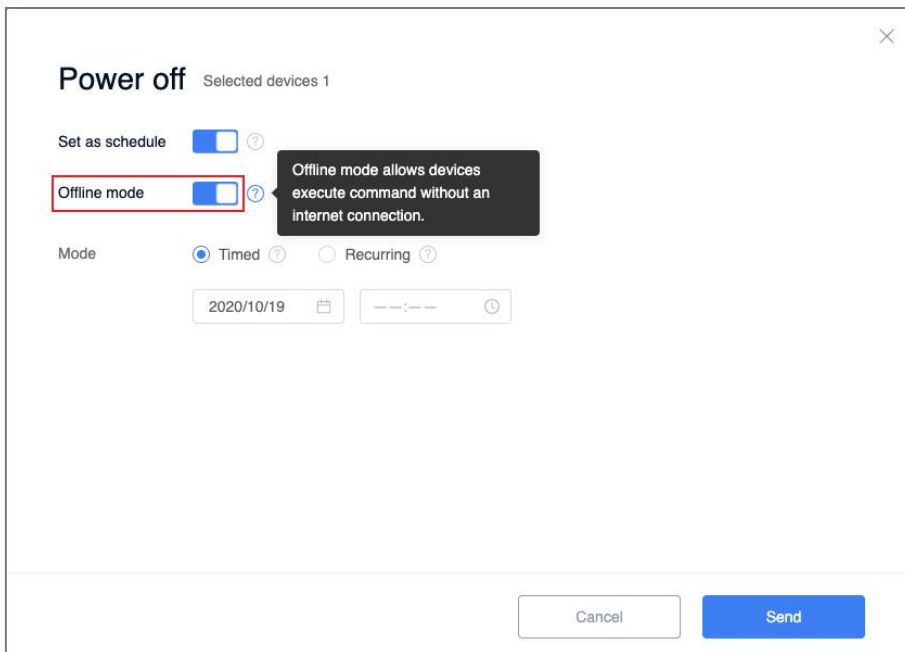

2.3.2 OFFLINE COMMAND RECALL :

If it is necessary to recall/cancel an offline command, the target device needs to be in the network connection state, and the command is withdrawn by the sender. The order withdrawal is consistent with other ordinary orders.

2.3.3 APPLICATION SCOPE AND IMPACT

2.3.3.1 Power off – offline mode

Default state: offline mode is off

Users can choose to turn on/off. After the device is turned on, if the device successfully receives the instruction, the device can still perform the shutdown successfully according to the set time when the device is not connected to the Internet.

2.3.3.2 Reboot – offline mode

Default state: offline mode is off

Users can choose to turn on/off. After being turned on, if the device successfully receives the command, the device can still restart according to the set time when it is not connected to the Internet.

2.3.3.3 Screen Lock – offline mode

Default state: offline mode is open, and the user cannot close it.

After successful reception, the device can still execute according to the set time when it is not connected to the Internet; if the Internet is interrupted during the lock screen process, the lock screen command will still be executed without being affected by the Internet;

3. DEVICE MANAGE

3.1 DEVICE CONTROL

3.1.1 POWER ON

Support three time modes

The principle is to complete the wake-up action through the 2G network in the chip when the device is turned off.

The remote boot function relies on the establishment of Wake On LAN. Need to install Bytello DMS WOL on a PC system.

Keep Bytello DMS WOL turned on and be in the same network environment as the controlled device, you can use the remote wake-up function.

After the command is issued, if the device does not have a wake-up server installed, the execution result is a failure.

Send the Power on command to the booted device, and the execution result is successful.

3.1.2 POWER OFF

Support three time modes

Support offline line mode

When the shutdown instruction is reached, a second confirmation pop-up window will appear in the equipment section. If a user does not want to shutdown, he can reject the shutdown instruction. If you do not click to reject within 10s, the shutdown will be executed.

Send the Power off command to the shutdown device, and the execution result is a failure.

3.1.3 REBOOT

Support three time modes

Support offline line mode

When the restart instruction is reached, a second confirmation pop-up window will appear in the equipment section. If a user does not want to restart, he can reject the shutdown instruction. If you do not click to reject within 10s, a restart will be performed.

Send the Power off command to the shutdown device, and the execution result is a failure.

3.1.4 BELLS

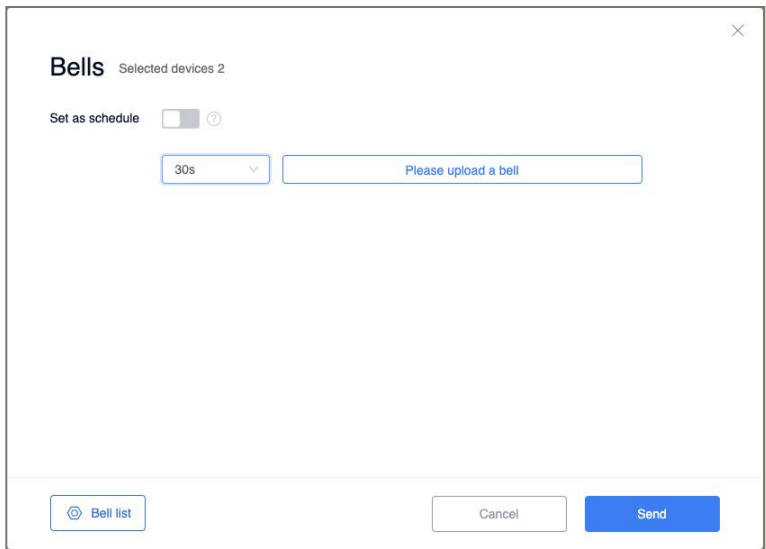

Support three time modes

The ringtone function supports playing music for a fixed length of time on the target device at a specified time. Support playing 10s, 20s, 30s, 60s and play whole song..

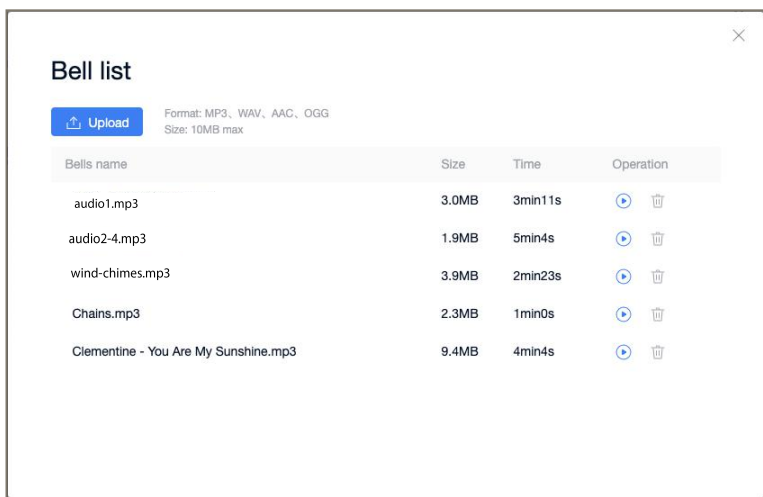

Support local uploading of music files. Successfully uploaded files will be stored in the bell list.

3.1.5 SCREEN LOCK

Support three time modes;

The screen lock function supports to lock the specified device within a certain period of time.

Screen lock function sending

After the device is locked, no software operations are allowed, and the remote control cannot be used.

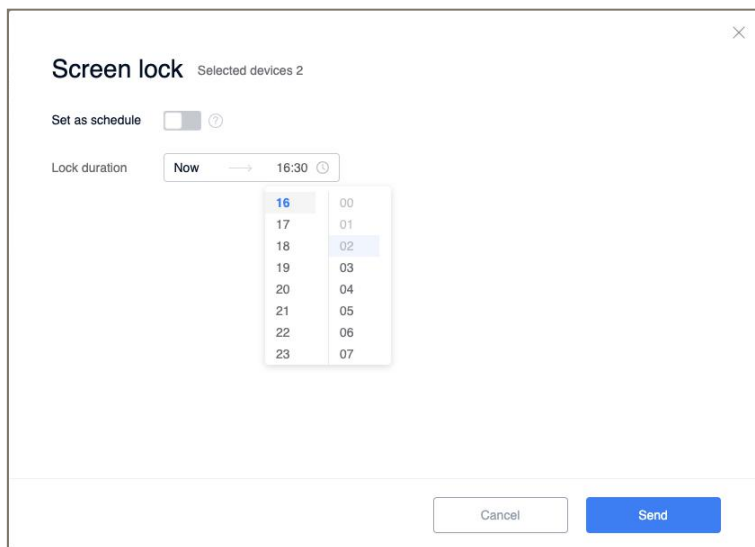

The single lock time period of the device is locked until 23:59 of the day at the latest; the screen cannot be locked across days.

Screen lock password setting

Find screen lock in the setting → Password manage page, and set a 6–digit password

Screen lock unlock

1. It will be automatically unlocked when the screen lock end time is reached
2. The device will be automatically unlocked when it reaches 23:59
3. During the locked time period, enter the password on the target device to use the target device normally. If there is no operation for 20 minutes after unlocking, the device will be locked again and you can enter here with a password. The password of the screen lock can be viewed in the setting page of admin/Sub-admin.

4. On the command records page by admin/sub-admin, for a single lock screen command, unlock Unlock, unlock means to cancel the lock on the target device during this time period.

3.2 MESSAGE

3.2.1 NOTIFICATION

Text notification, supports three time modes

Enter the text and display it as a text marquee subtitle on the target device; support to set the number of cycles: 1time, 3 times, 5 times, 10 times and 20 times.

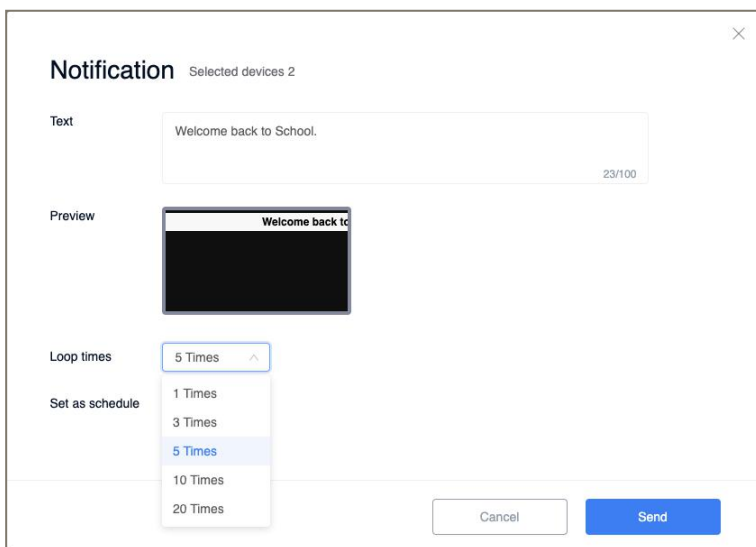

The screenshot shows a 'Notification' configuration window with the following elements:

- Title:** Notification Selected devices 2
- Text:** A text input field containing 'Welcome back to School.' with a character count of 23/100.
- Preview:** A small window showing the text 'Welcome back to' on a black background.
- Loop times:** A dropdown menu currently set to '5 Times', with options for 1 Times, 3 Times, 5 Times, 10 Times, and 20 Times.
- Set as schedule:** A label indicating the notification can be scheduled.
- Buttons:** 'Cancel' and 'Send' buttons at the bottom right.

Information closing: After reaching the set number of times, it will be closed automatically; the user can click to close at any time during the playback.

3.2.2 ANNOUNCEMENT

Support three time modes

Multimedia notification function, support the information release of pictures and video formats. A large window is displayed on the target device with a close button.

The information in the picture format is closed by the end user. The video information is automatically closed after playing once, or the end user can click to close during the broadcasting process.

Support local upload of multimedia files. Upload the successfully file and save it in the

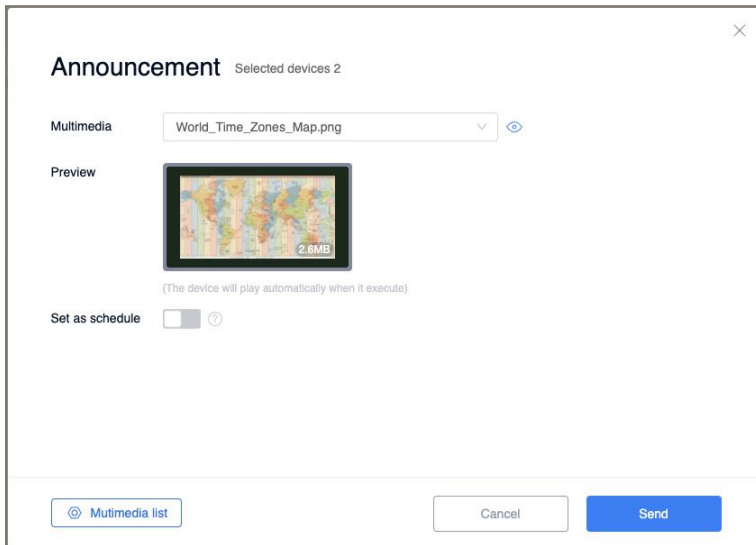

multimedia list.

3.2.3 FILE PUBLISH

Support immediate sending + regular sending, not cyclic sending

The file transfer function can push and store any type of file to the centralized control temporary folder of the target device.

Support for uploading files locally and storing them in the File list

After successfully distributed to the temporary folder of the target device, it will be notified via a pop-up window

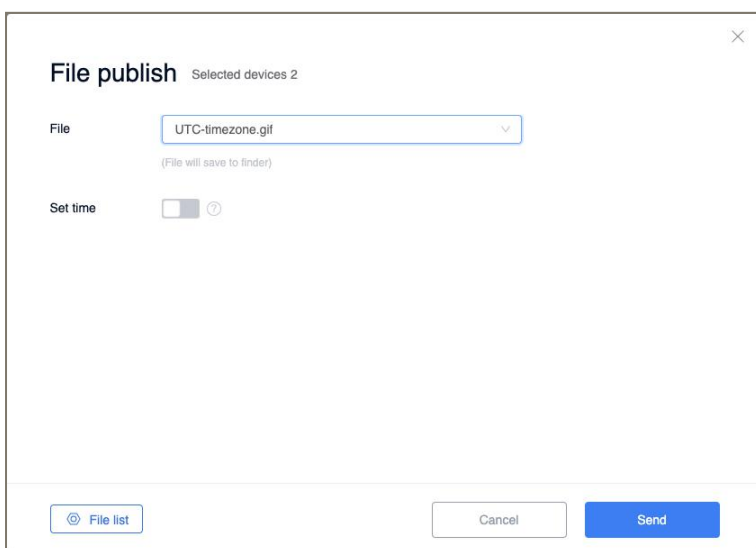

Support for uploading files locally and storing them in the File list

3.2.4 EMERGENCY

Features

Emergency information function, only supports Execute Now to send immediately; all devices in the current school are selected by default;

Emergency has a preset warning template, which can be sent directly after changing the text in the template;

Support for uploading pictures locally and storing them in the Emergency resource table;

After the emergency information is sent, it will be displayed as a full-screen information display on the target device, and the user cannot close it by himself;

Emergency information recall

When the emergency information is sent, a red light effect representing a warning will be displayed on the top bar of the web. Go to the emergency page again and click Recall to cancel the emergency release.

Device permissions for emergency information

Emergency command permissions are different from other command permissions. If the sub-admin has the permission to send emergency commands, the emergency command issued by default is valid for all devices in the school.

For more information about Sub-admin, please refer to 7

3.2.5 LIVE CHANNEL

Features

A live channel can be established and broadcast on the device at regular intervals.

Resource support format: RTMP/RTSP. Example: `rtmp://live.hkstv.hk.lxdns.com/live/hks`

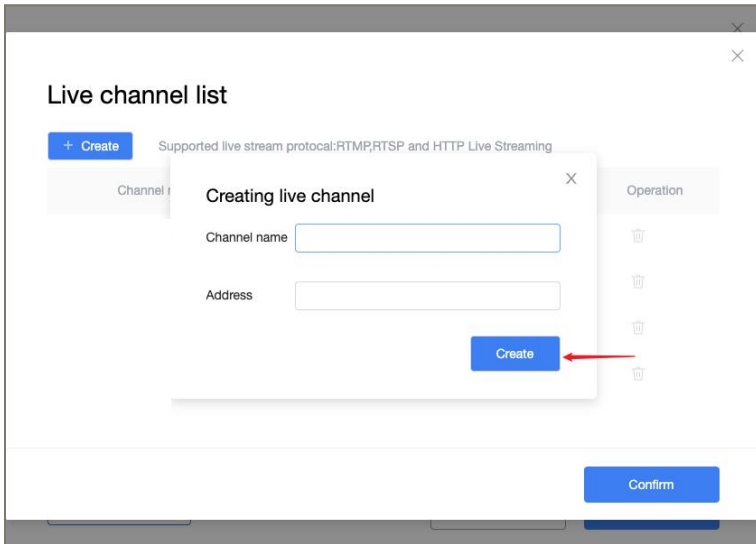

Apple HLS (HTTP Live Streaming). Example: <http://ivi.bupt.edu.cn/hls/cctv1hd.m3u8>

3.3 DEVICE SETTINGS

3.3.1 IMAGE MODE

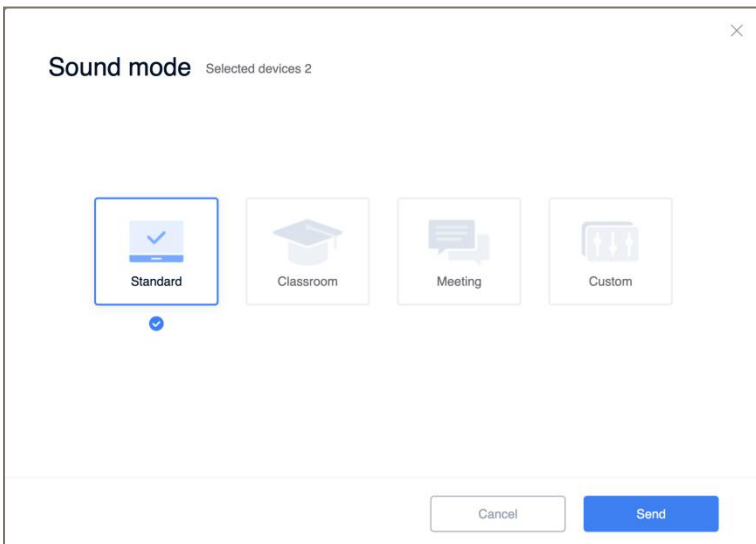
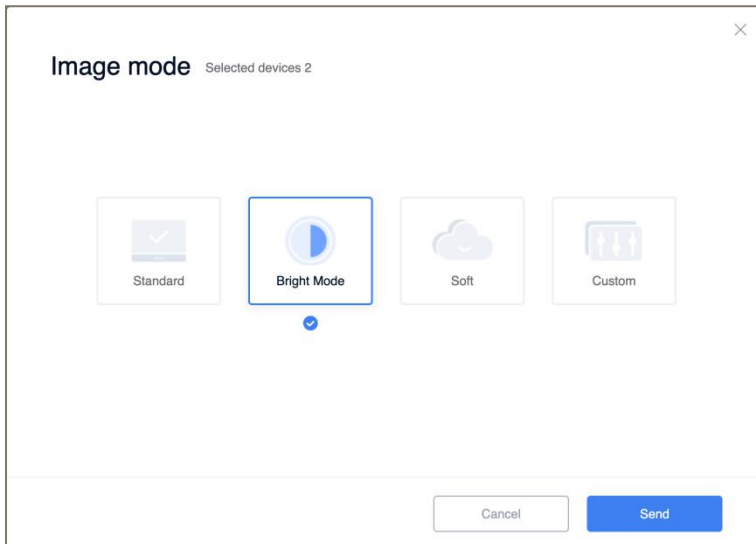

Image mode refers to the setting of the device's screen display, and only supports
Execute Now

3.3.2 SOUND MODE



Sound mode refers to the sound mode of the device, only supports Execute Now

3.3.3 POWER STATE

No Signal Shutdown

Definition: It is detected that the device has not been operated for a period of time, that is, it will automatically shut down.

Selectable time period: Never, 1 min, 3mins... 1 hour

Display After Power Outage

Definition: There are three situations in which the device encounters an unexpected power failure and is connected to the power supply again.

1. Remain power off: Reconnect power after power off, the device will remain off
2. Auto power on: power on after power off, the device will automatically power on

3. Return to the power state before power outage: After the power is cut off and then

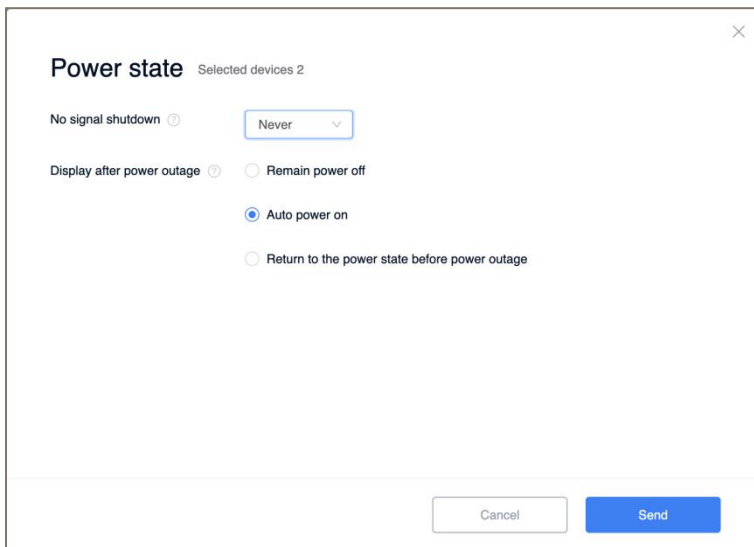

connected to the power, the device maintains the state before the power outage

After the command is sent, the device will be turned on within 24h after the command is sent, and the command can be received. If the instruction is not executed for more than 24h, it is judged as execution failure.

3.3.4 ANDROID STATE

Android channel switch, only supports Execute Now;

When the switch is turned on, the target device has an Android channel and a dock bar. You can use finder, media player, browser, note and other internal Android system applications.

When the switch is turned off, the target device does not have an Android channel and only serves as a channel display channel.

The instruction sending follows the downlink asynchronous, and the device can receive the instruction within 24h after the instruction is sent. If the instruction is not executed for more than 24h, it is judged as execution failure.

3.3.5 WALLPAPER

Wallpaper setting, only supports Execute Now;

Supports restoring to the default wallpaper of the device; supports local uploading of wallpapers and saving them in the Wallpaper list;

After receiving this instruction, the device will automatically change the wallpaper immediately;

The instruction sending follows the downlink asynchronous, and the device can receive the instruction within 72h after the instruction is sent. If this command is not executed for more than 72h, it is judged as execution failure.

3.3.6 LOGO

Boot logo setting, only supports Execute Now;

Support to restore to the default boot logo of the device; support local upload and save in the logo list;

After the device receives this instruction, it will automatically change the startup logo immediately and it will take effect in the next startup;

The instruction sending follows the downlink asynchronous, and the device can receive the instruction within 72h after the instruction is sent. If this command is not executed for more than 72h, it is judged as execution failure.

4. ADVANCED FUNCTION

4.1 APPLICATIONS

The entrance is in the navigation bar-functions; supports Execute Now and Timed two time modes; supports local upload of third-party apk, and stores and displays in the app list; first select the target application, then select the target operation, and finally select the target

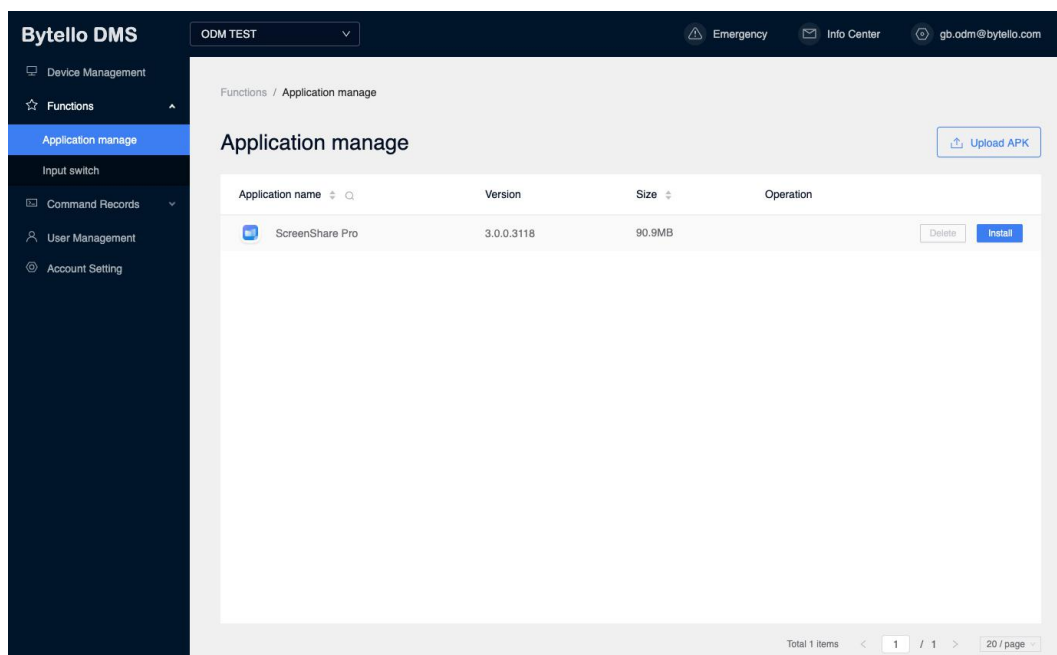

device.

Operations that can be performed on third-party apk:

1. Install, install a new application to the target device
2. Update, update has been applied to the latest version
3. Uninstall, uninstall the installed application
4. Disable, to disable the installed applications, the disabled applications will not be displayed in the app store

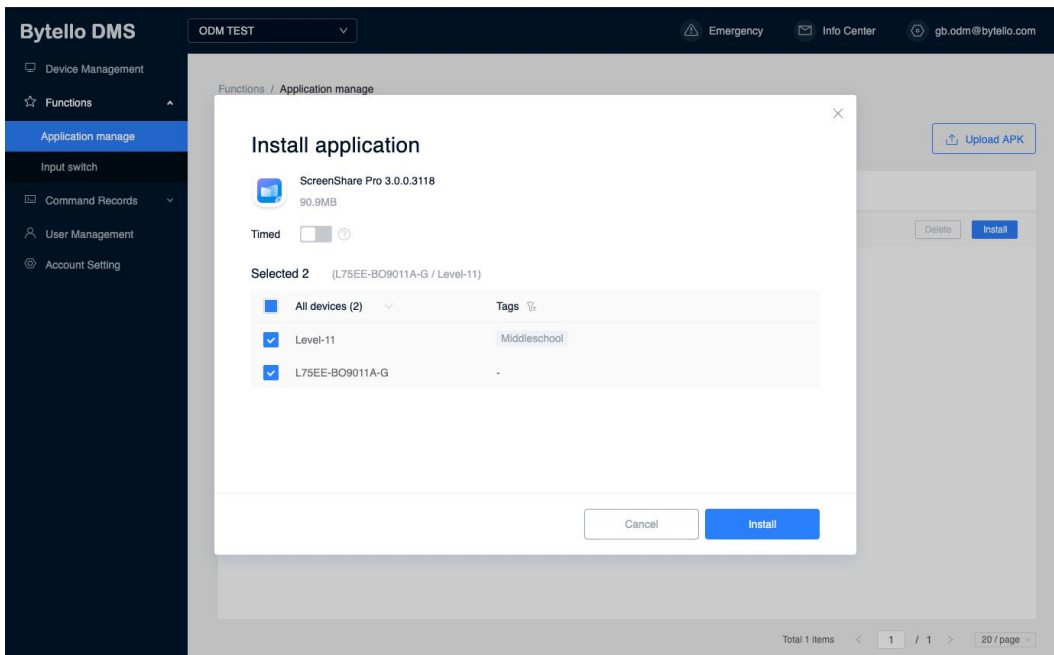

5. Enabled, enable disabled applications

4.2 ANDROID INPUT SWITCH

For the channels under the Android system, the function can be switched in batches; only Execute Now is supported;

The channel list will display: 1–Whether the channels of all devices are available or not, 2–The current channel of the device that is turned on;

First select the target device, and then select which channel to switch to;

If the device does not have the target channel, the command is judged as a failure; if the device status is off, the command is judged as a failure;

4.3 DMS SOFTWARE UPDATE

For the DMS client management function of Android devices, the IT administrator issues the latest version of the DMS client, and maintains the new version of the DMS to

Bytello DMS Demo 0312/Admin

Emergency Enroll Info Center

Device Management

- All types
- JFP
- Sound bar

Functions

- Application manage
- Input switch
- Software Update**

Command Records

System Manage

- Admin Manage
- Organization Manage
- Password Manage
- User Settings

Functions / Software update

Software update

Android Windows

Latest version: V1.7.1
Release date: 2021/03/15 [Update all \(2\)](#)

*Total 6 devices 2 devices need to be update to V1.7.1

All types All Select Status Search device name

Device name	Status	Current version	Actions
MS10B	Offline	V1.6.1	Update
TC02B	Offline	V1.6.1	Update
demo11	Online	V1.7.1	Up to date
L65CC-BO9086C-G	Online	V1.7.1	Up to date
L65EB-CLM310A	Online	V1.7.1	Up to date
W43PNC-CS1186	Online	V1.7.1	Up to date

Total 6 items < 1 / 1 > 20 / page

support the latest functions.

5. RECORDS

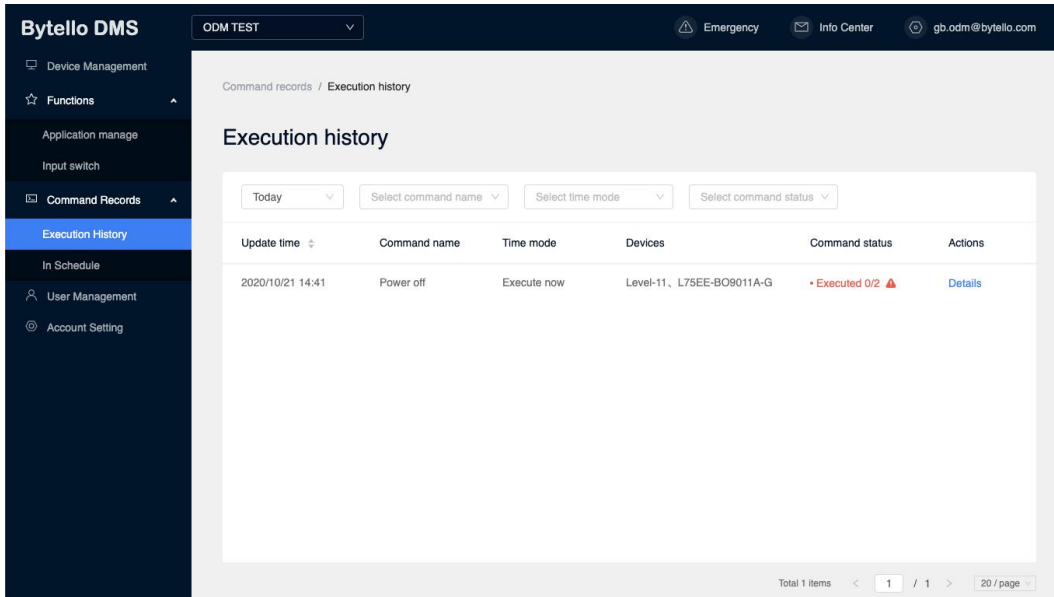

5.1 EXECUTION HISTORY

Commands that are executed immediately will enter the Execution history list after being sent. Timed and recurring instructions, after reaching the set time, the instructions will enter the Execution history list.

The status of the instruction is Executed, and the score indicates the success of the instruction under the current instruction.

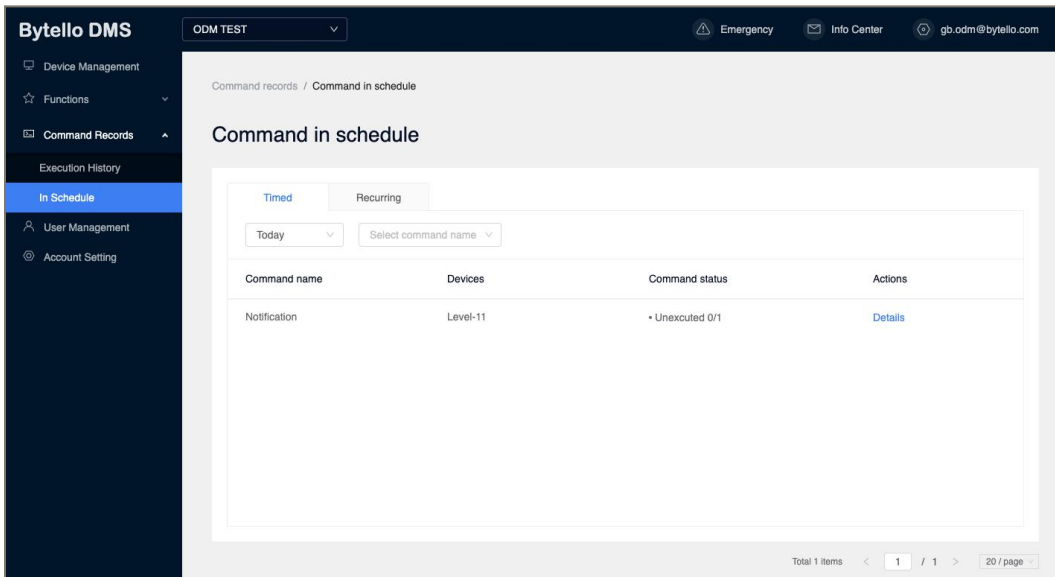

5.2 COMMAND IN SCHEDULE

Timed and recurring commands. When the set time is not reached, the command will enter the Command in schedule list. The command status is Unexecuted, and the score indicates the success of the device execution under the current command.

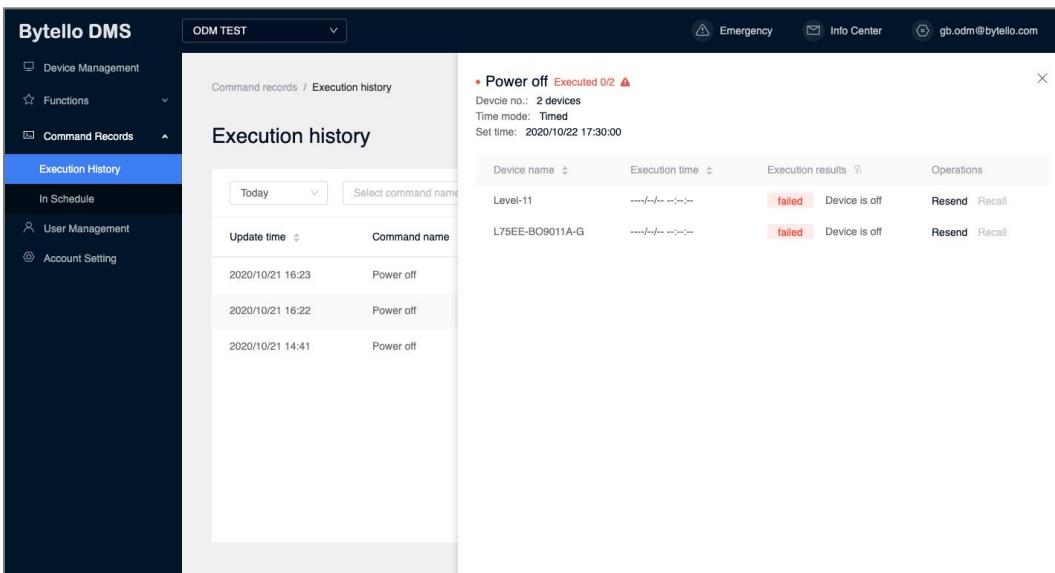

5.3 COMMAND RECORD DETAILS

The entry of instruction details can be entered in Execution history and In schedule; Under the device execution record details of the instruction, you can see the specific execution of each device under the instruction;

The specific Execution results are:

Success, this device has successfully executed this command;

Does not support any operations;

Failed, the execution of this device failed;

Support resend operation, that is, resend the command for this device;

Recalled, this device has withdrawn the issuance of this instruction;

Does not support any operations;

Wait, this device has not yet executed this command;

Support recall operation, that is, recall instructions for devices that have not yet executed instructions;

6. SYSTEM MANAGE -ADMIN MANAGE

6.1 ADD A SUB-ADMIN

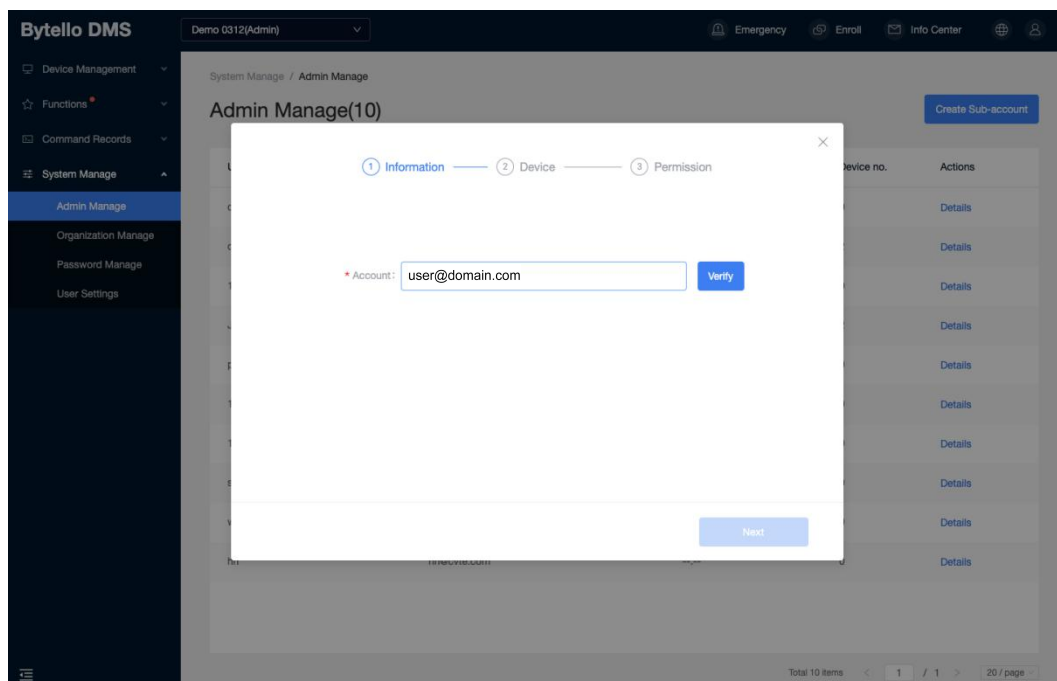

6.1.1 INPUT EMAIL ADDRESS

The entry for adding sub-admin sub-admin is in the User Management page;

The first step is to enter an email address and verify whether this email address already exists in Bytello User Center;

If the verification does not exist in the User Center, you need to set a password;

If the authentication already exists in the User Center, there is no need for admin to set a password for sub-admin;

6.1.2 AUTHORIZE DEVICES

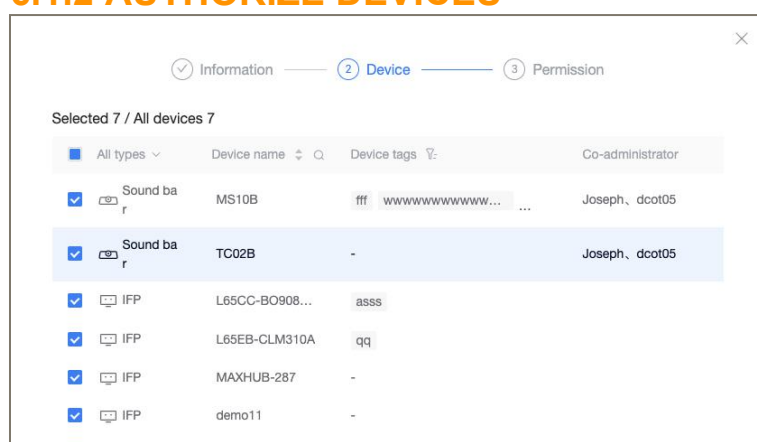

The second step is to select the controllable equipment of the equipment for the sub-admin;

The device added again after the device is allocated needs to be authorized again; see 7.2.2 for details

6.1.3 AUTHORIZE COMMANDS

The third step is to set the permissions and functional permissions for the sub-administrators.

Information — Device — 3 Permission

Permission authorized for ilumuyan@cvte.com

Password permission

Bytello DMS password ? Invisible Visible

Screen lock password ? Invisible Visible

Permission authorized for 14 / All devices 20

Device control ^

- Power on
- Power off
- Reboot
- Bells
- Screen lock

Prev Create

Visible password

Bytello DMS password:

If the switch is turned on, this sub-admin can view the client password in the DMS-web-settings page, which is used when the device is unbound;

Screen Lock password:

If this switch is turned on, this sub-admin can view the screen lock password in the DMS-web-settings page, when the user's screen is unlocked;

6.2 SUB-ADMIN MANAGE

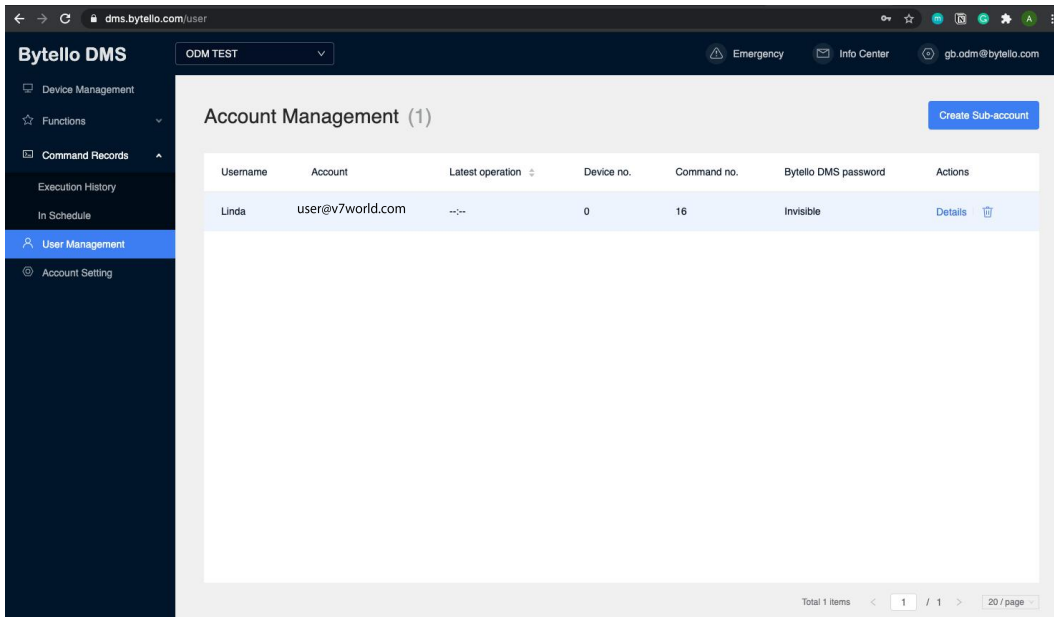

6.2.1 SUB-ADMIN LIST

The successfully added sub-admin will appear in the self-account management list. You can view basic information, enter details, and delete.

6.2.2 SUB-ADMIN DETAILS

Visible password

For a single account, you can set the password visibility again

Command authority

For a single account, you can set the command permissions again

Equipment management and control permissions

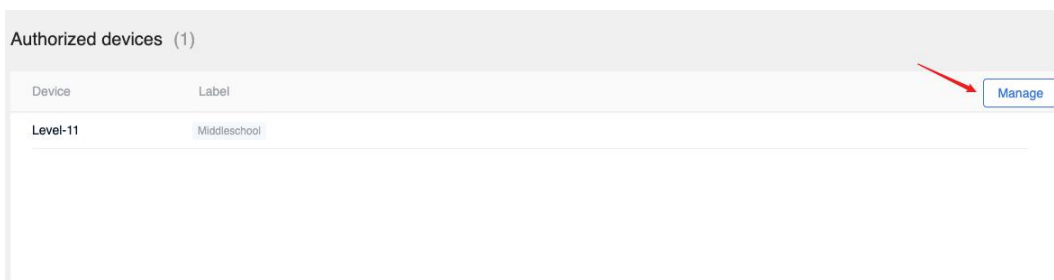

For a single account, you can set up controllable devices again

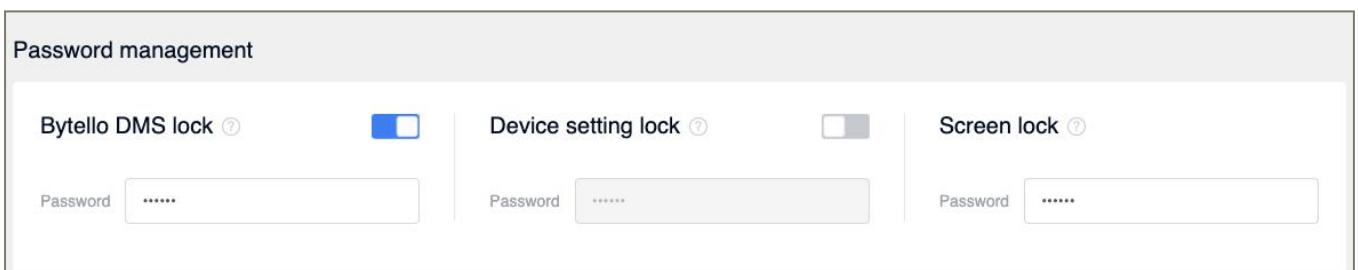

7. SYSTEM MANAGE

7.1 ORGANIZATION MANAGE

Demo 0312 [↗](#)

Admin username
test

Location
Australia

Admin account
user@v7world.com

Organization code
778235

Organization name, organization name, filled in during registration; can be changed

Admin username, the name of the administrator, filled in when the organization is registered;

Location, the area where the organization is located, filled in at the time of registration; it can be changed

Admin Email, the administrator's mailbox, filled in when the organization is registered; it cannot be changed;

Organization code, which is generated by the system when the organization registration is completed and cannot be changed;

Sever management			
Server name	Power state	Number connect device	Action
xxx	Offline	1	
L86FA	Offline	0	

7.2 SERVER MANAGE

Server name, the name of the server, filled in when creating the wake-up server; it can be changed by Bytello WOL;

Power state, server online status; indicates the switch status of WOL;

Connected devices, the number of devices connected to this server;

Action, support to delete this wake-up server;

7.3 PASSWORD MANAGE

Password of Bytello DMS lock ⓘ

Password

✓ ✗

7.3.1 BYTELLO DMS LOCK

Default 000000

Can be turned off/on, when the switch is turned on, the admin can set a 6-digit password;

When unbinding the device on the device, you need to enter the correct password to operate;

Password of screen lock ⓘ

Password

✓ ✗

7.3.2 SCREEN LOCK

Default 000000

Permanently open by default, admin can set a 6-digit password;

The user of the device can enter and use it normally during the lock screen time period by entering the correct password

7.4 USER SETTINGS

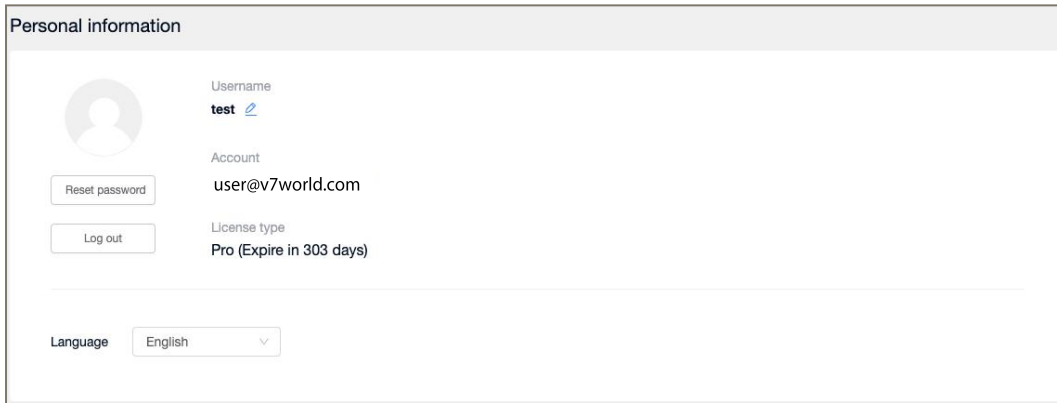

7.4.1 PERSONAL INFORMATION

Username is a custom nickname, you can modify it yourself

Password, support self-modification;

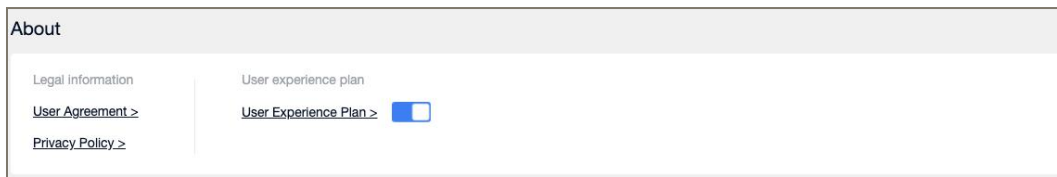

7.4.2 ABOUT

You can view the user agreement, privacy agreement, and user experience plan.