

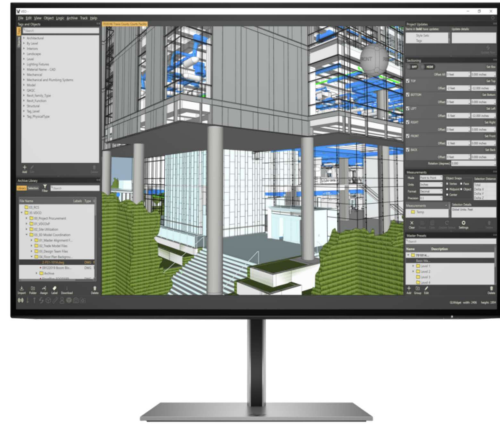

HP Z24n G3 WUXGA Display

Exquisitely crafted for every detail

Meticulously crafted to surpass every design standard, the HP Z24n G3 WUXGA Display is the HP's thinnest 24 inch diagonal screen performance monitor. It is composed of authentic aluminum and delivers an impressive, frameless viewing experience. Bring your ideas to life with remarkable color accuracy in precise WUXGA resolution.



*Product image may differ from actual product

Universally consistent colors

- Out of the box, you get remarkable color accuracy from screen to screen¹. Achieve precise, vibrant detail with 99% sRGB color gamut and WUXGA resolution.

Design pushed to the edge

- This stunning 24" (61 cm) diagonal screen monitor is meticulously crafted with a razor thin profile and frameless design. Get ultimate comfort with 4-way ergonomic adjustability.

Always on low blue light

- Experience exceptional vibrancy with HP Eye Ease, the always on low blue light filter that reduces blue light exposure with zero impact to true color accuracy.

Responsibly reimagined

- Make a conscious choice with this monitor that's been built with the environment in mind. Its plastics consist of over 80% recycled materials² plus it has 100% sustainably sourced and recyclable packaging³. It is ENERGY STAR® certified and EPEAT® 2020 registered⁴.

Featuring

Easily connect multiple monitors

Declutter your desk and connect a series of displays by daisy chaining with a single DisplayPort™ cable.⁵

All the ports you need

Connect to a Workstation, a PC and additional displays.

Easily mount a Mini

Mount your HPZ2 Mini or HP Desktop Mini directly to the monitor for a clean workspace.⁶

HP Zero BrightDot Guarantee

Even if just a third of a pixel fails or is stuck in one position, HP will replace the entire display.⁷

Optional integrated audio

Easily attach the Z Display Conferencing Speaker Bar for stereo quality audio and dual microphones.⁸

3-year limited warranty

The assurance of HP's three-year standard limited warranty.

HP Z24n G3 WUXGA Display Specifications Table

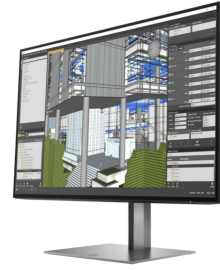
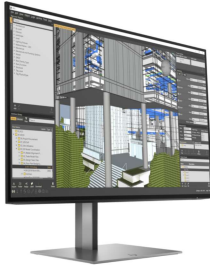

*Product image may differ from actual product

Display size (diagonal, metric)	61 cm (24")
Display type	IPS ¹
Panel active area	20.41 x 12.76 in; 51.84 x 32.4 cm
@@Brightness@@	350 nits ¹
Contrast ratio (static)	1000:1 ¹
Contrast ratio (dynamic)	10000000:1
Response ratio	5ms GTG (with overdrive) ¹
Product color	Turbo Silver
Aspect ratio	16:10 ¹
Backlight type	Edge-lit
Detachable stand	Yes
Curvature	Flat
Native resolution	WUXGA (1920 x 1200) ¹
Resolutions supported	640 x 480; 800 x 600; 1024 x 768; 1280 x 720; 1280 x 800; 1280 x 1024; 1440 x 900; 1600 x 900; 1600 x 1200; 1680 x 1050; 1920 x 1080; 1920 x 1200
Display features	Language selection; On-screen controls; Pivot rotation; Anti-glare; Height adjustable
User controls	Exit; Information; Management; Power control; Input control; Menu control; Brightness+; Image; Color
Input signal	1 DisplayPort™ 1.2-out; 1 HDMI 1.4; 4 USB-A 3.2 Gen 1; 1 DisplayPort™ 1.2-in
Ports and connectors	1 HDMI 1.4; 1 DisplayPort™ 1.2; 1 DisplayPort™ 1.2-out; 4 SuperSpeed USB Type-A 5Gbps signaling rate; 1 USB-B
HDCP	Yes, DisplayPort™ and HDMI
Camera	No integrated camera
Environmental	Operating temperature: 5 to 35°C
Power	100 - 240 VAC 50/60 Hz
Power consumption	63 W (maximum), 28 W (typical), 0.5 W (standby)
Dimensions	20.93 x 1.52 x 13.5 in; 53.17 x 3.85 x 34.29 cm (Without stand.)
Weight	10.8 lb; 4.9 kg (With stand.)
Physical security features	Security lock-ready ²
Ecolabels	ENERGY STAR® certified; EPEAT® registered;
Certification and compliance	BIS; BSMi; CB; CCC; CE; CECP; CEL; cTUVus; EAC; ENERGY STAR®; ErP; FCC; GS Mark; ISO 9241-307; KC/KCC; NOM; PSB; SEPA; TCO Certified; TCO Certified Edge; TÜV-S; VCCI; WEEE; ISC; Low blue light; Ukraine Energy label; WW application; UAE
Sustainable impact specifications	Arsenic-free display glass; Low halogen; Mercury-free display backlights; TCO Certified; TCO Certified Edge
What's in the box	Monitor; Documentation; VESA Mount adapter; USB Type-A to B cable; Cable manager; AC power cord; DisplayPort™ 1.4 cable ⁴
Warranty	3 year limited warranty including 3 year of parts and labour. Certain restrictions and exclusions apply.
Pixels per inch (ppi)	96 ppi
Panel bit depth	8 bit (6 bit + 2 FRC)
Vertical viewing angle	178°
Horizontal viewing angle	178°
Bezel	4-sided micro-edge
Swivel	±45°
Tilt	-5 to +20°
Pivot	±90
Height adjustment range	150 mm
VESA mounting	100 mm x 100 mm (bracket included)
Hardness	3H
Screen treatment	Anti-glare
Touch-enabled	Not touch-enabled
Integrated privacy filter	No
Flicker-free	Yes
Low blue light modes	Yes, HP Eye Ease (TÜV Low Blue Light Hardware Solution certified)
Energy efficiency class	E
Display scan frequency (vertical)	50-60 Hz
Display scan frequency (horizontal)	30-75 KHz
Pixel pitch	0.270 mm
Display colors	Up to 16.7 million colors supported (through FRC technology)
Display color gamut	99% sRGB; 85% DCI-P3
Microphone	No
Speakers	No
Management software	HP Display Center; HP Display Manager
Displayport™ out	1 DisplayPort™ 1.2-out

HP Z24n G3 WUXGA Display

Accessories and services (not included)

HP Business PC Security Lock v3 Kit



Help prevent chassis tampering and secure your PC and display in workspaces and public areas with the affordable HP Business PC Security Lock v3 Kit.

Product number: 3XJ17AA

HP Integrated Work Center for Desktop Mini and Thin Client



Make the most of small work spaces with an HP IWC Desktop Mini/Thin Client that lets you create a compact desktop solution by combining a display¹ with an HP Desktop Mini, HP Thin Client or HP Chromebox¹ and giving you convenient front access to all of its inputs.

Product number: G1V61AA

HP 3 year Next business day Onsite Standard Monitor Hardware Support



HP Z24n G3 WUXGA Display

Messaging Footnotes

- ¹ All performance specifications represent the typical specifications provided by HP's component manufacturers; actual performance may vary either higher or lower.
- ² Recycled plastic content percentage is based on the definition set in the IEEE 1680.1-2018 EPEAT standard.
- ³ 100% outer box/corrugate cushion packaging made from sustainably sourced certified and recycled fibers. Fiber cushions made from 100% recycled wood fiber and organic material. Any plastic cushions are made from >90% recycled plastic. Excludes plastic bags and plastic foam sheeting.
- ⁴ Based on US EPEAT® registration according to IEEE 1680.1-2020 EPEAT®. Status varies by country. Visit www.epeat.net for more information.
- ⁵ Requires an additional DisplayPort™ cable to daisy chain.
- ⁶ Z2 Mini and Desktop mini and B550 Z Display G3 PC Mounting Bracket sold separately.
- ⁷ The HP Pixel Policy allows no bright sub-pixel defects for this display. For complete details, see <http://support.hp.com/us-en/document/c00288895>.
- ⁸ Z Display Conferencing Speaker Bar Sold Separately.

Technical Specifications Footnotes

- ¹ All specifications represent the typical specifications provided by HP's component manufacturers; actual performance may vary either higher or lower.
- ² Lock sold separately.
- ³ Based on US EPEAT® registration according to IEEE 1680.1-2018 EPEAT®. EPEAT® status varies by country. Visit www.epeat.net for more information.
- ⁴ Included cables may vary by country.

Sign up for updates hp.com/go/getupdated

© Copyright 2023 HP Development Company, L.P. The information contained herein is subject to change without notice. The only warranties for HP products and services are set forth in the express warranty statements accompanying such products and services. Nothing herein should be construed as constituting an additional warranty. HP shall not be liable for technical or editorial errors or omissions contained herein.

USB-C® is a registered trademark of USB Implementers Forum. DisplayPort™ and the DisplayPort™ logo are trademarks owned by the Video Electronics Standards Association (VESA®) in the United States and other countries. Missing Mac (Apple) ENERGY STAR. For trademark comments, see: <https://legal.int.hp.com/legal/pages/tradeack.aspx>.

December 2023

