



PN-HW861/PN-HW751/PN-HW651
PN-HW551/PN-HW501/PN-HW431

4K Ultra HD displays

www.sharp.co.uk

SHARP
Be Original.



Emilie de Vabres (b. 1966)

Basilica di San Marco, Venezia

Behold the cool-headed, intellectual insight of the painter.
The painting is filled with minute and precise depictions
of the most delicate textures of surfaces illuminated



Clearly a better choice.

Enhance almost any professional environment with the outstanding 4K Ultra HD clarity of Sharp's PN-HW displays. They offer a wide range of screen sizes and flexible installation methods, including standalone operation, making them the ideal choice for both retail and corporate organisations.

With Sharp's PN-HW professional displays you can enjoy the perfect combination of slim and stylish design and crystal clear pictures. So you can get your message across loud and clear, wherever it needs to be seen.

Their true 4K Ultra HD (3840 x 2160) resolution is four times the resolution of 1080p Full HD. It means on-screen content, including movies and still images, is rendered in superbly realistic detail and depth.

This is further enhanced by innovative LED backlighting, which ensures vivid colours and boosted contrast for sharper text and beautifully textured graphics.

This exceptional clarity means that everything is optimised for reading and displaying complex information in professional specialised applications, such as CAD or air traffic control. In addition, the screens are ideal for film and broadcasting as the white balance, brightness and colour temperature can be optimised in these environments.

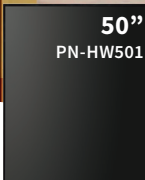
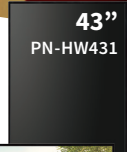



55"
PN-HW551

65"
PN-HW651

75"
PN-HW751

86"
PN-HW861

More life-like colour

With the PN-HW displays you can enjoy a more accurate and realistic representation of images on-screen. Their 10Bit colour depth provides a wider colour gamut, so you can see a greater range of colours.

It makes them the perfect solution for when you need to ensure precise and attention-grabbing communications with any audience in any indoor venue, such as premium retail locations, executive boardrooms, reception areas or other public spaces.



Better looking by design

You want whatever you are showing on screen to look great, but why not make sure that your entire display looks good too! The slim and lightweight design of Sharp's PN-HW professional displays ensures that they are easy to install wherever you need them, but will also exquisitely enhance any space.

In fact, their impressively sleek and elegant look, with its stylish cabinet design, makes them the perfect way to enhance a wide variety of locations – from the most sophisticated corporate meeting rooms and reception areas to high traffic retail environments.

With sizes ranging from 43" up to 86", you can select the most suitable display for your particular needs or operating space.

Bigger size, bigger impact

Wherever you use these displays, it's debatable which will grab your audience's attention first – the stylish design or the eye-catching, ultra clear picture quality. Especially as you can create a huge impact with life sized images of people or showcase all manner of content using the larger format 75" and 86" screen sizes.

Bring content to life – fast.

Multimedia presentations should deliver a compelling audio and visual experience. With the PN-HW's built-in speakers, support for USB playback and range of connectivity, it's easy to create digital signage and displays that make a real impact.

Nowadays people expect a much more interactive experience in almost every aspect of their lives. The static images and silent video traditionally used in commercial displays are no longer enough to attract and retain the attention of more technologically savvy consumers.

So with Sharp's PN-HW range of 4K professional displays you can combine video and audio to present your content in an ideal way. They include 10W + 10W speakers that automatically enhance any multimedia content, without having to spend time, effort or money on connecting and configuring external speakers. And because they are fully integrated they also save space and add to the sleek, modern look of your displays.

Easily play any content

A built-in USB media player provides an easy way to display slideshows of 4K Ultra HD photos or play Full HD videos and music – without any extra hardware or unsightly cabling. So there's no need to buy and connect a PC to run the media or spend time learning how to use specialist software applications. Simply plug in a USB stick and you're ready to go!

Simply more control

All of your displays can be easily controlled and monitored from a single PC or laptop in a central location thanks to their integrated LAN and RS-232C interfaces. They allow you to adapt how you use the displays to suit your own control systems. Each display is also fitted with three HDMI inputs, so you can readily switch between sources.





Be Elegant and Bold

BELINDA

Make life simple.

When you're working, you need your technology to be working to. And it should be easy to set up and use in the best way to support your particular needs.

Sharp's PN-HW range of professional displays are designed for continuous use during normal retail and business hours, and in other high demand environments. Their 16/7 operation means they will deliver your content with outstanding clarity and precision over long periods. They are ideal for promoting products and services or communicating information in a wide range of professional settings, including meeting rooms, reception areas and retail signage.

And thanks to their outstanding energy efficiency you can just leave them on without using lots of power and running up large bills.

Your message, your way

You can choose to install the PN-HW displays in either landscape or portrait mode, to suit whatever type of content you want to show and to ensure they blend in with their surroundings. Create stunning visual posters in portrait mode or dazzle your audience with ultra realistic films or images.

If you prefer not to use a conventional wall mounting, you also have the freedom to deploy them as a stand-alone display. So you can quickly present the right information in the right way at the right time and create a real impact in almost any location, such as a hotel foyer or customer service desk. It's also provides the perfect solution for historic buildings or hard-to-access places where standard fittings and cabling are not possible.



Dimensions

PN-HW861

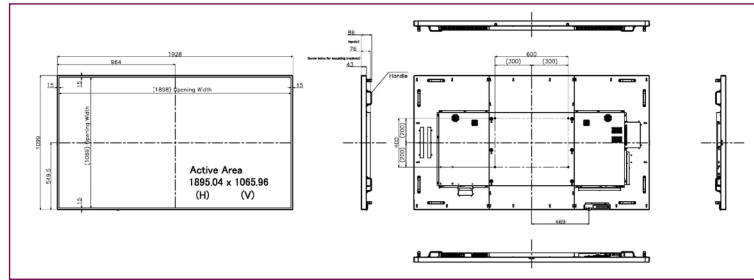

PN-HW751

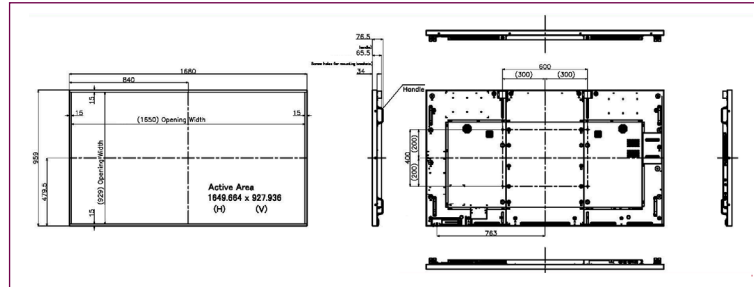

PN-HW651

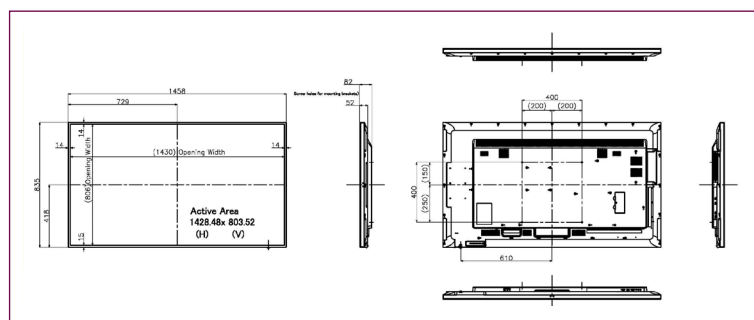

PN-HW551

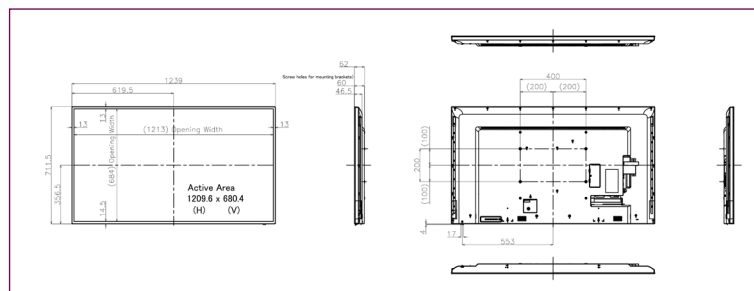

PN-HW501

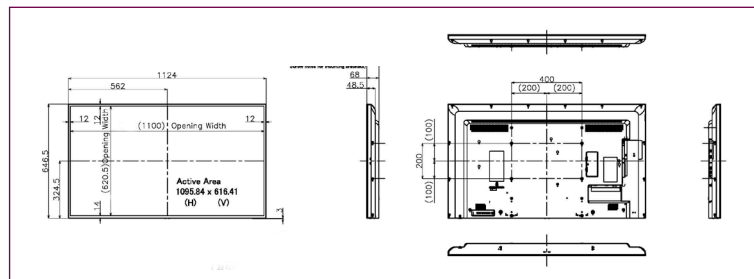

PN-HW431

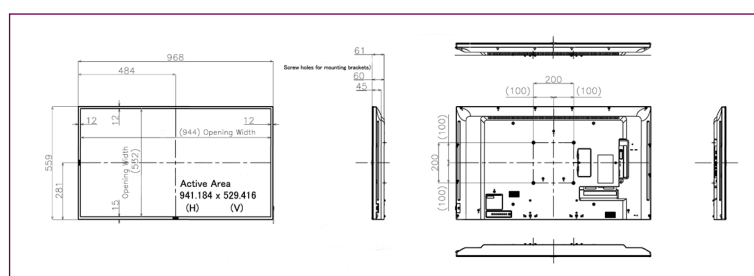

Specifications

| Model name | PN-HW861*1 | PN-HW751 | PN-HW651 | PN-HW551 | PN-HW501 | PN-HW431 | |
|---|---|---|---|--|--|--|-------------------------------|
| Installation | Landscape / Portrait | | | | | | |
| | 86" Class [85 3/8 inch (217.426cm) diagonal] TFT LCD | 75" Class [74 1/2 inch (189.273 cm) diagonal] TFT LCD | 65" Class [64 1/2 inch (163.896 cm) diagonal] TFT LCD | 55" Class [54 3/8 inch (138.783cm) diagonal] TFT LCD | 50" Class [49 1/2 inch (125.730cm) diagonal] TFT LCD | 43" Class [42 1/2 inch (107.986cm) diagonal] TFT LCD | |
| LCD panel | Backlight | LED, edge lit | | LED, full array | | | |
| | Max. Resolution | 3,840 x 2,160 pixels | | | | | |
| | Max. Display Colours (approx.) | Approx. 1.07 billion colors | | | | | |
| | Pixel Pitch (HxV) | 0.4935 mm (H) x 0.4935 mm (V) | 0.429 mm (H) x 0.429 mm (V) | 0.372 mm (H) x 0.372 mm (V) | 0.315 mm (H) x 0.315 mm (V) | 0.2854 mm (H) x 0.2854 mm (V) | 0.2451 mm (H) x 0.2451 mm (V) |
| | Max Brightness*2 | 400cd/m ² | | 350cd/m ² | | | |
| | Contrast ratio | 1200 : 1 | | 4000 : 1 | | | |
| | Viewing Angle (H/V) | 178°/178° (CR≥10) | | | | | |
| | Active Screen Area (W×H) | 1.895.04 x 1.065.96 mm | 1.647.36 x 926.64 mm | 1.428.48 x 803.52 mm | 1.209.6 x 680.4 mm | 1.095.84 x 616.41 mm | 941.18 x 529.41 mm |
| Response Time | 8ms (grey to grey, avg.) | | | | | | |
| Input Terminals | | 1x Analog Mini D-Sub 15 Pin, 3x HDMI (HDMI2.0, HDCP2.2, HDMI CEC) | | | | | |
| | Audio | 3.5mm mini stereo jack x 1 | | | | | |
| | Serial (RS-232C) | D-sub 9 pin x 1 | | | | | |
| | LAN Terminal | 10Base-T/100Base-TX x1 | | | | | |
| Output Terminals | USB Port | USB 2.0 compliant (For Media Player) x 1 | | | | | |
| | Audio | RCA pin (L/R) x 1 | | | | | |
| Plug & Play | VESA DDC2B | | | | | | |
| Power Management | VESA DPMS | | | | | | |
| Speakers | 10W + 10W | | | | | | |
| Power Requirement | AC 100-240V, 50/60 Hz | | | | | | |
| Mounting (4 points) | 600 mm x 400mm pitch, M6 screw | | 400 mm x 400mm pitch, M6 screw | 400 mm x 200mm pitch, M6 screw | | 200 mm x 200mm pitch, M6 screw | |
| Environmental Conditions | Operating Temperature | (0°C to 40°C) | | | | | |
| | Operating Humidity | 20% to 80% (no condensation) | | | | | |
| Power Consumption (input signal waiting mode / standby mode) | 330 W (0.7W / 0.5W) | 255 W (0.7W / 0.5W) | 205 W (0.7W / 0.5W) | 150 W (0.7W / 0.5W) | 130 W (0.7W / 0.5W) | 115 W (0.7W / 0.5W) | |
| Dimensions | 1.928 x 76 x 1.099 mm | 1.680 x 65.5 x 959 mm | 1.458 x 82 x 835 mm | 1.239 x 62 x 711.5 mm | 1.124 x 69 x 646.5 mm | 968 x 61 x 559 mm | |
| Weight | 64kg | 55kg | 27.5kg | 16kg | 13kg | 9 kg | |
| Main Accessories | AC power cord, remote control unit, battery (AAA size x 2), CD-ROM, set-up manual, cable clamp x 2, logo sticker, USB flash drive cover, USB flash drive cover fixing screw x 2 | | | | | | |



*1 The PN-HW861 is available now and all other models coming later 2019. *2 Brightness depends on input mode and other picture settings. Brightness level will decrease slightly over the lifetime of the product. Due to the physical limitations of the equipment, it is not possible to maintain a precisely constant level of brightness. HDMI, the HDMI logo, and High-Definition Multimedia Interface are trademarks or registered trademarks of HDMI Licensing, LLC in the United States and other countries. All other brand names and product names may be trademarks or registered trademarks of their respective owners. All trademarks acknowledged. E&OE. Sharp Corporation November 2018. Ref: 19484 Amber 8pp Brochure.