

TORMEK® T-1

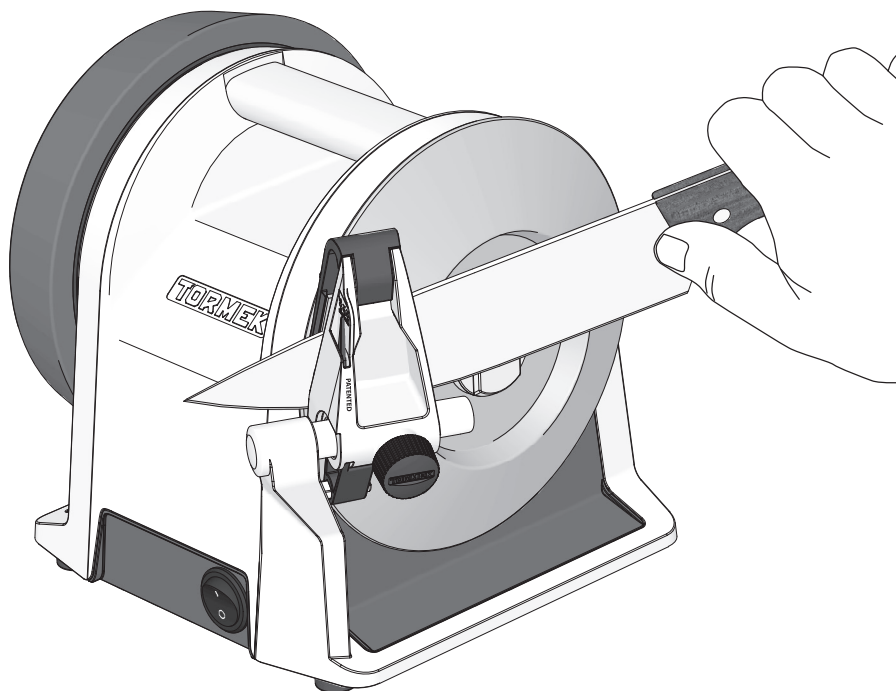

FOR HOUSEHOLD USE

Safety

Automatic overheat protection

*The Tormek T-1 has a recommended maximum operating time of 30 minutes per hour. The motor has an automatic overheat protection system that will shut off the motor if it reaches a certain temperature. **Note: If the motor shuts off, always turn off the machine by pressing the power button as the motor will resume operation once it cools down.***

General information

- Read all instructions carefully before using the machine.
- To protect against risk of electrical shock do not expose the machine to rain and do not use in damp environments. Do not put the machine in water or other liquids.
- This appliance is not intended for use by children or by persons with reduced physical, sensory, mental capabilities, or lack of experience and knowledge. Close supervision is necessary when any appliance is used near children. Children should not play with the appliance.
- Turn the appliance OFF, then unplug from the outlet when not in use. Always unplug the appliance before assembling or disassembling parts and before cleaning. To unplug, grasp the plug and pull from the outlet. Never pull from the power cord.
- Avoid contacting moving parts.
- Do not operate any appliance with a damaged cord or plug, after the appliance malfunctions, or after the appliance is dropped or damaged in any manner. Please contact your local dealer or Tormek's customer support (support@tormek.se) for information on examination, repair, or adjustment.
- The use of attachments not recommended or sold by Tormek may cause fire, electric shock or injury.
- Do not use outdoors.
- Do not let the cord hang over the edge of a table or counter.
- Do not let the cord contact hot surfaces, including a stove.
- Carefully route the power supply cord to avoid damage from the knife blade while sharpening.
- SAVE THESE INSTRUCTIONS

Sharpening and honing

- The Tormek T-1 is only intended for sharpening and honing kitchen knives. Only use the machine for its intended purpose. Follow the instructions.
- Tormek's accessories are specially made for Tormek machines and must not be used on any other grinding machine.

- Do not force the machine. Gentle pressure not only works better, it is safer.
- Make sure your hands are dry and clean of grease and oil.
- Do not wear loose clothes, gloves, ties, rings, necklaces, etc. that can get trapped in the moving parts.
- Protect long hair with a hair net. Wear non-slip shoes.
- Stand or sit in a stable position and with a good balance while you work with the machine.
- Avoid body contact with grounded surfaces (ex. pipes, elements, refrigerator, stove, etc.).
- Keep your hands and fingers away from the area between the guide and grinding wheel.
- Keep a close eye on your work, use common sense, and do not use the machine when you are tired.

Condition of the machine

- Check that the machine is undamaged and working properly before use. Do not use the machine if the power switch does not switch on and off.
- Check that the power cable is undamaged on a regular basis. If it is damaged, have it replaced by qualified personnel. This also applies to an extension cable if one is used.
- Unplug the plug from the electrical socket before cleaning or performing maintenance on the machine, and when replacing the grinding wheel or honing wheel.
- Use only genuine Tormek grinding wheels. Maximum diameter 150 mm and maximum width 18 mm. Hole diameter 12 mm.
- Never tug at the cable to unplug the plug. Make sure the cable is not close to any sharp edges, oil, or sources of heat.

Workplace

- Connect the machine to a grounded socket with the voltage and period number (Hz) as indicated on the machine plate.
- Do not use the grinding machine in the vicinity of flammable gases or fluids, or in a dangerous environment, ex. Wet or damp premises, and do not expose it to rain.
- Make sure that any tools (ex. wrenches, adjustable wrenches) are removed from the machine before starting it.
- Position the machine on a flat and stable surface. Keep the working area clean. Untidy surfaces and benches cause accidents. Make sure you have good lighting.
- Children and unauthorised personnel should be kept at a safe distance from the working area.



Instructions on grounding



- In the event of faults or open circuits, grounding reduces the risk of electric shock by diverting the current. This machine is equipped with a grounded cable and plug. The plug must be connected to a matching electrical socket installed and grounded in accordance with applicable laws and regulations.
- Do not modify the original plug – if it does not plug into the electrical socket, contact an authorized electrician to install a suitable electrical socket.
- Incorrect connection of the grounded plug may result in electric shock. The insulated ground cable is green, with or without yellow stripes.
- Check with an authorized electrician or service personnel if you have not fully understood the instructions, or if you are doubtful that the machine is properly grounded.
- Only use an extension cable with a grounded plug and grounded electrical sockets that the machine's plug fits into.
- Repair or replace a damaged or worn cable immediately.

After work

- Always turn the machine off and unplug the machine. Never unplug the machine when the machine is running/switched on.
- Store the machine in a locked area and out of reach of children and unauthorized personnel.

Machine plate for Tormek T-1

| |
|--|
| <p>ARTICLE NO: T-1 ALO/EUR SERIAL NO: DATE:</p> <p>Made in Sweden by Tormek AB www.tormek.com 220-240 V, 50-60 Hz, 120 W</p> <p>    <small>Intertek</small> </p> <p>HOUSEHOLD TYPE</p> |
|--|

| |
|--|
| <p>ARTICLE NO: T-1 SERIAL NO: DATE:</p> <p>Made in Sweden by Tormek AB www.tormek.com 100-115 V, 50-60 Hz, 120 W</p> <p>   <small>Intertek 3196221</small> </p> <p> <small>CONFORMS TO UL STD. 982 CERTIFIED TO CSA STD. C22.2 NO 60335-1 & E60335-2-14</small> </p> <p>HOUSEHOLD TYPE</p> |
|--|

Spare parts and repairs

This machine meets applicable safety standards. Repairs must be performed by qualified personnel using genuine spare parts. Incorrectly performed repairs may cause serious injury to the user.

Tormek warranty

The Tormek warranty is valid for 8 years, 5 years + 3 years after registering the machine at tormek.com, from the date of purchase. This includes all parts for your Tormek T-1 in the event of material and manufacturing faults. The Tormek warranty guarantees the function of your machine but does not cover normal wear and tear, misuse, or mishandling. Valid together with purchase receipt.

If your Tormek T-1 needs service – contact the place of original purchase. Problems can often be solved by phone or by a spare part being sent. Do not return the machine without an agreement with, or return authorization from, the place of purchase.

Tormek AB

Torphyttvägen 40

711 34 Lindesberg

SWEDEN

Tel.: +46 581 147 90

Email: support@tormek.se

Knife sharpening for the kitchen

The Tormek T-1 Kitchen Knife Sharpener is a quick, easy, and clean way to sharpen knives in the convenience of your own kitchen. This advanced development of the traditional diamond bench stone, combined with the patented sharpening angle guide, makes it possible to sharpen kitchen knives at home with the same or better results than a professional sharpening service. The Tormek T-1 sharpening method consists of two steps: sharpening on the diamond grinding wheel, followed by honing on the composite honing wheel.

SPECIFICATIONS, TORMEK T-1 KITCHEN KNIFE SHARPENER

DIMENSIONS

| | |
|--------|----------------------------|
| Width | 8" (204 mm) |
| Depth | 7 $\frac{3}{4}$ " (196 mm) |
| Height | 7 $\frac{1}{8}$ " (181 mm) |

WEIGHT

Weight of machine: 11.9 lbs (5.4 kg)

GRINDING WHEEL

DF-150 Conical Diamond Wheel Fine
 \varnothing 5 $\frac{7}{8}$ " x $\frac{5}{8}$ " (150 x 18 mm)
 Max 200 rpm

HONING WHEEL

\varnothing 6 $\frac{1}{4}$ " x 1 $\frac{3}{16}$ " (160 x 30 mm)

MATERIAL

Fully cast in zinc, powder coated
 Lower section in impact resistant ABS plastic

MOTOR

Single phase AC motor 120 W (input power)
 220–240 V, 50–60 Hz
 or 100–115 V 50–60 Hz
 Maintenance-free
 Runs at low noise, 45 dB
 Min. 10,000 hours of operating time

WARRANTY

8-year warranty. 5 years + 3 years when registering the machine at tormek.com

PATENT

See tormek.com/patents for all patents

KNIFE BLADE HEIGHT



1/2"–2 $\frac{3}{8}$ "
 (12–60 mm)

KNIFE BLADE LENGTH



Unlimited

KNIFE BLADE WIDTH

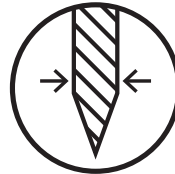

Up to $\frac{3}{16}$ "
 (5 mm)

For indoor, home use only. Do not use in wet or damp places.

Important points to remember before you start

Always clean and dry the knife before sharpening. The grinding wheel's performance may be affected by food residue or other contaminants.

Upon first usage, the diamond wheel will seem aggressive and will give a rough surface. After a short break-in period, the diamond crystals on the wheel will stabilize to a uniform level and provide a finer surface. This normally takes between 2–5 grindings.

If necessary, clean the grinding wheel with a nylon brush. Always store the machine in a dry place.

The Tormek T-1 Kitchen Knife Sharpener is delivered fully assembled. The only thing you need to do is read the instructions and plug it in. Good luck with your sharpening!

Instructions for sharpening and honing

1. Set the desired edge angle

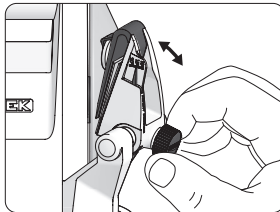

15° setting results
in 30° edge angle.

Tip! Save time by always sharpening the knife to the same edge angle. You will remove the least amount of steel during each grinding. Plus, your knives will last longer!



SUGGESTIONS FOR EDGE ANGLES



20–30°



25–40°



25–30°

Example of angle setting and result: A common angle for kitchen knives is 30°. Set the indicator to 15° sharpening angle, which results in 30° total angle on the knife.

Which edge angle should I use?

In general, a small edge angle is better at cutting, while a larger edge angle is stronger and lasts longer. For example, a knife that will be used for meat should have a larger edge angle than a thinner fillet knife or vegetable knife. The composition of the steel will also affect which angle is most suitable. A high-quality knife blade, even with a smaller edge angle, generally retains its sharpness better than a lower quality knife blade.

Japanese knives are sharpened with a slightly smaller angle compared to European knives. Some knives are only sharpened on one side. In which case, 20–25° is a suitable edge angle for that side.

You can typically get details about the recommended edge angle for your particular knife from the knife manufacturer.

2. Position the knife and start sharpening

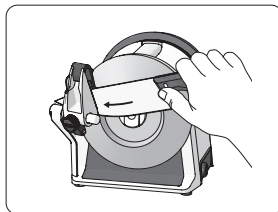
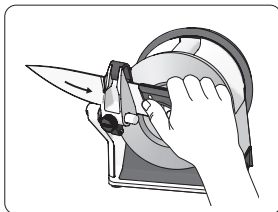
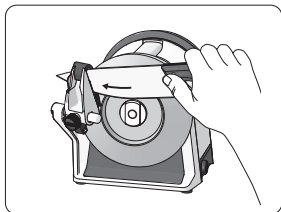

Make sure the knife is clean before you start sharpening. Press the power switch to start the machine. Insert the knife into the guide and lower it towards the grinding wheel. Slide the knife back and forth at a steady pace across the grinding wheel applying a light pressure. Guide the knife so that it is in contact against the whole width of the grinding wheel. Follow the shape of the edge right up to the tip. Allow the guide to control the angle. Moving the knife back and forth 2–3 times is enough if you have a) a normally worn knife, and b) you are sharpening at the same angle as before. Feel that a “burr” is formed along the entire edge. The burr forms on the opposite side of the blade that was just sharpened on the grinding wheel.

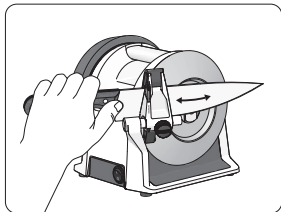

Turn the knife around and sharpen the opposite side in the same way.

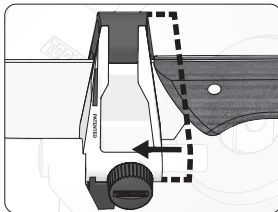

On knives where the handle catches the guide – loosen and move the guide on the shaft so that the entire knife blade can move across the grinding wheel.

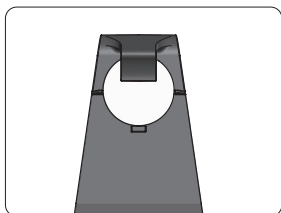
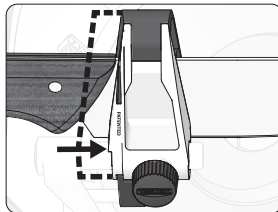

The guide has a magnet on the underside that collects steel particles while sharpening. It helps to keep the grinding wheel clean.

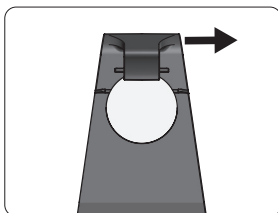

If you experience that the magnet interferes with the sharpening (some knives have a tendency to attach themselves to it) you can easily remove it.

Tip! Clean the magnet using a dry cloth or kitchen paper towel.

Tip! To repeat an existing edge angle, you can use the Marker Method. Color the bevel with a permanent marker. With the machine switched off, slide the knife through the guide as if you were sharpening it and see where the marker is rubbed away. Adjust the angle and repeat until the color is removed from the entire bevel.

Note: The plastic part of the guide that is closest to the diamond grinding wheel may get slightly worn during the first few sharpenings. This is completely normal and a part of the run-in process.

3.hone the knife to a final finish

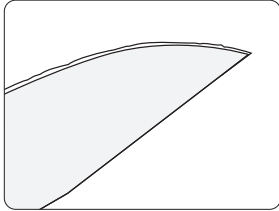

After sharpening, a “burr” is created. It needs to be honed off in order to obtain a sharp and durable edge.

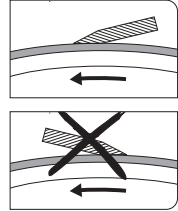
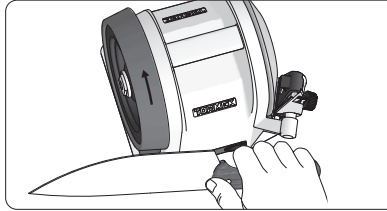

⚠ Before you start honing, make sure that the honing wheel rotates **away from** the edge. Otherwise the knife will cut into the honing wheel and you risk being injured.

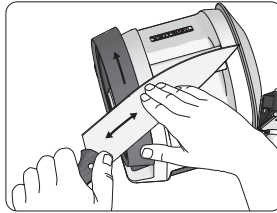
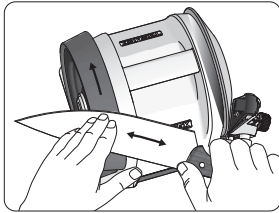

Slide the knife back and forth across the honing wheel applying light pressure. Make sure you do not have too steep of an angle as you could round off your newly sharpened edge resulting in a blunt knife. A couple of times on each side is usually sufficient. The number of times may vary depending on steel grade. You now have a completely sharpened knife!

Note: If the “burr” is not honed off properly, the knife may be experienced as dull, even though it is newly sharpened.

Tip! Depending on steel grade, the “burr” may bend, flipping from one side of the knife to the other. Sometimes it is best to alternate from side to side when honing.

Tip! Moisten the composite honing wheel with water using a damp sponge or paper towel. This will reduce friction and can make the edge even finer.

Service and maintenance

Replacing the Knife Protection Pads

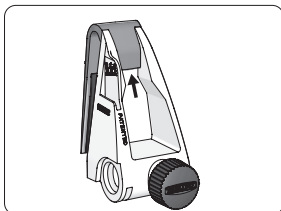
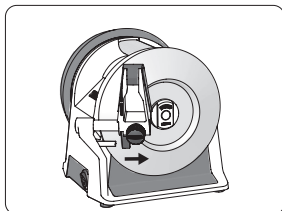

Slide the guide off the shaft and remove the clamp.

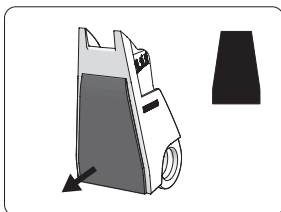
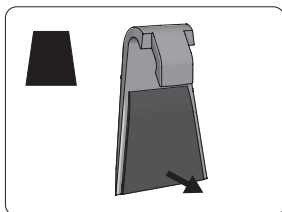

Remove the self-adhesive pads from both the clamp and the guide. Replace with new pads.

Tip! With the Knife Protection Pads removed, clean out any sharpening particles between the clamp and the guide.

Note: The shapes of the Knife Protection Pads are different for the guide and clamp.

Cleaning the magnet

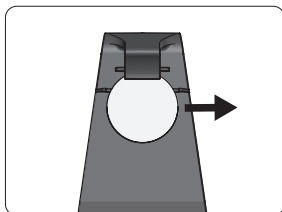

Unclip the magnet from the guide and wipe away the sharpening dust using a dry cloth or kitchen paper towel.

Replacing the diamond grinding wheel

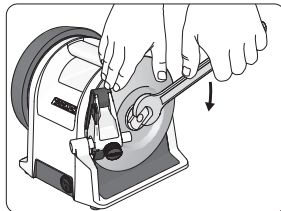

DISASSEMBLY: Hold the diamond grinding wheel with one hand and loosen the grinding wheel nut using a 19 mm wrench. **Note: The nut is loosened clockwise because it has left-handed threads.**

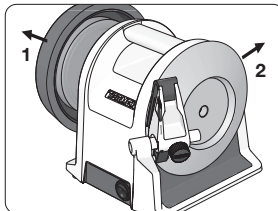

Pull the composite honing wheel and shaft out slightly so the diamond grinding wheel can be removed past the guide.

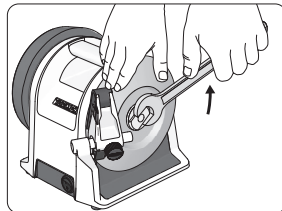

ASSEMBLY: Thread on the diamond grinding wheel nut counterclockwise. Hold the diamond grinding wheel with one hand and tighten the nut with a 19 mm wrench. **Note: The nut is locked counterclockwise because it has left-handed threads.**

Replacing the composite honing wheel

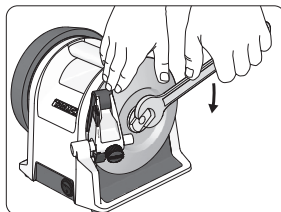

DISASSEMBLY: Hold the diamond grinding wheel with one hand and loosen the grinding wheel nut using a 19 mm wrench. **Note: The nut is loosened clockwise because it has left-handed threads.**

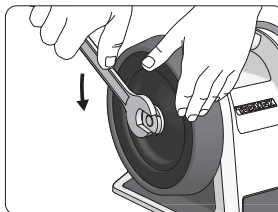

Loosen the honing wheel by holding the composite honing wheel with one hand and loosening the honing wheel nut using a 19 mm wrench. Remove the whole shaft from the machine housing.

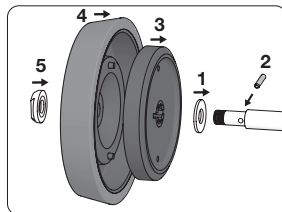

ASSEMBLY: Place the flat drive wheel washer onto the shaft. Insert the drive wheel lock pin into the hole in the shaft. Install the drive wheel followed by the honing wheel. Tighten the nut. Ensure that all parts are assembled in the order shown in the illustration.

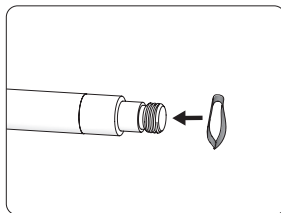

Next, install the wave washer. The wave washer slides onto the shaft from the grinding wheel side.

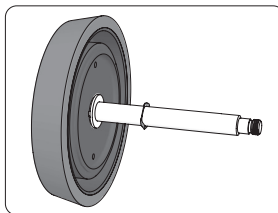

When everything has been assembled in the order shown in the illustration above and the wave washer is in place, it is time to slide the shaft through the machine housing.

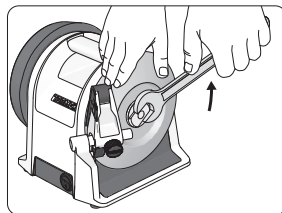

Finish by reinstalling the grinding wheel. Remember that the nut on the grinding wheel side has left-handed threads and is locked counterclockwise.

Spare parts list – Tormek T-1

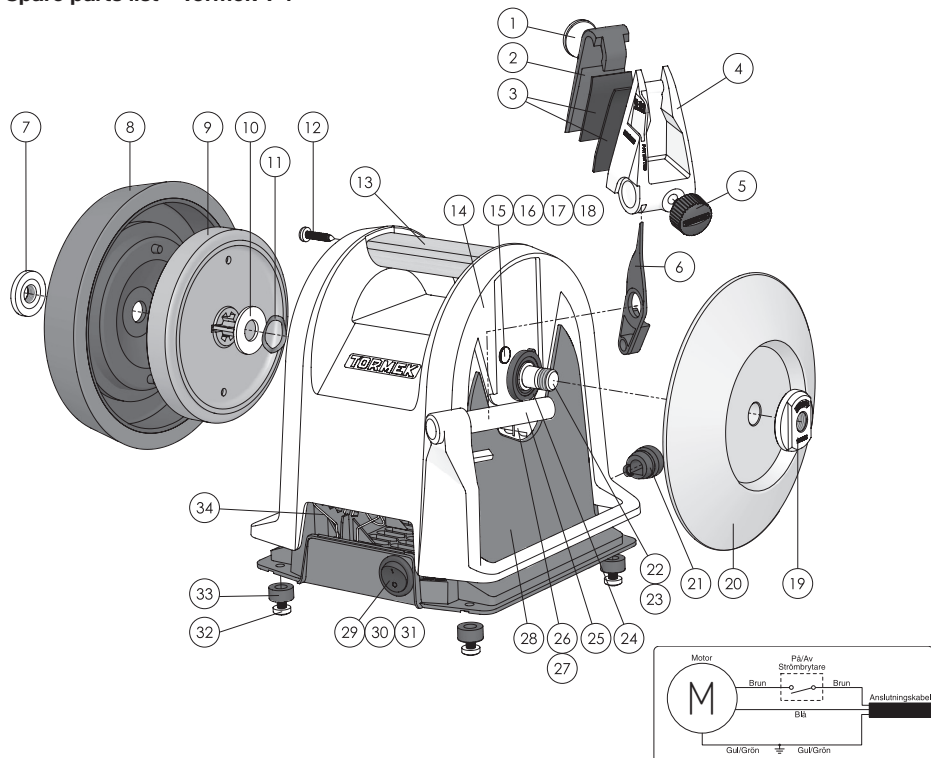

| Pos | Designation | Quantity | Part no. |
|-----|--|----------|----------------------------|
| 1 | Magnet | 1 | 5370 |
| 2 | Clamp for the guide | 1 | 3115 |
| 3 | Knife Protection Pads | 1+1 | 6040+6015 |
| 4 | Zinc part for the guide | 1 | 2015 |
| 5 | Knob screw | 1 | 1185 |
| 6 | Indicator for the guide | 1 | 3075 |
| 7 | Honing wheel nut M12 | 1 | 0100 |
| 8 | PW-160 Composite honing wheel | 1 | 3670-07 |
| 9 | Drive wheel | 1 | 3208-07 |
| 10 | Washer for drive wheel | 1 | 5081 |
| 11 | Wave washer | 1 | 5410 |
| 12 | Screw for handle | 1 | 5025 |
| 13 | Handle | 1 | 0820 |
| 14 | Housing | 1 | 2550 |
| 15 | Swing shaft | 1 | 1030 |
| 16 | Bushing for swing shaft* | 3 | 3121 |
| 17 | Spacer spring for the motor* | 1 | 0520 |
| 18 | Motor 80 W* | 1 | 6095 (230V) 6105 (115V) |
| 19 | Grinding wheel nut M12 with left-hand thread | 1 | 0060 |
| 20 | Grinding wheel | 1 | 6090 |
| 21 | Grommet | 1 | 6085 |
| 22 | Main shaft | 1 | 1025 |

| Pos | Designation | Quantity | Part no. |
|-----|------------------------------|----------|--|
| 23 | Lock pin for drive wheel* | 1 | 5071 |
| 24 | Main shaft bearing | 2 | 3061 |
| 25 | Shaft | 1 | 1420 |
| 26 | Screw M4×8* | 2 | 5600 |
| 27 | Toothed lock washer* | 2 | 5021 |
| 28 | Lower section | 1 | 3085 |
| 29 | Power switch | 1 | 6110 |
| 30 | Inner wiring* | 1 | 6100 |
| 31 | Insulation sleeve* | 3 | 3105 |
| 32 | Screw M5×10 | 4 | 5590 |
| 33 | Rubber foot | 4 | 3095 |
| 34 | Counterhold spring for motor | 1 | 0515 |
| 35 | Power cable rack* | 1 | 6031 (EUR) 6041 (CH) 6043 (US) 6050 (JP) 6053 (GB) 6055 (AU) 6057 (ZA) |

* Not shown in the drawing.

