



# PRODUCT CATALOGUE 2021



+44 (0) 1905 821 697

+44 (0) 1476 513 801

[sales@tyre-equipment.co.uk](mailto:sales@tyre-equipment.co.uk)

[www.tyre-equipment.co.uk](http://www.tyre-equipment.co.uk)

# Welcome to The Tyre Equipment Company



We are a long-established specialist supplier of the tyre service parts and equipment.

Please visit our website  
for current price information:  
[tyre-equipment.co.uk](http://tyre-equipment.co.uk)

We serve the commercial end of the market including haulage, transportation companies, coach and public transport, agricultural, plant and mining sectors - not to mention tyre fitters and other service companies based around these activities.

The Tyre Equipment Company has been dedicated to offering old-fashioned service and supplying quality products to customers through the UK.

With a large range of items in stock ready for same-day despatch, this catalogue highlights just some of the products we are able to supply - if you are looking for something specific, please have a look at our website or give us a call.



Find Us

**Twitter:** @tyreequipmentco

**Facebook:** /tyreequipmentcompany



 Call us today  
 01905 821697 / 01476 513801
  Email us at  
[Sales@tyre-equipment.co.uk](mailto:Sales@tyre-equipment.co.uk)

We welcome



Monthly credit accounts are also available – please contact us for more details

# Contents

## Section One: Tyre Service Tools

Truck & Bus Tyre Changing Tools	pp. 6-10
Tyre Levers	pp. 11-13
Wheel Lifting Equipment	p. 14
Driving Irons	p. 14
Tyre regroovers and Accessories	pp. 15-16
Tyre Spreaders	p. 17
Wheel Nut Wrenches & Braces	p. 18
Torque Wrenches	p. 19
Wheel Nut Indicators & Restraints	p. 20-21
Conspicuity Tape	p. 22
Wheel Chocks & Other Accessories	p. 23
Wheel Balancing Compounds & Weights	p. 24
Bead Seating Tools	pp. 25-26
Tyre Inflation Safety Cages	p. 27
Tyre Service Tools	p. 28
Tyre Mounting Compounds	pp. 29-30
Tyre Inflators	pp. 31-33
Tyre Pressure/Tread Depth Gauges	p. 34, 118
Rechargeable Lights	p. 35
Drain Pans	p. 36
Liquid Ballast Pumps	p. 37

## Section Two: Tyre Bead Breakers & Accessories

Bead Breakers	pp. 40-41, 44-48, 51
Hammers	p. 42
Bead Holders & Protectors	p. 43
Back Bead Rams	p. 49
Hydraulic Pumps	p. 50
Wheel Push Off/Separation Tools	pp. 52-53
Hydraulic Couplers & Hoses	p. 54

## Section Three: Lifting Equipment

Bottle Jacks	pp. 58-59
Air Service Jacks	pp. 60
Agricultural Service Jacks	p. 61
Forklift Jacks	p. 62
Lifting Jacks	pp. 63-64
Trolley Jacks	pp. 65-67
Axle Stands	pp. 68-69
Jack Stands	pp. 70-72
Transportation Tools	pp. 72-74
Wheel Lifting Equipment	p. 75

## Section Four: Air/Power Tools & Accessories

½" Impact Wrenches	pp. 78-79, 84, 87-88
¾" Impact Wrenches	pp. 80-81, 84, 89
1" Impact Wrenches	pp. 82-84, 90
½" Drive Impact Socket Sets	p. 91
¾" Drive Impact Socket Sets	p. 91
1" Drive Impact Socket Sets	p. 92
Pneumatic Tools	pp. 85-86, 93-94
Air Tool Oils	p. 94
Hose Reels & Filter Regulators	pp. 95-96
Air Line Hoses & Assemblies	p. 97
Air Line Fittings	p. 98

## Section Five: Tyre Repair Materials

Plug Patch Repairs	p. 102
Puncture Repair Starter Kits	p. 103
Tyre and Tube Repair Materials	pp. 104-106
Plug Repair Patches & Solutions	p. 107
Off-Road "String Insert" Puncture Repair Kits	pp. 108-109
Solutions & Repair Tools	p. 110
Tyre Injury Fillers	p. 111
Tyre Sealants and Pumps	p. 112
Vulcanisers	p. 113

## Section Six: Tyre Valves & Accessories

Truck & Bus Tyre Valves	pp. 116-117
Agricultural & Plant Tyre Valves	p. 118
Tread Depth Gauges	p. 118, 34
Tyre Valve Accessories	p. 119
Air Connector	p. 120
Other Accessories	p. 121
Car/Van Valves, Weights & Accessories	p. 122
Wheel Weight Tools	p. 122
TPMS Sensor Saver Starter Kits	p. 123



# Tyre Service Tools

## Section One:

Truck & Bus Tyre Changing Tools.....	6-10
Tyre Levers.....	11-13
Wheel Lifting Equipment.....	14
Driving Irons.....	14
Tyre Regroovers and Accessories.....	15-16
Tyre Spreaders.....	17
Wheel Nut Wrenches & Braces.....	18
Torque Wrenches.....	19
Wheel Nut Indicators & Restraints.....	20-21
Conspicuity Tape.....	22
Wheel Chocks & Other Accessories.....	23
Wheel Balancing Compounds & Weights.....	24
Bead Seating Tools.....	25-26
Tyre Inflation Safety Cages.....	27
Tyre Service Tools.....	28
Tyre Mounting Compounds.....	29-30
Tyre Inflators.....	31-33
Tyre Pressure/Tread Depth Gauges.....	34, 118
Rechargeable Lights.....	35
Drain Pans.....	36
Liquid Ballast Pumps.....	37

## Truck & Bus Tyre Changing Tools

Deluxe BLUE COBRA® Tubeless Truck Tyre Service Set

CODE

35444



The deluxe set contains:

BLUE COBRA® Truck Tyre Demount Tool

T45A Tubeless Tyre Iron

T45AC Classic Tubeless Tyre Iron

Double-Ended Tyre Spoon

T11ES Bead Breaking Wedge w/ Safety Handle

T35 Heavy-Duty Tyre Hammer

Bucket Euro Paste Lube

Euro-Style Lube Applicator Brush

Aluminium C-Lok™ Bead Holder

Leather Rim Protector

The BLUE COBRA® Truck Tyre Service Set contains all the tools you need to change most 22.5" and 24.5" tubeless truck tyres quickly and easily.

BLUE COBRA® Truck Tyre Demount Tool

CODE

35440



Quickly demount nearly any 22.5" and 24.5" tubeless truck tyre, up to a 13" wide wheel.

Ergonomic-shaped handle with no-slip grip for optimum leverage while reducing back injuries.

Solid steel Cobra head is press-fit into the steel handle – no fasteners to loosen or fall out.

Allows demounting of the tyre without lifting the entire wheel and tyre off the ground, reducing back injuries.

Aluminium bead support to grab the top bead of super single and super wide tyres.

2 heavy-duty nylon rollers are easily replaced when worn.

Kit includes two rollers and two roll pins.

## Truck & Bus Tyre Changing Tools

Gaither Bead Saver System®

CODE

52-550



*Gaither*  
PROFESSIONAL EQUIPMENT

View a product  
demonstration on  
our website

The patented design of Gaither's Bead Saver System® quickly became the industry standard for changing tubeless truck tyres.

By using simple principles of leverage, the Bead Saver System® actually works with the tyre and rim to do the work for you, in less time, with less strain, at a fraction of the cost of tyre changing machines.

The Bead Saver System® mounts and dismounts all tubeless truck tyres from 17.5" up to 24.5" and all super singles. It's the safest, fastest and easiest way ever invented to change tubeless truck tyres - guaranteed not to damage tyre beads.

Gaither Code: #12880E

## Bead Keepers

"Rubberhead"

CODE

52-555RCW

The "Rubberhead" bead keeper will help you avoid costly damage to your expensive alloy wheels while mounting tyres.

"Bead Keeper" holds the tyre bead below the rim flange for fast, damage-free truck tyre mounting.

Suitable for both alloy and steel wheels



Tip: Use 2  
"Rubberheads" and  
you don't need to stand  
on the sidewall.

Gaither "Super Slick-'Em" Lubricant

CODE

46-649



Tip: Use "Super Slick-'Em"  
on all wheels before  
operating any manual,  
hydraulic, or pneumatic  
bead breaker.

*Gaither*  
PROFESSIONAL EQUIPMENT

"Super Slick-'Em" is applied to the tyre bead before the tyre is deflated. This special lubricant will penetrate and aid in breaking the bead from the tyre, without using a hammer.

Penetrates quickly and aids in breaking tyre beads

The special formula eats rust and grease between the tyre and wheel

Will not freeze – a non water-based lubricant

## Truck & Bus Tyre Changing Tools

Gaither J1 J-Tool

CODE

GTC-J1

*Gaither*  
PROFESSIONAL EQUIPMENT



It is strongly recommended that Gaither's "Super Slick 'Em" tyre lube is used in conjunction with the J-Tool.

J-Tool is a revolutionary truck and bus tyre changing tool for quick and easy removal of a wide range of commercial tyre sizes and easy refitting, in conjunction with "Rubberhead" bead keepers.

Gaither Mini Bead-Saver

CODE

GTC-12880M

*Gaither*  
PROFESSIONAL EQUIPMENT



The Gaither MINI BEAD-SAVER is a reduced version of the well-known Bead Saver System.

The tool works in the same way as the full Bead Saver System but with the tyre mounting spoon end now incorporated in the "crook end" of the bar.



It is strongly recommended that Gaither's "Super Slick 'Em" tyre lube is used in conjunction with the Mini Bead-Saver.



## Truck & Bus Tyre Changing Tools

### Super Serpent™ 5 Pc. Tyre Changing Set

CODE 35446



#### Demount Tool

- Unique and lightweight
- For super singles only

Weight: 19lbs (8.6kg)

#### Set includes:

- 1 x Super Serpent Mount Tool,
- 1 x Super Serpent Demount Tool,
- 2 x Brass Bead Holding Device,
- 1 x Leather Wheel Protector

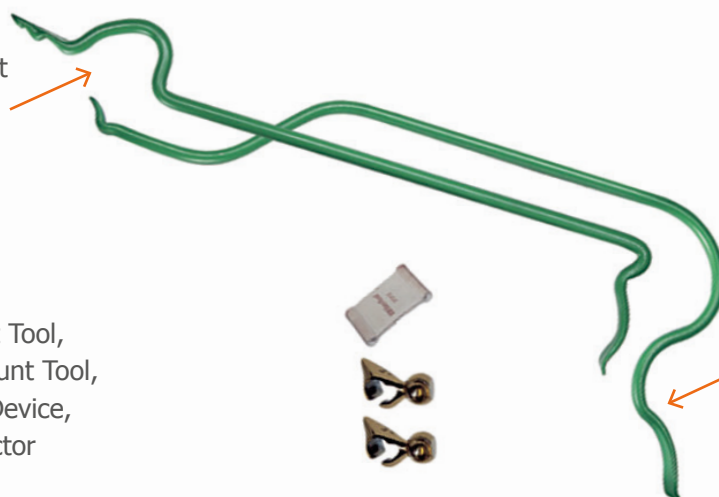

#### Mount Tool

Makes interference of the second bead, while mounting the first, a thing of the past, and delivers twice the leverage of any "straight-type" tyre mounting tool.

- Innovative design
- For super singles only

We also supply the Aluminium Wheel Protector (31810) as a singular item.

### Tyre Mounting & Demounting Tool Set for 19.5" Tyres

CODE 33195



#### 5 Pc. Set includes:

- 1 x Tyre Mounting Tool
- 1 x Tyre Demounting Tool
- 1 x Bead Holder for 19.5" Aluminium Wheels
- 1 x Bead Holder for Steel Wheels – Solid Brass
- 1 x Aluminium Wheel Protector - Leather

Nineteen-Five™ bars are specially designed to work on the hub side to make your job easier, faster and safer!

New tyre bar uniquely designed to work on hub side of wheel – wheel hub protrudes above rim.

Specially-designed ends manipulate tyre with less effort.

Tools are powder-coated to protect from rust and corrosion.

Forged from 3/4" diameter high-grade carbon steel and heat-treated for long-lasting strength and durability.

Patented bead holder to hold beads on 19.5" aluminium wheels.

## Truck & Bus Tyre Changing Tools

### 17.5" Sidewinder™ Set

CODE 35459



Weight: 18.6lbs (8.43kg)

Set includes:

- 1 x 17.5" Bead Holder
- 1 x Demount Tool
- 1 x Mount Tool
- 1 x Gap Tool
- 1 x Leather Rim Protector

The first tyre tools designed exclusively for 17.5" tyres found on vehicle transporters, moving vans and high volume trailers

Patent-pending revolutionary Sidewinder™ demount bar demounts the tyre from the wheel by pushing against the tyre for leverage

Innovative balanced aluminium bead holder specifically designed to stay in place when mounting the problematic bottom bead on 17.5" tyres

## Industrial Lock Ring Tools

### Industrial Wheel Lock Ring Set

CODE 32129

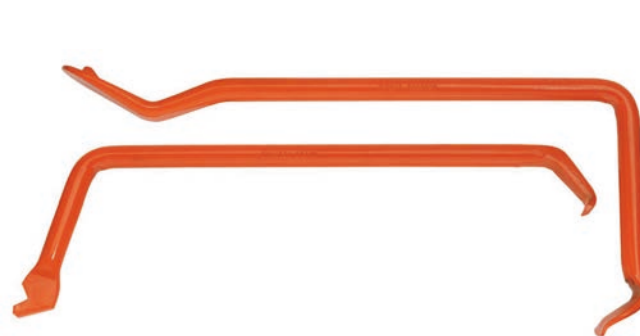

**Ken-Tool**  
WHEREVER TIRES ARE CHANGED™



Weight: 3.3lbs (1.5kg)

Set is comprised of 32131 Demount Prep Tool & 32130 Mount/Demount Tool

Specially-designed to remove & replace lock rings on multi-piece industrial forklift wheels

Helps prevent injury as it's easier to keep hands safely outside of the press cage!

Powder-coated to protect from rust and corrosion.

Forged from high-grade carbon steel and heat-treated for long-lasting strength and durability



## Tyre Levers



Ref	Lever	Length	CODE	
a	Truck	870mm (34")	CODE	TTL1
b	Tractor	770mm (30")	CODE	TTL2
c	Tractor	770mm (30")	CODE	TTL3
d	Truck	870mm (34")	CODE	TTL4
e	Truck	770mm (30")	CODE	TTL4S
f	Truck	970mm (37½")	CODE	TTL5
g	Truck	990mm (39")	CODE	TTL6
h	General purpose Available in lengths:	flat 1¼" wide	CODE	TL32
		250mm (10")	CODE	TL32-10
		305mm (12")	CODE	TL32-12
		350mm (14")	CODE	TL32-14
		450mm (18")	CODE	TL32-18
		610mm (24")	CODE	TL32-24
		770mm (30")	CODE	TL32-30
i	General purpose Available in lengths:	flat 7/8" wide	CODE	TL37
		305mm (12")	CODE	TL37-12
		450mm (18")	CODE	TL37-18
		610mm (24")	CODE	TL37-24
j	Truck	530mm (21")	CODE	TL38
k	Lock ring	520mm (19½")	CODE	TL40
l	Lock ring	510mm (19")	CODE	TL45

Ref	Lever	Length	CODE	
m	Swan neck	600mm (23")	CODE	TL50
n	Hooked	290mm (15¼")	CODE	TL55
o	Double ended spoon	180mm (7")	CODE	TL65
	Double ended spoon	305mm (12")	CODE	TL70
p	Lock ring	550mm (21½") 19mm diam.	CODE	TL81A
q	Double ended flat	230mm (9")	CODE	TL85
r	Spoon	230mm (9")	CODE	TL88
	Spoon	305mm (12")	CODE	TL90
	Spoon	510mm (20")	CODE	TL95
s	EM pry bar	770mm (30")	CODE	TL100
t	EM	980mm (38½") 28mm diam	CODE	TL105
u	Mount/demount bar for manual tyre changers		CODE	50331
v	Chrome vanadium	500mm (20")	CODE	CVL-20
	Chrome vanadium	600mm (24")	CODE	CVL-24
	Sleeve for CVL levers for use with alloy wheels		CODE	CVL-SL



## Michelin Tyre Levers

Michelin tyre levers are top-of-the range levers designed by tyre people for professional users.



Ref	Lever	Length	Width	CODE	
1	Specially designed for motorcycle tyres	380mm	0.5kg	CODE	MOTO
2	For tubeless passenger car tyres	380mm	0.5kg	CODE	FUSIL
3	For tubeless farm vehicle and truck tyres mounted on drop centre rims (small tyre sizes)	530mm	1kg	CODE	FACE
4	For tubeless farm vehicle and truck tyres mounted on drop centre rims (large tyre sizes)	750mm	1.5kg	CODE	FORCE
5	For tube and tubeless tyres mounted on flat rims	450mm	1.5kg	CODE	FIACRE
6	For tube and tubeless tyres mounted on flat rims	415mm	1.2kg	CODE	FIFRE
7	For tubeless truck tyres mounted 15° drop-centre rims	800mm	1.7kg	CODE	HALTE
8	For earthmover tyres	950mm	2.7kg	CODE	SAYAM
9	For lug base (double X) and earthmover tyres mounted on drop centre rims	935mm	3.1kg	CODE	HYOCA
10	For lug base (double X) and earthmover tyres mounted on drop centre rims	990mm	2.9kg	CODE	HYUDA
11	Tyre bead breaker	1390mm	11.5kg	CODE	FAGUS

## Ken-Tool Tyre Levers

Ref	Lever	Length		
Car, Motorcycle, Truck and Agricultural				
1	T43C FACE	530mm (21")	CODE	39806
2	T44 HALTE	790mm (31")	CODE	39808
3	T43D FORCE	760mm (30")	CODE	39810
4	T45A®	940mm (37")	CODE	34645
5	T45A®-2000K	940mm (37")	CODE	34644
6	T16A Small lever	410mm (16")	CODE	32116
7	T9A Small lever	230mm (9")	CODE	32109
8	T19A	760mm (30")	CODE	33219
9	T45HD	1040mm (41")	CODE	34647
10	T23A truck lock ring remover	760mm (30")	CODE	33223



## Wheel Lifting Equipment

IRONMAN™ Ergonomic Wheel Lifting Bar

CODE 34950

**Ken-Tool**  
WHEREVER TIRES ARE CHANGED™



Weight: 10lbs (4.5kg)

Reduces back strain

Easily and safely lift heavy, awkward truck tyre and wheel assemblies

Extremely useful in outdoor conditions - when truck tyre and wheel assemblies can become wet and slippery

Lift all sizes and types of small and large heavy truck wheels



Specially-designed forged ends work from either side of the wheel assembly as it lays flat

## Driving Irons

T26A Driving Iron

CODE 32126



**Ken-Tool**  
WHEREVER TIRES ARE CHANGED™

Weight: 4.4lbs (2kg), Length: 11-3/4" (30cm)

Driving iron is used for loosening rusted truck and bus beads

Will speed up truck tyre repair work and save labour and time

## Tyre Regroovers

### Truckstar Plus

CODE PSO-TRSTAR-P



A high-quality, European-made tyre regroover with push button heat control, allowing variable heat settings in 1% increments

Automatic shut off after 15 minutes of no use

Robust steel transformer case

Lightweight cutting head

Supplied with a pack of a popular blade size

Conforms to EC directive EN60335-2-45

### Standard

CODE PSO-PS15

A high-quality, European-made tyre regroover

4 heat settings plus zero position

Robust steel transformer case

Lightweight cutting head

Supplied with a pack of a popular blade size

Conforms to EC directive EN60335-2-45



## Regrooving Blades

### Cutting Blades R Series



Blade type	R1 Code 93-211	R2 Code 93-213	R3 Code 93-214	R4 Code 93-215	R5 Code 93-212
Lower cutting width	3mm	5mm	6mm	8mm	10mm
Cutting depth	7mm	7mm	10mm	12mm	12mm
Upper cutting width	5mm	8mm	15mm	16mm	18mm
Blade depth	21mm	21mm	23mm	25mm	24mm
Quantity per pack	20	20	20	20	20

### Cutting Blades W Series



Blade type	W1 Code 93-216	W2 Code 93-217	W3 Code 93-218	W4 Code 93-219	W5 Code 93-220	W6 Code 93-221
Lower cutting width	3mm	5mm	7mm	9mm	11mm	23mm
Cutting depth	7mm	7mm	10mm	12mm	12mm	12mm
Upper cutting width	5mm	6mm	10mm	13mm	15mm	28mm
Blade depth	21mm	21mm	22mm	24mm	23mm	24mm
Quantity per pack	20	20	20	20	20	10

## Tyre Regroovers and Accessories

RILLFIT-R6

CODE 93-210

From the inventors of tyre regroovers and the world leaders in tyre regrooving technology



The RILLFIT-R6 features:

5 position switch – 4 heat settings and off

Hi-tech toroidal power transformer with thermo switch for safe and powerful non-stop cutting

Super flexible connection cable - ergonomic and operator-friendly

Ergonomic handgrip

Greater water resistance for the transformer casing and high standard temperature pre-set switch

Additional blade adjustment pattern

Compatible with all existing Rillcut blades

TUV and CE certificated

Regrooving Depth Gauge

CODE PSO-15000

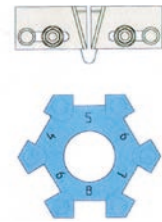
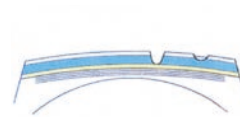

PSO Tyre Regrooving Stand

CODE PSO-STAND



The support forms a base for the tyre, enabling you to regroove any sort of HGV tyre quickly and easily

The tyre is rotated in a single direction and mounting/dismounting is completed in a matter of seconds with no tools required

This stand measures 60 x 60cm

Please note the regroover is sold separately

We also stock spare parts for RILLFIT and PSO regroovers



## Tyre Spreaders

Tyre Spreader

CODE

GTS-01



For use with a manual wrench or a ratchet wrench with 32mm socket

Ideal for quick and efficient tyre repairs

Min jaw closure	35mm
-----------------	------

Max jaw opening	355mm
-----------------	-------

Weight	3kg
--------	-----

*Gaither*  
PROFESSIONAL EQUIPMENT

Ratchet Action Truck Tyre Spreader

CODE

31554



Heavy-duty ratchet action truck tyre spreader

Model	T54
-------	-----

Min jaw closure	89mm
-----------------	------

Max jaw opening	360mm
-----------------	-------

Weight	7.3lbs (3.3kg)
--------	----------------



**Ken-Tool**<sup>®</sup>  
WHEREVER TIRES ARE CHANGED™

## Spin Wheel Nut Wrenches

### Spin Wheel Nut Wrenches



Heavy-duty spin wheel nut wrenches from Ken-Tool.  
Available in the following sizes:

4 Way - 24 x 27 x 30 x 33mm

700mm long arms **CODE** 35795

4 Way - 13/16", 15/16", 3/4", 7/8"

560mm long arms **CODE** 35659



### Spin Wheel Nut Wrenches



High quality vanadium steel with a blue epoxy finish.  
22mm diameter bar. Available in the following sizes:

4 Way - 24 x 27 x 33 x 38mm

500mm long arms **CODE** 4WL/P

650mm long arms **CODE** 4WL/EL/P

6 Way - 24, 27, 32, 33, 38mm and 3/4" drive

650mm long arms **CODE** 6WL/EL/P3



## Wheel Nut Braces

### Standard and Heavy-Duty versions available

Manufactured from high-quality steel bar and tube for heavy-duty applications. For regular breakdown use these braces are available in all wheel nut sizes with either Hex or Bi-hex sockets (please specify when ordering).



Tip: Use the double-ended 1" square drive "L" brace with regular or impact 1" drive sockets to cover all eventualities.

#### L Brace Support Stand

This handy stand gives stability to "L" wheel braces while "cracking" wheel nuts.  
Suitable for all wheel rim sizes

**CODE** 50011



Size	Standard	Heavy-Duty
Extension bar	-	50000
L brace 17mm	50001 STD/17	50001/17
L brace 19mm	50001 STD/19	50001/19
L brace 24mm	50001 STD/24	50001/24
L brace 27mm	50001 STD/27	50001/27
L brace 28mm	50001 STD/28	50001/28
L brace 30mm	50001 STD/30	50001/30
L brace 32mm	50001 STD/32	50001/32
L brace 33mm	50001 STD/33	50001/33
L brace 36mm	50001 STD/36	50001/36
L brace 38mm	50001 STD/38	50001/38
L brace 41mm	50001 STD/41	50001/41
L brace 1" drive	-	50010

## Torque Wrenches

### Sykes-Pickavant MOTORQ Torque Wrenches



All models supplied with calibration certificate traceable to National Standards

Features:

Secure locking mechanism to avoid forced adjustment against the lock

Extended for comfort and reduced calibration drift

72 tooth ratchet

Dual scale – Nm and lbf.ft

Chemical-resistant lens for clear reading of scale. Accurate to +/- 3%. Manufactured to ISO6789 standard

Square drive	Nm range	Lbf.ft range	Length	Weight	CODE	
1/2" push-thru	40 – 200	30 – 148	455mm	1kg	06605	
1/2" push-thru	60 – 300	44 – 221	570mm	1.4kg	06606	
1/2" push-thru	60 – 330	44 – 243	690mm	1.4kg	06607	
3/4" push-thru	80 – 400	59 – 295	690mm	2.1kg	06608	

### Sykes-Pickavant MOTORQ Commercial Torque Wrenches

Featuring a break back mechanism, 36 tooth ratchet head, and graduated scale on the handle for easy adjustment



All models supplied with calibration certificate traceable to National Standards

Square drive	Nm range	Lbf.ft range	Length	Weight	CODE	
3/4" push-thru	150 – 700	110 – 516	1090mm	6kg	06609	
3/4" push-thru	300 – 1000	221 – 738	1470mm	7kg	06610	
Norbar 5R 1" push-thru	300 – 1000	200 – 750	1475mm	10.4kg	06611	

Also available in 6", 10" & 12" lengths



3/4" drive 16" extension bar for use with commercial torque wrenches	CODE	TGM340022
1" drive 16" extension bar for use with commercial torque wrenches	CODE	TGM110050



Drive adapter for the commercial torque wrench. 3/4" male to 1" male	CODE	06610/AD
--	------	----------

### Torque Multiplier

CODE TQ1

This Professional Torque Multiplier will loosen the tightest wheel nuts on trucks, agricultural machines and other heavy vehicles.

Maintenance-free with a maximum torque output of 3500 Nm and a high power ratio of 1:68

Complete with 32 & 33mm impact sockets



## Wheel Nut Indicators & Restraints

**Loose Wheel Nut Indicator** Available in sizes from 17mm to 50mm

CODE

CKT



Available in colours: yellow, red

Loose wheel nut indicator that is used extensively by the transport industry as an enhancement and development of fleet safety roadworthiness procedures, daily walk-round inspection and defect reporting and scheduled maintenance requirements. Its use allows accurate monitoring for loose wheel nuts and helps prevent wheel hub damage or the loss of a road wheel should a wheel nut loosen.

**Interlink** Available in sizes 30, 32, 33mm

CODE

CKL



The Interlink helps ensure, by linking one wheel nut to the next, that a loosened wheel nut will not spin off the stud. However, the Interlink is not a wheel nut-locking device. It is a wheel nut restraint should a wheel nut loosen off. As such, it is for use as an integrated part of a roadworthiness fleet risk management reporting and documenting regime. The wheel nut link will distort if one of the nuts is loose.

**Wheel Nut Cap Indicator** Available in sizes 24, 27, 28, 30, 32, 33, 38mm

CODE

DUST



Combining the effectiveness of the wheel nut indicator with a cap which helps to protect the wheel nut from corrosion and gives a visual indication of loose wheel nuts.

**Long Reach Wheel Nut Cap Indicator**

CODE

DUST-LR



Available in colours: yellow, red

For use where wheel trims with wheel nut access holes have been fitted. Until now, the fitting of a wheel trim has made it difficult to effectively use the standard loose wheel nut indicator products.

Available in sizes 17, 19, 21, 22, 24, 27, 30, 32, 33mm

A reflector version of this Wheel Nut Indicator is available as shown

**Short Reach Wheel Nut Cap Indicator**

CODE

IP

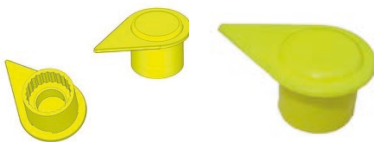

Wheel Nut Cap Indicator with short barrel length of only 21mm, suitable for minibuses and other similar vehicles

Available in sizes 17, 19 and 21mm

**INTERCLIP Wheel Nut Restraining System**

CODE

ICLIP



Improves vehicle safety  
Easy to fit  
Cost-effective

INTERCLIP wheel nut restraining system works by linking one wheel nut to the next so that a loosened wheel nut will not spin off the stud. INTERCLIPS are fitted over adjacent wheel nuts (5 clips being required for a 10-stud hub).

27mm wheel nut diameter size - PCD 205mm - For 6 Stud Wheels

30mm wheel nut diameter size - PCD 275mm - For 8 Stud Wheels

32mm wheel nut diameter size - PCD 225mm - For 10 Stud Wheels

32mm wheel nut diameter size - PCD 335mm - For 10 Stud Wheels

33mm wheel nut diameter size - PCD 335mm - For 10 Stud Wheels

## Twindicator

### Twindicator wheel nut indicator



The Twindicator helps with wheel nut security and has all the current benefits of the standard wheel nut indicator, with the added benefit of a retaining function.

Underneath there is a bridge that links the two pointers together and provides an increasing counterforce during stretching and elongation, allowing the pointer to rotate 45 – 50 degrees

Until a balance arises between the loosening torque and the force to ratchet within the indicator, the Twindicator functions as a ratchet, keeping it in a recognisable position and providing a counterforce for the loosening torque, meaning some clamping force is maintained.

Clamping force prevents the wheel from wobbling, which is recognised as the last stage before wheel detachment.

- Easy to Fit like a standard indicator
- Low Height for re-torquing

Can be supplied in High Temperature versions ( 165 degrees c) to suit applications such as car transporters and buses where temperatures can be high due to lack of air cooling.

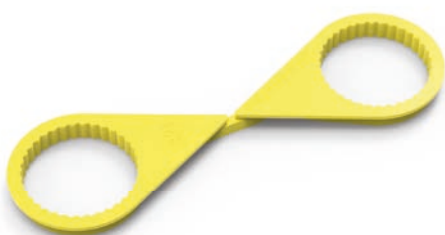

#### Truck , Bus, Trailer 22.5 " , PCD 335, 10 Stud Wheel

CODE	TWIN335/32Y	Yellow - 32mm
CODE	TWIN335/33Y	Yellow - 33mm
CODE	TWIN335/32RED	Red - 32mm
CODE	TWIN335/32GREEN	Green - 32mm
CODE	TWIN335/32MAGE	Magenta -32mm
CODE	TWIN335/33RED	Red -32mm
CODE	TWIN335/32Y-HT	Yellow High temp - 32mm
CODE	TWIN335/32R-HT	Red High temp -32mm
CODE	TWIN335/33Y-HT	Yellow High temp - 33mm
CODE	TWIN335/33R-HT	Red High temp - 33mm

#### Low Loader Trailer PCD 225, 10 Stud Wheel

CODE	TWIN225/32Y	Yellow - 32mm
CODE	TWIN225/32RED	Red - 32mm
CODE	TWIN225/32Y-HT	Yellow High temp - 32mm
CODE	TWIN225/32RED-HT	Red High temp - 32mm
CODE	TWIN225/32BLACK-HT	Black High temp - 32mm
CODE	TWIN225/32BLUE-HT	Blue High temp - 32mm

## Conspicuity Tape

### ECE-104 Microprismatic Reflective Vehicle Conspicuity Tape



Since July 2011, Regulation ECE 104 has required that all newly registered heavy goods vehicles over 7.5 tonnes and trailers over 3.5 tonnes have retro-reflective conspicuity markings that clearly outline the rear and sides of the vehicle to increase its visibility.

This tape is ECE-104 certified for Vehicle Markings for trucks and trailers with rigid surfaces.

Provides excellent reflectivity which enhances driver's day and night time safety

VC-E4 sealing tape consists of micro-prisms, sealed and backed with pressure sensitive adhesive and clear poly liner

Ideal for trucks, trailers, tankers, buses and more

Clear, solvent-based, permanent adhesive

Durability: 7-8 years

Width: 2"

Certifications: UN-ECE 104, AIS090

Colours Available: White, Yellow, Red

Length	Colour	CODE	White (VC-E41W), Yellow (VC-E41Y), Red (VC-E41R)
1m	White, Yellow, Red	CODE	White (VC-E41W), Yellow (VC-E41Y), Red (VC-E41R)
2m	White, Yellow, Red	CODE	White (VC-E42W), Yellow (VC-E42Y), Red (VC-E42R)
5m	White, Yellow, Red	CODE	White (VC-E45W), Yellow (VC-E45Y), Red (VC-E45R)
10m	White, Yellow, Red	CODE	White (VC-E410W), Yellow (VC-E410Y), Red (VC-E410R)
12.5m	White, Yellow, Red	CODE	White (VC-E4125W), Yellow (VC-E4125Y), Red (VC-E4125R)
15m	White, Yellow, Red	CODE	White (VC-E415W), Yellow (VC-E415Y), Red (VC-E415R)
25m	White, Yellow, Red	CODE	White (VC-E425W), Yellow (VC-E425Y), Red (VC-E425R)
50m	White, Yellow, Red	CODE	White (VC-E450W), Yellow (VC-E450Y), Red (VC-E450R)



## Wheel Chocks and Other Accessories

### Wheel Chock

CODE IP-CHOCK



Homologated yellow plastic wheel chock with metal insert

Conforms to EC Regulation DIN76051-E53

Suitable for large trailers

Length	Width	Height	Radius	Weight
467mm	198mm	225mm	555mm	1.25kg

### Plastic Chock Holder

CODE IP-CHOCKH



Made for wheel chocks

Supplied in black

Length	Width	Height	Weight
284mm	194mm	344mm	0.7kg

### Plastic Fixing Support

CODE IP-CHOCKF



Made for wheel chocks

Supplied in black

Length	Width	Weight
258mm	55mm	0.18kg

### Document Roll Holder

CODE IP-DOCUR



Ideal for A4 documents

Strong and durable

Height	Width
340mm	124mm

### Document Box Holder

CODE IP-DOCUB



Ideal for A4 documents

Side opening for ease of use

Height	Length	Width
367mm	318mm	74mm

## Commercial Vehicle Wheel Balancing

### EASYBALANCE Commercial Vehicle Wheel Balancing Compound



Comes with  
quantity/tyre size  
application chart



EASYBALANCE is a compound balancing material that is put directly into the tyre as it is being fitted on the wheel rim. When the vehicle reaches a speed of approximately 25km/hr centrifugal force distributes the compound, which will counteract any imbalance, to perfectly balance the wheel.

Permanent balancing during the lifetime of the tyre

Faster balancing/measured application by tyre size

Permanent balancing constantly adjusts to changing load effects

Extended tyre life

A higher level of driving comfort

Tyres can be repaired and remoulded

Absorption of humidity inside the tyre

No lump formation

Environmentally-friendly as it requires no special disposal measures

#### Size

100 gram bag	CODE	EB-100G
200 gram bag	CODE	EB-200G
300 gram bag	CODE	EB-300G
350 gram bag	CODE	EB-350G
500 gram bag	CODE	EB-500G
3000 gram tub	CODE	EB-3000G
7500 gram tub	CODE	EB-7500G

### Truck Clip-On Wheel Weights

Truck clip-on wheel weights by TRAX, available in the following sizes:

Size	Box QTY	CODE	
50	10	CODE	0150G
75	10	CODE	0175G
100	10	CODE	01100G
150	10	CODE	01150G
200	10	CODE	01200G
250	10	CODE	01250G
300	10	CODE	01300G



**TRAX**  
balance weight technology



## Bead Seating Tools

### CH5 Cheetah

CODE

CHEETAH



Easy to use  
on car, truck,  
agricultural and  
ATV tyres

The CH5 Cheetah has turned one of the most frustrating and time-consuming jobs in the tyre shop into one of the quickest and easiest.

This product seats the beads of difficult tubeless tyres instantly by directing a rush of air into the gap between the tyre and rim, lifting the bead to give a contact seal which allows the tyre to inflate.

Perfect for service vehicles

Will save you time and money as there is no need for various sizes of bead seating rings

Works for all sizes

Supplied with full CE certification

### Gaither Bead Bazooka

Gaither's revolutionary Bead Bazooka combines the unique rapid air release technology and easy-to-handle tank for seating tubeless tyre beads. Simply fill the tank, aim the redesigned Double Barrel, and FIRE!!

The instantaneous blast of air from the tank will work on truck (including super singles), passenger, motorcycle & ATV wheels.

The 9 & 12 litre models will also suit some small Agricultural and OTR tyres

Features include:

Most powerful automatic release system available in any bead-seating device

All Bead Bazookas are lightweight, reducing stress on the technician

Push-button trigger allows technician to keep both hands on the tank for more control, making it safer than manual release tanks



We also supply  
the Gaither Bead  
Bazooka Stand

*Gaither*  
PROFESSIONAL EQUIPMENT

Three models available:

6 litre	CODE	BB06L
9 litre	CODE	BB09L
12 litre	CODE	BB12L

"Slotted" Double Barrel directs the air for best overall lift. Fully CE & ASME certified

## Bead Seating Tools

Gaither Bead Seater 38 Litre

CODE

GB 38L



Automatic Rapid Air Release System makes this the most powerful inflation product in the market

38l (10 gallon) tank provides enough volume to handle large OTR and agricultural tyres with ease

Lightweight aluminium tank (11.5kg) reduces stress on the technician and allows for easy manoeuvring around large tyres

2" exhaust valve allows for optimal airflow from tank and increased efficiency

Patented 2" jet-assisted barrel creates a natural effect that draws 2 times the amount of surrounding air into the tyre chamber when fired

Fully ASME, CE, TUV, & CRN certified

## Tyre Inflation Safety Cages

### Fixed Model Safety Cages

Heavy-duty workshop tyre inflation cages.

Available in four sizes:

1240 x 1240 x 610mm	CODE	TSC121260
1240 x 1240 x 915mm	CODE	TSC121290
1830 x 1830 x 762mm	CODE	TSC181870
1830 x 1830 x 915mm	CODE	TSC181890



Fully enclosed, heavy-duty workshop tyre inflation cages. Mesh enclosed for full protection from air blast.

Available in five sizes:

915 x 915 x 610mm	CODE	TSC09096E
1240 x 1240 x 610mm	CODE	TSC12126E
1240 x 1240 x 915mm	CODE	TSC12129E
1830 x 1830 x 762mm	CODE	TSC18187E
1830 x 1830 x 915mm	CODE	TSC18189E

Other sizes can be made on request

## Tyre Inflation Safety Devices

### BAG-IT



The BAG-IT tyre safety device is a lightweight, compact and totally portable means of protecting operators from the dangers associated with tyres exploding under inflation. Used on-site or on the roadside, this unique product is designed to defuse the force of an exploding tyre, whilst containing the cloud of dirt and debris, including steel cord, which are projected at high speed and are a particular hazard to an unprotected face and eyes.

BAG-IT is made from high impact fabric with elasticated shock cord at the front and a drawstring at the rear. Before inflation, the BAG-IT is placed around the tyre and secured by means of the drawstring. Should the tyre explode, the BAG-IT expands and the openings allow the initial blast to escape, diffusing the shock of the explosion, whilst any projected debris is contained.

BAG-IT has been rigorously tested in the UK and the USA and excellent results have been achieved. BAG-IT is the only product that provides protection from the force produced by a compressed air explosion.

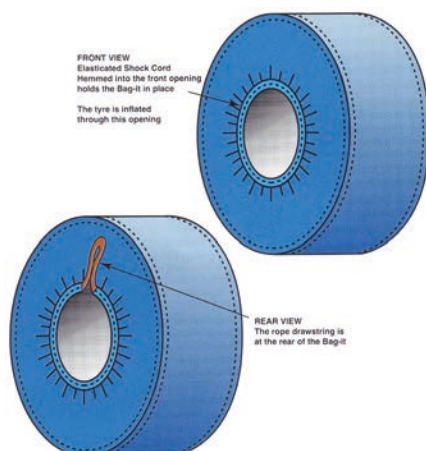

Tyre safety device for passenger cars	CODE	BAG-IT/B1
Tyre safety device for vans and light trucks	CODE	BAG-IT/B2
Tyre safety device for commercial tyres up to super singles	CODE	BAG-IT/B3

Aimed at the commercial tyre market, BAG-IT will fit all common sizes. It can also be supplied in a smaller format to give the tyre installer full protection when working with larger or smaller tyres.

## Tyre Service Tools

### Tyre Test Tank



A handy "tyre bath" for puncture testing on car and light van tyres and inner tubes.

Height of test tank avoids unnecessary bending.

Test tank and stand	CODE	50341
Replacement bowl only	CODE	50341/RB

### Bead Wedge

CODE 50326

A handy device for holding down the sidewall of truck tyres while fitting the tyre.

Avoids the tyre bead slipping up over the rim, and the need to stand on the sidewall.



### Rubber Mallet

CODE 67218-67



A 1kg rubber mallet for general tyre and workshop use.

The mallet has an internal metal structure that prevents handle breakage

The rubber has excellent resistance to tearing and this makes it the most popular hammer of this type

### Gaither Click & Go Valve Core Tool

CODE GT10-6

This tool mechanically locks the valve core in place so that the valve cores don't get blown across the shop when deflating a tyre and makes it much easier to install a core into a new stem/wheel assembly.

There is no magnet so there is no chance of this tool interfering with TPMS

*Gaither*  
PROFESSIONAL EQUIPMENT



## Tyre Mounting Compounds

### "Super Slick-'Em" Lubricant

CODE 46-649



"Super Slick-'Em" is applied to the tyre bead before the tyre is deflated. This special lubricant will penetrate and aid in breaking the bead from the tyre, without using a hammer.

Penetrates quickly and aids in breaking tyre beads  
The special formula eats rust and grease between the tyre and the wheel  
Will not freeze – a non water-based lubricant

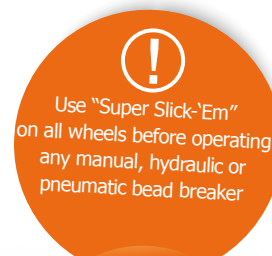

Use "Super Slick-'Em" on all wheels before operating any manual, hydraulic or pneumatic bead breaker



*Gaither*  
PROFESSIONAL EQUIPMENT

Supplied individually or as a case of 4 x 5 litres

### Speed Grease

CODE GG-SPG04

4kg tub Go-Gomma special yellow tyre mounting grease  
Designed for use with truck, bus, farm and earthmoving tyres  
Excellent performance  
Ultra slipperiness  
Rust protection  
Won't freeze  
Long shelf life



### Pink Panther Grease Rim Seal

CODE GG-PPG04



4kg tub Go-Gomma gel rim seal with super slipperiness for mounting tubeless tyres

Suitable for deformed and rusted rims, or on tyres with loss of air around the bead.

Gel dries to form a polymer film between the rim and the bead. Won't freeze, and helps prevent corrosion

### Blue Panther Grease

CODE GG-LBPG04

4kg tub Go-Gomma special paste designed for run flat and low profile, high performance tubeless tyres  
Ultra slippy, rapid drying  
Ideal for mounting tyres with automatic tyre changers on alloy rims  
Won't freeze and helps prevent corrosion



## Tyre Mounting Compounds

### Black Panther Grease

CODE GG-BPG04



Go-Gomma black universal mounting paste

Non-staining, super high protection of the beads and rust protection for the rims

Designed for rapid mounting and de-mounting of all types of motorcycle, car, bus and truck tyres

Won't freeze and helps prevent corrosion

### Earthmover Mounting Grease

CODE 135670



5kg tub

A tyre mounting grease specifically formulated for earthmover tyres.

Also available in  
a 12.5kg  
container

### Myers Tyre & Tube Mounting Compound

CODE 46633



Good for  
Earthmover/OTR  
tyres, truck and  
passenger

11kg tub

Myers Tyre and Tube Mounting Compound is designed to assist in mounting rubber tyres and tubes on all types of wheels.

It is fortified with rust inhibitors to provide protection against corrosion of the wheels. Thick vegetable based, jelly-like lubricant. Comes with an applicator swab inside the bucket.

Environmentally-friendly

Non-toxic, biodegradable

Totally safe for all tyres

Made from natural, renewable resources

Economical when diluted

No petroleum oils of any kind

Excellent for general purpose tyre mounting and de-mounting applications.

Can be used concentrated or diluted (add to water: 1 part lube and 3-4 parts water), mix slowly or let it sit overnight to have a superior, environmentally-friendly and economical tyre mounting liquid lube.



Small paste brush CODE 60804

Large paste brush CODE 60805

## Digital Tyre Inflators

### Schrader Digital Readout Inflation Gauge

CODE 39901



**SCHRADER**  
**DIGIT AIR**

High quality and performance, strong gauge with the latest pressure reading technology

Calibrated range from 1.5 psi to 160 psi

Easy-to-read thanks to 12mm high numbers

Gauge turns on when pressurised (connection to valve)

Turns off automatically when pressure is withdrawn or without constant pressure for 10 seconds

Duration of battery: 10 years after manufacture in temperate environment

### PCL ACCURA® MK4 Digital Tyre Inflator

CODE DAC406

This inflator marries the ruggedness of a metal analogue inflator with the lightness, accuracy and ease of use of a digital gauge

Replaceable 2 X AAA batteries power unit (supplied)

Max Inflation Pressure: 250 psi / 17.2 bar / 1723 kPa

Reading Accuracy: 0.1 psi / 0.01 bar / 1 kPa

Calibration: 4-250 psi / 0.3-17.2 bar / 30-1723 kPa

Complete with 2.7m hose

Higher pressure range for multiple applications 4 – 250 psi range (including trucks)



### PCL Digital Readout Inflation Gauge

CODE PCL DTI 08



**PCL**

This highly accurate inflator is suitable for all kinds of tyre applications

Large, clear, easy-to-read LCD display with backlight

Reliable accuracy (+/- 1 psi up to 60 psi, then 2 psi up to 150 psi) with individual certification

Long battery life with battery level indicator

Complete with 1.8m hose

Hand trigger inflate and thumb-controlled deflate

Pressure Range: 5-170 psi / 0.34-12 bar

Max Supply Pressure: 218 psi / 15 bar / 1500 kPa

Resolution: 0.1 psi / 0.01 bar / 1 kPa

Duration of battery: 1000 hours with backlight off / 40 hours with backlight on

## Tyre Inflators/Air Line Gauges

### Schrader "UNIV'AIR" Dial Face Air Line Gauge



Calibrated 10-160 psi / 0.7-11 bars

Supplied with a calibration certificate

Same spec as Michelin Eurodainu but just Schrader branded

1/4" female air inlet thread



The construction of this top quality gauge allows faster inflation rates than with conventional in-line gauges; the air flow passes directly from the air inlet to the valve connector passing under the gauge.

Standard gauge with 1.5 metre hose to clip-on Euro valve connector

**CODE** S39702

Tyre shop gauge with 3 metre hose to clip-on Euro valve connector

**CODE** S39702-3

EM gauge with 6 metre hose to clip-on Large Bore EM Euro valve connector

**CODE** S39702-6 EM

### MICHELIN Licensed "Eurodainu" Dial Face Tyre Inflator

**CODE** W1991

The construction of this top-quality gauge allows faster inflation rates than with conventional in-line gauges; the air flow passes directly from the air inlet to the valve connector passing under the gauge.

Dual calibrated 10-160 psi and 0.7-11 bars

Single clip-on valve connector

Gauge enclosed in a protective rubber bumper

Has a 1/4" female air inlet thread

Conforms to CE directive 86/217/EEC



### Schrader "MAST'AIR" Tyre Inflation Gauge

**CODE** S39106



Dual calibrated – 0-12 bars and 0-170 psi

Robust rubber covered body with large (75mm diam) dial face

Complete with certificate of accuracy



### PCL AIRFORCE Gauge

**CODE** PCL-AFG1H06



PCL's AIRFORCE air line gauge with 9" hose length and a twin clip-on connector for truck tyre service use





## Tyre Inflators

### PCL ACCURA QUBE Tyre Inflator

CODE

QUBE1



PCL has cost-effective and accurate tyre inflation boxed off with this space-saving, entry-level unit, the ACCURA QUBE Tyre Inflator.

PCL proves that being square can be stylish with its simplest electronic tyre inflator to date, the user-friendly ACCURA QUBE Tyre Inflator. This tiny 150mm x 150mm unit packs a petite but powerful punch, offering fast and accurate tyre inflation within a simple, safe, state-of-the-art design.

Simple to operate - preset the required pressure, place the connector on the tyre and let the in-built auto-start function do the rest.

This 230 volt unit comes complete with a UK plug and a 5m inflation hose.

- Consistent cost-effective provision of high levels of safe air inflation services
- Plug and play - tyre inflator with 3 pre-selectable application modes
- Fits all applications - general, tyre shop and N2
- Low and simple maintenance
- Electronic pressure preset
- Touch screen technology
- Ceramic sensor - accuracy to +/- 0.5% of full scale reading

### PCL MK4 Gauge

CODE

AFG4H06



The already highly-regarded predecessor to the AIRFORCE® MK4, the classic MK3 Tyre Inflator has been industry standard in many garages, petrol forecourts & tyre depots for over 25 years. Many thought the MK3 could not be improved...until now!

The new AIRFORCE® MK4 Tyre Inflator is as robust as ever and highly accurate, offering leading inflation and deflation rates and high performance for both indoor and outdoor applications. Meanwhile, the redesigned piston and seal arrangement means increased accuracy - cycle tests now give over 400,000 inflation cycles at 100% accuracy - over 50% more than previously!

9ft (2.7m tyre shop model) with twin clip-on connector  
Calibration: 0-138 psi / 0-9.6 bar  
12ft (3.6m) hose version available – Code AFG5H36

## Tyre Pressure/Tread Depth Gauges

### PCL Heavy-Duty Universal Service Gauge

CODE TPG60H03



This heavy-duty gauge has a black vulcanite handle to withstand rigorous use over a long period.

Suitable for cars and commercial vehicles, it is fitted with an extra large filter to protect the quality mechanism.

Calibration: 10 – 160 psi / 0.8 – 11 bars in 2 psi / 0.2 bar units

### PCL Digital Tyre Pressure Gauge

CODE DTPG7

This 3-in-1 Digital Tyre Pressure and Tread Depth Gauge with light is self-calibrating and features a 90 second auto power off. Easy to use, with a stylish blue light which is ideal for working in the dark.

Measures: Pressure 2 - 100lbf/in<sup>2</sup> & 0.15-7bar and 15-700kPa. Tread Depth: 0-15mm



### Digital Tyre Pressure Gauge

CODE DTPG8



Accuracy +/- 1 %  
Reading Resolution 0.2 psi / 0.01 bar / 1 kPa  
Battery 2 x AAA / LR03  
Head Type Straight & Angled  
Calibration 0-174 psi / 0-12 bar / 0-1200 kPa

This Digital Tyre Pressure Gauge is self-calibrating and features a 30 second auto power off. Easy to use, simply press the "ON" button and the Digital Tyre Pressure Gauge is then ready to use.

Tyre pressures are displayed in your choice of 4 measurement options - psi / bar / kPa / kg/cm<sup>2</sup>

Replaceable batteries Backlit screen for easy reading in dark or low light areas. Comes included with calibration certificate

Pressure range: 0 - 150 psi; also in bars, kg/cm & kpa

Accuracy: +/- 1% at 100 psi and +/- 2% at 150 psi

Backlit LED display with auto switch off

Fitted with a twin tyre valve connection for access to valves on dual wheel assemblies

Length: 300mm

### Digital Commercial Tyre Tread Depth Gauge

CODE DTDG1D04

Made from extra strong carbon fibre composite

Large LCD display

Zero setting in any position

Metric, decimal inch and fraction inch (1/64") toggle

1 battery: SR44 1.5v (supplied)

Range: 0-25mm



## Rechargeable Lights

### Omega Rechargeable Lights

CODE

PL-1001



Powerful 24 LED Pocket Light

Two Steps: full illumination & half illumination

Comes complete with strap and charger

Adjustable magnetic support

Run time: 1.5 hours at full illumination and 3 hours at half illumination

Luminous flux: 220 lm

Charging time: 2.5 – 3 hour



### PCL Multifunctional Light

CODE

MA001

This multifunctional work light is ideal for increasing vision in areas of low light, particularly for increasing light in under car areas.

Also very handy as a general purpose light that can either be hung up or used with the magnet attached to the rear.

#### Key Product Benefits:

24 high intensity output LEDs that never get hot

LED lifetime: 100,000 hours

4 hours continuous use

Comes complete with foldaway hanging hook

Requires 3 x AA batteries



## Drain Pans

Pro Super Single Axle Drain Pan

CODE

30600



**Ken-Tool**  
WHEREVER TIRES ARE CHANGED™

The Ken-Tool Professional Super Single Axle Drain Pan is designed for workplace safety. The highly visible bright orange colour helps technicians to avoid spilling a pan attached to the axle or sitting on the floor, and the tip-resistant design helps keep shop floors slip-free. Additionally, the bright orange colour makes it easier to spot oil contaminants and parts when draining the axle.

Securely catches oil and grease

Lightweight moulded plastic pan that locks inside truck and trailer wheels to keep tyre and wheel clean

Fits most steel and aluminium 22.5" and 24.5" 10-hole hub and stud-piloted tubeless wheels

Allows 2 or 3-hole stud attachment to wheel using finger-tightened lug nuts, will not tip

124 oz. / 3.6 litre capacity with self-draining shelves for hub and axle nuts

Made in USA from HPDE high-density polyethylene design - won't warp if oil is warm

Keeps wheels and tyres clean when servicing



## Liquid Ballast Pumps

Yamada Calcium Chloride Pump with Accessories

CODE 15100

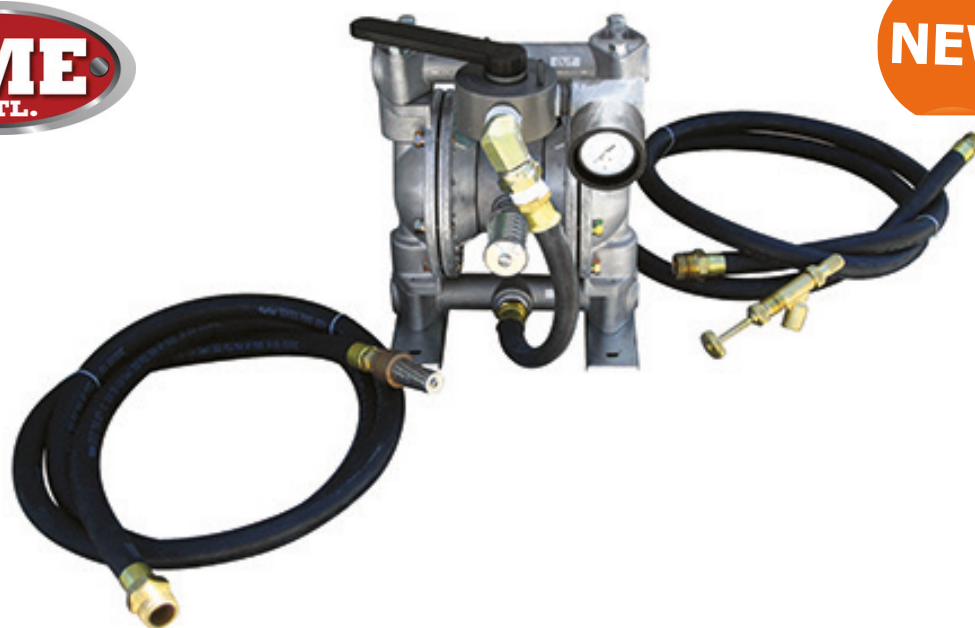

**AME Liquid Ballast Pump for improving tractor stability and tyre traction.**

40 gallon (152 litre) per minute capacity; 1-to-1 ratio double diaphragm pump

Bolted construction which eliminates leaks and simplifies post-maintenance reassembly

Outside-accessible air valve

Patented air valve technology

Handles a wide variety of fluids with a high solids content

Self-priming

Ability to run dry

Simple installation and portable

Variable flow rate and discharge pressure

High-pressure capabilities

No mechanical seals, couplings or motors

No pressure relief or bypass needed

Maintenance-free, with no cumbersome snap rings or lubricated dynamic O-rings to replace or repair

Weight: 38 lbs. (17.2kg)

Pump with quick connectors: 15100 (QC)

**Comes complete with accessories!**

# Notes

# Tyre Bead Breakers and Accessories

---

## Section Two:

Bead Breakers.....	40-41, 44-48, 51
Hammers.....	42
Bead Holders & Protectors .....	43
Back Bead Rams .....	49
Hydraulic Pumps .....	50
Wheel Push Off/Separation Tools.....	52-53
Hydraulic Couplers & Hoses .....	54

## Manual Bead Breakers

### Heavy-Duty Bead Breaker

CODE 50321

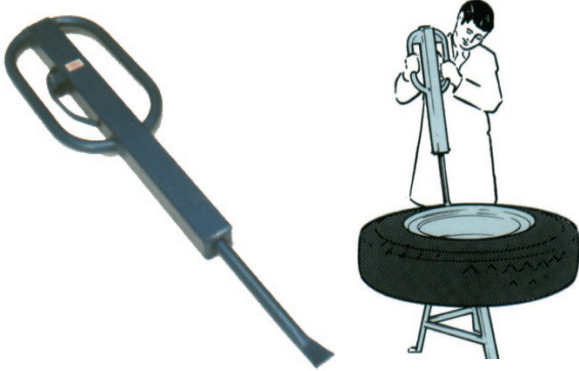

An extremely robust, sliding bar action bead breaker with double handles for easier use

It has a locking trigger mechanism to prevent movement of the bead breaker bar while being handled between jobs.

### Heavy-Duty Tyre Stand

CODE 50301

A robust tyre changing stand with 3 leg construction for use on both uneven and level ground



### Bead Driver



20" hammer bead driver with hand guard **CODE** 50323

10" hammer bead driver with hand guard **CODE** 50324

### Little-Buddy

CODE 70-160

A manual bead breaker for agricultural, implement, lawnmower and ATV tyres

Ratchet-screw action pushes away the toughest beads

Use as a back up for hydraulic tools, or as a stand-alone tool for low volume work

Recommended for use with manual wrenches only





## Manual Bead Breakers

### T26B Heavy-Duty Impact Bead Breaker

CODE 35926



**Ken-Tool**  
WHEREVER TIRES ARE CHANGED™

Length: 50" (127cm)  
Width: 80" (203cm)

Bead breaker loosens beads with bead breaking foot and ram bar, but never cuts the bead of the tyre. The wedge foot is forced between the bead and rim flange. Breaker is designed for shop or road use. No other bead breaking tools are necessary. Provides greater accuracy than other conventional bead breakers.

T26B has exclusive spring action design to reduce user fatigue associated with slide hammer kickback.

### TG11E Duck-Billed Bead Breaking Wedge

CODE 35429

Length: 32" (81cm)  
Width: 11lbs (5kg)

Fibreglass Handled.

**Ken-Tool**  
WHEREVER TIRES ARE CHANGED™



### T11K™ - Polymer-Handled Duck-Billed Bead Breaking Wedge

CODE 35460



**Ken-Tool**  
WHEREVER TIRES ARE CHANGED™

Length: 32" (81cm)  
Head Weight: 10.5lbs (4.8kg)

Hump Design prevents tool from wedging between rim and bead. Breaks the bead with little or no prying. New polymer handle design for longer lasting everyday use. Full length fibreglass core for greater strength. Coating on handle provides durability.

### T11KH - Replacement Handle (Polymer) - for Hammer T11K™

CODE 35230

Length: 32" (81cm)



## Hammers

Hammers are used for mounting and demounting tyres. They make tyre changing faster and easier for passenger car, truck, bus and agricultural tyres. Non-marring rubber end can be used for driving on lock rings.

### TG35 - Heavy-Duty Fibreglass-Handled Tyre Hammer

CODE 35423



Length: 18" (46cm)  
Head Weight: 4.8lbs (2.2kg)  
Weight: 6.6lbs (3kg)



### T36 - Heavy-Duty Wooden-Handled Tyre Hammer

CODE 35325

Length: 16 1/2" (42cm)  
Head Weight: 5.3lbs (2.4kg)  
Weight: 5.8lbs (2.6kg)



### T11CH - Replacement Handle for T36 Hammer

CODE 35119



Length: 17" (43cm)  
Weight: .75lbs (.3kg)



### Bead Wedge - "The Wedgie"

CODE 75005

A simple solution to a problem that many tyre fitters have in the field

Used to assist in breaking beads on earthmover, agricultural and construction tyres

Simple yet effective device

High impact nylon material

Avoids metal-on-metal contact

Allows for a bead breaker to fit between the tyre and the wheel



## Bead Holders & Protectors

### Aluminium Bead Holder for Steel & Aluminium Wheels

CODE

31713



Length: 5.5" (15cm)

Width: 8oz (.2kg)

Special C-Lok<sup>™</sup> shape fits most passenger, light truck, agricultural and truck wheels without slipping off. Aluminium design is lightweight but very strong and is less likely to mark alloy wheels. Great for super singles and super wide wheels. Fits both steel and aluminium wheels.

### Bead Holding Device

CODE

31710

Holds the bead in place against the wheel when mounting the tyre on to the wheel.  
Can be used for wheels from 17.5" and above.  
Do not use to pry.



### Aluminium Wheel Protector

CODE

31810



Length: 6" (15cm)

Width: 6oz (.2kg)

Protect expensive rims from damage during manual tyre changing. Durable leather protector fits on the rim and protects the inside of the rim well. Use with an assortment of tyre tools. When one end wears out, flip it over and use the opposite end.

Great for roadside service or in the shop.

## "Compact" EVA Safety Hump Bead Breaker

### EVA Compact Bead Breaker

CODE 50325

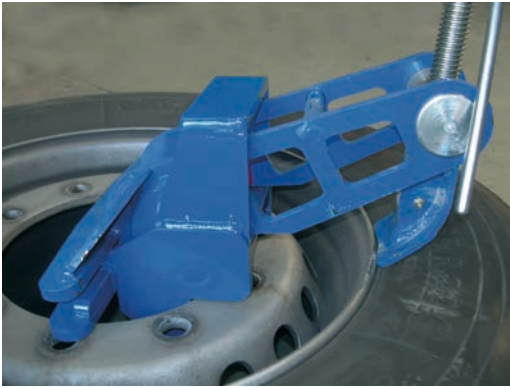

A mechanical bead breaker for hollow base truck wheels with safety hump.

For steel or alloy rims of type 17.5" / 19.5" / and 22.5."

Weight of bead breaker: 14kg (The photo shows the COMPACT in use with the optional adapter).

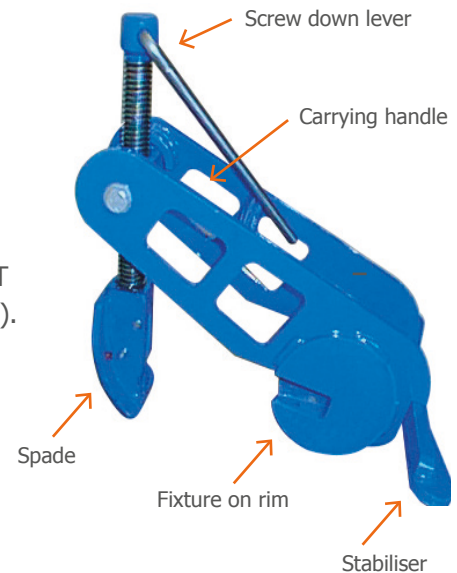

An optional adapter is available for zero inset rims

CODE 50325/AD

### "Bead-Vice" EVA Safety Hump Bead Breaker

CODE 50320

This tool is specially-designed for EVA/EVH truck wheels with a safety hump. In combination with Gaither's "Super Slick-'Em" bead lubricant, "Bead Vice" easily breaks the bead down and across the hump without damaging either bead or rim!

*Gaither*  
PROFESSIONAL EQUIPMENT

**To be used with a Manual Wrench only!**

**TIP:** Before attaching the "Bead Vice" to the stud holes of the EVA/EVH wheel (17.5" – 22.5") apply "Super Slick-'Em" between the rim and the bead of the tyre and before removing the valve core to deflate the tyre.



After removing the valve core and completely deflating the tyre, attach the "Bead Vice" and use a hand wrench (ratchet or T bar) with a 32mm socket to push the bead away from the rim.

### Bead Vice Support Adapter

CODE 50320/BVA3



Comes with  
"Super Slick 'Em"  
tyre lubricant and  
a "Super Slick 'Em"  
applicator bottle

Bead Vice support adapter for use with Super Single EVA wheels and on super singles and back beads.

Please note that a Bead Vice is not supplied with the BVA3 support adapter.



## Hydraulic Bead Breakers

### "Standard" Tractor Tyre Bead Breaker

CODE

52-001 COMBI



This is our "standard" tractor tyre bead breaker

A robust and reliable tool for professional tyre fitters

For use on tractor, truck and ATV tyres

Most popular tool for breaking beads on all agricultural wheels

Used on construction wheels up to 25"

Works on single, 2 and 3 piece wheels

Tool clamps hydraulically to the wheel and then breaks bead with 11 tons of force

3.75" (9.5cm) Stroke Length

Weight: 34lbs (15.5kg)



### "Large" Tractor Tyre Bead Breaker

CODE

52-002 COMBI

Larger version of the 52-001 combi bead breaker

Least expensive bead breaker for new 3 piece wheels

This is the tool operators are most familiar with

Most parts interchange with common bead breakers in the market

Larger clamp and feet allow tool to easily clamp onto wheels

Compact design allows the tool to be used on the front or back side of wheel

Weight: 38lbs (17kg)



## Hydraulic Bead Breakers

### MINI-LEM

CODE 50551-M



A lightweight tool for trucks (up to 24"), tractors and combine harvesters

The body is aluminium and, weighing only 8.70kg, this is lighter than any other similar make

The wider jaw opening makes this a versatile tool

Use with  
BVA-PA1500,  
BVA-PA3801 or AME  
15900 air hydraulic  
foot pump

Bead push stroke	70mm
Length of bead push cylinder	305mm (inc removable T handle)

### MICRO-LEM

CODE 50549

This is a smaller tool than Mini-Lem

Also with an aluminium body, the MICRO-LEM weighs only 5kg and is ideal for small tyres and back beads

Because of the small size, the bead push stroke is limited, but it is an excellent complementary tool to any of the above

Supplied with a 20mm magnetic spacer to increase the bead push

View a product  
demonstration on  
[our website](#)



Bead push stroke	26mm (46mm with spacer)
Length of bead push cylinder	85mm

### MAXI-LEM

CODE 50551



View a product  
demonstration on  
[our website](#)

As well as EM tyres, including new 3 piece rims up to 29", this versatile tool also handles plant, tractor, and truck tyres

It has an aluminium body and weighs only 13.5kg

Bead push stroke	80mm
Length of bead push cylinder	360mm (inc. removable T handle)

## Hydraulic Bead Breakers

### MANTIS HD P EVA Bead Breaker

CODE

MANTIS

The MANTIS HD P has been purposely designed for breaking the beads of truck tyres, particularly the EVA type double hump safety rims

This ingenious piece of equipment takes all the hard work out of removing tyres from these sometimes very difficult wheel assemblies



Weight	12kg
Dimensions	74 x 13.5 x 33cm
Stem Stroke	11.5cm
Bead Breaking Power	4900kg
Max Operating Pressure	700B bar

This tool requires an air-operated hydraulic pump for operation. To view our range of hydraulic pumps, please refer to Section 2.

### Mini Grover

CODE

GROVER

The Mini Grover Bead Breaker has been specifically designed to break the beads of inside tyres, especially of crane vehicles with Megatrak suspensions

Weight	8.7kg
Dimensions	45 x 11 x 32cm
Stem Stroke	7cm
Bead Breaking Power	2830kg
Clamping Power	from 2120kg to 4950kg
Max Dimensions of Tyres	25"
Max Operating Pressure	700B Bar



This tool requires an air-operated hydraulic pump for operation. To view our range of hydraulic pumps, please refer to Section 2.



## Earthmover Hydraulic Bead Breakers

SHUTTLE-8

CODE 50554



An EM (OTR) bead breaker for use on EM rims with pry bar or bead loosening pockets

8cm approx. bead push moves the toughest tyres from 25" up to 51"

With interchangeable "feet" and supplied complete with 2 double-ended "wedges" for holding open the gap while repositioning the tool (not shown)

Swivel connection for hydraulic hose avoids hose kinks

EM (OTR) Bead-Breaking Tool

CODE 11000



An EM (OTR) bead-breaking tool for use on 5-piece EM rims with pry bar or bead loosening pockets

108mm - (4 1/4") bead push moves the toughest tyres from 25" up to 51"



Dual Agricultural Bead Breaker

CODE 11060



Guaranteed to break any dual agricultural tyre beads, regardless of vehicle

Unique, compact design allows the tool to fit in the tightest spaces – only 3" (7.6cm) wide at narrowest point

Spreads to 26" (66cm) in width - enough to break any bead

Used to break the inside bead of the outside tyre on a dual assembly

Can also be used to break the inside bead of the inside tyre, when tool is placed against the frame of vehicle

10 ton cylinder has enough force to break all tractor beads



## Back Bead Rams

### EM Hydraulic Back Bead Rams

Used to break rear beads on 5-piece wheels

Removable plunger adapter allows the use  
of a variety of threaded attachments

A must have for OTR wheel and tyre service



Capacity	Stroke	Retracted Height	CODE	
10 ton	2 - 1/8" (5.4cm)	4 - 3/4" (12.1cm)	CODE	13010 10 Ton
10 ton	4" (10.5cm)	6 - 3/4" (17.14cm)	CODE	13020 10 Ton
10 ton	6 - 1/8" (15.57cm)	9 - 3/4" (24.77cm)	CODE	13030 10 Ton
10 ton	8" (20.32cm)	11 - 3/4" (29.84cm)	CODE	13040 10 Ton
10 ton	10 - 1/8" (25.73cm)	13 - 3/4" (35cm)	CODE	13050 10 Ton
30 ton	2 - 7/16" (6.19cm)	4 - 5/8" (11.75cm)	CODE	13060 30 Ton
25 ton	8 - 1/4" (21cm)	12 - 3/4" (32.39cm)	CODE	13090 25 Ton
25 ton	10 - 1/8" (25.73cm)	14 - 3/4" (37.4cm)	CODE	13095 25 Ton
25 ton	6 - 1/4" (15.75cm) 10	10 - 3/4" (27.3cm)	CODE	13100 25 Ton



## Hydraulic Pumps

### BVA Pump

CODE BVA-3801



This pump is tried and tested and known to be extremely reliable  
It has a wide base steel reservoir for excellent stability and durability  
3.8 litre oil capacity

Supplied complete with hydraulic hose and quick screw connection for use with all TEC hydraulic bead breakers

Supplied without hydraulic hose and coupler **CODE** BVA-PA3801LH

### Omega Pump

CODE 22903

This pump is tried and tested and known to be extremely reliable

It has a steel reservoir for excellent durability

1.5 litre oil capacity

Supplied complete with hydraulic hose and quick screw connection for use with all TEC hydraulic bead breakers

Supplied without hydraulic hose and coupler **CODE** BVA-PA1500LH



### AME Air-Hydraulic Foot Pump

CODE 15900



Builds 10,000 psi of pressure to fit the majority of tools on market

Operates on 80-120 psi of inlet air pressure  
(standard on most compressors and shop air)

Durable Metal Air Motor Assemblies

Designed specific to conditions normally associated with OTR sites

Oil Capacity: 2.5 Quarts (2.36 litres)

Reservoir Type: Polyethylene

Weight: 14lbs (6.4kg)

### Hydraulic Hand Pump

CODE P350

Suitable for use with BVA Ram Kit and back bead rams

Develops up to 10000 psi hydraulic pressure



## Bead Breakers

### Kema Air-Operated Bead Breaker

CODE

KEMA

This compact bead breaker is fully air-operated and easy to handle on both front and back beads of tractor and implement tyres. It just requires an air supply to get working.



The Kema Pneumatic Bead Breaker is a portable and practical tool and comes into its own when agricultural tyres have to be removed from the rim – either in the workshop or in the field.

Without even removing the rim  
With a Kema you don't have to remove the rim from the vehicle -  
if you have a flat tyre, all you need is a jack.

Compact, lightweight and portable  
The Kema only weighs 13kg (28.66lbs) and is very compact and easy-to-use.

Breaks both the inside and outside beads  
The Kema is designed to break both the inside and the outside beads  
of mainly agricultural tyres, without removing the rim.

  
View a product  
demonstration on  
our website



## Wheel Push Off Tools

BVA Mini-Press Wheel Push Off Tool

CODE

BVA1001-D

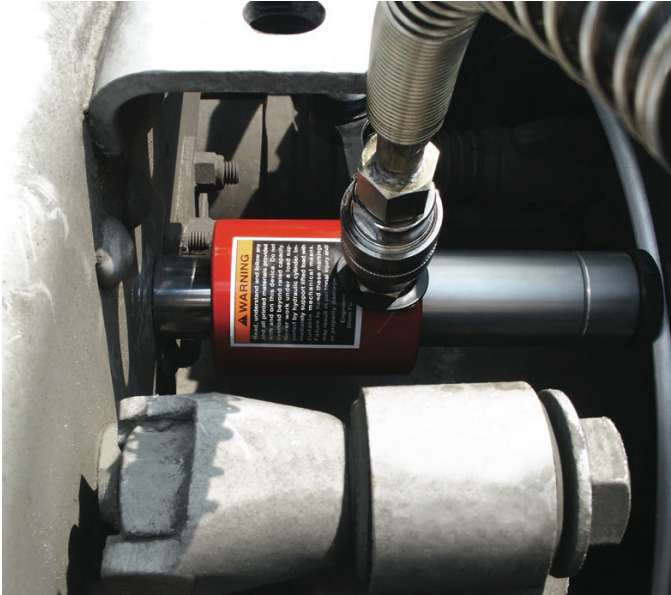

Use the BVA Mini-Press to press off stuck wheels  
BVA fits between the chassis and the wheel and develops up to 10 tons  
of hydraulic pressure to push off the most stubborn wheel

The BVA kit comprises of:  
1 x 10 tons ram (87mm long with 38mm stroke)  
1 x 10mm end cap  
3 x aluminium extensions (25mm, 50mm and 75mm long)

All in a handy storage case!



Use with any compatible manual or air operation hydraulic pump  
The BVA ram is fitted with a high flow coupler - the same as on our hydraulic bead breakers

## Wheel Separation Tools



Shark Fin™ Dual Wheel Separation Bag

CODE

34555



View a product  
demonstration on  
[our website](#)

Weight: 1.31lbs (.59kg)

The first wheel separation solution for steel, aluminium and chrome wheels!

No metal-on-metal contact!

5000lbs of static pressing force!

Works on 15" to 24.5" dual and single wheels and tyres on trucks and trailers

Kevlar inner inflation bag is industrial-grade and mostly puncture proof

Small but mighty - portable, durable and fast - full inflation only takes a matter of seconds

3 foot inflation hose makes access easy and safe

Deflation is controlled with a quick turn of the slotted valve cap

9.75" (24.7cm) x 8" (20cm) x 3/8" (1cm) height deflated - 5.5" (14cm) height when fully inflated

90 psi max pushing pressure - 150 psi maximum rated pressure

## Hydraulic Couplers & Hoses

### Replacement Hoses



Replacement hydraulic hose & coupler	CODE	52-472E
Replacement hydraulic hose without coupler	CODE	52-472E/LC

### Hose Couplers

Hydraulic hose coupler (male half) CH-38	CODE	52-482
Hydraulic ram coupler (female half) with 1/4" male thread	CODE	52-459/LEM
Hydraulic ram coupler (female half) with 3/8" male thread	CODE	52-459



### EM Tyre "O" Rings and Bead Seals

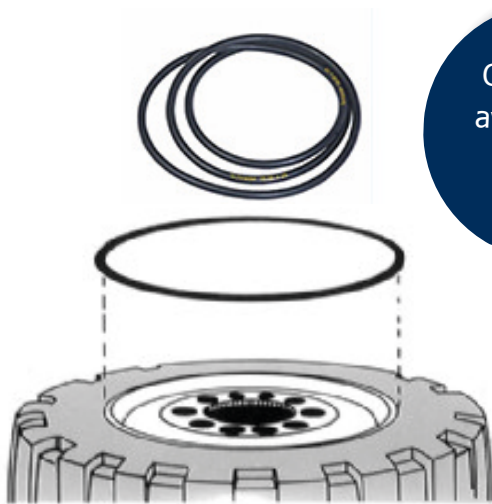

Other sizes  
available on  
request

#### "O" Rings for EM Tyres

25" Thin O Ring	CODE	15-446
25" Thick O Ring	CODE	15-448
29" O Ring	CODE	15-449
33" O Ring	CODE	15-450
35" O Ring	CODE	15-451
49" O Ring	CODE	15-452

#### "L" or "V" Seal for EM Tyres

25" Bead Seal	CODE	15-445
---------------	------	--------

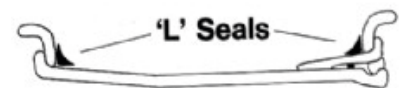

## Notes

# Notes



# Lifting Equipment

---

## Section Three:

Bottle Jacks .....	58-59
Air Service Jacks .....	60
Agricultural Service Jacks .....	61
Forklift Jacks.....	62
Lifting Jacks.....	63-64
Trolley Jacks .....	65-67
Axle Stands.....	68-69
Jack Stands .....	70-72
Transportation Tools .....	72-74
Wheel Lifting Equipment.....	75



## Omega Bottle Jacks

### Omega 2 - 8 ton Bottle Jacks

Code	OM11025	OM12021	OM11045	OM12041	OM11065	OM11085
Capacity	2 ton	2 ton	4 ton	4 ton	6 ton	8 ton
Closed height	184mm	170mm	208mm	173mm	221mm	231mm
Hydraulic lift	110mm	205mm	125mm	210mm	133mm	150mm
Screw extension	55mm	-	60mm	35mm	80mm	70mm
Maximum height	349mm	375mm	393mm	418mm	434mm	451mm
Weight	3kg	4kg	4kg	5.4kg	5kg	6.2kg

### Omega 12 ton Bottle Jacks



Code	OM11125	OM11129
Capacity	12 ton	12 ton
Closed height	240mm	152.5mm
Hydraulic lift	153mm	79mm
Screw extension	80mm	40mm
Maximum height	473mm	271.5mm
Weight	7.9kg	6.2kg

### Omega Standard and Low Entry 20 ton Jacks

Code	OM11205	OM11209
Capacity	20 ton	20 ton
Closed height	242mm	165mm
Hydraulic lift	153mm	80mm
Screw extension	80mm	40mm
Maximum height	475mm	285mm
Weight	12.5kg	9.4kg



### Omega Air-Hydraulic Bottle Jacks



Suitable for air or manual use, these air-hydraulic bottle jacks are ideal for on-site truck tyre service. They make vehicle lifting quicker and easier, whilst greatly reducing operator fatigue and speeding up the efficiency of any job.

Code	OM18202C	OM17302C
Capacity	20 ton	30 ton
Closed height	247mm	280mm
Hydraulic lift	130mm	180mm
Screw extension	100mm	-
Maximum height	477mm	458mm
Weight	16.5kg	27.5kg

## Winntec Bottle Jacks

### Winntec 2 - 20 ton Bottle Jacks

### Winntec 2 - 16 ton Bottle Jacks

Code	Y410200	Y410400	Y410600	Y410800	Y411200	Y411500
Capacity	2 ton	4 ton	6 ton	8 ton	12 ton	16 ton
Closed height	158mm	180mm	197mm	205mm	214mm	225mm
Hydraulic lift	90mm	110mm	125mm	125mm	125mm	140mm
Screw extension	60mm	60mm	60mm	60mm	60mm	60mm
Maximum height	308mm	350mm	382mm	390mm	399mm	425mm
Weight	2.3kg	3.3kg	4.4kg	5.4kg	7.2kg	8.3kg



### Winntec Standard and Low Entry 20 ton Bottle Jacks

Code	Y412000	Y412001
Capacity	20 ton	20 ton
Closed height	244mm	190mm
Hydraulic lift	145mm	90mm
Screw extension	60mm	60mm
Maximum height	449mm	340mm
Weight	10.5kg	9kg

### Winntec 20 ton Air-Hydraulic Bottle Jacks



Code	Y432020
Capacity	20 ton
Closed height	245mm
Hydraulic lift	145mm
Screw extension	80mm
Maximum height	470mm
Weight	16.5kg

### Winntec Low Entry Air-Hydraulic Bottle Jacks

Low profile jack with a 20 ton capacity. This unit includes a welded base to prolong service. Chrome main ram and aluminium air motor guarantee optimum lifetime. Air filter and air regulator connected to hose included.

Code	Y432021
Capacity	20 ton
Closed height	146mm
Hydraulic lift	67mm
Screw extension	49mm
Maximum height	262mm
Weight	9.4kg



## Gaither Air Service Jacks

### Gaither GT Models

All Gaither GT models are rigorously tested and constructed to withstand heavy daily use by the world's most demanding technicians in their commercial environments.

When you purchase a genuine GT product, you can be assured that you're getting the real thing. You can take comfort in the meticulous approach that Gaither takes to quality control and safety.

In fact, Gaither offer a unique 3-year warranty, guaranteeing that, for this period, their products won't show any hydraulic or pneumatic malfunctioning.

Designed for 30,000 minimum lift cycles

Built-in pressure regulator

Built-in water separator

Long, one-piece handle for durability, safety and easy manoeuvring

AVAILABLE IN TWO MODELS:

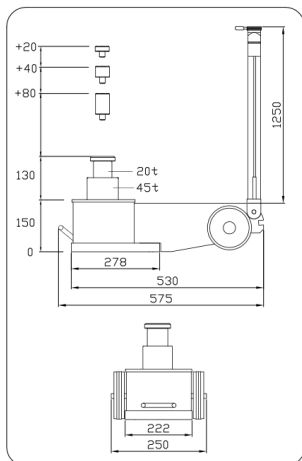

CODE GT4533

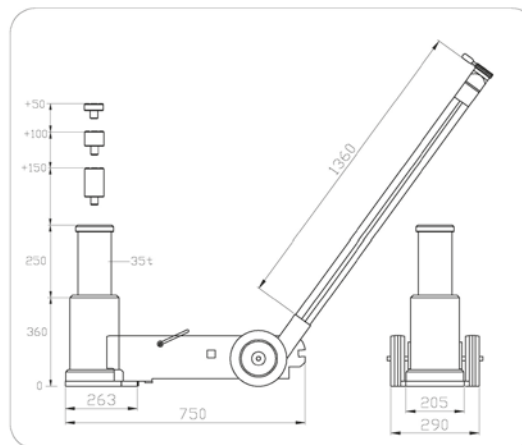
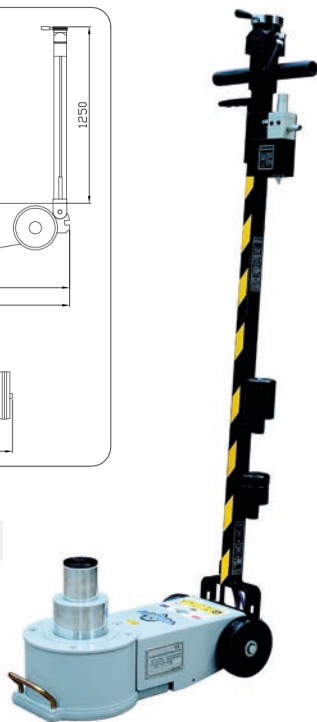

CODE GT3532

*Gaither*  
PROFESSIONAL EQUIPMENT

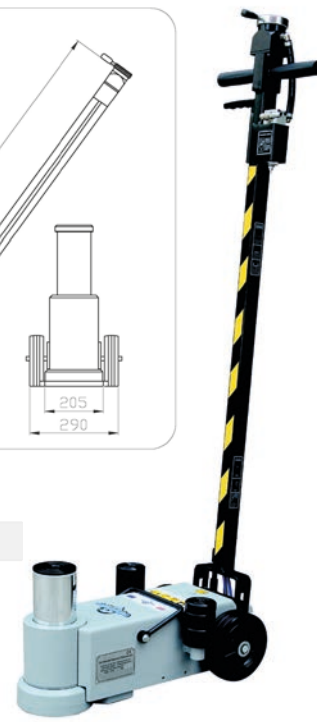

Capacity 1 <sup>st</sup> Stage	Capacity 2 <sup>nd</sup> Stage	Closed Height	Lifting Height	Total Height*	Extension 1	Extension 2	Extension 3	Weight	
45 Ton	20 tons	150mm	169mm	319mm	75mm	45mm	N/A	42kg	CODE GT4533
35 Ton	N/A	360mm	250mm	610mm	150mm	100mm	50mm	42kg	CODE GT3532

\* Without extensions

## Agricultural Service Jacks

### Gaither Air Hydraulic Jack

CODE GT3532AG

This model is designed for agricultural use and is part of the Gaither Air Service Jacks range.

Designed for 30,000 minimum lift cycles

Built-in pressure regulator

Built-in water separator

Long one-piece handle for durability, safety and easy manoeuvring

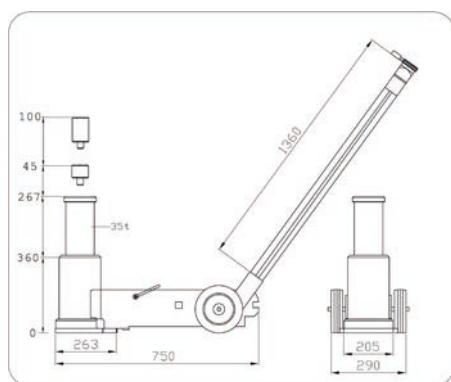

*Gaither*  
PROFESSIONAL EQUIPMENT



Capacity 1 <sup>st</sup> Stage	Closed Height	Lifting Height	Total Height*	Extension 1	Extension 2	Weight
35 ton	360mm	267mm	627mm	45mm	100mm	73kg

\* Without extensions

### Cattini Air Hydraulic Jack

CODE YAK 135

Ideal for heavy vehicles such as agricultural and public works vehicles

Fitted with roll-over protection plate

The two descent valves guarantee perfect holding in all situations and controlled speed under load

Capacity 1 <sup>st</sup> Stage	Closed Height	Lifting Height	Total Height*	Extension 1	Extension 2	Weight
30 ton	350mm	230mm	580mm	70mm	120mm	57kg

\* Without extensions



## Winntec Service & Forklift Jacks

### Winntec Air Service Jack

CODE Y432001

This jack is ideal for smaller workshops/transporters doing own service.

An aluminium air motor and integrated air filter ensures smooth pumping.

Air filter (connected to hose) is included.

Air return system eliminates over tightening of release valve.

One-piece handle for durability

Also comes with 3 saddles – 50mm, 50mm & 20mm – that can be placed on top of each other for added height

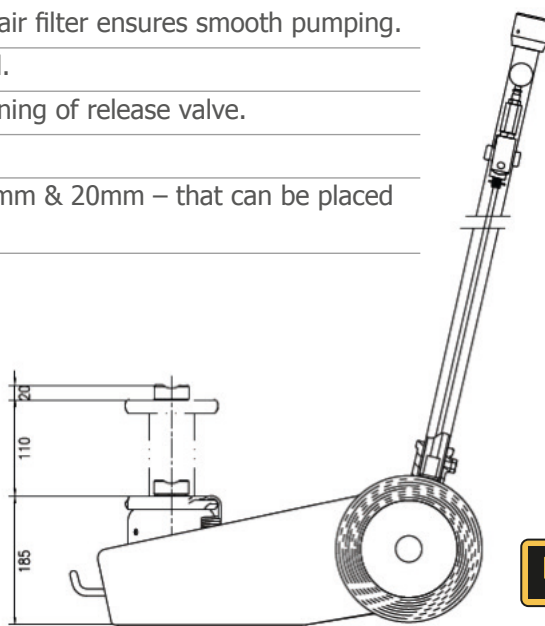

Capacity	Closed Height	Lifting Height	Total Height*	Extension	Weight	CODE
20 ton	185mm	108mm	303mm	80mm	47kg	Y432001

### Winntec Forklift Jack

CODE Y454000

Winntec forklift jack with dual lifting points, double speed function without load, chromed ram and chromed pump piston.

Lower, extended arm is only 65mm for easy access under forklift trucks.

The upright piston at 416mm is ideal for lifting tractors and farm machinery.

Hydraulic lift 355mm on forklift arm and 350mm on upright piston.

Weight: 45kg

	Capacity	Min Height	Hydraulic Lift	Max Height
Lift Point 1	4 ton	65mm	355mm	420mm
Lift Point 2	4.4 ton	416mm	350mm	766mm



## YAK Lifting Jacks

YAK Jacks are made by one of the leading jack manufacturers in Europe and comprise a comprehensive range of air-operated hydraulic jacks for all commercial vehicle applications. Fast and positive, air up and air down operation, with full control. These top quality jacks are reliable and rugged and come with full CE certification and a 12 months' warranty.

### Air-Hydraulic Jack Telescopic 2 Stage

CODE YAK 215/N



Capacity: 30 tons on the first stage and 15 tons on the second

Supplied complete with 1 extension saddle (10mm) and 2 extension blocks (120mm and 70mm) to increase the "closed" starting height

Long one-piece control handle with 3 handle positions for full manoeuvrability under the vehicle and for ease of positioning

A superb workshop jack

Closed Height	Max Height	Length	Jack Width	Handle Length	Weight
150mm	300mm	510mm	206mm	1315mm	39kg

If using 1 x 70mm extension block plus 10mm saddle, ADD 80mm to both closed height and max heights

If using 120mm extension plus saddle, ADD 130mm to both heights

If using BOTH extension blocks and the saddle, ADD 200mm to both heights



### Extra Low Air-Hydraulic Jack Telescopic 3 Stage

CODE YAK312

Capacity: 60 tons on the first stage; 30 tons on the second; and 18 tons on the third  
Supplied complete with 1 extension saddle and 2 extension blocks to increase the "closed" starting height

Long one-piece control handle with 3 handle positions for full manoeuvrability under the vehicle and for ease of positioning

Extra low 120mm starting height

Long handle for ease of positioning

The ideal jack for low floor buses or any low ground clearance heavy vehicle

Weight: 47kg

Closed Height	Max Height	Length	Jack Width	Handle Length	Weight
120mm	255mm	595mm	250mm	1315mm	50kg

If using 1 x 70mm extension block plus 10mm saddle, ADD 80mm to both closed height and max heights

If using 120mm extension plus saddle, ADD 130mm to both heights

If using BOTH extension blocks and the saddle, ADD 200mm to both heights



## YAK Lifting Jacks

### YAK 132 & 203 Pneumatic "Rubber-Ball" Jacks

Capacity: 2 tons

The ideal solution for lifting cars and small vans in confined road-side breakdown situations

Compact and lightweight (YAK 132 weighs only 14kg)

The YAK 132 & YAK 203 are a must for all tyre automotive service vehicles

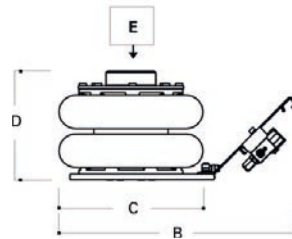

CODE YAK 132

	YAK 132
Portata Capacity	2.0 t 2.2 ton
Peso netto Net weight	14 kg 31 lb
Pressione di alimentazione Working air pressure	8-10 bar 116-145 psi
A	-
B	415 mm 16.34 in
C	250 mm 9.84 in
D	132-326 mm 5.2-12.83 in
E	2.0 t 2.2 ton

These jacks can also be used in confined space workshops and on vehicle lifts. Both jacks can be supplied as a trolley version with wheels and a long handle or with just a short handle (as shown)

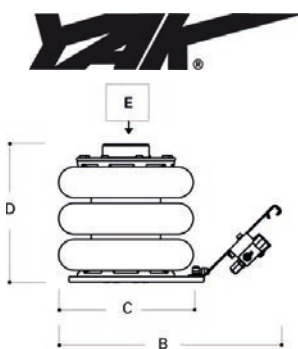

	YAK 203
Portata Capacity	2.0 t 2.2 ton
Peso netto Net weight	17 kg 37 lb
Pressione di alimentazione Working air pressure	8-10 bar 116-145 psi
A	-
B	415 mm 14.34 in
C	250 mm 9.84 in
D	205-490 mm 8.07-19.29 in
E	2.0 t 2.2 ton

CODE YAK 203





## Trolley Jacks

### Omega Pro-Lift 3 Ton Twin Piston Workshop Trolley Jack

CODE

T3006



Capacity	3 ton
Closed height	120mm
Maximum height	465mm
Weight	32kg



Specification as follows:

Comes with 24 month warranty

PU wheels to reduce noise and floor damage

Durable rubber saddle cover

Handle foam to protect vehicle

Industrial ram and pistons

### Winntec Heavy-Duty 3 Ton Trolley Jack

CODE

Y420330



Y420330

Capacity	3 ton
Closed height	120mm
Maximum height	450mm
Weight	32kg

Specification as follows:

Specially manufactured and configured for car dealers and workshops

Incorporates noise-reducing PU wheels, a rubber saddle grip and the turbo lifter pump system

A special release valve allows the convenience of controlled lowering of heavy loads

Both the ram and pistons are chrome-plated for a professional finish

3 year warranty on hydraulic power unit



## Omega & Weber Trolley Jacks

### Omega 3 Ton Trolley Jack

CODE

OM21030



Top-quality durable jacks from a leading manufacturer

3 tons lift capacity

Chassis length: 637mm long

Closed height: 140mm

Maximum lift height: 483mm

Foot pedal "fast-lift" up to load

OM29024

OM2903101

Capacity

2.25 ton

3 ton

Closed height

127mm

120mm

Maximum height

495mm

460mm

Jack Length

610mm

613mm

Weight

28.5kg

32.3kg



Shinn Fu Europe BV is introducing the first new Service Jack with a new design of an external and completely welded oil reservoir. Due to the welded oil reservoir, the changes for leakage will be reduced tremendously. Includes " MagicLift" fast pump action load.

### Weber Trolley Jack

CODE

WDK20



Weber  
UK

Wide and robust frame made of high-strength steel

Manual dead man's release for optimum safety when lowering

Built-in Safety Overload valve

All wheels incorporate a polyurethane central ring offering maximum surface protection and low noise

Ergonomically-designed handle ensuring positive and safe operation

2 tons lift capacity

Chassis length: 660mm

Closed height: 80mm

Maximum lift height: 495mm

Weight: 32kg

## Compac Trolley Jacks

### Compac Trolley Jacks



Dependable high quality from one of Europe's leading jack manufacturers

**2 ton capacity - Low profile:**

Low closed height of only 80mm

CODE CTC2T-C

Maximum lift height: 500mm

Specification as follows:

2 ton lift capacity, with "quick-lift" foot pedal

Short chassis: 730mm long

"Lift & twist" release mechanism prevents accidental lowering

# COMPAC

**C 3 ton capacity**

Low closed height of only 115mm

CODE CTC3T-C

Maximum lift height: 500mm

Specification as follows:

Chassis Length – 1015mm long

"Lift & twist" release mechanism prevents accidental lowering

3 ton lift capacity, with "quick-lift" foot pedal

Model	Max (Ton)	A (mm)	B (mm)	C (mm)	D (mm)	E (mm)	F (mm)	Kg
3T-C	3	115	500	1015	170	380	925	42

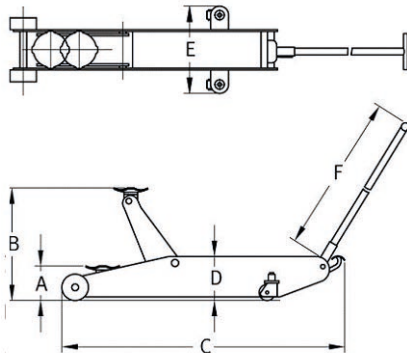

### Compac Long Reach Trolley Jack

CODE CPC2T-77

The same high spec as all Compac jacks

Lift capacity: 2 ton

Closed height: 77mm

Maximum lift height: 480mm

Weight: 41kg

Chassis length: 950mm

# COMPAC



Model	Max (Ton)	A (mm)	B (mm)	C (mm)	D (mm)	E (mm)	F (mm)	Kg
2T-77	2	77	480	950	126	380	925	41

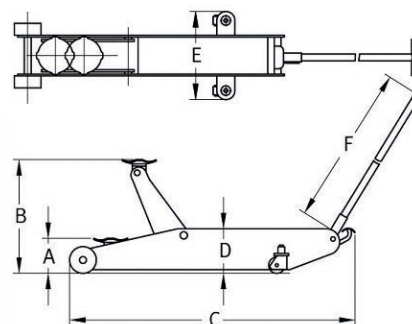

## Axle Stands

### Melco Axle Stands



Melco Products Limited was originally founded in 1921 by Thomas Meldrum in Sheffield, England and became known worldwide for the "Melco" range of tyre bay tools and garage equipment. Melco Products Limited continues to provide that same quality and service that has established this enviable reputation, now with an extended range of new and improved products.

Capacity Per Pair	Closed Height	Extended Height	Crutch Width	CODE
4 ton	300mm	500mm	84mm	AS10
8 ton	500mm	750mm	88mm	AS30
12 ton	300mm	500mm	144mm	AS40S
12 ton	540mm	1000mm	144mm	AS40
16 ton	540mm	1000mm	144mm	AS40HD
24 ton	300mm	500mm	144mm	AS45
32 ton	300mm	500mm	144mm	AS45HD

**Sold and to be used only in pairs!**

## Axle Stands

### Omega Ratchet Jack Stands



Counter-weighted pawl serves as a safe, secure locking device to prevent the load from accidentally disengaging

Sturdy, welded steel construction

One-piece, multi-position ductile ratchet bar provides super strength and durability, and quick adjustment mechanism that securely locks into desired location

Capacity Per Pair	Closed Height	Extended Height	Net Weight Pair		
3 ton	292mm	432mm	6kg	CODE	3203701
6 ton	390mm	618mm	14kg	CODE	3206701
12 ton	445mm	700mm	24kg	CODE	3212701

**Sold and to be used only in pairs!**

## Jack Stands

### Omega Self-Raising Jack Stands



Omega Magic Lift Axle Stands lift automatically when handle is lifted.

Key features are:

Counter-weighted pawl locks ratchet bar securely in place

Sturdy, welded steel construction

One-piece, multi-position ductile iron ratchet bar

Patented technology automatically raises ratchet arm to load

Capacity Per Pair	Closed Height	Extended Height	Net Weight Pair		
6 ton	395mm	620mm	14.5kg	CODE	32066
12 ton	510mm	780mm	34kg	CODE	32126

**Sold and to be used only in pairs!**

## Jack Stands

### Winntec HD Jack Stands



Winntec HD-Series Jack stands are available with a steel tubing column that is adjustable and secured using a chained lock pin or available as a ratchet type

Capacity Per Pair	Closed Height	Extended Height	Net Weight Pair	CODE
3 ton Pin Type	322mm	465mm	5.2kg	Y452300
6 ton Pin Type	404mm	604mm	11.2kg	Y452600
3 ton Ratchet Type	305mm	450mm	7kg	Y450301
6 ton Ratchet Type	395mm	625mm	13.8kg	Y451600

**Sold and to be used only in pairs!**

## Jack Stands

### Omega Heavy-Duty Jack Stands

CODE 32225



Split handle for easy mobility and storage

Sturdy, welded steel construction for superior safety and strength

Heavy gauge, steel frame helps prevent distortion or twisting



Capacity Per Pair	Closed Height	Extended Height	Net Weight Pair
22 ton	310mm	505mm	27.8kg

**Sold and to be used only in pairs!**

### Truck Tyre Dolly

CODE Y471106

The Winntec SAFERGO truck tyre dolly is the easiest way to mount and dismount truck tyres.

This convenient dolly makes manually lifting wheel sets completely unnecessary.

Simply slide the rollers underneath the tyre and use the jack handle to raise it to the desired height. You can then use the included Gaither O-LINE-ER® to perfectly position the wheel for easy installation. The SAFERGO also comes equipped with a collapsible handle frame making it easy to store and ideal for mobile service.

This lightweight, portable dolly has a compact hydraulic unit that ensures precise positioning.

Allowing the operator to work on a very short distance from the vehicle which is crucial during road assistance service work.

Shock absorbing casters ensure a smooth ride from and to the hub on a rough surface.

Fast Positioning

Carry Handle

Winntec delivers you once again affordable ergonomics without affecting operation speed





## Truck Wheel Transportation

### Wheel Dolly

CODE

Y471105HD



- Easy installation and removal of truck tyre/wheel assemblies
- One person control
- Heavy-duty industrial bearings
- 3 positions for rollers depending on tyre size
- Great tool for every service truck
- Avoid damage to wheel bolts and expensive modern rims
- For all wheels from 6.5" – 24.5", including super singles
- New longer rollers make it even easier to handle super single tyres
- Net Weight: 15kg
- Capacity: 220kg

#### HOW THE WHEEL DOLLY WORKS:

To remove from vehicle:

1. After the vehicle is positioned on jack stands and the lug nuts are removed, slide the Tyre Dolly under the tyre so that the rollers come into contact
2. Apply downward force on the handle to raise the tyre/wheel assembly, and pull away from the vehicle

To place onto vehicle:

1. Place Gaither O Liner(s) on stud(s)
2. Lift tyre/wheel assembly with Tyre Dolly and roll toward vehicle
3. Raise tyre/wheel assembly and line up stud holes with Gaither O Liner(s)
4. Remove Tyre Dolly and slide tyre/wheel assembly onto hub

### Gaither O Liner

CODE

GTO01TB

The Gaither O Liner tool is designed to make it easy to line up wheel studs with the holes in the rim for easy installation, resulting in decreased installation time, which can increase worker productivity and reduce risk of injury from struggling with heavy tyres and rims.



## Tyre Transportation

Smart Cart

CODE

Y471147HD



Weighs just 20kg and handles wheels from 14" – 20", up to 200kg



Finally, there's a product that really does the job!

This long-life, lightweight, high-capacity cart allows the tyre fitter to manoeuvre heavy wheel sets in the most ergonomic way, with the help of its tilting system. The unique push-slide-secure automatic locking system eliminates the need for inefficient, wear sensitive, foot-operated or hand-controlled jaws.

The light yellow-coloured, foam-filled tyres are maintenance-free and leave no traces on the workshop floor. The wheels run on industrial bearings. The cart comes in powder-coated steel with high strength components.

### HOW THE SMART CART WORKS:

1. Simply push the Smart Cart toward the stack of tyres and watch as the spring action arms grasp the tyres, without the need for cumbersome pedals, levers or gas springs.
2. Tip the Smart Cart toward you – note the tilting action. This allows for less stress on the technician.
3. Use the Push/Pull handle to remove the cart from the tyre stack.

Smart Cart (XL)

CODE

Y471147HDXL

We also supply the XL version of this product, which handles wheels from 16" size through to 24" size.

## Wheel Lifting Equipment

Wheel Assist

CODE

Y472260



ERGO+  
Version

The Winntec Wheel Assist brings speed and precision to wheel removal and fitting through its innovative, intuitive and highly portable design.

Operating as a standalone piece of workshop equipment, that doesn't require charging or linking up to a power source, the Winntec Wheel Assist has powerful gas springs that will enable workshop technicians to quickly and easily remove and/or replace wheels.

Developed in partnership with tyre specialists, this unique product intuitively supports the technician, enabling them to precisely position the height of the wheel, whilst guarding against injury during the numerous lifts required in the wheel fitting process. Its durable, yet lightweight, construction means it's easy to move around the workshop too!

The Winntec Wheel Assist allows a technician to remove and replace heavy tyre/wheel assemblies from and onto a vehicle without physical strain.

**Move tyres from vehicle to changer to balancer and back without any lifting!**

This ergonomically-correct product maintains safety in any tyre shop and reduces expensive worker injury claims by handling all passenger sizes.

Including run-flats with ease, the Wheel Assist travels from floor to post-lift height, and is free of hydraulics, pneumatics, and electric components, making it virtually maintenance-free.

Wheel Assist - ERGO+

CODE

Y472270

ERGO+ version features lockable castor wheels and detachable loading ramp.

Max capacity of wheel and tyre: 60kg, Length of wheel holder rollers: 337mm, 13 - 23" wheel capacity

## Notes

# Air/Power Tools & Accessories



We supply a range of tools from Chicago Pneumatic, Aircat and Universal Air Tools to suit your requirements.



## Section Four:

1/2" Impact Wrenches .....	78-79, 84, 87-88
3/4" Impact Wrenches .....	80-81, 84, 89
1" Air Impact Wrenches .....	82-84, 90
1/2" Drive Impact Socket Sets .....	91
3/4" Drive Impact Socket Sets .....	91
1" Drive Impact Socket Sets .....	92
Pneumatic Tools .....	85-86, 93-94
Air Tool Oils .....	94
Hose Reels & Filter Regulators .....	95-96
Air Line Hoses & Assemblies .....	97
Air Line Fittings .....	98

## 1/2" Chicago Pneumatic Impact Wrenches

1/2" Drive Impact Wrench Durable, Powerful and Ergonomic

CODE

CP7748



This is one of the most powerful tools on the market in its class. It is suitable for all maintenance applications, as well as car and van tyre changing.

Max Torque (Reverse): 1250Nm, Three Forward Torque Positions: Low - 245Nm, Med - 650Nm, High - 990Nm

Working Torque Range (fwd): 102-786Nm

Clutch Type: Twin Hammer

Free Speed: 8200rpm

Net Weight: 2kg

Vibration: 10.1m/s<sup>2</sup>

Sound Power: 104 dB(A) / Sound Pressure: 93 dB(A)

1/2" Drive Impact Wrench Torque Limited in Forward, Extreme Torque in Reverse

CODE

CP7748TL

The CP7748TL series is intended to be used as a "snugging" tool, prior to final tightening with a calibrated torque wrench to reach the car manufacturer's specified torque rating for wheel assembly. This product has a low sound level and is suitable for all car and van tyre changing applications.

Max. Torque (Reverse): 1250Nm

Working Torque Range (Forward): 90-100Nm

Clutch Type: Twin Hammer

Free Speed: 8200rpm

Net Weight: 2.2kg

Vibration: 4.8m/s<sup>2</sup>

Sound Power: 97 dB(A) / Sound Pressure: 86 dB(A)



1/2" Drive Impact Wrench Powerful and Lightweight

CODE

CP7749



Maximise operator comfort with an extremely well-balanced tool, which features the most convenient and unique reverse technology in the market.

Max. Torque (Reverse): 1300Nm

Working Torque Range (Forward): 135-704Nm

Clutch Type: Twin Hammer

Free Speed: 7000rpm

Net Weight: 1.8kg

Vibration: 2.7m/s<sup>2</sup>

Sound Power: 106 dB(A) / Sound Pressure: 95 dB(A)

## 1/2" Chicago Pneumatic Impact Wrenches

1/2" Drive Impact Wrench Ultra Compact and Powerful

CODE CP7732



This product features a powerful power-to-weight ratio (610Nm), is ultra compact, easy-to-use and durable.

Max. Torque (Reverse): 610Nm

Working Torque Range (Forward): 138-420Nm

Clutch Type: Single Dog Clutch

Free Speed: 9000rpm

Net Weight: 1.3kg

Vibration: 12.1m/s<sup>2</sup>

Sound Power: 106 dB(A)

Sound Pressure: 95 dB(A)

1/2" Drive Impact Wrench Ultra Lightweight, Easy To Operate and Compact

CODE CP7732C

This tool is lightweight at just 1kg with composite housing which features a new power system that has two positions in forward and reverse, a steel motor and aluminium clutch housing. This wrench measures only 108mm long, enhancing the ease of operation.

Max. Torque (Reverse): 625Nm

Working Torque Range (Forward): 70-387Nm

Clutch Type: Jumbo

Free Speed: 9,410rpm

Net Weight: 1kg

Vibration: 10.8m/s<sup>2</sup>

Sound Power: 106.5m/s<sup>2</sup>

Sound Pressure: 95.5m/s<sup>2</sup>



1/2" Drive Cordless Impact Wrench Powerful and Efficient

CODE CP8849



As this wrench is cordless, it can be used wherever needed. It features rubber battery dampeners which absorb impacts and shocks, as well as aluminium back and clutch housing.

Max. Torque (Reverse): 1050Nm

Working Torque Range (Forward): 68-950Nm

Weight: 3.1kg

Free Speed: 1900 rpm

Vibration Level: 12.2m/s<sup>2</sup>

Sound Power: 100 dB(a)

Sound Pressure: 89 dB(a)

Charge Time (for 4/6 Ah batteries): 100%: 90 mins, 80%: 60 mins

Battery Capacity: 6Ah 20V Lithium-ion

Length: 243mm

Height: 251mm

Kit includes 1 x 1/2" Impact Wrench, 2 x Batteries and 1 x Charger (supplied in a case).

## Section Four

Air/Power Tools  
& Accessories

# 3/4" Chicago Pneumatic Impact Wrenches

3/4" Drive Impact Wrench Powerful and Versatile

CODE

CP7630



 **Chicago  
Pneumatic**

The well-balanced, ergonomic design of this wrench helps to minimise wrist strain. This product is suitable for all maintenance and wheel changing applications.

Max. Torque (Reverse):	1500Nm
Working Torque Range (Forward):	177-1097Nm
Weight:	4.8kg
Free Speed:	6900rpm
Vibration Level:	9.8m/s <sup>2</sup>
Sound Power:	116.3dB(a)
Sound Pressure:	105.3dB(a)
Length:	240mm
Actual Air Consumption:	9.7l/s
Avg. Air Consumption:	2.4l/s
Air Inlet Thread:	3/8"
Clutch Type:	Twin Hammer
Min. Hose Size:	13mm

3/4" Drive Impact Wrench (Stubby) Ultra Compact, Lightweight and Powerful

CODE

CP7762

The First Real 3/4" Stubby Impact Wrench!

Ultra compact at less than 16cm in length, lightweight at just 3kg for less operator fatigue and powerful with a maximum torque of 1420Nm

Max. Torque (Reverse):	1420Nm
Working Torque Range (Forward):	200-900Nm
Weight:	2.9kg
Free Speed:	4850rpm
Vibration Level:	10.7m/s <sup>2</sup>
Sound Power:	103.8dB(a)
Sound Pressure:	92.8dB(a)
Length:	158mm
Height:	200mm
Width:	84mm
Actual Air Consumption:	16.4l/s
Air Inlet Thread:	3/8"
Clutch Type:	Twin Hammer



 **Chicago  
Pneumatic**



## 3/4" Chicago Pneumatic Impact Wrenches

3/4" Drive Impact Wrench Compact and Powerful

CODE CP7763



 **Chicago Pneumatic**

This product is ideal for general maintenance and wheel changing applications with a powerful motor and a durable clutch.

Max. Torque (Reverse):	1630Nm
Working Torque Range (Forward):	136-1288Nm
Weight:	5.25kg
Free Speed:	6300rpm
Vibration Level:	10.4m/s <sup>2</sup>
Sound Power:	107dB(a)
Sound Pressure:	96dB(a)
Length:	229mm
Actual Air Consumption:	14.2l/s
Avg. Air Consumption:	3.5l/s
Air Inlet Thread:	3/8"
Clutch Type:	Twin Hammer
Min. Hose Size:	13mm

3/4" Drive Impact Wrench Powerful, Lightweight and Compact

CODE CP7769

This is a powerful impact wrench which is good for general maintenance and wheel changing applications. It also maximises operator comfort with a lightweight and balanced design.

Max. Torque (Reverse):	1950Nm
Working Torque Range (Forward):	407-1464Nm
Weight:	3.4kg
Free Speed:	7000rpm
Vibration Level:	12.6m/s <sup>2</sup>
Sound Power:	108dB(a)
Sound Pressure:	97dB(a)
Length:	214mm
Actual Air Consumption:	14.7l/s
Air Inlet Thread:	3/8"
Clutch Type:	Twin Hammer
Power To Weight Ratio:	573.75Nm/kg



 **Chicago Pneumatic**

## Section Four

Air/Power Tools  
& Accessories

# 1" Chicago Pneumatic Impact Wrenches

1" Drive Impact Wrench High Torque and Comfort

CODE

CP7782-6



This is a durable impact wrench with great power for the toughest wheel changing jobs on heavy vehicles.

Max. Torque (Reverse):	2600Nm
Working Torque Range (Forward):	500-2000Nm
Weight:	11.6kg
Free Speed:	5200rpm
Vibration Level:	7.8m/s <sup>2</sup>
Sound Power:	111dB(a)
Sound Pressure:	100dB(a)
Length:	520mm
Actual Air Consumption:	19.2l/s
Avg. Air Consumption:	4.8l/s
Air Inlet Thread:	1/2"
Clutch Type:	Pinless Closed Rocking Dog
Min. Hose Size:	13mm

1" Drive Impact Wrench High Torque and Comfort

CODE

CP7782

This product is the same model as above except for this has a 2" anvil instead of a 6" anvil.

It offers great power for general maintenance applications with a reinforced clutch mechanism.

Max. Torque (Reverse):	2600Nm
Working Torque Range (Forward):	500-2000Nm
Weight:	11.6kg
Free Speed:	5200rpm
Vibration Level:	7.8m/s <sup>2</sup>
Sound Power:	111dB(a)
Sound Pressure:	100dB(a)
Length:	520mm
Actual Air Consumption:	19.2l/s
Avg. Air Consumption:	4.8l/s
Air Inlet Thread:	1/2"
Clutch Type:	Pinless Closed Rocking Dog
Min. Hose Size:	13mm



## 1" Chicago Pneumatic Impact Wrenches

1" Drive Impact Wrench Ultra Compact, Lightweight and Powerful

CODE CP7783-6



This is a heavy-duty product despite its lightweight of 9.5kg. Durable and user-friendly. This is suitable for all wheel changing applications.

Max. Torque (Reverse):	2400Nm
Working Torque Range (Forward):	560-1700Nm
Weight:	9.5kg
Free Speed:	6200rpm
Vibration Level:	15.1m/s <sup>2</sup>
Sound Power:	113dB(a)
Sound Pressure:	102dB(a)
Length:	500mm
Actual Air Consumption:	19l/s
Avg. Air Consumption:	4.75l/s
Air Inlet Thread:	3/8"
Clutch Type:	Pinless Closed Rocking Dog
Min. Hose Size:	19mm

1" Drive Pistol Impact Wrench Compact and Powerful

CODE CP7773

With a powerful motor and a durable clutch, this wrench is ideal for general maintenance applications and provides operator comfort due to its reduced noise level.

Max. Torque (Reverse):	1630Nm
Working Torque Range (Forward):	136-1288Nm
Weight:	5.5kg
Free Speed:	6300rpm
Vibration Level:	10.4m/s <sup>2</sup>
Sound Power:	107dB(a)
Sound Pressure:	96dB(a)
Length:	234mm
Actual Air Consumption:	14.2l/s
Air Inlet Thread:	3/8"
Clutch Type:	Twin Hammer
Power To Weight Ratio:	296.4Nm/kg
Min. Hose Size:	13mm



## Section Four

Air/Power Tools  
& Accessories

# Chicago Pneumatic Classic Range

There comes a time when the best-known products go beyond the standard they set to become must-have Classics. For decades, these classic Chicago Pneumatic products have been getting the job done and feature the authentic styling that customers have come to love.

### 1/2" Drive Impact Wrench The "Classic" Reference for 1/2" Impact Tools

CODE

CP734H



This durable 1/2" impact wrench is perfect for general maintenance and wheel changing applications.

Max. Torque (Reverse): 576Nm

Working Torque Range (fwd): 34-420Nm

Clutch Type: Pin Clutch

Free Speed: 8400rpm

Net Weight: 2.32kg

Vibration: 7.2m/s<sup>2</sup>

Sound Power: 104 dB(A) / Sound Pressure: 93 dB(A)

### 3/4" Drive Impact Wrench Durable and Versatile

CODE

CP772H

This wrench, with 4-power settings, is great for general maintenance and tyre changing applications and it offers a smooth operation due to the DYNA-PACT clutch. It is comfortable to use, thanks to low noise and vibration levels.

Max. Torque (Reverse): 1356Nm

Working Torque Range (Forward): 203-949Nm

Clutch Type: Pin Clutch Oil Bath

Free Speed: 4200rpm

Net Weight: 4.76kg

Vibration: 5.8m/s<sup>2</sup>

Sound Power: 107 dB(A) / Sound Pressure: 96 dB(A)



### 1" Drive Impact Wrench - 6" Anvil Efficiency and Power

CODE

CP7778-6



This wrench has a high efficiency motor yet remains economical. It is ideal for tyre work, general repair and maintenance.

Max. Torque (Reverse): 2200Nm

Working Torque Range (fwd): 400-1800rpm

Clutch Type: Pinless Rocking Dog

Free Speed: 5000rpm

Net Weight: 11.5kg

Vibration: 10.1m/s<sup>2</sup>

Sound Power: 117 dB(A) / Sound Pressure: 106 dB(A)

## Chicago Pneumatic - Pneumatic Tools

### Die Grinder Efficient and Economic

CODE

CP872



Suitable for general maintenance and tyre buffing applications, this tool features a rugged aluminium alloy body with a built-in air regulator. Also includes 1/4" and 6mm collets.

Free Speed: 22000rpm  
Sound Pressure: 100.9dB(A)  
Vibration: <math><2.5\text{m/s}^2</math>  
Length: 165mm  
Weight: 0.57kg

### Tyre Buffer Low Speed

CODE

CP873

The most popular tyre buffer in the market, this has an adjustable speed control and a quick change slip chuck for fast and easy changing of buffing wheels.

Free Speed: 2800rpm  
Sound Pressure: 99dB(A)  
Vibration: <math><2.5\text{m/s}^2</math>  
Length: 210mm  
Weight: 1.02kg



### Tyre Buffer With Exhaust Hose Low Speed

CODE

CP873K



The most popular tyre buffer in the market, this has an adjustable speed control and a quick change slip chuck for fast and easy changing of buffing wheels.

Free Speed: 2800rpm  
Sound Pressure: 99dB(A)  
Vibration: <math><2.5\text{m/s}^2</math>  
Length: 210mm  
Weight: 1.02kg

### Mini Die Grinder Compact and Lightweight

CODE

CP876

Suitable for general maintenance and tyre buffing applications. This compact and lightweight tool is designed for easy maneuverability and is ideal for limited space applications. Also includes 1/4" and 6mm collets.

Free Speed: 30000rpm  
Sound Pressure: 101.3dB(A)  
Vibration: <math><2.5\text{m/s}^2</math>  
Length: 121mm  
Weight: 0.34kg



## Chicago Pneumatic - Pneumatic Tools

### 3/8" Air Drill Reversible and Complete With Keyless Chuck

CODE CP9792



Suitable for general maintenance and tyre work, this drill has an ergonomic handle for maximum operator comfort.

Free Speed: 2000rpm  
Sound Pressure: 90dB(A)  
Vibration: <math><2.5\text{m/s}^2</math>  
Length: 216mm  
Weight: 1.18kg

### 1/2" Air Drill Reversible and Complete With Keyless Chuck

CODE CP9791

This drill is ideal for general maintenance. It is powerful and resistant to stalls, whilst being great for various low speed drilling applications.

Free Speed: 800rpm  
Sound Pressure: 90dB(A)  
Vibration: <math><2.5\text{m/s}^2</math>  
Length: 237mm  
Weight: 1.42kg



### 3/8" Stubby Ratchet Small and Durable

CODE CP825T



This ratchet is ideal for general maintenance, particularly for use in tight access applications. It is compact and lightweight with a progressive tease throttle.

Free Speed: 200rpm  
Sound Pressure: 98dB(A)  
Vibration:  $3\text{m/s}^2$   
Length: 165mm  
Weight: 0.9kg  
Max Torque: 21Nm  
Working Torque: 7-21Nm

### 1/2" Ratchet Compact With High Torque

CODE CP886H

This tool features an easy grip reverse for simple directional changes and has a compact head design with hardened gears.

Free Speed: 160rpm  
Sound Pressure: 99dB(A)  
Vibration:  $3.7\text{m/s}^2$   
Length: 260mm  
Weight: 1.19kg  
Max Torque: 68Nm  
Working Torque: 13-68Nm



## 1/2" AIRCAT Impact Wrenches

Top-quality impact wrenches featuring massive torque - suitable for most high torque applications. The AIRCAT line represents the most significant advances of performance of pneumatic power tools in nearly 30 years. Founded in 1998, the AIRCAT range has a substantially-reduced level of noise, while retaining more power and torque. AIRCAT incorporates a patented, ergonomically-engineered handle design to relieve stress and fatigue on the operator's hand, wrist and arms.

### AIRCAT 1150 1/2" Massive Torque Impact Wrench

CODE AC1150



The sheer power and performance of 1756 NM or 1,295 foot-pounds (ft-lb) of loosening torque and 1,400 blows per minute makes this one of the strongest, hard-hitting Twin Hammer 1/2 impact wrenches on the market.

1,756 NM of torque or 1,295 Ft-lbs of loosening torque  
Hard-hitting twin hammer mechanism

Lightweight, all-black composite body, with a patented ergonomic AIRCAT handle

Durable composite housing

Quiet-tuned exhaust (86 decibels)

Easy flip operation - flip lever forward & reverse

### NITROCAT®1250-K Twin Clutch 1/2" Massive Torque Impact Wrench

CODE AC1250-K

Inside the 1250 NITROCAT®-K lies some serious power and groundbreaking technology. This tool will blow the user away with an amazing 1,000 blows per minute, all the speed of a 1/2" with 3/4" power. The rapid impacts will get the job done with speed and power. The 1250-K is engineered with the "Xtreme" hard-hitting Twin Clutch mechanism built for high torque performance.

1,763 NM of torque or 1,300 Ft-lbs of loosening torque

Hard-hitting smooth twin clutch mechanism

Durable Kevlar reinforced "body armour" housing

Ergonomically-designed handle

Quiet-tuned exhaust (92 decibels)

Easy flip operation flip lever forward & reverse

Twin clutch suited for heavy-duty work



## 1/2" UT / AIRCAT Impact Wrenches

### 1/2" Drive Composite Impact Wrench

CODE UT8126



A heavy-duty 1/2" wrench with high torque 3 position power settings in forward, full power in reverse

Through Handle Exhaust, twin hammer mechanism

Speed: 9000 rpm

Av. Air Con.: 5.7cfm

Max Torque: 580 lbs ft (786 NM)

Weight: 2.0kg

Vibration Level: 6.75 m/sec

Sound Pressure: 85 db (a)

Length: 195mm

Height: 170mm

Also available as a kit with 5 impact sockets (16, 17, 19, 22 & 24mm) in a tool case - Code: UT8126K

### AIRCAT AC 1450 1/2" Drive Impact Wrench

CODE AC1450

Quality and Value from AIRCAT

Refined design twin hammer increases blow frequency and blow efficiency

800ft-lb/1085 (NM) Max. Torque

Very fast torque development

9,000 RPM free speed provides fast run-down

Ergonomically-designed grip provides maximum operating comfort

Six-position power management switch in back cap provides ultimate control

Great balance and handling comfort

Brushed aluminium housing fin

Weight: 2.2kg



### Professional 1/2" Cordless Impact Wrench

CODE UT-HP180LI



Innovative wrench which gives the operator the ability to set a torque limit with a control switch on the back of the tool, while tightening nuts, and to run at maximum torque while loosening.

Maximum torque: 542 Nm (400ft-lbs)

Voltage: DC 18.0v

Impacts per minute: 2300

Charge time: 1 hour

Weight: 2.9kg

Battery capacity: 3.0 ah

No load speed: 1800 rpm

Length: 254mm

Vibration level: 5.89m/sec<sup>2</sup>

Height: 269mm

Sound pressure: 98 db(a)

Supplied in a robust tool case with charger, 2 batteries and replaceable carbon brushes



## 3/4" UT / AIRCAT Impact Wrenches

### 3/4" Impact Wrench

CODE UT5315



Good general-duty tool suitable for many agricultural and workshop applications



Max torque	1153 Nm (850 ft-lbs)
Weight	4.8kg
Average air consumption	8 cfm
Free speed	5000 rpm
Length	253mm
Air inlet thread size	1/4"
Vibration level:	5.8m/s <sup>2</sup>

### 3/4" Impact Wrench

CODE UT8326

UT's heavy-duty composite 3/4" air wrench  
Lightweight and lower air consumption

Max torque	1085 Nm (800 ft-lbs)
Weight	3.8kg
Average air consumption	6.3 cfm
Free speed	4000 rpm
Length	244mm
Air inlet thread size	3/8"
Vibration level:	4.2m/s <sup>2</sup>



### 3/4" Heavy-Duty Impact Wrench

CODE AC1600TH



This wrench uses the rugged and reliable Twin Hammer mechanism - better suited for bus, large automotive and agricultural use.

- Hard-Hitting "Super Clutch" Twin Hammer Mechanism
- Ergonomically-designed handle (reduces operator fatigue)
- Patented quiet technology (86 decibels)
- Patented through the handle exhaust (keeps debris away from face)
- Patented easy operation flip lever forward and reverse

Loosening torque	1,400 (ft-lbs)
Working torque	200-1200 (ft-lbs)
Free speed	4,500 (RPM)
Weight	7.9lbs (3.58kg)
Overall length	9.25in (235mm)
Avg. air consumption	8 (CFM)
Sound level	86 (dBA)
Air flow pressure	90 – 120 (psi)
Air inlet	3/8" NPT

CE Certified  
Patented Ergonomically-Designed Handle

## 1" Air Impact Wrenches

### Heavy-Duty 1" Air Impact Wrench

CODE

UT8419

A high power 1" air impact wrench with maximum 2440 Nm torque

Pinless single hammer mechanism for improved reliability and maximum output

Adjustable torque control

Forward and reverse control valve

8" anvil for easy access to wheel nuts

Speed: 4,500 rpm

Maximum torque in reverse: 2440 Nm

Length: 521mm

Net weight: 11.59kg

Vibration level: 9.5m/sec<sup>2</sup>

Sound pressure: 108.4db(a)

Air inlet: 1/2"



### Lightweight High Power 1" Air Impact Wrench

CODE

UT8468

The latest in high tech performance from UT

Lightweight and high torque - ideal for plant or commercial vehicle use

2441 Nm (1800ft-lbs) at maximum torque

Free Speed: 6,000rpm

Average air consumption: 10cfm

Vibration level: 6.55m/sec<sup>2</sup>

Sound pressure: 96db(a)

Weighs only: 7.5kg (16.5 lbs)

Adjustable torque control

Forward and reverse control valve

Side auxiliary handle adjustable for right or left handed use

1" square drive with 8" anvil

Air inlet: 1/2"



### High Power 1" Air Impact Wrench

CODE

UT8420



Ideal for heavy-duty plant or commercial vehicle use where a high torque is needed

Free Speed: 4,500rpm

Impacts Per Minute: 1,100

Max Torque in reverse: 2,300ft lbs (3118 Nm)

Average Air Consumption: 12cfm

Length: 660mm (26 ins)

Net Weight: 14.5 kgs (31.9lbs)

Vibration Level: 8.9m/sec<sup>2</sup>

Sound Pressure: 103db (a)

Air Inlet: 1/2 BSP ins

## 1/2" Drive Impact Socket Sets

### 4-Piece Deep Length 1/2" Drive Impact Socket Set

CODE

SET08VWN4



Comes with plastic sleeve and insert for the protection of alloy wheels. 17, 19, 21 & 22mm

### 11-Piece 1/2" Drive Impact Socket Set

CODE

H0082

Supplied in a plastic moulded case.  
Contents: 12mm, 13mm, 14mm, 15mm, 16mm,  
17mm, 18mm, 19mm, 21mm, 22mm, 24mm



### 11-Piece Deep 1/2" Drive Impact Socket Set

CODE

H0082-MM



Supplied in a plastic moulded case.  
Contents: 12mm, 13mm, 14mm, 15mm, 16mm,  
17mm, 18mm, 19mm, 21mm, 22mm, 24mm

### 7-Piece 1/2" Drive Socket Set

CODE

IS12/SET-8LUG

For removing locking wheel nuts and worn nuts. Easy-to-use and the sockets have a left hand taper thread, which tightens on the nut being removed as you undo it. To release the socket from the nut, hold the nut in a vice and reverse direction.

Contents: 17mm, 18.5mm, 20mm, 21.5mm, 23mm, 24.5mm, 26mm



## 3/4" Drive Impact Socket Sets

### 8-Piece Deep Length 3/4" Drive Impact Sockets

CODE

H0086-1



Supplied in a plastic moulded case:  
Contents: 24mm, 27mm, 29mm, 30mm, 32mm, 33mm, 36mm, 38mm

## 1" Drive Impact Socket Sets

### 8-Piece Deep Length 1" Drive Impact Sockets

CODE H0093-1



Supplied in a plastic moulded case.

Contents: 24mm, 27mm, 29mm, 30mm,  
32mm, 33mm, 36mm, 38mm

### 4-Piece Deep Length 1" Drive Impact Sockets

CODE H0095

Supplied in a plastic moulded case.  
Contents: 27mm, 30mm, 32mm, 33mm



### 8-Piece Drive Impact Adapter Set

CODE SETADAPT8



Set comprises:

1/4" female x 3/8" male

3/8" female x 1/4" male

3/8" female x 1/2" male

1/2" female x 3/8" male

1/2" female x 3/4" male

3/4" female x 1/2" male

3/4" female x 1" male

1" female x 3/4" male



Individual impact sockets are available in a wide range of sizes:

1/4" drive – from 4mm to 14mm in standard and deep lengths

3/8" drive – from 6mm to 24mm in standard and deep lengths

1/2" drive – from 8mm to 38mm in both standard and deep lengths

3/4" drive – from 13mm to 47mm in standard and deep lengths

1" drive – from 17mm to 100mm in standard and deep lengths

Section Four  
Air/Power Tools  
& Accessories

## Universal Air Tools – Pneumatic Tools

Tyre Buffer

CODE UT5721-TB



Speed	20,000rpm
Av. air con	4cfm
Vibration level	3m/sec <sup>2</sup>
Sound pressure	93db(a)
Length	270mm
Weight	0.6kg

20mm Belt Sander

CODE UT8765



Heavy-Duty

Belt sizes	520 x 20mm
Speed	16000rpm
Vibration level	<2.5m/sec <sup>2</sup>
Sound pressure	87db(a)
Weight	1.5kg

3" Exhaust Cut Off Tool

CODE UT5762



Speed	20,000rpm
Av. air con	4.5cfm
Vibration level	3m/sec <sup>2</sup>
Sound pressure	93db(a)
Weight	0.6kg

4 1/2" Angle Grinder

CODE UT8750A



Speed	12000rpm
Av. air con	10cfm
Vibration level	5.1m/sec <sup>2</sup>
Sound pressure	82.9db(a)
Weight	1.86kg

Reciprocating Air Saw

CODE UT5920



Strokes per min	10000rpm
Av. air con	4cfm
Vibration level	24.1m/sec <sup>2</sup>
Sound pressure	79db(a)
Weight	0.6kg

Pneumatic Tyre Buffing Tool

CODE UT8777AC

The perfect tool for tyre work  
Angled for comfort and control

Speed	18000rpm
Collet chuck size	6mm
Av. air con	4cfm
Vibration level	<2.5m/sec <sup>2</sup>
Sound pressure	82db(a)
Length	135mm
Weight	0.48kg
Air inlet thread	1/4" bsp



TIP: Use, for example, with 40503 golf ball rasp for tyre puncture repair preparation.

The UT Catalogue showing the full, extensive range of air tools is available on request

## Universal Air Tools – Pneumatic Tools

### Hammer and Chisel Kit

CODE

UT8646-BK

Blows Per Minute	3500
Average Air Con	4cfm
Vibration Level	13.8m/sec <sup>2</sup>
Sound Pressure	96.3db(a)
Weight	1.6kg
Length	171mm
Height	145mm
Piston Bore	19mm



A general-duty hammer kit including five mixed chisels for multiple applications including exhaust work, bodyshop work, scraping and chiselling applications.

### 3/8" Reversible Drill

CODE

UT5825



Speed	1800rpm
Av. air con	4cfm
Vibration level	<2.5m/sec <sup>2</sup>
Sound pressure	91db(a)
Weight	1.36kg

### 1/2" Reversible Drill

CODE

UT8850A



Speed	800rpm
Av. air con	4cfm
Vibration level	<2.5m/sec <sup>2</sup>
Sound pressure	91db(a)
Weight	1.5kg

## Preventive Maintenance for Air Tools

Keeping your expensive investment in air tools in good working order is common sense.

All air tool manufacturers specify the regular lubrication and greasing of their tools as appropriate (check the tool manual for specific recommendations). Failure to properly lubricate your air tools will result in the build-up of gum and deposits that will effect the tool's operation and will nullify your warranty.

### Marvel Air Tool Oil

Marvel's unique formulation has a heavy-duty corrosion inhibitor to protect your Universal Air Tool from moisture in the airline. It includes a solvent that breaks down deposits, allowing them to be safely blown out of the exhaust, leaving a lasting coating of oil for lubrication and your air tool in peak condition. The oil is silicone-free and protects the o-rings, seals and other parts.



Marvel Air Tool Oil 118mm

CODE H0076

Marvel Air Tool Oil 946mm

CODE H0077



## Hose Reels

### Retractable Rubber Air Hose Reel

CODE

AH1315R REEL



Ideal for commercial vehicle workshops

13mm (1/2") x 15m (50") rubber air hose rated at 300 PSIG (20 bar) max. with Male 1/2" BSP fitting

Heavy-duty reinforced steel construction

Spring retractable design allows automatic rewind of hose

Four non-slag roller hose guides reduce hose wear

Reel supported on both sides by pedestals and arm guides

Reinforced steel mounting plate for floor, wall or overhead mounting

Spring protector prevents hose damage and stretching

Also available in 10mm (3/8") x 15m (50") rubber air with Male 1/4" BSP fitting

CODE

UT-AH1315 R10MM

### Retractable PVC Air Hose Reel

CODE

UT1015 REEL

With a high impact composite case

Wall mounted, automatic or ratchet free running, with a 10mm hose diameter

Ideal for automotive workshops

10mm (3/8") ID x 15m (50") with 1/4" male BSP fittings

Automatic or free running

Highly-durable composite case



## Air Treatment

### PCL 2-Piece Filter/Regulator and Lubricator Set



A high-quality airline filter/regulator with pressure gauge and airline lubricator and wall mounting bracket

Manual/semi automatic drain; 10 micron filter; Locking device

1/4" ports

CODE

PCL-ATCFRL6

1/2" ports

CODE

PCL-ATCFRL12



## Section Four

Air/Power Tools  
& Accessories

# Hose Reels

## Polypropylene Spring Rewind Hose Reel

CODE

2752153



### Goodyear Brand Spring Rewind Compressed Air Hose Reel

A compact spring rewind hose reel constructed in durable impact resistant polypropylene. Supplied complete with 15 metre x 3/8" super flexible Hybrid polymer hose, 1.5 metre inlet hose and integral pivoting wall bracket. The compact size makes this reel ideal for use in smaller workshops where space is limited.

Hose has no memory and lays flat when in use

High quality, durable polypropylene housing

Fully automatic spring rewind

Low effort, easy-to-use rewind tension

Integral pivoting wall bracket, swivels through 180°

Latching of hose at any length

Working pressure up to 300psi (20 bar)

## Retractable Spring Driven Hose Reel

CODE

C815350GY

### Goodyear Brand Spring Rewind Air/Water Hose Reel

A high performance spring rewind hose reel constructed in heavy gauge powder-coated steel for use in low pressure applications. The 4-position roller guide arm adjusts for wall, overhead or ceiling mounting positions. Reel supplied with fitted hose.

Suitable for use with Compressed Air or Water up to 60°C

Corrosion-resistant powder coating

Guide arm adjustable handling up to 4 positions

Multi-position ratchet lock

Solid 1" steel axle

Spring fully enclosed and lubricated

Latching of hose at any length

All brass swivel assembly

Maximum Working Pressure: 20 bar (300psi)





## Section Four

Air/Power Tools  
& Accessories

# Air Line Hoses & Assemblies

Air Line Hoses from Universal Air Tools with superior working qualities, giving improved oil and abrasion resistance. 290psi (20 bars) working pressure / burst pressure is 870psi (60 bars). 100% silicone-free, Conforms to BS EN ISO 2398:2008. Available in a wide range of lengths and sizes as below:



Hose ID	Length	Fitting A	Fitting B	CODE	
10mm	5m	¼" BSP Male	¼" BSP Male	CODE	AH1005RA
10mm	10m	¼" BSP Male	¼" BSP Male	CODE	AH1010RA
10mm	15m	¼" BSP Male	¼" BSP Male	CODE	AH1015RA
10mm	20m	¼" BSP Male	¼" BSP Male	CODE	AH1020RA
13mm	5m	½" BSP Male	½" BSP Female	CODE	AH1305RA
13mm	10m	½" BSP Male	½" BSP Female	CODE	AH1310RA
13mm	15m	½" BSP Male	½" BSP Female	CODE	AH1315RA
13mm	20m	½" BSP Male	½" BSP Female	CODE	AH1320RA



## PCL Air Line Hoses c/w Couplers



Air tool hose c/w 100 series adapter & ½" male ends.

Working pressure 300 lb/in (21 bar)

Hose ID	Length	Fittings	CODE	
13mm	10m	100 series & ½" male	CODE	HA2110
13mm	10m	100 series & ½" male	CODE	HA2111

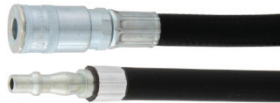

Air tool hose c/w vertex couplings & standard adapter ends.

Working pressure 300 lb/in (21 bar)

Hose ID	Length	Fittings	CODE	
10mm	5m	Standard & vertex coupler	CODE	HA2133
10mm	10m	Standard & vertex coupler	CODE	HA2134
10mm	15m	Standard & vertex coupler	CODE	HA2139
10mm	20m	Standard & vertex coupler	CODE	HA2129



Air tool hose c/w 100 series coupling & adapter ends.

Working pressure 300 lb/in (21 bar)

Hose ID	Length	Fittings	CODE	
13mm	10m	100 series & coupling	CODE	HA2144
13mm	15m	100 series & coupling	CODE	HA2150
13mm	20m	100 series & coupling	CODE	HA2128
13mm	30m	100 series & coupling	CODE	HA2152

All air tool manufacturers specify the use of Leader Hoses.

Leader Hoses avoid unnecessary vibration in couplers attached directly at the tool, and consequently save money.



Hose ID	Length	Fittings	CODE	
7mm	60cm	Standard & ½" male	CODE	HA2108
10mm	60cm	Standard & ½" male	CODE	HA2149
10mm	60cm	Standard & 3/8" male	CODE	HA2109
13mm	60cm	100 series & ½" male	CODE	HA2116

## Heavy-Duty Recoil Air Hose

Available in various lengths, this is a robust workshop hose, which is kink-resistant and has a maximum working pressure of 200lb/in<sup>2</sup>.



Hose ID/OD	Length	Fittings	CODE	
6.5mm/10mm	2.5m	¼" Bspt	CODE	HA5210
6.5mm/10mm	5m	¼" Bspt	CODE	HA5212
6.5mm/10mm	7.5m	¼" Bspt	CODE	HA5214
8mm/12mm	7.5m	¼" Bspt	CODE	HA5217
8mm/12mm	10m	¼" Bspt	CODE	HA5219
10m/15mm	10m	3/8" Bspt	CODE	HA5221

## PCL Air Line Fittings



### PCL Vertex Couplers



Coupler 1/4" BSPF female	AC91CF
Coupler 1/4" BSPM male	AC91CM
Coupler 3/8" BSPM male	AC91EM
Coupler 1/2" BSPM male	AC91JM

### PCL Airflow Couplers



Coupler 1/4" BSPF female	AC21CF
Coupler 1/4" BSPM male	AC21CM
Coupler 3/8" BSPM male	AC21EM
Coupler 1/2" BSPM male	AC21JM

### PCL M100 Couplers



Coupler 3/8" BSPF female	AC5EF
Coupler 3/8" BSPM male	AC5EM
Coupler 1/2" BSPF female	AC5JF
Coupler 1/2" BSPM male	AC5JM

### Plug in Adapters - Vertex & Airflow



Adapter 1/4" BSPM male	ACA2593
Adapter 1/4" BSPF female	ACA2746
Adapter 6mm hose stem	ACA1793
Adapter 8mm hose stem	ACA2487
Adapter 10mm hose stem	ACA2488

### Y Couplings



PCL Airflow Y coupling	AC6103
PCL Vertex Y coupling	AC6503
PCL M100 Y coupling	MA1097
M100+Vertex Y coupling	MA1097S

### PCL Plug in Adapters - M100



Adapter 3/8" BSPF female	ACA2994
Adapter 3/8" BSPM male	ACA2999
Adapter 1/2" BSPM male	ACA3035
Adapter 13mm hose stem	ACA3036

### Hose Stems



6mm stem - 1/4" BSPM male	HC5656
8mm stem - 1/4" BSPM male	HC1206
10mm stem - 1/4" BSPM male	HC1217
13mm stem - 1/4" BSPM male	HC2479
13mm stem - 1/2" BSPM male	HC2954

### Bushing - Male/Female

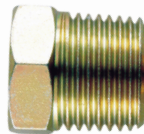

Bushing 1/2"M - 1/4"F	HC6896
Bushing 1/2"M - 3/8"F	HC6897
Bushing 3/8"M - 1/4"F	HC6895

### Union - Unequal Double Male



Union 1/4"M - 3/8"M	HC6899
Union 1/4"M - 1/2"M	HC6900
Union 3/8"M - 1/2"M	HC6901

### Union - Equal Double Male



Union 1/4"M	HC6560
Union 3/8"M	HC4281
Union 1/2"M	HC6898

### Hose Repair Joiners



Repair stem - 6mm	HC2983
Repair stem - 8mm	HC2984
Repair stem - 10mm	HC2985
Repair stem - 13mm	HC2986

### Elbows



1/2"F x 1/2"M	MA14303
1/4"F x 1/4"M	MFL04N
1/2"F x 1/2"M	50-909GE/6

# Notes

# Notes

# Tyre Repair Materials



## Section Five:

Plug Patch Repairs.....	102
Puncture Repair Starter Kits .....	103
Tyre and Tube Repair Materials.....	104-106
Plug Repair Patches & Solutions .....	107
Off-Road "String Insert" Puncture Repair Kits ..	108-109
Solutions & Repair Tools .....	110
Tyre Injury Fillers .....	111
Tyre Sealants and Pumps.....	112
Vulcanisers .....	113

## Plug Patch Repairs



### Schrader PRP Tyre Repair Units with Pilot Wire



Repair instructions, together with an injury limit chart, are included in each box; subject to local regulations.

Size	CODE	
Box (40) 3mm stem	S4953-1	
Box (40) 4.5mm stem	42866	
Box (24) 6mm stem	S4956-1	
Box (12) 8mm stem	42868	
Box (10) 10mm stem	S4955-1	



Remove the tyre and mark out the puncture on the inside

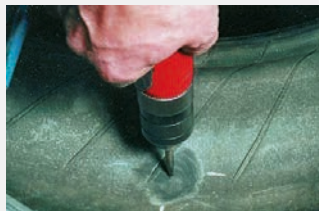

Choose the correct size PRP and drill out the injury from the inside



Lightly buff until curing bladder pattern disappears. Remove subsequent dust



Apply vulcanising cement to the puncture area and into the hole. Allow 5 minutes to dry

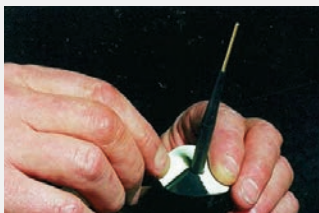

Remove protective foil from the patch. Do not touch the face gum



Pull the metal insert through the tyre smoothly and locate the plug patch



Roll down the patch from the centre outwards

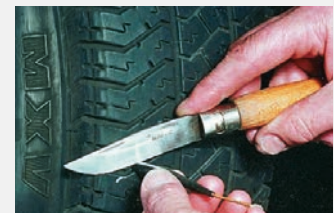

After refitting and inflating the tyre, cut off excess plug stem. Do not pull while cutting



### PRP Kits

Contains 40 x 3mm and 24 x 6mm PRP units; 10 x 20ml tubes solution; 1 x 3mm and 1 x 6mm carbide cutter; 1 x golf ball rasp. 1 x stitcher/roller	CODE	S4958
Contains 20 x 3mm and 12 x 6mm PRP units; 5 x 20ml tubes solution; 1 x 3mm and 1 x 6mm carbide cutter	CODE	S4964
Contains 24 x 6mm PRP units; 5 x 20ml tubes solution; and 1 x 6mm carbide cutter	CODE	S4252

### Tools



Golf ball rasp	CODE	40503
Patch stitcher/roller	CODE	42-617
3mm angular milling cutter	CODE	42-393
4.5mm angular milling cutter	CODE	42-394
6mm angular milling cutter	CODE	42-378
8mm angular milling cutter	CODE	42-377
10mm angular milling cutter	CODE	42-379



## Puncture Repair Starter Kits



### Tyre Puncture Repair Starter Kit No.1

CODE

PRPKIT-1

Contains all you need to get started:

- 1 box (24) 6mm PRP plug patches
- 1 box (10) 10mm PRP plug patches
- 1 tin vulcanising solution
- 1 tin cleaner/buffer fluid
- 1 6mm angular milling cutter
- 1 10mm angular milling cutter
- 1 "golf ball" buffing rasp
- 1 patch roller
- 1 x 24" toolbox



Instructions included in each box of PRP patches

### Tyre Puncture Repair Starter Kit No.2

CODE

PRPKIT-2



Instructions included in each box of PRP patches

Contains all you need to get started:

- 1 box (24) 6mm PRP plug patches
- 1 box (10) 10mm PRP plug patches
- 1 tin vulcanising solution/1 tin cleaner/buffer fluid
- 1 6mm angular milling cutter/1 10mm angular milling cutter
- 1 "golf ball" buffing rasp/1 patch roller
- 2 x standard tyre valves/2 x safety hump valves/2 x super single valves/2 x 8" rubber extensions and mounting clamps/1 box valve cores/1 box valve caps/1 core tool
- 1 x 24" toolbox

### Tyre Puncture Repair Starter Kit No.3

CODE

PRPKIT-3

Contains all you need to get started:

- 1 box (24) 6mm PRP plug patches
- 1 box (10) 10mm PRP plug patches
- 1 box (10) RAD112 70x115mm radial tyre patches
- 1 box (10) RAD114 85x130mm radial tyre patches
- 1 tin vulcanising solution/1 tin cleaner/buffer fluid
- 1 6mm angular milling cutter/1 10mm angular milling cutter
- 1 "golf ball" buffing rasp/1 patch roller
- 2 x standard tyre valves/2 x safety hump valves/2 x super single valves/2 x 8" rubber extensions and mounting clamps/1 box valve cores/1 box valve caps/1 core tool
- 1 x 24" toolbox



Instructions included in each box of PRP & RAD patches

## Tyre and Tube Repair Materials

### Schrader SR Radial Tyre Patches

For injuries up to 6mm maximum in car tyres and 10mm maximum in truck tyres, use PRP Plug Patches.



Ref	Quantity	Size	Ply Rating	CODE	
SR 110	20	65 X 80mm	1 ply	CODE	66220-67
SR 112	10	70 x 115mm	1 ply	CODE	66221-67
SR 114	10	75 X 145mm	1 ply	CODE	66222-67
SR 115	10	75 x 90mm	1 ply	CODE	66223-67
SR 120	10	75 x 125mm	2 ply	CODE	66224-67
SR 122	10	75 x 165mm	2 ply	CODE	66225-67
SR 124	10	75 x 215mm	2 ply	CODE	66226-67
SR 125	10	100 x 125mm	3 ply	CODE	66227-67
SR 140	10	100 x 200mm	3 ply	CODE	66231-67

Other sizes  
available on  
request

Schrader SR radial tyre patches store up to 5 years after the packing date. The arrow printed on the repair unit indicates the radial bead-to-bead direction. Repair instructions, together with an injury limit and tyre-patch size chart, are included in each box; subject to local regulations.



### Universal Tyre Patches

box (100) 35mm tyre patches	CODE	66200-67
box (100) 40mm tyre patches	CODE	66202-67
box (30) 45 x 45mm tyre patches	CODE	66203-67
box (50) 60 x 60mm tyre patches	CODE	66205-67
box (50) 69 x 69mm tyre patches	CODE	66207-67

For up  
to 8mm tyre  
injury



### Tube Repair Patches

Full Range of Oval tube patches also available



box (100) 25mm tube patches	CODE	66260-67
box (100) 30mm tube patches	CODE	66261-67
box (30) 34mm tube patches	CODE	66262-67
box (30) 43mm tube patches	CODE	66263-67
box (30) 50mm tube patches	CODE	66264-67
box (30) 80mm tube patches	CODE	66265-67
box (10) 94mm tube patches	CODE	66266-67
box (10) 116mm tube patches	CODE	66267-67





## Tyre and Tube Repair Materials

### Radial Tyre Patches

For injuries up to 6mm maximum in car tyres and 10mm maximum in truck tyres, use PRP Plug Patches. VIPAL RAC radial tyre patches store up to 2 years after the packing date. The arrow printed on the repair unit indicates the radial bead-to-bead direction.

Repair instructions, together with an injury limit and tyre-patch size chart, are included in each box; subject to local regulations.

Ref	Qty	Size	Ply	CODE	
RAC 10	20	55 x 75mm	1 ply	CODE	303810
RAC 12	10	70 x 115mm	1 ply	CODE	303812
RAC 14	10	85 x 130mm	1 ply	CODE	303814
RAC 15	10	90 x 75mm	1 ply	CODE	303815
RAC 20	10	80 x 120mm	2 ply	CODE	303820
RAC 22	10	75 x 165mm	2 ply	CODE	303822
RAC 25	10	115 x 125mm	3 ply	CODE	303825
RAC 26	10	260 x 75mm	3 ply	CODE	303826
RAC 35	10	200 x 150mm	4 ply	CODE	303835
RAC 40	10	195 x 95mm	3 ply	CODE	303840
RAC 42	10	260 x 130mm	4 ply	CODE	303842
RAC 44	10	335 x 130mm	4 ply	CODE	303844
RAC 45	5	230 x 180mm	4 ply	CODE	303845



Other sizes  
available on  
request



### Universal Tyre Patches

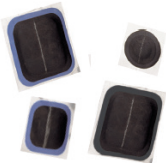

Box (100) VFP3 35mm tyre patches	CODE	303919
Box (50) VFP6 50mm x 50mm tyre patches	CODE	303646
Box (50) VFP8 67mm x 67mm tyre patches	CODE	303648

For up  
to 8mm tyre  
injury

### Tube Repair Patches

Box (100) R00 30mm tube patches	CODE	345100
Box (100) R01 40mm tube patches	CODE	345101
Box (40) R02 50mm tube patches	CODE	345102
Box (40) R03 60mm tube patches	CODE	345103
Box (40) R04 80mm tube patches	CODE	345104
Box (25) R05 100mm tube patches	CODE	345105
Box (25) R06 120mm tube patches	CODE	345106



## Tyre Repair Materials

### Cross-Ply Tyre Patches

For the repair of damage to cross-ply tyres in the tread and shoulder area.



Ref	Quantity	Size	Ply Rating	CODE	
VD01	30	60mm	1 ply	CODE	303901
VD02	20	85mm	2 ply	CODE	303902
VD03	10	105mm	2 ply	CODE	303903
VD04	10	135mm	2 ply	CODE	303904
VD05	10	165mm	4 ply	CODE	303905
VD06	10	245mm	6 ply	CODE	303906
VD07	10	300mm	6 ply	CODE	303907
VD08	5	350mm	6 ply	CODE	303908
VD09	5	395mm	8 ply	CODE	303909
VD10	3	455mm	8 ply	CODE	303910



### Radial Agricultural Tyre Patches

A selection of patches specifically designed for using on radial agricultural tyres.



Ref	Quantity	Size	Ply Rating	CODE	
RAC 80	5	195 x 150mm	2 ply	CODE	303880
RAC 82	5	255 x 190mm	3 ply	CODE	303882
RAC 84	5	290 x 215mm	3 ply	CODE	303884
RAC 86	5	345 x 250mm	3 ply	CODE	303886



## Plug Repair Patches & Solutions

### Vipal PRP Tyre Repair Units with Pilot Wire



Box (50) 3mm stem	CODE	351423
Box (40) 6mm stem	CODE	351426
Box (20) 8mm stem	CODE	351428
Box (18) 10mm stem	CODE	351430

Repair instructions, together with an injury limit chart, are included in each box; subject to local regulations.



### Vipal CV Patch Solution

Use with Vipal RAC patches, Universal patches, Tube patches & plug repair patches

CV 00 225ml	CODE	470010
CV 01 500ml	CODE	470011
CV 02 1000ml	CODE	470012



### Vipal SV-01 Inner Liner Patch Sealer



For sealing the edges of radial patches after application

SV 01 500ml	CODE	461280
-------------	------	--------



## Off-Road "String Insert" Puncture Repair Kits

### String Insert Kit

CODE

SIPK6



The ideal starter kit for off-road puncture repairs to ATV, lawnmower, small plant and farm tubeless tyres.

The string repair inserts are constructed of twisted cord permeated with butyl rubber inside and out. The high tensile cord assures no breakage during insertion and the soft and tacky butyl rubber seals the injury.

The kit contains:

- 1 pack (50) string inserts 7" long (180mm)
- 1 metal T handle insert needle tool
- 1 metal T handle probe/rasp tool
- 1 small knife
- 1 tub lubricant

Recommended for temporary puncture repairs in tyres used off-road only

### String Insert Kit

CODE

SIPK5

The kit contains:

- 1 pack (100) string inserts 4" long (100mm)
- 1 metal T handle insert needle tool
- 1 metal T handle probe/rasp tool
- 1 small knife
- 1 tub lubricant

Recommended for temporary puncture repairs in tyres used off-road only



### Heavy-Duty Off-Road "String Insert" Puncture Kit

CODE

SIPK3

String repair kit comes inside a custom-made, heavy-duty plastic case with snap lock latch. T Bone needle and handle have a steel inner core, with moulded rubber grips, for greater comfort and long life.



The kit contains:

- 1 - T bone Handle with Spiral Probe
- 1 - T bone Handle with 6" open eye needle
- 1 - Spare 6" open eye needle
- 1 - Pack of 15 - 6" Thick Black String
- 1 - Pack of 20 - 6" Thin Black String
- 1 - Pack of 50 - 4" Thick Brown String
- 1 - Jar of lube
- 1 - Razor blade for removing excess repair material
- 1 - Valve core remover with reversible Philips and Straight type screwdriver
- 1 - Hex key for interchanging needle

Recommended for temporary puncture repairs in tyres used off-road only

## Off-Road "String Insert" Puncture Repairs

### Off-Road "String Insert" Puncture Kit

CODE

SIPK1



Starter kit for puncture repairs off-road from outside the tyre. The string repair inserts are constructed of twisted cord, permeated with butyl rubber inside and out. The high tensile cord assures no breakage during insertion and the soft and tacky butyl rubber seals the injury. The kit contains: 1 pack (50) 8" x 3.5mm black "string" inserts; 1 pack (20) 12" x 6mm black "string" inserts; 1 x metal T handle insert needle tool with replaceable split eye needle; 1 x long replacement closed eye needle; 1 x long replacement open eye needle; 1 x T handle probe/rasp tool; 1 x 250ml tin vulcanising solution with application brush; 1 x small knife; 1 x toolbox.

Recommended for temporary puncture repairs in tyres used off-road only

### BlackJack Tyre Repair

Uses eight strands of high-tensile fibre. Each strand of fibre is individually impregnated with our live butyl vulcanising rubber compound. Carbon black makes rubber stronger and matches the colour of the tyre. BlackJack conforms to the size and shape of the injury, sealing out moisture and dirt. The soft malleable repair conforms to the shape of the injury, eliminating stress to the belts. Available in two different sizes as below:



6" long thick box of 40

CODE RE-640



6" long thick box of 45

CODE RE-645

### Heavy-Duty "T" Bone String Insert Handle (as found in product SIPK3)

Comes with the following open-ended Interchangeable needles. Check out our website for more Heavy-Duty Needles and Reamers.

95mm	(3 - 3/4") Long
125mm	(4 - 7/8") Long
145mm	(5 - 3/4") Long



More sizes of Off-Road "String Insert" puncture materials as follows:

Box (50) 7" x 3.5mm black	CODE	15-206
Pack (40) 12" x 3.5mm black	CODE	15-283
Box (60) 4" x 6mm brown	CODE	15-280
Box (30) 7" x 6mm brown	CODE	15-281
Pack (20) 12" x 6mm black	CODE	15-284

Recommended for temporary puncture repairs in tyres used off-road only

### Insert Tools for "Off-Road" String Repairs



No.	Description	CODE	
1	"T" grip open eye needle insert tool	CODE	15-224
2	"T" grip rasp/probe tool	CODE	15-225
3	"T" grip split eye needle insert tool	CODE	15-227
4	Chrome "T" handle split eye needle insert tool	CODE	15-231
5	Replacement split eye needle	CODE	15-230
6	"T" grip cementing tool	CODE	15-232

Section Five  
Tyre Repair Materials

## Solutions & Repair Tools



Item	Description	CODE	
1	Schrader "QUARTZ" vulcanising solution for use with tube patches: 235ml	66317-67	
2	Schrader "JADE" vulcanising cement for use with tyre patches: 235ml	66310-67	
3	Schrader cleaner / buffer solvent: 800ml tin	66215-67	
3	Schrader cleaner / buffer solvent: 500ml spray	66217-67	
4	Schrader inner-liner seal: 250ml can	66371-67	
5	Extra seal Bead Sealer: 945ml	14-101	
6	Schrader leak finder: 945ml bottle	66372-67	
7	Schrader dilution bottle – capacity 600ml	66373-67	



Tyre probe **CODE** 19911

"T" grip 6mm rasp **CODE** 15-114

"T" grip long 6mm rasp **CODE** 15-114L



General purpose tyre repair knife **CODE** KF-01



Patch stitcher/roller **CODE** 42-617



Small paste brush **CODE** 60804

Large paste brush **CODE** 60805



Tyre marking crayon

Pack 14 White **CODE** MC-W10

Pack 14 Yellow **CODE** MC-Y10

Pack 14 Orange **CODE** MC-O10

## Tyre Injury Fillers

### A & B Compound

CODE 130115-25



Two part self-vulcanising putty. Ideal for repairing tyres and all types of rubber products.

Mix the 2 parts together to vulcanise at room temperature.

Supplied in 2 x 500g tins (1 each A & B).  
Use with Jade vulcanising cement

### Tyre-Fill

A cold cure rubber compound used for filling cosmetic repairs such as small rubber cuts, holes and bead leaks.



#### Description

Tyre-Fill Applicator Gun	CODE	TF1
Tyre-Fill Cartridge 310ml	CODE	TF2
Tyre-Fill Cartridge Nozzle	CODE	TF3
Tyre-Fill Set: 1 x Applicator Gun, 2 x Tyre-Fill Cartridge and 2 x Nozzle	CODE	TF4

### Tyre Dough



The kit comes complete with dough applicator gun, three tyre dough cartridges, a tin of vulcanising solution and a small rasp-probe tool. These products are also sold separately.

#### Description

Tyre Dough Applicator Gun	CODE	TDG1
Tyre Dough Cartridge	CODE	TD1
Tyre Dough Set: 1 x Applicator Gun, 3 x Tyre Dough Cartridges, 1 x Tin Vulcanising Solution and 1 x Rasp-Probe Tool	CODE	TDSET

## Tyre Sealants & Pumps

### Oko Tyre Sealant

The Linseal Oko Anti-Puncture Treatment

More and more farmers, site contractors and fleet operators the world over are discovering how to banish most punctures altogether.

Linseal seals punctures as they happen - instantaneously, effecting a permanent seal with no loss of air pressure. Easy-to-use, Linseal will seal holes in the tyre tread area caused by puncturing objects up to 10mm in diameter. Linseal is absolutely safe, has no adverse effect on rubber, is non-toxic and water-soluble.

Linseal works just as well in all vehicles from wheelbarrows and all-terrain vehicles (ATVs) to ride-on lawn mowers, tractors, skiploaders, diggers, backhoes and other heavy-wheeled vehicles. Linseal will seal hole after hole.

10 reasons for using Oko Tyre Sealant:

- Reduces puncture repair costs
- Reduces downtime and immobility
- Reduces expensive call out costs
- Replaces the need for an inner tube
- Reduces occurrence of run flat tyre damage
- Increases useful life of tyre
- Helps fight tyre underinflation
- Not harmful to the environment
- Offers peace of mind
- Can be used for a wide range of vehicles

Application charts are available on our website



#### Product

25 Litre Drum

CODE OKO25

1 Litre Container

CODE OKO1

### Tyre Sealant Pump

CODE OKOP1



To fit 25 litre drums of Linseal Oko Tyre Sealant. Dispenses 200ml per stroke.

Comes with:

- An applicator hose
- A tyre valve connector

For use with Linseal Tyre Sealant and their drums with a female thread only.



## Vulcanisers

At The Tyre Equipment Company, we are able to offer tyre vulcanising solutions for a wide range of tyres - from 4x4 tyres through to earthmover tyres. We are able to supply a full range of tyre repair tools and equipment and also offer full training on all aspects of tyre repair and vulcanising.

### Tyre Vulcaniser

CODE

M50



The M50 is capable of carrying out Hotcure spot repairs on 4x4, truck, tractor, implement and small earthmover tyres. Repairs can be made in the tread or sidewall areas depending on injury size, location and tyre category.

Reinforcement is then required and achieved using chemical cure reinforced repair patches, bonded with special cements and gums.

### Tyre Vulcaniser

CODE

VSM150

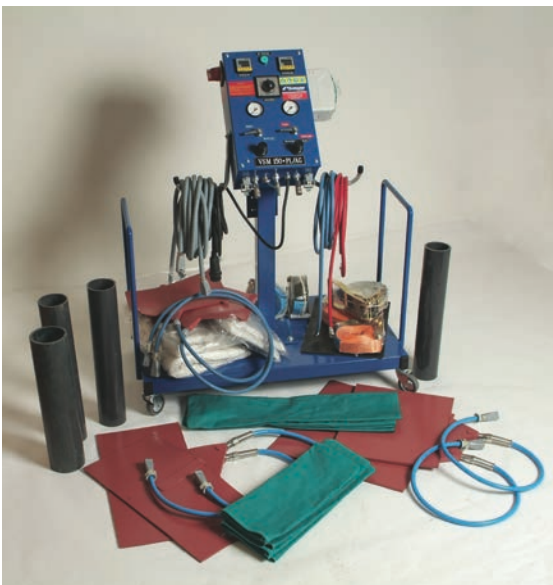

The VSM 150 machine is capable of carrying out large Hotcure repairs using airbags and heat pads on truck, tractor, implement and small earthmover tyres.

Extra pads and airbags of numerous sizes are available to cater for specific tyre ranges and sizes.

This versatile system cures the repair material and patch simultaneously – using heat, pressure and time – which produces a mechanical bond between the tyre, the new repair material and the patch.

# Notes

# Tyre Valves & Accessories

---

## Section Six:

Truck & Bus Tyre Valves.....	116-117
Agricultural & Plant Tyre Valves .....	118
Tread Depth Gauges.....	118, 34
Tyre Valve Accessories.....	119
Air Connector.....	120
Other Accessories.....	121
Car/Van Valves, Weights & .....	122
Accessories Wheel Weight Tools .....	122
TPMS Sensor Saver Starter Kits .....	123

Section Six  
Tyre Valves & Accessories

## Truck & Bus Tyre Valves to fit 9.7mm valve hole

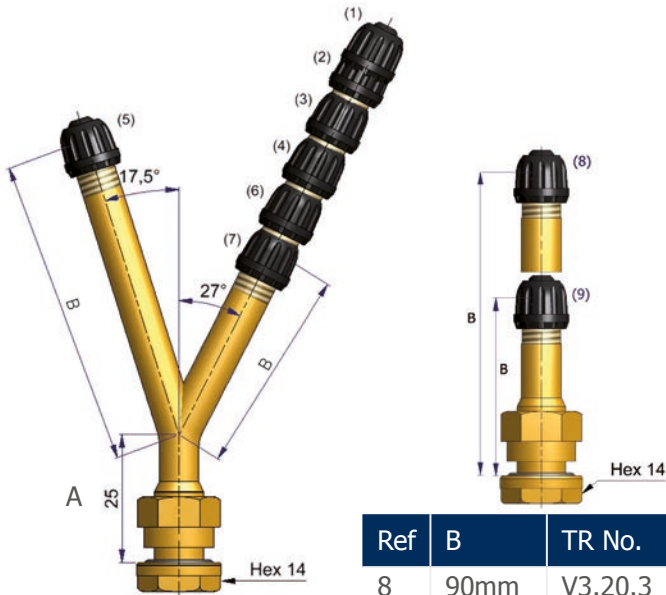

Ref	A	B	TR No.	Code
1	25mm	85mm	V3.20.6	R1487
2	25mm	80mm	-	R1898
3	25mm	70mm	V3.20.12	R1680
4	25mm	60mm	V3.20.4	R1485
5	25mm	60mm	V3.20.2	R1798
6	25mm	50mm	V3.20.7	R1500
7	25mm	40mm	V3.20.5	R1486

Ref	B	TR No.	Code
8	90mm	V3.20.3	V3203
9	35mm	V3.20.1	V3018

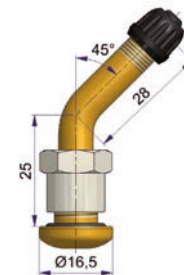

Item	TR No.	Code
Valve for EVA safety hump wheels	V3.22.1	S1390

## Nickel-plated truck and bus valves for alloy wheels with 9.7mm valve hole

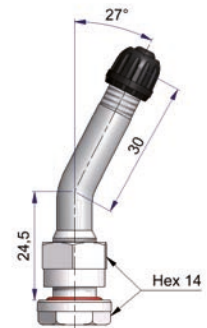
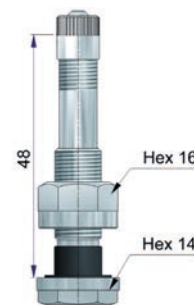
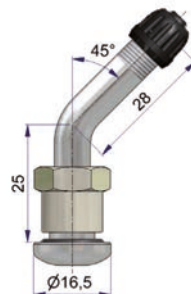
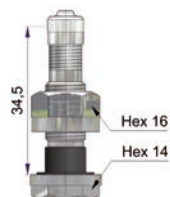

Ref No.	Code
70MS-07N2	65758

Ref No.	Code
40MS-00N	65769

Ref No.	Code
V3.22.1	42729

Ref No.	Code
54MS-00N	65757

Ref No.	Code
60MS-00N	41684

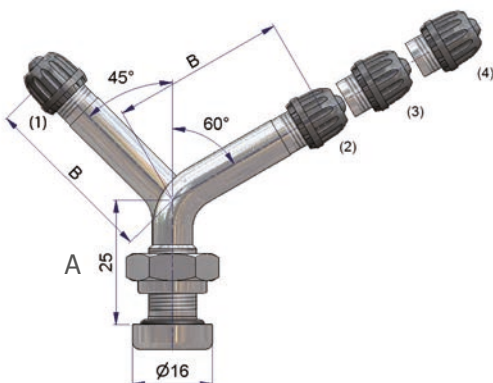

Ref	A	B	TR No.	Code
1	25mm	35mm	TR543C	33645
2	25mm	35mm	TR543D	S4295
3	25mm	50mm	TR544D	S4297
4	25mm	66mm	TR545D	42132
5	25mm	59mm	TR543	S4296
6	25mm	32mm	TR542	42130

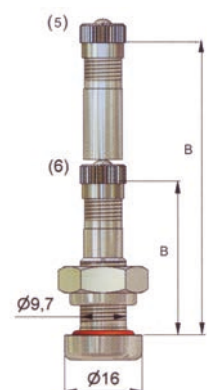

## Truck & Bus Tyre Valves to fit 16mm valve hole

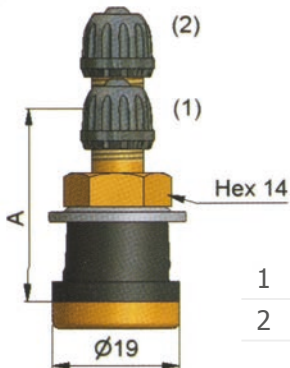

1	Valve	CODE	TR575	A	29mm
2	Valve	CODE	TR501	A	38mm

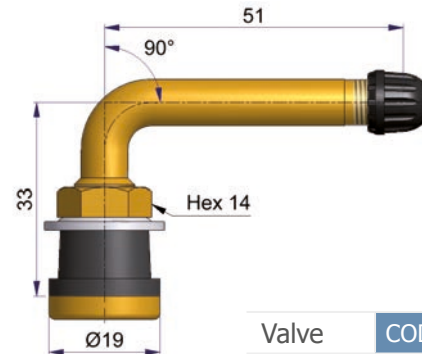

Valve CODE TR570C

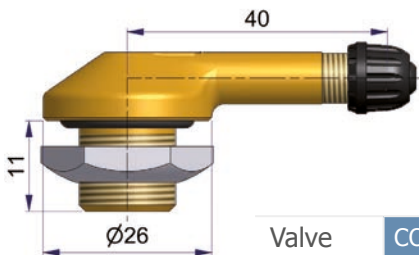

Valve CODE S8500

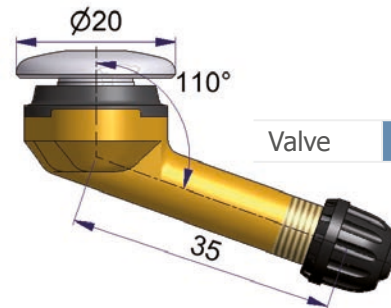

Valve CODE R2112

## Tyre Valve Extensions and Fittings

### Flexible Rubber Extensions



#### Overall Length

140mm	CODE	FLEX140
160mm	CODE	FLEX160
180mm	CODE	FLEX180
210mm	CODE	FLEX210



Other sizes available on request

### Flexible Rubber Extensions - Stainless Steel Braided

#### Overall Length

125mm	CODE	FLEX125S
180mm	CODE	FLEX180S
210mm	CODE	FLEX210S

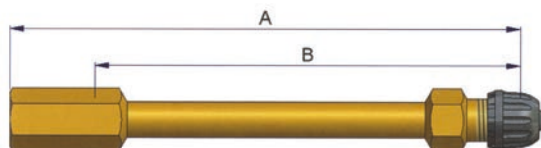

Other sizes available on request

### Rigid Metal Extensions

Overall Length A	Effective Length B	CODE
86.5mm	78mm	RE80
100mm	93mm	RE100
140.7mm	127mm	S4134

### Rigid Plastic Extensions

Overall Length A	Effective Length B	CODE
61mm	53.5mm	42563
71mm	53.5mm	S8023
111mm	97.5mm	S8024
140mm	132.5mm	42564
150mm	132.5mm	S8025
170mm	152.5mm	S8026
180mm	161mm	S8027

## Agricultural & Plant Tyre Valves

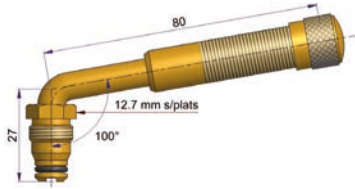

J650 EM valve **CODE** 26-191



TRSP2 valve spud for J650 **CODE** 26-120

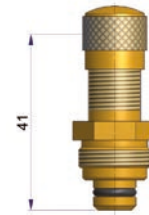

TRJ670 valve **CODE** R0979



Large valve cores **CODE** 25-500



Air water clamp in valve TR618-A **CODE** V3107



Air water, rubber based tractor valves

80mm diam base **CODE** TR218A/80  
110mm diam base **CODE** TR218A/110



Basic air-water tyre filling tool **CODE** 30717



Air water snap in valve **CODE** S42176



Replacement core housing for TR218A and TR618A **CODE** S2066



A/W valve Rim Nuts

Brass rim nuts **CODE** S2074A  
Plastic rim nuts **CODE** R1225

## Tread Depth Gauges



PCL Tread Depth Gauge **CODE** TDG16C01

Calibrated 1 - 26mm in 1mm graduations, and with a 1.6mm mark

Complies with EC directive 89/459/EEC

VOSA approved

Schrader Dial Face Tread Depth Gauge **CODE** 33640

Calibrated 0 - 10mm in 1/10th of a mm graduations for precise measurements and with a 1.6mm red band

Complies with EC 89/499 standards

Robust steel case

Supplied with a leather pouch



## Tyre Valve Accessories



Valve core tool - long **CODE** S1701



Valve core tool **CODE** S1701



Double-ended core tool – standard & EM **CODE** S1703



EM valve adapter that either screws into the EM valve internal thread or the outside thread reducing the size for pressure checking and tyre inflation with standard gauges.



Thread Type **CODE** 25-503  
Cap Type **CODE** BT 5526



(bx 100) Valve cores **CODE** TR-C1

Standard valve cores  
Red Seal type also available



Key top metal caps **CODE** S2021



Valve fishing tool **CODE** 27-112



4 way valve tool **CODE** 30713



(bx 100) "Dome" metal cap **CODE** S2027



(bx 100) Hex caps available in colours Yellow, Chrome, Red, Green & Blue **CODE** S6500



(bx 100) Plastic dust cap **CODE** S2023

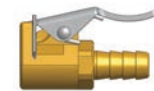

Single clip-on connector (6mm) **CODE** R0985



Single clip-on connector (8mm) **CODE** 41291



Large Bore clip-on connector **CODE** R0984

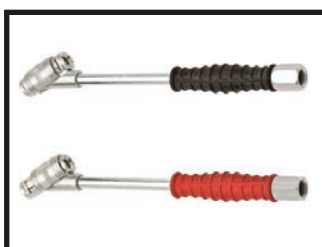

Twin clip-on connector - open end: black rubber handle

**CODE** PCL-C03A03

Twin clip-on connector - closed end: red rubber handle

**CODE** PCL-C03B03



Sliding sleeve lock on chuck for EM large bore valves with 1/4" female thread for hose connection

**CODE** 27-273



Sliding sleeve lock on chuck for std bore valves with 1/4" female thread for hose connection

**CODE** S5265



**CODE** TI-00003

Designed for the safe installation and removal of tyre valve cores during the inflation of commercial vehicle tyres. Vastly reduces inflation/deflation time of commercial vehicle tyres by allowing the operator to remove the valve core safely during the process. Eliminates the risk of serious injuries from "flying" valve cores.

Will deflate a 385/65 x 22.5 tyre in 4.5 mins with 9-bar pressure. This unit comes complete with a silencer, reducing the decibel level from 104 dB(a) to 73 dB(a).



**CODE** GT10-6

The Gaither Click & Go Valve Core Tool mechanically locks the valve core in place so that the valve core doesn't get blown across the shop when deflating a tyre and makes it much easier to install a core into a new stem/wheel assembly. There is no magnet so there is no chance of it interfering with TPMS.

## Air Connector

The new and improved air connector replaces PCL's CO2 single clip on connector.

After 40 years of fantastic service PCL will say good bye to the most robust reliable CO2 single clip on connector in their range.

The new and improved Air Connector has been designed to enhance and bring the PCL connector range into the 21st century. Through extensive in-house and external testing, the new Air Connector has been proven to be as robust and reliable as ever.

Alloy/steel wheels have got bigger with intricate designs making the valves more difficult to reach with the human hand. The new range now consists of standard straight as well as 90-degree connectors for those difficult to reach valves, with both hose tail fitting and female threaded versions available.

Manufactured using the finest zinc alloy, aluminium and brass, the Air Connector boasts a vice like grip and easy operation with a simple but effective thumb push button which quickly releases the tyre valve, reducing non-value added time.



### Features and benefits

- Once the PCL Air Connector is on, it stays on! - Does not bleed air
- Simple but effective thumb push button - quickly releases the tyre valve, reducing non-value added time
- Simply turn clockwise to achieve even more grip
- Undergone extensive in house and external testing - Highly reliable
- This open end connector is suitable for use with the MK4 Tyre Inflator, PCL wall gauges and PCL portable gauges
- Suitable for use in garages, workshops and tyre shops

Part Number	Description	Thread type
CH2K01	Straight single clip-on connector	For 7.9mm / 5/16" bore hose
CH2H01	Straight single clip-on connector	For 6.35mm/ 1/4" bore hose
CH2A01	Straight single clip-on connector	Rp 1/4 Inlet
CH4K01	Angled single clip-on connector	For 7.9mm / 5/16" bore hose
CH4H01	Angled single clip-on connector	For 6.35mm/ 1/4" bore hose
CH4A01	Angled single clip-on connector	Rp 1/4 Inlet



## Other Accessories



### Valvecapper® Pro

CODE 29999



4 Tools In One - Cap and Core Remover/Installer

Designed by a trucker to make a difficult job easier

No more dropped caps - holds onto caps and valve cores for removing and replacing

Longer valve cap grip works on flow-through, double seal valve caps

At 11 ¾", it has enough reach to get the job done

Designed for use on metal and plastic valve caps

### T68 Wheel Cover Puller / Replacer

CODE 31568

Length: 14" (36cm)

Removes wheel covers quickly and easily without gouging or scratching them.



### Professional Lug Nut Cover Remover

CODE 30606



Special coating will not scratch or damage chrome, painted or coated lug nut covers

Adjusts to fit larger lug nuts

### Heavy-Duty Cap Nut Wrench

CODE 30619

Length: 41mm

Heavy-duty design will not slip out of position

Wrench rests snugly against the centre hole, reducing the possibility of rim damage

Ideal for aluminium wheels



## Car/Van Valves, Weights & Accessories



A	CODE	
25mm	TR412	
34mm	TR413	
40mm	TR414	
35mm	TR415	
53mm	TR418	



High pressure valve **CODE** TR600HP



Valve puller inserting tool **CODE** 65027

## Wheel Weight Tools



Wheel Weight Plier **CODE** 35354

B230 - Professional Wheel Weight Tool

Weight: 1lb (.5kg)

Clip-claw crowbar, punch-designed handles and heavy hammerhead provide years of use

Automotive Wheel Weight Hammer **CODE** 35361

Length: 11" (28cm) Weight: 1lb (.5kg)

Features anti-marring replaceable hammer face that is safe for use on steel, aluminium and chrome

Replaceable chromoly steel hook removes all clip-on wheel weights - lead, zinc and steel



## Car Clip-On Wheel Weights

Size	Box QTY	CODE	Steel	Alloy
5g	100	015G	015G	015GA
10g	100	0110G	0110G	0110GA
15g	100	0115G	0115G	0115GA
20g	100	0120G	0120G	0120GA
25g	100	0125G	0125G	0125GA
30g	100	0130G	0130G	0130GA
35g	50	0135G	0135G	0135GA
40g	50	0140G	0140G	0140GA
45g	50	0145G	0145G	0145GA
50g	50	0150G	0150G	0150GA



**TRAX**  
balance weight technology



## reCore® Sensor Saver Starter Kits

Now you can repair TPMS sensors without even taking the tyres off the vehicle.

Most TPMS sensor failures are caused by galvanic corrosion of the valve core and stem. This sounds like an easy fix - but, until now, service technicians could not, in most cases, replace the valve stem without replacing the entire sensor module, rebalancing the wheel and resetting the TPMS sensor. Proven reliable in thousands of miles of real world, all-season testing, the Ken-Tool reCore® Sensor Saver System changes all that. The kit provides everything you need to drill out the corroded valve core, tap new threads and install a new, corrosion-proof valve core and stem. No need to have the TPMS computer relearn the module. No need to even remove the tyre or wheel from the vehicle! With a little skill, a technician can install a new valve stem in 10-15 minutes.

### reCore® TPMS Sensor Saver System

CODE 29980

Ken-Tool's Patented reCore® Starter Kit includes everything you need to service your TPMS sensor replacement.

The kit includes:

- 12 x TPMS Sensor Savers
- TPMS Valve Core Torque Tool (preset at 4-in-lbs)
- High speed dual cutter countersink drill bit
- Tap
- Tap holder with T-handle
- Bottle of Ken-Lok thread sealant
- Complete with easy-to-follow instructions in a blow-moulded plastic storage case.



### reCore® TPMS Sensor Saver Refill Kit

CODE 29981



Ken-Tool's patented reCore® Refill Kit includes 25 TPMS sensor savers plus a fresh tap (29984).

### DIY reCore® TPMS Valve Stem Repair Kit

CODE 29975



This kit includes two repair stems, a custom stepped drill bit, a tap, a tap holder, a valve core torque tool and a 2ml tube of thread locker.

## Notes

## Notes

## Notes

## Notes



**The Tyre Equipment Company**  
**Gonerby Hill Foot,**  
**Grantham,**  
**NG31 8HE**

**Telephone: +44 (0)1905 821697 / +44 (0)1476 513801**

**Email: [sales@tyre-equipment.co.uk](mailto:sales@tyre-equipment.co.uk)**

**[www.tyre-equipment.co.uk](http://www.tyre-equipment.co.uk)**

