



<https://polydevs3d.com>



# PolyDevs

Professional Data Preparation  
Software for 3D Printing

Polydevs takes data preparation software for Additive Manufacturing to a new level of performance based cost effectiveness.

Prepare your 3D CAD model with an intuitive user interface, user-friendly workflow, and easy operation. Polydevs powerful functionality speeds up your model preparation for printing with superior quality, efficiency and reliability.

**UnionTech**  
Create your Imagination

**Shanghai Union Technology Corporation**  
Room 102, Unit 40, 258 Xinzhuang Rd, Shanghai, 201612, China  
[enquiry@uniontech3d.cn](mailto:enquiry@uniontech3d.cn)  
Visit us online at [www.uniontech3d.com](http://www.uniontech3d.com)

**Union Tech, Inc.**  
100 Illinois St., Suite 200, St. Charles, Illinois, 60177, USA  
[info@uniontech3d.com](mailto:info@uniontech3d.com)

**UnionTech GmbH**  
Friedrich-Ebert Anlage 36, Frankfurt, Hessen, 60325, Germany  
[info@uniontech3d.com](mailto:info@uniontech3d.com)

**UnionTech**  
Create your imagination



### File Repair

Create water-tight data for 3D printing: identify part errors, and repair files automatically, semi-automatically or manually.

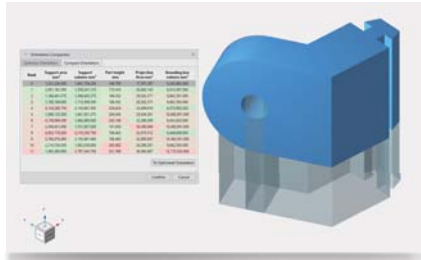

### Orientation

Find the optimal orientation to automatically place parts for your build based upon spacing, volume, base area, print time, support area, support volume and bounding box volume.

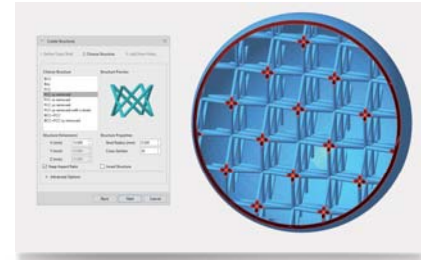

### Lattice Structure

Hollow a part and fill it with a lightweight structure, then add holes to remove the excess powder/resin, help you reduce the weight and material usage in your designs.

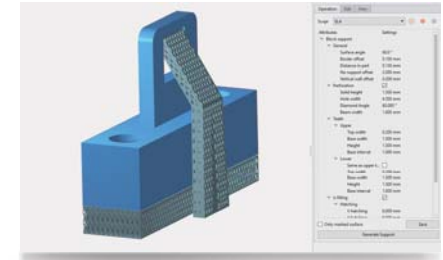

### Support Generation

Easily identify critical support areas, reduce data preparation time with semi-automatic support generation, and create proper support structures for different types of geometry.

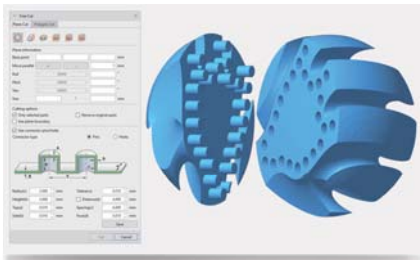

### Free Cut

Cut with advanced cutting lines: define the cutting directions by 3 points plane, tangent plane, vertical plane, XY plane, XZ plane, YZ plane, polygon, circle, rectangle and section.

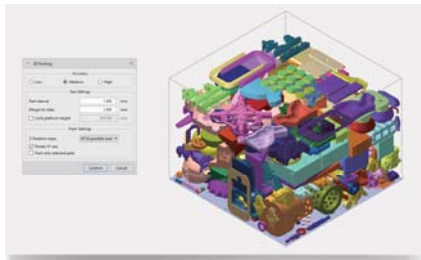

### 3D Packing

Nest parts automatically and quickly for your platform, control the height and density, avoid interlocking and colliding parts, protect small and fragile parts.

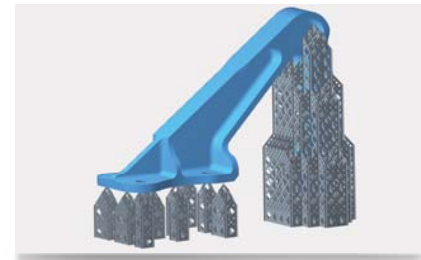

### Smart Support

Automated support generation, needle-thin contact points to make support removal easier and leading to a better surface quality for your part, reduce time and materials consumption.

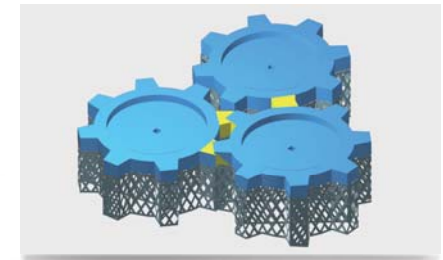

### Collision Detection

Check for collision between intersecting triangles or with an indicated clearance between different parts.

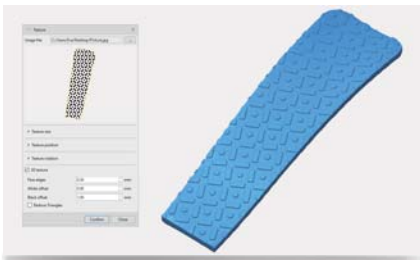

### Texture

Easily add 2D or 3D textures on marked areas, and edit for texture size, position and rotation, or change texture image to suit your needs.

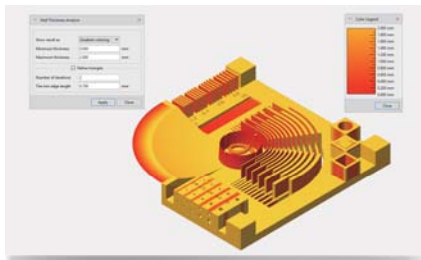

### Wall Thickness Analysis

Predict where problems can occur during building and ensure all features of the part are of adequate thickness: detect small details, thin/thick walls.

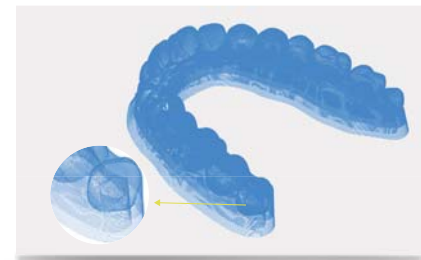

### Slice

Slice parts with any layer size, and you can set different layer size in different area of parts for adaptive slicing, and visualize the contours of each slice conveniently.

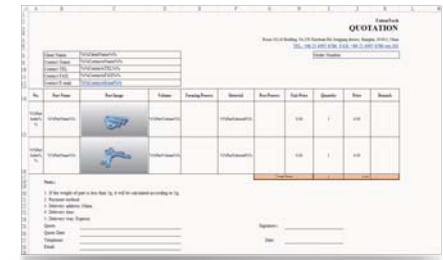

### Quotation

Create templates related your company with Excel, and easily embed parameters of parts, customize materials and costing parameters to generate instant quotes.