



b-MOLA空氣處理系統 使用說明書

型號: NCCO1802

目錄

安全注意事項	2-4
NCCO技術	5
主要部件名稱	6
<hr/>	
使用入門	7-10
• 初次使用	7
• 使用說明	7-10
<hr/>	
維護保養	11-12
• 清潔方法	11
• 更換濾網	12
<hr/>	
常見問題	13
疑難排解	14
產品規格	15

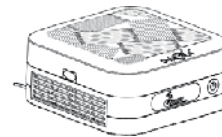

附保修證

感謝您選用b-MOLA空氣淨化器。
使用和維護本產品前，請仔細閱讀本使用說明書。
使用本產品前請務必仔細閱讀「安全注意事項」。
不遵照說明書使用本產品有可能導致受傷或財產受損。
請妥善保管此說明書以供日後參考。
請妥善保管保修證以供日後維修之用。



安全注意事項

請務必遵守

- 八歲或以上兒童，有身體缺陷，感官或精神問題，或者缺乏知識經驗的人在獲得有關安全使用本裝置的監督/指導，並清楚所涉及之危害情況下可以使用本裝置；兒童不得玩要該裝置。兒童不得在沒有監督/指導的情況下進行清洗和維護設備的相關工作。
- 如果電源線損壞，必須由製造商或有資質的服務機構進行更換，以免出現危險。
- 進行清潔和保養前，必須切斷本產品的電源。

為了避免對您或其他人造成傷害或財物損害，請務必遵守安全注意事項。

- 以下標誌是根據錯誤使用所產生的危險或受傷程度進行分類。



警告 本標誌所表示的內容為“不遵守的話可能造成人員死亡或重傷”。



注意 本標誌所表示的內容為“不遵守的話可能造成人身輕傷或財物損害”。

- 以下標誌為務必遵守的指示種類。（下列標誌為例子）



此標誌表示禁止事項。



此標誌表示強制事項。



警告



- 移動或存放時禁止拉扯電源線。
(否則電源線可能會損壞，導致火災或觸電)
- 禁止損壞電源線或電源插頭，禁止切割、改裝、過度扭曲、摺咬、擠壓電源線，禁止電源線靠近熱源或在電源線上放置重物等。
(否則電源線可能會損壞，導致火災或觸電)

- 禁止使用額定電壓 (DCSV 2A) 以外的電源。
(否則電源線可能會過熱，導致火災)

- 禁止將手指或金屬物等異物放入進風口、出風口或縫隙中。
(否則可能會接觸到產品內部，導致觸電或受傷)

- 禁止用濕手接觸電源插頭。
(否則可能會導致觸電)



- 禁止弄濕機體，禁止在機體上放置水杯等。
(否則產品可能會短路，導致火災或觸電)



- 禁止將小部件放置在嬰幼兒可觸及到的地方。
(馬一吞食請速醫治)

- 禁止將產品內置電池投入火中及加熱、分解、改造。
(如損壞了絕緣物或排氣閥等，電池可能會發熱、破裂導致受傷)



- 當有以下任何情況出現時，請立即停止使用本產品並拔出電源插頭。
(否則可能會導致觸電、起火或冒煙)
< 以下為異常故障的例子 >
 - 移動電源線時，產品連轉停止；
 - 如果任何控制按鈕故障；
 - 如果斷路器起作用或保險絲燒毀；
 - 如果電源線或電源插頭異常發熱；
 - 如果您發覺有奇怪的異味或異常的聲音或振動；
 - 如果有其他任何異常現象或故障。一應立即停止運轉，拔出電源插頭，聯繫客戶諮詢服務中心或經銷商進行檢查、維修。

- 請定期清潔電源插頭。
(如果電源插頭上有灰塵、濕氣，可能會破壞電源插頭的絕緣部分，導致火災)
 - 拔出電源插頭，用乾布擦淨。
 - 長期不使用產品時，應拔出電源插頭。

- 維護保養產品前，請務必拔出電源插頭。
(否則產品可能會突然運轉，導致觸電或受傷)

- 請將電源插頭完全插入電源插座。
(如果電源插頭沒有完全插牢，可能會使電源線過熱引起火災或觸電)
 - 禁止使用已損壞的電源插頭或鬆動的電源插座。



- 禁止擅自拆卸或改裝本產品。
(否則產品可能會異常動作或起火，引起火災或觸電)
 - 一需要維修時請聯繫客戶諮詢服務中心或經銷商。

安全注意事項

請務必遵守



注意



- 禁止放置本產品於以下場所。
(否則產品可能會翻倒，導致受傷或產品損壞)
 - 不平穩的場所。(否則產品可能會翻倒，導致受傷或產品損壞)
 - 浴室等高溫、高濕或會弄濕產品的場所。
(否則產品可能會漏電，導致火災或觸電)
 - 廚房等排放油煙的場所。
(否則產品可能會破裂，導致受傷)
 - 油或可燃性氣體可能出現洩漏的場所。
(否則吸入產品內可能會起火，導致火災)
 - 風口正對動植物的場所。
(否則可能會導致動物不適、植物風乾)

禁止使用汽油或其他揮發性混合溶劑擦拭產品，以及把殺蟲劑噴到產品上。
(否則產品可能會破裂或短路，導致受傷、火災或觸電)

使用煙熏型殺蟲劑時，禁止運轉產品。
(否則產品內可能會積聚藥物，然後從出風口排出，危害身體健康)
一使用殺蟲劑後，應先讓房間徹底通風，然後才可運轉產品。

禁止在產品出風口處放置物品，如書本、衣物等。
(否則堵塞出風口，可能會導致冒煙、起火)

禁止坐、靠本產品。
(否則產品可能會翻倒，導致受傷或產品損壞，有小孩的家庭需多加注意)

禁止將點燃的香煙、香火等可燃物接近產品。
(否則易燃物可能會被吸入產品內導致起火，引起火災)



請手持插頭部位拔出電源插頭。
(否則電源線可能會損壞，導致火災或觸電) 與熱燒器具一起使用時，需保持空氣流通。

設置與使用要求

請務必遵守

禁止事項：

■ 嚴禁拆裝產品。

電池內部具有保護機構和保護電路，可以避免發生危險。不合適的拆裝會損壞保護功能，造成電池發熱、冒煙、變形或燃燒。

■ 嚴禁加熱和焚燒電池。

加熱和焚燒電池將會造成電池隔離物的熔化，安全功能喪失或電解質燃燒。過熱就會使電池發熱、冒煙、變形或燃燒。

■ 禁止弄濕產品。

本產品帶有電池，請勿弄濕產品，更不能將產品投入水中，否則會造成電池內部保護電路和功能喪失及發生不正常的化學反應，亦可能會導致電池發熱、冒煙、變形或燃燒。

■ 避免在火源附近或陽光直射下充電或使用產品。

切勿在火源、烤爐附近或過高溫度的環境中充電或使用產品。過熱將會導致產品功能喪失、電池內部短路和發生不正常的化學反應，電池有可能發熱、冒煙、變形或燃燒。

產品內置鋰電池安全事項說明

注意事項:

1. 在第一次使用產品時,若發現產品內置電池有異味等不正常現象,請勿繼續使用產品,應及時聯繫銷售商更換產品。
2. 在使用產品過程中,應遠離熱源、高壓,避免兒童玩弄摔跌產品。
3. 避免產品在劇烈搖晃環境中使用。
4. 避免在強光曝曬環境下存放或使用產品,以免發熱、變形、冒煙、降低電池壽命。
5. 避免在會產生靜電的環境使用產品,以免電池工作不正常:發熱、變形、冒煙、降低電池壽命。
6. 請使用專用充電器和推薦的充電方式給電池充電。
7. 勿將產品正負極短路,切勿自己拆裝產品及電池,也勿讓產品放在受潮處,以免發生危險。
8. 長期不用時,請將產品儲存完好,讓電池處於半荷電狀態,將產品保存於陰涼乾燥處。
9. 切勿將產品投入火中或水中。

在以下這些場所使用非常有效!

■ 針對室內揚塵。

由於灰塵容易落到地板附近,建議將本產品放在房間中的平坦的地方。

■ 使用開關的空氣有效循環。

請將本產品設置在其右上方距離牆壁、傢俱、窗簾等約15cm以上的場所,否則污染物難以被吸入機體。

■ 請勿設置本產品於以下場所。

- 陽光直射、被空調吹到或受熱等場所
(否則可能會造成變形、老化、變色)
- 電視機及收音機等物體附近
(否則可能會導致影像紊亂以及雜音)
→ 距離 1 m 以上設置。

■ 在同一場所長時間使用時。

產品周圍的牆壁及地板會發熱,進行產品維護保養時,建議改變設置場所。

■ 請勿與電視機、收音機等設備使用同一電源插座。

(電源插頭插入時有可能會產生影像紊亂以及雜音)
→請將電源插頭插到與其他電源插座上。

■ 請勿在產品上放置物品。

(否則可能會導致操作或產品故障)

■ 請勿在產品進風口和出風口處放置障礙物。

(否則可能會影響產品性能)

獨有NCCO氧聚解專利技術, 給您帶來清新潔淨的空氣

NCCO (Nano Confined Catalytic Oxidation) 納米氧聚解空氣處理技術, 是與香港科技大學創業計畫成員合作研發, 並且獲得全球多國專利, 可以全方位解決室內空氣質量問題, 打造空氣清新的家居及辦公環境, 保障您及您家人的健康。



關於NCCO (氧聚解空氣處理技術)

- NCCO(Nano Confined Catalytic Oxidation)專利技術,即氧聚解空氣處理技術。
- NCCO 技術的原理是: 高效吸附污染物,把污染物變成水(H₂O)及二氧化碳(CO₂)。
- NCCO 特點: 使用壽命長,無二次污染,除菌除醛,高效除臭等。
 1. 使用壽命長(以活性炭吸附為例,它的使用壽命只有3個月左右,而 NCCO 壽命則是它們的數十倍)
 2. 杜絕二次污染(其他濾芯吸附飽和後,被吸附的污染物將被釋放回空氣中,造成二次污染。)
 3. 除菌除醛(該項技術可以有效分解化學污染物,包括甲醛和其他有害污染物,與此同時該淨化系統可以隔離固體懸浮粒子、重金屬微粒、有毒微生物等)
 4. 高效除臭(NCCO 核心技术能清除臭味,例如處理公廁、地鐵洗手間、垃圾堆填區等持續釋放強烈臭味的環境)
- NCCO 專利技術由香港科技大學創業計畫成員研發。

關於智能斷電保護

b-MOLA空氣處理系統自帶智能斷電保護系統,當接通外置電源時,機器8小時智能斷電,30分鐘後自動重啟;當使用內置電源時,機器2小時智能斷電,10分鐘後自動重啟。智能斷電能有效避免機器過熱過度負荷,消除用電安全隱患。

主要部件名稱

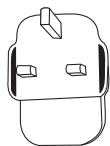
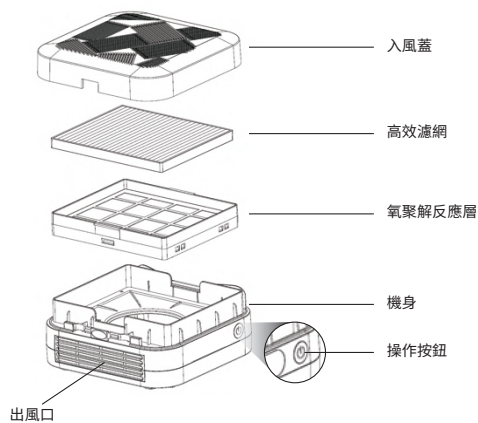

電源適配器



USB電源線



螺絲刀



織帶

使用入門

初次使用

1 拆除包裝盒，從包裝袋中取出濾網組合。

① 撕開包裝袋，取出高效濾網和氧聚解反應層。



⚠ 配件嚴禁清洗、浸入水中或用水沾濕，否則會損壞配件導致失效。

② 拿出機器，按住側面的卡扣，將機器入風蓋掀開。

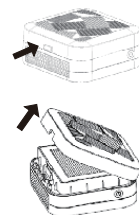

③ 將濾網組合安裝到機身中，請留意：白色面高效濾網應朝上。

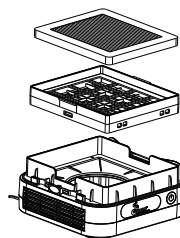

④ 將機器頂蓋上的卡扣對準機身扣緊，再蓋好頂蓋。聽到“噠”的一聲，說明入風蓋安裝正確。



使用入門

接通電源

2 接通電源

以下三種方法，都可以接通電源：

- ① 直接按機身側面的開機鍵，機器會使用內置鋰電池的電源運行。
- ② 拿出機器配置的USB電源線，接入USB供電電源，即可使用外部電源為機器供電。



- ③ 將電源線的USB接頭連接車內USB供電口，即可使用汽車電源為機器供電。



注意事項

- 若濾網組合沒有裝入機器內，機器會發出“嗚嗚嗚”的報警聲，請確保濾網組合被正確放置。
- 初次使用時，因氧聚解反應層特殊的製造工藝會有輕微的礦物味道，這是正常現象，對人體無害，使用一段時間後味道會消失。
- 該產品的輸入功率為DC5V 2A，請確保正確的電源供應。
- 在車內安裝使用前，請先確保中斷電源供應，小心提起產品。

使用入門

車內使用

3 車內使用步驟

- ① 鬆開機身底部的織帶固定蓋螺絲，將織帶按圖示放於兩個方孔上，蓋回織帶固定，再擰緊螺絲固定織帶。
- ② 將電源線DC連接端插入產品DC插孔內。

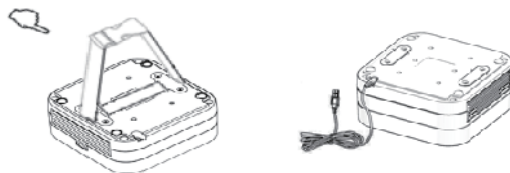

- ③ 將穿好織帶的產品懸掛在車枕後方位。
- ④ 可調節扣位活動端一邊的織帶，根據車枕位寬度調整織帶鬆緊度，安裝完畢。



注意事項

- 若在移動場景中使用本產品，請務必確保產品已經安全牢固地固定住，不會出現晃動或者脫離的情況。
- 若在車內使用請遵守相關法律法規，不能將本產品放置在法律法規不允許放置的位置。例如：車內中控台。
- 該產品的輸入功率為DC5V 2A，請確保正確的電源供應。

使用方法

開 / 關

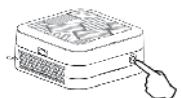

按下操作按鈕產品開始運轉，風量為低速風量，操作按鈕顯示為弱白色燈光。

在產品運行時，按一次操作按鈕，風量變為高速風量，操作按鈕顯示為藍色燈光。

再次按下此按鈕，產品停止運轉。

燈光

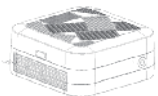

以下為不同燈光閃爍時所表示的情況：

風速	慢閃	快閃
藍燈	高 運行，充電	電量低
白燈	低 運行，充電	電量低

■ 當燈光白色和藍色交替閃爍時，表示設備處於關機狀態並處於為內置電池充電狀態。

記憶功能

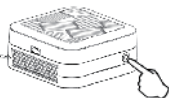

當外接電源停止供電時機器會自動轉換使用內置電池工作模式。當電池電量耗盡停機的時候，機器會自動記憶斷電時的模式，重新連接外部電源時，會繼續保持斷電前的工作狀態。

維護保養

警告



維護保養產品前（除進行過濾器更換操作外），請務必拔出電源插頭。

（否則產品可能會突然運轉，導致觸電或受傷。）

提示事項

- 禁止使用洗滌劑來清潔。
- 使用經過化學處理的抹布時，請務必按說明操作。
- 進行維護時，請勿隨意碰放拆卸的部件。（否則可能會絆倒行人或造成部件損壞）
- 濾網未安裝時，請勿運轉本產品。（否則將會對氧聚解反應層造成不可逆的損壞）
- 如果沒有定期更換高效濾網，會導致氧聚解反應層處理效率嚴重降低。

清潔方法

1 清潔外部機身



請先將入風蓋與機身分離後，方可用水沖洗入風蓋（僅入風蓋用水沖洗），再用柔軟的乾布擦拭機身，以免將灰塵落入機體內。

提示事項

切記：沖洗完入風蓋後，需用乾布把入風蓋完全擦乾才能蓋回。
小貼士：可以用濕布來清潔產品表面，但請勿使用帶有磨料的材質。

2 清潔進風口和出風口

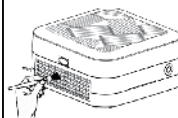

用柔軟的毛刷或真空吸塵器清潔進風口和出風口。

提示事項

警告：不可用水清洗高效濾網和氧聚解反應層，也不可將它們浸泡在水中。

長期閒置時

- ① 停止運轉產品，並拔出電源插頭。
- ② 需進行維護保養。
- ③ 放入塑膠袋和紙箱中，並存放於乾燥處。

維護保養

濾網的護理和更換

1. 根據環境、使用方式和設備所處位置的不同，濾網的壽命也各不相同。
2. 如需讓設備維持最佳狀態，建議使用推薦的濾網。
3. 在更換濾網時，請保持機器關機狀態，但請勿斷開機器與電源的连接。
4. 當氧聚解反應層需要更換，高效濾網可根據下表的濾網顏色變化更換指標進行操作。

濾網/濾芯的清潔和更換週期建議		
濾網/濾芯	週期時長	方法
高效濾網	每 6 - 12 個月 *	更換
氧聚解反應層	可長效使用 **	可持續使用

* 濾網更換週期可能會因運行環境的不同而有變化。

** 如高效濾網沒有定期更換或受損，拆開見到氧聚解反應層表面有灰塵/油性物質遮蓋或污染，可能會減低效用從而導致需要更換氧聚解反應層。

高效濾網表面顏色變化更換指標		
不需要更換	建議更換	需要更換

常見問題

Q1 設備發出“滴滴滴”聲響及不運作。

A 請重新檢查濾網組件是否安裝正確，並重新安裝濾網組件。

Q2 高效濾網是否可以清洗？

A 高效濾網為複合材料製成，水洗後會嚴重影響淨化效果。

Q3 在長時間運行後，空氣質量仍然沒有改善。

A 當在一個污染較重的地方使用本產品時，空氣質量的改善需要較長時間。可使用更高一級的性能設置或在必要情況下讓設備運行更長的時間。

Q4 設備散發出異常氣味或煙霧（例如：煙霧、火苗或燃燒）。

A 請立即關閉設備切斷電源，並立即致電客服中心或聯繫有資質的服務機構處理。

疑難排解

故障描述	解決方法
設備不工作	查看設備是否已經接通電源。 (接通電源的三種方法見第8頁) 啟動設備。
設備發出“嗡嗡”聲響及不運作。	檢查濾網是否安裝正確。 重新安裝濾網。
出風口沒有排風	查看設備是否已經接通電源。 啟動設備。
在長時間運行後，空氣質量 仍然沒有改善	當在一個污染較重的地方使用本產品時，空氣質量的改善需要較長時間。可使用更高一級的風速檔位，或在必要的情況下讓設備運行更長時間。
	可能需要清潔或更換濾網。 清潔、更換濾網。
出風口的氣流速度減慢	除塵濾網可能被阻塞。 更換除塵濾網。 (安裝除塵濾網的方法見第7頁)
	確認所有的包裝材料都被拆卸。
設備發出異常噪音	確認所有的包裝材料都被拆卸。
	確保出風口和進風口沒有被異物阻塞。
	設備可能出現故障。 致電客服中心尋求建議或諮詢有授權的服務機構。
設備散發出異常氣味或煙霧 (例如：煙、火苗或燃燒)	關閉設備、切斷電源。 立刻致電客服中心或聯繫有授權的供應商。

產品規格

供電電源		DC5V 2A	
耗電量 (W)	模式	低速	1.3
		高速	2.5
風量 (m ³ /hr)	模式	低速	12
		高速	25
噪音水平 (dB)	平均聲壓級		34 dB-38 dB
	聲功率級		40.6 dB-44.9 dB
產品尺寸 (長×寬×高) (mm)		160 (L) x 160 (W) x 73 (H)	
淨重 (kg)		0.85	
處理系統		活氧產生器	殺菌消毒
		高效濾網	去除灰塵、毛髮和漂浮在空氣中的 比如過敏源、花粉、細菌、病毒和 真菌。
		氧聚解反應層	去除異味，將諸如甲醛和VOC 等有害污染物分解、氧化。



b-MOLA NCCO Air Treatment Unit Operation Manual

Model No.: NCCO1802

CONTENT

Confirmation & Setup	2-9
• Safety Instructions	2-3
• Setting & Operation Requirement	3-4
• NCCO Technology	5
• Parts & Components	6
• Setup	7-9
Operation Method	10
Maintenance & Care	11-12
Other Information	13-15
• FAQ	13
• Trouble Shooting	14
• Product Specification	15

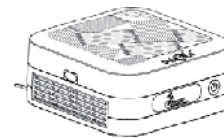

Thank you for choosing b-MOLA product;
Please read this manual prior to operation and maintenance work;
Please read the "Safety Instructions" before operation. (Page 2~3);
Injury or property loss may occur if not operated according to this manual;
Please retain this manual for future reference. (Retain manual in reserve);



Safety Instructions

Please Follow Instructions Below

- This appliance can be used by children aged from 8 years and above and persons with reduced physical, sensory or mental capabilities or lack of experience and knowledge if they have been given supervision or instruction concerning use of the appliance in a safe way and understand the hazards involved. Children shall not play with the appliance. Cleaning and user maintenance shall not be made by children without supervision.
- If the supply cord is damaged, it must be replaced by the manufacturer, its service agent or similarly qualified persons in order to avoid a hazard.
- Prior to cleaning or maintenance, the appliance must be disconnected from the supply mains.

In order to avoid injury of operatives or others, please follow safety instructions.

- The following symbols are classified based on the hazard level or injury effects caused by improper use or operation.

 **WARNING**
This symbol means 'May cause fatalities or serious injury if instructions are not followed'.

 **ATTENTION**
This symbol means 'May cause minor injury or damage to property if instructions are not followed correctly'.

- The two symbols below refer to the relevant instructions that need to be followed.

 **Prohibited Item**

 **Mandatory Item**

 **WARNING**

- Removal of the power cord is prohibited when moving or storing the unit. The power cord might otherwise be damaged leading to a potential fire risk or electric shocks.
- It is prohibited to damage the power cord or power plug. It is prohibited to cut, refit, excessively twist, 'wing' or squeeze the power cord.
- It is prohibited to put the power cord near a heat source or place under a heavy object.
(Otherwise this could lead to a fire or an electric shock.)
- It is prohibited to use no other power source other than a voltage of DC5V and 2 amps.
(Otherwise this could cause overheating leading to a possible fire.)
- It is prohibited to place one's finger/thumb, any metal object or anything else into the air inlet, air outlet or any gap.
(Otherwise the user might touch an internal component, leading to an electric shock or personal injury.)
- It is prohibited to touch the power plug or any electrical component with a wet hand.
(Otherwise the user may suffer an electric shock.) 
- It is prohibited to wet the body of the unit in anyway.
- It is prohibited to place any liquid receptacle (e.g. water bottle) on any part of the unit.
(Otherwise this might cause the unit to short circuit leading to a possible fire or electric shock.)
- It is prohibited to place small objects near any area of the unit where a child or infant might be liable to touch.
(Please avoid children of eating such objects. If such situation occurs, please go to hospital immediately.)
- It is prohibited to place the battery in the fire or near heat whilst refitting with a new battery. Please dispose of the battery in line with local safety disposal requirements. Damage to the battery outer insulation cover or release valve could cause personal injury.

- If one of the following abnormal or malfunctioning situations occurs, please immediately stop using the unit and pull the plug from its power source.
 - Unit stops running when moving the power cord.
 - Any control button fails.
 - If the circuit breaker moves or fuse burns up.
 - If the power cord or plug is abnormally warm or heated.
 - If there is a burnt smell, abnormal noise or vibration.
 - If there is anything deemed abnormal in the unit's function.
— Please contact your local service centre or distributor to check the malfunction.
- Please periodically clean the power plug. If there is any dust found on the plug in a humid environment, this could damage the insulator leading to a possible fire.
 - Pull out the power plug and clean it with a dry cloth.
 - If you do not intend to use the unit for a long period of time, please pull plug out of power source.
- Please pull out the power plug before any maintenance or cleaning work is undertaken.
(Otherwise the unit might start functioning unexpectedly causing an electrical shock or personal injury.)
- Please fully insert the plug into the power source. If not fully inserted, then power cord could become overheated causing a possible fire or an electric shock.
 - It is prohibited to use damaged power plug or loose power socket.
- It is prohibited to arbitrarily disassemble or refit the unit otherwise it might function abnormally, causing a fire or electric shock. If any maintenance work is required on the unit, please contact your local customer care centre or distributor.

Safety Instructions

Please Follow Instructions Below

 **ATTENTION**

- It is prohibited to place the unit in the following places.
 - An uneven place.
(Unit might fall causing injury or product damage.)
 - A bathroom, shower room or other places where there is high temperature, high humidity or where the unit could get wet.
(Otherwise the unit could suffer electrical leakage leading to a possible fire or impart an electric shock.)
 - A kitchen or similar places with cooking oil fumes.
(Otherwise unit may break up and cause personal injury.)
 - Locations where oil or other combustible gases might be leaking.
(Otherwise such an environment might cause the unit to catch fire, leading to a disaster.)
 - Places where the unit inlet/outlet is situated close to animal or plant resting areas.
(Otherwise the animal could feel discomfort and the plant might not develop properly.)
- It is prohibited to wipe the unit using gasoline or other volatile solvents, or to spray the unit with insecticide.
(Otherwise the unit casing might fracture, resulting in a short circuit.)
- It is prohibited to operate the unit when using insecticide smoke.
(Otherwise insecticide particles might accumulate inside the unit resulting in the exhaust draft from the air outlet possibly causing damage to health.)
— After using insecticide, the room should be ventilated thoroughly, before the unit can be operated.
- It is prohibited to place objects such as books or clothes near to or against the air outlet.
(Otherwise with a blocked outlet could cause smoke or even fire.)
- It is prohibited to sit or lean on the unit.
(Otherwise the unit might turnover or crack, causing personal injury or unit damage.)
* Families with children, please pay attention to the operation process.
- It is prohibited to light up a cigarette, cigar or burn incense near the unit.
(Otherwise, flammables may be sucked into the unit and cause fire.)

- Please pull the power plug by holding the correct part of the plug.
(The power cord might otherwise be damaged leading to a potential fire risk or electric shocks.) Maintain good indoor ventilation when operating unit together with combustor.

Setting & Operation Requirement

Prohibited Items

Prohibited Items:

- It is prohibited to disassemble the unit.
There are protection mechanisms and protection circuits inside the battery to protect the user. Any improper dismantling will damage the protection mechanisms and possibly cause the battery to get heated, generate smoke and fire.
- It is prohibited to heat or burn the battery.
This may cause the melting of the battery insulator with the loss of its safety function and burn the electrolyte within. High temperatures might cause the battery to overheat, distort the case and lead to smoke and possibly fire.
- It is prohibited to wet the unit.
The unit is insulated with an internal battery. Wetting the unit or placing it into water may cause the loss of functionality of the battery protective circuits. This could lead to an abnormal chemical reaction leading to possible heating of the battery, giving off smoke and start a fire.
- Please avoid charging or operating the unit near a source of fire or under direct strong sunlight.
Do not charge or operate the unit near the source of a fire or oven, or in an environment of excessive high temperatures. Overheating could ensue causing functionality loss, short circuit of the battery together with an abnormal chemical reaction. This could overheat the battery leading to smoke and possibly fire.

Setting & Operation Requirement

Matters That Need Attention

Lithium Battery Safety Instructions

Following Aspects Need Attention:

1. If one observes an undesirable odour from the installed battery, or from other areas within the unit on first-time operation, please do not operate and return to the distributor.
2. Please keep the unit away from an environment involving a heat source, a high barometric pressure or an increasing pressure on the surface of unit during its operation. Place the unit in a secure and safe operating location and away from children.
3. Avoid the unit being shaken in a serious vibrating environment.
4. Please avoid storing or operating the unit in a strong sunlit and hot environment. This will prevent the battery from overheating, becoming distorted, smoking or shortening its life.
5. Please avoid operating the unit in an environment which might conduct static electricity and induce the battery to overheat, distort, generate smoke or shorten its life.
6. Please only charge the battery with the dedicated charger and follow the recommended charging method.
7. Insert battery in correct polarities. It is prohibited to arbitrarily disassemble or refit unit and battery. For safety concern, do not place unit at a wet location.
8. To keep the battery at half-charged condition without any damage and place in the unit a cool dry location when stored for a long period of time.
9. Do not put unit into fire or water.

For highest efficiency of air filtration!

■ Removing indoor dust.

Place unit on a flat surface in an open area where dust falls easy.

■ Best air circulation location area.

Place unit at least 15cm (6") from a wall, furniture, curtains etc, otherwise its filtration efficiency will possibly be diminished.

■ Do not place the unit in the following places or areas.

- Direct sunlight, near air-conditioning unit air flow or heat. (This may cause distortion, colour change or reduced life.)
- Near television, radio etc. (This may cause television image disorder and radio noise.)
- Place unit at least 1m from such objects.

■ When operating unit in same location for a long period of time.

- Surrounding walls or floor could be dirty.
- When maintaining unit, please change the location.

■ Do not use the same power socket as one already used for television or radio.

(Television image disorder and radio noise may appear when power plug is inserted into socket.)
→ Please use alternative power sockets.

■ Do not place objects on the unit.

(This might affect the operation of the unit.)

■ Do not obstruct air inlet or outlet.

(This could reduce efficiency of air filtration by unit.)

NCCO Technology

Please Follow Instructions Below

Patented NCCO Air Purification Technology Brings You Fresh and Clean Air

Our patented NCCO (Nano Confined Catalytic Oxidation) technology used inside our b-MOLA NCCO Air Treatment Unit is able to effectively remove fine particulates, passive smoke, pollen, PM_{2.5}, bacteria, viruses and more. It brings you clean fresh air indoors when the outside air environment is polluted. The unit has safe operation of up to 8 hours (battery powered) under the control of its intelligent control of an automatic power-off and re-start function after 30 minutes of rest (See bottom of page for further info).



About NCCO (Nano Confined Catalytic Oxidation) Air Purification Technology

- NCCO Air Purification Technology has world-wide patents.
- The principle of NCCO technology is based on the efficient adsorption of pollutants through the use of active oxygen to break the chemical bonds of the pollutant molecule and then decomposing them to Carbon Dioxide and water molecules.
- Characteristics of the technology are - extremely long filter/Reactor life, no secondary pollution, sterilises and removes carcinogenic pollutants such as formaldehyde and effectively deodorises.
 1. **Long Life** – Take example of adsorption capacity of activated carbon, which has a lifetime of only about three months, on the contrary, NCCO product is available to sustainable use.
 2. **No Secondary Pollution** – For other types of filters, they will be saturated relatively quickly and thus release unabsorbed pollutants back into the air and is called secondary pollution. NCCO technology continuously decomposes pollutants into harmless Carbon Dioxide and water.
 3. **Sterilisation and Formaldehyde Removal** – NCCO technology can effectively decompose chemical pollutants including formaldehyde which is deemed to be carcinogenic. It also filters suspended particles, heavy metal particles, pollen, viruses and bacteria.
 4. **Efficient Deodorisation** – NCCO technology can completely remove offensive odours found in public washrooms and indoor environment near landfills.

NCCO IS AN INNOVATIVE TECHNOLOGY INVENTED BY MEMBER OF HKUST ENTREPRENEURSHIP PROGRAM.

About Intelligent Power-Off Protection

b-MOLA NCCO Air Treatment Unit is designed using an Intelligent Power-Off Protection System. The unit will intelligently power off after continuous use over a period of 8 hours and then will restart automatically after 30 minutes downtime once connected to an external power supply. The unit will use the intelligent system to power-off after continuous use of 2 hours, and then will restart automatically after 10 minutes of downtime when using its internal (battery) power supply. Our intelligent power-off system is able to effectively avoid excessive load and eliminate any risk during the supply of power.

Parts & Components

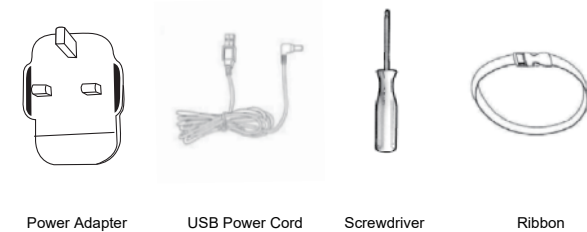
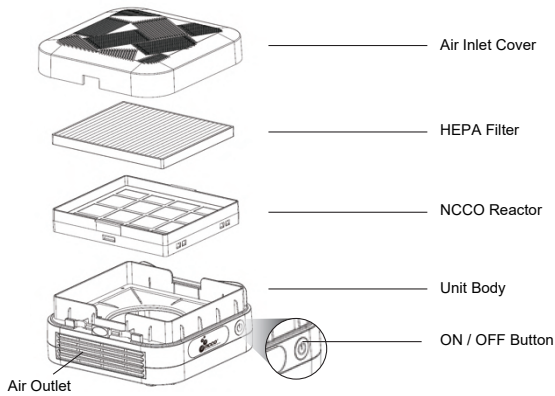

Setup

1. HEPA Filter and NCCO Reactor Installation

① Take out HEPA Filter and NCCO Reactor from protective packaging material.



Note

It is prohibited to clean, soak or wet any parts, or they could be damaged and so affect the unit operation.

② Take out the body of the filtration unit. Press the side clips to open the air inlet cover.

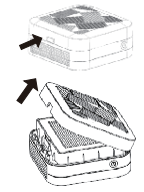

③ Install HEPA Filter and NCCO Reactor combination into the body of the unit.

N.B. HEPA Filter should face upwards.

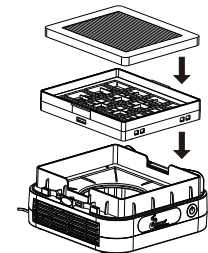

④ Firmly clip and re-fit the air inlet cover onto the main body of the unit. A 'clicking' sound should be heard indicating successful installation.

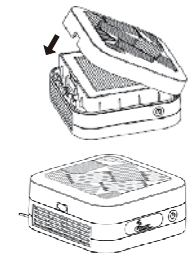

Setup

2. Power Supply Connection & Operation

One can connect to a power supply using the following methods:

- ① **Using internal battery** – Just press the ON/OFF Button and the unit will start using its rechargeable lithium battery.

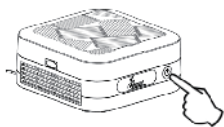

- ② **Using USB power cord** – Insert USB connector into supplied power plug and connect to appropriate socket. Insert pin end of plug into the power port of main unit. This is located underneath the unit.



- ③ **Using USB power source (car)** – Insert USB connector into car USB port which will use charging power from vehicle.

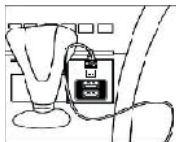

Note

- If filters should not be installed into the unit, a 'DiDiDi' alarm sound will be heard from the unit. Please ensure that HEPA Filter and NCCO Reactor are properly installed prior to switching the unit on.
- When first switched on there will be a slight mineral smell. This is perfectly normal and is due to special manufacturing technique of the NCCO Reactor. The smell is harmless and will disappear after a period of time operating the unit.
- Please check and ensure that the car power supply is correct. The power input of this unit is DC 5V 2A.
- Before operating unit in car, please make sure that the power supply has been disconnected and lift up unit carefully.

Setup

3. In-Car Operation Procedure

- ① Remove base plate from underneath unit. Remove 4 screws holding ribbon securing plates. Place and locate both free ends of ribbon and then screw back securing plates. Replace base plate.

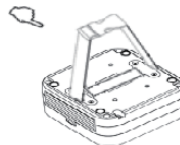

- ② Plug in DC power jack into power port in base of unit.



- ③ Position the unit at the back of car headrest using the securing ribbon.

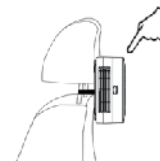

- ④ You can adjust ribbon tension by moving ribbon within the clip buckle.



(*Please ensure that ribbon has been tightened to prevent unit from wagging.)

Note

- If using the unit in a mobile environment, please ensure that the unit is firmly fixed so that it does not 'waggle' or loosen when in motion.
- If using the unit in a car, please follow the relevant country laws and regulations such as not placing free standing objects on the car centre console.
- Please check and ensure that the car power supply is correct. The power input of this unit is DC5V 2A.

Operation Method

ON/OFF Operation

To switch on unit

Press the ON/OFF button to start operation. At the start of operation, unit will be in normal low airflow mode and the ON/OFF button will have a weak-white light.



To switch to high airflow mode

Press the ON/OFF button whilst in operation and the airflow volume will increase to high airflow mode and the ON/OFF button will have a blue light.

To switch off unit

Press the ON/OFF button again to stop operation.

LED Indicator

When the power ON/OFF indicator flashes in different colours, they indicate following situations:

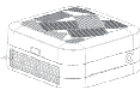

	Fan Speed	Slow Flash	Fast Flash
Blue Indicator	Highest	Charging & Charging	Low Power
White Indicator	Lowest	Charging & Charging	Low Power

- When the indicator flashes white and then blue alternately, it indicates that the unit is off and is charging.

Memory Function

When the external power supply is stopped or interrupted unexpectedly, the unit will automatically transfer to its internal battery power supply. When the battery is exhausted and the unit stops running, it will memorise the operation mode and will return to the previous mode when external power is re-connected to it.



Maintenance & Care

WARNING



Always disconnect the power supply of the unit before any maintenance or care process is carried out (except replacing filters).

(Otherwise the unit might still be running and could cause an electrical shock causing injury.)

Note

- It is prohibited to clean the unit with any detergent.
- If cleaning the unit by using a cloth that is chemically treated, please read the instructions supplied.
- During maintenance work, do not touch the disassembled parts randomly and ensure you do not stumble over them, thus injuring yourself or damaging the parts.
- Do not operate unit if HEPA Filter has not been installed, since this could cause irreversible damage to NCCO Reactor.
- If the HEPA Filter is not replaced periodically as indicated in instructions, it may seriously affect the efficiency of the NCCO Reactor.

Cleaning Methods

1 Cleaning External Surfaces of Unit Body



Please first take out Air Inlet Cover before washing it with water (only Air Inlet Cover can be washed with water). The main body of the unit can be wiped with a soft dry cloth but avoid dust falling on HEPA Filter or NCCO Reactor.

Note

After washing the air inlet cover, please ensure that it is completely dry before replacing onto the main unit.

Tips : A damp (non-abrasive) cloth can be used to clean the unit surface.

2 Cleaning Air Inlet and Air Outlet

Use a soft brush or light vacuum to clean the air inlet and air outlet.

Note

WARNING:
Never rinse or soak the HEPA Filter or NCCO Reactor with water. When storing unit for a long period of time:

- Stop operating unit and pull power plug from power source.
- Carry out any maintenance or care work.
- Place the unit in a plastic or box carton, and store in a cool dry place.

Maintenance & Care

Filter Maintenance and Replacement

1. Filter lifetime will vary depending on the environment, amount of usage and location of the unit.
2. To maintain optimal operating condition of the unit, only use the recommended filter.
3. Turn off unit but maintain power supply when replacing filters.
4. When NCCO Reactor needs to be replaced, please follow the HEPA Filter Surface Color Changing Indicator to dispose HEPA Filter.

RECOMMENDED FILTER CLEANING AND REPLACEMENT CYCLES AND METHODS		
Filter	Cycle	Method
HEPA Filter	Every 6-12 months*	Replace
NCCO Reactor	Available to sustainable use **	Available to sustainable use **

*The filters cleaning and replacement cycle may vary depending on the operation environment.

**If the HEPA Filter has not been replaced periodically or it has been damaged, and the surface of the NCCO Reactor is covered with dust or oily substances after disassembling, the removal capacity of the NCCO Reactor may be badly reduced and should be replaced.

HEPA Filter Surface Color Changing Indicator		
No need to Replace	Replacement is Recommended	Replacement is Needed

FAQ

Q1

A 'DiDiDi' sound is heard from the unit and the unit is not operational.

A

Please re-check whether the HEPA Filter and NCCO Reactor Combination has been properly installed. If not, please re-install HEPA Filter and NCCO Combination.

Q2

Can the HEPA Filter be washed?

A

NO, the HEPA Filter is made of composite material and washing will seriously affect its purification capacity.

Q3

Air quality still has not improved even after operating for a long period of time.

A

When the unit being used in a seriously polluted area, the treatment process will take a long time. Continue operating the unit in high airflow mode until pollution is reduced.

Q4

The unit emits an unusual smell or smoke (e.g. smoke, flames or burning)

A

Immediately turn off unit and disconnect power supply. Then contact your local service centre or authorised distributor service centre for resolution.

Trouble Shooting

Problem	Solution
Unit does not operate.	Check whether the unit is correctly connected to its power supply. (Please refer to page 8 for the correct method of connecting the power supply.) Turn on unit.
'DiDiDi' sound is heard and unit does not operate.	Check whether the filters have been correctly installed. Re-install filters.
No air is being blown out of the Air Outlet.	Check whether the unit is correctly connected to its power supply. Turn on unit.
Air quality still has not improved despite operating for a long time.	If the unit is used in a seriously polluted area, the treatment process will take longer than normal. It is recommended to operate the unit using its high airflow mode until the pollution diminishes.
	Filters might require cleaning or replaced. Clean or replace filters.
Airflow speed at Air Outlet becomes slow.	HEPA Filter may be clogged or blocked. Replace HEPA Filter. (Refer to page 7 for method of replacing HEPA Filter).
	Make sure all packaging materials are removed.
Unit produces abnormal noise.	Make sure all packaging materials are removed.
	Make sure Air Inlet and Air Outlet are not blocked by foreign matter.
	The unit may be malfunctioning – Seek advice from service centre or an authorised service provider.
Unit emits unusual smell, odour or smoke (also flames or burning).	Immediately switch off unit and disconnect its power source. Contact local service centre or authorised service provider.

Product Specification

Power Supply			DC5V 2A
Power Consumption (W)	Mode	Lowest	1.3
		Highest	2.5
Airflow Volume (m ³ /hr)	Mode	Lowest	12
		Highest	25
Noise Level (dB)	Sound Pressure Level	34 dB-38 dB	
	Sound Power Level	40.6 dB-44.9 dB	
Product Dimension (L x W x H) (mm)			160 (L) x 160 (W) x 73 (H)
Net Weight (kg)			0.85
Treatment System		Active Oxygen Generator	Sterilization & Disinfection
		HEPA Filter	Removes dust, hair, and airborne particles such as allergens, pollen, bacteria, viruses and fungus.
		NCCO Reactor	Removes odour, decomposes and oxidises formaldehyde, VOCs and other harmful pollutants.